

188

item 4

5430 0005

REPORT OF THE PROPERTY OF THE
YERINGTON MALACHITE COPPER COMPANY
YERINGTON MINING DISTRICT? LYON CO.,
NEVADA,
BY
D. MacVICHE.

September 27, 1911.
Salt Lake City, Utah.

Salt Lake City, Utah.

September 27, 1911.

REPORT ON THE PROPERTY OF THE
YERINGTON MALACHITE COPPER CO.
YERINGTON MINING DISTRICT, LYON CO.
NEVADA.

LOCATION.

The property is situated in Lyon County, Mason Mining District, State of Nevada, fourteen miles south of Wabuska, a station on the line of the Nevada-California Railroad, and five and a half ($5\frac{1}{2}$) miles west of Yerington, in Mason Valley. It is on the eastern slope of the range of mountains which form the western boundary of the Mason Valley.

The Nevada Copper Belt Railroad, an enterprise financed and constructed by the interest of the Nevada-Douglas Copper Company of Mason, Nevada, connects with the Nevada-California Railroad at Wabuska, and extends to the Nevada-Douglas Mine in Smith Valley, which is located on the western slope of the range of mountains in which the Malachite, Mason Valley and Blue Stone Mines are situated. The Nevada Copper Belt also extends from Wabuska in a northerly direction about three miles to the Mason Valley Mines Company Smelter.

This is better understood by referring to the blue Print of the Mason Mining District.

PROPERTY.

The property consists of the following mining claims, having a total of 192.563 acres, all held by United States Patent, and covering about two thousand (2,000) feet of the strike of the mineral zone:

Malachite,
Malachite Extension,
Malachite Fraction,
Malachite No. 1,

Malachite No. 2,
" " 3,
Montgomery,
January,

Plumbum
Know U Dont,
Lime Ridge.

GEOLOGY.

The country rock is a dolomite and garnet limestone Epidote with large bunches of black shale and porphyry dykes. About two thousand (2,000) feet north, at the north end of the property of the Mason Valley Mining Company, there is a large flow of Rhyolite; to the west, on the west side of the McConnel Hill, the granite outcrops with a dip to the east, indicating that the underlying rocks at the Malachite are granite.

The ore bodies occur in a fissured zone with its strike practically north-south, and are a replacement of the limestone. The copper occurs in the form of chalcopyrite, chalcocite, cuprite or native copper, bornite and malachite.

The property is joined by the Mason Valley on the North and extends to the property of the Western Nevada Copper Co. on the south. This is shown by blue print indicating the claims of the three properties.

The writer has had the advantage of examining the Mason Valley Mines Company property, immediately adjoining the Malachite property on the north, and has permission to use the information gained by such examination, for the benefit of the Malachite Copper Co.

The Mason Valley Mines Company in their No. 3 Tunnel, which is approximately three hundred (300') feet below the outcrop of ore on the surface, is developed to within sixty (60') feet of the line dividing the two properties. The breast of the tunnel within sixty feet of the Malachite line is in ore of good quality. In fact there is a stope approximately one hundred (100') feet north of the dividing line, which shows a width of sixty (60') feet of excellent copper ore.

GEOLOGY.-continued.

The Mason Valley Mines Company claim a developed tonnage of one million (1,000,000) tons. I feel confident that this estimate is conservative. In fact I am of the opinion that it will run very much over the million ton mark.

The property of the Malachite Copper Company has a very fine surface showing, the mineralized area being 200 feet in width. I am of the opinion that ore may be found anywhere within this area.

The Zone is extensively fissured north and south in the Mason District. The mineral bearing solutions ascended through the fissures and replaced the limestone with ore in irregular masses. These masses sometimes have an abnormal swell which yield a very large tonnage.

This condition is shown conclusively in the development of the Mason Valley Mines.

Pits have been sunk on the outcrop entirely across the property of the Malachite Copper Company and a great majority of them show profitable ore; in fact the outcrop of ore is remarkable for its continuity and persistency, extending almost across both properties. This demonstrates beyond a question of a doubt, that the properties are on the same vein or zone.

DEVELOPMENT.

Developments are shown by the sample map. They consist of a tunnel on the Malachite Claim, approximately five hundred fifty (550) feet in length; the number of the sample indicate how much of this tunnel is in ore.

On the January Claim there are a number of open pits and a tunnel. At the end of the tunnel the Natchez winze sunk to a depth of about fifty (50) feet, covers the development of this claim. The winze is in good ore from top to bottom.

A working shaft on the Plumbum claim, started in the black shale and away from the ore, with a view of making it a permanent shaft for operating the property, is sunk to a depth of

one hundred forty two (142) feet. This is a three compartment shaft well constructed.

There is also a tennel on the Plumbum Claim. This tunnel does not show any ore.

There are a great number of shallow pits sunk on the outcrop of the Malachite Claim, which show ore of good quality. The writer did not sample these shallow pits. Samples from the pits were taken by Grant Snyder and are shown on the sample map.

The samples taken under the writer's directions average 6.17% copper. This average is arrived at by the usual method of foot per cent. Sample No. 16 is not included in the average for the reason that it shows only a bunch of sulphide ore, isolated from the others.

EQUIPMENT.

The property is equipped with a hoisting plant of thirty (30) horsepower; an air compressor with a capacity of seven hundred fifty (750) feet of free air per minute; blacksmith shop, boarding house and bunk house.

Electricity, furnished by the Truckee River General Electric Company and transmitted about forty (40) miles, is used for power.

GENERAL DISCUSSION.

The developments are not such as to make possible the measuring of the ore; in other words, the ore bodies are not blocked out, neither are the workings of sufficient depth to determine the permanency of the ore. However, from the fact that it is on the same vein or ore zone as that of the Mason Valley Mine, there is scarcely a doubt but that the ore bodies developed near the surface will continue to depth, as they have done in the latter property.

The average of the ore in the present developments is exceptionally good. The prospect of developing a large mine is very favorable, and I estimate that \$30,000.00 spent in development work

GENERAL DISCUSSION - continued.

will make this property a valuable one.

I understand from the management of the Malachite Copper Company that they have recently received a proposition from the management of the Mason Valley Mines Company, whereby the Malachite Company could work through the tunnels of the Mason Valley Mines Company, and transport their ores through the tunnels and openings of the latter company, and over the Mason Valley Mines Company tramway to the Nevada Copper Belt Railroad.

It is my impression that the proposition is an attractive one and that in all probability the Malachite Company will avail itself of the opportunity. In my opinion this privilege will enhance the value of the Malachite property very materially.

The Mason Valley Mines Company smelter north of Wabuska is practically completed, and is expected to go into commission about the middle of November, 1911. This is a custom plant and to its desire to secure as much custom ore as possible, is due the attractive proposition to the Malachite Company referred to above.

It is the intention of the Mason Valley Company to carry on a general custom smelting business with their Mason Valley mine as a safe guard on which to fall back upon when short of custom ore. For this reason they are desirous of assisting meritorious properties in the Yerington and Mason Districts to develop their ore, so that as sufficient tonnage may be had for the smelter.

There is, no doubt, but that all the mining companies in these districts who are successful in developing ore, will find the Mason Valley Smelter able and willing to co-operate with them in their advantage in the treatment of their ores.

The completion of the Nevada Copper Belt Railroad into the Mason Mining District; the heavy tonnage of ore now exposed in the Mason Valley Mine and in the property of the Nevada-Douglas Copper Company on the western side of the range; the large tonnage developed in the Blue Stone Mine belonging to Captain J. R. DeLaMar; and the considerable tonnage in the McConnell and Western

Nevada properties, together with the completion of the custom smelter, make the Yerington Malachite an attractive mining venture.

Respectfully submitted,

D. MacVichie.

CRISMON & NICHOLS? Assayers.

Salt Lake City, Utah.

Description	No.	Per cent Copper	Ounces sil- ver per ton.	Ounces gold per ton
	1	2.92	0.10	Trace
	2	0.81	Trace	"
	3	6.36	0.10	0.015
	4	7.48	0.10	0.01
	5	5.96	Trace	Trace
	6	11.81	0.20	"
	7	11.10	0.20	0.015
	8	6.65	0.20	0.01
	9	9.79	2.00	0.015
	10	5.86	0.20	Trace
	11	5.57	0.10	0.01
	12	3.84	Trace	Trace
	13	2.43	"	"
	14	2.73	0.30	"
	15	2.78	0.60	0.01
	16	5.05	0.20	0.01
	17	6.98	0.20	0.025
	18	4.35	1.60	Trace
	19	3.44	Trace	"

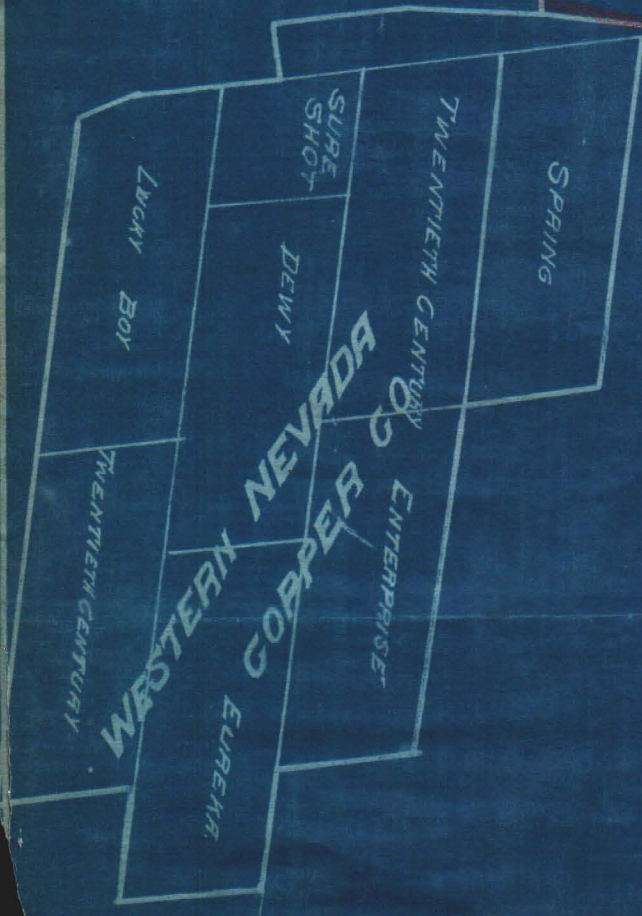

Mason Valley Mine





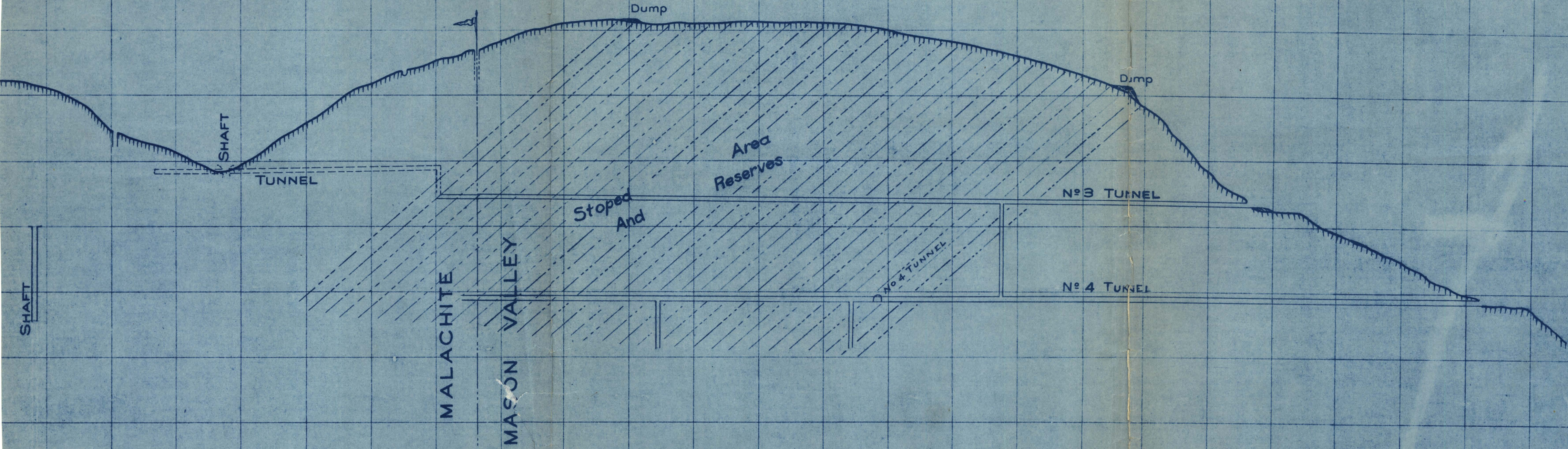

Nº 3

A geological map or sketch showing several features:

- VEIN**: Written vertically along the top left edge.
- MALACHITE**: Large, bold, italicized letters across the center.
- EXPOSED NORTH**: Written diagonally from the bottom left towards the center.
- T**: A small letter near the bottom left.
- Cu**: Several instances of "Cu" are scattered around, likely representing copper ore locations or concentrations.
- S**: A large letter near the bottom right.
- Jou 71**: Located near the top right corner.
- SH**: Located at the far top right corner.
- Hand-drawn symbols**: There are two simple rectangular shapes with vertical lines extending upwards, possibly representing structures or specific geological features.

PLUMBUM

MAIN SHAFT

Copper Co.

1952