

5350 0007

PRELIMINARY EXAMINATION
OF THE
MELLBOURNE CLAIMS
T 4 N, R 56 E, MDBM
NYE COUNTY, NEVADA
PAN-NEVADA INC
AUGUST, 1968

5350 0007

(262)

Item 9

52084.0.10V 11834

7/5000P 5000P



PRELIMINARY EXAMINATION

OF THE

MELLBOURNE CLAIMS

T 4 N, R 56 E, MDBM

NYE COUNTY, NEVADA

PAN-NEVADA, INC.

L. B. GOLDSMITH

J. K. DUFF

AUGUST, 1969

TABLE OF CONTENTS

LOCATION MAP	i
INTRODUCTION	i
GENERAL GEOLOGY	i
ECONOMIC GEOLOGY	i
CONCLUSIONS AND RECOMMENDATIONS	2
APPENDIX	

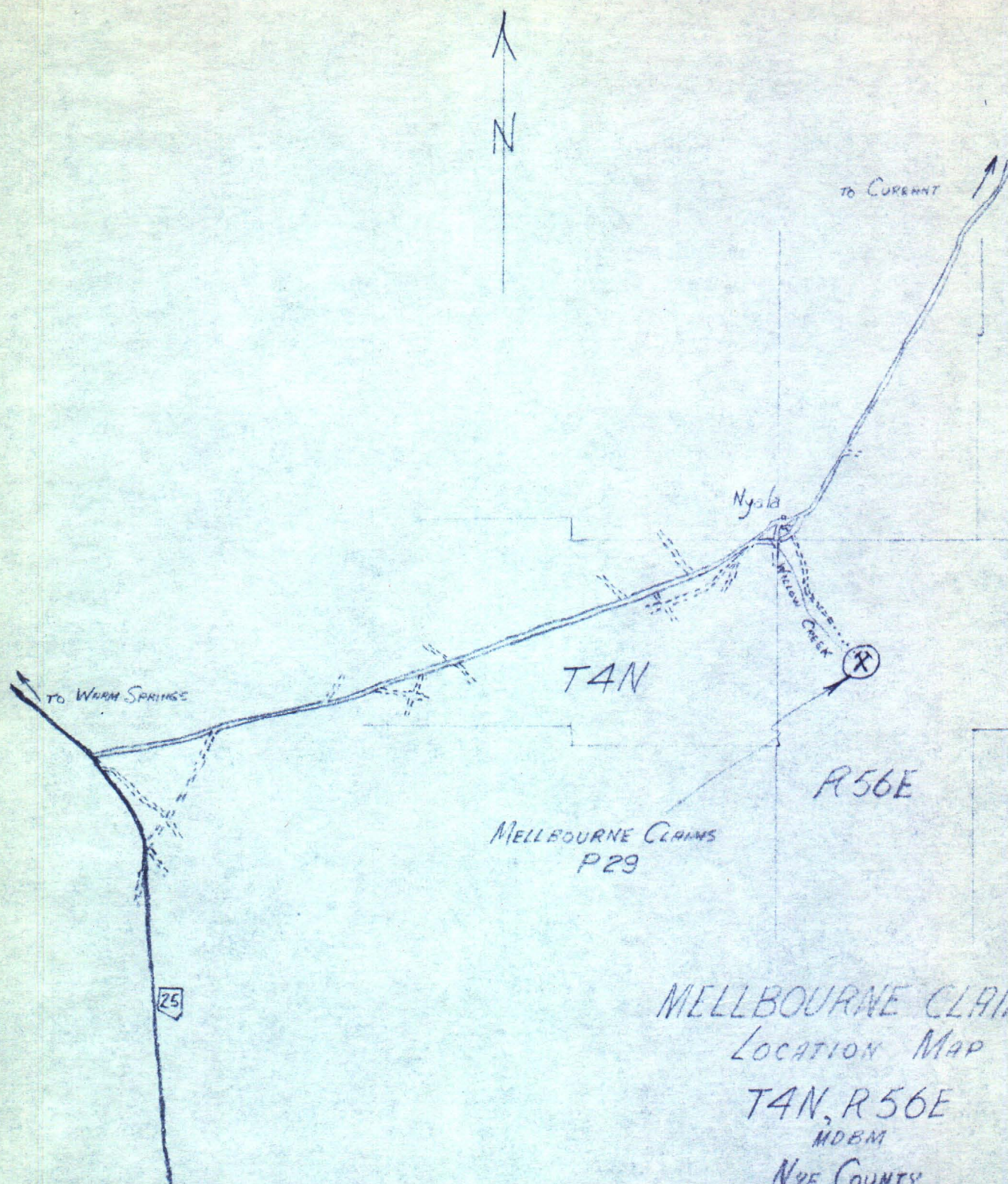

MELLBOURNE CLAIMS
LOCATION MAP

T4N, R56E

MDBM

NYE COUNTY

NEVADA

P29

SCALE

0 1 2 3 4 5
MILES

INTRODUCTION

The property consists of two unpatented claims, the Melbourne and the Willow 1, located in T 4 N, R 56 E, MDBM, an unsurveyed township, Nye County, Nevada. A road is usable as far up Willow Creek Canyon as an old stone cabin, whence a walk of one and one-half miles will bring one to the property.

Several pits, adits and a shaft have been driven on the property; a small tonnage may have been mined and taken elsewhere for treatment.

No previous economic geology report has been found.

Preliminary investigation of the property was carried out during July 26 and 27, 1968 by J. K. Duff and L. B. Goldsmith.

GENERAL GEOLOGY

The country rock is a schist, becoming more schistose near the quartz vein. Folding and dragging is present near the narrow shear zone which contains the quartz vein and veinlets. Rusty gossan and bleaching mark the shear. A porphyry dyke lies on the hangingwall of the quartz vein in one exposure.

ECONOMIC GEOLOGY

Neither the schists nor the porphyry dyke appear to carry any gold values. Sample No. 173 across a one foot quartz vein assayed 0.100 oz. Au/ton. This vein probably fingers out into veinlets in the sample locations which did not carry gold values.

The vein may continue under overburden to the southwest but might have been tested by an adit at a lower elevation.

CONCLUSIONS AND RECOMMENDATIONS

One positive assay is not enough to use as a basis for decisions. However, the zone to the northeast from the 0.100 value did not carry gold. Tonnage potential on a one foot width of quartz with no wall rock mineralization is not great.

Since more extensive testing would require drilling, it is recommended that no expenditure be made on the property at this time.

Assessment work is complete for 1967-68. If a new lease were to be negotiated these claims could be returned to the lessor.

L. B. Goldsmith, Geologist

Pan-Nevada Inc.
August, 1968

APPENDIX

SP-1 COTTON FIBER
100% Cotton
(212)

SAMPLE LOGS - MELBOURNE GROUP

NUMBER	DESCRIPTION	ASSAYS	
		Au Ozs/ton	Ag Ozs/ton
169.	Channel, across 10'. Rusty sheared schists, with quartz veinlets. Uppermost trench on hillside.	Tr	None
170.	Channel, across 12'; NE wall of pit. Schists and quartz veinlets, rusty shear zone with alterations.	Tr	None
171.	Channel, across 6'. Rusty shear, weakly schistose. Footwall (NW) of vein; near collapsed shack.	Tr	None
172.	Channel, across 6" contact zone on FW of quartz vein at same location as No. 171. Light brown earthy alteration.	Tr	None
173.	Channel, across 1. Quartz vein. Minor limonite stain. Same location as No's 171 and 172.	0.100	0.2
174.	Channel, across 4'. Porphyry dyke on hangingwall of quartz vein. No visible mineralization. Same location as No's 171, 172, 173.	None	None

Assays were performed by the Union Assay Office, P. O. Box 1529, 269 Brooklyn Ave., Salt Lake City, Utah; the original assay report dated August 13, 1968 is signed by Glen P. Williams.