

5340 0001

306

item 1

REPORT ON

WILLARD METALS MINES COMPANY
NEW WILLARD GOLD MINES COMPANY
JOSE-DAVIS GROUP
SHEEPHENDER'S INDIAN LEASE

LOVELLOCK, PIERCE COUNTY, NEVADA.

NOTES ON THE HONEY BEE VEIN.

Examination Oct. 22-24, 1919.

By W. H. Blackburn.

Date of Report-Nov. 1, 1919.

REPORT ON THE

WILLARD METALS MINES COMPANY
NEW WILLARD GOLD MINES COMPANY
JOSE-DAVIS GROUP
SHEPHERDER'S DREAM LEASE

LOCATION:

The above properties are located about ten miles northeasterly from the town of Lovelock, Nevada. The camp of Rochester lies about three miles to the east. The Southern Pacific Railroad comes to within three miles of the property and the nearest sidetrack is Kodak, about four miles distant. The camp is now known as the Loring District. Wagon roads can be easily constructed between property and railroad without excessive grades.

PROPERTY:

Both companies and the Shepherd's Dream Lease are controlled by E. E. Roberts and W. I. Beauchamp, of Reno, Nevada. The lease was purchased from Jose and Davis and there is still \$25,000. coming to them out of a \$30,000. purchase. Although it was not verified, it is understood that Jose and Davis have charge of the mining operations on the lease until they are paid in full.

The Willard Metals Mines Company includes the following locations:

Memory 1, Memory 2, Memory 3, Memory 6, Memory 7, Memory 8, Memory 9 and Memory 10.

With these it is understood that the Rose Quartz, Apex 1, Apex 2 and Ruby Claims would be thrown in.

The New Willard Gold Mines Company includes the following locations:

Memory 4, Memory 5, Black Cloud and Black Cloud Fraction.

The Jose-Davis Group includes seven locations lying to the east and south of the Shepherd's Dream Group.

The Shepherd's Dream Group includes the Shepherd's Dream, Bankers Dream and the Prospector's Dream.

Besides the above locations, application to purchase has been made to the Southern Pacific Railway Company for the W. 1/2 of N.W. 1/4, the W. 1/2 of N.W. 1/4 of N.E. 1/4 and the

N.W. 1/4 of S.W. 1/4, Sec. 25, T. 28 N., R. 32 E. The selections of railroad land are to cover conflicts with the above mentioned groups, except the Sheepherder's Dream Lease.

None of the various claims are patented.

The lease on the Sheepherder's Dream also includes the Banker's Dream and the Prospector's Dream, and has a year and five months to run. The royalties are 7-1/2% of smelter returns up to February, 1920, and after that date the royalties are 15%.

DEVELOPMENT:

Very little or none on any group except the Sheepherder's Dream, a plat of which is shown with this report.

ORES:

Quartz and calcite vein croppings show on Apex 1, Rose Quartz and Memory 3 of the Willard Metals Mines Company, but no exploration work to determine their value.

Quartz and calcite vein croppings have been slightly prospected on the Black Cloud and Black Cloud Fraction of the New Willard Gold Mines Company, but samples No. 1 and No. 2 failed to show any appreciable value in gold or silver. These two groups are frankly admitted to be for acreage purposes primarily. The New Willard Gold Mines Company acreage would be materially benefited by the addition of Sunset 1, Sunset 2, Snowstorm and Snowstorm 1 if prospecting of the outcrops at depth were undertaken on the Black Cloud Fraction.

A lesser system of quartz and calcite vein material shows on the Jesse-Davis Group, with no development work of any kind.

The vein in the Sheepherder's Dream extends from near the southwest end line of the claim in a northeasterly direction for about 400 feet. There has been a small amount of surface prospecting done on the outcrop and some very fine gold specimens have been obtained.

The principal development work has been confined to a tunnel which has connected with two shallow shafts, the total depth below the surface nowhere being over 40 feet, and the distance developed along the vein by the tunnel being 85 feet.

The attached sketch of the tunnel shows position of the vein as exposed and the location of the samples. The highest return in gold from eight samples was 0.18 of an ounce. The samples were all from vein material indicated by Mr. Beauchamp, and go to show that outside of the spots of residual gold, the vein matter has no commercial value. All the veins examined occur in fissures in shale. Intrusions of rhyolite occur in the southeasterly portion of the district.

GENERAL:

No equipment, camp housings or improvements exist on any

of the Groups. Water has to be hauled four miles from the Humboldt River. While the Lahontan Power Line passes near the properties, it is doubtful whether they have any excess over the requirements at Rochester. Terms were not discussed.

CONCLUSION:

On account of the spotted character of the Sheepherder's Dream vein, and the apparent absence of values in the outcrop on the other groups, these properties cannot be recommended for further development.

THE HONEY HIVE GROUP.

Located southeasterly from the properties under consideration, and containing practically the same type of vein in fissured shale.

At present considerable exploration of the outcrop of the Finlander vein is being done. Sinking of the Malley shaft is in progress, and shows an unaltered shale as depth increases. The surface shales show effects of weathering and oxidization.

The main vein under development is no more impressive than the Sheepherder's Dream vein. The equipment is small and of the gas engine type.

Tonopah, Nevada,

November 1, 1919.

CLASS OF SERVICE	SYMBOL
Telegram	
Day Letter	Blue
Night Message	Nite
Night Letter	N L

If none of these three symbols appears after the check (number of words) this is a telegram. Otherwise its character is indicated by the symbol appearing after the check.

WESTERN UNION



TELEGRAM

NEWCOMB CARLTON, PRESIDENT

GEORGE W. E. ATKINS, FIRST VICE-PRESIDENT

CLASS OF SERVICE	SYMBOL
Telegram	
Day Letter	Blue
Night Message	Nite
Night Letter	N L

If none of these three symbols appears after the check (number of words) this is a telegram. Otherwise its character is indicated by the symbol appearing after the check.

RECEIVED AT

25J MS 95 BLUE

127 N. CENTER ST., RENO, NEV., PHONE 436, ALWAYS OPEN

TONOPAH NEV 409P OCT 25 1919

W H BLACKBURN

170
RIVERSIDE HOTEL RENO NEV

SAMPLE ONE GOLD TRACE SILVER POINT TWELVE SAMPLE TWO GOLD TRACE SILVER
POINT TWELVE SAMPLE THREE GOLD POINT NAUGHT TWO SILVER TRACE SAMPLE
FOUR GOLD POINT EIGHTEEN SILVER POINT FORTY TWO SAMPLE FIVE GOLD POINT
TEN SILVER POINT TWENTY TWO SAMPLE SIX GOLD POINT NAUGHT SIX SILVER POINT
TWENTY TWO SAMPLE SEVEN GOLD TRACE SILVER POINT SIX SAMPLE EIGHT GOLD
POINT NAUGHT TWO SILVER POINT TWENTY SIX SAMPLE NINE GOLD POINT NAUGHT
TWO SILVER POINT TWENTY EIGHT SAMPLE TEN GOLD POINT NAUGHT EIGHT SILVER
POINT SIXTEEN SAMPLE ELEVEN GOLD POINT SIXTEEN SILVER POINT TWENTY EIGHT

H A JOHNSON 450P

CLASS OF SERVICE DESIRED	
Telegram	
Day Letter	X
Night Message	
Night Letter	

Patrons should mark an X opposite the class of service desired; OTHERWISE THE MESSAGE WILL BE TRANSMITTED AS A FULL-RATE TELEGRAM

WESTERN UNION TELEGRAM

NEWCOMB CARLTON, PRESIDENT

GEORGE W. E. ATKINS, FIRST VICE-PRESIDENT

Receiver's No.
Check
Time Filed

Send the following message, subject to the terms
on back hereof, which are hereby agreed to

Tonopah, Nev., Oct. 25, 1919.

W. H. BLACKBURN,
RIVERSIDE HOTEL,
RENO, NEVADA.

CONFIRMATION

SAMPLE ONE GOLD TRACE SILVER POINT TWELVE. SAMPLE TWO GOLD TRACE SILVER POINT
TWELVE. SAMPLE THREE GOLD POINT NAUGHT TWO SILVER TRACE. SAMPLE FOUR
GOLD POINT EIGHTEEN SILVER POINT FORTY TWO. SAMPLE FIVE GOLD POINT TEN
SILVER POINT TWENTY TWO. SAMPLE SIX GOLD POINT NAUGHT SIX SILVER POINT
TWENTY TWO. SAMPLE SEVEN GOLD TRACE SILVER POINT SIX. SAMPLE EIGHT GOLD
POINT NAUGHT TWO SILVER POINT TWENTY SIX. SAMPLE NINE GOLD POINT NAUGHT TWO
SILVER POINT TWENTY EIGHT. SAMPLE TEN GOLD POINT NAUGHT EIGHT SILVER POINT
SIXTEEN. SAMPLE ELEVEN GOLD POINT SIXTEEN SILVER POINT TWENTY EIGHT.

H. A. JOHNSON.

CHARGE T.M.CO.

ALL MESSAGES TAKEN BY THIS COMPANY ARE SUBJECT TO THE FOLLOWING TERMS:

To guard against mistakes or delays, the sender of a message should order it REPEATED, that is, telegraphed back to the originating office for comparison. For this, one-half the unrepeated message rate is charged in addition. Unless otherwise indicated on its face, THIS IS AN UNREPEATED MESSAGE AND PAID FOR AS SUCH, in consideration whereof it is agreed between the sender of the message and this Company as follows:

1. The Company shall not be liable for mistakes or delays in the transmission or delivery, or for non-delivery, of any UNREPEATED message, beyond the amount received for sending the same; nor for mistakes or delays in the transmission or delivery, or for non-delivery, of any REPEATED message, beyond fifty times the sum received for sending the same, *unless specially valued*; nor in any case for delays arising from unavoidable interruption in the working of its lines; *nor for errors in cipher or obscure messages.*

2. In any event the Company shall not be liable for damages for any mistakes or delays in the transmission or delivery, or for the non-delivery, of this message, whether caused by the negligence of its servants or otherwise, beyond the sum of FIFTY DOLLARS, at which amount this message is hereby valued, unless a greater value is stated in writing hereon at the time the message is offered to the Company for transmission, and an additional sum paid or agreed to be paid based on such value equal to one-tenth of one per cent. thereof.

3. The Company is hereby made the agent of the sender, without liability, to forward this message over the lines of any other Company when necessary to reach its destination.

4. Messages will be delivered free within one-half mile of the Company's office in towns of 5,000 population or less, and within one mile of such office in other cities or towns. Beyond these limits the Company does not undertake to make delivery, but will, without liability, at the sender's request, as his agent and at his expense, endeavor to contract for him for such delivery at a reasonable price.

5. No responsibility attaches to this Company concerning messages until the same are accepted at one of its transmitting offices; and if a message is sent to such office by one of the Company's messengers, he acts for that purpose as the agent of the sender.

6. The Company will not be liable for damages or statutory penalties in any case where the claim is not presented in writing within sixty days after the message is filed with the Company for transmission.

7. *Special terms governing the transmission of messages under the classes of messages enumerated below shall apply to messages in each of such respective classes in addition to all foregoing terms.*

8. *No employee of the Company is authorized to vary the foregoing.*

THE WESTERN UNION TELEGRAPH COMPANY

INCORPORATED
NEWCOMB CARLTON, PRESIDENT

CLASSES OF SERVICE

TELEGRAMS

A full-rate expedited service.

NIGHT MESSAGES

Accepted up to 2.00 A.M. at reduced rates to be sent during the night and delivered not earlier than the morning of the ensuing business day.

DAY LETTERS

A deferred day service at rates lower than the standard telegram rates as follows: One and one-half times the standard Night Letter rate for the transmission of 50 words or less and one-fifth of the initial rates for each additional 10 words or less.

SPECIAL TERMS APPLYING TO DAY LETTERS:

In further consideration of the reduced rate for this special "Day Letter" service, the following special terms in addition to those enumerated above are hereby agreed to:

A. Day Letters may be forwarded by the Telegraph Company as a deferred service and the transmission and delivery of such Day Letters is, in all respects, subordinate to the priority of transmission and delivery of regular telegrams.

B. Day Letters shall be written in plain English. Code language is not permissible.

C. This Day Letter may be delivered by the Telegraph Company by telephoning the same to the addressee, and such delivery shall be a complete discharge of the obligation of the Telegraph Company to deliver.

D. This Day Letter is received subject to the express understanding and agreement that the Company does not undertake that a Day

Letter shall be delivered on the day of its date absolutely and at all events; but that the Company's obligation in this respect is subject to the condition that there shall remain sufficient time for the transmission and delivery of such Day Letter on the day of its date during regular office hours, subject to the priority of the transmission of regular telegrams under the conditions named above.

No employee of the Company is authorized to vary the foregoing.

NIGHT LETTERS

Accepted up to 2.00 A.M. for delivery on the morning of the ensuing business day, at rates still lower than standard night message rates, as follows: The standard telegram rate for 10 words shall be charged for the transmission of 50 words or less, and one-fifth of such standard telegram rate for 10 words shall be charged for each additional 10 words or less.

SPECIAL TERMS APPLYING TO NIGHT LETTERS:

In further consideration of the reduced rate for this special "Night Letter" service, the following special terms in addition to those enumerated above are hereby agreed to:

A. Night Letters may at the option of the Telegraph Company be mailed at destination to the addressees, and the Company shall be deemed to have discharged its obligation in such cases with respect to delivery by mailing such Night Letters at destination, postage prepaid.

B. Night Letters shall be written in plain English. Code language is not permissible.

No employee of the Company is authorized to vary the foregoing.

Sheepherders Dream Lease
Scale 50 ft. to 1 inch.

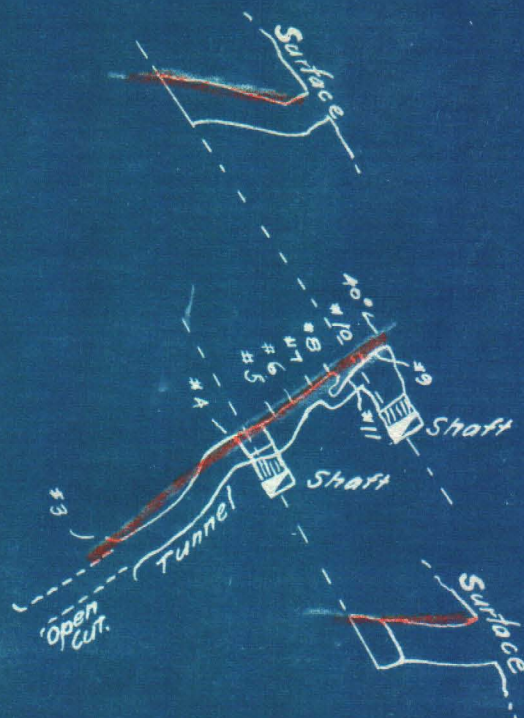

0 50 ft.

306
Hom 1

MINE *Sheepherders Dream*
Scale 50

DATE 10/23/19

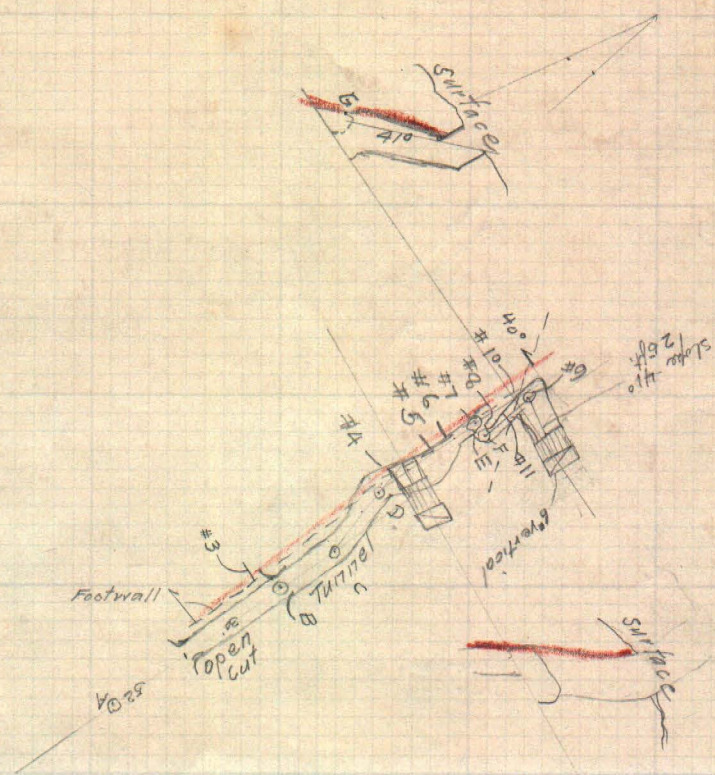
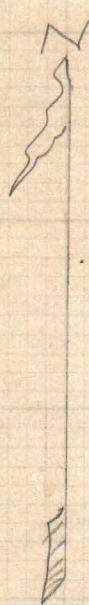

0 50 ft.

MINE

Willard District.

DATE

10/26/19

Pershing No 2

Pershing

Banker's

Dream

Gold Note

June apple

June Bug

Road to Lovelock 8 miles

Sec. 26

Sec. 35

Tin Lizzie

Sec. 25

Sec. 36

Top

Young-Goodin

Red

Midnight

Reserve

Bank of England

NEVADA Federal Honey

Ford

Shut Honey Bee

Wasa Fr

Badger

Badger

BEE FINLAND

Finland No 3

No 5

Finland No 2

Finland No 1

35° 40°

Treasure No 5

Treasure

Treasure No 1 / Treasure No 2 / Treasure No 3

T28N R32E

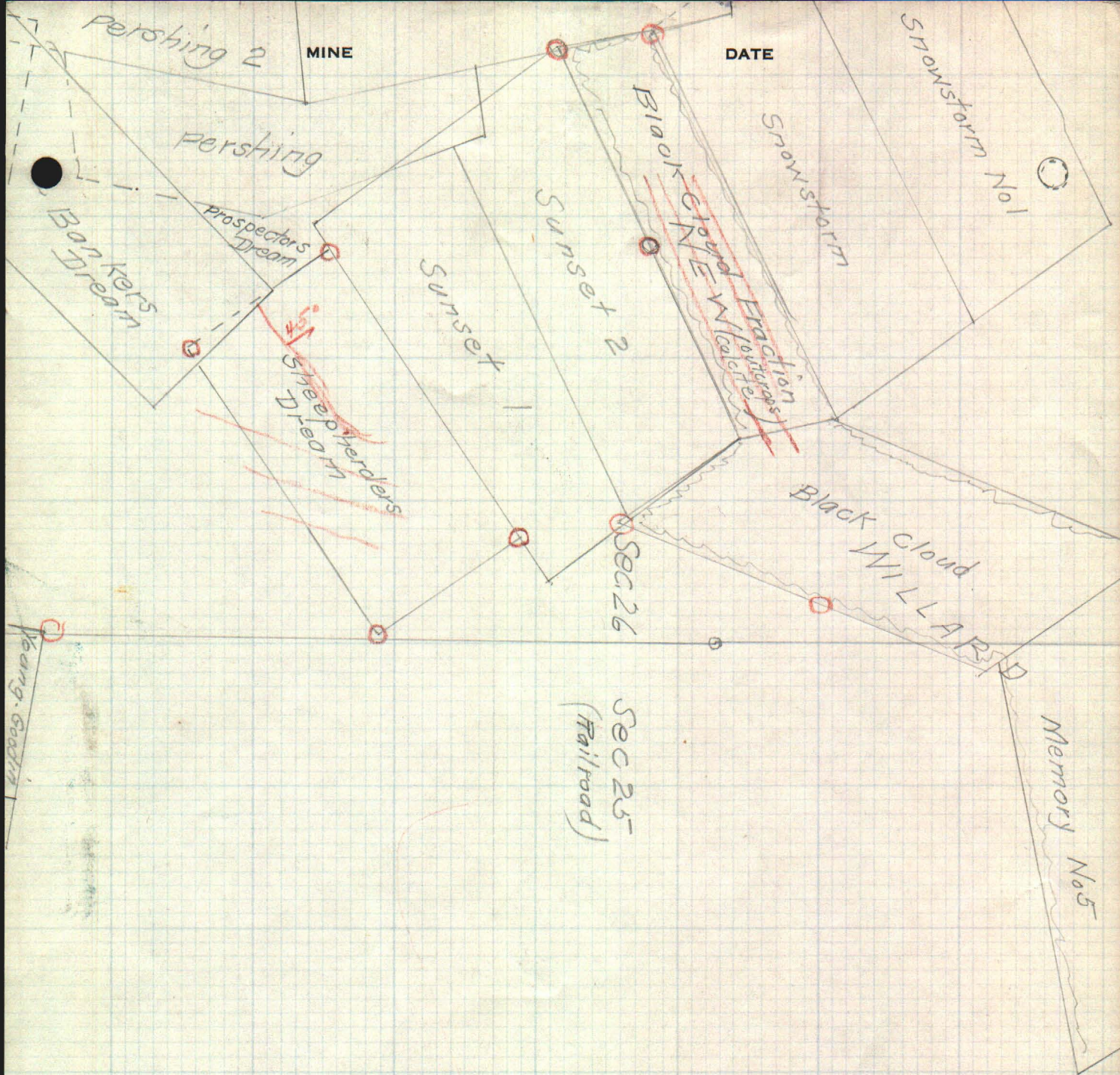

6/12/01

DATE

MINE

Ruby

SHOALS No 1

apex 2

apex 1

Part of
Quartz

Sec 26

(Railroad)
Sec 23

Memory 2

Sec 24

Memory 3
(Railroad)
Sec 25

Memory 4

GOLD MINES
Co.

Memory 5

Memory 6

Memory 7
Co.

Memory No 8

Scale 500

0 500 ft.

