

# MAYFLOWER GROUP MAP OF

## 5 MINING CLAIMS

ON TWIN RIVER

60 Miles North of Tonopah

NYE COUNTY NEV.

12-13N, 42E

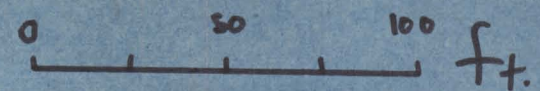

SCALE

1 inch = 50 feet

BY

JAMES H. PARKS, C.E.

GOLDFIELD, NEV.

5-6-1911.

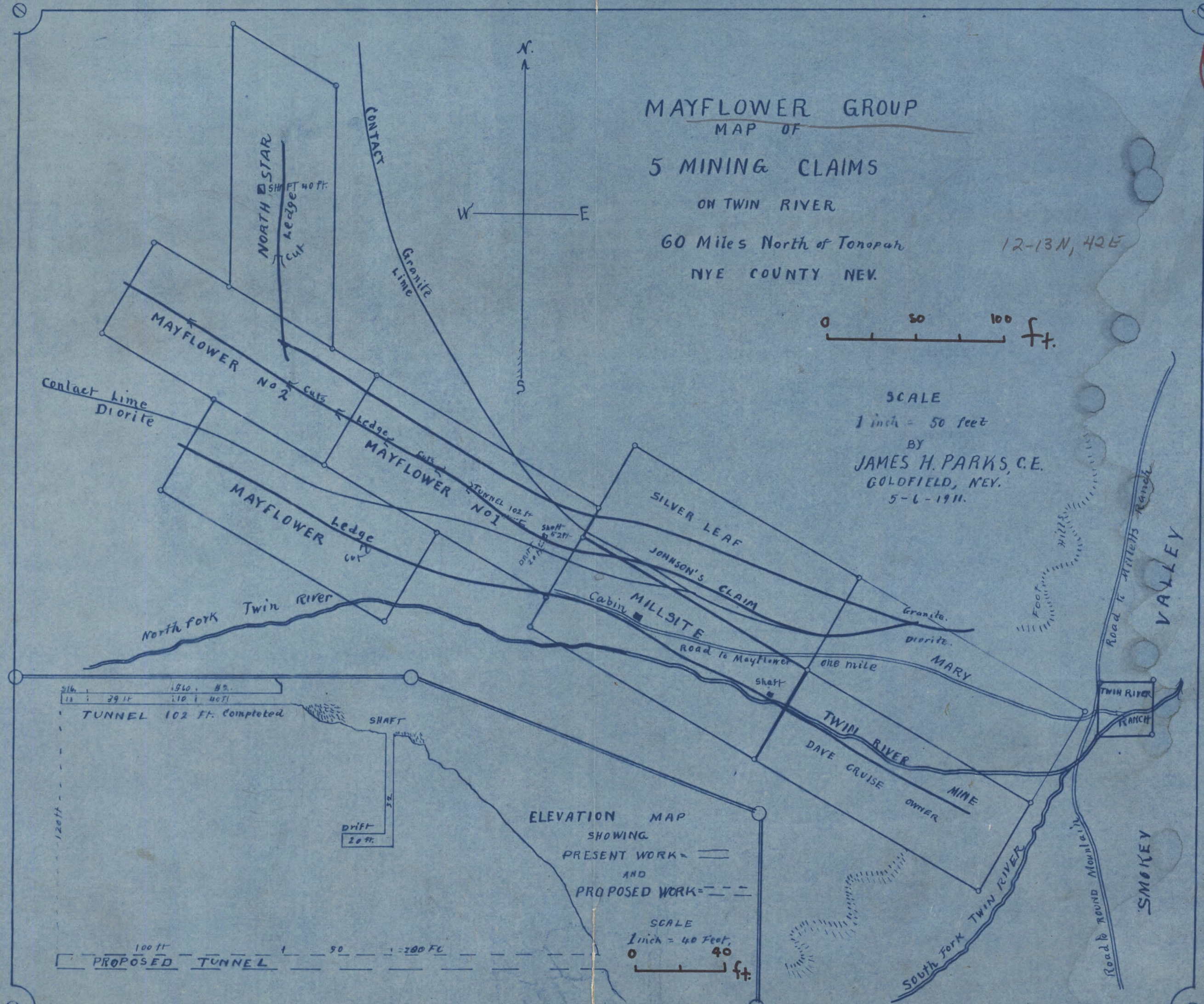

ELEVATION MAP

SHOWING

PRESENT WORK =

AND

PROPOSED WORK =

SCALE

1 inch = 40 Feet

