

The Mizpah Extension Company

The Mizpah Extension Company was probably incorporated in 1901 or 1902. It owns 13 patented claims that are north of the Belmont and Halifax mines. The main shaft of the company is 1,000 feet deep. Probably between 1 and 2 miles of workings have been driven from this shaft, a large part of which has been extended from winzes below the 1,000-foot level.

Shaft sinking was started in 1901 or 1902 and some lateral work was done at depths of 500 and 800 feet. Some low-grade ore was found but none rich enough to ship and the property apparently lapsed into inactivity until the discovery of the Belmont vein in the property to the south. This renewed work disclosed some small orebodies, from which trial shipments were made in 1913 and 1914. In 1915 the Tonopah Mining Company acquired a lease on the property but relinquished it in August, 1917, "no bodies of commercial ore having been discovered."<sup>1/</sup>

---

<sup>1/</sup>Sixteenth Annual report, The Tonopah Mining Company of Nevada, p. 8, 1918.

---

The Halifax Company appears to have leased the claims the succeeding year and made several small shipments in the succeeding years. These were in



part, however, the production of sub-lessees. The Halifax lease was probably terminated in 1923 or early 1924 since in March, 1924, the Belmont Company acquired a 5-year lease on the property. Their activities appear to have been confined chiefly to deep development work from the 1500-foot level of the Belmont shaft and no production is recorded during the period of their lease.

The following table shows the production from the Mizpah Extension mine according to unpublished records of the U. S. Geological Survey and U. S. Bureau of Mines. It is incomplete since for some years the mine production was combined with that of the companies holding leases on the property.

Production of the Mizpah Extension Mine

Year	Ore tons	Gold ounces	Silver ounces	
1913	33	10.05	892	1.127
1914	17	16.76	1,523	1.101
1915	33	10.56	965	1.095
1916	--	--	--	--
1917	--	--	--	--
1918	--	--	--	--
1919	--	--	--	--
1920	--	--	--	--
1921	949	157.93	23,345	.676
1922	14	2.30	200	1.150
1923	--	--	--	--







1400  
2600  
Miz. Ex. 1155L

1" = 80'

(3)

Raise-up 60 Ft. in M.T.

Qtz in Top Drift

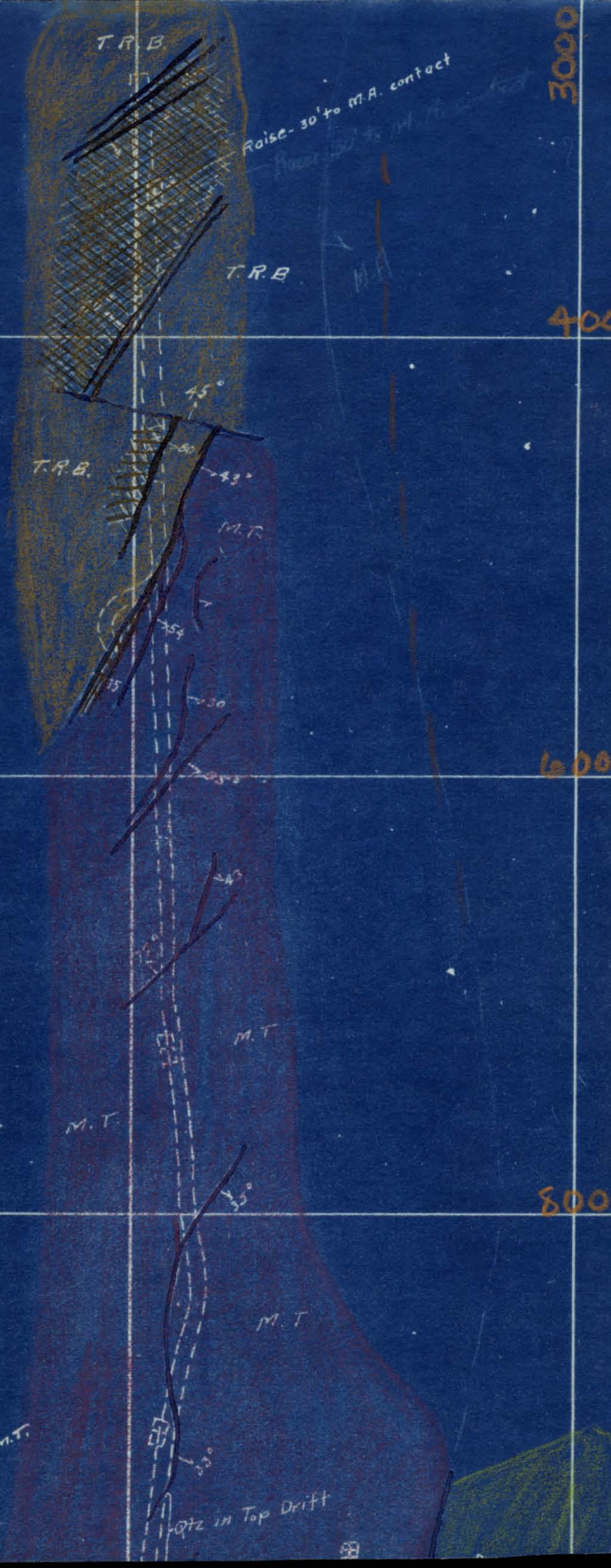



UN.

 $1'' = 80'$ 

1004

1200

1400

2600

280

3000-3





1600

1800

2000

2200

T.R.B.

T.R.B.

Miz. Ex. 1155L.

1" = 80'

N

1700

1400

ST

185

MB

MB

Tight Contact

WR

WR

Main Winze

6" Dry Drift

MS

WR

WR

145

WR

OR

WR

OR

Tight Intrusive Contact OR into WR

MB

180

MB

Tight Intrusive Contact OR into W.R.

Tight Sharp Contact MB and Crushed WR

1153 Level

Elev. 5142

1600

1800



MIZ. EX. 1070 L.

1000

1" = 80'

1200

1400

1600

1800

1800

2000

2200

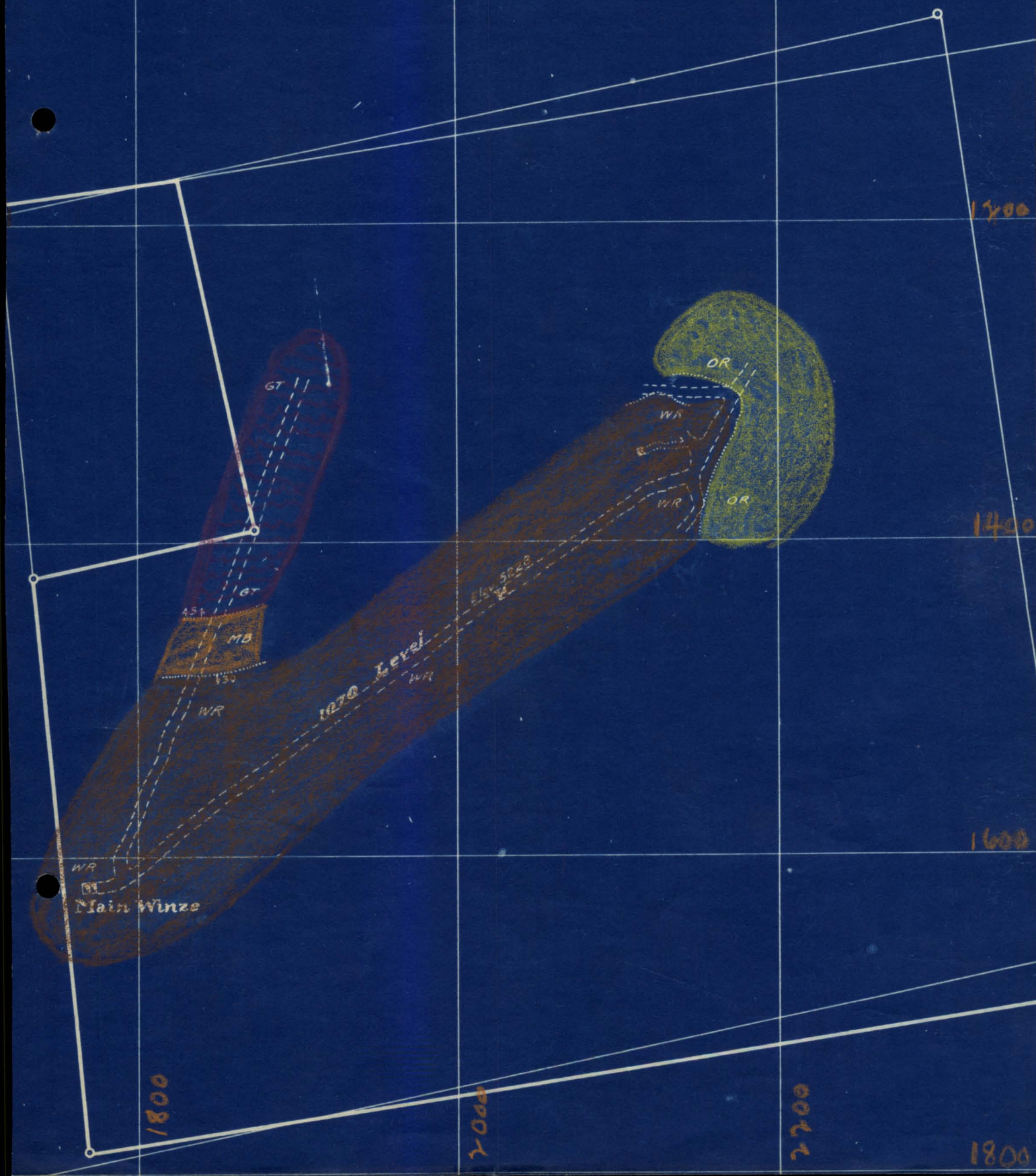



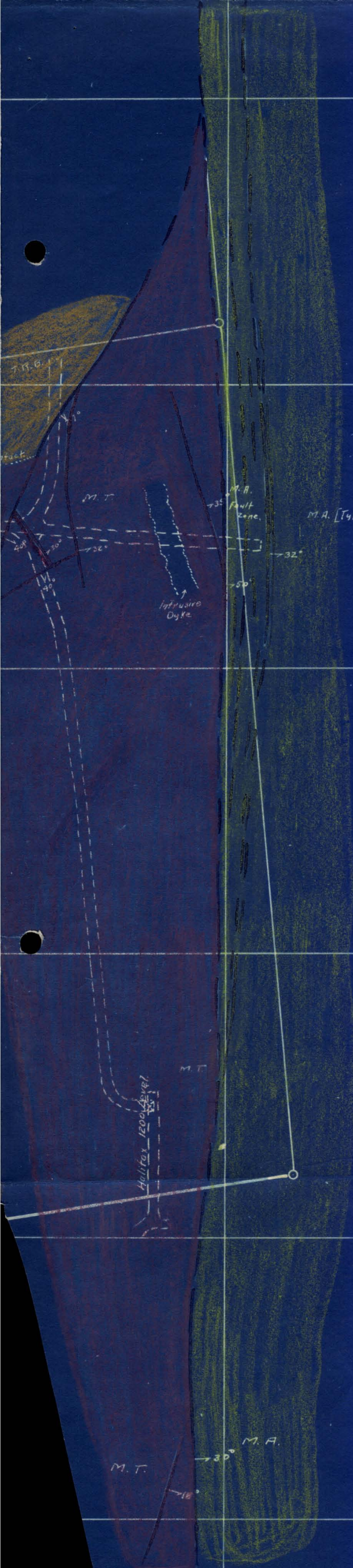

MIZ. Ex 1345  
1" = 80'

(2)

3200

3400

3600



2400

2600

1800

1000  
1200

1 N

Miz. Ex 1000L  
1" = 80'

1200

EAGLE

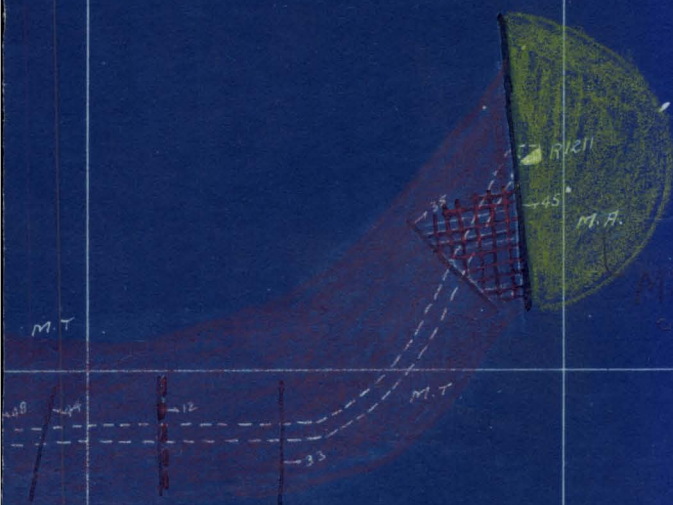

M.T.  
exp. from tracing

1400

3

1600

1800

AY - TO



1000

1800

2000

2200

N

Miz. Ex 1000L  
1" = 80'

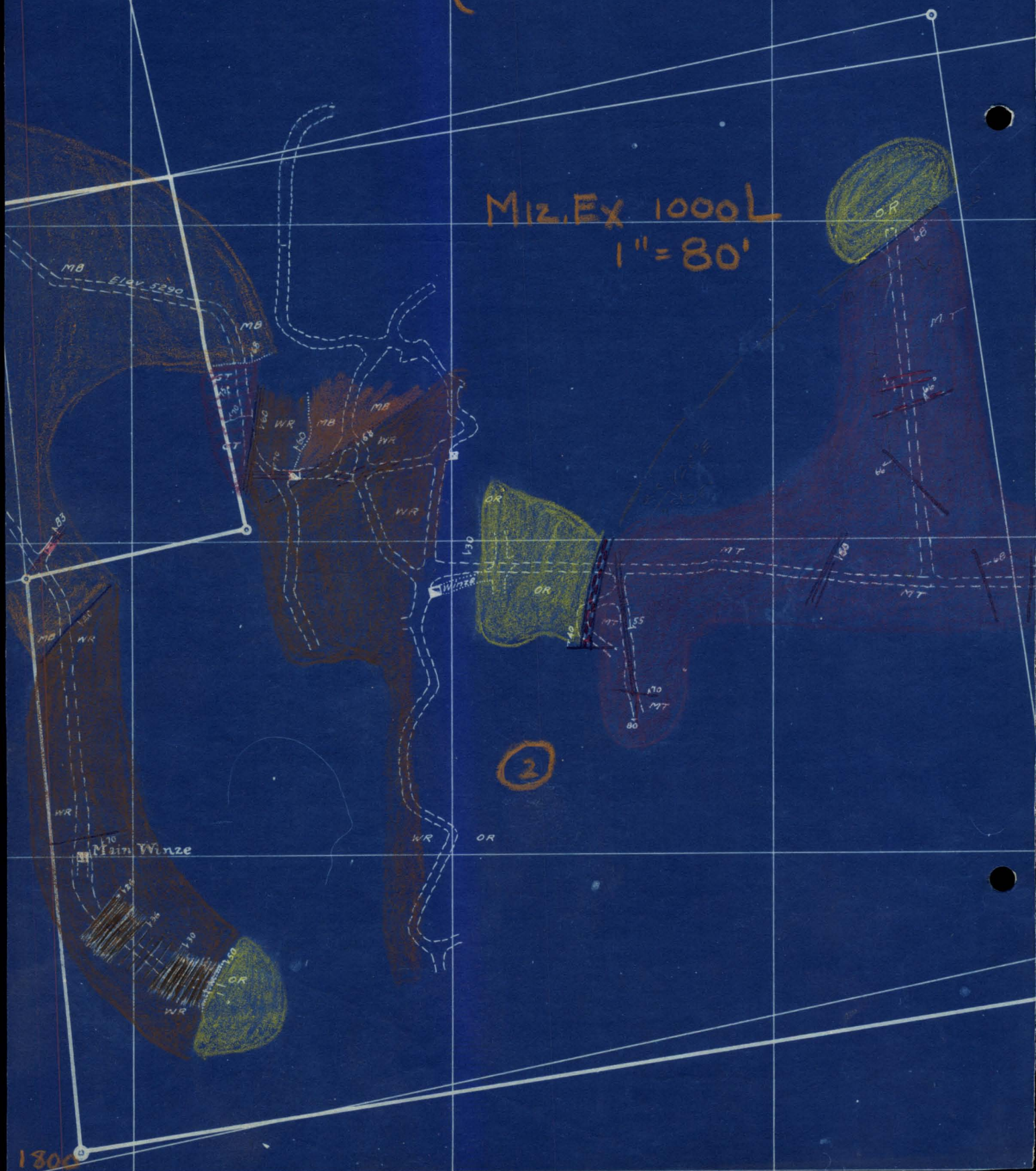

2

1800



1000

1200

1400

1600

1800

Miz Ex. 1475 L

1"=80'

①

1475 Level

Elev. 4825

GT

OR

130

GT

OR

n ze

2000

2200



# BLACKBIRD

Mizpah Extension Shaft  
(Elev. collar - 6227.39)

Miz Ex 1000 L  
1" = 80'

①

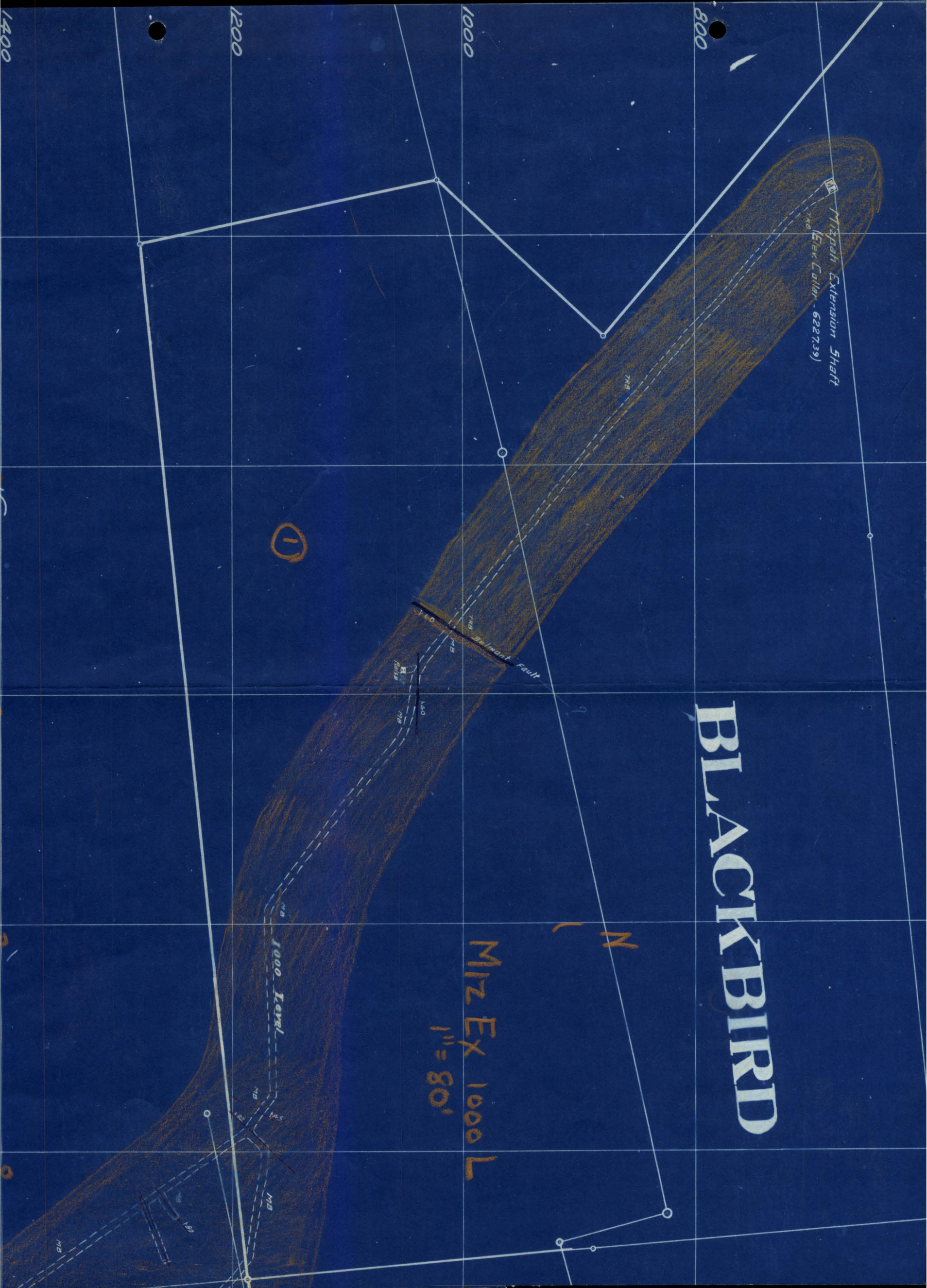



N

Miz. Ex 1370 L

1" = 80'

①

