

MABEL MINE SERIES (REPORTS)

1

J. M. FOX (1921)

H. D. RUDELMAN (130) (1924)

(254)

Item 117

1 of 46

4840 0117

REPORT ON THE MABEL MINE

GOLD RANGE MINING DISTRICT-MINERAL COUNTY-NEVADA.

LOCATION: This property is situated in what is commonly referred to as the Garfield District, about 19 miles by auto road, in a westerly direction from Mina, Nevada. The Mabel NO.1. claim of this group end lines the Lancashire claim (U.S.S.39) of the old Garfield property lying to the east. (See property map)

HOLDINGS: There are six claims in the group; Mabel NOS.1, 2, 3, 4, and the Boston Nos. 1 and 2. None are patented, all being held by assessment work which has been performed for the first half of this year and recorded at Hawthorne, the county seat.

TOPOGRAPHY: The claims are located at an approximate elevation of 7000 feet above sea level. They lie just east, or northeast of the main ridge of Gold Range, with their long axis paralleling that of the range. Within the limits of the property the relief is not extreme, so that only very moderate depth, probably not to exceed three hundred feet can be attained by tunnels of reasonable length.

WOOD AND WATER: The district is devoid of timber of any description. Water in small amounts, but of good quality, is available for domestic purposes, at a spring on the adjoining Garfield property.

EQUIPMENT: Aside from one cabin and a small blacksmith shop scantily equipped for dressing hand steel, there are no surface improvements. The mine is provided with one 16 cu. ft. car, picks, and shovels. The greater portion of the track is strip steel spiked to wooden stringers. The newer work is provided with 8# rail.

DEVELOPMENT: But little recent work has been done, the greater portion having been performed probably thirty or thirty-five years ago. The three veins comprising the vein system have been opened up for an aggregate length of between 800 and 1000 feet on their strike on the Mabel No. 1 claim, and for about 100 feet on the Mabel No. 2. On their dip, considering only the accessible portion of the main winze, the deepest vein exposure is that on the Middle vein below its junction with the Foot Wall vein. Here a depth of approximately 200 feet below the croppings has been reached. The winze is said to have followed the vein about 50 feet deeper than this, but due to muck in the bottom, this could not be confirmed.

While numerous cuts, short adit drifts, and several shafts disclose the veins at various points on the property, the most important of the workings consists of an adit crosscut driven from a point on the Lancashire Claim into the Mabel No. 1 Claim a distance of 350 feet so far as can be measured; the end of the cross cut being rendered inaccessible by a cave. Within this distance all three veins are intersected, and lateral drifts have been driven on all three. The Hanging Wall vein is further exposed by an adit drift driven upon it for a distance of 275 feet, at an elevation of 79 feet vertically above the main cross cut tunnel.

About 1500 feet westerly from the main workings, at least one vein of the system has been exposed on the Mabel No. 2 Claim by a fair amount of drifting as noted above.

GEOLOGY: Country Rock: The formation in which the veins occur is limestone, relatively thinly bedded, and in most cases considerably shattered. While the limestone forms both walls of the veins in the greater part of the mine, several instances were noted where either the foot wall or the hanging wall was dike rock. Due to alteration

it was difficult to procure a satisfactory specimen for identification, but it appears to be porphyritic in character, and may be an adesite. It was particularly noted near the face of the lower tunnel on the Hanging Wall vein, and at certain places as forming the foot wall of the Foot Wall vein where followed by the drift on the latter from the main adit crosscut.

VEINS: These are three in number, designated as the "Hanging," "Middle", and "Foot Wall" veins, all having a northwesterly strike with varying dips to the south west. The two latter parallel each other fairly consistently, showing but a slight divergence in their strike as followed to the north west. In their dip, however, they differ. (See Vertical Cross Section). A short distance below the main level, the Foot Wall vein and the Middle vein unite, and the dip below the junction gradually changes to almost 90 degrees.

Above the main level, the Foot Wall vein flattens decidedly, in places being almost horizontal. Judging from extraneous workings on it however, it must, towards surface, increase its dip, the flattening being merely a local roll.

The Middle vein is more consistent, holding an approximate dip of about 55 to 65 degrees above the main level so far as now exposed in the stopes.

The Hanging Wall vein maintains its dip of about 65 degrees fairly steadily. The apparent reversal of dip as indicated in the cross section is possibly accounted for by a series of faults displacing to the north east on its dip. If the stopes on the Hanging Wall vein above the main level were accessible this could be proved or disproved. It is an important point as having a bearing on the likelihood of the Hanging Wall vein uniting with the others in depth. If a reversal of dip does occur, such a junction may be anticipated;

otherwise not.

The strike of the Hanging Wall vein shows a marked divergence from the other veins in a northwesterly direction.

ORE: The values present are silver and gold only, of importance in the order named, silver greatly predominating. No bases were noted. The silver occurs either as black, cloudy, areas, or as well defined sooty looking aggregates of the silver sulphides in white, well crystallized quartz. In certain oxidized portions of the veins, the halogen salts of silver were noted in small amounts.

The gangue is at all times quartz. Sampling indicated the absence of important values wherever quartz was lacking. The ore shoots are lenticular, pinching out, both on their strike and their dip in relatively short distances. Between shoots the vein is indicated by a variable width of selvage or gouge. This, if followed, has to date, always disclosed other quartz lenses carrying usually, pay values. Both walls are well defined, particularly so at the ore shoots and the quartz breaks down clean in all cases.

Work to date would indicate that about 50% of the vein on its strike was composed of ore shoots of variable width and tenor. From what could be seen of the old stoping, this percentage is greater on the dip, probably being about 75%. If so, the mineable portion of the veins, yet to be exposed, might be between 35% and 40% of the veins total volume.

FAULTING: Faults, transverse to the strike of the veins are numerous, but the displacement is moderate in all instances. The lower level on the Hanging Wall vein shows this feature well. (See insert. Vertical Cross Section). There is evidence also, particularly in the case of the Foot Wall vein, that faulting on one or both walls was not infrequent. Possibly proximity to surface may

account for much of this and in depth faulting may be less pronounced. "C" Level would indicate this. Here both walls are less fractured, and the formation appears to be less disturbed and tighter than in the upper workings.

ORE RESERVES: These are negligible. So far as the mine has been opened, aside from the new east and west stopes, and a short length on the Middle Vein in the older workings, no positive reserves can be estimated. The older workings indicate the comparatively complete removal of the pay ore. As the values are confined to the quartz streak only, and do not penetrate the walls, the latter cannot be depended upon to yield mill ore in any amount, and furthermore, as the values in the quartz drop from relatively high figures to practically nothing, those portions of the vein left are too low in grade to be considered as mill ore. Therefore it is judged that the blocks indicated, A, B, and C, constitute the legitimate reserves now exposed.

<u>Block</u>	<u>Av. Val.</u>	<u>Av. Width.</u>	<u>Tons</u>	<u>Total Value</u>
A	\$67.18	1.16'	401	\$26939
B	\$14.10	0.9'	285	\$ 4018
C	\$32.40	1.0'	241	\$ 7808
Total	\$41.82	1.0	927	\$38765

SAMPLING: Samples were taken wherever possible of ore exposures both in drifts and stopes. Five foot intervals were used. In addition special samples were taken to indicate the presence or absence of values in the wall rock. A grab sample was taken from 25 out of a large number of sacks or sorted ore on the dump. This returned \$118.

The majority of the samples taken are platted on the stope assay plan. The number of the sample, together with the value and width sampled are indicated. Samples not shown on this plan will be found on the other maps.

DISCUSSION: The three veins described converge on their strike toward the south east, and at a relatively short distance, about 400 to 500 feet easterly from the common end line of the Lancashire and the Mabel No. 1 claims, unite to form the, at one time, very productive vein mined by the old Garfield company. A study of the latter's stoping maps should indicate the percentage of profitable stoping ground in that vein and aid in determining, to a certain extent, the possibilities of the veins in the Mabel ground. It is not thought that the veins will unite at any point on their strike in the latter property, but they may on their dip. Two already have, and the third may, or may not. The reported gross production of the Garfield Mine was several million dollars, the greater portion being from high grade shipping ore.

The junction of the veins, should it occur, would rake to the north west, becoming deeper in that direction, so that greater widths or ore than those so far indicated, should apparently be sought for at greater depths than those not attained. Against this argument is the fact that "C" Level exposes the vein in an almost vertical position between walls much tighter than those above, and shows it to have a somewhat narrower width than higher up. These features may be local however.

CONCLUSIONS: Everything considered, the Mabel property is judged worthy of additional development as outlined further on, provided a suitable option can be procured. The terms of such an option are suggested below.

This conclusion is dependent on further metallurgical tests confirming the original ones, and there is not much doubt but that they will do so. The original work showed it possible to make an extraction of approximately 90%, using from 2# to 2 1-2# of cyanide.

RECOMMENDED DEVELOPMENT: Rather than seek to rehabilitate and utilize the present workings for further development, it is recommended that a new vertical shaft be sunk at some such point as X(indicated on plan and section) to a depth of 350 feet. This would put it approximately 100 feet below the present reported depth of the main winze. At this elevation cross cuts should be driven to intersect the veins and the latter then be developed by drifting.

Being located at X, the aggregate length of crosscuts required would be a minimum, unless very material changes in dip of the veins occur. It is judged that total crosscutting at the 350 foot level would not exceed 150 feet.

Assuming that the Hanging Wall vein at this depth has not united with the already united Foot Wall and Middle veins, it will be necessary to drive two drifts, one on each vein, for a recommended footage of 400 feet. The estimated cost of this work is as follows:

350 feet of shaft sinking at	\$30.00-----	\$10,500
150 " " crosscutting "	\$15.00-----	\$ 2,250
400 " " drifting "	\$12.00-----	\$ 4,800
Equipment, overhead, contingencies, etc.		\$ 7,450

Total		\$25,000

OPTION REQUIRED: It is recommended that the above work be undertaken only with the understanding that no payments be required prior to 9 months from the time the shaft work is started, and that furthermore, should unusual difficulties be encountered in the work, such as water, bad ground, etc. this time may be reasonably extended. Allowing 60 feet per month for shaft progress, eight months should see the shaft completed to the required depth, the veins intersected by crosscuts, and a small amount of drifting accomplished on the veins

Should this drifting prove encouraging, a 10% payment of the purchase price of \$50,000 could then be made advisedly. After the initial payment, the rest of the payments, three of the \$15,000 each could follow at the periods stated in the original tentative option, that is, at the end of every 90 days.

It should be agreed that any and all ore broken by the West End company during the progress of this work may be either milled as broken, or stored on dumps and held for milling at any time within two years from the time of starting shaft sinking. From the results of this milling a royalty would be paid the owners of the property, said royalty to be mutually agreed upon, and to be applied upon the purchase price of the property.

While the ore exposures on the Mabel property are admittedly small, the ore widths narrow, and the shoots limited as to length, the grade of the ore exposed is considered high enough, and the past history of the Garfield Mine suggestive enough, to warrant the conclusions drawn, and the latter are respectfully submitted for your consideration.

San Francisco, Calif,
July 10th., 1921.

J. M. Fox

Mining Engineer

NEVADA GARFIELD EXCELSIOR MINING COMPANY

156 Broadway

New York

TO INVESTORS

We offer you an investment, fully protected, and from its increase of value much profit should accrue. From the ores now on hand, generous monthly dividends can be paid. This issue of stock is made solely for the purpose of converting these ores into cash for dividends.

We have 200,000 tons of Silver-Gold Ore already mined in the Fills and on the Dumps and also 100,000 tons of Ore blocked out in sight in the Garfield Excelsior Mines at Mineral County, Nevada.

We have accepted an offer from a concern to build a Concentrating Plant on our property, capable of treating from 150 to 300 tons of ore daily, according to the character of the Ore treated, erect it at the base of our enormous Ore Dumps and take the ENTIRE PAYMENT OUT OF THE PROCEEDS. We expect it to be in operation in about three months time. Thus at no expense to us we will have a plant capable of treating enough ore to return us about \$3,000 net profit daily, taking as a basis the lowest estimate of value of the five Engineers.

EXCERPS FROM MR. MORRISON'S REPORT

This rich class of Sulphide Ore comes in at a certain depth under the surface. The "backs" of this ore body from the bend inward, for 1,000 feet are from 700 feet to 1,000 feet and reach to the surface of the mountain. The vein is over 5 feet wide, with a heavy pay-streak at the south wall about 2½ feet wide. We can count on being able to stope from above this tunnel good ore 800 feet long, 400 feet high, and 2½ feet wide, making over 50,000 tons of high grade ore which can be safely counted on as worth \$30 per ton, or a gross value of \$1,500,000. This estimate does not include, or take into consideration, the lower grade ore, of which there is a large tonnage. This estimate, further, does not include any of the richer Sulphide Ores mentioned above, but which can be steadily mined, by driving a working tunnel both ways, eastward and westward, on the vein at the foot of the 155 foot winze.

The No. 3 cross-cut tunnel has to be driven about 75 feet further to reach the winze sunk from the "Rattlesnake" tunnel. From this point every foot the tunnel is advanced along the vein means at least 50 tons of Rich Ore; and about 700 feet of advance will reach a point directly under the end of the upper tunnel and leave ready for stoping down at least 35,000 tons of rich ore, which, if we estimate at the low valuation of \$50 per ton, will give a total of \$1,750,000, all of which can be secured at cost, all told, not exceeding \$2 per ton for driving the No. 3 tunnel, stoping, hauling and tramming to the mill.

In addition to the richer ores mentioned, a LARGE QUANTITY of low grade ore can be supplied from these same stopes, as I found that these ore bodies were from ten to twenty feet wide in many places where they cross-cut to the walls. Most of the ore on the Dumps, to an amount of over 100,000 tons, will pay handsomely for milling or concentration, the same remark also applies to a quantity of ore in the stoped chambers.

EXCERPS FROM MR. BOYLE'S REPORT.

							Total.
Sample	Lancashire Tunnel	Assayed	Silver	\$147.52	Gold	\$12.61	\$160.13
"	Great Western Dump	"	"	32.46	"	.41	32.87
"	Fill No. 2 Winze	"	"	14.62	"	7.85	22.47

The foregoing sample was taken from the surface of the Dump, and owing to the weathering and leaching by rains and snows, and also the fact that the last work done was in lower grade ore and piled last on dump, it should run as a whole higher than the sample shows.

The Garfield covers a highly mineralized area and has produced, something in the neighborhood of \$5,000,000. The Sulphide Zone, which should be productive of better values, has never been reached and should be encountered within 500 feet from the collar of the proposed shaft. The entire Bolton claim, and much of the Atherton and Lancashire claims are not prospected, and this untouched area should be as productive as anything opened up. Further, there may be still other ore bodies above the present working levels which could be uncovered by careful prospecting and development work.

To provide labor costs until our Concentration Plant is running, One hundred thousand shares of Stock will be sold at the special low price of fifty cents a share. The Ore already mined and blocked out gives the stock an estimated intrinsic value of Eight Dollars a share.

The mines have over ten thousand feet of tunnels, (about two miles), shafts and winzes, with tracks, ore cars, gasoline hoist etc., as shown in detail by the reports of five prominent Engineers.

We intend to also ship sufficient high grade ore to permit declaring monthly dividends, which can be continued indefinitely. With the Plant in operation, it is estimated fifteen dollars a ton, or more, can be saved on the 300,000 tons ready to treat.

The funds received from the sale of this allotment of stock will be ample to do all the preliminary work and instead of selling any stock to build the Mill and Tramway, the EARNINGS received from this plant now planned to be erected will provide all the money needed and there will be no occasion to sell any more stock.

This will mean very large profits for all Stock buyers and with ABSOLUTELY NO RISK as we have millions of dollars of Ore mined to treat as soon as the plant is ready and in the meantime the rich ore as mined will be sold to the Smelter. Besides, all the Engineers agree that the mines have a very large tonnage of rich ore as yet undeveloped.

The following exact words appear in the Summary of the Reports of the five Engineers, all of whom have most excellent reputations:

MR. MILLER: I am fully satisfied of the great values of this property. One cannot over-estimate it. The amount of Ore appears to be unlimited in quantity. The property is the finest I have seen on the coast.

MR. MILFORD: From the immense ore bodies in sight and the richness of the ores, I recommend these properties with confidence as a good investment.

MR. HAMILTON: From my knowledge I can confidently state that I believe the Garfield group the most valuable and promising mining property now developed in Mineral County.

MR. MORRISON: The properties are located in proven and developed ground. Present development reveals immense ore bodies. These extensive ore bodies carry high values to a large degree. Present developments fully warrant immediate large operations. The ore is easily and cheaply mined and is friable. Milling operations are simple and inexpensive. As a COMPLETE PROPOSITION it must be classed with the highest in every respect.

MR. BOYLE: The property has been productive wherever worked. With a Mill on the Railroad, cheap power, modern mining methods and equipment and intelligent management, this should be ONE OF THE BIGGEST AND BEST PRODUCERS IN THE STATE.

The Reports in detail, together with Photos of ore Dumps, Tunnel openings with tracks, Ore Cars, Ore Bins, etc., also the Map of the extensive underground workings can be seen at our office, which you are cordially invited to call and inspect.

Yours very truly,

NEVADA GARFIELD EXCELSIOR MINING COMPANY.

G. H. Rogers

Eastern Manager.

PLAN OF THE GARFIELD GROUP OF MINES.

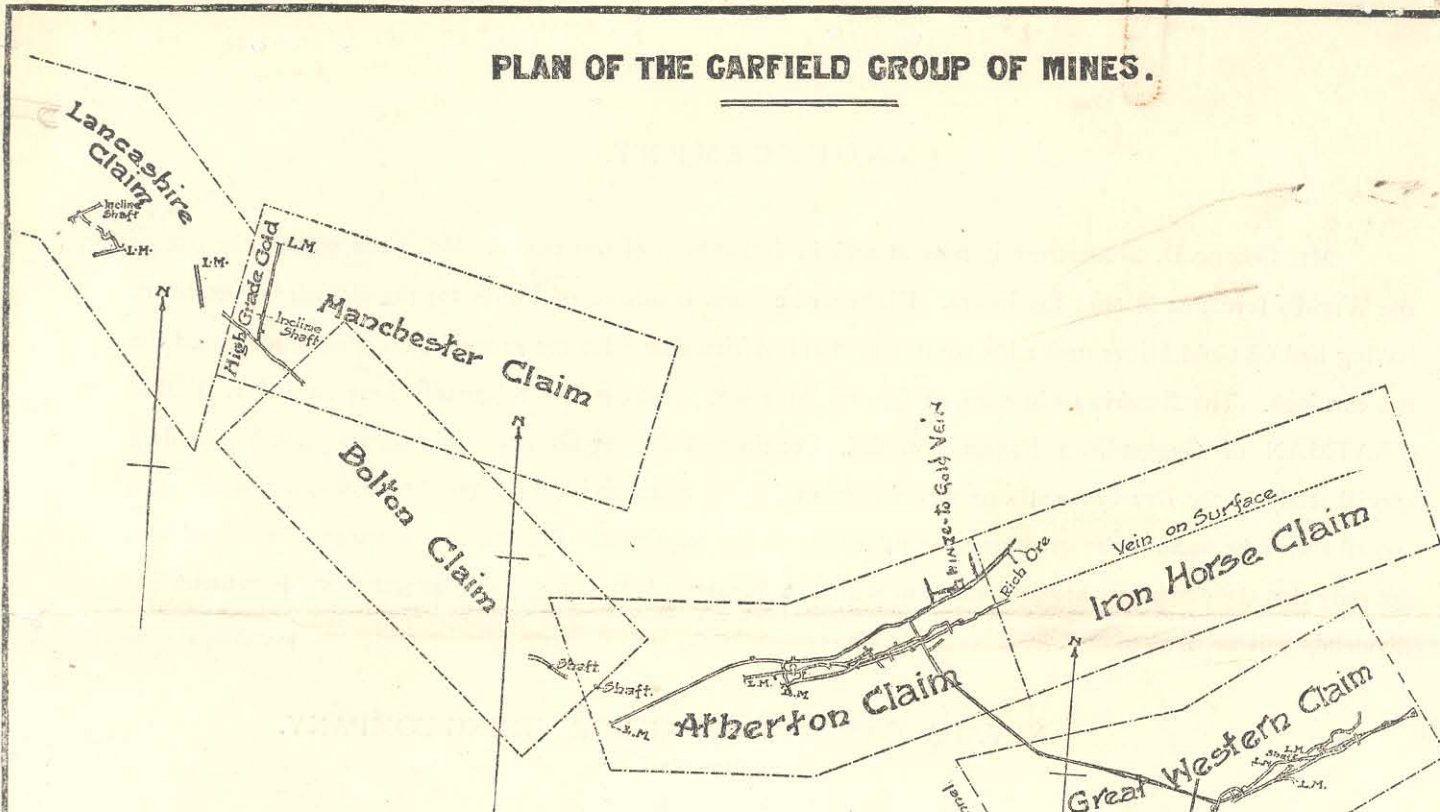

SECTION OF GREAT WESTERN MINE.

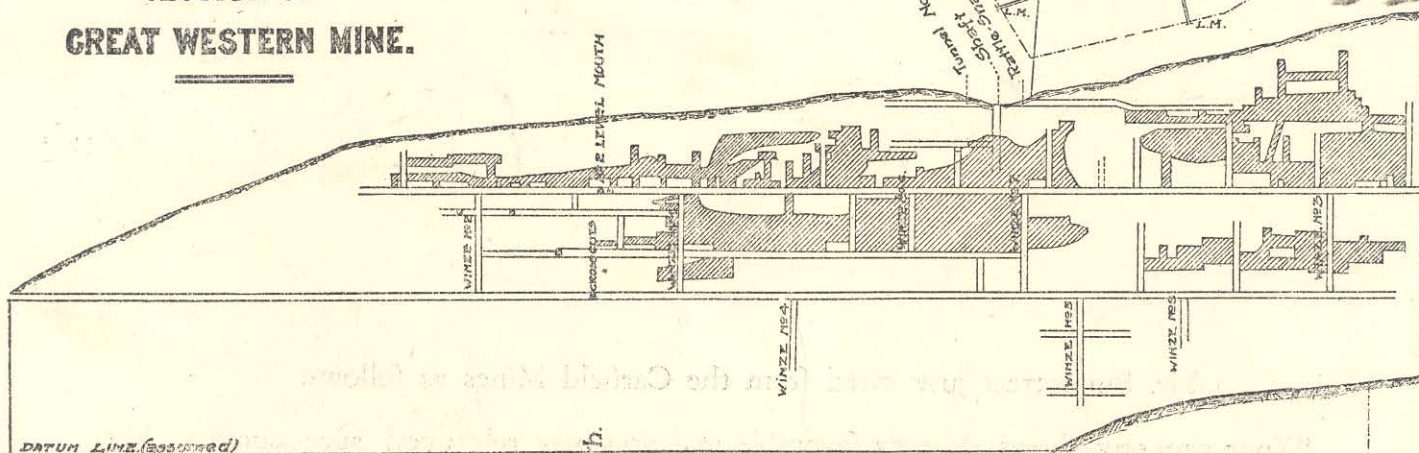

SECTION OF ATHERTON MINE

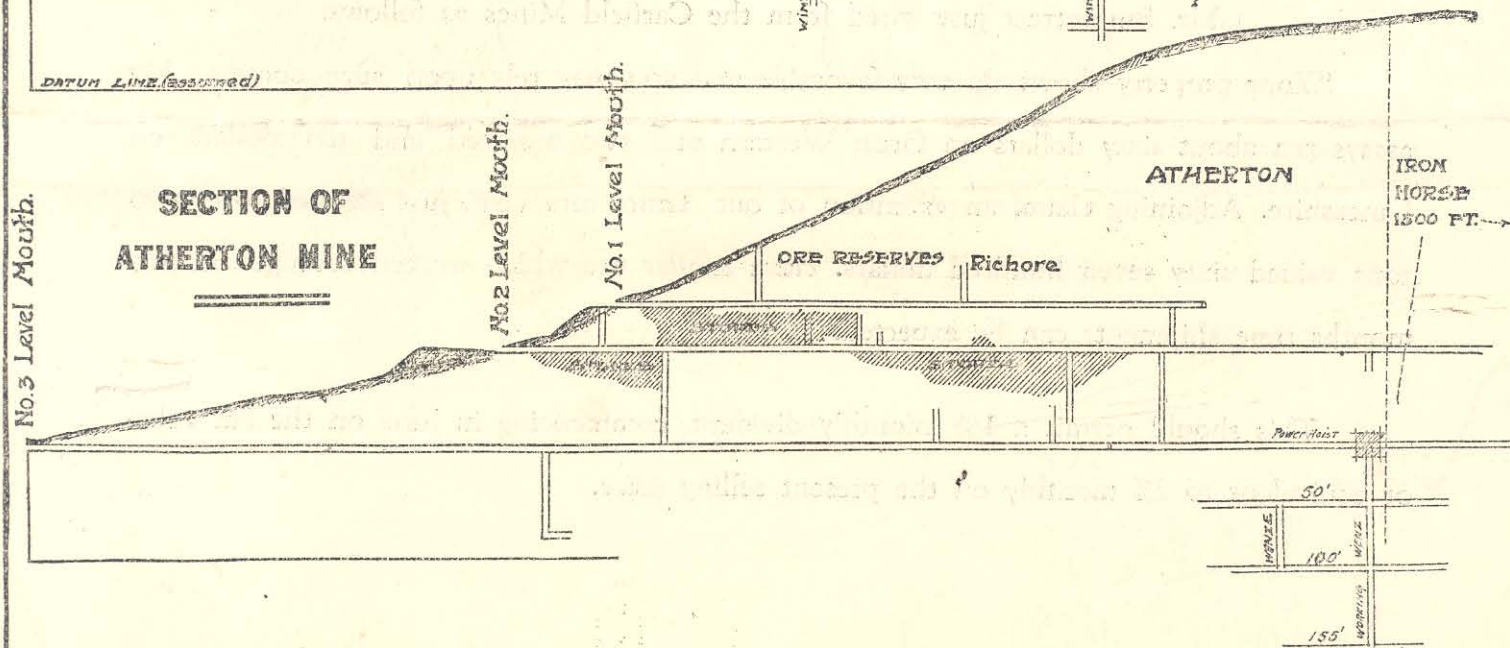

ANNOUNCEMENT.

Mr. George D. Stonestreet is now at and in full charge of our mines. He is conceded to be one of the World's foremost Mining Engineers. His record covers, Inspector of Mines for the British Government, having had 63 Gold Mines under his control in South Africa where his recommendation greatly increased the net earnings. The Rosario Gold mine of Central America. Among his references here, are Mr. POPE YEATMAN of Guggenheim Exploration Co., Continental Copper Co. and many others. He has made a special study of the Dry Concentrator we are arranging to erect and very favorably recommends it. His record shows he secures the greatest possible results at the least cost. We can thus assure our stockholders, not only that their interests are protected but with Mr. Stonestreet in charge, the largest possible returns for dividends will be secured.

NEVADA GARFIELD EXCELSIOR MINING COMPANY.

Mr. Stonestreet just wired from the Carfield Mines as follows:

"Your property shows up very favorable and you may rely upon sure success. My assays ran about sixty dollars on Great Western and two hundred and ten dollars on Lancashire. Adjoining claim, an extension of our Lancashire vein, just shipped forty two tons valued sixty seven hundred dollars. Have similar ore which we can soon get. In two months time shipments can be expected."

This should permit a 1% monthly dividend, commencing in June on the Par value or equivalent to 2% monthly on the present selling price.

REPORT ON THE MABEL MINE

OF THE

WEST END CONSOLIDATED MINES CORPORATION

GARFIELD MINING DISTRICT

MINERAL COUNTY, NEVADA

Report by H. D. Budelman,
Tonopah, Nevada.

January 10, 1930

REPORT ON THE MABEL MINE
OF THE
WEST END CONSOLIDATED MINES CORPORATION
GARFIELD MINING DISTRICT, MINERAL COUNTY, NEVADA

CLAIMS:

The Mabel Mine includes the following lode claims, held by location and purchase, an area of approximately 120 acres; Mabel No. 1, Mabel No. 2, Mabel No. 3, Mabel No. 4, Boston No. 1, Boston No. 2, and Mabel North; giving an aggregate length along the lode of 4500 feet; also water right on Pepper Spring, situated 12 miles from the property.

LOCATION AND ACCESSIBILITY:

The property is situated in the Garfield Mining District, Mineral County, Nevada, 20 miles by good road from Mina, Nevada, the nearest railroad station, which is on both the Southern Pacific and the Tonopah & Goldfield railroads. In a direct line the Southern Pacific passes within 6 miles of the property, and at any time operating conditions warrant a suitable road could be built to this point. The Mineral County Power line passes within 6 miles of the property.

TITLES AND PRESENT OWNERSHIP:

Title to the property is vested in the West End Consolidated Mines Corporation, through purchase, location and transfer of title.

HISTORY OF PROPERTY AND OTHER MINES IN THE DISTRICT:

The Garfield District is an old one, having been discovered about 1875. The principal production was made between 1880 and 1890, and the principal producer was the Garfield Mine, which was originally owned by Archie Farrington, and later sold by him to an English company. Records on production are incom-

plete, but the production of the Garfield Mine alone is estimated to have been between five and fifteen millions in value, all in high grade gold and silver ore. Development was superficial, from tunnels, and the sulphide zone was never reached in any of the workings, although the veins persist in the lowest tunnel workings and show values. Originally the ore was shipped to outside plants for reduction but later a chlorination plant was constructed at Garfield Springs, about ten miles from the mine, and so long as the ore continued high grade and carbonate in character it was treated at this plant. When the English company took over the property the ore in sight was stoped out without proper development work being done to open new ore bodies and the mine was finally closed down. Several Desultory attempts have been made to reopen the mine, but without success, new work being confined to the tunnel workings in the developed area.

The property which is now the Mabel Mine, adjoining the Garfield on the West, was, in the early days of the district, worked in a few places on surface, the maximum depth being less than 100 feet. Production probably did not exceed \$200,000.00, in gold and silver, and the claims were finally abandoned without obtaining patent. Around 1920 Messrs. Jones and Fitting, from Hawthorne, Nevada, made 6 locations covering all known westerly extensions of the Garfield veins, naming the property the Mabel Mine. By hand methods they mined and shipped four cars of ore from the shallow stopes near the easterly end of the property. The ore averaged over \$100.00 per ton and netted them about \$20,000.00

Due to the complicated ownership, which involved other parties who had assisted these two men in financing their first operations, they decided to dispose of the property and it was offered to the West End Consolidated Mining Company for \$50,000.00, on terms, royalties on ore shipped to apply on the purchase price. This company took over the option, installed a Chicago Pneumatic Hothead compressor, and sunk an inside vertical two compartment

shaft from the main tunnel level to a depth of 100 feet, and then started lateral development on what was designated the 200 Level. A north crosscut to the ~~So~~ called Mabel Vein opened ore of shipping grade almost at once, within 50 feet of the shaft, placing the mine on a self-sustaining basis. During the next few years the shaft was ~~s~~unk to the 500 level, raised to the surface, and a 25 H.P. gasoline hoist installed. It is noteworthy to remark that the royalties from ore shipped ~~met~~ payments on the purchase price as they came due, so that the mine paid for itself without capital expenditure. Total production since the West End company acquired the property is in excess of \$400,000.00, of ore which averaged about \$100.00 per ton.

X In 1926 the West End Consolidated Mining Company was so burdened with financial difficulties, with creditors pressing for payment of their various claims, that what ore was in sight was stoped out in order to raise cash. Development to the West had been disappointing, due to the drifts having gotten off the Mabel Vein and following a secondary vein, and was practically discontinued. In September, 1926, control of the Company passed out of the hands of Mr. F. M. Smith and to the operating staff at Tonopah. However, there was no cash available for development work and it was with great difficulty that sufficient cash was obtained to sink the vertical shaft to the 600 Level, drift westerly on the vein for 400 feet, and sink a winze on the vein an additional 130 feet to prove the existence of primary sulphides and payable values ^{this} at depth, the deepest ever attained in the district. Several cars of ore was shipped during the course of this work but operating conditions were so difficult that it was evident that the shaft should be sunk an additional 100 or 200 feet, and better hoisting facilities provided for before attempting further work on the deeper levels. X

In the oxidized zone the westerly workings on the secondary vein had been stopped, but crosscutting had disclosed

what is likely the faulted portion of the Mabel Vein. However, values were not high enough in the limited exposures to provide shipping ore, and the West End Company, due to lack of funds, was forced to suspend all work in the mine in October, 1929.

In November, 1929, the West End Consolidated Mining Company was reorganized, and title to all its assets, which included the Mabel Mine, passed to a new corporation, the West End Consolidated Mines Corporation.

TOPOGRAPHY:

The mine is at an elevation of 7000 feet above sea level and topography is mountainous, although not rugged.

GEOLOGY:

Geology of the Garfield District is not complex. The principal rocks are shales and slates, with some thin beds of limestone, and with intrusions of a dark colored andesite. These rocks are usually so altered that they are not always easy to identify, and until recently had been classed as metamorphosed volcanic ash. A portion of the surface is covered by late basalt flows, locally known as malpais, which has no bearing on the mineralization but does make it difficult, and at times impossible, to trace the outcrops of the veins. The shale and slate series is of unknown thickness and covers a large area, and therefore indicates no reason why the veins of the district should not extend a considerable but indefinite distance on both strike and dip.

The veins are true fissure veins, have a general easterly and westerly strike, with steep dips usually to the South. Hanging wall and footwall are well defined, the former usually showing evidence of some fault movement in the plane of the vein. Wall rock in the vicinity of the vein is usually highly altered, sometimes brittle and quite soft. However, conditions in the wall rocks are not such as interfere with economical mining. All outcrops are highly oxidized.

The vein fillings consists of quartz, with considerable iron oxide at times, which latter changes to pyrite ^{and chalcopyrite} with depth. Very little calcite is found, but at times barite is common, especially in the wall rocks near the veins, where occasional stringers up to several inches in width are sometimes found.

So far as developed the veins are rarely over 4 feet in width, and will average about 2 feet, with a tendency to wider average width with depth.

As previously stated some faulting along the plane of the veins is in evidence, and in addition there are many small cross faults, with various strikes and dips, in that portion which has been developed. To date however, no large faults have been encountered, although one important one has been cut in westerly work on three levels, the 300, 400 and 500 Levels. This fault has a strong northeasterly strike with a steep dip to the northwest, and the strike tends to become more a westerly one as it is developed to the west. There has been some silicification and mineralization along this fault, and the secondary vein thus produced at times shows a marked resemblance to the Mabel Vein, but without the presence of sufficient precious metals to prove profitable to mine. When this fault was first cut subsequent development drifts to the west were driven on it, on the three levels above mentioned, in the belief that it was the Mabel Vein, and a great deal of work done before the conclusion was reached that what was being followed was a secondary vein. On crosscutting into the footwall on the 300 and 500 levels the real vein was found but on account of operating conditions very little work has been done on it, due principally to the fact that values were not sufficiently high to make shipping grade ore. A few tons were saved which ran over \$100.00 per ton, but the average of the vein where opened would probably not exceed \$20.00 per ton.

Principal values are in silver, gold and lead, with a noticeable proportionate increase in the gold content with depth. Surface ores are oxidized, with the silver as a chloride, gold

content very small, and lead practically absent except in certain sections of the vein. The first sulphide ore was found in the vicinity of the 300 Level, and the sulphide area increases with depth, although there is still some oxidation found on the 600 Level east. In the sulphide ore the silver and gold occur with galena, spalerite and pyrite. Lead occurs in commercial amount but zinc so far does not, being more spotted. No conclusion has been reached as to whether the silver and gold show any tendency to accompany any particular one of the above base metals and, in fact, careful sampling fails to indicate any preference.

There appears to be a low grade, in places almost barren zone, in the leached or partially leached portion of the Mabel Vein between the lower limits of the oxidized zone and the upper limits of the sulphide zone. A part of the 500 and 600 Levels and all of the 700 Level appear to have passed below this low grade zone.

GENERAL FACILITIES AND EQUIPMENT:

Water for domestic and mining purposes is obtained from Pepper Springs, 12 miles from the property, on which the Company has sufficient water rights to provide for operating needs. There is no water in the mine, and no springs in the immediate neighborhood.

The property is well equipped with all necessary tools, tanks and buildings for present hoisting and compressor equipment. The compressor is large enough to handle three ~~small~~ machine drills, of the jackhammer type. The 25 H.P. gasoline hoist is in good condition. Camp buildings will accommodate a maximum of 15 men, which is ordinarily sufficient for normal operations.

DEVELOPMENT:

Development on the Mabel Mine group consists of a 567 foot vertical shaft, with laterals on the 100, 200, 300, 400, 500 and 600 Levels, and a winze on the vein from the 600 to the 730 Level, with about 130 feet of work on the 700 Level. A total of 10,050 feet of work, outside of the shaft sinking, has been per-

In both the oxidized and sulphide zone there are found occasional areas in which are containing high grade gold values occur. To date the most important of these was found between the 400 and 500 Levels, there some which averaged over 1000 per ton in Cu alone was mined.

formed on the property. More than half this amount is drifting, and includes a considerable footage of work from intermediate levels. This does not include the surface work done by the original owners, no record on which is available.

PRODUCTION:

Production since the West End Consolidated Mining Co., purchased the property, from 1922 to 1929 inclusive, amounted to 4310.3 dry tons, of an average gross value of \$97.82 per ton, and a total gross value of \$421,626.79. Net returns from smelters, less hauling, was \$281,866.04.

Metal content of this ore is interesting, and was as follows: Gold, 5526.310 ounces, an average of 1.282 ounces per ton, valued at \$113,882.09; Silver, 396,255.99 ounces, an average of 91.93 ounces per ton, valued at \$271,913.47; Lead, 440,169 pounds, an average of 102 pounds per ton, valued at \$35,831.23.

A resume' of these figures show gold value to be 27.01% of the total value, silver 64.49% of the total and lead 8.5% of the total. It is quite evident that the lead content has so far not been important. This is generally true of the oxidized ores, but as the sulphide zone is developed the lead content will undoubtedly become of more economic importance.

As previously stated production by original owners was estimated to have been \$200,000.00 gross. Messrs. Jones and Fitting shipped 200 tons of ore in 1920 and 1921 which had a gross value of \$25,000.00. Gross production of the Mabel Mine to date is therefore approximately 6510 tons, of an average value of \$99.32 per ton, and with a gross value of \$646,627.00.

DISCUSSION:

The following discussion is made with the idea of summarizing facts in an effort to arrive at a definite conclusion regarding future possibilities of the Mabel Mine.

The mine is in a district which has produced from seven to fifteen millions in gold and silver, from high grade ore, and

is adjacent to, and contains the westerly extensions of the veins of the Garfield Mine, by far the largest producer in the district.

The mine contains at least two veins which are known to carry commercial ore, only one of which, the Mabel Vein, has been partly developed. One other known commercial vein has been stoped near the surface during the early days of the district, but has never been developed at any depth. Practically no crosscutting has been done to determine what value the other known veins may have, or whether there are still other veins.

All early work in the district was surface work, never reaching the sulphide zone. Recent work in the Mabel Mine has proved that the Mabel Vein extends into the sulphide zone, is really stronger and larger there than it is above, and contains high grade values, with evidence that proportionate gold content is increasing with depth.

The property is not fully developed, as an examination of the attached map will show. Lateral development on the Mabel Vein on the various levels is as follows; 100 Level 300 feet, 200 Level 450 feet, 300 Level 650 feet, 400 Level 700 feet, 500 Level 800 feet, 600 Level 500 feet, and 700 Level 130 feet. The maximum development of the vein on its strike is on the 500 Level, of 800 feet. As stated on page #5 of this report the west drifts on the 300, 400, and 500 Levels were driven through a fault, and where additional work was done west of this fault it was practically all on a secondary vein. The Mabel Vein has been recovered west of this fault on the 300 and 500 Levels, and is normal. There appears to be no logical reason why it cannot be recovered on all the levels. By referring to the attached map you will see some surface work about the center of the Mabel No. 2 claim which is marked "Woodhouse Workings". This is some of the original work, done about 1880, and is reported to have produced some very high grade gold^{and}/silver ore. This work is 1000 feet westerly from the extreme west work done on the Mabel Vein by the West End Consolidated. To the West of these "Woodhouse Workings" the surface

is rolling and covered with dirt and loose rock, so that it is impossible to trace the outcrops of the veins. However, there is no visible change in geological conditions so that it is believed the veins will extend west from this work an indefinite distance.

Operating conditions are ideal, and there is no indication of water in the mine, which might cause heavy ground and ^{increase operating} raise costs.

^{blanked out tonnage of} There is no ore of shipping grade in sight, although there is an uncertain tonnage of ore of mill grade. In the sulphide zone ^{all of} the ore is ideal for concentration, but ⁱⁿ the oxidized ^{zone the lower grade} ore is of uncertain value at present.

Average gross value of the ore in the sulphide zone of primary enrichment is not so high as in some portions of the oxidized zone, where secondary enrichment has occurred, but proportionate gold values are noticeably higher and some very high grade gold ore has been found in this zone. The gold in the sulphide zone is not usually visible to the naked eye and at times is so intimately associated with the galena, spalerite and pyrite that it cannot be detected even by panning, except by treating the concentrate with acid. This is found to be true of rock which will assay several thousand dollars per ton. From a small bunch near the 615 winze a car of ore was mined and shipped which ran over 7 ounces gold per ton, and carried but 14 ounces silver per ton. It is also true that in the oxidized zone some bunches of high grade gold have been found, noticeably between the 400 and 500 Levels just east of the main shaft, silver and lead values being almost entirely lacking, but these occurrences are not so numerous ~~or so large~~ as in the sulphide zone.

The sulphide ore on the deepest levels has been carefully examined by Mr. H. G. Fergusen, geologist with the United States Geological Survey, and his opinion coincides with ours that these sulphide ores are primary, and there is no known minerological or geological reason why these ores should not extend to much deeper elevations. The ore is an ideal one for flotation concentration so it appears very probable that, by an

energetic campaign of development, sufficient sulphide ore can be blocked out to justify the erection of a mill, thereby permitting the treatment of lower grade ores than will ~~now~~ pay to ship to smelters, and saving a large portion of the present high costs of hauling, railroad transportation and treatment.

CONCLUSIONS:

The Mabel Mine is a property of high potential value. The Mabel Vein is the only one on which any extensive development work has been accomplished, and this work shows that the vein extends at least 3000 feet on surface, and to a depth of over 700 feet, continuing strong on both strike and dip, and maintaining its values. This vein justifies further extensive development on both strike and dip, with good possibilities for profitable ore in both the oxidized and sulphide zones, although the latter appears to have the best chance for permanency.

In addition the development work already done shows a noticeable absence of crosscuts into either footwall or hanging wall country to open up parallel veins. I feel, and Mr Ferguson has expressed the same opinion, that there are splendid opportunities for additional ore from these parallel veins.

I regard the Mabel Mine as one with many first class possibilities, and I feel that conditions justify the raising of a \$75,000.00 development fund for the exploration of the property, with the opinion that the entire amount will not be necessary before the mine will be placed on a producing and profitable basis.

Tonopah, Nevada.

January 10th, 1930.

REPORT ON THE MABEL MINE
OF THE
WEST END CONSOLIDATED MINES CORPORATION
GARFIELD MINING DISTRICT
MINERAL COUNTY, NEVADA

Report by: H. D. Budelman
Tonopah, Nevada

February 1, 1934.

REPORT ON THE MABEL MINE
OF THE
WEST END CONSOLIDATED MINES CORPORATION
GARFIELD MINING DISTRICT, MINERAL COUNTY, NEVADA

CLAIMS:

The Mabel mine includes the following lode mining claims, held by location and purchase, an area of approximately 120 acres: Mabel No. 1, Mabel No. 2, Mabel No. 3, Mabel No. 4, Boston No. 1, Boston No. 2, and Mabel North; giving an aggregate length along the lode of 4500 feet; also water right on Pepper Spring, situated 12 miles from the property.

LOCATION AND ASSESSIBILITY:

The property is situated in the Garfield Mining District, Mineral County, Nevada, 20 miles by good road from Mina, Nevada, the nearest railroad station, which is on both the Southern Pacific and Tonopah and Goldfield railroads. In a direct line the Southern Pacific passes within six miles of the property and at any time operating conditions warrant, a suitable road can be built to this point. The Mineral County power line passes within six miles of the property.

TITLES AND PRESENT OWNERSHIP:

Title to the property is vested in the West End Consolidated Mines Corporation, through purchase, location and transfer of title.

HISTORY OF PROPERTY AND OTHER MINES IN THE DISTRICT:

The Garfield District is an old one, discovered about 1875. The principal production was made between 1880 and 1890, and the principal producer was the Garfield Mine, originally owned by Archie Barrington, later sold by him to an English company. Records on production are incomplete, but the production of the Goldfield Mine alone is estimated to have been between five and fifteen millions in value, all in high grade gold and silver ore. Development was superficial, from funnels, and so far as known the sulphide zone was never reached in any of the workings, although the veins persist in the lowest tunnel workings and show values. Originally the ore was shipped to outside plants for reduction but later a chlorination plant was constructed at Garfield Springs, about ten miles from the mine, and so long as the ore continued high grade and carbonate in character it was treated at this plant. When the English company took over the property, ore in sight was stopped out without proper development work being done to open new ore bodies and the mine was finally closed down. Several desultory attempts have been made to reopen the mine, but without success, new work being confined to the tunnel workings in the developed area.

The property which is now the Mabel Mine, adjoining the Garfield on the West, was, in the early days of the district, worked in a few places on surface, the maximum depth being about 100 feet below surface. Production probably did not exceed \$200,000.00 in gold and silver, and the claims were finally abandoned without obtaining patent. Around 1920 Messrs. Jones and Fitting from Hawthorne, Nevada, made six locations covering all known Westerly extensions of the Garfield veins, naming the mine the Mabel Mine. By hand methods they mined and shipped four cars of ore from the shallow stopes near the Easterly end of the property. The ore averaged over \$100 per ton and netted them about \$20,000.00.

Due to the complicated ownership, which involved other parties who had assisted these two men in financing their first operations, they decided to dispose of the property and it was offered to the West End Consolidated Mining Company for \$50,000.00 on terms, royalties on ore shipped to apply on

the purchase price. This company took over the option, installed a Chicago Pneumatic Hothead compressor, and sunk an inside vertical two compartment shaft from the main tunnel level to a depth of 100 feet, and then started lateral development on what was designated the 200 level. A North crosscut to the so called Mabel vein opened ore of shipping grade almost at once, within 50 feet of the shaft, placing the mine on a self sustaining basis. During the next few years the shaft was sunk to the 500 level, raised to the surface, and a 25 H.P. gasoline hoist installed. It is noteworthy to remark that the royalties from ore shipped met payments on the purchase price, so that the mine paid for itself without capital expenditure. Total production since the West End Company acquired the property is in excess of \$400,000.00, of ore which averaged about \$100 per ton.

TOPOGRAPHY:

The mine is at an elevation of 7000 feet above sea level and topography is mountaineous, although not rugged.

GEOLOGY:

Geology of the Garfield District is not complex. The principal rocks are shales and slates, with some thin beds of limestone, and with intrusions of a dark colored andesite. These rocks are so altered that they are not always easy to identify, and until recently had been classed as metamorphosed volcanic ash. A portion of the surface is covered by late basaltic flows, locally known as malpais, which has no bearing on the mineralization but does make it difficult, and at times impossible, to trace the outcrops of the veins. The shale and slate series is of unknown thickness and covers a large area, and no reason is indicated why the veins of the district should not extend a considerable but indefinite distance on both strike and dip.

The veins are true fissure veins, having a general Easterly and Westerly strike, with steep dips usually to the South. Hanging Wall and Footwall are well defined, the former usually showing evidence of some fault movement in the plane of the vein. Wall rock in the vicinity of the veins is usually highly altered, sometimes brittle and quite soft. However, conditions in the wall rocks are not such as interfere with economical mining. All outcrops are highly oxidized.

Vein filling consists of quartz, with considerable iron oxide at times, which latter changes to pyrite and chalcopyrite with depth. Very little calcite is found, but at times barite is common, especially in the wall rocks near the veins, where occasional stringers up to several inches in width are sometimes found.

So far as developed the veins are rarely over four feet in width, and will average about two feet where stepped, with a tendency to widen average width depth.

As previously stated some faulting along the plane of the veins is in evidence, and in addition there are many small cross faults, with various strikes and dips, in that portion which has been developed. To date however, no large faults have been encountered, although one important one has been cut in westerly work on three levels: the 300, 400 and 500 levels. This fault has a strong Northeasterly strike with a deep dip to the Northwest, and the strike tends to become more a Westerly one as it is developed to the West. There has been some silicification and mineralization along this fault, and the secondary vein thus produced at times shows a marked resemblance to the Mabel Vein, but without the presence of sufficient precious metals to prove at all profitable to mine. When this fault was first cut subsequent development drifts to the West were driven on it, on the three levels above mentioned, in the belief that it was the Mabel Vein, and a great deal of work done before the conclusion was reached that what was being followed was a secondary vein.

By crosscutting into the footwall on the 300 and 500 levels the real vein was found but on account of the operating conditions very little work has been done on it, due principally to the fact that values are not sufficiently high to make shipping grade ore. A few tons were saved which ran over \$100 per ton, but the average of the vein opened would probably not exceed \$20 per ton.

Principal values are in silver, gold and lead, with a noticeable proportionate increase in the gold content with depth. Surface ores are oxidized, with the silver as a shloride, gold content small, and lead practically absent except in certain sections of the mine. The first sulphide ore was found in the vicinity of the 300 level, and the sulphide area increases with depth, although there is still oxidation found on the 600 level. In the sulphide ore the silver and gold occur with galena, sphalerite and pyrite. Lead occurs in commercial amount but zinc so far does not, being more spotted. No conclusion has been reached as to whether the silver and gold show any tendency to accompany any particular one of the above base metals and, in fact, careful sampling fails to indicate any preference.

In both the oxidize and sulphide zone there are found occasional areas where segregnated high grade gold values occur. To date the most important of these was found between the 400 and 500 levels, where five tons of ore averaged over \$1000 per ton in gold alone was mined.

There appears to be a low grade, in places almost barren zone, in the leached or partially leached portion of the Mabel Vein between the lower limits of the oxidized zone and the upper limits of the sulphide zone. A part of the 500 and 600 levels and all of the 700 levels appear to have passed below this low grade zone.

GENERAL FACILITIES AND EQUIPMENT:

Water for domestic and mining purposes is obtained from Pepper Springs, 12 miles from the mine, on which the company has sufficient water rights to provide for operating needs. There is no water in the mine, and no springs of importance in the immediate neighborhood. The property is well equipped with necessary tools, tanks and buildings for present hoisting and compressor equipment. The compressor is large enough to handle at least three drills of the jackhammer type. The 25 H.P. gasoline hoist is in good condition. Camp buildings will accomodate a maximum of 15 men, which is ordinarily sufficient for normal operations.

DEVELOPMENT:

Development on the Mabel group consists of a 567 foot vertical shaft, with laterals on the 100,200,300,400,500 and 600 levels, with a winze on the vein from the 600 to the 730 level, with about 130 feet of development work on the 700 level. A total of 10,050 feet of development work, outside of the shaft, has been performed on the property. More than half this amount is drifting, and includes a considerable footage of work from intermediate levels. This estimate does not see include the surface work done by the original owners, no record on which is available.

PRODUCTION:

Production since the West End Consolidated Mining Company purchased the property, from 1922 to 1929 inclusive, amounted to 4310.3 dry tons, of an average gross value of \$97.82 per ton, and a total gross value of \$421,626.79. Net returns from smelters, less hauling, was \$281,866.04.

Metal content of this area is interesting, and was as follows: gold, 5526.310 ounces, an average of 1.282 ounces per ton, valued at \$113,882.09; silver, 396,255.99 ounces, an average of 91.93 ounces per ton,

valued at \$271,913.47; lead 440,169 pounds, an average of 102 pounds per ton, valued at \$35,831.23.

A resume' of these figures show gold value to be 27.01% of the total value, silver 64.69% of the total, and lead 8.5% of the total. It is quite evident that the lead content has so not been important. This is generally true of the oxidized zone but as the sulphide zone is developed the lead content may become of more economic importance.

A previously stated production by original owners as estimated was \$200,000.00 gross. Messers. Jones and Pitting shipped 200 tons of ore in 1920 and 1921 which has a gross value of \$25,000.00. Gross production of the Mabel Mine to date is therefore approximately 6510 tons, of an average value of \$99.32 per ton, and with gross value of \$646,627.00.

DISCUSSION:

The following discussion is made with the idea of sumarizing facts in an effort to arrive at a definate conclusion regarding future possibilities of the Mabel Mine.

The mine is in a district which has produced from six to fifteen millions in gold and silver, from high grade ore, and is adjacent to, and contains the Westerly extensions of the veins of the Goldfield Mine, by far the largest producer in the district.

The mine contains at least two veins which are known to contain commercial ore, only one of which, the Mabel Vein, has been partly developed. One other known commercial vein has been stoped near the surface during the early days of the district, but has never been developed at any depth. Practically no cross-cutting has been done during to determine what value the other known vein may have, or whether there are still other veins.

All early work in the district was surface work, never reaching the sulphide zone. Recent work in the Mabel Mine has proved that the Mabel Vein extends into the sulphide zone, is really stronger and larger there than it is above, and contains high grade values, with evidence that proportionate gold content is increasing with depth.

The property is not fully developed, as an examination of the attached map will show. Lateral development on the Mabel Vein on the various levels is as follows: 100 Level 300 feet; 200 level, 450 feet, 300 level, 650 feet; 400 level, 700 feet; 500 level 800 feet; 600 level 500 feet; and 700 level 130 feet;. The maximum development of the vein on its strike is on the 500 level, of 800 feet. As stated on page of this report, the west drifts on the 300, 400 and 500 levels were driven through a fault, and where additional work was done west of this fault it was practically all on a secondary vein. The Mabel Vein has been recovered west of this fault on the 300 and 500 level, and is normal. There appears to be no logical reason why it cannot be recovered on all the levels. By referring to the attached map you will see some of the surface work about the center of the Mabel No. 2 claim which is labeled "WOODHOUSE WORKINGS". This is some of the original work, done about 1880, and is reported to have produced some very high grade gold and silver ore. This work is 1000 feet westerly from the extreme west work done on the Mabel Vein by the West End Consolidated. To the West of these "WOODHOUSE WORKINGS" the surface is rolling and covered with dirt and loose rock, so that is impossible to trace the outcrops of the veins. However, there is no visable change in geological conditions so that it is believed the vein will extend west from the work an indifinate distance.

Operating conditions are ideal, and there is no indication of water in the mine, which might cause heavy ground and thereby increase operating costs.

There is no blocked out tonnage of ore of shipping grade in sight but there is an uncertain tonnage of ore of mill grade. In the sulphide zone this millgrade ore is ideal for concentration, but in the oxidized zone it is of uncertain value on account of the problem of milling it.

Average gross value of the ore in the sulphide zone of primary enrichment is not so high as in some portions of the oxidized zone, where secondary enrichment has occurred, but proportionate gold values are noticeably higher and some very high grade gold has been found in this zone. The gold in the sulphide zone is not usually visible to the naked eye and at times is so intimately associated with the galena, sphalerite, and pyrite that it cannot be detected even by panning, except by treating the panned concentrate with acid. This is found to be true of rock which will assay several thousand dollars per ton. From a small bunch near the 615 Winze to the 700 level a care of ore was mined and shipped which ran over 7 ounces gold per ton, and carried but 14 ounces silver per ton. It is also true that in the oxidized zone bunches of high grade gold ore have been found, silver and lead values being almost entirely lacking, but these occurrences are not so numerous as in the sulphide zone.

The sulphide ore on the lowest levels has been carefully examined by Mr. H. C. Ferguson, geologist with the United States Geological Survey, and his opinion coincides with ours that these sulphides are primary, and there is no known mineralogical or geological reason why these area should not extend to much deeper horizons. The ore is an ideal one for flotation concentration so it appears very probable that, by an energetic campaign of development, sufficient sulphide ore can be blocked out to justify the erection of a mill, thereby permitting the treatment of lower grade ores than will pay to ship to smelters, and saving a large portion of the present high costs of hauling, railroad transportation and treatment.

CONCLUSION\$:

The Mabel Mine is a property of high potential value. The Mabel Vein is the only one on which any extensive development has been accomplished, and this work shows that the vein extends at least 3000 feet on surface, and to a depth of over 700 feet, continuing strong on both strike and dip, with good possibilities for profitable ore in both the oxidized and sulphide zones, although the latter appears to have the best chance for permanency.

In addition the development work already done shows a noticeable absence of crosscuts into either hanging wall or footwall country to open up parallel veins. I feel, and Mr. Ferguson has expressed the same opinion, that there are splendid opportunities for additional ore from these parallel veins.

The mine should be developed by sinking the shaft an additional 200 feet to the 800 level, drifting done on the 800 for at least 100 feet easterly and for an indefinite distance westerly, a raise connection driven on the vein from from the 800 to the 730 level. Then this preliminary work is completed ventilating conditions will be greatly improved and stoping can be carried on while the development work is pushed westerly on the 600, 700 and 800 levels, with possibly additional drifting on the upper levels of the mine and cross-cutting.

The present hoist, powered by a 25 H.P. Western Gas Engine is inadequate for this work, and another larger hoist should be purchased. A 50 H.P. gasoline driven hoist will be suitable and it is estimated that a used hoist of this type can be purchased for \$2000. The Mineral County power line passes within six miles of the mine and later it is planned to electrify the entire mine equipment. However, on account of the first cost, it is not recommended that this change be made at the present time.

I regard the Mabel Mine as one with many first class possibilities, and feel that conditions justify the expenditure of at least \$25,000 on development, which sum is estimated will complete the preliminary work outlined above to a point where actual mining of ore can be begun.

The following compilation illustrates comparative figures on value of some of the ore shipments from the Mable Mine, made on early part of 1929, based on prices received for gold and silver at time shipments were made, as compared with present day prices obtainable for gold and silver;

Lot No. 96

Metal quotations at time shipment was made;

Gold,-----\$20.67 per ounce.

Silver,--- .57375 per ounce.

7.0203 ounces gold per ton, \$145.11 Gold value per ton.
 13.267 " silver " " , 7.61 Silver value per ton.
 \$152.72 Total value per ton.

Metal quotations at present time;

Gold,-----\$35.00 per ounce.

Silver,--- .645 per ounce.

7.0203 ounces gold per ton, \$245.71 Gold value per ton.
 13.267 " silver " " , 8.56 Silver value per ton.
 \$254.27 Total value per ton.

Total gross value of shipment at time it was made,

34.494 Tons @ \$152.72 per ton -----\$5267.98

Total gross value of shipment at present prices,

34.494 Tons @ 254.27 per ton -----\$8770.71

Additional present day value -----\$3502.73

An increase in gross value of 66.5%

Lot No. 100

Metal quotations at time shipment was made:

Gold,-----\$20.67 per ounce.

Silver,--- .5375 per ounce.

1.25 ounces gold per ton, \$25.84 Gold value per ton.
 72.00 " silver " " , 38.70 Silver value per ton.
 \$64.54 Total value per ton.

Metal quotations at present time;

Gold,-----\$35.00 per ounce.

Silver,--- .645 per ounce.

1.25 ounces gold per ton, \$43.75 Gold value per ton.
 72.00 " silver " " , 46.40 Silver value per ton.
 \$90.15 Total value per ton.

Total gross value of shipment at time it was made,

50.443 tons @ 64.54 per ton----- \$3255.59

Total gross value of shipment at present prices,

50.443 tons @ 90.15 per ton----- \$4547.44

LOT NO. 100 (Continued)

Additional present day value--\$1291.85

An increase in gross value of 39.7%

LOT NO. 99

Metal quotations at time shipment was made,

Gold,-----\$20.67 per ounce.

Silver,--- .55875 per ounce.

.755 ounces gold per ton,	\$ 15.61 Gold value per ton.
32.15 " silver " " ,	17.96 Silver value per ton.
	\$ 33.57 Total value per ton.

Metal quotations at present time,

Gold,-----\$35.00 per ounce.

Silver,--- .645 per ounce.

.755 ounces gold per ton,	\$26.43 Gold value per ton.
32.15 " silver " " ,	20.74 Silver value per ton.
	\$47.17 Total value per ton.

Total gross value of shipment at time it was made,

41.72 Tons @ \$35.57 per ton-----\$1400.54

Total gross value of shipment at present prices,

41.72 tons @ \$47.17 per ton-----\$1967.93

Additional present day value----\$ 567.39

An increase in gross value of--- 40.5%

MABEL MINE SERIES
CORRESPONDENCE

2

1921

4840 0117

(254) Item 117

2 of 40

WEST END CONSOLIDATED MINING CO.

OFFICE OF GENERAL MANAGER

J. W. SHERWIN, GENERAL MANAGER

SYNDICATE BUILDING
OAKLAND, CALIFORNIA

September 20, 1921

Mr. H. D. Budelman,
Tonopah, Nevada.

My dear Mr. Budelman:

Warren Richardson was in the office last week and left a signed copy of an agreement between himself and Adams, Miller & Gregory, covering the Garfield group. That is, it is signed by Miller, Gregory and Richardson; Adam's signature being missing. Warren did not send any duplicate, but he doubtless has a duplicate there in Tonopah. Will you kindly get him to let you take it and if you require it, have the local stenographer make you a copy.

The outstanding features are a purchase price of \$75,000.00; the first payment of \$15,000.00 to be made in June, 1922. We have until November 12th to begin work.

I wish you would go down taking Marsh with you if he is available and give the property a preliminary examination, and leave Marsh to do any sampling or surveying or other work which may appear to be advisable.

Warren said that the maps were not in Reno, and I understood him to say that they were in New York and could be sent. However this information came over the long distance phone from Reno and I could not hear half of what he said. I am writing him today asking him to get these maps at once. I do not know just how much you can learn working through the property without the maps. My *walking* idea is that if it appears to be worth doing any work on, we should find it out by November 12th, and we could then do a small amount of work from our headquarters at the Mabel without any overhead.

Of course the end of the Garfield claims nearest the Mabel is the part that would suggest itself as being most apt to have unprospected ore bodies which might be worked from the Mabel shaft by drifting into the Garfield on the veins. However, I think the other end of the Garfield should be looked at as well, although I fear you could not accomplish much until the maps are forthcoming. I wish you would keep after Warren in regard to these maps as he is very apt to forget all about them unless you do so.

Please let me know if you succeed in getting a copy of the agreement. Also advise as soon as convenient what progress has been made toward getting started in the Mabel.

With kind regards,

Yours very truly,

J. W. Sherwin
General Manager.

JWS:RS

WEST END CONSOLIDATED MINING CO.

OFFICE OF GENERAL MANAGER

J. W. SHERWIN, GENERAL MANAGER

SYNDICATE BUILDING
OAKLAND, CALIFORNIA

Sept. 26, 1921

Mr. H. D. Budelman,
c/o West End Consolidated Mining Co.,
Tonopah, Nevada.

My dear Mr. Budelman:

✓ { Your letter of September 23rd with enclosure received.

As to the price of the Garfield property - \$60,000.00 is the correct figure, as is plainly stated in the agreement on file here. I do not know how the \$75,000.00 slipped in.

W.R.G. { Re. Warren Richardson's commission: I assume he expects to return this to the company to reduce the cost of the property to us in the event we should exercise the option. He certainly worked them for a good sized commission, although doubtless they raised the price of the mine to cover it.

✓ { Mr. Sizer called me up late Saturday and casually mentioned his outfit at Polo and said that the last he had heard from Tonopah was that the West End had found an outfit at Spanish Belt which was cheaper. He said he positively believed from what he had been told that the Spanish Belt outfit was not in anywhere as good condition as his. I suggested he write you about it. I do not know whether he would or not, but I want you to have the information for what it is worth.

With kind regards,

Yours very truly,

J. W. Sherwin
General Manager.

JWS:RS

Sept. 23, 1921

J. W. Sherwin, General Manager,
West End Consolidated Mining Co.,
Syndicate Bldg.,
Oakland, Cal.

Dear Mr. Sherwin:

I have your letter of September 20th regarding the agreement between Adams, Miller and Gregory and Warren Richardson, and covering the Garfield group. Warren was in yesterday and left a signed copy of the agreement here and also left the deed to the ground and escrow instructions.

deed and
I am enclosing copy of ^{deed and} escrow instructions between Adams, Miller, Gregory and W. V. Richardson covering payments for the ground, and also escrow instructions covering agreement between Adams, Miller, Gregory and Richardson concerning the commission Mr. Richardson is to receive. I am not enclosing copy of the agreement, since you already have one. In your letter you state that the purchase price is \$75,000. In the copy which we have it is stated as \$60,000, but Mr. Richardson has said that the one you have is a copy of the one we have here, and therefore I assume the \$75,000 as stated in your letter is a typographical error. We haven't been able to locate the maps as yet but Warren is on the trail.

I expect to go to Mina and Garfield on Monday and will write you later regarding this.

Mr. Marsh is still at the Mabel mine and will remain there until the contractors begin work, which will probably be Monday or Tuesday.

Yours very truly,

HDB EMC
Encl.

MINE SUPERINTENDENT

WEST END CONSOLIDATED MINING CO.

Oct. 6, 1921.

Hon. John B. O'Sullivan
U. S. Surveyor General
Reno, Nevada.

Dear Sir:

Kindly mail us copy of the patent
plat of the following claims situated in
Garfield Mining District, Mineral County,
Nevada.

Atherton lode, Survey No. 37,
Great Western Lode, Survey No. 38,
Lankashire lode, Survey No. 39,
Manchester lode, Survey No. 40,
Bolton lode, Survey No. 41.

Yours very truly,

WEST END CONS. MINING COMPANY,

HDB:R

By _____
MINE SUPERINTENDENT.

November 7, 1921

Mr. Warren Richardson,
Tonopah, Nevada.

My dear Mr. Richardson:

Relative to the Garfield property: We have decided that the property does not warrant our interesting ourselves, upon the terms on which it has been offered. Will you please so advise the owners.

I am outlining below the terms upon which we ^{would} consider doing some work on the property.

- 1 - Extend the time for beginning work at least 30 days.
- 2 - The number of shifts to be worked to be 30 shifts per month for two months, 60 shifts per month for the next two months, and thereafter 90 shifts per month.
- 3 - The first payment to be put over from June 1st to October 1st, 1922, and all subsequent payments delayed a corresponding length of time.
- 4 - The clause in the option which states that no ore may be shipped for six months after commencement of operations to be modified to allow shipments at any time.
- 5 - The royalties to be paid upon ore shipped to be reduced from 50% flat, which the present option requires, to a graded basis, beginning with 20% on low grade ore and graded upwards to 50% on high grade ore.
- 6 - The "Iron Horse" claim to be included in the group.

I suggest that you communicate immediately with the owners and learn if they are willing to make these concessions. In case they are not willing to give approximately these terms, we shall not be able to interest ourselves in the property.

Please address your reply to me at Westend, California, c/o West End Chemical Company.

Yours very truly,

General Manager.

JWS:RS
c/c to Mr. Budelman.

STATE OF NEVADA)
COUNTY OF MINERAL.) ss

On this 6th day of October, A. D. 1921, before me, A. S. GREEN, a Notary Public in and for the County of Mineral, State of Nevada, duly commissioned and sworn and residing therein, personally appeared J. H. MILLER, known to me to be the same person described in, whose name is subscribed to and who executed the foregoing instrument, who duly acknowledged to me that he executed the same freely and voluntarily and for the uses and purposes therein mentioned.

IN WITNESS WHEREOF, I have hereunto set my hand and affixed my official seal at my office in the said County of Mineral, State of Nevada, the day and year in this certificate first above written.

A. S. GREEN.

Notary Public in and for the
County of Mineral, State of
Nevada.

(SEAL)

My commission expires Sept. 12, 1922

Adams

Miller & Gregory agreement
use 2 barrels and grain
at market mine

(LAST)

138-7

My commission expires Sept. 15, 1953

Deputy

County of Mineral, State of
Montana

Under and before me

Mineral, State of Montana, the day and year in this certificate
and attached my official seal as my office in the said County of

IN WITNESS WHEREOF, I have hereunto set my hand

and for the uses and purposes therein mentioned.

Tested to me that he executed the same freely and voluntarily

to and who executed the foregoing instrument, who duly acknowl-

ed to be the same person described in, whose name is expressed

residing therein, personally appeared, J. H. MILLER, known to

of Mineral, State of Montana, duly commissioned and sworn and

me, J. S. [illegible] a Deputy Public in and for the County

of Mineral, State of Montana, do hereby certify that the

COUNTY OF MINERAL

STATE OF MONTANA

1387

H.D.V.

Agreement

A G R E E M E N T

THIS AGREEMENT, made and entered into this 14th day of September A. D. one thousand nine hundred and twenty one between J. E. ADAMS and J. H. MILLER, co-partners, doing business under the firm name of ADAMS & MILLER, and L. K. GREGORY, parties of the first part and WEST END CONSOLIDATED MINING COMPANY, a corporation, party of the second part,

W I T N E S S E T H:

WHEREAS, the party of the second part has obtained an option to purchase the Mabel No. 1, Mabel No. 2, Mabel No. 3, Mabel No. 4, Boston No. 1 and Boston No. 2 lode mining claims situated in the Gold Range Mining District, also known as Garfield Mining District, Mineral County, State of Nevada; and

WHEREAS, the parties of the first part are the owners of the Lancashire lode mining claim, U. S. S. No. 39 and other lode mining claims upon which there is situated a spring, said mining claims lying adjoining and contiguous to the said Mabel No. 1 and No. 3 lode mining claims described; and

WHEREAS, there is situated on said Lancashire lode mining claim, the mouth or portal of a tunnel which has been used by the owners of the said Mabel No. 1 and other lode mining claims for the development of ore bodies of said claims and extends from said Lancashire lode mining claim into said Mabel No. 1 lode mining claim; and

WHEREAS it is the desire of the party of the second part to use said tunnel in conducting mining operations in and upon said Mabel No. 1 and other lode mining claims, and also to erect necessary machinery and buildings at or near the mouth of said tunnel and also use such ground as may be necessary for the dumping of waste and ore resulting from said mining operations conducted by the party of the second part; and

mining claims and to place upon said Lancashire lode mining claims such materials as may be necessary to carry on said mining operations as aforesaid and to remove all of the same before or within sixty (60) days after the expiration of this agreement.

IT IS ALSO FURTHER agreed that the parties of the first part or their assigns shall be authorized to work the said Lancashire lode mining claim and other adjacent ground owned by them through the said tunnel and the parties hereto agree that their respective work shall be done as nearly as possible without interference with each other, the parties of the first part to provide their own machinery and equipment for operations through said tunnel.

IT is also agreed that the party of the second part shall be authorized to remove all ore dumped upon the said Lancashire lode mining claim before or within sixty (60) days after the expiration of this agreement, or the termination, expiration or forfeiture thereof.

IT is also agreed that the party of the second part is hereby given the privilege, license and authority to use such water as may be necessary from the spring mentioned aforesaid until the parties of the first part or their assigns are required to use said water for their mining operations.

The right and privilege hereby granted shall extend for the term of two (2) years from the date hereof provided, however, that in case of the failure of the party of the second part to exercise its option to purchase the Mabel No. 1 and other lodes or the said option shall for any reason become determined or forfeited, the right and privilege hereby granted shall terminate and expire within sixty (60) days after the forfeiture or termination of said option and the party of the second part shall surrender to the parties of the first part or their assigns the peaceable possession of said premises and all ores or waste then remaining upon said premises at the termination of said privilege

WHEREAS: the parties of the first part have granted to one W. V. Richardson and assigns option to purchase the said Lancashire and other lode mining claims by a contract bearing date of the 12th day of September, 1921, and reserving to the party of the second part and said W. V. Richardson and assigns the joint use of said tunnel and water in such manner as may be agreed upon by the said W. V. Richardson or assigns and said party of the second part and most suitable to their mutual convenience.

NOW, THEREFORE, the said parties of the first part for and in consideration of the sum of One Dollar to them in hadn paid by the party of the second part, the receipt whereof is hereby acknowledged, do hereby give and grant to the party of the second part the right, license and privilege to erect such buildings and machinery as the party of the second part may deem necessary upon said Lancashire lode mining claim in the vicinity of the mouth or portal of said tunnel and to use so much of said ground as may be necessary or convenient for the dumping of waste and ore extracted by the party of the second part in conducting its mining operations in or upon said Mabel No. 1 and other mining claims hereinbefore described, provided that the party of the second part shall keep in separate dumps the low grade ore and waste so extracted and shall dump no earth or waste upon the ore dump now upon said premises so as to interfere with the removal thereof.

AND it is further agreed in consideration hereof that the party of the second part is authorized to remove said buildings, machinery, equipment and materials at any time during the period of this agreement and within sixty (60) days after its expiration.

IT IS FURTHER agreed that the party of the second part shall have the right to enter in and upon the said Lancashire lode mining claim to work the said Mabel No. 1 and other lode

shall become the property of the parties of the first part.

IN WITNESS WHEREOF, the parties of the first part have hereunto set their hands, and the party of the second part has caused this instrument to be duly executed by its proper officer thereunto duly authorized on the day and year in this instrument first above written.

J. E. ADAMS.

J. H. MILLER.

STATE OF CALIFORNIA) ss.
COUNTY OF ALAMEDA)

ON THIS 27th day of September, in the year One Thousand Nine Hundred and twenty-one before me NIARA BOOKER a Notary Public in and for the County of Alameda, State of California residing therein, duly commissioned and sworn, personally appeared F. M. SMITH known to me to be the President of the Corporation that executed the within instrument and the officer who executed the within instrument on behalf of the Corporation therein named, and acknowledged to me that such Corporation executed the same.

(SEAL)

IN WITNESS WHEREOF, I have hereunto set my hand and affixed my Official Seal, the day and year in this certificate first above written.

NIARA BOOKER Notary Public
in and for the County of Alameda,
State of California.

THIS AGREEMENT, made and entered into this 12th day of September in the year of our Lord One Thousand Nine Hundred and Twenty-one, by and between J. E. ADAMS of the City and County of Los Angeles, State of California, and J.H.MILLER of the Town of Hawthorne, County of Mineral, State of Nevada, co-partners doing business under the firm name and style of "Adams & Miller" and L. K. GREGORY of the City of Reno, County of Washoe, State of Nevada, the parties of the first part, and W. V. RICHARDSON, of the Town of Tonopah, County of Nye, State of Nevada, the party of the second part, witnesseth:

That the said parties of the first part, for and in consideration of the sum of One (\$1.00) Dollar, lawful money of the United States of America, to them in hand paid by the party of the second part, the receipt whereof is hereby acknowledged, (and the rents, royalties, covenants and agreements hereinafter reserved and contained, to be paid, kept and faithfully performed by the party of the second part), do hereby covenant and agree to sell and convey to the party of the second part, and the party of the second part may purchase at his option all of those certain lode mining claims situated in Garfield Mining District, County of Mineral, State of Nevada, more particularly described as follows:

ATHERTON LODE, GREAT WESTERN LODE, LANCASHIRE LODE, MANCHESTER LODE and BOLTON LODE, consisting of five contiguous lode mining claims granted and conveyed by patent from the government of the United States.

Together with all buildings, ore-bins, one 15 horse-power hoist, and all equipment, tools, machinery and improvements now situated upon the premises hereinabove described.

It is further agreed that the party of the second part, or his assigns, may forthwith enter into the possession of said property and premises and may work and operate the same during the

term or life of this agreement, mining and extracting therefrom any and all valuable mineral deposits found therein upon the terms and conditions following, to wit:

1. The party of the second part shall pay as the purchase price of said property the sum of Sixty Thousand (\$60,000) Dollars, in installments as follows: \$15,000.00 on or before the 20th day of June, 1922; \$15,000.00 on or before the 20th day of September, 1922; \$15,000.00 on or before the 20th day of December, 1922; and \$15,000.00 on or before the 20th day of June, 1923. All such payments shall be made and deposited to the credit of "Adams & Miller", one-half of the amount of such respective payments, and to the credit of L. K. Gregory one-half of each payment at the Farmers & Merchants National Bank of Reno at Reno, Nevada.

2. The party of the second part shall have the right and privilege of mining, extracting and developing any ores found in or upon said premises and may, after the expiration of six months from the commencement of mining operations on said premises, ship, treat, mill or reduce any ores so produced, yielding and paying to the parties of the first part fifty per cent. of the net returns, after deducting only the cost of hauling, railroad freight, and treatment charges, less which treatment charges shall not exceed the current price for the treatment of similar grade or value of ore at Tonopah, Nevada. That the hauling charges for delivery of ore from the mine to railroad points shall not exceed a price at which the parties of the first part, or either of them, may bid for such hauling. All ores shall be shipped in the name of the firm of "Adams & Miller", with instructions to the milling or smelting proprietors to make duplicate returns to "Adams & Miller" and to the party of the second part and to forward

fifty per cent. of the net proceeds, after deductions aforesaid, to the Farmers & Merchants National Bank of Reno, to be divided equally between said "Adams & Miller" and L. K. Gregory and credited to the party of the second part on the unpaid purchase price. The remaining fifty per cent. shall be subject to the order and disposal of the party of the second part. The provisions of the foregoing paragraph with reference to the shipment and treatment of ore shall not apply to ores now mined upon said premises and contained in the dumps or stopes thereon, but all such ore now mined upon said premises shall remain upon said property until after the payment of the purchase price in full. Provided, however, that if the party of the second part shall erect a milling or reduction plant upon or in the vicinity of said mining property he shall have the right to mill and reduce said ores, provided, however, the charges for treatment does not exceed the then current charge for like grade of ores at the Town of Tonopah; the proceeds to be divided between the parties as hereinabove provided and applied upon the purchase price.

3/ The party of the second part shall commence operations and development of said mining property within sixty days from the date of this agreement and shall perform at least ninety shifts per month continuously each and every month thereafter during the term of this agreement. All work shall be done in a good substantial miner-like manner necessary to economical mining so as to take out the greatest amount of ore possible with due regard to the safety, development and preservation of said premises as a workable mine.

All drifts, shafts or adits shall be kept free and clear of rubbish, waste and caves. And the party of the second part shall timber said premises and workings therein at all points where such timbering may be necessary to prevent caving, and shall comply with all of the requirements of the laws of the State of Nevada relating to safety appliances and workmen's compensation.

4. The party of the second part shall be entitled to use any buildings, machinery or improvements now upon said premises. All such machinery shall be kept and remain covered, in case of termination of this agreement, so as to prevent rust or deterioration and all buildings upon said premises shall be maintained and left upon said premises in as good condition as the same now are or may hereafter be put into (reasonable use and wear and damage by the elements excepted).

5. The party of the second part may remove from said premises, in case of the termination of this agreement, any and all machinery, tools, or appliances placed upon said premises by the party of the second part for use in mining operations and development, above the shaft collars, or tunnel portals, excepting that all buildings, improvements, or additions thereto, and all gallows or head frames placed upon said premises shall remain thereon during the term of this agreement and upon any termination, forfeiture, or expiration thereof, shall become the property of the parties of the first part.

6. In case of the abandonment, termination, or forfeiture of this agreement, all ore then extracted and remaining upon said premises shall continue to remain thereon, and shall become the property of the parties of the first part.

7. This agreement shall be subject to an agreement between the parties of the first part and West End Mining Co., with reference to the use of the Ida Tunnel and the use of water upon said premises, it being contemplated hereby that the said West End Mining Co., and the party of the second part may jointly use said tunnel and water in such manner as may be agreed upon between them, and best adapted to their respective conveniences.

8. The parties of the first part, or their agents, servants, or attorneys, shall have the right to enter into and upon the said lands and premises for the purpose of examination, inspection, surveying or sampling and assaying the ores therein contained, at any and all reasonable times.

The party of the second part agrees to pay all the expenses of operating and developing said property under the terms of this agreement, together with all costs and charges of power, electrical energy, material, supplies and labor, and not to suffer any liens, charges, or encumbrances to be laid or imposed upon said premises, and to keep at all times notices posted in a conspicuous place in and upon said premises that the same are being worked and operated by the party of the second part, or his assigns, at his or their own costs, charges and expenses, and that the owners of said mining claims will not be responsible for, or subject to, any claims or liens for labor, services, improvements, or material, performed, made or used in or about the said mining claims and premises.

9. That during the term of this agreement the party of the second part shall pay all state, county and municipal taxes levied or assessed upon said premises, machinery, equip-

ment and property, or shall perform upon said premises all necessary work required to exempt such property from such taxes.

The parties of the first part agree that, within thirty days from the date hereof, they will make, execute and deposit in escrow with the Farmers & Merchants National Bank of Reno, a good and sufficient deed, conveying and assuring to the party of the second part all of the right, title and interest of the parties of the first part in and to the said mining claims and premises, accompanied by a duplicate copy of this agreement and with instructions and directions to said Bank to deliver the same to the party of the second part upon the payment of the purchase price hereinbefore mentioned.

It is further stipulated and agreed that time is of the essence of this agreement. And in the event of the failure of the party of the second part to make such payments at the time and in the manner hereinbefore specified, or in case the party of the second part shall fail to comply with any of the terms, conditions, stipulations, agreements or covenants herein contained, the parties of the first part shall at their option be relieved from all obligation, either in law or in equity, to convey said premises and the party of the second part shall forfeit all right to such conveyance and this agreement may at the option of the parties of the first part be deemed forthwith terminated and ended and the party of the second part shall forthwith surrender the possession of said property to the parties of the first part, and all moneys theretofore paid shall become the property of the parties of the first part as liquidated damages and as rentals for the use and occupation of said property and as a consideration for this option to purchase.

STATE OF NEVADA,

County of Nye,

} ss.

On this 23d day of September A. D. one thousand nine hundred and twenty one personally appeared before me, OTTO FALK, a Notary Public in and for the said County of Nye, State of Nevada.....

W. V. Richardson

known to me to be the person.. described in and who executed the foregoing instrument, who acknowledged to me that ..he.. executed the same, freely and voluntarily, and for the uses and purposes therein mentioned.

IN WITNESS WHEREOF, I have hereunto set my hand, and affixed my Official Seal, the day and year in this certificate first above written.

O. Falk

Notary Public in and for the County of Nye, State of Nevada.



CLASS OF SERVICE	SYMBOL
Telegram	
Day Letter	Blue
Night Message	Nite
Night Letter	N L

If none of these three symbols appears after the check (number of words) this is a telegram. Otherwise its character is indicated by the symbol appearing after the check.

WESTERN UNION TELEGRAM



NEWCOMB CARLTON, PRESIDENT

GEORGE W. E. ATKINS, FIRST VICE-PRESIDENT

CLASS OF SERVICE	SYMBOL
Telegram	
Day Letter	Blue
Night Message	Nite
Night Letter	N L

If none of these three symbols appears after the check (number of words) this is a telegram. Otherwise its character is indicated by the symbol appearing after the check.

RECEIVED AT

425P N 90 BLUE

TONOPAH, NEVADA

not c

LAS VEGAS NEV 1256P OCT 19 1921

H B BUDELMAN

40

CARE WESTEND CONS CO TONOPAH NEV

I WIRED STOTESBURY LAST WEEK THAT I WAS LEAVING TOWN BUT THAT HE SHOULD GET IN TOUCH WITH YOU REGARDING TRANSPORTATION AND OTHER ARRANGEMENTS AT GARFIELD I HAVE NOT RECEIVED ANY ANSWER TO MY LETTER BUT NO DOUBT YOU WILL HEAR FROM HIM SOON I HAVE NOT SEEN HIM PERSONALLY NOR HAD A CHANCE TO EXPLAIN THE SITUATION PLEASE GO INTO THIS IN DETAIL WITH HIM SO THAT HE WILL KNOW THE CONDITIONS I WILL PROBABLY BE HERE ALL THIS WEEK ADVISE ME IF YOU DO NOT HEAR FROM STOTESBURY

J A SHERWIN

2PM

This agreement shall be assignable and the terms, covenants and conditions herein contained shall apply to and bind the heirs, executors, administrators and assigns of the respective parties hereto.

IN WITNESS WHEREOF, the several parties hereto have hereunto set their hands and seals and executed this agreement in quadruple the day and year first above written.

J. E. Adams (SEAL)

J. Milley (SEAL)

L. K. Gregory (SEAL)

W. Richardson (SEAL)

STATE OF CALIFORNIA.

City and County of Los Angeles.)

)
: ss

On this 17th day of September, A. D. Nineteen Hundred
and Twenty-one, before me E. L. Adams

a Notary Public in and for the County of Los Angeles, State of
California, duly commissioned and sworn and residing therein,
personally appeared J. E. ADAMS, known to me to be the same
persons described in, whose name is subscribed to and who ex-
ecuted the foregoing instrument, who duly acknowledged to me that
he executed the same freely and voluntarily and for the uses and
purposes therein mentioned.

IN WITNESS WHEREOF, I have hereunto set my hand and
affixed my official seal at my office in the said County of Los
Angeles, the day and year in this certificate first above
written.

(NOTARIAL SEAL)

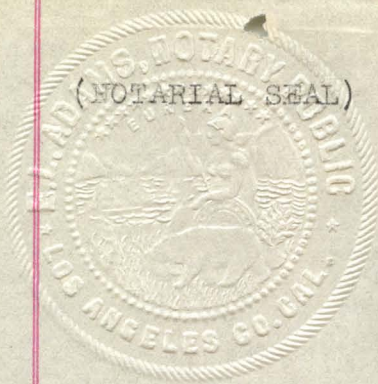

E. L. Adams
Notary Public in and for the County
of Washoe, State of Nevada.

My commission expires _____

My Commission Expires January 6, 1923

STATE OF NEVADA,)
 : ss
County of Washoe.)

On this 12th day of September, A. D. Nineteen Hundred and Twenty-one, before me, GEORGE S. GREEN, a Notary Public in and for the County of Washoe, State of Nevada, duly commissioned and sworn and residing therein, personally appeared J. H. MILLER and L. K. GREGORY, personally known to me to be the same persons described in, whose names are subscribed to and who executed the foregoing instrument; who duly acknowledged to me that they executed the same freely and voluntarily and for the uses and purposes therein mentioned.

IN WITNESS WHEREOF, I have hereunto set my hand and affixed my official seal at my office in the said County of Washoe, the day and year in this certificate first above written.



Geo. S. Green

Notary Public in and for the County
of Washoe, State of Nevada.

My commission expires Sept. 12, 1922.

LEASE AND OPTION TO PURCHASE

THIS INDENTURE OF LEASE made and entered into this 2nd day of July, 1934, by and between W. J. HARRIS, of the City of Reno, County of Washoe, State of Nevada, and NEW ELDORADO GOLD MINING COMPANY, a corporation duly chartered, organized and existing under and by virtue of the laws of the State of Nevada, the party of the first part, hereinafter referred to as lessors, and WEST END CONSOLIDATED MINES CORPORATION, a corporation duly chartered, organized and existing under and by virtue of the laws of the State of Nevada, the party of the second part, hereinafter called lessee,

W I T N E S S E T H:

That the said lessors in consideration of the rents, royalties, covenants and agreements hereinafter reserved and contained, by the said lessee to be paid, kept and faithfully performed, do hereby lease, demise and let unto the said lessee all those certain lode mining claims situated in Gold Range Mining District, County of Mineral, State of Nevada, more particularly described as follows, to-wit:

Lancashire Lode, Manchester Lode, Bolton Lode, Atherton Lode and Great Western Lode, granted and conveyed by patents issued by the General Land Office of the United States, and Last Dollar Lode, Lucky Dwight Lode, Dwight No. 1 Lode, Easter Lode, South Great Western Lode, Iron Horse, Jr. Lode, B & M No. 1 Lode and B & M No. 2 Lode unpatented mining claims, the certificates of location of which are recorded in the office of the County Recorder of the County of Mineral, State of Nevada, to which reference is hereby made for further identification, all said lodes being situated in Sections 17, 20 and 21, Township 7, North Range 33 East, M.D.B. & M.

TO HAVE AND TO HOLD the said premises unto the said lessee for the period of six (6) years from and after the first day of August, 1934, and until the expiration of said term, unless sooner forfeited or terminated through default or violation by said lessee of the terms and covenants herein contained. And the said lessee does hereby covenant and agree as follows, to-wit:

1. To enter into and upon the said premises and work and operate the same in a proper, skilful and minerlike fashion, and in a manner necessary to good and economical mining so as to take out the greatest amount of ore with due respect to the safety, preservation and development of said premises as a workable mine.

The lessee shall work, operate and develop said property either through the Mabel shaft on lessee's ground, or any other shaft upon any of the mining claims hereinabove described. In case said ground is developed through the Mabel shaft, the lessee shall continue sinking the said shaft to a depth of two hundred (200) feet below the bottom of the present shaft, and shall then continue the work by a drift into the property and premises of lessors. That said work shall commence on the first day of August, 1934, and shall be prosecuted continuously until the said shaft and drift are completed. After said shaft and drift have reached the ground of lessors, the lessee shall perform at least one hundred (100) shifts per month during each and every month during the term of said lease upon the premises of the lessors, and a failure to perform such labor for thirty (30) continuous days shall work a forfeiture of this lease.

2. To pay as royalties and rentals for the use and occupation of said premises ten (10%) per cent on all ores, the gross value of which is Thirty (\$30.00) Dollars per ton, or less,

fifteen (15%) per cent on all ores, the gross value of which is Thirty (\$30.00) to Fifty (\$50.00) Dollars per ton, twenty (20%) per cent on all ores, the gross value of which is Fifty (\$50.00) to One hundred (\$100.00) Dollars per ton, and twenty-five (25%) per cent on all ores, the gross value of which is more than One hundred (\$100.00) Dollars. Such royalties shall be computed upon the gross value of the ore after deducting transportation and smelting charges. The lessee shall be charged with any or all loss resulting from the shipment or treatment of any ore which does not prove to be of profitable or payable grade, or the value of which shall be insufficient to pay the costs of transportation and reduction.

3. The lessee shall ship all ores in the joint names of W. J. Harris, New Eldorado Gold Mining Company and West End Consolidated Mines Corporation, with instructions to the mill, smelter or reduction plant to deduct and pay to the lessors their royalties in the proportion of one-half to W. J. Harris and one-half to New Eldorado Gold Mining Company. The mill, smelter or reduction plant reducing said ores shall furnish each of the parties hereto at least three duplicate copies of the settlement sheets.

4. The lessee shall keep all ores extracted from the said leased premises separate and segregated from the ore produced from lessee's own property and shall not comingle the same with ore extracted from adjoining or adjacent mining claims, or any other mines or mining claims wheresoever situated. In case of the forfeiture, termination or expiration of said lease, the lessee grants to the lessors the right to remove all such ores as have been extracted from lessors' premises and stored upon the ground of lessee, within ten (10) years from the date hereof, and all ores remaining on said ground at the termination or expiration of said lease shall be the property of the lessors until the expiration of said period.

5. The lessors shall have such permission of ingress and egress through the property of lessee for the purposes aforesaid for a period of ten (10) years from the date hereof, provided that in case the lessee is not operating the said property, the machinery and equipment used for such inspection shall be operated at the expense of the lessors, and the lessors shall have the right to use the same.

6. The lessee shall pay all miners or other laborers engaged or employed in or about the said premises at least twice a month.

7. The lessee shall cause all workmen, miners or laborers to be insured by Nevada Industrial Commission and shall pay to said Commission all charges incurred in connection with the protection of such workmen.

8. The lessee shall cause to be posted in a conspicuous place upon said premises notice of the non-liability of the lessors notifying all persons that the said lessors will not be responsible or liable for any labor performed, materials furnished or improvements made upon said premises during the term of said lease, and cause a copy of such notice together with an affidavit of posting the same in a conspicuous place upon said premises, to be recorded in the office of the County Recorder of the County of Mineral, State of Nevada, in all respects as required by Section 2221 of the Revised Laws of the State of Nevada as amended by the statute of 1917, page 435.

9. The lessee shall well and sufficiently timber all of the workings upon said premises at all points where proper in accordance with safe mining, and promptly repair and replace all timbering which may be rendered insufficient by shock, blasting, pressure, water, wear and tear, or other causes, and keep such

timbering at all times in a good, safe and serviceable condition, and shall not remove any timber from any portion of said premises except insofar as may be necessary for repairs, enlargement or more speedy and economical working of the said property.

10. Any caving of stopes or obstruction of drifts, levels or other workings necessary to continuous operation of the said premises, and resulting from a default or neglect of the lessee shall, if not corrected within thirty (30) days after having received notice thereof from the said lessors, at the option of the lessors, cause an immediate forfeiture and termination of this lease.

11. The lessee shall keep at all times the drifts, shafts, tunnels and other workings thoroughly drained, accessible and clear of loose rock, rubbish and earth. All ores must be hoisted to the surface and shall not be stored underground in the Mabel or the mining claims of lessors.

12. The lessee shall make all shafts at least seven feet long, at least four feet wide in the clear, and all drifts at least six feet high and four feet wide in the clear.

13. If for any reason due to an act of God, labor trouble and/or strikes, or any other cause beyond the control of the lessee, the said lessee is prevented from continuous operation under this lease for a definite period of time, the term of this lease shall be extended a like period.

14. In the event the said lessee, or its servants, agents or employees, shall at any time during the continuance of this lease, make a strike of any ores of importance, or a strike of increased values of ores theretofore discovered, the same shall be reported to the lessors within three days after such strike or

discovery. All ores shall be kept separate from waste as extracted, and shall not be mixed with wastes so as to deteriorate the value of such ores, and all ores which are not milled or reduced shall be piled separately upon the dump or dumps.

15. The lessee shall deliver to the lessors on or before the tenth of each month, a correct statement in writing showing all shipments of ores and the number of shifts of work performed on said mining claims during the previous month.

16. The lessors reserve the right to remove the hoist and ore bins now upon the Lancashire claim.

17. The lessors shall pay the state and county taxes upon the net proceeds of mines in the amount of the royalties and payments received by them, and the tax on the net proceeds of mines shall be paid by the lessee on that portion of the proceeds which it shall receive.

18. Time and punctuality are of the essence of this agreement.

19. That during the term of said lease, the lessee shall at its own expense, perform all annual labor required by Section 2324 of the Revised Statutes of the United State, and shall annually caused to be filed a proof of such labor for the purpose of holding said unpatented mining claims for the benefit of the lessors, and shall make and file with the Board of Equalization the affidavits of performance of annual labor upon the patented mining claims so as to obtain the exemption from taxes as provided by law.

20. The lessee is hereby granted an option to purchase said mining claims for the sum of Seventy-five thousand (\$75,000.00) Dollars, payable as follows, to-wit:

Two thousand (\$2,000.00) Dollars on or before the 1st day of August, 1934; Five thousand (\$5,000.00) Dollars on or before the 1st day of August, 1935; Ten thousand (\$10,000.00) Dollars on or before the 1st day of August, 1936; Ten thousand (\$10,000.00) Dollars on or before the 1st day of August, 1937; Ten thousand (\$10,000.00) Dollars on or before the 1st day of August, 1938; Nineteen thousand (\$19,000.00) Dollars on or before the 1st day of August, 1939 and Nineteen thousand (\$19,000.00) Dollars on or before the 1st day of August, 1940.

All such payments may be made at First National Bank in Reno for deposit to the credit of the lessors, share and share alike. In the event of the failure to make either or any of such installment payments at the time and in the manner hereinbefore specified, then and in that event the said lease and option shall be terminated, and the lessee covenants and agrees to quietly and peacefully surrender the said demised premises to the said lessors, and in case of default in any such payment, the lessors shall be relieved of all obligations in law or in equity to convey the said premises, and the lessee shall forfeit all right thereto, and all sums theretofore paid shall become the property of the lessors as stipulated and liquidated damages as a consideration for this option and as rentals for the use and occupation of said premises. All royalties herein provided for may be applied by the lessee on the purchase price, or the installment thereof next becoming due and payable. Upon receiving payments in the manner and in the amount hereinbefore mentioned, the said lessors covenant and agree to make, execute and deliver to the said lessee a good and sufficient deed and conveyance of said leased premises, conveying and assuring to the said lessee all of the right, title and interest of

the said lessors in and to said demised premises and every part thereof.

21. The lessors at all times during the period of ten (10) years from the date of this lease, or until the said option to purchase is exercised and consummated, shall have the right, privilege and permission to enter into and upon and inspect, sample or survey any part of the surface or underground workings upon said premises, including the Mabel shaft and drifts therefrom entering the ground of lessors, for the purpose of determining and measuring the ores extracted and whether the said lease is being fully complied with, and this stipulation shall be deemed a covenant running with the land binding upon the successors and assigns of said lessee. In case the said lessee, its successors or assigns, are not operating said Mabel shaft or mining property, the lessors may nevertheless have the right of such inspection and use of the machinery for ingress and egress to said property, providing the lessors pay the expense of the operation thereof for the purposes of such inspection.

22. The lessee agrees to furnish to lessors on demand copies or prints of any plats, maps or surveys of the surface or underground workings which it may make or have made during the term of said lease, or any extension thereof.

23. This lease and option and all of the terms, conditions and covenants therein contained, shall be binding upon and affect the heirs, executors, administrators, assigns and successors of the respective parties hereto.

IN WITNESS WHEREOF, the said lessor, W. J. Harris, has hereunto set his hand and seal, and the said lessors, New Eldor-

STATE OF NEVADA

County of _____

)
) ss.

On this _____ day of July, A. D. 1934, before me, the undersigned, a Notary Public in and for the County of _____, State of Nevada, duly commissioned and sworn and residing therein, personally appeared _____, known to me to be the President of the corporation that executed the foregoing instrument, who upon oath did depose and say that he is the officer of said corporation as above designated; that he is acquainted with the seal of said corporation and that the seal affixed to said instrument is the corporate seal of said corporation; that the signatures to said instrument were made by the officers of said corporation as indicated after said signatures; and that the said corporation executed the said instrument freely and voluntarily and for the uses and purposes therein mentioned.

IN WITNESS WHEREOF, I have hereunto set my hand and affixed my official seal at my office in said County of _____, the day and year in this certificate first above written.

(NOTARIAL SEAL)

Notary Public in and for the County
of _____, State of _____

My commission expires
_____.

(254) Item 117

3 of 46

4840 0117

MABEL MINE SERIES
DRAWINGS & DATA

3

1924

Mabel Mine 1924₃

Garfield - Mohul
1921

correspondence
& leases

TONOPAH, NEVADA

→ To Shaft

4200

Crover
370
N700E

4400

5000

4000 level

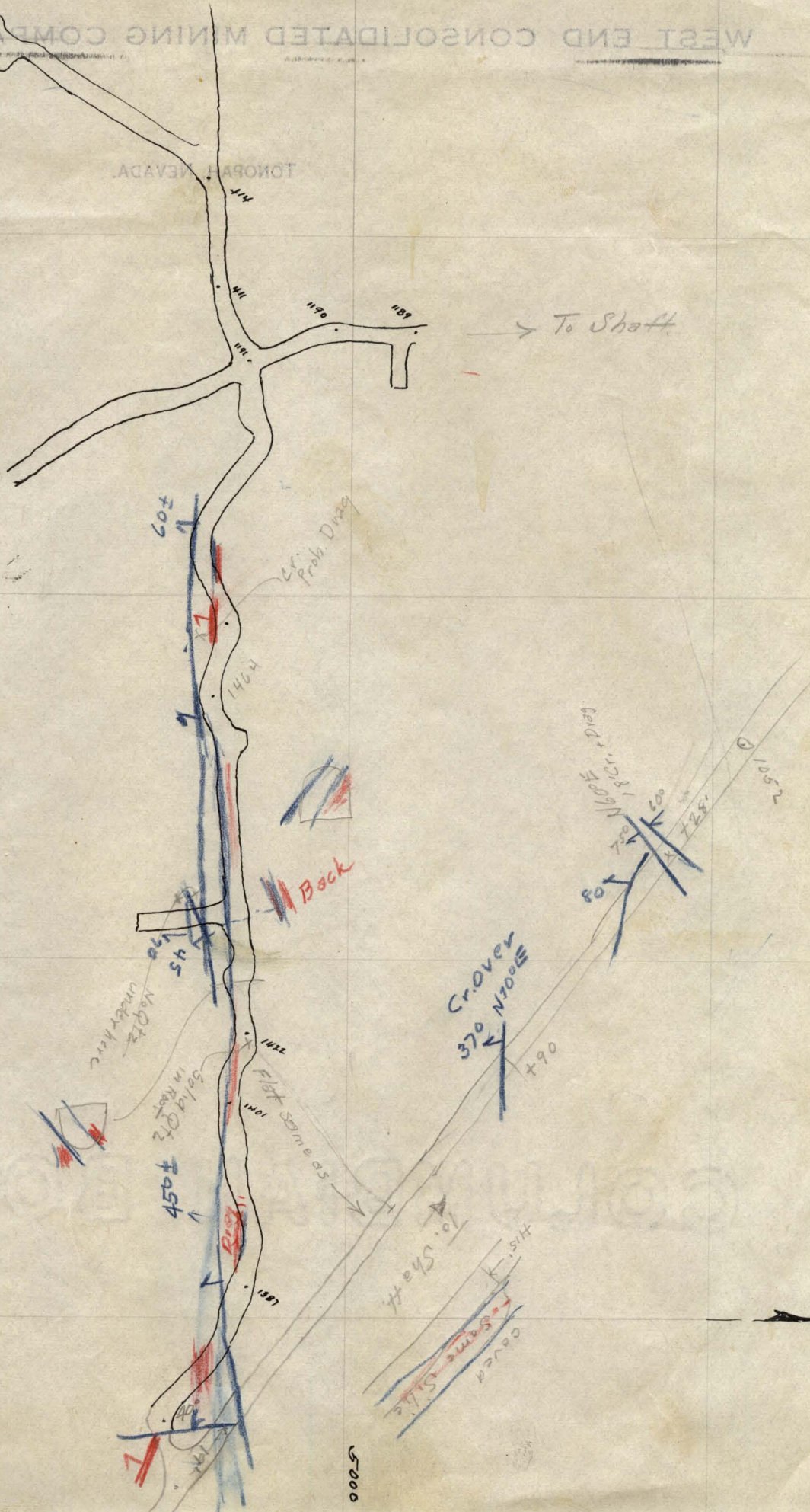

③

PLAN

100 Level

Flat Vein

Open Slope

Fill

Pillar

See Thru Winze

RT PLAN

VERT PLAN

1016

5829.7

— 7.8

31.9

— 18.6

2^d Inter. Level 5808.3

12.7

5805.6

SURFACE CUT AT

S-17-A

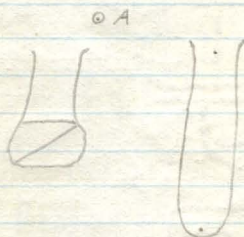

SURFACE CUTS AT S-16



INCLINE AT S-22

Part Filled- Open 20' Down

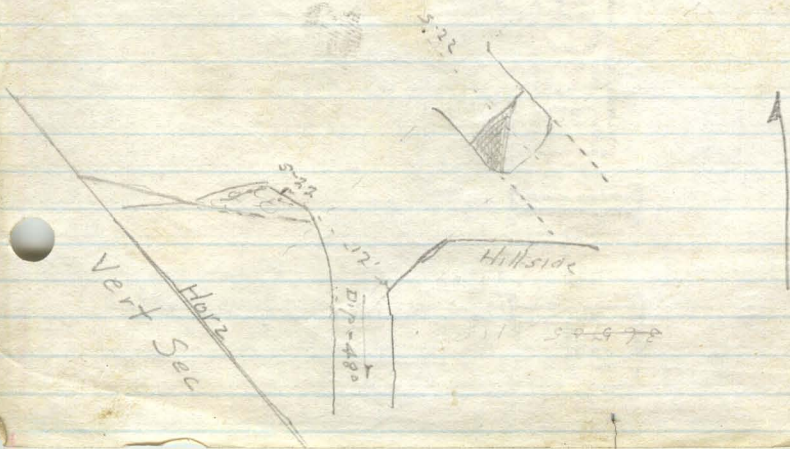

MIDDLE TUNNEL
MABEL MINE

5/17/22

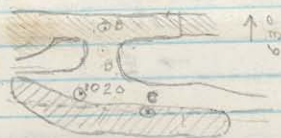

Hor

Stops at Sta 1020

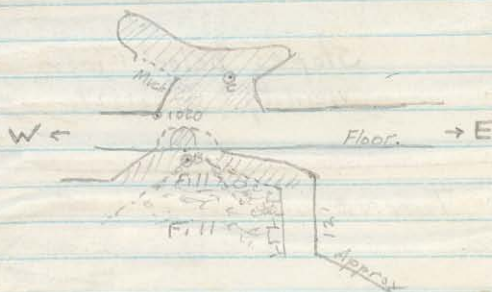

Vert.

Sec at B.

Stops at 1020-A



Hor

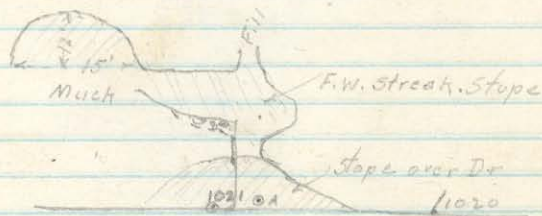

Vert.

→ E

Sec at A.

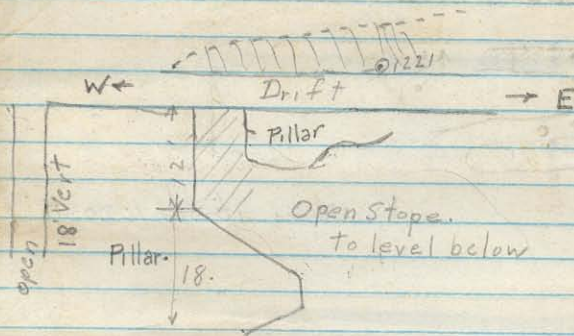

Vert.

Slopes below Floor
vicinity Sta 1221

UPPER TUNNEL Vert. Sec.

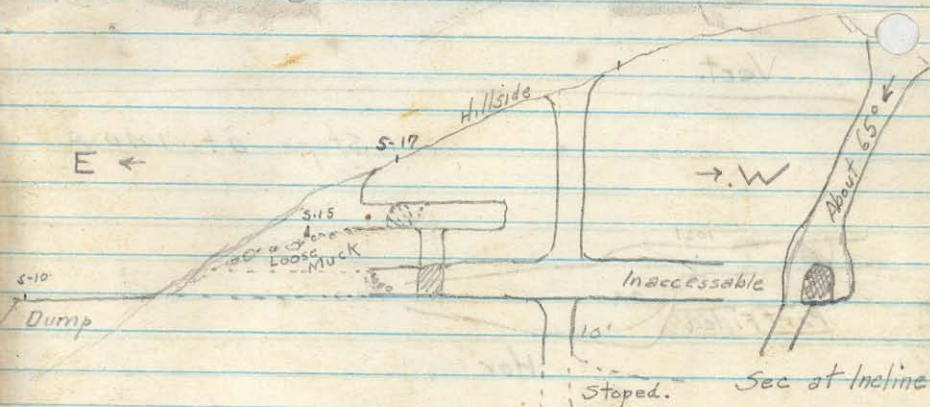

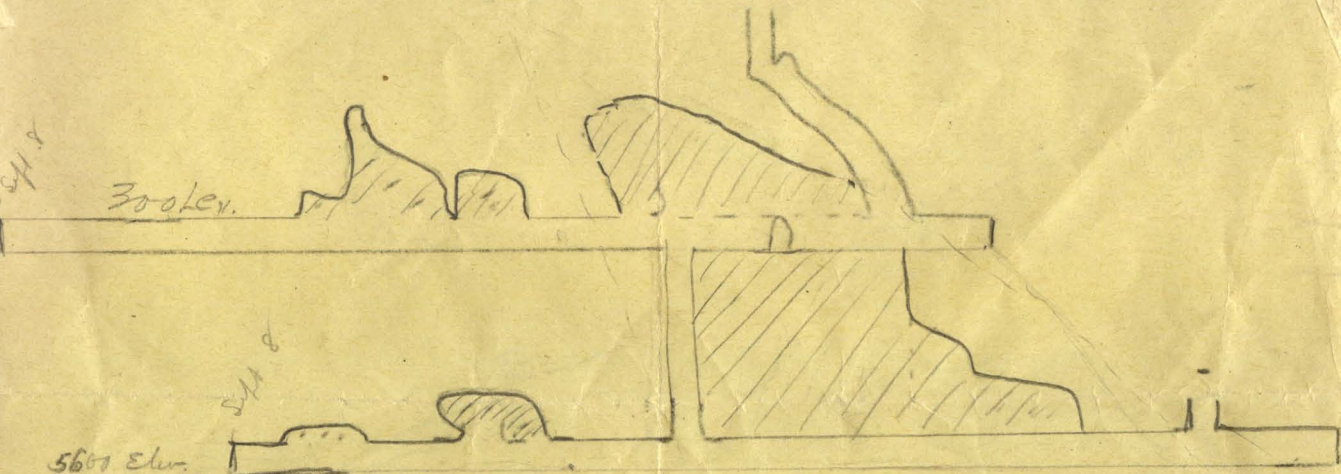

5600 Elev.

N 76° W.
last. 20' ±

N ←

→ E

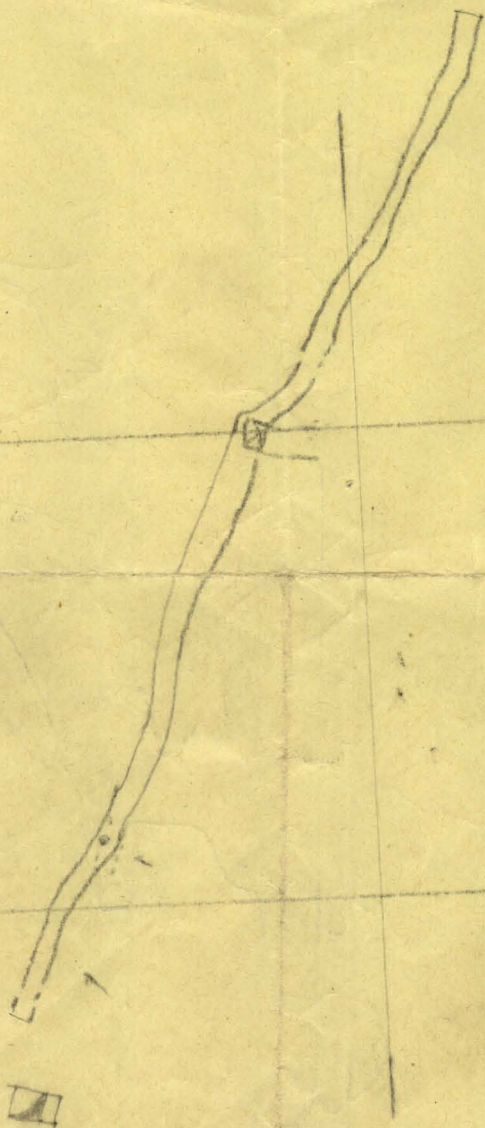

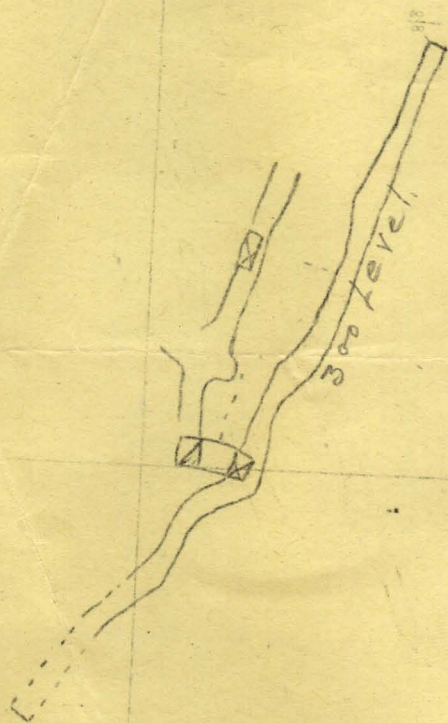

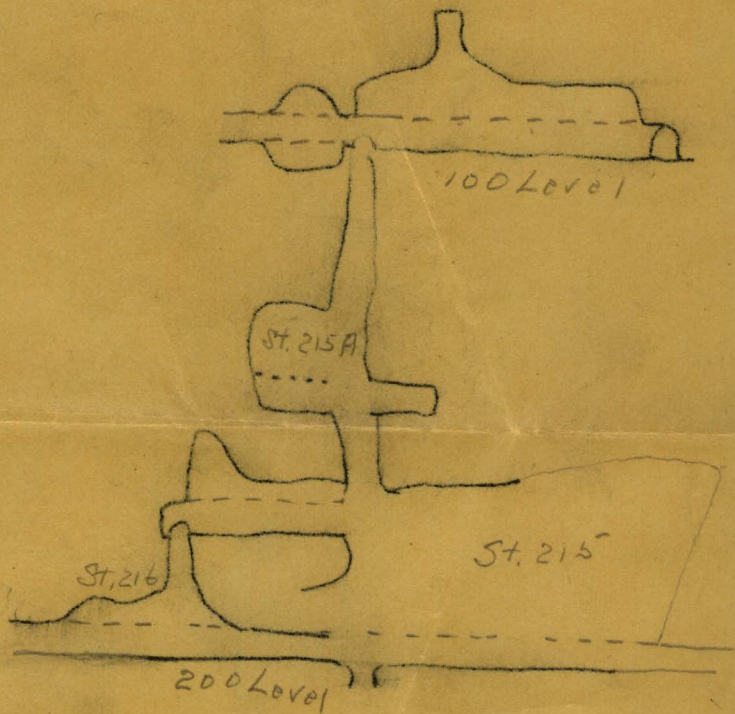



100 Level



24.512

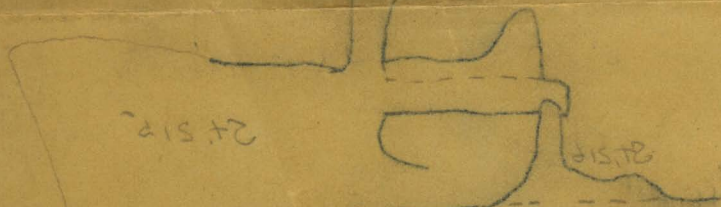

24.512

24.512

100 Level

July 16, 1924.

Mr. Archie Farrington,
Millet, Nevada

Dear Mr. Farrington:-

Could you tell me who ran the Lancashire tunnel, that is, the Garfield Company or the original owners of the Mabel ground? Did the Garfield Company grant any permission to the previous owners of the Mabel ground to use this tunnel?

Mr. Jones of Hawthorne has told me that Mr. Kelso states that he thinks that you gave Mr. Fish verbal permission to run that tunnel through the Garfield ground.

With kindest regards,

Very truly yours,

MINE SUPERINTENDENT

HDB:G

WEST END CONSOLIDATED MINING COMPANY

TONOPAH, NEVADA,

July 16, 1924.

Mr. Archie Farrington,
Millet, Nevada

Dear Mr. Farrington:-

Could you tell me who ran the Lancashire tunnel, that is, the Garfield Company or the original owners of the Mabel ground? Did the Garfield Company grant any permission to the previous owners of the Mabel ground to use this tunnel?

Mr. Jones of Hawthorne has told me that Mr. Kelso states that he thinks that you gave Mr. Fish verbal permission to run that tunnel through the Garfield ground.

With kindest regards,

Very truly yours,

O. H. Hudelman
MINE SUPERINTENDENT

HDB:G

*Millet, Nevada
July 18, 1924*

*Dear Mr. Hudelman,
In reply to the above ~~There~~^{was} no permission
~~was~~ ever given by me to make the tunnel
and it was done after I left there.
Trusting that all will be satisfactory
I am
Very truly yours
Archie Farrington Sr.
B. V. F.*

Hawthorne
Mineral Co
July 15th / 24 West

Mr H F Bridelman

Dear Sir

In regards to your letter received this morning, I asked Mr Kelso about that and he told me as near as he could remember that Archie Farrington who was Super & Owner of the Garfield at that time, gave Mr Fish verbal permission to run that tunnel through that small piece of Garfield ground, so Mr Fish who was the locator of the Ida, (being the Mabel now) ran the both, hanging wall & footwall tunnells. if you could see Mr Farrington he could give you full particulars. with kind regards from Martin & myself.

I remain

Yours Truly
J Jones

WEST END CONSOLIDATED MINING CO.

OFFICE OF GENERAL MANAGER

J. W. SHERWIN, GENERAL MANAGER

SYNDICATE BUILDING
OAKLAND, CALIFORNIA

July 7, 1924.

Mr. J.H. Miller,
Hawthorne, Nevada.

Dear Mr. Miller,

I was sorry to learn that you had been inconvenienced by our superintendants refusal to take you into the Mabel - Mine workings. We have standing orders with the superintendants at all our mines, not only at the Mabel, but at Tonopah, Las Vegas and elsewhere, not to take visitors underground without special orders. We have found such a rule to be necessary, and without it we would be overrun with visitors, to the serious detriment of, and interference with, our work. This is particularly true at the Mabel where our facilities are so limited.

*marsh was not
there when
miller called.*

However, we like to accomodate our friends and neighbors as much as possible, and if you are still desirous of inspecting the Mabel and will drop a note to Mr. Budelman at the West End Mine, Tonopah, stating the approximate date upon which you expect to be in that vicinity, he will instruct our Mabel superintendant to show you through the mine. We have no objection to your having an engineer accompany you if you wish.

Yours very truly,

J. W. Sherwin.
General Manager.

OFFICES OF

Hawthorne Mines, Incorporated

HAWTHORNE, NEVADA, July 14th 1924

Mr. Budelman,
West End Mine,
Tonopah, Nevada.

Dear Mr. Budelman:-

I am enclosing a letter to myself from
Sherwin which is self explanatory.

It is my desire that you instrust
Mr. Marsh at the Mabel, to allow myself and whoever I
desire to have accompany me, whether an engineer or
Mr. Harris or others interested with me in the Garfield
group, to have access to the Mabel at any time.

It is not my intention to interfere
with your men working, and I have been in the game
long enough so that I can keep out of the way I guess.

Will appreciate your doing this and
would like to have you advise me here of your action.

Yours very truly,

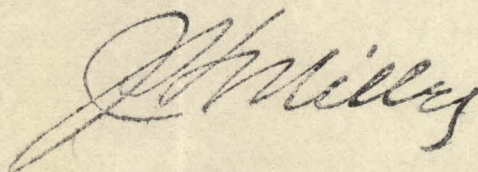

JHM:B

WEST END CONSOLIDATED MINING CO.
MABEL MINE ORE SHIPMENTS TO SMELTERS, YEAR 1924

DOT NOS.	MONTH	DRY TONS	OZS. GOLD	OZS. SILVER	LBS. LEAD	GROSS VALUE	SMELTER TREATMENT & DEDUCTION	HAULING	FREIGHT	ASSAYING SAMPLING & SUPERVISION	NET RETURNS
24	Jan.	44	66.668	3904.55	7578	4485.19	943.18	295.40	349.21	15.00	2882.40
25	Feb	44	71.338	5462.90	9288	5778.85	1017.77	318.50	599.04	8.00	3835.54
26	March	47	66.478	5236.03	10618	5676.15	1052.35	335.30	440.96	13.00	3834.54
27	April	47	59.150	3444.02	9193	4182.90	969.53	329.90	334.48	8.00	2540.99
28	June	42	96.538	7421.48	11296	7762.55	1113.63	297.85	566.05	11.00	5774.02
29	July	40	69.920	7041.38	8417	6664.27	986.86	286.72	542.11	31.34	4817.24
31	Oct.	39	48.448	3158.67	5032	3628.75	799.29	257.22	286.84	64.03	2221.37
32	Nov.	38	54.107	3201.88	7436	3980.30	830.39	231.60	310.86	56.41	2551.04
34	Dec.	34	48.900	3306.21	8274	4078.18	797.24	213.48	368.00	47.51	2651.95
		375	581.547	42177.12	77132	46237.14	8510.24	2565.97	3797.55	254.29	31109.09

MABEL MINE ORE SHIPMENTS TO WEST END MILL, YEAR 1924

DOT NOS.	MONTH	DRY TONS	OZS. GOLD	OZS. SILVER	GROSS VALUE	LOSS IN MILL	MARKETING	NET BULLION	MILLING	HAULING	NET RETURNS
30	Aug.	13	5.187	344.27	341.32	22.17	6.62	312.53	44.20	121.04	147.29
33	Dec.	13	2.906	259.04	236.36	17.03	5.06	214.27	50.67	76.26	87.34
		26	8.093	603.31	577.68	39.20	11.68	526.80	94.87	197.30	234.63

SUMMARY OF MABEL MINE ORE SHIPMENTS, YEAR 1924

Gross Value Smelter Shipments	46237.14
Gross Value Mill Shipments	577.68
TOTAL GROSS VALUE	46814.82

SMELTER SHIPMENTS

Smelter Treatments & Deductions	8510.24
Assaying, Sampling & Supervision	254.29
	8764.53

MILL SHIPMENTS

Mill Losses	39.20
Marketing Bullion	11.68
Mill Treatment	94.87
	145.75
	8910.28
	37904.54

Hauling Smelter Shipments	2565.97
Hauling Mill Shipments	197.30
R. R. Freight on Smelter Shipments	2763.27
Total Hauling & Freight	3797.55
	6560.82
NET RETURNS	31343.72

Mabel Mine ore Shipments to Smelters year 1924

Date	Month	Dry Tons	Ore Sold	Oz Silver	Lb Lead	Gross Value	Smelter Treatment & Ded.	Hauling	Freight	Assaying, Sampling & Supervision	Net Return
24	Jan	44	66668	390455	7578	448519	94318	29540	34921	1500	288240
25	Feb	44	71338	546290	9288	577885	101777	31850	59904	800	383554
26	March	47	66478	523603	10618	567615	105235	33530	44096	1300	383454
27	April	47	59150	344402	9193	418290	96953	32990	33448	800	254099
28	June	42	96538	742148	11296	776255	111363	29785	56605	1100	577402
29	July	40	69920	704138	8417	666427	98686	28672	54211	3134	481724
31	Oct	39	48448	315867	5032	362875	79929	25722	28684	6403	222137
32	Nov	38	54107	320188	7436	398030	83039	23160	31086	5641	255104
34	Dec	34	48900	330621	8274	407818	79724	21348	36810	4751	265195
		375	581547	4217712	77132	4623714	851024	256597	379755	25429	3110909

Mabel Mine ore Shipments to West End Mill year 1924

Date	Month	Dry Tons	Ore Sold	Oz Silver	Gross Value	Gross in Mill	Marketing	Net Bullion	Marketing	Net Return
30	August	13	5187	34427	34132	2217	662	31253	4420	12104
33	Dec	13	2906	25904	23636	1703	506	21427	5067	7626
		26	8093	60331	57768	3920	1168	52680	9487	19730

Summary of Mabel Mine ore Shipments year 1924.

Gross Value Smelter Shipments		4623714
Gross Value Mill Shipments		57768
Total Gross Value		4681482
Smelter Shipments		
Smelter Treatment & Deductions	851024	
Assaying, Sampling & Supervision	25429	876453
Mill Shipments		
Mill Losses	3920	
Marketing Bullion	1168	
Mill Treatment	9487	14575
Total Treatment & Deductions		891028
		3790454
Hauling Smelter Shipments	256597	
Hauling Mill Shipments	19730	276327
R.R. Freight on Smelter Shipments		379755
Total Hauling & Freight		656082
Net Return		3134372

July 12, 1924.

Mr. Joseph Jones,
Hawthorne, Nevada

My dear Mr. Jones:-

As a matter of information, could you find out for me who ran the Lancashire Tunnel at the Mabel Mine. Was it the owners of the Garfield Mine or was it done by the original owners of the Mabel ground?

With kindest regards to yourself and Martin,

Very truly yours,

MINE SUPERINTENDENT

HDB:G

July 16, 1924.

Mr. J. H. Miller,
Hawthorne, Nevada

Dear Mr. Miller:-

This is in reply to your letter of the 14th with which you enclosed Mr. Sherwin's letter to you of the 7th.

Conforming with instructions in Mr. Sherwin's letter, I will be glad to arrange for you to visit the Mabel Mine at any convenient time. In case you are unable to plan your visit sufficiently ahead to advise me by letter, allowing time for my answer to reach Mr. Marsh, please call me on the telephone and I will instruct him by wire, in your care, so that there will be no misunderstanding when you arrive on the ground. Before you go out, you had best make sure that Mr. Marsh is at the Mine, as there will be no one else there with authority to permit anyone to go under ground.

We are at present doing no work below the tunnel level, having started to raise the shaft through to surface, so that the only way to get to the lower levels is by the ladder ways. This shaft work should be completed in about three weeks, after which time we expect to have the hoist again in operation, and navigation up and down the shaft will not be so arduous as now.

Very truly yours,

MINE SUPERINTENDENT

HDB:C
C:Mr.Sherwin
C:Mr.Marsh

July 16, 1924.

Mr. H. E. Marsh,
Mina, Nevada

My dear Mr. Marsh:-

The enclosed copy of letter to Mr. J. H. Miller is in answer to a recent letter of his in which he asked for a permanent pass through the Mabel Mine, for himself and whoever he wishes to take with him. Without further instructions from Oakland we are unable to accede to his request any more liberally than my letter indicates.

However, I believe it is Mr. Sherwin's wishes that we accommodate Mr. Miller as much as possible while any of our equipment is on the Garfield property. With this in mind, I would suggest that if Mr. Miller comes on the ground without notice, that you tell him you feel sure it will be O.K. and take him down, with whoever may be along.

Advise Casey or whoever you happen to leave in charge while you are away, to take no one down the mine in your absence unless special instructions have been issued. Tell him to use a little judgment though, in turning them down so as not to antagonize anyone.

With kindest regards,

Very truly yours,

HDB:G

MINE SUPERINTENDENT

Mabel 2/5/24

Brenton

314 K-C

A B 555W 26
+10 $2.5/1.5$ +20 $3/1$ +26 $1.5/2.5$ ✓

B face S16W 29
+5 $2.5/1$ +19 $2.5/1.5$ +24 $1.5/3$ +29 $1/3.5$

313 1/4 T. Dr. #2

1065 a N62W 81.5

a b N60W 34 St. 2 W end

+5 $3.5/1.5$ +18 $4.5/1.5$ +26 $3.5/0$ +29 $3/1$
+34 $1.5/3.5$

b face N73W 21

+6 $9/4$ +13 $5/4$ +21 $3/2$

402 Dr.

d e N71W 19

+0 $2.5/1$ +16 $3.5/1.5$ +19 $2.5/1$ ✓

e f N77W 22.7

+6 $1/2.5$ +13 $0/3.5$ +22.7 $2/1.5$

f face N53W 16

+5 $1.5/3.5$ +11 $2/2$ +16 $2.5/1$

(over)

Samples

617-207 SKS. Lot 25

618-Cut 1' oxidized over
face 402 Dr.

ft 19

H.D.B.

Please bring home
these two packages
Illene

Mabel Mine
Brunton 2/7/23

Raise 309

stop DIST. 1, 2

X Y N3W 21

Y face N11W 31 +37°

+0 $\frac{5}{3}$ $\frac{2}{3}$ H.W. +13 $\frac{3}{1}$ $\frac{4}{2}$ +20 $\frac{3.5}{.5}$ $\frac{4}{.5}$

+22 $\frac{2.5}{4}$ $\frac{12}{1}$ +25 $\frac{2}{4}$ $\frac{8}{2}$ +31 $\frac{1}{4}$ $\frac{3}{3}$

X is Budelmans pt.

Raise 311

H a N66W 23

a b 9.5 +90°

b face N14E 13 +18°

+3 $\frac{5}{1}$ $\frac{1}{3}$ +7 $\frac{5}{2}$ $\frac{2}{2}$ +13 $\frac{2.5}{2.5}$ $\frac{.5}{3.5}$ +13.15° F.W. of ore

Dr. 310

K J N43W 50

+21 $\frac{0}{3.5}$ +25 $\frac{1}{3.5}$ +30 $\frac{4}{.5}$ +33 $\frac{3.5}{0}$

+38 $\frac{2}{1}$ +42 $\frac{5}{3}$ +46 $\frac{1}{2}$ +49 $\frac{3}{1.5}$

J L N64W 18

+0 $\frac{3}{1.5}$ +5 $\frac{3}{.5}$ +10 $\frac{3}{1}$ +13 $\frac{3.5}{.5}$ +18 $\frac{1.5}{2}$

L face N80W 25

+0 $\frac{1}{2}$ +6 $\frac{0}{3.5}$ +13 $\frac{1}{3}$ +19 $\frac{2}{1.5}$ +25 $\frac{2}{1}$

288°44'

288 44

577 8

360

217°28'

288 44

506 2

360

146°2'

111 18

360

471 18

235 39

2 217°24'

360

2 577 21

288 47

267 19

66 34

233 53

267 19

170 51

438 10

360

78 10

Mabel Mine Jan. 1, 1923

214 Dr.

1034M a N25W 15.7

a b N65W 36

+20 $\frac{0}{4}$ +29 $\frac{4}{1}$ +4 $\frac{1}{1}$ +36 $\frac{2.5}{1}$ $\frac{40}{6.5}$

b c S67W 16

+5 $\frac{2}{1.5}$ +10 $\frac{0}{4}$ +16 $\frac{2.5}{1.5}$ ✓

c face N55W 23

+0 $\frac{2}{1.5}$ +10 $\frac{3}{1}$ +23 $\frac{0}{3.5}$

310 Dr.

H K N67W 41.3

K face X_{6307} S19W 12

+0 $\frac{4}{1}$ +2 $\frac{3.5}{3}$ +5 $\frac{1.5}{3}$ +12 $\frac{2}{2}$

K face N44W 31

+0 $\frac{2}{4}$ +2 $\frac{2.5}{3}$ +5 $\frac{5 \text{ cor.}}{0}$ +7 $\frac{5 \text{ cor.}}{1.5}$ +10 $\frac{5}{0.6 \text{ cor.}}$

+13 $\frac{2.5}{3.5}$ +17 $\frac{1}{3}$ +25 $\frac{0}{3.5}$ +27 $\frac{2}{2}$ +31 $\frac{3}{0}$

309 Int. Dr. #1 4/12/23

G a S38E 23
+7 $\frac{5}{3}$ +13 $\frac{2}{4}$ +14 $\frac{2}{2}$ +20 $\frac{1}{2}$ +23 $\frac{2}{3}$

a face S60E 15
+6 $\frac{1}{3}$ +10 $\frac{5}{3}$ +15 $\frac{2}{2}$

309 Int. Dr. #2

G 1 S86W 21

1 face N25W 23

+4 $\frac{2}{3}$ +10 $\frac{1}{2}$ +16 $\frac{4}{0}$ +20 $\frac{2}{1}$ +23 $\frac{0}{3}$

Mabel Mine 10/24/22

120 115 DK

d face S70W 31

+0 ^{1.5}/₂ +7 ¹/₃ +15 ^{1.5}/₂ +24 ⁰/₄ +26 ⁰/_{3.5}
+30 ²/₂

Xc 304

f g S63W 15

+0 ³/₂ +6 ⁵/₆ +15 ^{1.5}/₂

g h S8W 25

+4 ^{2.5}/₁ +10 ^{5.50W 44}/_{2.5} +16 ⁰/₅ +25 ^{3/cor.}/₁ +25

h face S23W 14

+5 ³/_{1.5} +15 ²/₂

h + 9' is ledge N58W dips 76° S

Mabel Minto

402 Dr 1/3/24

b c N75W 49
+15 $\frac{1}{3}$ +30 $\frac{1}{2}$ +44 $\frac{1.5}{2.5}$ +49 $\frac{2}{1}$

c face N84W 36
+5 $\frac{3}{.5}$ +9 $\frac{2.5}{.5}$ +16 $\frac{0}{3.5}$
+23 $\frac{1}{2.5}$ +29 $\frac{2}{1}$ +36 $\frac{2.5}{.5}$

Mabel Mine

11/8/22

305 + 306 Drifts.

q. h SW 33

h 305 face N72W 17

+0 $\frac{3.5 \text{ cov}}{3 \text{ cov}}$ +2 $\frac{1 \text{ cov}}{4 \text{ cov}}$ +4 $\frac{1 \text{ cov}}{1 \text{ cov}}$ +6 $\frac{4 \text{ cov}}{.5}$

+12 $\frac{2.5}{1}$ +17 $\frac{2}{1}$

h 306 face S72E 10

+6 $\frac{1}{2}$ +10 $\frac{1.5}{1.5}$

Mabel Mine 12/1/22

305 DK

h face N66W 42

+20 $\frac{1}{3}$ +26 $\frac{5}{3}$ +32 $\frac{5}{2.5}$ +42 $\frac{2}{2}$

306 DK

h face S70E 37

+18 $\frac{2}{1}$ +19 $\frac{2}{2}$ +23 $\frac{3}{1}$ +30 $\frac{2.5}{1}$
+34 $\frac{2}{2}$ +37 $\frac{3}{2}$



W.D. 301

8/30/22

a b N44W 27.5

+0 1 +5 $\frac{6}{2}$ +9 $\frac{3}{3}$ +11 $\frac{2.5}{2}$ +17 $\frac{1}{3}$ +27 $\frac{2}{2}$

b c N39W 52

+10 $\frac{2.5}{1.5}$ +18 $\frac{4}{1.5}$ +25 $\frac{5}{6}$ +35 $\frac{4}{1.5}$ +52 $\frac{2}{1.5}$

c d N24W 31

+5 $\frac{1.5}{2.5}$ +15 $\frac{1.5}{3}$ +25 $\frac{2.5}{1.5}$ +31 $\frac{2.5}{2.5}$ W.D. 302

d face N70W 13

+0 $\frac{4}{2}$ +3 $\frac{6}{1}$ +5 $\frac{3.5}{1}$ +13 $\frac{2}{2}$ N.W. 3013

Sta (a) is N.W. cor. of shape.

W.D. 104

115

120

Sta. $\frac{1015}{M}$ a N74W 94

a b N87W 15

+10 $\frac{2}{2}$ +15 $\frac{2.5}{1.5}$

b face S70W 35

+3 $\frac{3.5}{1.5}$ +10 $\frac{4}{1.5}$ +12 $\frac{4}{1}$ +13 $\frac{2}{1.5}$ +19 $\frac{0}{3.5}$ +30 $\frac{2.5}{3}$ +35 $\frac{2.5}{2}$

OCT. 1, 1922 Mabel

20/15 DK

b c S67W 50
+20 $\frac{5}{3.5}$ +31 $\frac{3.5}{2}$ +40 $\frac{3.5}{0}$ +50 $\frac{3}{1.5}$

c d N81W 20
+6 $\frac{3}{1}$ +12 $\frac{1}{2}$ +18 $\frac{2}{1.5}$ +20 $\frac{1.5}{2}$

d face S68W 21
+5 $\frac{1.5}{2}$ +9 $\frac{1}{3}$ +15 $\frac{2}{2}$ +21 $\frac{3}{1}$

Xc 303

d e N8W 10'

e face N38E 31
+0 $\frac{2.5}{2.5}$ +10 $\frac{2}{2}$ +27 $\frac{2}{2}$ +31 $\frac{0}{4}$

Xc 304

d f N59W 32.5

+7 $\frac{2^{cor}}{3}$ +10 $\frac{0}{4.5}$ +32 $\frac{2.5}{2}$

f face S67W 16

+5 $\frac{4.5}{0}$ +10 $\frac{4.5}{.5}$ +16 $\frac{1}{2.5}$

Mabel Mine 1924

MABEL MINE SERIES
HOIST PLANS

4

1924

(254) Item 117 4 of 46

4840 0117

25 H.P. GASOLINE HOIST FOUNDATION PLAN, - 6 Tons.
AT HALIFAX. TO MABEL MINE

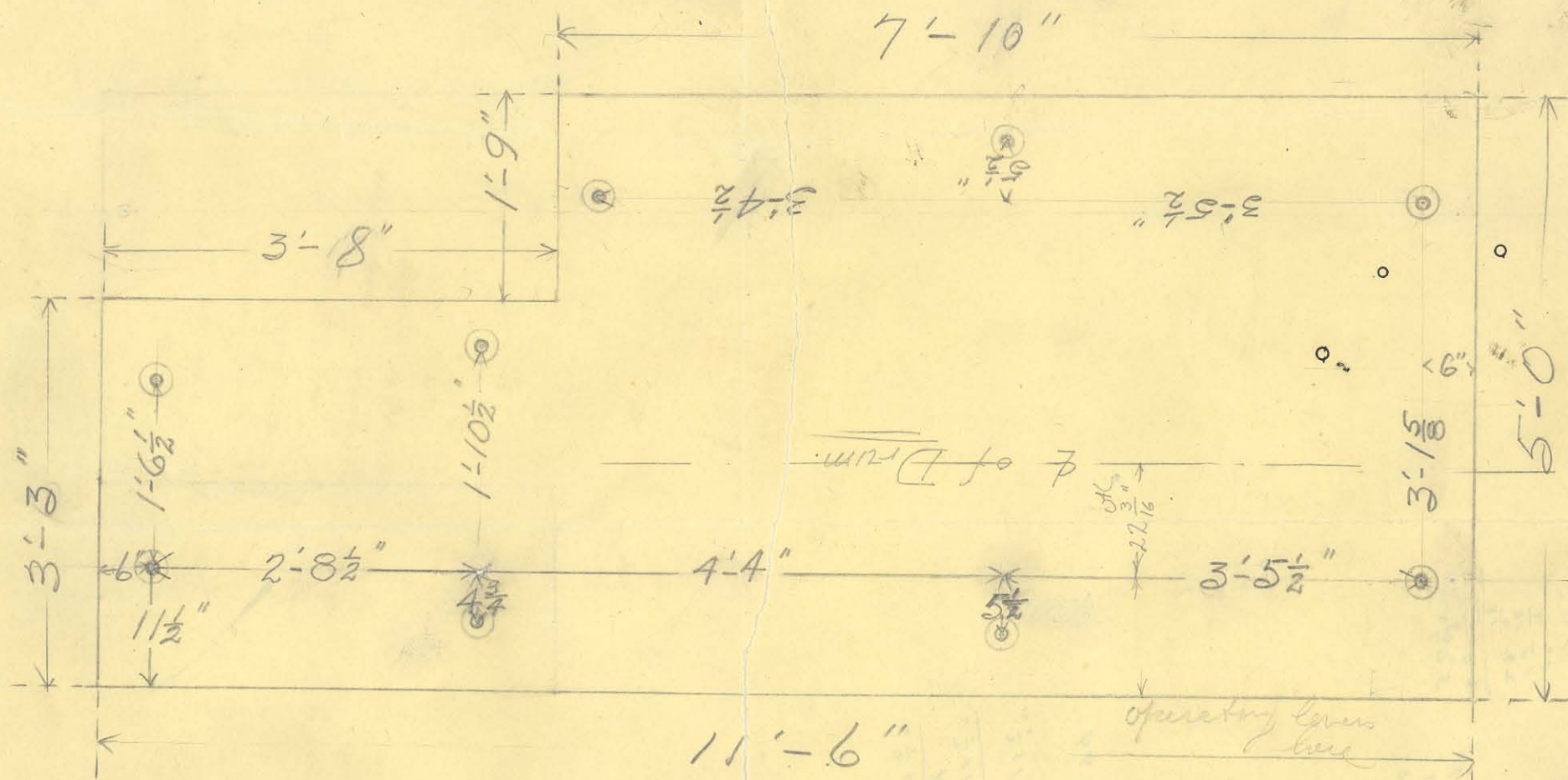

Concrete to project 8" above floor
All Anchor bolts 7/8 in.

This end faces shaft

$$36 \frac{36}{1}$$

$$\begin{array}{r} 11 \\ 12 \\ 15 \frac{7}{16} \\ 22 \frac{3}{15} \\ \hline 60 \frac{5}{1} \\ 5' 0 \frac{5}{1} \end{array}$$

$$36 \frac{26}{16}$$

$$19' 1''$$

$$3 \ 3$$

$$15' 10''$$

$$37 \frac{16}{16}$$

$$22 \frac{3}{15}$$

$$18 \frac{7}{16}$$

$$1' 10 \frac{1}{2}$$

$$8' 4 \frac{3}{4}$$

$$2' 3 \frac{3}{4}$$

$$1'$$

$$63.94$$

$$\begin{array}{r} 63' 11 \frac{1}{2}'' \\ 15' \\ \hline 48' 11 \frac{1}{2}'' \\ 28' 4'' \\ \hline 20' 7 \frac{1}{2}'' \end{array}$$

Foundation - Mabel Hothead
 Concrete to be 8" above floor
 All Foundation bolts $\frac{7}{8}$ in.

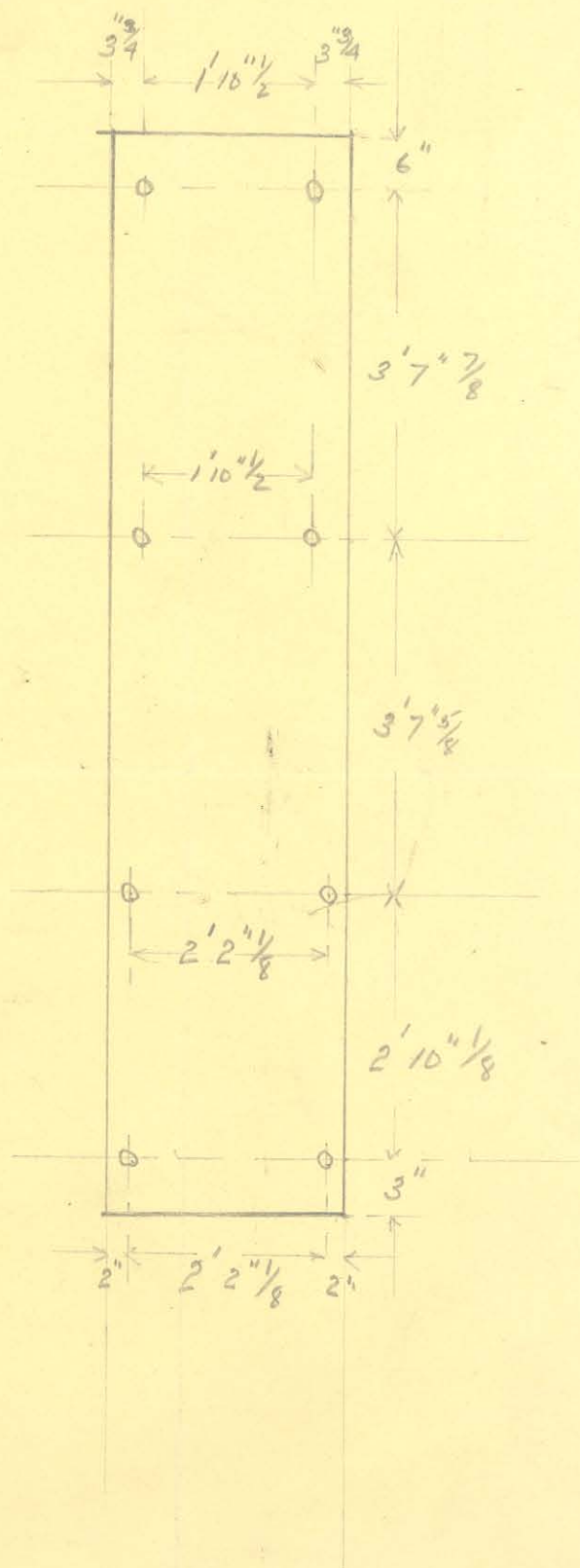

5 Mabel Mine Papers
claim - 1925

MABEL MINE SERIES	5
CLAIM PAPERS	
1925	

(254) Item 117 5 of 46

4840 0117

C E R T I F I C A T E O F L O C A T I O N

THE UNDERSIGNED hereby certifies that they have located a mining claim in the GARFIELD Mining District, County of Mineral, in the State of Nevada, on a vein, lode or ledge, known as the MABEL NORTH., and more particularly described as follows, to wit:

Beginning at the South East corner, which corner is identical with the North West corner of the Mabel No.1 lode, thence running S 82° 27' W, 1426.6 ft. to corner No.2, the South West corner; thence North, 600. ft. to the North West corner No.3; thence N 82° 27'E, 1426.6 ft. to the North East corner No.4; thence South, 600. ft. to the South East corner No.1, the place of beginning.

The discovery monument is situate at N 82° 27' E, 50. ft. from a point on the Westerly end line, which point is 300. ft. from the South West corner No.2.

The discovery work is situate at S 85° E, 7 1/3 ft. from the location monument, and consists of Open Cut 6' x 10' x 4' deep.

Each corner is marked by a 4x4 post 4 1/2 feet long, set 1-1/2 ft. in the ground, with a mound of earth and stone 3 ft. in diameter and 1 ft. high built up around same. There is also a 4x4 post similarly set, at the middle of each side line.

Date of discovery Oct 23-1925

The discovery work has been done and the location work completed since Oct 23 1925.

Dated Dec 14, 1925

West End Consolidated Mining Co., Locator

by, Geo. J. Barnett
Agent.

West End / Mabel 6
1927

MABEL MINE SERIES
MISCELLANEOUS PAPERS

6

1927

(254)

Item 117

6 of 46

4840 0117

Distribution of Mine Shovels used - March 1927

	Amount	To	Breaking develop	St.P.	HEP	Track Frame	Timber	Compressor	2nd Bunk	76 develop	W.E. Ext Bunk	Ext develop
Coal - Bitum	7500			7500								
Coal - B. S.	1000	1000										
Drill Parts	10000	10000										
Carbide	8250	8250										
Grease + Oils	2500	1000			1000			500				
Lumber + Wedges	25000		3000				7000		5000	2500	5000	2500
Miscellaneous	10000	8000				2000						
Nails	2500		500						500	500	500	500
Polis	15000		3000				3000		2500	2000	2500	2000
Powder Truss + Saps	81731		9048						13400	13995	28621	16667
Wire Rope	5000				5000							
	168481	28250	15548	7500	6000	2000	10000	500	21400	18995	36621	21667
			14944	1040					2978	1757	5853	1678
			14944	16588	7500	6000	2000	10000	500	24378	20752	23345

West End Consolidated Mining Co.

MINE

TONOPAH, NEVADA,

March

192 7

Following Material Used

West End Mill

(Insert Working Place Here)

1 Plate $\frac{1}{4}$ " X 4' X 10'

2075

1- Bale Waste

1840

5-lbs $\frac{3}{8}$ "-cut washers

35

3950

$$\begin{array}{r}
 415 \\
 \hline
 26.75 \\
 86 \\
 \hline
 411.86
 \end{array}$$
 (398)

LOMOBYN MEALDY

LOMOBYN MEALDY

LINE

AMERICAN CORPORATION

West End Consolidated Mining Co.

MINE

TONOPAH, NEVADA,

192

Following Material Used

(Insert Working Place Here)

10 gal. kerosene oil
~~2 hr. Line Shavers~~
1-16-value 12 A stoper

10 00

3 50

22.50

$$\begin{array}{r} 1.09 \\ 59 \\ \hline 1.68 \\ 6 \\ \hline 8 \end{array}$$

$$\begin{array}{r} 1.09 \\ 6 \\ \hline 6.54 \end{array}$$

$$\begin{array}{r} 59 \\ 8 \\ \hline 472 \end{array}$$

$$\begin{array}{r} 16.50 \\ 190 \\ \hline 18.40 \\ 7 \\ \hline 12880 \end{array}$$

West End Consolidated Mining Co.

MINE

TONOPAH, NEVADA, March 192

Following Material Used

Mabel mine

(Insert Working Place Here)

8-1" - Tees			84
8-1" - Elbows			60
2-1" X $\frac{3}{4}$ " - Bushings		161	07
2-1" X 1 $\frac{1}{2}$ " nipples			10
1- Keg 20 X 40 Penny Nails		10	06
2 - Cone Lense	✓	37	80
3 - bar bar hole	✓	22	50
12 - Bundas Wedges	✓		552
1 $\frac{1}{2}$ hr Lense Thomas			

Kings

4

4

4

4

4

4

4

4

4

36

Guant

6

6

12

6

12

6

12

8

12

80

West End Consolidated Mining Co.

MINE

TONOPAH, NEVADA,

March 29

1927

Following Material Used

Michel Mine

(Insert Working Place Here)

50 lbs Track Spikes for 8 lb. Rails	3	47
6-1" 45° Ells		48
10-1" Couplings	1	10
6- Picks	6	54
8- " Handles with wedges for	4	72
7 lb better waste	1	29
1 1/2 hr Time 7 hours		17 60

5.25
168

693
347

West End Consolidated Mining Co.

MINE

TONOPAH, NEVADA,

192

Following Material Used

(Insert Working Place Here)

1-8"-Small Bastard Files	19
2-14"- " " "	90
2-12"- " " "	69
1-14"-Large " " "	45
1-1/2" X 12" □ - " " "	34
1-1/2" X 12" O - " " "	25
1-8"-Shin Saw	20
4-1"-Brass Plug locks	160
8-1"-RR wheels	256
	718

$$\begin{array}{r} 18606 \\ 5 \overline{) 9001} \\ \underline{5000} \\ 4001 \end{array}$$

$$\begin{array}{r} 7530 \\ 2 \overline{) 1506} \\ \underline{1000} \\ 506 \\ 2 \overline{) 253} \\ \underline{200} \\ 53 \\ 2 \overline{) 265} \\ \underline{200} \\ 65 \\ 2 \overline{) 325} \\ \underline{200} \\ 125 \end{array}$$

LONGLEAF KENNY

NAME

MADE BY COMPTON & SONS CO.

March. 1927

MONTH

LEVEL

SHIFT

"76" Lease

WORKING PLACES

H. E. Ext.

Date	Break			Devel												Break			Devel		
	Pow'd	Fuse	Caps	Pow'd	Fuse	Caps	Pow'd	Fuse	Caps	Pow'd	Fuse	Caps	Pow'd	Fuse	Caps	Pow'd	Fuse	Caps	Pow'd	Fuse	Caps
1	28	42	7	265	288	48										230	318	53	375	402	47
2	190	192	32	270	282	47										285	372	62	75	84	14
3	257	342	57	195	204	34										41	72	12	280	324	54
4	80	126	21	95	102	17										326	480	80	360	360	60
5	85	108	18	145	162	27										315	516	86	180	148	28
6	495	720	120	270	288	48										230	276	46	100	96	16
7	140	168	28	50	54	9										50	76	12	359	340	60
8	154	192	32	164	198	33										90	138	23	284	306	51
9	30	48	8	230	234	39										250	366	61	2013	2080	350
10	105	264	44	1684	1812	302										280	378	63			
11	1564	2202	367													474	666	111			
12																335	408	68			
13																305	468	78			
14																128	186	31			
15																3339	4720	786			
16																					
17																					
18																					
19																					
20																					
21																					
22																					
23																					
24																					
25																					
26																					
27																					
28																					
29																					
30																					
31																					
Total																					

On Hand Ohio

9 Bx Powder ✓
 1700 ft Eclipse Fuse ✓
 1 c 4500 ft Bear " ✓
 7,880 Caps

On Hand H. E.

1 Bx Powder ✓
 700 Caps ✓
 400 ft Fuse

Mon Pitts
 Devel.

90 96 16
 90 96 16
 190 216 36
 190 198 33
 180 192 32
 350 340 60
 1090 1158 193

Powder March 1927

Breakup Development					
Monarch Pitto	1090	1158	193		
W. End Ex H	3339	4720	786	2013	2080
"76"	1564	2202	367	1684	1812
	4903	6922	1153	4787	5050
	4787	5050	845		
	9690	11972	1998		

Develop	1090 sticks powder @	8152	
	1158 ft fuse @	668	
	193 caps @	228	9048
W.E. Ext Bank	3339 sticks powder @	24972	
	4720 ft fuse @	2722	
	786 caps @	927	28621
W.E. Ext Develop	2013 sticks powder @	15055	
	2080 ft fuse @	1199	
	350 caps @	413	16667
"76" Breakup	1564 sticks powder @	11697	
	2202 ft fuse @	1270	
	367 caps @	433	13400
76 Develop	1684 sticks powder @	12594	
	1812 ft fuse @	1045	
	302 caps @	356	13995
			81731

	Powder	Fuse	Saps
On hand 4/28/27	550	17000	1190
Purchased March 1927	5850	90100	10025
	6400	107800	11215
Sold March 1927	1750	69000	1300
	4650	94200	9915
On hand 3/30/27	500	84200	8580
Used March 1927	4150	10000	1335

On hand 4/28/27	9625	11730	2237	23592
Purchased March	102220	56770	18850	177840
	111845	68500	21087	201432
Sold March 1927	30625	37800	2600	41775
	81220	59950	18487	159657
On hand 3/31/27	8750	53046	16130	77926
Used March 1927	72470	6904	2357	81731

P 07478844169
F 005766789124
C 00117967968

Pounds Tons Cans

1	200		1015
✓	500	1	2300
✓	400	1	2230
1	500	1	1425
✓	200	1	2090
1	300		1025
✓	500		2100
✓	500		2100
✓	400		2030
✓	500	1	2300
✓	300		1960
✓	200		1960
1	100	1	1145
✓	400	1	2230
1	200	1	1215
		1	200
1	200	1	1215
✓			1750
1	100	1	1145
✓	700	1	2440
1	100		945
1	200	1	1215
1	200		1015
1	100		945
35	6900	13	37995

30625

4220

26

37995

MINE STORES *march* 1917

	On Hand <i>Feb 28, 17</i>	Received <i>march 1917</i>	Total	On Hand <i>march 31, 17</i>	Used	Cr. Acct.	Sold
Candles							
Coal—Bitum	<i>347 24</i>		<i>347 24</i>	<i>272 24</i>	<i>75 00</i>		
Coal—B. S.	<i>3 55</i>	<i>27 15</i>	<i>30 70</i>	<i>20 70</i>	<i>10 00</i>		
Drills and Parts—	<i>8201</i>	<i>111 09</i>	<i>193 10</i>	<i>89 60</i>	<i>100 00</i>	<i>3 50</i>	
Cochise							
Dreadnaught							
I-Rand							
Stoppers							
Sullivan							
<i>Carbide</i>	<i>22 50</i>	<i>150 00</i>	<i>172 50</i>	<i>67 50</i>	<i>82 50</i>	<i>22 50</i>	
D. Sharpener Pts.							
Drill Steel	<i>212 23</i>		<i>212 23</i>	<i>212 23</i>			
Gasoline and Dist.							
Grease and Oils	<i>84 62</i>		<i>84 62</i>	<i>49 62</i>	<i>25 00</i>	<i>10 00</i>	
Lumber and Wedges	<i>1289 35</i>		<i>1289 35</i>	<i>1033 83</i>	<i>250 00</i>	<i>5 52</i>	
Mine Cars							
Miscellaneous	<i>1288 79</i>	<i>349 89</i>	<i>1638 68</i>	<i>1464 26</i>	<i>100 00</i>	<i>62 42</i>	<i>12 00</i>
Nails	<i>78 87</i>	<i>12 05</i>	<i>90 92</i>	<i>55 86</i>	<i>25 00</i>	<i>10 06</i>	
Oil—Fuel							
Pipe—Air							
Pipe—Wrought	<i>19 67</i>		<i>19 67</i>	<i>19 67</i>			
Poles	<i>791 84</i>		<i>791 84</i>	<i>641 84</i>	<i>150 00</i>		
Powder, Fuse & Caps	<i>235 92</i>	<i>1728 40</i>	<i>2014 32</i>	<i>779 26</i>	<i>817 31</i>	<i>37 80</i>	<i>379 95</i>
Rails & Fastenings	<i>170 53</i>		<i>170 53</i>	<i>167 06</i>		<i>3 47</i>	
Truck Parts							
Washer Parts							
Wire Rope	<i>771 69</i>		<i>771 69</i>	<i>721 69</i>	<i>50 00</i>		
<i>Elv Buckets</i>	<i>181 82</i>		<i>181 82</i>	<i>181 82</i>			
	<i>5580 63</i>	<i>2428 58</i>	<i>8009 21</i>	<i>5777 18</i>	<i>1684 81</i>	<i>155 27</i>	<i>391 95</i>
					<i>155 27</i>		
					<i>1840 08</i>		

march 11 5 27
march 11 5 27

MABEL MINE INVENTORY--

Mar. 1-1927. Purchased- Used. April 1-1927

					No. B.
6x6x18	37		11		26
4x4x16	26		14		12
2x12x16	6	30	26		9
2x12x18	0				
2x8x16	9	26	9		26
1x12x16	34		10		24
Round 6"	120'		120ft		
1x4x16		20	11		9
2x4x18		6	5		1
Cumbride		600			
Caps	700	7	590	110	11.80
Fuse	4600ft.	6000	3900 636	6600ft.	24.57
Powder	150#	600#	640# 145	90#	124.80
					161.17
Fuel Oil	13 Drums	13 1/2 drums	9 { 5 Comp. 2 B. House 2 Bunk House		4 Drums

Distribution of Lumber. - Development 20%
Stoping 80%

✓ { Powder } Development 65%
Caps } Stoping 35%
Fuse }

Stores on hand should be 249.11
On hand as per list 109.44
overcharged 139.67

Mabel Mine— Labor Distribution April 1927

Supervision	\$ 183 11
Compressor	56 25
Hoist	135 00
Mine Hauling	33 63
Surface Plant	39 31
Boarding House	130 84 ✓
Tools	40 82
Striping	449 79
Development	544 49
	<hr/>
	1613 22
	130 84
	<hr/>
	1482 38

MABEL MINE INVENTORY—

April 1-1927 Purchased April Used April May 1-1927

			From Requis.		
6x6x18	26	—	(11)	14 ✓	12
4x4x16	12	—	(9 1/2)	4 ✓	8
2x12x16	9	?	(20)	—	24
3x12x18		12		—	12
2x8x16	26	—	(8)	13 ✓	13
1x12x16	24	—	(2)	4 ✓	20
6" Round	1—	?	(20 ft)		70 Pieces
1x4x16	9	—		—	9
2x4x18	1	—		—	1

Carbide Caps.	110	5 Cans. 500#	2 Cans 200# ✓	3 Cans 300#
Fuse	6600 ft.	1000	(5 1/2) 610	500.
Powder.	90#	500# 25% 200# 40%	4100. 63# Used 15 sticks to 430# 1950	2500 ft. 25% — 200# 40% — 90#
Fuel Oil. Large	4	13 1/2 in in angle	(B. House 5 Small Compressor 1 large 8 small)	✓
Small		72 Drums.	(Bunk House 2 Small)	3 57

Distribution of Lumber { Development — 30%
Stopping — 60%
Surface Plant — 10%

✓ { Powder } { Development 80%
Caps } { Stopping 20%
Fuse }

Mabel Mine Progress - April - 1927

Dr	332	10 ft.
R	334	29 ✓
Dr	410	62 ✓
R	327 STB	11 ✓

37
19
31
25
<hr/> 112

Total.

112 ✓

MABEL MINE SERIES
MISCELLANEOUS PAPERS

7

1928

(254)

Item 117

7 of 96

4840 0117

MINE STORES

July

1928

	On Hand 6/30/28	Received July 1928	Total	On Hand 7/31/28	Used July 1928	Cr. Acct. July 1928	Sold July 1928
Candles	2 00		2 00	2 00			
Coal—Bitum	2 70 00		2 70 00	2 00 00	70 00		
Coal—B. S.	4 40 00		4 40 00	3 50 00	6 00	Mabel 3 00	
Drills and Parts—	2 10 00		2 10 00	1 80 00	3 00 00		
Cochise							
Dreadnaught							
I-Rand							
Stoppers							
Sullivan							
Carbide	7 00	70 00	77 00	14 00	63 00		
D. Sharpener Pts.							
Drill Steel	4 83 5		4 83 5	2 08 0		Mabel 2 7 65	
Gasoline and Dist.							
Grease and Oils	9 00 00	12 00	10 20 00	7 50 00	2 20 00	comp 5 00	
Lumber and Wedges	3 00 00	2 51 84	2 81 84	3 00 00	2 51 84		
Mine Cars							
Miscellaneous	6 15 73	9 43 3	7 12 06	5 85 30	1 12 06	Mabel 14 70	
Nails	1 01 7		1 01 7	1 01 7			
Oil—Fuel							
Pipe—Air							
Pipe—Wrought	1 5 43		1 5 43	1 5 43			
Poles	1 50 00		1 50 00	1 00 00	30 00	JB 20 00	
Powder, Fuse & Caps	7 9 47	3 98 60	4 78 27	8 23 7		JB 41 86	3 54 04
Rails & Fastenings	1 47 06		1 47 06	1 47 06			
Truck Parts							
Washer Parts	5 21 69		5 21 69	5 21 69			
Wire Rope	1 81 82		1 81 82	1 81 82			
	2 442 92	8 28 77	3 271 69	2 220 64	5 84 90	1 12 11	3 54 04
					112 11		
					696 01		

Mill Stores August 1928

	On Hand 7/31/28	Purchased Aug. 1928	Total	On Hand 8/31/28	Used Aug. 1928	Cr. in Account	Sold
Belting	10003		10003				10003
Brick & Fire	22619		22619	22619			
Elect & Motors	54742		54742	54742			
Gasoline	17941		17941	7070	Truck 413 Auto 2338		8120
Miscellaneous	94265		94265	85843			8422
Oil - Fuel	 						
Oil Motor	6068		6068	5840	Truck 70 Auto 35		123
Truck Parts	7700		7700	7550			150
	213338		213338	183664		2856	26818

WEST END CONSOLIDATED MINING COMPANY

KABEL MINE OPERATIONS - MAY - 1928

	<u>MAY 1928</u>	<u>5 MONTHS TO DATE</u>	<u>SINCE BEGUN</u>		
	No Ore Shipped During Month of May, 1928	<u>Total</u>	<u>Per Dry Ton</u>	<u>Total</u>	<u>Per Dry Ton</u>
Dry Tons		525		3975	
Oz. Gold		450.865	1.367	5010.477	1.261
Oz. Silver		19772.82	60.84	532234.65	96.31
Pounds Lead		5534	17	429495	108
Total Gross Value		21256.86	65.41	403828.98	101.64
Smelter Tread & Ded.		4120.49	12.68	77635.91	19.54
		<u>17136.37</u>	<u>52.73</u>	<u>526193.07</u>	<u>82.10</u>
Freight Charges		789.19	2.43		
Net Smelter Ret.		<u>16347.18</u>	<u>50.30</u>		
Hauling to R.R.		1651.69	5.08	51919.82	13.07
		<u>14697.49</u>	<u>45.22</u>	<u>274275.25</u>	<u>69.03</u>
Royalty paid Lums.		2921.17	8.99	2921.17	.73
Net Returns		<u>11776.32</u>	<u>36.23</u>	<u>271354.08</u>	<u>68.30</u>
Royalty applied on payment purchase price of property				46884.83	11.80
Net Balance				<u>224469.25</u>	<u>56.50</u>
Total Operating Expense	1367.58	10532.50	32.41	292460.43	73.61
Less Ore Shipments		<u>11776.32</u>	<u>36.23</u>	<u>272572.55</u>	<u>68.61</u>
Net Profit	1367.58	1243.82	2.82	19887.90	5.00

Kabel Mine Trial Balance
as of 5/31/28 1243.82

DEVELOPMENT

	<u>Feet</u>	<u>Feet</u>	<u>Feet</u>
Shaft Sinking	20	100	566.5
Crosscutting	42	58	1228
Drifting		68	5044
Raising		106	2490
Winze			211
Extra Excav.			112
	<u>Labor</u>	<u>Supplies</u>	<u>Total</u>
Shaft Sinking Costs	1006.75*	230.67	1237.42**
Total Cost of Sinking Shaft 100 feet.	2151.75	1643.20	3994.95

*Includes \$631.50 bonus paid shaft sinking crew.

** Shaft sinking costs not included in operating costs.

WEST END CONSOLIDATED MINING COMPANY

EXECUTIVE OFFICE, TONOPAH, NEVADA

F. C. NINNIS, PRESIDENT AND TREASURER

H. D. BUDELMAN, VICE PRESIDENT AND GENERAL MANAGER

Motel Mines

~~TONOPAH, NEVADA~~

July, 1st. 28.

Tom:-

Below is a statement of contracts on 602 W.D. & 603 E.D. All four men were in together. We allowed them two & one half shifts for timbering. McAlister & McGilvery were paid one shift each the first half on contract.

602 W.D. footage on contract 55 feet six inches
603 E.D. " " " 45 " Three "
Total 100 feet 9 inches at \$3.75 per.ft. \$377.82

Carried on pay roll.

First half June.

McGilvery	1 shift at	***-----	\$5.75	} Paid.
McAlister	1 " "	-----	5.75	

Second Half June. Pay Roll

Marling	12 & 1 half shifts at	\$5.75	71.87
McGilvery	12 & 1 half shifts	" "	71.87
McAlister	12 & 1 " "	" "	71.87
Sefton	11 & 1 " "	" "	66.12
Total			\$293.23

Bonus over pay roll \$84.59 to be split equally among four men. I am giving Joe Sefton time checks for the amount on pay roll and three days for this month. He will call at office for June bonus. *\$ 21.15*

Send the rest of the bonus checks out with the pay roll.

Homer.

HABEL (500-600)

4/2/28

Shaft Contract.

12⁰⁰ per ft., labor only -
drilling and mucking 100'.

45⁰⁰ per month board.

6²⁵ per day for contractors,
and balance to contractors
on completion of work.

Less Crane, Shortie Lambert
Gunner Olson, Arthur Gubseb.

Final Results.

Contractors - 1256.50 = \$ 13.96 Av. pay
No. shifts - 90 per shift.

Total Cost = $\frac{3994.95}{100}$ = \$ 39.95 per
Feet. = foot.

Cost details

Supervision	275.00	2.75
Blacksmith & Twp	307.75	3.078
Timber framing	139.50	1.395
Camp & Hoisting	589.34	5.893
Labor Sinking	1256.50	12.565
Misc. Handling	194.91	1.949
Explosives	119.70	1.197
Misc. Supplies	457.00	4.570
Lumber & Nails	500.00	5.000
Office	100.00	1.000
Ind. Ins.	55.75	.553
	<hr/> 3994.95	<hr/> 39.95

Labor Est - Mabel Sh.

4 Men in shift @ 6.50 + time and a half for Sat. — @ 6.50	26.00
2 Top men @ 6.00	12.00
1 Timber framer @ 6.50	6.50
1 Blocksmith (G. M. Smith)	6.50
Horolman 6.50	6.50
Add for time & a half. Sat. day.	4.50
Actual wages.	62.00
55.1%, Sur. Ins. 7.2%, Nor. Un. Conf. 2.7 total 10.9%	6.75
Total Labor for day.	68.75

Est. - repair outhaul hoist and
compressor.

new Cable $\frac{7}{8}$ " @ 20	19 knots/hr. 1000'	300.00
2" Pipe		200.00
1" Pipe		
Signal Cable. $\frac{1}{2}$ "	1000'	100.00
2 Drills.		450.00
Steel 2.05 # ft. $\frac{1}{2}$ "	600' @ 20¢	120.00

To net sheet.

856 - Lens. 200' S and SW
backhead.

900. - No sta but note last line.

1166 - Big Alder 04 stage
centrifugal, under water.
1000 gal min.

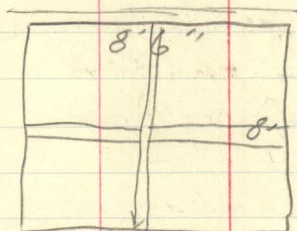

Timber Est. 100' Mabel Mine
shaft - 600 - 700.

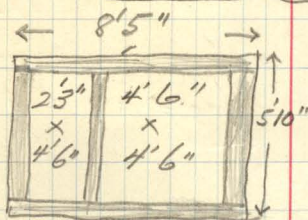

8x8 - ball and end
plates.

8x8 - Posts

4x8 - Guides

2x12 - lagging

Hard ladder stak

2x4 - 18' long.

Per Set.

2 - 8x8x16 - 2 ball P. 2 end pl (2x19' ball) 170

1 - 8x8x18 - 4 Posts 96

1 - 4x8x4'8" (16' timber make 3) 13

8 - 2x12x16 - 24 pcs lagging 256

2 - 1x1x12 - Strips 2

1 - 2x12x3 - Landing way 3rd set 6

1 - 2x4x12 - ladder stak 8

1 - 1x4x7 - " " 2 1/2

1 - 4x4x10 - Guides

1 Bundle wedges each set.

Extra 8x8 and 2x12 for blocking. 60

Total Timber

40 - 8x8x16 - End Plates	3413
20 - 8x8x18 - Posts	1920
7 - 4x8x16 - Scissors	300
10 - 8x8x16 - Extra blocking	854
160 - 2x12x16 - Logging	5120
8 - 2x12x16 - Extra	256
12 - 2x12x12 - Landings	48
40 - 1x1x12 - Strips	40
14 - 2x4x18 - Ladder material	168
10 - 1x4x14 - " "	47

200 running feet guides 4x4 $\frac{267}{12433}$
30 Bundles bridges
Log Screws

(Note. if 6x6 used for posts (108)
lumber 11593 Bd. feet.

Logging

11000 ft.

520 - for 100' ch. 10 ft in ch.

11000 - 1100 for logging.

Nathan S. Olsen & Son.

William J. Beisel.

25 Santa Fe
L.A.

7-9-41

Timber & Cost Estimate, Lumber from Ton. Western shaft.

6' sets, use same posts.

For 100' of shaft.

34 Wall plates, figure 9' long

$$8 \times 8 \times 9' = 48 \text{ bd ft.}$$

1632

34 End plates, figure 8' long

$$8 \times 8 \times 8' = 42.6 \text{ bd ft.}$$

1448

68 Posts, figure 5' long

$$8 \times 8 \times 5' = 26.6 \text{ bd ft.}$$

1809

520 Lagging, figure 5' long

$$2 \times 12 \times 5 = 10 \text{ bd ft.}$$

5200

Extras

5 Wall plates, $5 \times 48 =$

240

5 End " 5×42.6

211

50 lagging 50×10

500

11040

Ladders.

16 - $2 \times 4 \times 16$

171

10 - $1 \times 4 \times 14$

47

30 Bunch bridge.

218

Guides

240 linear ft. 4×4

320

544 bld ft 2×4

~~6 Pcs $4 \times 8 \times 16$ ft.~~

6 Pcs 4×6 16 ft.

Cost: 100'

11040 - Gr. W. Sh - @ 25 ⁰⁰	276.00
218 - New ladder @ 65 ⁰⁰	14.17
320 - Guides (Used) @ 50	16.00
	<u>306.17</u>
Hauling @ 50	60.00
	<u>366.17</u>

200' = 2 x 366.17 = 732.34

New figure. 7-11-41

✓ 800 H. fut 8 x 8 S @ 35	504.40
✓ 200 " " 2 x 12 S @ 30	126.00
Ladders	20
Guides	25
Donkeys	10
	<u>415.40</u>

Hauling 60. —
475.40
Cont deliv'd at
next shift, 100 fut @ 65 actual.

West End Consolidated Mining Co.

MINE

TONOPAH, NEVADA,

1928

Following Material Used

(Insert Working Place Here)

12 Pieces 100 lbs $\frac{7}{8}$ " - Hex Hollow steel	14	50	✓
50 lbs waste	10	00	✓
8 " - Hire clay		20	✓
	24	70	

12064
12064

2000 / 25.000 9.0 / 22-
2000
5000

.04 25-
2000
25.0000

West End Consolidated Mining Co.

MINE

TONOPAH, NEVADA,

192

Following Material Used

(Insert Working Place Here)

11 Pieces 90 lbs $\frac{7}{8}$ " Hex Hollow steel	13.05
240 lbs - Blacksmith coal	3.00
75 " - Track spikes for 8 lbs	4.50
	20.55

Mabel Mine Shaft Sinking Data 500 to 600 Levels

4-2-28

\$12 per foot, labor only, drilling
and mucking, 100'

\$45 per month board

\$6.25 per day allowed for contractors,
balance payable on completion.

Jess Crane, Shortie Lambert, Gunner
Olsen, Arthur Gubsch.

Final Results:

Contractors - $\frac{\$1256.50}{90} = \13.96 Av.
No. Shifts

Total Cost $\frac{3994.95}{100} = \$39.95 \text{ Av.}$
Feet

Cost Details

		<u>Per Ft</u>
Supervision	\$ 275.00	\$ 2.750
Blacksmith and Top	307.75	3.078
Timber Framing	139.50	1.395
Comp. and Hoisting	589.34	5.893
Labor, Sinking	1256.50	12.565
Misc. Hauling	194.91	1.949
Explosives	119.70	1.197
Misc. Supplies	457.00	4.570
Lumber and Wedges	500.00	5.000
Office	100.00	1.000
Ind. Insurance	55.25	.553
Total	<u>\$3994.95</u>	<u>\$39.950</u>

Powder

III III
III III
III III
III

33
50
1650

Fuse

III III
III III
III III
III III
III III
III III
III III

6700

Caps

III III
III I

16

$$\begin{array}{rcl} 33 \times 8.50 & = & 280.50 \\ 6700 \times .63 & = & 42.21 \\ 16 \times 1.88 & = & 30.08 \end{array}$$

352.79

37.00

1750

2050

July 1928

1200ft

1900*

63
8

504

1.88
1 1/2

94
188
2.82

63

188

8.50

$$33 \times 8.50 =$$

$$67.00' \times 1.63 =$$

$$16 \times 1.88 =$$

$$280.50$$

$$42.21$$

$$30.08$$

$$352.79$$

$$4 \times 8.50 =$$

$$8.00' \times 1.63 =$$

$$1.50 \times 1.88 =$$

$$34.00$$

$$5.04$$

$$2.82$$

$$41.86$$

July 30
on hand

Powder Box 4

Fuse ~~40~~ 4400 ft

4536

Caps 1800

2066

Motel Mine.

PROGRESS FOR MONTH OF JUNE, 1928.

603 E.D. 64' 3 "

602 W.D. 73'

TIMBER & POWDER USED.

603 E.D.

Powder 200 lb. fuse 930 ft. caps 155

150 running ft. 6 x 6

225 " " 2 x 12

50 " " 2 x 4

3 bundles wedges

602 W.D.

Powder 230 lb. fuse 1060 ft. caps 177

220 running ft. 6 x 6

320 " " 2 x 12

110 " " 2 x 4

4 bundles wedges.

July

Powder 4 Bat

Caps 150

Fuse 800 ft

8046 X 0 Z B

J Bartell

4840 0117

MABEL MINE SERIES		8
LAUCASHIRE MINE PAPERS	1929	
MABEL TRESPASS CASE	1947	

(254)

It. - 117

8 of 46

TONOPAH SEVENTY-SIX CONSOLIDATED MINING CO.

Farmers & Merchants National Bank.

Tonopah, Nevada,
May 10, 1929.

W. J. Harris, Vice President,
Farmers & Merchants National Bank,
Reno, Nevada.

Dear Mr. Harris:-

The following report of conditions in the lease workings on the Lancashire claim cover the month of April, 1929.

Progress during April amounted to approximately 65 feet, 30 feet of raising and 35 feet of drifting. Mr. O'Connell, who is in charge of the work, has failed to send in his regular progress statement so far as of April 30th, so the development footage figures are not exact, although reasonably so.

A total of 52 1/2 shifts of underground work was performed by the Tonopah Seventy-Six Consolidated Mining Company in the Lancashire claim during the month of April.

Since the date of our last report the East Drift passed into a crushed zone and what quartz showed was low grade. For this reason the drift was temporarily discontinued and a raise started near the center of the ore shoot. The vein became low grade after the first round and continued so to a height of 20 feet, where a flat fault was cut. This fault displaced the vein about 5 feet south, with improved values above the fault. We now have the vein exposed for 10 feet above the fault, with average good ore for this distance. Samples from the face of the raise were as follows; west side 10" - \$53.11, east side 10" - \$189.20.; these samples being taken by the writer on May 4th.

Yours very truly,

General Manager.

HDB:B

52 1/2 V.G.

Tonopah 76

Tonopah, Nevada,
June 6, 1929.

W. J. Harris, Vice President,
Farmers & Merchants National Bank,
Reno, Nevada.

Dear Mr. Harris:

The following is a report of conditions in the lease workings on the Lancashire claim covering the month of May, 1929.

Progress during May amounted to 25 feet, all as intermediate drifting from the raise mentioned in our report dated May 10th. This work failed to open much ore, the shoot being short and cutting off against an east dipping fault on its upward course. This development has been very disappointing so far, and ore tonnage mined is relatively small. While there is still some ore of stopable grade above the level, we have temporarily discontinued this work in order to start a winze from the 300 Level, in an attempt to prove the ore shoot in that direction, preliminary to starting work from a lower level, probably the 500. Since June 1st six feet progress has been made in this winze, with the vein showing better in both size and value as the work advances.

A total of 35 shifts of underground work was performed by the Tonopah Seventy-Six Consolidated Mining Company in the Lancashire claim during the month of May.

For convenience in referring to the workings we have numbered them as follows; Drift 332, Raise 336 and Winze 337. The intermediate drifts have been given no number, they were driven off of Raise 336 and can be identified by that number.

Yours very truly,

General Manager.

HDB:B

Underground shifts

Clark - 28 1/2

Homer - 6 1/2 / 35 Total

} 143 1/2 To Date.

XXXXXXXXXX
XXXXXXXXXX

Tonopah, Nevada,
October 9, 1929.

W. J. Harris, Vice President,
Farmers & Merchants National Bank,
Reno, Nevada.

Dear Mr. Harris:-

The following is a report on lease work performed in the Lancashire claim during the month of September, 1929.

A total of 90 underground shifts were performed in the Lancashire claim during the month of September, and progress amounted to about 30 feet.

Nothing of any importance was developed during the month, although the streak being followed to the east of the Menetti shaft by subleasers has shown some improvement. These subleasers plan to ship a small car some time before the middle of this month, of ore which they estimate will run about \$100.00 per ton.

Enclosed herewith find Assay Certificates on both original and duplicate samples on Farmers & Merchants National Bank Lot No. 1, also Utah Ore Sampling Weight and Moisture Certificate for same lot. You will note that on the assay certificate marked "Orig." we have inserted pencil figures above the typewritten ones; these are the smelter assays on the same sample, and settlement is made on the average of the two. The gross value of this 16 ton lot was \$76.38 per ton, of which \$48.99 is in gold and \$27.37 in silver, which is about what we figured it should run.

Yours very truly,

General Manager.

1st month of 2nd period

HDB:B	<i>Tham mabel shift</i>	-	<i>12</i>	<i>shifts</i>
Encls.	<i>Subleasers</i>	-	<i>78</i>	<i>"</i>
	<i>Total</i>	-	<i>90</i>	<i>"</i>
	<i>Previous</i>	-	<i>371</i>	<i>"</i>
	<i>Total to date</i>	-	<i>461</i>	<i>"</i>

Tonopah, Nevada,
August 8, 1929.

W. J. Harris, Vice President,
Farmers & Merchants National Bank,
Reno, Nevada.

Dear Mr. Harris:

The following is a report of conditions in the lease workings on the Lancashire claim covering the month of July, 1929.

Information relative to footage progress has not yet been received, although more than ordinary was accomplished during July. The 337 Winze was sunk to a depth of around 27 feet, and an east intermediate has been driven approximately 25 feet on the vein. So far no shipping values have shown in this work which has proved very disappointing. In addition to this 300 level work we have driven an intermediate drift east from a stope raise of the West End, about 40 feet above the 500 Level. This work has disclosed a small tonnage of low grade ore in which gold values predominate, with good possibilities as the work advances. We have leased the ground in vicinity of the Vonetti shaft and there are two men at work on the 100 Level. They have taken out a few tons of fair ore and are now engaged in doing some development work, in an attempt to solve fault problems.

A total of 95 underground shifts were spent in the Lancashire claim by the Tonopah Seventy-Six Consolidated Mining Company during the month of July.

Yours very truly,

General Manager

HDB:B

File. { TONOPAH SEVENTY-SIX CONSOLIDATED MINING CO.
Farmers & Merchants National Bank

Tonopah, Nevada.
April 9, 1929.

W. J. Harris, Vice President,
Farmers & Merchants National Bank,
Reno, Nevada.

Dear Mr. Harris:-

The following report of conditions in the lease workings on the Lancashire claim is in accordance with Article 15 of lease dated February 4, 1929, between J. H. Miller, W. J. Harris, W. V. Richardson and J. E. Adams and Tonopah Seventy-Six Consolidated Mining Company.

Progress to the end of March amounted to 80 feet, with a total of 56 underground shifts performed during that month.

The progress was all drifting, on the 300 Level from the Mabel shaft, designated as 332 Drift. With the exception of one small fault, with a displacement of a few feet to the south, the vein was continuous in the drift. Values were nominal except for 20 feet near the face of the drift, along which distance is exposed an average of 4 inches of ore of shipping grade, and from which assays of from \$40 to \$200 per ton across this width were obtained. This ore shoot is practically under and in line with the Venetti shaft and about 140 feet below the bottom level from this shaft.

The drift is being continued at present but we expect to start a raise on the ore shoot around the middle of the month of April.

56 U.G.
Conditions appear favorable. The ore is oxidized in character, carries some lead, and is in every way similar to the ore mined in other parts of the immediate vicinity. The ore width given does not indicate the width of the vein, which shows about 12 inches of low grade quartz in the hanging wall of the ore. The following are typical samples; No. 111, taken March 27th, 4" wide by 2 feet along the drift, Gold \$51.20, Silver \$87.49, Lead 43.5%. No. 113, taken March 28th, 4" wide by 3 feet along the drift, Gold \$40.00, Silver \$30.91, Lead 25.4%. You can readily see that if this grade holds out it will make good shipping ore.

Yours very truly,

General Manager.

HDB:B

-2- J. W. Sherwin

in the Great Western and this vein has not been traced to the lower tunnel level, although at one place it is only 15 feet or so above. The vein at this point seems to flatten. I did not get into the upper workings of the Great Western on account of lack of time. There are several miles of underground workings on these two veins and it will take some little time to get an idea of what is there. To examine it with care would require a survey, there being no suitable maps at present, and then some sampling and geological study; probably two to three weeks' work.

It is rather difficult for us to do the work as we are especially busy here at the present time. Mr. Marsh is at the Mabel Mine and will be occupied there for the better part of the next two or three weeks and then will be needed here to aid in surveying.

Both the Atherton and Great Western are undoubtedly worth spending a little time and money on for examination. There is considerable surface work on the other claims included in Mr. Richardson's option which should be looked into.

I will have Mr. Atkinson make out an assignment covering Mr. Richardson's option. Mr. Richardson has said that he would write you regarding commission that he arranged with the owners. Mr. Richardson has been sick with tonsillitis and is out today for the first time in almost a week. The whole town is full of la grippe, 'flu, tonsillitis, etc. etc. This all seems rather out of place as the weather is ideal; not cold and very little wind, mostly sunshine.

We are starting to move the Polo equipment tomorrow. Mr. Marsh is now putting in the concrete foundation for the compressor at the mine. The contractor on the "Mabel" is cutting out for a station and will start the shaft by hand as the compressor will likely not be ready for about three weeks.

Yours very truly,

HDB:R
Enc.

MINE SUPERINTENDENT.

Oct. 6, 1921.

Mr. J. W. Sherwin
Gen. Mgr. West End Cons. Mng. Co.
Syndicate Bldg.
Oakland, Calif.

Dear Mr. Sherwin:

Enclosed find copies of claim map of the Garfield claims showing relation to the Mabel Group; also 300 scale map showing roughly some of the workings on the Atherton and Great Western veins; also section in plan of vein through the Atherton and Great Western stopes. I have no idea how near up to date these maps are and Mr. Gregory could give us no further information. One thing is certain, they are not up to date. I obtained these copies from Spencer & Company, Surveyors in Mina who just happened to have them in their files. Spencer says that he has never done any underground surveying on the Garfield although he has located the corners of the patented claims within recent years. Mr. Gregory has been unable to make up any maps at all. So far as I know, he had none while he was on the ground so it may be possible that there are none.

Regarding the Garfield mine examination, I went down there a week ago Monday accompanied by Mr. Richardson and returned Tuesday. Mr. Archie Farrington, the man who is supposed to have made the real money out of the Garfield, was there at that time; also Gregory and Harry McNamara. These latter are probably making an attempt to influence Farrington to put some money into development on the Iron Horse Claim, which you will note on the enclosed map end-lines the Atherton claim only 100 feet from the winze in the main tunnel. Gregory and Miller did not include the Iron Horse claim in Mr. Richardson's option. We got very little information from Farrington, he being unable physically to wander around much. It has been so long since he was on the ground, that without going underground, he could not tell us much of value.

Mr. Gregory went through the Atherton lower tunnel and the first one above this lower tunnel with us, but without a survey and sampling, it is not possible to tell much about it.

It appears that the greatest production has been

4

Lancashire

1929

Gorfield
(Mabel Group)

XX 1947 trespass
case, Mabel

Mabel Mine lease
1933-5 9

MABEL MINE SERIES
CORRESPONDENCE: LEASE & SALE
1933 - 1935

9

9.446

(254) Item 117

4840 0117

CHURCHILL COUNTY—
H. W. SAWYER
CLARK COUNTY—
FRANK M. RYAN
DOUGLAS COUNTY—
W. F. DRESSLER
ELKO COUNTY—
JOHN E. ROBBINS
ESMERALDA COUNTY—
W. H. KEENAN
EUREKA COUNTY—
EDGAR SADLER
HUMBOLDT COUNTY—
PHIL TOBIN
LANDER COUNTY—
NOBLE H. GETCHELL

NEVADA



STATE LEGISLATURE
THIRTY-SEVENTH SESSION

Senate Chamber

CARSON CITY

February 1, 1935

LINCOLN COUNTY—
L. L. BURT
LYON COUNTY—
GEORGE FRIEDHOFF
MINERAL COUNTY—
J. H. MILLER
NYE COUNTY—
W. A. MARSH
ORMSBY COUNTY—
IRA L. WINTERS
PERSHING COUNTY—
W. W. CARPENTER
STOREY COUNTY—
WILL COBB
WASHOE COUNTY—
JOHN BERNARD FOY
WHITE PINE COUNTY—
L. C. BRANSON

Mr. H.D. Buddleman,
West End Cons. Mines Corp.,
Tonopah, Nevada

Dear Mr. Buddleman:

I was pleased to learn that you
will be willing to give us an option.

In making the option, you can
put the price at \$75,000, according to your
terms stated in your letter.

If you have any bullion reports,
production and descriptive data at your disposal,
would it be possible for you to forward same
to me? Anything that might help in the sale of
the mine, because I have recently had another re-
quest from the parties that I have interested,
asking about the option and ectra.

I certainly hope that I can put
this over and I am going to put my earnest efforts
into making a deal.

Yours very truly,

J.H. Miller
J.H. Miller.

JHM:fb

P.S. Any reports received will be confidential and returned.
Please allow the option to J.H. Miller, with the privilege
of assignment, allowing sixty days for examination before
the first payment.

NATIONAL

NATURAL ICE

WHOLESALE & RETAIL

COLD
STORAGE.



COMPANY

LOCAL OFFICE
RAINIER BOTTLING PLANT
PHONE MAIN 16

Reno, Nev. July 15, 1921.

Mr. H.D. Budelman,

Tonopah Nev.,

Dear Herman:

Have been looking for Johnny Miller to show up here any day as his partners in Fallon are installing a rig and they have been expecting him. Wires to him addressed to Los Angeles are unanswered and no one is certain where he is but I am informed that the well which has been drilling in Montana came in with a big flow of oil and that he probably is on the ground. I am keeping busy here so as to meet him when he arrives.

Have not had a chance to go after the big fish that inhabit the upper Truckee river and its tributaries yet but will sure be hooking them up next Sunday.

With kindest regards,

Cordially Yours,

Warren V. R.

P.S. I am going over to Virginia City this morning for the day and shall see Fred at Silver City if he is there.



No. 7038

FIRST NATIONAL BANK

IN RENO

Reno, Nevada
July 26, 1934

Mr. H. D. Budelman, Vice President and Manager
West End Consolidated Mines Corporation
Tonopah, Nevada

Dear Mr. Budelman:

I have your letter of the 24th inst. regarding the Garfield group, and am enclosing a copy of same to Mr. Miller today, and as soon as I hear from him will advise you.

I have an idea that we would be agreeable to waiving the commencing of work on August 1st to some specified reasonable later date, provided that the \$2,000.00 payment should be made on August 1st. Personally I would like to have the matter disposed of as soon as possible for the reason that I have had several inquiries lately for the property, and out of the number, one party, I think, could raise the necessary funds for development, and if you decide not to take over the Garfield and desire to sell the Mabel on some reasonable terms I wish you would let me know.

With kind regards, I remain

Yours very truly,

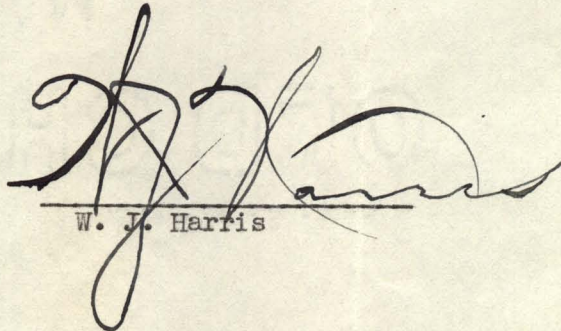

W. J. Harris

WJH:ML



No. 7038

FIRST NATIONAL BANK

IN RENO

RICHARD KIRMAN, PRESIDENT
W. J. HARRIS, VICE PRESIDENT L. S. REESE, CASHIER
L. R. MUDD G. B. HARRIS R. KIRMAN, JR. H. M. QUILICI
ASSISTANT CASHIERS

RENO, NEVADA

July 12, 1934

Mr. H. D. Budelman
Tonopah, Nevada

Dear Mr. Budelman:

I was talking today with Mr. S. J. Clausen, Jr., a mining engineer who is representing the Howe Sound Company of New York, and who has recently made a trip to Tonopah and adjoining mining camps, and called his attention to our "76" property.

I told him what you said about the possibilities of sinking a main shaft, and also told him of your connection with the West End Company. I am inclined to believe from what he says that it might be a good idea if you could have a talk with him the next time you come to Reno, and when you do come in, if you will call at the bank I will arrange a meeting.

The Howe Sound Company is a big organization, as you may know, and who knows but what this company might be interested in development work in Tonopah.

With best regards, I remain

Yours very truly,

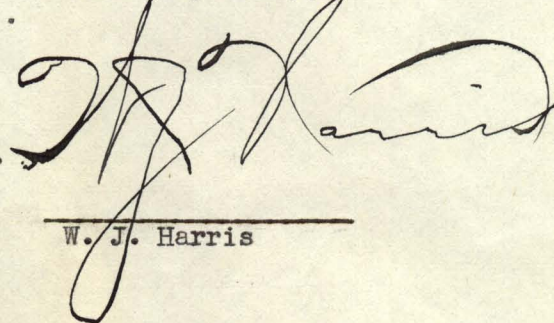

W. J. Harris

WJH:ML



Reno, Nev. 7/13/34.

Mr. H.D. Budelman.

Tonopah, Nev.,

Dear Herman;

I saw Mr. Harris upon my return from Tonopah , after our talk regarding the Garfield lease. The objectionable points which you called to my attention I reasoned out with Mr. Harris and he said that he would approve of the changes when the papers were received by him from Mr. Miller. I dropped in the Bank today and Mr. Harris told me that he had signed and expressed the papers to you. So I am glad that everything is settled, in connection with the deal as far as the terms are concerned. If you should find any further changes are advisable or necessary let me know if I can be of further assistance , as I am very anxious that the enterprise may be successful.

The family are all fine and join in best wishes. I will see you in Tonopah next week on my way traveling South. I hear it is 122 degrees Farenheit in LasVegas now and I am afraid I am missing something

Kind personal regards

Cordially,

W. W. Richardson



No. 7038

FIRST NATIONAL BANK

IN RENO

RICHARD KIRMAN, PRESIDENT
W. J. HARRIS, VICE PRESIDENT L. S. REESE, CASHIER
L. R. MUDD G. B. HARRIS R. KIRMAN, JR. H. M. QUILICI
ASSISTANT CASHIERS

RENO, NEVADA

July 12, 1934

Mr. H. D. Budelman, Vice President and
General Manager
West End Consolidated Mines Corporation
Tonopah, Nevada

Dear Mr. Budelman:

Upon my return from San Francisco this morning I find a letter from Mr. Miller under date of July 9th, and your letter to him under date of July 3rd, also three copies of the lease and option prepared by Mr. Miller, and carrying out the changes as suggested by you, with apparently only one exception, that is on page 2 of your letter in the first paragraph, the concluding three lines commencing with "provided", which Mr. Miller informed me he had crossed out, so I think you will find everything else to your satisfaction with this minor exception.

I am forwarding to you today the three copies of revised lease and option, duly executed by The New Eldorado Mining Company and myself. You can execute and return one copy to Mr. Miller at Hawthorne, and one copy to me, retaining one for yourselves. I am also including in this package to you per Express our Abstract of Title and a late map made by L. B. Spencer of Mina.

The Abstract of Title was quite difficult to obtain in the first place and I will ask that it is kept in a safe in case of fire, until it serves its purpose, and then you can return it to me. The two remaining copies of the original lease sent to you by Mr. Miller can be returned to me.

Kindly acknowledge
receipt on copy
sent with papers.

Trusting that you will find everything in order
and that all concerned will make some money from the trans-
action, and with kind regards to you and Mr. Ninnis, I remain

Yours very truly,

W. J. Harris

WJH:ML

April 5, 1935.

Mr. H. C. Carlisle,
315 Montgomery Street,
San Francisco, California.

Dear Mr. Carlisle:

On the 30th of last June I sent you our regular Mabel Mine Working Map for your inspection during examination you were making at that time.

So far as we are able to determine the map was not returned. Will you please return it to me here at Tonopah at your early convenience.

With kindest regards,

Very truly yours,

HDB:B

J. H. MILLER
HAWTHORNE, NEVADA

January 16.1935

Mr. H.G. Buddleman,
Tonopah, Nevada

My dear Mr. Buddleman:

I will shortly have an engineer examining the Garfield property, who is representing a very substantial company and I think it maybe possible that I can sell the Mable together with the Garfield under a lease and option, providing that you are in a position to grant same, if so, kindly advise the price and terms you will grant the lease and option for.

The country is now covered with considerable snow and probably impossible to make an examination at the present time, in the meantime if you can give me an agreement as to what you would be willing to do, allowing in any figures granted, a ten per cent commission as payments are made.

With kind personal wishes, I remain

Yours sincerely,

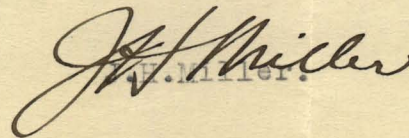
J. H. Miller

JHM:fb

August 15, 1934.

Mr. J. H. Miller,
Hawthorne, Nevada.

Dear Mr. Miller:

As you probably know I saw Mr. Harris in Reno a little over a weekago and returned the abstract of title to him; on the Garfield group. Mr. Hatton still thinks that you people should have a quit claim deed from Mr. Moore, in oder to clean up that detail, even though it does not appear, from what Mr. Harris told me, there could ever be any serious question raised. I passed through Hawthorne about 10:30 so could not stop and see you, at least I was a little nervous about waking you at that time of night.

There was no desire or intention on our part to stall on this deal, the question of title had to be clear before money could be paid, but as it turned out we were unable to carry out our plans at this time. Perhaps later on we may get together again, and you may become more generous by then.

As I told Mr Harris in Reno I expected to get to Ashby or Hawthorne and see you, but I have been busy working on other things here and unable to get away. For that reason I am writing you and returning the lease forms as you requested in your wire of July 28. You will find enclosed two copies of the first draft - you will recall that the third copy was sent to you with my letter of July 3 - and three copies of the final draft. I would really like to keep one of the latter, as it might save a lot of brain fog later if we agree on another option, and if you can see your way clear to do I would appreciate a copy.

May be down that way any time now and will come in and see you if possible. Am sorry that we are not busy on the Mabel shaft right now, and after those millions resting under the Garfield.

Kindest regards,

Very truly yours,

HDB:B

Called J. H. M. at Ashby 8/25/34
W.D.



FIRST NATIONAL BANK

IN RENO

RICHARD KIRMAN, PRESIDENT
W. J. HARRIS, VICE PRESIDENT L. S. REESE, CASHIER
L. R. MUDD G. B. HARRIS R. KIRMAN, JR. H. M. QUILICI
ASSISTANT CASHIERS

RENO, NEVADA

July 10, 1934

Mr. H. D. Budelman, Vice President & General Manager,
West End Consolidated Mines Corporation,
Tonopah, Nevada.

Dear Mr. Budelman:

I am today in receipt of a letter from Mr. J. H. Miller addressed to my father, with which he enclosed your letter of July 3rd, together with Garfield lease and re-draft of said lease, in accordance with your desires.

For your information, Mr. Budelman, my father at the present time is in San Francisco attending the Knights Templar Conclave and is not expected to return until the latter part of this week or the first part of next week. Immediately upon his return, the matter will be brought to his attention and he will either communicate with you or Mr. Miller.

Yours very truly,

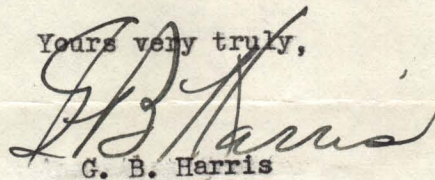
G. B. Harris

GBH:VB

July 3, 1934.

Mr. J. H. Miller,
Hawthorne, Nevada.

Dear Mr. Miller:

Thanks for your very prompt attention to the Garfield option, which reached me Sunday.

I have gone over it carefully and submitted it to Mr. Hatton, our attorney, and there are some things which, for the sake of clearness, we think should be changed a little. I shall ennumerate them to you for your consideration, as I do not think there is anything of importance which we have not already agreed upon.

1. You will recall you were to send me a claim map, so that we could see just how the new claims filled in the open spaces.

2. In Article 1, first paragraph and first line, between "premises" and "and" insert "as hereinafter provided for".

3. In Article 1, second paragraph. This wording forces us to a definite line of development, which we might not want to go through with. This, I believe, is not your intention as you know that when shaft sinking is started we might encounter some conditions which would cause us to change our ideas entirely. At any rate, we expect to do work on more than one level toward and in the Garfield, and we may not want to do it on the bottom level at all. We suggest the following a re-write for the entire second paragraph of this article:

"The lessee shall work, operate and develop said property either through the Mabel Shaft on lessee's ground, or any other shaft or development working upon any of the mining claims hereinabove described. In case said ground is developed through the Mabel Shaft lessees agree to commence development work toward the ground of the lessor as soon as possible after the completion of necessary preliminary work; consisting to repairs to buildings, installation of another hoist or other equipment if considered necessary, the installation of which would necessitate delay in actual underground work, repairs in the present Mabel Shaft of lessees, or sinking of the same, and all necessary preliminary work customarily regarded as such around a mine; and lessee agrees to start this preliminary work by August 1, 1934, and to prosecute it with due diligence;

J. H. Miller - 3.

July 3, 1934.

to be started. Would it be possible for you to have your abstract of title forwarded here for Mr. Hatton's inspection. If you like, it could be sent direct to him, W. D. Hatton, Tonopah, Nevada.

With the thought that perhaps you have no copy there I am enclosing one of the three copies of the original draft of the lease and option, so that you may be sure to have one for purpose of comparison.

If you find these alterations in order please let me know just what to do with the copies I have here. If you like I can re-write the necessary pages, or perhaps it would be better to send all copies back to Reno so as to have the typing all done on the same machine. ~~Please let me know.~~

With kindest regards,

Very truly yours,

HDB:B

General Manager

J. H. Miller - 2.

July 3, 1934.

and it is understood between the parties hereto that during this period of preparatory work the following provision relating to the number of shifts to be performed by lessee in lessor's ground shall be suspended and shall not apply, provided lessee prosecutes the said preliminary work with due diligence and does not delay the actual development work toward ground of lessor. After said preliminary work is completed and development workings have reached the ground of lessors, the lessee shall perform at least 100 shifts per month during each and every month during the term of said lease upon the premises of the lessors, unless prevented as provided herein, or upon waiver by mutual consent of both parties hereto, and a failure to perform such labor for 30 consecutive days shall work a forfeiture of this lease; provided that a deficiency of work for any month may be made up during the following month, if the work for that month shall have been completed."

You will note that we have placed a clause, the last three lines of the above paragraph, which allows work to be made up in the following month, placing the work actually on a two month basis instead of a one month basis. This might be very convenient for us in operating, and would work no hardship on you people.

You may rest assured that in our preliminary work we will naturally be in a hurry to get going in Garfield ground, with a payment coming due in a year, so that will work both to our and your benefit, and simply clarifies actual conditions as theybare.

4. In Article 5, in the fifth line between the words "equipment" and "used" insert "which may have been left on the property by the lessee, and"; and in line six between the words "expense" and "of" insert "and risk"; and in the last line place a semicolon after "same" and add "the lessee not being required, however, to maintain or leave machinery on said property".

This is simply for the purpose of clarifying the risk attendant to going down the shaft etc, and to give us the right, without question, of removing machinery from our Mabel Shaft if we wish to do so when we quit work.

5. In Article 21, fourth to the last line, between the words "use" and "of" insert "at their risk"; and in the same line after the word "machinery" inser "then remaining on said premises".

6. As this lease and option calls for a cash payment the question of title naturally arises before any work is

April 18, 1935.

Mr. J. H. Miller,
Hawthorne, Nevada.

Dear Mr. Miller:

This is in reply to your telephone message of the 17th, relative to option on the Mabel Mine.

We are agreeable that you handle the Mabel Mine sale, on the basis as outlined to you in my letter of Jan. 27, and if sale be made we will protect you to the extent of a 10% commission on payments as made.

Purchase price to be \$75,000, of which \$10,000 is to be cash at end of 30 days from date of this letter, but with this understanding; that if, at the end of this 30 day period, you have engineers on the ground actually engaged in making an examination, we will then allow another 30 days in which to complete the examination.

The actual option, to be made between the West End Company and the interested parties, can be drawn up when indications point to their sustained interest in the deal.

Rights of present Lessees would have to be respected, but terms of that lease are such that company operations can be carried on, would have first call on machinery and shaft.

Any interested party will naturally want to look over the data we have here. This is quite voluminous and it is not practicable to send it on to you. It seems that the logical plan would be to send them here for that purpose.

You may depend on us assisting you in every way possible, and that we will carry out the premises herein given.

It is our understanding that in case of a joint sale of the two properties you will put the Garfield in on the same basis as the Mabel, at least as to total purchase price. We feel that if you place too large a price on the Garfield it would react against the sale of the Mabel, and in fact against the joint deal.

As you know, it has been our desire to have a reciprocal agreement on the sale of the two properties. In case we handle the sale we to get a 10% commission, in

J. H. Miller - 2

April 18, 1935.

case you handle the sale you to get the same. Would that be a satisfactory arrangement to you and, if so, on what terms would you and Mr. Harris be interested. We should have a definite understanding as to price, in order to avoid having any uncertainty due to the two properties being offered by different people at varying prices.

You will note that we have specifically avoided reference to future payments. We have done this as we think that the matter of terms should be worked out between the owners and the prospective purchasers.

With kindest regards from Mr. Ninnis and myself,

Very truly yours,

HDB:B

CLASS OF SERVICE	SYMBOL
Day Message	
Day Letter	Blue
Night Letter	N. L.

If none of these three symbols appears after the check (number of words) this is a day message. Otherwise its character is indicated by the symbol appearing after the check.

Nevada Telephone-Telegraph Company TELEGRAM

J. CLARENCE KIND
General Manager

Receiver's No. 18/7
Check 26 8 L.
Time Filed 9:45a

RECEIVED. AT 9:47a

Hawthorne July 28 1934

To H. D. Budelman
Tucson. Ariz.

unless contract is signed and payment
made on date specified we will call
deal off return all papers to me except
abstract return that to Harris

J. H. Miller

January 27, 1935.

Mr. J. H. Miller,
Hawthorne, Nevada.

Dear Mr. Miller:

Thanks for your letter of the 16th relative to a deal price to work on for a joint sale of the Mabel and the Garfield to interested parties.

We would be willing to put the Mabel in on the same basis as you would use for the Garfield, with a minimum figure of \$50,000, \$10,000 of which should be cash. This cash payments will cover only a portion of the actual value of surface improvements on the Mabel, which would be available to any one actually starting operations. We will protect you to the extent of a 10% commission as payments are made to us.

This should not be construed as an exclusive option on the Mabel Mine.

With kindest regards from Mr. Ninnis and myself. We shall await the next move with interest and in case we can be of assistance please let us know; we want to see some work done there and feel that the mines have merit and good possibilities for successful ventures.

Very truly yours,

HDB:B

July 24, 1934.

Mr. W. J. Harris,
First National Bank in Reno,
Reno, Nevada.

Dear Mr. Harris:

Regarding the Abstract of Title on the Garfield group. Mr. Hatton has been busy and has as yet been unable to finish with his investigation on it, so as to give us his legal opinion. However, he told me today that he is getting along fine and will be able to finish within the next few days. You may rest assured that we will take good care of it, and return it to you just as soon as we are finished.

It appears unlikely that we can be prepared to start work on August 1, as anticipated, for several reasons, and I would appreciate advice from you as to an extension of time on the option as prepared, say for 30 days. If you and Mr. Miller cannot see your way clear to give us an extension we shall be forced to allow the option to expire and later take it up with you again, but we would very much prefer to have an extension of time and thus keep the option alive as it is.

As soon as I receive final word from Mr. Hatton I shall write you again, and return the Abstract.

With kindest regards,

Very truly yours,

HDB:B

Reno, Nevada,
September 12, 1934.

Mr. H. D. Budelman
TONOPAH,
Nevada.

Dear Mr. Budelman:

Almost got into Tonopah yesterday
and expected to hand you the enclosed report and have
the pleasure of seeing you. I am on my way to Idaho
and am stopping here at Reno for a day.

Sorry I could not do something on the Mabel
and really liked it for a small profit per year.
Then tried to do something through T. L. Oddie as I
knew he was looking for something for parties back East,
but he was called back there and believe he did not
get to see you. Was merely turning it over to him as
a friendly act^{to him}, without any strings on it myself.

Please look me up when you come to town next.

Sincerely yours,

Henry A. Farwell

H
C
C
/
S

Encs. 1.

Do not know Fred's address so am sending to you.

XC

EXCLUSIVE!

The point of origin
of this message is one
of the thousands of places
served exclusively by...

WESTERN UNION

**WESTERN
UNION** (43)

REYNOLD CARLSON, PRESIDENT

J. C. WILLEVER, FIRST VICE-PRESIDENT

SIGNS

DL = Day Letter

NM = Night Message

NL = Night Letter

LCO = Deferred Cable

NLT = Cable Night Letter

WLT = Week-End Letter

The filing time as shown in the date line on full-rate telegrams and day letters, and the time of receipt at destination as shown on all messages, is **STANDARD TIME.**

Received at

1934 JUN 23 AM 10 43

VZ16 10 XC=D3=FALLON NEV JUN 23 1035AM

S D BUDDLEMAN=

TONOPAH NEV=

MINUTES IN TRANSIT

FULL-RATE

DAY LETTER

ARRIVE TONOPAH TUESDAY SHOULD LIKE GO PROPERTY WITH YOU
THURSDAY=

HENRY C CARLISLE.

sent to property with H.C.C. & Handed et al. in Jan 28, 1934 HAD

CLASS OF SERVICE DESIRED	
Telegram	
Day Letter	X
Night Message	
Night Letter	
Patrons should mark an X opposite the class of service desired; OTHERWISE THE MESSAGE WILL BE TRANSMITTED AS A FULL-RATE TELEGRAM	

WESTERN UNION TELEGRAM

NEWCOMB CARLTON, PRESIDENT

GEORGE W. E. ATKINS, FIRST VICE-PRESIDENT

Receiver's No.
Check
Time Filed

Send the following message, subject to the terms
on back hereof, which are hereby agreed to

Tonopah, Nevada,
June 19, 1934.

J. H. Miller,
Care First National Bank in Reno,
Reno, Nevada.

Have already submitted your stiff tentative
terms to my people no word from them yet may take several
days perhaps week before ready stop please dont rush this
must have time discuss it ourselves and with you stop you
know how it is maybe some give and take.

H. D. Budelman

Charge West End.

J. H. MILLER
HAWTHORNE, NEVADA

June 30, 1934

H. D. Buddleman,
West End Mines Company,
Tonopah, Nevada

Dear Mr. Buddleman:

Enclosed you will please find lease and option in triplicate, which I trust you will find satisfactory.

The only matter in these contracts, which we did not discuss is the question of annual assessment work and as long as ^{you} will be operating and the claims are contiguous, you of course will be performing sufficient labor to take care of the entire groupe, yearly.

Kindly execute and send one copy to me at Hawthorne, Nevada and one copy to W. J. Harris at the First National Bank in Reno, Nevada.

As soon as you get in operation I will be up to see you and trust that you will take out the millions that I think that are lying beneath the surface of the property.

With kind personal wishes, I remain

Yours sincerely,

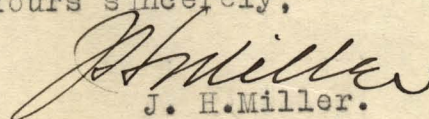
J. H. Miller.

JHM;fh

June 19, 1934.

Dear Fred:

Received a wire from Miller this morning, from Reno. Evidently he was pleased with possibilities for a deal along the lines he suggested and wants to close up right now. The wire read as follows:

"Think we can arrange deal along lines I proposed providing you act at once stop advise by wire when you can be here"

I replied thusly:

"Have already submitted your stiff tentative terms to my people no word from them yet may take several days perhaps week before ready stop please dont rush this must have time discuss it ourselves and with you stop you know how it is maybe some give and take".

What they like about the proposition is the cash payment, and it may be the final price can be chiseled to something reasonable. I suppose the thing to do is to take it up with Carlisle and see if he is interested. Even if we cannot sell him the Mabel, and maybe we can, this should be considered as the two properties can be developed at the same time and certain overhead costs shared. If he is interested let me have what he considers ~~maximum~~ might be interesting to his people and I had better be the one to get the option before his name appears in the picture. I have asked for 30 days time for an examination and he can come in after the option is signed.

Stine was in, not very well pleased because we have not cooperated, and is going to put his own company in. That deal is off for the time, as he says he cannot wait any longer.

Best to all,

CLASS OF SERVICE

This is a full-rate Telegram or Cablegram unless its deferred character is indicated by a suitable sign above or preceding the address.

WESTERN UNION

NEWCOMB CARLTON, PRESIDENT

J. C. WILLEVER, FIRST VICE-PRESIDENT

SIGNS

DL = Day Letter
 NM = Night Message
 NL = Night Letter
 LCO = Deferred Cable
 NLT = Cable Night Letter
 WLT = Week-End Letter

The filing time as shown in the date line on full-rate telegrams and day letters, and the time of receipt at destination as shown on all messages, is STANDARD TIME.

Received at

VZ9 23 DL=RENO NEV 19 943A

1934 JUN 19 AM 9 46

H D BOUDLEMAN=

TONOPAH NEV=

MINUTES IN TRANSIT

FULL-RATE	DAY LETTER

THINK WE CAN ARRANGE DEAL ALONG LINES I PROPOSED PROVIDING
 YOU ACT AT ONCE STOP ADVISE BY WIRE WHEN YOU CAN BE HERE=

J H MILLER.

CLASS OF SERVICE

This is a full-rate Telegram or Cablegram unless its deferred character is indicated by a suitable sign above or preceding the address.

WESTERN UNION

(11)..

NEWCOMB CARLTON, PRESIDENT

J. C. WILLEVER, FIRST VICE-PRESIDENT

SIGNS

DL = Day Letter
 NM = Night Message
 NL = Night Letter
 LCO = Deferred Cable
 NLT = Cable Night Letter
 WLT = Week-End Letter

The filing time as shown in the date line on full-rate telegrams and day letters, and the time of receipt at destination as shown on all messages, is STANDARD TIME.

Received at

VZ24 7=SAN FRANCISCO CALIF 1 1157A

1934 JUN 1 PM 12 13

H D BUDELMAN=

TONOPAH NEV=

MINUTES IN TRANSIT

FULL-RATE	DAY LETTER

PLEASE WRITE ME TODAY NINNIS ADDRESS HERE=

HENRY C CARLISLE.

Fred
Please return
H.D.R.

June 30, 1934.

Mr. H. C. Carlisle,
315 Montgomery Street,
San Francisco, Calif.

Dear Mr. Carlisle:

Under separate cover I am today mailing you our regular mine working map, on which I have brought all faces to date.

After you have finished with this map please return to me here.

My estimate of cost for getting hot head and hoist going, which would include necessary water and fuel, for inspection of the shaft but no repairs therein, and for blowing out the bottom levels of the Mabel Mine, is \$150 to \$200.

I trust that you and Stotes had a pleasant trip to Reno, and that the week end was a pleasant one.

With kindest regards,

Very truly yours,

June 1, 1934.

Mr. H. C. Carlisle,
315 Montgomery Street,
San Francisco, California.

Dear Mr. Carlisle:

Regarding Fred Winnis's address, about
which you wired me today.

He is living at 1149 High Court, Berkeley,
California. Telephone Ashberry 9306.

My family is living at 1224 Oxford Street,
Berkeley, and this is listed in the telephone dir-
ectory; telephone Ashberry 7671. In case of any
uncertainty call Mrs. Budelman and she can likely
tell you anything of the whereabouts of either Fred
or myself.

With kindest regards,

Very truly yours,

April 20, 1933.

Mr. Henry G. Fergusen,
Care Geological Survey,
Department of the Interior,
Washington, D. C.

Dear Mr. Fergusen:

I am very much interested to know if you
ever put your data on the Garfield District, in which
the Mabel and Garfield Mines are situated, near Mina,
Nevada, in print.

We have hopes of getting some work started
in that section and feel that your observations
would be of assistance to us.

With kindest regards,

Very truly yours,

HDB:B

Mabel + Garfield
lease + sale

correspondence

1933 - 35

Muller
Car hire

MABEL MINE SERIES
CLAIMS, DRAWINGS, ETC.

10

1939

(254)

Z-117

10 of 46

4840 0117

CERTIFICATE OF LOCATION

This is to Certify That a mining claim named the GM No. 1

was located by H.D. Budelman and F.C. Ninnis

on the 13 day of June 191³⁹, situated in Garfield
District, Mineral County, State
of Nevada, and about 3/4 mile westerly from the Mabel shaft

(Refer to some natural object or permanent monument.)

We claim 1500 linear feet along the course of the mineral-bearing
ledge, lode or vein, extending 10 feet from the location monument in a
easterly direction, and 1490 feet in a westerly direction,
together with 300 feet on each side of the center of the ledge for the entire
length of the claim.

The discovery work consists of open cut
situated about 300 feet in a Westerly direction from the location
monument, and its dimensions are 4 feet wide, 20 feet long
and 3 feet deep, exposing ledge, lode or vein in place.

The northwest corner is marked by stone monument 4 feet high, inscribed
"N. W. corner GM No. 1 mine;" the southwest corner is marked by a
stone monument 4 feet high, inscribed "S. W. corner GM No. 1
mine;" the southeast corner is marked by a stone monument 4 feet high, inscribed
"S. E. corner GM No. 1 mine;" the northeast corner is marked by a
stone monument 4 feet high, inscribed "N. E. corner GM No. 1
mine." There is also a stone monument at the center of each side line.

The discovery work has been done and the location work completed since
June 13, 1939., 191

Dated

7-7-39

, 191

Miner  Print

H.D. Budelman.
Locator.

F.C. Ninnis
Locator

30211

Filed for Record at request of

J. C. Harris
September 7, 1939 at 30
min. past 2 o'clock P. M.

Recorded in Book 11 of
Mining Locations

Page 278 Records of
Mineral County Nevada

J. J. Donnelly
County Recorder

By _____ Deputy

CERTIFICATE OF LOCATION

This is to Certify That a mining claim named the GM No. 2

was located by H.D. Budelman and F.C. Ninnis

on the 13 day of June 191³⁹, situated in Garfield
District, Mineral County, State
of Nevada, and about 3/4 mile westerly from the Mabel shaft

(Refer to some natural object or permanent monument.)

We claim 1500 linear feet along the course of the mineral-bearing
ledge, lode or vein, extending 10 feet from the location monument in a
westerly direction, and 1490 feet in a easterly direction,
together with ~~600~~ 300 feet on each side of the center of the ledge for the entire
length of the claim.

The discovery work consists of Open Cut
situated about 225 feet in a Easterly direction from the location
monument, and its dimensions are 6 feet wide, 10 feet long
and 4 feet deep, exposing ledge, lode or vein in place.

The northwest corner is marked by stone monument 4 feet high, inscribed
"N. W. corner GM No. 2 mine;" the southwest corner is marked by a
stone monument 4 feet high, inscribed "S. W. corner GM No. 2
mine;" the southeast corner is marked by a stone monument 4 feet high, inscribed
"S. E. corner GM No. 2 mine;" the northeast corner is marked by a
stone monument 4 feet high, inscribed "N. E. corner GM No. 2
mine." There is also a stone monument at the center of each side line.

The discovery work has been done and the location work completed since
June 13, 1939 ~~x191x~~

Dated 9-7-39, 191

Miner  Print

H.D. Budelman
Locator.

F.C. Ninnis
Locator

30212

Filed for Record at request of

F. C. Annis

Sept 7, 1939 at 30
min. past 2 o'clock P. M.

Recorded in Book

11 of

Mining Locations

Page 278-279 Records of
Mineral County Nevada

J. J. Hornelly
County Recorder

By _____ Deputy

CERTIFICATE OF LOCATION

This is to Certify That a mining claim named the GM No. 3

was located by H.D. Budelman and F.C. Ninnis

on the 13 day of June 1939 ~~1941~~, situated in Garfield
District, Mineral County, State
of Nevada, and about 3/4 mile westerly from the Mabel shaft

(Refer to some natural object or permanent monument.)

We claim 1500 linear feet along the course of the mineral-bearing
ledge, lode or vein, extending 20 feet from the location monument in a
easterly direction, and 1480 feet in a westerly direction,
together with 300 feet on each side of the center of the ledge for the entire
length of the claim.

The discovery work consists of Open cut
situated about 20 feet in a Westerly direction from the location
monument, and its dimensions are 6 feet wide, 10 feet long
and 4 feet deep, exposing ledge, lode or vein in place.

The northwest corner is marked by stone monument 4 feet high, inscribed
"N. W. corner GM No. 3 mine;" the southwest corner is marked by a
stone monument 4 feet high, inscribed "S. W. corner GM No. 3
mine;" the southeast corner is marked by a stone monument 4 feet high, inscribed
"S. E. corner GM No. 3 mine;" the northeast corner is marked by a
stone monument 4 feet high, inscribed "N. E. corner GM No. 3
mine." There is also a stone monument at the center of each side line.

The discovery work has been done and the location work completed since

June 13, 1939 ~~1941~~

Dated 9-7-39, 191

H.D. Budelman

Locator.

F.C. Ninnis

Locator

Miner  Print

CERTIFICATE OF LOCATION

30213

Filed for Record at request of

F. C. Davis
Sept 7, 1939 at 30
min. past 2 o'clock P M.

Recorded in Book 11 of

Mining Locations

Page 279 Records of
Mineral County Nevada

J. Hornelly
County Recorder

By _____ Deputy

Tonopah, Nevada,

Messrs. Ray W. Campbell and
Howard J. Kressly,
719 Second Avenue,
Seattle, Washington.

Gentlemen:

In consideration of the sum of Ten Dollars (\$10.00), receipt of which is hereby acknowledged, we hereby relinquish any claim against Ray W. Campbell and/or Howard J. Kressly for commission on the Agreement of sale, dated approximately August 24, 1939, by and between New Eldorado Mining Company and W. J. Harris, the parties of the first part, and Ray W. Campbell and/or Howard J. Kressly, parties of the second part, covering the Garfield Group of Claims, in the Garfield Mining District (sometimes called the Gold Range Mining District), Mineral County, Nevada.

DEED

THIS INDENTURE, made this _____ day of September, 1939, by and between F. C. NINNIS and H. D. BUDELMAN, parties of the first part, and RAY W. CAMPBELL and H. J. KRESSLY, parties of the second part:

W I T N E S S E T H

That the parties of the first part, for and in consideration of the sum of Ten Dollars (\$10.00) to them in hand paid by the parties of the second part, receipt whereof is hereby acknowledged, do by these presents grant, bargain, sell, remise, release and forever quitclaim unto the parties of the second part, their successors and assigns, those certain unpatented lode mining claims situated in the Garfield Mining District (sometimes known as the Gold Range Mining District), Mineral County, State of Nevada, known and described as follows; to-wit:

"GM No. 1", "GM No. 2", "GM No. 3", "GM No. 4" lode mining claims, certificates of location of said lode mining claims being on record in the office of the County Recorder of Mineral County as follows:

GM No. 1 in Book 11 of Mining Locations, Page 278;
GM No. 2 in Book 11 of Mining Locations, Pages 278-279;
GM No. 3 in Book 11 of Mining Locations, Page 279;
GM No. 4 in Book 11 of Mining Locations, Pages 279-280.

TOGETHER with all dips, spurs, and angles and also all the metals, ores, gold, and silver bearing quartz, rock and earth therein; and all the rights privileges, and franchises therein incident, appendant, and appurtenant, or therewith usually had and enjoyed; and also all and singular the tenements, hereditaments and appurtenances thereto belonging or in anywise appertaining, and the rents, issues, and profits thereof.

TO HAVE AND TO HOLD, all and singular the said premises, together with the appurtenances and privileges thereto incident, unto the said parties of the second part, its successors and assigns forever.

IN WITNESS WHEREOF, the parties of the first part have hereunto set their hands on the day and year in this indenture first above written.

STATE OF NEVADA }
COUNTY OF NYE } SS.

On this _____ day of September, A. D. 1939, personally appeared before me, _____, a Notary Public in and for Nye County, Nevada, F. C. NINNIS and H. D. BUDELMAN known to me to be the persons described in and who executed the foregoing instrument, who acknowledged to me that they executed the same freely and voluntarily and for the uses and purposes therein mentioned.

In witness whereof I have hereunto set my hand and affixed my notarial seal the day and year first above written.

Notary Public in and for Nye
County, State of Nevada.

My Commission expires _____

CERTIFICATE OF LOCATION

This is to Certify That a mining claim named the GM No. 4

was located by H.D. Budelman and F.C. Ninnis

on the 13 day of June, 1939 ~~1911~~, situated in Garfield
District, Mineral County, State
of Nevada, and about 3/4 mile westerly from the Mabel shaft

(Refer to some natural object or permanent monument.)

We claim 1500 linear feet along the course of the mineral-bearing
ledge, lode or vein, extending 20 feet from the location monument in a
easterly direction, and 1480 feet in a westerly direction,
together with 300 feet on each side of the center of the ledge for the entire
length of the claim.

The discovery work consists of Open Cut
situated about 20 feet in a Westerly direction from the location
monument, and its dimensions are 4 feet wide, 20 feet long
and 4 feet deep, exposing ledge, lode or vein in place.

The northwest corner is marked by stone monument 4 feet high, inscribed
"N. W. corner GM No. 4 mine;" the southwest corner is marked by a
Stone monument 4 feet high, inscribed "S. W. corner GM No. 4
mine;" the southeast corner is marked by a stone monument 4 feet high, inscribed
"S. E. corner GM No. 4 mine;" the northeast corner is marked by a
stone monument 4 feet high, inscribed "N. E. corner GM No. 4
mine." There is also a stone monument at the center of each side line.

The discovery work has been done and the location work completed since
June 13, 1939 ~~1911~~

Dated

9-7-39

, 191

H.D. Budelman
F.C. Ninnis

Locator.

Locator

Miner  Print

30214

Filed for Record at request of

F. C. Armes
Sept 7, 1929 at 30
min. past 2 o'clock P. M.

Recorded in Book 11 of
Mining Locations

Page 229-230 Records of
Mineral County Nevada

Normally
County Recorder

By _____ Deputy

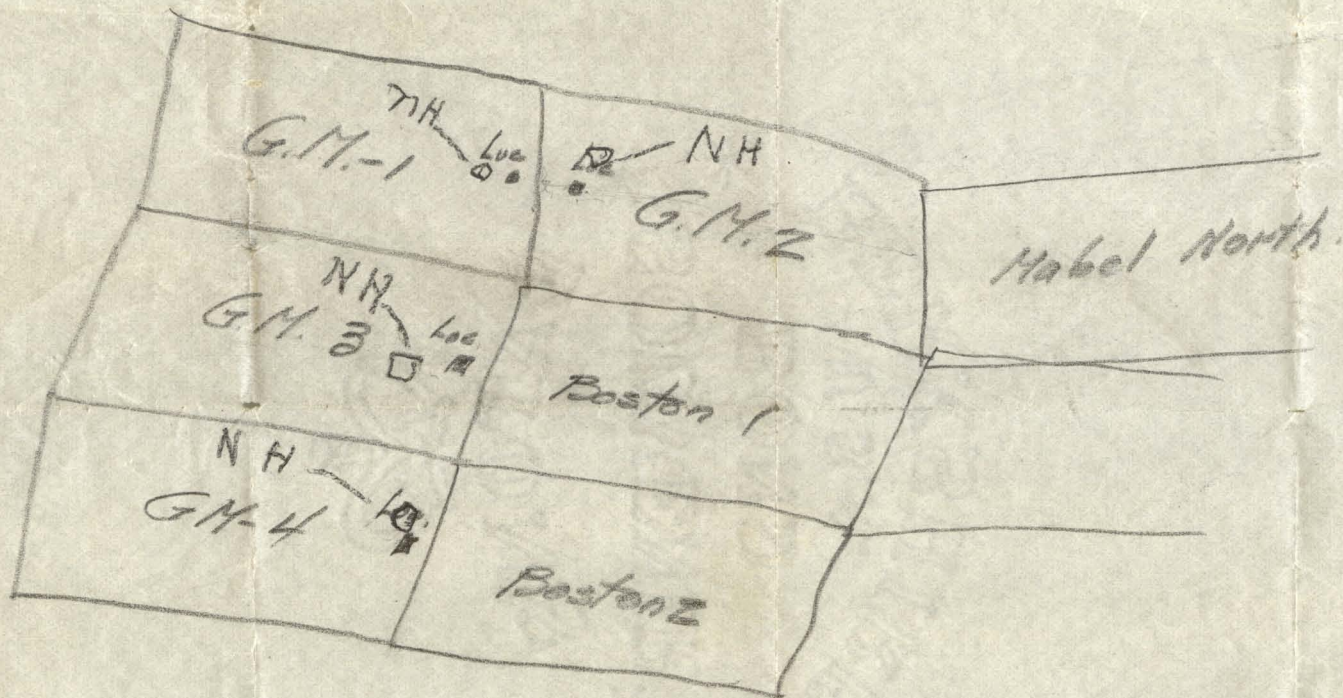

14 shifts

75 8
3700
14 | 11 2.50
 11 2

Assessment book
H. M. Gramp

No. 1 - open cut $8\frac{1}{2}$ feet \times $10\frac{1}{2}$ feet, 3' deep
earth and rock, 250' W of location monument.

No. 2 - open cut $9' \times 11'$, 3' deep, earth and
rock, 270' E of location monument.

No. 3 - open cut $6' \times 10'$, 4' deep, earth
and rock, 40' W. of location monument.

No. 4 - open cut $8' \times 10'$, 3' deep, earth
and rock, N 30° W 60' from location
monument.

DAILY REPORT

191

SUPPLIES USED		LABOR		WASTE HOISTED	CARS	ORE HOISTED	CARS
Powder, Boxes		Shift Bosses					
Fuse, Feet		Machine Men					
Electric Cartridges		Miners					
Caps, Boxes		Shovelers					
Candles, Boxes		Car Men					
Lumber, Feet		Timber Men					
Timber, Feet		Engineers					
Miscellaneous		Top Men					
		Blacksmiths					
		Machinists					
		Total		Total		Total	

REMARKS:

Any irregularities, defective machinery, etc., must be reported under this head.

Shift Boss.

FF10

g M # 1, 2, 3, 4

1939 - claims
etc.

(Garfield - Mahul)