

253

Ham 1

4830 0001

REPORT ON
LAND MARK GROUP
TOLICHA MINING DISTRICT
NYE COUNTY? NEVADA.

Examined Jan. 13-15, 1921

Reported Jan. 18, 1921

By A. F. Carper.

Copy sent J.H.W.,

REPORT ON
LAND MARK GROUP.
TOLICHA MINING DISTRICT,
NYE COUNTY, NEVADA.

LOCATION.

The Land Mark Group is located on the Pahute Mesa, in the low hills about two miles north of Tolicha Peak. Ancram Station on the Tonopah and Tidewater Railroad about twelve miles south west is the nearest point for freight. Goldfield forty nine miles to the north west is the nearest point for small supplies and mail.

CLAIMS AND AREA.

There are three claims in this group known as the Land Mark, Land Mark No.1, and Tolicha, covering an area of about fifty acres of mining ground.

OWNERSHIP AND TITLE.

This ground was located and is owned by Mr. J. C. Mc Kay of Reno, Nev., Mr. J. J. Jordan of Tonopah, Nev., and Mr. E. D. Yeiser of Goldfield, Nev. Their title is possessory being by right of location and discovery.

HISTORY.

The first discovery of mineral in this district was in 1905. A small amount of work was done by these locators on what is now known as the Periscope Group. These men suspended work and gave up their claims in 1909.

The present owners of the camp located practically all of the claims in July 1917. Shortly after their location the Life Preserver Group was optioned to Mr. Zeb Kendell who interested Mr. Geo. Wingfield. The Wingfield interest did about three hundred feet of development work in short tunnels and shallow shafts, then gave up their option.

A two thirds interest in the Land Mark Group leased and optioned to Mr. E. S. Harney in September 1919. The purchase price

(2)

was \$30,000.00 payable at the end of eighteen months. This option was cancelled in December 1920 on account of failure to work according to agreement.

FACILITIES.

Transportation:

There is a passable road to Ancram Station, with only one summit to cross. This road is open to travel the whole year. The road to Goldfield is fair and is over an easy grade the whole distance of 49 miles.

Power:

There is no electric power closer than Goldfield. Any prospecting or development would require fuel oil engines.

Water:

The nearest water developed is at Monte Cristo Springs a distance of 4 1/2 miles to the west. This spring develops only enough water for domestic uses. It is fairly possible that water for milling purposes could be developed in the west to the west of the property.

Timber:

There is no timber even for domestic purposes.

GEOLOGY.

General:

The rock formation in this district is a coarse grained Rhyolite which approaches a quartzporphyry. This rhyolite is very coarse grained showing the plagioclase phenocrists well developed, and the quartz in prominent crystals. Quartz veins from one inch to fifteenfeet wide are scattered fairly over the whole territory. The rhyolite close to the veins is fairly well altered and close to the veins is highly silicified. Excessive faulting makes these ledges hard to trace for any distance.

Local:

The same rhyolite that covers the whole territory covers this property. There are two veins about ten feet wide, and possibly a third vein on this group. Extensive faulting has taken

GEOLOGY. Contd.

place along the plane of the veins, as well as cross faulting. The veins are a mixture of quartz, talc and crushed rhyolite, in most places not recemented. The walls to these veins are hard silicified rhyolite.

Faults are numerous and cut the veins into short segments. No work has been done to prove the extent of the fault throw.

DEVELOPMENT.

The development consists of a tunnel with 285 feet of crosscutting and drifting. The west vein is developed for a distance of 65 feet at a depth of about 30 feet below the surface. Besides this tunnel there eight cuts two feet deep and fifty feet long, and two shafts ten feet deep.

EQUIPMENT.

Equipment consists of a blacksmith shop, ore bin, crusher, mine rails and car.

PRODUCTION.

There has been about 150 tons of ore mined from the drift, all of this rock is on the dump. (See samples 10 and 11)

SAMPLES.

Cut samples were taken every ten feet across the vein in the drift from the cross cut to the point where the vein was lost by faulting. One sample was cut from the vein at the surface above the tunnel. The balance of samples were grab samples from different piles of ore on the surface.

PRICES AND TERMS.

The purchase price for this property is \$150,000.00 with any terms suitable to the purchaser. The owners stated that any proposition would be considered. It is possible that a development arrangement could be made on a basis of no payments and a 40% holding for the present owners non assessable.

RECOMMENDATIONS.

Further development should be to drive the east crosscut, the west end

(4)

ahead to the east vein and develop it by drifting. AAcrossect should be driven west south of the fault to find the next fault block of the west vein. If these prove satisfactory greater depth should be gained on the veins by means of a winze or shaft.

CONCLUSIONS.

The property in its present shape is not worth the price asked.

The extent of the faulting is such that the ore bodies will be short.

Water for milling purposes is indeterminate. The ore is of such a grade that it could not be shipped.

The property is not worthy of further consideration. except as a development proposition.

Respectfully submitted,

A. F. Carper

Examined Jan. 13 - 15, 1921.

Reported Jan. 18, 1921

By A. F. Carper.

SAMPLES.

NO.	WIDTH.	OZ GOLD	OZ SILVER	VALUE	DESCRIPTION
1	7.0	.16	Tr.	\$ 3.20	Cut across south side of xc and xxx back of drift H.W. side of vein. Broken Quartz, silicified rhyolite and talc.
2	7.0	.07	Tr.	1.40	Cut across back of drift and south side of xc. Extension of sample No.1 F.W. Side.
3	6.1	.30	Tr.	6.00	Cut across back of drift 10 feet south of cross cut.
4	6.7	.16	Tr.	3.20	Cut across vein back of drift 20 feet south of cross cut.
5	6.3	.52	.10	10.50	Cut across back of drift 30 feet south of cross cut. At north side of raise 3 feet high.
6	6.4	.72	.16	14.56	Cut across back of drift 40 feet south of cross cut. At south side of raise.
7	6.5	.12	Tr.	2.40	Cut across back of drift 50 feet south of cross cut.
8	4.8	.05	Tr.	1.00	Cut across back of drift 60 feet south of cross cut. 4 feet north of fault.
9	7.7	.32	.24	6.44	Cut across south side of east xc 21 to 29 feet west of face. crushed zone showing stain of iron oxide.
10		1.02	.90	21.30	Grab of 50 ton ore pile on dump.
11		1.92	1.12	39.52	Grab of ore dump about 100 tons from drift.
12	11.0	.26	.18	5.38	Cut across vein in surface cut over sample No. 1 and 2.
13		.72	.76	15.16	Grab of 15 tons ore piled from surface cut where sample 12 was taken.
14		.07	.05	1.45	Grab of dump from 10 foot hole on east vein. 40 feet east of east cross cut.

DATE _____

DIVIDEND №3

DIVIDEND No. 4.

Dividendo No. 1

~~AGE~~ LINCOLN No 2

SALTED CAT

BUNKER HILL

ABE LINCOLN No. 4

ASE LINCOLN No. 5

AGE LINCOLN No. 3

TOLICHA

DOLORA

Landmark
Ex-1

Land Area No. 1

Land Mark

TELEMAN
FRAC

1130

~~BIOTITE~~

253

MINE

DATE

Owned by J. B. McWay - Reno - Nev.

J. J. Jordan Tonopah.

E. D. Yeiser Goldfield.

located July 1917.

First Discovery 1905 worked to 1909
on Claims now known as Pariscope.
adjacent Life Preserver Co West.

Wingfield & Zeb Kendall had option and
did some work on Life Preserver group
in 1917.

Option to Bob Highland in 1917.
5 days work. -

E. S. Harney had a lease & option
in $\frac{7}{8}$ just expired on account of
labor not performed. \$20,000 - 18 mos (15th Apr 27)
Equip. track rails - Ore bin B.S. Shop.

Good road. - $4\frac{1}{2}$ mi To Water for domestic use
H₂O? for mill use.

Un named Mng Dist or Tolachi Mng Dist.

Near R.R. Ancram Switch on T&T - $12\frac{1}{2}$ Miles

253
Item 1

MINE	LAND MARK GROUP	DATE	MINE	LAND MARK GROUP	DATE
8	Cut Across 4.8 Ft. Back S. Drift XC + 60 Ft. South All vein - 44 ft to fault.	1-15-21	1	Cut Across 8.5 Side XC & Back Dr 7.0 Ft. NW Side Vein. Broken Quartz - Mud seams - Silicified Rhyolite - Oxidized. (?) HW) - Sample 5' N. of 02 2' E @ 2.	1-14-20
9	Cut Across 7.7 Ft. S. Side E. XC. 21 Ft. W. of Br. Crushed zone of Rhyolite - Spots Silicified Red with Fe ₂ O ₃ .		2	Cut Across Back Dr 8 S Side XC. To Ft. 51.0, 7. Ft. Extension of sample 1 Same material. FN. Side Vein	
10	Grabs of 150 tons ore on dump from South Drift		3	Cut Across 6.1 Ft. Back South Drift XC + 10 Ft. South. All vein.	
11	Grabs Dump from Drift. South ± 100 tons.		4	Cut Across 6.7 Ft. Back S. Drift XC + 20 Ft. South All vein.	
12	Cut Across 11.0 Ft. Surface Cut W. Vein About over camp. No 1 & No 2 - All vein -		5	Cut Across 6.3 Ft. Back S. Drift XC + 30 Ft. South - N. Side R. Round High All vein.	
13	Grabs ± 15 tons ore from Surface Cut W. Vein. Same cuts as S.M. 12.		6	Cut Across 6.4 Ft. Back S. Drift XC + 42 Ft. South. - S Side R. All vein.	
14	Grabs Dump from 10 Ft. Hole Surface 40 Ft. E. of E. XC. E. Vein NW Side.		7	Cut Across 6.5 Ft. Back S. Drift XC + 50 Ft. All vein.	

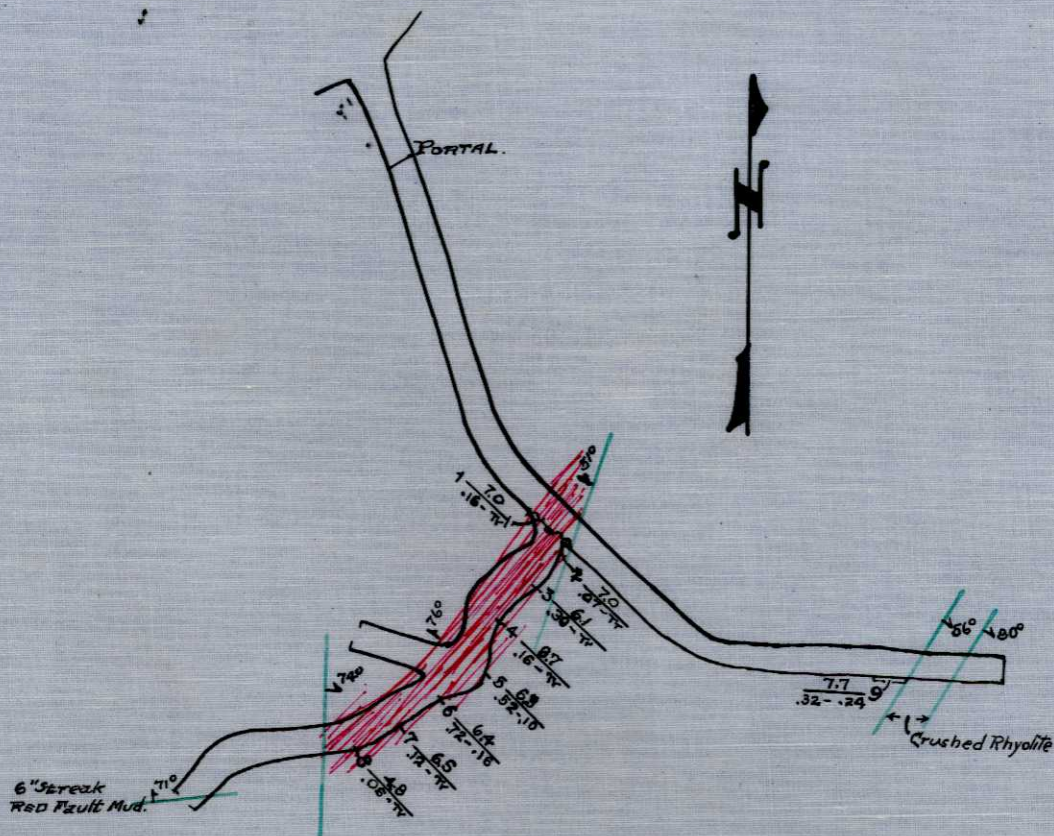

LAND MARK TUNNEL
 TOLICHA MINING DISTRICT
 NYE COUNTY, NEVADA.
 SCALE 1 IN = 40 FT. JAN. 16, 1921.

0 20 40 ft.

Drumton Survey By A.F.B.

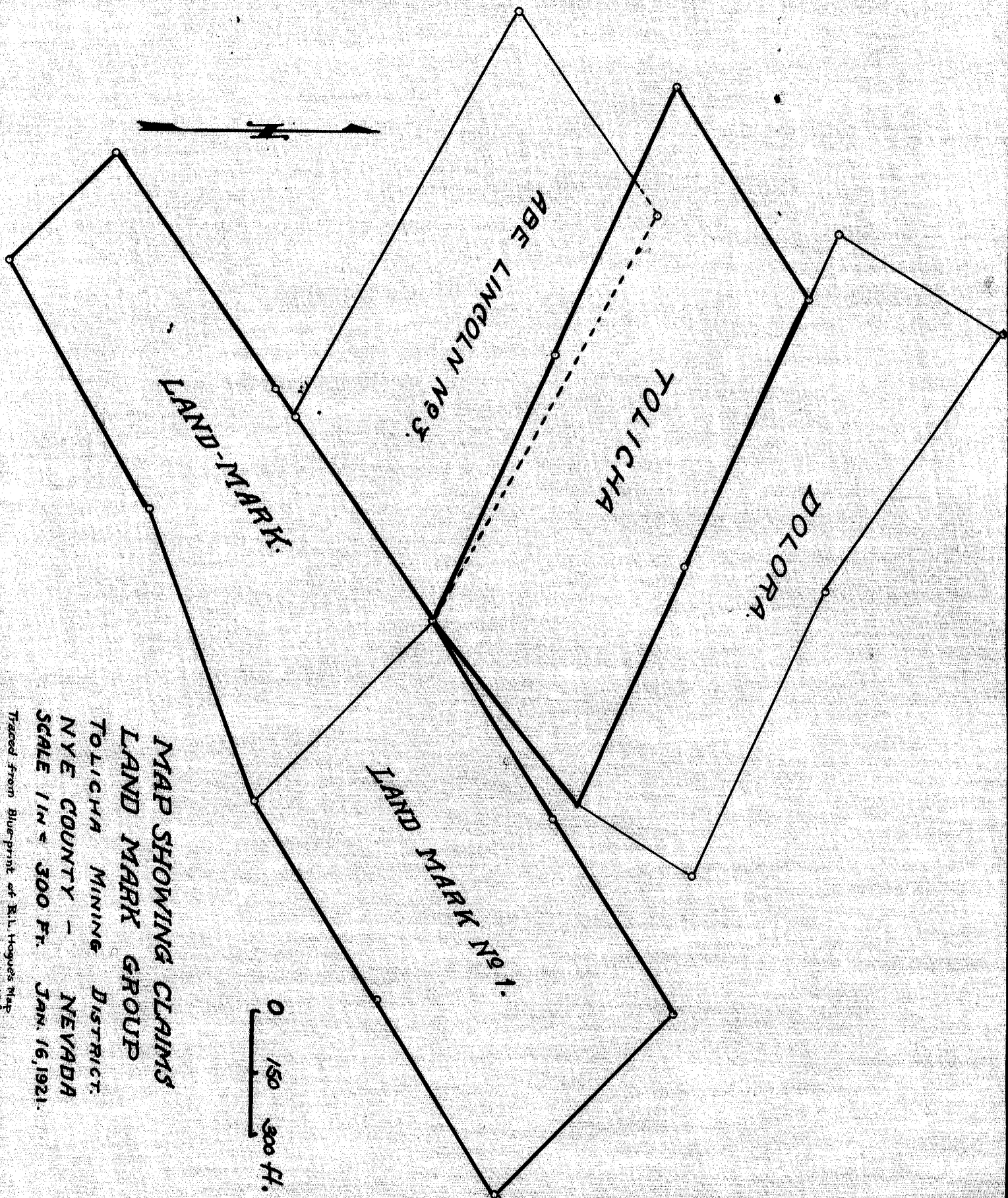

MAP SHOWING CLAIMS
LAND MARK GROUP

TOLICHA MINING DISTRICT
NYE COUNTY - NEVADA
SCALE 1 in = 300 FT. JAN. 16, 1921.

0 150 300 ft.

LAND MARK No. 1.

ABE LINCOLN No. 3.

TOLICHA

DOLORA

LAND-MARK.

