

4420 6000312

SILVER MOUNTAIN RESERVES  
NEVADA

SILVERBOW

H. Browne  
2903 Via Corbina  
San Clemente  
Calif —



FIRST CLASS

D. L. DAVIS  
1528 MICHIGAN AVE  
SALT LAKE CITY  
UTAH

Dudley L. Davis  
1528 Michigan Avenue  
Salt Lake City, Utah  
May 23, 1966

Mr. Jim Browne  
2903 Via Corbina  
San Clemente, California

Dear Jim:

Enclosed is the descriptive material necessary to your application for OME assistance for the exploration of Silver Mountain Reserves, Inc.

The suggested enclosures may be added to as you feel necessary but those listed will probably be adequate.

I am mailing the assay pulps and rejects under separate cover.

The OME examining officer says there is plenty of money for all projects in his district. Thus June will be an ideal time to apply since they will want to spend all they can before the end of the fiscal year for fear their next appropriation may be cut; at least, this is my analysis of the situation.

You should have me accompany the examining officer when he makes his visit so that I can explain the geological objectives of each exploration proposal. You should also be present but it will not be necessary for Mr. Lewis to be present.

Please make an extra copy of the completed application for my file. You never know when your copy may be lost, burned, or otherwise destroyed so an extra one in a different file is well worth the additional cost.

Do not hesitate to call on me if I can be of further assistance in this or any other project where I may help you.

With very best regards.

Yours truly,

Dudley L. Davis  
Registered Professional Engineer



Application for "O.M.E." Assistance

Silver Mountain Reserves, Inc, Silverbow, Nevada

Reference: O.M.E. 40

1. a- See copies of letters of refusal from two banks.  
b- None  
c- Cash
2. a- See copies of lease and option agreements for Silver Bend and New Strike claims. All other claims are held by possessory title.  
b- The property lies in sections 28, 29, 32, 33, 34, and 35, T.1 N., R. 49 E., M D M. All claims would be subject to government lien.  
c- Five copies of Form 52 are enclosed for each leased property.
3. a-b- Property maps are enclosed. All work was done prior to ownership by present management except for drilling done on the New Strike property.  
c- No accurate production records are available to the applicant.  
d- See Reinhardt report enclosed herewith.  
e- Ditto  
f- We expect to find ore in the Silver Bend lower adit where it will explore the vein under an area stoped above. Ore is reported from the Silver Dick shaft workings to be fifteen feet wide but the collar of the shaft has caved and requires retimbering. The stockwork area is a favorable geologic structure which we expect will contain silver-gold mineralization at depth. The vein which bounds this stockwork on the south has three inclined shafts which were developed by old-time miners and the dumps of which show some good silver ore. We believe that repair and retimbering these shafts is likely to reveal ore in the old workings. The basalt plug mapped by Reinhardt is bounded on the northwest by a mineralized vein structure where it cuts well altered rhyolite breccia. Thus the contact zone offers a good geologic environment for ore deposition. Silicified rhyolite on the hill at the northwest edge of the property on claims , Silver Mountain 37 and 39 has been partially explored by shallow adits; drilling is recommended to explore these silicified reefs at depth.  
g- Maps are enclosed which need not be returned.
4. a- Access from Tonopah, Nevada is via U. S. Hiway 6 easternly for 11 miles to the Sandia test area road; thence south for 16 miles on this road; thence northeasterly (left) on an improved dirt road past a windmill 20 miles to the property. An air strip lies 2½ miles from the camp near the center of the property. The road from camp to the Silver Bend mine is in poor condition but the remainder of the roads are in good condition.

Either Mr. Jim Browne, 2903 Via Corbina, San Clemente, California or Mr. Dudley L. Davis, 1528 Michigan Avenue, Salt Lake City, Utah will accompany the OME examiner to the property.

4. b- Tonopah, Nevada is the nearest supply point and is 47 miles from the property. The nearest railhead is at Sodaville which is 120 miles away.
5. a-1- Clean out and repair the lower adit of the Silver Bend workings and extend that level 200 feet northwesterly along the vein under the area stoped above. Higher values are expected where the cross vein intersects the main vein and northwesterly to the limit of the ore shoot. This adit should be driven not less than 5' by 7' in cross section. See plate OME No. 1 adapted from Reinhardt's report of 1964.
- 2- Repair collar of the Silver Dick shaft and make deeper workings accessible for sampling and geologic mapping. Retimber and erect headframe for hoisting men and materials.
- 3- Repair old shafts immediately south of the western stockwork area (Reinhardt's report) which show a strong vein with good silver mineralization in material on the dumps. This minor rehabilitation may disclose ore in these old workings.
- 4- Diamond drill to explore mineralized siliceous vein structures on the hill at Silver mountain numbers 37 and 39 where old time miners have driven shallow adits to partially explore these veins. Four holes 200 feet deep would be a minimum exploration effort here.
- 5- Prospect the stockwork area by twenty-five rotary drill holes 300 feet deep and save all cuttings for assay. Drill roads must be made by bulldozer.
- 6- Drill inclined diamond drill holes to prospect the contact between thebasalt plug (Reinhardt's report) and the mineralized shear zone to the north. Three holes of 150 feet length each would be minimal.
- 7- Drill twenty-five vertical rotary drill holes on the Silver Valley group to prospect the main mineralized zone west of the Blue Horse mine. Two sites are already prepared; more bulldozer work is needed for further site preparation.
5. b- No access road to be built; however, the road to the Silver Bend mine requires repair. For the work contemplated, dozer repair in the amount of 10 hours is deemed sufficient.
- c- Work can be started within one month after approval has been given. Progress on the underground work will be five linear feet per day; hence two months (of 20 working days each) would be adequate to this phase of the program. Drilling can be done simultaneously so that the entire phase 1 program can be completed in six months.
6. Operations have been contracted by E. E. Lewis, Inc, P. O. Box 1481, Grand Junction, Colorado who are well-known in that area as mining contractors. The supervision of drilling, geological mapping, and engineering control will be supplied by Dudley L. Davis, 1528 Michigan Avenue, Salt Lake City, Utah who is a registered engineer and consulting geologist of twenty-five years experience.



7. All work will be contracted. Pre-contract negotiations with Lewis and Davis have resulted in the prices quoted below. The code figures refer to exploration described under section 5.

a-1. Drifting underground will cost \$50.00 per linear foot for labor with rail, pipe, and timber extra. These supplies are estimated to cost to amount to an additional \$5.00 per foot.

a-2,3- Shaft repair and retimbering contract cost for a 3-man crew is \$100 per day plus materials.

a-4,6- Diamond drilling will cost \$10.00 per linear foot for "AX" (minimum acceptable) size.

a-5,7- Rotary drilling will cost \$1.75 per linear foot.

5-b- Road repair and drill site preparation will cost \$20 per hour for dozer and operator. Fuel and grease will be about \$1.25 per hour extra.

7. b- Supervision, engineering and geological consultant will be furnished by Dudley L. Davis for \$1500 per month.

c,d- Furnished by contractors.

e- None

f- None

g- Assaying will amount to an estimated 1,000 assays for silver and gold which will cost \$3.00 each.

Summary of Costs--Phase 1				
Item Form 40	Unit Cost	Number of Units	Total Cost	Estimated Time
5a1 Dozer Wk	\$20 /hr	35	\$700	5 days
5a-1 drift	\$50 / ft	200	10,000	60 "
a-2,3	\$100 / day	40	4,000	60 "
Supplies	Timber and other		2,500	
a-4,6	\$ 10 /ft	1250	12,500	61 "
a-5,7	\$1.75	15,000	25,250	50 "
7. b	\$1500 / month	4	6,000	120 "
7. g	\$3.00 each	1,000	3,000	

Total cost, phase 1 \$ 63,950 180 days

If the result of phase 1 is encouraging, phase 2 will be done as follows:

5. a-4,6-	\$10.00 /ft	1,000	\$10,000	90 days
a-5-*	50.00 / ft	1,000	50,000	120 "
a-6-**	200.00 / ft	200	40,000	180 "
7. b	1500.00 / mo	9,000	9,000	180 "
7. g	\$3.00	500	15,000	
Dozer Work	\$20.00 / hr	50	1,000	
Supplies, mine timber, pipe, rail, etc			5,000	

Total cost, phase 2 129,000

Grand Total Cost \$192,950

\* If ore is cut by diamond drilling, a shaft should be sunk to investigate.

\*\*If ore is found in dotary drilling, it should be checked by underground work.

Enclosures

Reinhardt report complete with maps

Claim maps from Gray's report

Result of drilling on the New Strike claims with assays

Complete list of claims with recording data (Book and Page).

Copies of leases from both Schlecht and Huntley.

Five copies of Form MME 52 signed by lessors (total of ten).

Copies of letters from two banks refusing to loan money for the project.

Stratigraphic section--Fig. 4, Gray's report.

General Location map, Fig. 1, Gray's report.



## Application for "O. M. E. " Assistance

AIRLINE METALS

Silverbow, Nevada

Reference: O. M. E. 40

1. a - See copies of letters of refusal from two banks.  
b - None.  
c - Cash.
2. a - See copies of lease and option agreements for Silver Bend, Tickabo, Silver Dick, Towack, Helen, Silver Dan, Silver Valley and Silver Mountain claims.  
b - The property lies in Sections 25, 26, 27, 28, 29, 32, 33, 34, 35, and 36, T. 1 N., R 49 E., M D M. All claims would be subject to government lien.  
c - Five copies of Form 52 are enclosed for each leased property.
3. a-b - Property maps are enclosed. All work was done prior to ownership by present management except for drilling done on the New Strike property.  
c - No accurate production records are available to the applicant.  
d - See Reinhardt report enclosed herewith.  
e - Ditto.  
f - We expect to find ore in the Silver Bend lower adit where it will explore the vein under an area stoped above. Ore is reported from the Silver Dick shaft workings to be fifteen feet wide but the collar of the shaft has caved and requires retimbering. The stockwork area is a favorable geologic structure which we expect will contain silver-gold mineralization at depth. The vein which bounds this stockwork on the south has three inclined shafts which were developed by old-time miners and the dumps of which show some good silver ore. We believe that repair and retimbering these shafts is likely to reveal ore in the old workings. The basalt plug mapped by Reinhardt is bounded on the northwest edge by a mineralized vein structure where it cuts well altered rhyolite breccia. Thus the contact zone offers a good geologic environment for ore deposition. Silicified rhyolite on the hill at the northwest edge of the property on claims Silver Mountain 39 and 41 has been partially explored by shallow adits; drilling is recommended to explore these silicified reefs at depth.  
g - Maps are enclosed which need not be returned.
4. a - Access from Tonopah, Nevada, is via U. S. Hiway 6 easternly for 11 miles to the Sandia test area road; thence south for 16 miles on this road; thence northeasterly (left) on an improved dirt road past a windmill 20 miles to the property. An air strip lies 2-1/2 miles from the camp near the center of the property. The road from camp to the Silver Bend mine is in poor condition but the remainder of the roads are in good condition.

Mr. Dudley L. Davis, 1528 Michigan Avenue, Salt Lake City, Utah, will accompany the OME examiner to the property.



4. b - Tonopah, Nevada, is the nearest supply point and is 47 miles from the property. The nearest railhead is at Sodaville which is 120 miles away.
5. a-1 - Clean out and repair the lower adit of the Silver Bend workings and extend that level 200 feet northwesterly along the vein under the area stoped above. Higher values are expected where the cross vein intersects the main vein and northwesterly to the limit of the ore shoot. This adit should be driven not less than 5' by 7' in cross section. See plate OME No. 1 adapted from Reinhardt's report of 1964.
  - 2 - Repair collar of the Silver Dick shaft and make deeper workings accessible for sampling and geologic mapping. Retimber and erect headframe for hoisting men and materials.
  - 3 - Repair old shafts immediately south of the western stockwork area (Reinhardt's report) which show a strong vein with good silver mineralization in material on the dumps. This minor rehabilitation may disclose ore in these old workings.
  - 4 - Diamond drill to explore mineralized siliceous vein structures on the hill at Silver Mountain numbers 37 and 39 where old time miners have driven shallow adits to partially explore these veins. Four holes 200 feet deep would be a minimum exploration effort here.
  - 5 - Prospect the stockwork area by twenty-five rotary drill holes 300 feet deep and save all cuttings for assay. Drill roads must be made by bulldozer.
  - 6 - Drill inclined diamond drill holes to prospect the contact between the basalt plug (Reinhardt's report) and the mineralized shear zone to the north. Three holes of 150 feet length each would be minimal.
  - 7 - Drill twenty-five vertical rotary drill holes on the Silver Valley group to prospect the main mineralized zone west of the Blue Horse mine. Two sites are already prepared; more bulldozer work is needed for further site preparation.
- b - No access road to be built; however, the road to the Silver Bend mine requires repair. For the work contemplated, dozer repair in the amount of ten hours is deemed sufficient.
- c - Work can be started within one month after approval has been given. Progress on the underground work will be five linear feet per day; hence two months (or 20 working days each) would be adequate to this phase of the program. Drilling can be done simultaneously so that the entire phase 1 program can be completed in six months.
6. Operations have been contracted by E. E. Lewis, Inc., P. O. Box 1481, Grand Junction, Colorado, who are well-known in that area as mining contractors. The supervision of drilling, geological mapping, and engineering control will be supplied by Dudley L. Davis, 1528 Michigan Avenue, Salt Lake City, Utah, who is a registered engineer and consulting geologist of twenty-five years experience.
7. All work will be contracted. Pre-contract negotiations with Lewis and Davis have resulted in the prices quoted below. The code figures refer to exploration described under Section 5.
  - a-1 - Drifting underground will cost \$50.00 per linear foot for labor with rail, pipe, and timber extra. These supplies are estimated to cost to amount to an additional \$5.00 per foot.



7. a-2, 3 - Shaft repair and retimbering contract cost for a 3-man crew is \$100 per day plus materials.
- a-4, 6 - Diamond drilling will cost \$10.00 per linear foot for "AX" (minimum acceptable) size.
- a-5, 7 - Rotary drilling will cost \$1.75 per linear foot.
- 5-b - Road repair and drill site preparation will cost \$20 per hour for dozer and operator. Fuel and grease will be about \$1.25 per hour extra.
7. b - Supervision, engineering and geological consultant will be furnished by Dudley L. Davis for \$1500 per month.
- c, d - Furnished by contractors.
- e - None.
- f - None.
- g - Assaying will amount to an estimated 1,000 assays for silver and gold which will cost \$3.00 each.

## Summary of Costs--Phase 1

Item Form 40	Unit Cost	Number of Units	Total Costs	Estimated Time
5a1 Dozer Wk	\$20 /hr	35	\$700	5 days
5a-1 drift	\$50 / ft	200	10,000	60 "
a-2, 3	\$100 / day	40	4,000	60 "
Supplies	Timber and other		2,500	
a-4, 6	\$ 10 / ft	1250	12,500	61 "
a-5, 7	\$1.75	15,000	25,250	50 "
7. b	\$1500 / month	4	6,000	120 "
7. g	\$3.00 each	1,000	3,000	
Total cost, phase 1			\$63,950	180 days
If the result of phase 1 is encouraging, phase 2 will be done as follows:				
5. a-4, 6-	\$10.00 / ft	1,000	\$10,000	90 days
a-5-*	50.00 / ft	1,000	50,000	120 "
a-6-**	200.00 / ft	200	40,000	180 "
7. b	1500.00 / mo	6	9,000	180 "
7. g	\$3.00	500	15,000	
Dozer Work	\$20.00 / hr	50	1,000	
Supplies, mine timber, pipe, rail, etc.			5,000	
Total cost, phase 2			\$129,000	
Grand Total Cost			\$192,950	

\* If ore is cut by diamond drilling, a shaft should be sunk to investigate.

\*\* If ore is found in rotary drilling, it should be checked by underground work.

ENCLOSURES

1. List of General and Limited Partners.
2. Copies of letters from two banks refusing to loan money to project.
3. Copy of lease with Schlecht.
4. Complete list of claims with recording data.
5. Five copies of Form MME 52 signed by lessor.
6. General location map.
7. Stratigraphic section.
8. Exploration location map.
9. Reinhardt report.
10. Silver Mountain Reserves assay reports.



XERO COPY

XERO COPY

XERO COPY

XERO COPY

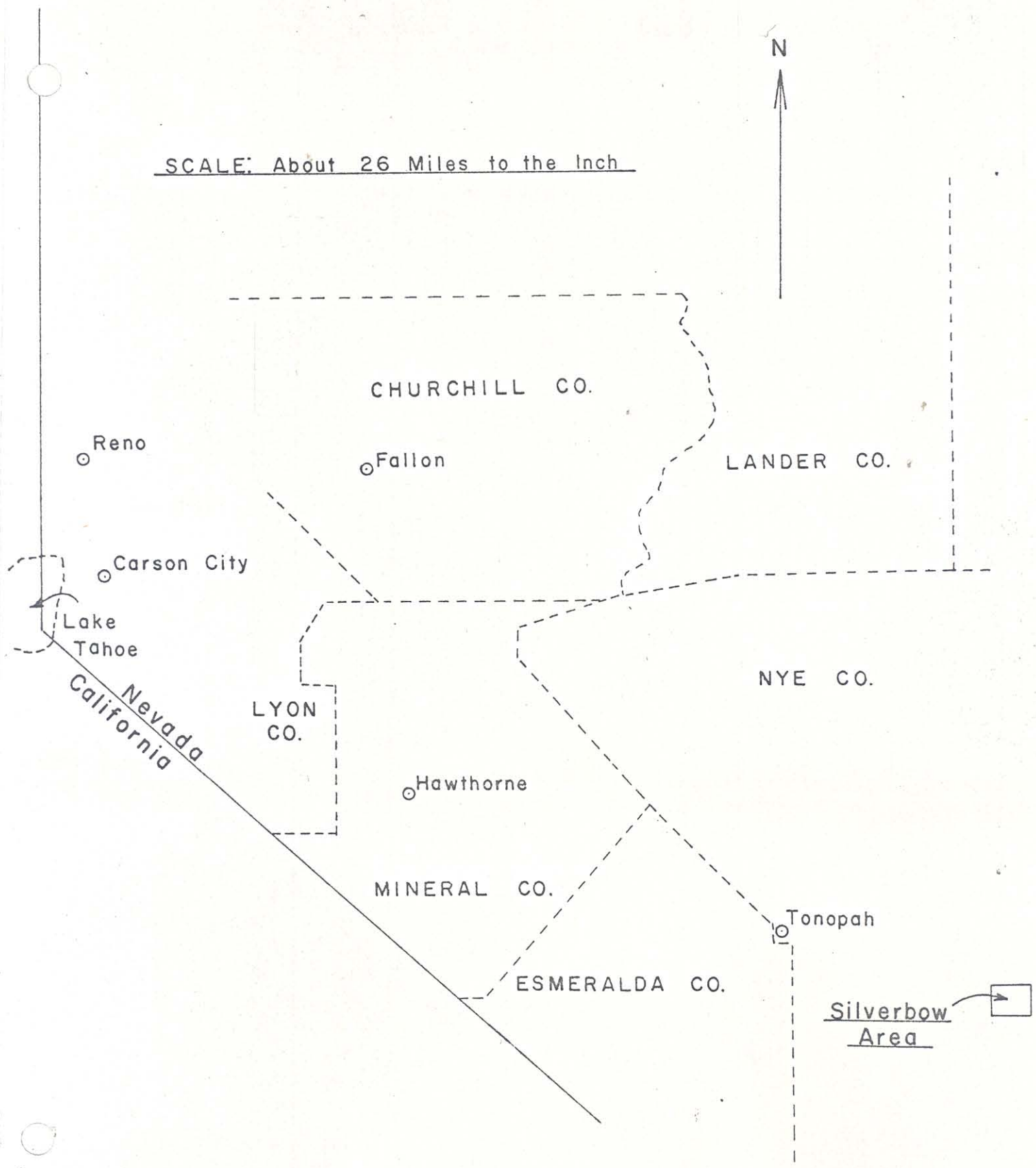

GENERAL LOCATION MAP  
FIG. I

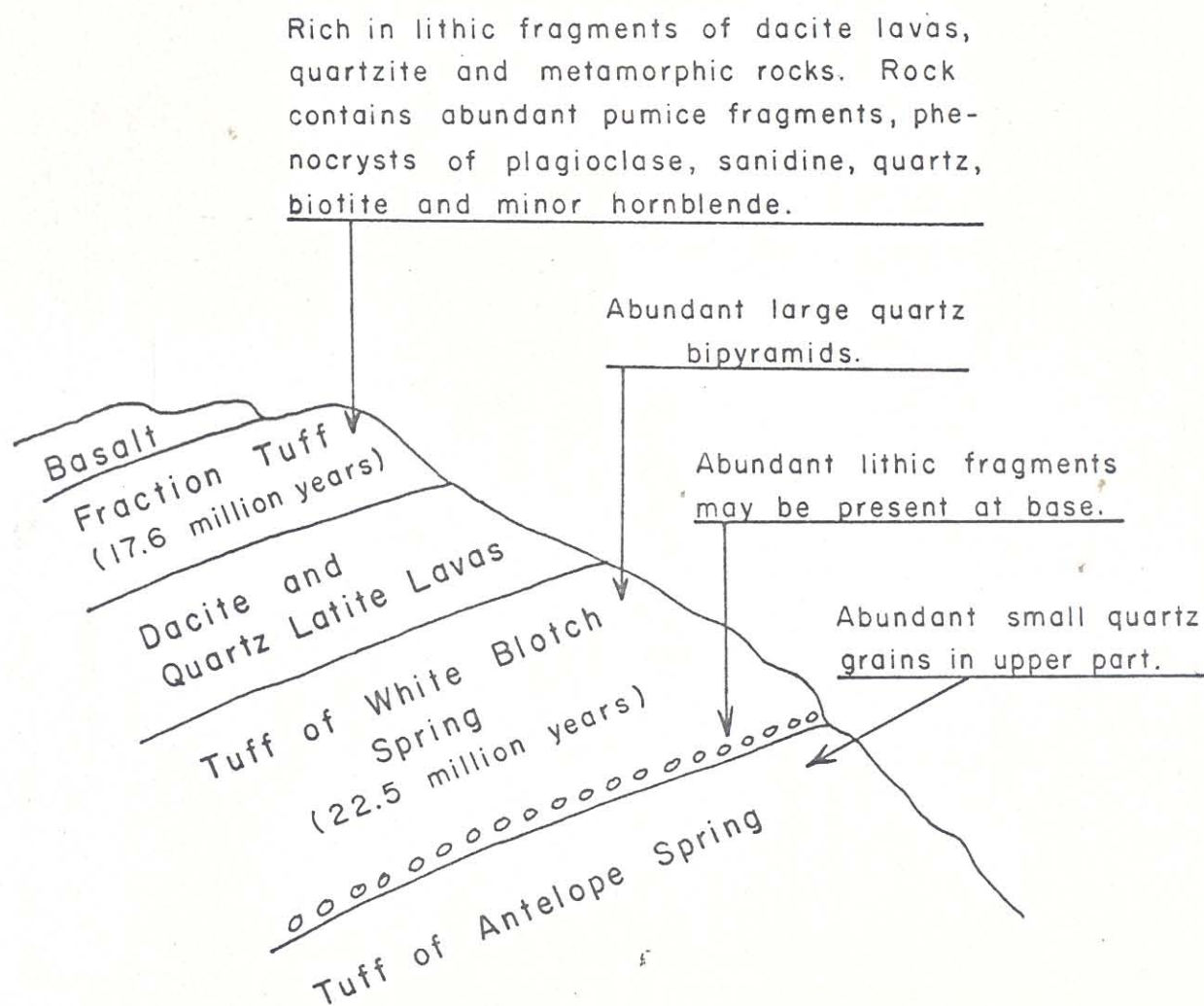

### Local Stratigraphic Section

After field sketch by Ernest Anderson  
and Bart Ekren of the U.S.G.S.

FIG. 4



LIST OF CLAIMS WITH RECORDING DATA

- 1
- 2
- 3
- 4
- 5
- 6
- 7
- 8
- 9
- 10
- 11
- 12
- 13
- 14
- 15
- 16
- 17
- 18
- 19
- 20
- 21
- 22
- 23
- 24
- 25
- 26
- 27
- 28
- 29
- 30
- 31
- 32

Certificate of Location  
Towack No. 1  
Located December 23, 1963  
Certificate of Location recorded March 10, 1964  
File No. 47411, Book 68, Official Records, page 196  
Located By Dan Sheek

Certificate of Location  
Towack No. 2  
Located December 28, 1963  
Certificate of Location recorded March 10, 1964  
File No. 47412, Book 68, Official Records, page 197  
Located by Dan Sheek

Certificate of Location  
Towack No. 3  
Located December 29, 1963  
Certificate of Location recorded March 10, 1964  
File No. 47413, Book 68, Official Records, page 198  
Located by Dan Sheek

Certificate of Location  
Towack No. 4  
Located December 30, 1963  
Certificate of Location recorded March 10, 1964  
File No. 47414, Book 68, Official Records, page 199  
Located by Dan Sheek

Certificate of Location  
Helen  
Located December 17, 1963  
Certificate of Location Recorded March 10, 1964  
File No. 47415, Book 68, Official Records, page 200  
Located by Dan Sheek

Certificate of Location  
Silver Dan No. 1  
Located December 16, 1963  
Certificate of Location recorded March 10, 1964  
File No. 47416, Book 68, Official Records, page 201  
Located by Dan Sheek

Certificate of Location  
Silver Dan No. 2  
Located December 16, 1963  
Certificate of Location recorded March 10, 1964  
File No. 47417, Book 68, Official Records, page 202  
Located by Dan Sheek

- 1 Certificate of Location  
Silver Dan No. 3  
2 Located December 17, 1963  
3 Certificate of Location recorded March 10, 1964  
4 File No. 47418, Book 68, Official Records, page 203  
5 Located by Dan Sheek
- 6 Certificate of Location  
Silver Dan No. 4  
7 Located December 17, 1963  
8 Certificate of Location recorded March 10, 1964  
9 File No. 47419, Book 68, Official Records, page 204  
10 Located by Dan Sheek
- 11 Certificate of Location  
Silver Bend No. 1, located November 28, 1963  
12 Certificate of Location recorded February 26, 1964  
13 File No. 47306, Book 68, Official Records, page 61  
14 Located by Richard N. Hayes and L. W. Schlecht
- 15 Certificate of Location  
Silver Bend No. 2  
16 Located November 28, 1963  
17 Certificate of Location recorded February 26, 1964  
18 File No. 47307, Book 68, Official Records, page 62  
19 Located by Richard N. Hayes and L. W. Schlecht
- 20 Certificate of Location  
Tickabo No. 1  
21 Located November 27, 1963  
22 Certificate of Location recorded February 26, 1964  
23 File No. 47308, Book 68, Official Records, page 63  
24 Located by Richard N. Hayes and L. W. Schlecht
- 25 Certificate of Location  
Tickabo No. 2  
26 Located November 27, 1963  
27 Certificate of Location recorded February 26, 1964  
28 File No. 47309, Book 68, Official Records, page 64  
29 Located by Richard N. Hayes and L. W. Schlecht
- 30 Certificate of Location  
Tickabo No. 3  
31 Located November 27, 1963  
32 Certificate of Location recorded February 26, 1964  
File No. 47310, Book 68, Official Records, page 65  
Located by Richard N. Hayes and L. W. Schlecht
- 33 Certificate of Location  
Tickabo No. 4  
Located November 27, 1963  
Certificate of Location recorded February 26, 1964  
File No. 47311, Book 68, Official Records, page 66  
Located by Richard N. Hayes and L. W. Schlecht



- 1 Certificate of Location  
2 Tickabo No. 5  
3 Located December 9, 1963  
4 Certificate of Location recorded February 26, 1964  
5 File No. 47312, Book 68, Official Records, page 67  
6 Located by Richard N. Hayes and L. W. Schlecht
- 7 Certificate of Location  
8 Tickabo No. 6  
9 Located December 9, 1963  
10 Certificate of Location recorded February 26, 1964  
11 File No. 47313, Book 68, Official Records, page 68  
12 Located by Richard N. Hayes and L. W. Schlecht
- 13 Certificate of Location  
14 Silver Dick  
15 Located November 30, 1963  
16 Certificate of Location recorded February 26, 1964  
17 File No. 47314, Book 68, Official Records, page 69  
18 Located by Richard N. Hayes and L. W. Schlecht
- 19 Proof of Labor  
20 Claim: Silver Dick  
21 File No. 51828, Book 78, Official Records, page 424  
22 June 1, 1965  
23 Listed owners: S & H Incorporated and L. W. Schlecht.
- 24 Proof of Labor  
25 Claims: Towack No. 1, Towack No. 2, Towack No. 3,  
26 Towack No. 4  
27 June 1, 1965  
28 File No. 51829, Book 78, Official Records, page 425  
29 Listed Owners: S & H Incorporated and L. W. Schlecht
- 30 Proof of Labor  
31 Claims: Helen, Silver Dan No. 1, Silver Dan No. 2,  
32 Silver Dan No. 3, Silver Dan No. 4,  
June 1, 1965  
File No. 51830, Book 78, Official Records, page 426  
Listed owners: S & H Incorporated and L. W. Schlecht
- Proof of Labor  
Claims: Tickabo No. 1, Tickabo No. 2, Tickabo No. 3,  
Tickabo No. 4, Tickabo No. 5, Tickabo No. 6  
June 1, 1965  
File No. 51831, Book 78, Official Records, page 427  
Listed owners: S & H Incorporated and L. W. Schlecht
- Proof of Labor  
Claims: Silver Bend, Silver Bend No. 1, Silver Bend No. 2  
June 1, 1965  
File No. 51832, Book 78, Official Records, page 428  
Listed owners: S & H Incorporated and L. W. Schlecht



1 Mining Deed, dated January 2, 1964  
2 File No. 47208, Book 67, Official Records, page 466  
3 L. W. Schlecht and Margaret D. Schlecht, and Richard  
4 N. Hayes and Sophie N. Hayes, to S & H Incorporated  
(Relates to Silver Bend claim only.)

5 Mining Deed  
6 A. Dan Sheek to S & H Incorporated  
7 File No. 48473, Book 70, Official Records, page 517  
(Relates to Towack No. 1, Towack No. 2, Towack No. 3,  
8 Towack No. 4, Helen, Silver Dan No. 1, Silver Dan  
9 No. 2, Silver Dan No. 3, Silver Dan No. 4.)

10 Deed of Mining Claims  
11 File No. 46518, Book 64, Official Records, page 21  
12 Phillip Meyer and Louis Meyer to Richard N. Hayes and  
13 L. W. Schlecht  
(Relates to Silver Bend only.)

14 Trustee's Deed  
15 In the Matter of S & H Incorporated, Bankrupt.  
16 United States District Court (Nevada) #BK-65-43  
17 File No. 54435, December 28, 1965, Book 84, Official  
18 Records, page 242, also recorded as File No. 52884  
19 on August 23, 1965, in Book 81, Official Records,  
20 page 157  
(Relates to Parcels A. & B., but does not include Silver  
Bend.)

21 Proof of Labor  
22 Claims: Silver Bend, Silver Bend No. 1, Silver Bend No. 2,  
23 Silver Bend No. 3  
24 July 26, 1966  
25 File No. 57025, Book 89, Official Records, page 268  
26 Assigned owners: Airline Metals Company

27 Proof of Labor  
28 Claims: The Helen, Silver Dan No. 1, Silver Dan No. 2, Silver  
29 Dan No. 3, Silver Dan No. 4  
30 July 26, 1966  
31 File No. 57027, Book 89, Official Records, page 270  
32 Assigned owners: Airline Metals Company

Proof of Labor  
Claims: Tickabo No. 1, Tickabo No. 2, Tickabo No. 3,  
Tickabo No. 4, Tickabo No. 5, Tickabo No. 6  
July 26, 1966  
File No. 57028, Book 89, Official Records, page 271  
Assigned owners: Airline Metals Company

Proof of Labor  
Claim: Silver Dick  
July 26, 1966  
File No. 57029, Book 89, Official Records, page 272  
Assigned owners: Airline Metals Company



1 Proof of Labor

2 Claims: Towack No. 1, Towack No. 2, Towack No. 3,  
Towack No. 4

3 July 26, 1966

4 File No. 57030, Book 89, Official Records, page 273

5 Assigned Owners: Airline Metals Company

6 Certificate of Location

7 Silver Mountain Nos. 11 through 45, inclusive

8 Located February 28, 1966, through March 1, 1966

9 Certificate of Location recorded May 6, 1966

10 File Nos. 55799 through 55833, Book 87, Official Records,  
pages 4 through 38

11 Located by E. V. Cook

12 Certificate of Location

13 Silver Valley Nos 1 through 26, inclusive

14 Located February 21, 1966

15 Certificate of Location recorded May 6, 1966

16 File Nos. 55834 through 55859, Book 87, Official Records,  
pages 39 through 64

17 Located by E. V. Cook

8.30.66

Dudley -

By God we  
finally did it!Sending only the  
important items -

Jim Browne

New Address &amp; Phone

30644 Calle Chuesa  
San Juan Capistrano

714 493 1228



78 424

# PROOF OF PERFORMANCE AND COMPLETION OF ANNUAL ASSESSMENT WORK

STATE OF Nevada Colorado ss.  
County of Nye Mesa

The undersigned in whose behalf the following described work was performed or improvements made, certifies that at least \$200.00 Dollars were expended, and/or the following labor expended or improvements made having a value thereof, consisting of:

Head frame repairs, underground exploration  
Sampling  
(Describe Character and Location of Expenditures or Labor or Improvements)

were performed and made upon the Silver Duck

(Insert Name(s) of Claim(s))

situated in the Silverbow Mining District of the County of Nye  
State of Nevada, during the year ending 12:00 Noon, September 1, 1965.

The work described above was performed on from 1/1/64 to 12/31/65  
(Insert Dates that Work Performed)  
by A. H. Incorporated Nevada Corporation  
(Insert Names of Persons, Corporation or Contractor who Performed the Work or made the Improvements.)

Such expenditure was made by or at the expense of A. H. Incorporated  
Nevada Corporation and L. W. Schlecht  
owner(s) of said claim(s) for the purpose of holding said claim(s).

L. W. Schlecht  
(Signature of Person Certifying the Above)  
Subscribed and sworn to before me this 25th day of May, 1965  
Alvin Anderson  
NOTARY PUBLIC  
My Commission Expires 8/28/65  
OR  
WITNESS  
WITNESS

Recorder's Stamp  
File No. 51828  
Filed for record at request of  
L. W. Schlecht  
June 1, 1965  
at 1:00 minutes past 1 o'clock  
P.M. and recorded in Book 78  
of Official Records, page 424  
Nye County, Nevada  
Margaret H. Brook  
County Recorder

Proof of Performance and Completion of Annual Assessment Work must be Recorded within 60 days after Completion of work and must be Sworn to before a Notary Public or subscribed to by Two Competent Witnesses. (NRS 517.230)



# PROOF OF PERFORMANCE AND COMPLETION OF ANNUAL ASSESSMENT WORK

STATE OF Colorado  
County of Mesa ss.

The undersigned in whose behalf the following described work was performed or improvements made, certifies that at least \$500.00 Dollars were expended, and/or the following labor expended or improvements made having a value thereof, consisting of:

Open cut exploration & sampling  
(Describe Character and Location of Expenditures or Labor or Improvements)

were performed and made upon the Silver, Silver Duff, Silver Duff #1, Silver Duff #2, Silver Duff #3 and Silver Duff #4  
(Insert Name(s) of Claim(s))

situated in the Silver Mining District of the County of Mesa State of Nevada, during the year ending 12:00 Noon, September 1, 1965.

The work described above was performed on from 6/22/1964 to 6/30/1965  
(Insert Dates that Work Performed)  
by M. H. L. Incorporated  
(Insert Names of Persons, Corporation or Contractor who Performed the Work or made the Improvements.)

Such expenditure was made by or at the expense of M. H. L. Incorporated  
and L. W. Schlecht  
owner(s) of said claim(s) for the purpose of holding said claim(s).

(Signature of Person Certifying the Above)

Subscribed and sworn to before me this 25th day of May, 1965

Alvin Anderson  
NOTARY PUBLIC  
My Commission Expires 8/28/65

OR

WITNESS

WITNESS

## Recorder's Stamp

File No. 51830  
Filed for record at request of  
L. W. Schlecht  
June 1, 1965  
at 1 minutes past 1 o'clock  
P. M. and recorded in Book 78  
of Official Records, page 426  
This County, Nevada  
Margaret H. Booth  
County Recorder

Proof of Performance and Completion of Annual Assessment Work must be Recorded within 60 days after Completion of work and must be Sworn to before a Notary Public or subscribed to by Two Competent Witnesses. (NRS 517.230)



# PROOF OF PERFORMANCE AND COMPLETION OF ANNUAL ASSESSMENT WORK

STATE OF Colorado  
County of Mesa ss.

The undersigned in whose behalf the following described work was performed or improvements made, certifies that at least \$800.00 Dollars were expended, and/or

the following labor expended or improvements made having a value thereof, consisting of:

Exploration, Sampling and Mill Site work  
(Describe Character and Location of Expenditures or Labor or Improvements)

were performed and made upon Lichabot #1, Lichabot #2, Lichabot #3, Lichabot #4, Lichabot #5, and Lichabot #6  
(Insert Name(s) of Claim(s))

situated in the Silverton Mining District of the County of Yuma State of Nevada, during the year ending 12:00 Noon, September 1, 196 5.

The work described above was performed on from 11/4 to 11/30, 1965  
(Insert Dates that Work Performed)  
by A. H. Incorporated a Nevada Corporation  
(Insert Names of Persons, Corporation or Contractor who Performed the Work or made the Improvements.)

Such expenditure was made by or at the expense of A. H. Incorporated a Nevada Corporation and T. W. Spelbeck  
owner(s) of said claim(s) for the purpose of holding said claim(s).

(Signature of Person Certifying the Above)

Subscribed and sworn to before me this 25th day of May, 19 65  
Alvin Anderson  
NOTARY PUBLIC  
My Commission Expires 8/28/65

OR

WITNESS

WITNESS

## Recorder's Stamp

51831  
Filed for record at request of  
L. W. Schlecht  
June 1, 1965  
at \_\_\_\_\_ minutes past 1 o'clock  
P.m. and recorded in Book 78  
of Official Records, Page 427  
Yuma County, Nevada  
Margaret H. Booth  
County Recorder



# PROOF OF PERFORMANCE AND COMPLETION OF ANNUAL ASSESSMENT WORK

STATE OF Nevada Colorado  
County of Esmeralda Mesa ss.

The undersigned in whose behalf the following described work was performed or improvements made, certifies that at least 800<sup>00</sup> Dollars were expended, and/or the following labor expended or improvements made having a value thereof, consisting of:

Drilling 75 ft of Drift & Tying 150 ft of Track  
(Describe Character and Location of Expenditures or Labor or Improvements)

were performed and made upon Silver Bow, Silver Bow #1 and Silver Bow #2  
(Insert Name(s) of Claim(s))

situated in the Silver Bow Mining District of the County of Nye State of Nevada, during the year ending 12:00 Noon, September 1, 1965.

The work described above was performed on August 12, 1965 by A. H. Incorporated  
(Insert Dates that Work Performed)  
(Insert Names of Persons, Corporation or Contractor who Performed the Work or made the Improvements.)

Such expenditure was made by or at the expense of A. H. Incorporated owner(s) of said claim(s) for the purpose of holding said claim(s).

(Signature of Person Certifying the Above)

Subscribed and sworn to before me this 25th day of May, 1965

Albin Andersen  
NOTARY PUBLIC  
My Commission Expires 8/25/65

OR

WITNESS

WITNESS

## Recorder's Stamp

51832

File No. 51832  
Filed for record at request of L. W. Schlecht  
June 1, 1965  
of Esmeralda County, Nevada  
P. M. and recorded in Book 78  
of Official Records 428  
Margaret H. Barth  
County Recorder

Proof of Performance and Completion of Annual Assessment Work must be Recorded within 60 days after Completion of work and must be Sworn to before a Notary Public or subscribed to by Two Competent Witnesses. (NRS 517.230)



# PROOF OF PERFORMANCE AND COMPLETION OF ANNUAL ASSESSMENT WORK

STATE OF Nevada Colorado  
County of Washoe Nevada SS.

The undersigned in whose behalf the following described work was performed or improvements made, certifies that at least 500 Dollars were expended, and/or the following labor expended or improvements made having a value thereof, consisting of:

Open cut Exploration Sampling & Road work  
(Describe Character and Location of Expenditures or Labor or Improvements)

were performed and made upon Truck #1, Truck #2, Truck #3 and Truck #4  
(Insert Name(s) of Claim(s))

situated in the Silver Bow Mining District of the County of Nye State of Nevada, during the year ending 12:00 Noon, September 1, 1965.

The work described above was performed on April 30, 1965 by S. H. Incorporated in Nevada Corporation  
(Insert Dates that Work Performed)  
(Insert Names of Persons, Corporation or Contractor who Performed the Work or made the Improvements.)

Such expenditure was made by or at the expense of S. H. Incorporated a Nevada Corporation and L. W. Schlecht owner(s) of said claim(s) for the purpose of holding said claim(s).

(Signature of Person Certifying the Above)

Subscribed and sworn to before me this 25th day of May, 1965  
Alvin Anderson  
NOTARY PUBLIC  
My Commission Expires 8/28/65

OR

WITNESS

WITNESS

## Recorder's Stamp

51829

Filed for record at request of  
L. W. Schlecht  
June 1, 1965  
at 10 minutes past 10 o'clock  
P.m. and recorded in Book 78  
of Official Records 425  
Washoe County, Nevada  
Margaret H. Booth  
County Recorder

64 FEB 21

DEED OF MINING CLAIM

THIS INDENTURE, made the 21st day of November, 1963, between  
PHILIP MEYER and LOUIS MEYER, of Tonopah, Nevada, the parties of the  
first part, and RICHARD N. HAYES and LOU SCHLECHT, of P. O. Box  
963, Grand Junction, Colorado, the parties of the second part,

WITNESSETH:

That the parties of the first part, in consideration of the sum of  
TEN DOLLARS (\$10.00), lawful money of the United States of America, to  
them in hand paid by the parties of the second part, the receipt whereof is  
hereby acknowledged, do by these presents grant, bargain and sell unto the  
parties of the second part, their heirs and assigns, all that certain unpatented  
lode mining claim situate in the Silver Bow Mining District of the County of  
Nye, State of Nevada, described as follows, to-wit:

The SILVER BEND unpatented lode mining claim.

TOGETHER with all the right, privileges and franchises thereto  
incident, appendant, and appurtenant, or therewith usually had and enjoyed,  
and also all and singular the tenements, hereditaments, and appurtenances  
thereto belonging, or in anywise appertaining, and the rents, issues and  
profits thereof.

TO HAVE AND TO HOLD the said premises appurtenances and  
privileges, unto the parties of the second part, their heirs and assigns,  
forever.

IN WITNESS WHEREOF, the parties of the first part have executed  
these presents the day and year first above written.

Philip Meyer  
Louis Meyer



64 Nov 22

STATE OF NEVADA )  
COUNTY OF NYE ) ss.

On the 21st day of November, 1963, before me, the undersigned Notary Public in and for the County and State aforesaid, personally appeared PHILIP MEYER and LOUIS MEYER, known to me to be the persons named in and who executed the within and foregoing instrument, and they acknowledged to me that they executed the same freely and voluntarily and for the uses and purposes therein mentioned.

IN WITNESS WHEREOF, I have hereunto set my hand and affixed my official seal at my office on the day and year in this certificate first above written.

*Charles Lee*  
Notary Public, Nye County, Nevada  
My Commission expires Feb 22, 1967

File No. 46510  
Filed for record at request of  
Lou Schlacht  
November 21, 1963  
at 20 minutes past 11 o'clock  
A.M. and recorded in Book 64  
of Official Records page 21  
Nye County, Nevada Records

*Margaret H. Barth*  
County Recorder



48473  
File No. \_\_\_\_\_  
Filed for record at request of  
S. & H. Incorporated. \_\_\_\_\_  
July 15, 1964. \_\_\_\_\_  
at \_\_\_\_\_ minutes past 1 o'clock  
P.m. and recorded in Book 70.  
of Official Records page 517  
Nye County, Nevada  
Margaret B. Brath  
County Recorder

MINING DEED

A. DAN SHEEK, a single man, Grantor, for and in consideration of the sum of One Dollar and other good and valuable considerations, quitclaims and transfers to S & H INCORPORATED, Grantee, all of the right, title and interest of Grantor in and to the following described unpatented lode mining claims situate in the Silver Bowl Mining District of Nye County, Nevada, the location certificates of which are recorded in the books and on the pages as set forth below in the records of the Recorder of said Nye County, Nevada, as follows:

<u>Name of Claim</u>	<u>Location Certificate</u> <u>Recorded in</u>	
	<u>Book</u>	<u>Page</u>
Towack No. 1	68	196
Towack No. 2	68	197
Towack No. 3	68	198
Towack No. 4	68	199
Helen	68	200
Silver Dan No. 1	68	201
Silver Dan No. 2	68	202
Silver Dan No. 3	68	203
Silver Dan No. 4	68	204

IN WITNESS WHEREOF, Grantor has executed this instrument on the 30 day of March, 1964.

STATE OF NEVADA )  
COUNTY OF CLARK ) ss.

A. Dan Sheek  
A. Dan Sheek

On this 8 day of <sup>July</sup> March, 1964, personally appeared before me E. K. Phillips, a Notary Public in and for said County and State, A. Dan Sheek, a single man, known to me to be the person described in and who executed the foregoing instrument, who acknowledged to me that he executed the same freely and voluntarily and for the uses and purposes therein mentioned.

IN WITNESS WHEREOF, I have hereunto set my hand and affixed my official seal at my office in the County of CLARK the day and year in this certificate first above written.

My Commission expires:

E. K. Phillips  
Notary Public



JUN 68

68 MAR 1964

File No. 47411  
Filed for record at request of

## CERTIFICATE OF LOCATION

LODE—QUARTZ

THIS IS TO CERTIFY that the  
claim was located byDan Sheek  
March 10, 1964  
at 35 minutes past 2 o'clock  
P. M. and recorded in Book 68  
of Official Records, page 19  
Nye County, Nevada, Records  
Lode miningMargaret H. Booth  
County Recorder

(print name of locator)

(print post office address)

Dan Sheek

Box 343 Tonopah, Nevada

on the 23 day of December, 1963, situated in the  
Blue Bow Mining District, Nye County,  
State of Nevada, and about3/4 mile from the Blue Bow mine Northwesterly  
and 1/4 mile North Easterly from the Bombing rangeWe (or I) claim 1500 linear feet along the course of the mineral-bearing  
ledge, lode or vein, extending 750 feet from the location monument  
in a Westerly direction, and 750 feet in a  
Southerly direction, together with 300 feet on  
each side of the center of the ledge for the entire length of the claim.The discovery work consists of a Open Cut  
located about 50 feet in a Westerly direction from the location  
monument, and its dimensions are 20 feet wide, 50 feet long  
and 4 feet deep, exposing ledge, lode or vein in place.The northwest corner is marked by a post 4 feet high, inscribed "NW  
Corner of the Towack #1 Claim"; the southwest corner is marked by a  
post 4 feet high, inscribed "SW Corner of the Towack #1  
Claim"; the southeast corner is marked by a post 4 feet high, inscribed  
"SE Corner of the Towack #1 Claim"; the northeast corner is marked by a  
post 4 feet high, inscribed "NE Corner of the Towack #1  
Claim." There is also a post at the center of each side line. The discovery  
work has been done, and the location completed since Feb 20, 1964

LOCATORS

Dated Feb 26, 1964

Dan Sheek

(Section 517.050, Nevada Revised Statutes, provides that every location of a mining claim made after  
July 1, 1941, shall be absolutely void unless a certificate of location thereof is recorded with the county  
recorder of the county in which the claim is located within 90 days after the date of location.)



# CERTIFICATE OF LOCATION

LODE—QUARTZ

THIS IS TO CERTIFY that the  
claim was located by

TOWACK #2

File No. 47412  
Filed for record at request of  
Dan Sheek  
March 10, 1964  
minutes past 2 o'clock  
P. M. and recorded in Book 68  
of Official Records, page 197  
Nye County, Nevada Records  
lode mining  
Margaret Booth  
County Recorder

(print name of locator)  
DAN SHEEK

(print post office address)  
P.O. Box 363 Tonopah Nevada

on the 28 day of December, 1963, situated in the  
Silver Bow Mining District, Nye County,  
State of Nevada, and about

1 mile Easterly from the Silver Bow  
Camp

We (or I) claim 1500 linear feet along the course of the mineral-bearing  
ledge, lode or vein, extending 750 feet from the location monument  
in a North Easterly direction, and 750 feet in a  
South Westerly direction, together with 300 feet on  
each side of the center of the ledge for the entire length of the claim.

The discovery work consists of a open cut  
located about 50 feet in a southerly direction from the location  
monument, and its dimensions are 20 feet wide, 50 feet long  
and 4 feet deep, exposing ledge, lode or vein in place.

The northwest corner is marked by a post 4 feet high, inscribed "NW  
Corner of the TOWACK #2 Claim"; the southwest corner is marked by a  
post 4 feet high, inscribed "SW Corner of the TOWACK #2  
Claim"; the southeast corner is marked by a post 4 feet high, inscribed  
"SE Corner of the TOWACK #2 Claim"; the northeast corner is marked by a  
post 4 feet high, inscribed "NE Corner of the TOWACK #2  
Claim." There is also a post at the center of each side line. The discovery  
work has been done, and the location completed since Feb 20, 1964

LOCATORS

Dated Feb 26, 1964

Dan Sheek

(Section 517.050, Nevada Revised Statutes, provides that every location of a mining claim made after  
July 1, 1941, shall be absolutely void unless a certificate of location thereof is recorded with the county  
recorder of the county in which the claim is located within 90 days after the date of location.)

68-197



File No. 47413  
Filed for record at request of

Dan Sheek  
March 10, 1964

at 35 minutes past 2 o'clock  
P. M. and recorded in Book 68  
of Official Records, page 198  
Nye County lode mining records

Margaret H. Beed  
County Recorder

68-198 **CERTIFICATE OF LOCATION**

**LODE—QUARTZ**

THIS IS TO CERTIFY that the TOWACK #3  
claim was located by

(print name of locator)

DAN SHEEK

(print post office address)

P. Box 363, Tonopah, Nev.

on the 29 day of December, 1963, situated in the  
Silver Bow Mining District, Nye County,  
State of Nevada, and about

3/4 mile Northerly from Blue Horse mine  
and 1/2 mile Southerly from Silver Bow Camp

We (or I) claim 1500 linear feet along the course of the mineral-bearing  
ledge, lode or vein, extending 750 feet from the location monument  
in a Northerly direction, and 750 feet in a  
Southerly direction, together with 3000 feet on  
each side of the center of the ledge for the entire length of the claim.

The discovery work consists of a open cut  
located about 50 feet in a Easterly direction from the location  
monument, and its dimensions are 20 feet wide, 50 feet long  
and 4 feet deep, exposing ledge, lode or vein in place.

The northwest corner is marked by a post 4 feet high, inscribed "NW  
Corner of the Towack #3 Claim"; the southwest corner is marked by a  
post 4 feet high, inscribed "SW Corner of the Towack #3  
Claim"; the southeast corner is marked by a post 4 feet high, inscribed  
"SE Corner of the Towack #3 Claim"; the northeast corner is marked by a  
post 4 feet high, inscribed "NE Corner of the Towack #3  
Claim." There is also a post at the center of each side line. The discovery  
work has been done, and the location completed since Feb 20, 1964

**LOCATORS**

Dated Feb 24, 1964

(Section 517.050, Nevada Revised Statutes, provides that every location of a mining claim made after  
July 1, 1941, shall be absolutely void unless a certificate of location thereof is recorded with the county  
recorder of the county in which the claim is located within 90 days after the date of location.)



# CERTIFICATE OF LOCATION

LODE—QUARTZ

THIS IS TO CERTIFY that the  
claim was located by

TOWACK #4

File No. 47414  
Filed for record at request of  
Dan Sheek  
March 10, 1964  
at 35 minutes past 2 o'clock  
P m and recorded in Book 68  
of Official Records page 199  
Nye County mining Records  
Margaret A. Bard  
County Recorder

(print name of locator)

DAN SHEEK

(print post office address)

P.O. Box 368, Tonopah, Nev.

on the 30 day of December, 1963, situated in the Silver  
Bow Mining District, Nye County,  
State of Nevada, and about  
3/4 mile easterly from Silver  
Bow Camp.

We (or I) claim 1500 linear feet along the course of the mineral-bearing  
ledge, lode or vein, extending \_\_\_\_\_ feet from the location monument  
in a northerly direction, and \_\_\_\_\_ feet in a  
southerly direction, together with 200 feet on  
each side of the center of the ledge for the entire length of the claim.

The discovery work consists of a open cut  
located about 50 feet in a easterly direction from the location  
monument, and its dimensions are 20 feet wide, 50 feet long  
and 4 feet deep, exposing ledge, lode or vein in place.

The northwest corner is marked by a post 4 feet high, inscribed "NW  
Corner of the Towack #4 Claim"; the southwest corner is marked by a  
post 4 feet high, inscribed "SW Corner of the Towack #4  
Claim"; the southeast corner is marked by a post 4 feet high, inscribed  
"SE Corner of the Towack #4 Claim"; the northeast corner is marked by a  
post 4 feet high, inscribed "NE Corner of the Towack #4  
Claim." There is also a post at the center of each side line. The discovery  
work has been done, and the location completed since Feb 20, 1964

LOCATORS

Dated

Feb 26, 1964

Dan Sheek

(Section 517.050, Nevada Revised Statutes, provides that every location of a mining claim made after July 1, 1941, shall be absolutely void unless a certificate of location thereof is recorded with the county recorder of the county in which the claim is located within 90 days after the date of location.)

68-199



900A

68 W 200

# CERTIFICATE OF LOCATION

## LODE—QUARTZ

THIS IS TO CERTIFY that the  
claim was located by

HELEN

File No. 47415  
Filed for record at request of  
Dan Sheek  
March 10, 1964  
35 minutes past 2 o'clock  
P.m. and recorded in Book 68  
of Official Records Page 200  
Nye County, Nevada  
lode mining  
Margaret B. Reed  
County Recorder

(print name of locator)

DAN SHEEK

(print post office address)

P.O. Box 363 Tonopah, Nevada

on the 17 day of December, 1963, situated in the  
Silver Bow Mining District, Nye County,  
State of Nevada, and about

3 miles eastwardly from the Silver Bow  
Camp and joins the West side line of the  
Silver Dick mining claim

We (or I) claim 1500 linear feet along the course of the mineral-bearing  
ledge, lode or vein, extending 750 feet from the location monument  
in a westerly direction, and 750 feet in a  
easterly direction, together with 300 feet on  
each side of the center of the ledge for the entire length of the claim.

The discovery work consists of a open cut  
located about 300 feet in a northwesterly direction from the location  
monument, and its dimensions are 20 feet wide, 50 feet long  
and 4 feet deep, exposing ledge, lode or vein in place.

The northwest corner is marked by a post 4 feet high, inscribed "NW  
Corner of the Helen Claim"; the southwest corner is marked by a  
Post 4 feet high, inscribed "SW Corner of the Helen  
Claim"; the southeast corner is marked by a Post 4 feet high, inscribed  
"SE Corner of the Helen Claim"; the northeast corner is marked by a  
Post 4 feet high, inscribed "NE Corner of the Helen  
Claim." There is also a post at the center of each side line. The discovery  
work has been done, and the location completed since Feb 20, 1964

### LOCATORS

Dated

Feb 26, 1964

Dan Sheek

(Section 517.050, Nevada Revised Statutes, provides that every location of a mining claim made after July 1, 1941, shall be absolutely void unless a certificate of location thereof is recorded with the county recorder of the county in which the claim is located within 90 days after the date of location.)



# CERTIFICATE OF LOCATION

## LODE—QUARTZ

THIS IS TO CERTIFY that the  
claim was located by

SILVER DAN #1

Dan Sheek  
March 10, 1964  
at 35 minutes past 2 o'clock  
P. M. and recorded in Book 63  
of Official Records, page 201  
Nye County mining records  
Margaret H. Booth  
County Recorder

(print name of locator)

DAN SHEEK

(print post office address)

P.O. Box 363 Tonopah Nevada

on the 16 day of December, 1963, situated in the  
Silver Bow Mining District, Nye County,  
State of Nevada, and about

3 miles from the Silver Bow Camp  
and joins the Silver Bow #1 Claim on  
the South East end

We (or I) claim 1500 linear feet along the course of the mineral-bearing  
ledge, lode or vein, extending 10 feet from the location monument  
in a northwesterly direction, and 1490 feet in a  
southeasterly direction, together with 300 feet on  
each side of the center of the ledge for the entire length of the claim.

The discovery work consists of a shaft  
located about 50 feet in a South west direction from the location  
monument, and its dimensions are 6 feet wide, 6 feet long  
and 50 feet deep, exposing ledge, lode or vein in place.

The northwest corner is marked by a post 4 feet high, inscribed "NW  
Corner of the Silver Dan #1 Claim"; the southwest corner is marked by a  
post 4 feet high, inscribed "SW Corner of the Silver Dan #1  
Claim"; the southeast corner is marked by a post 4 feet high, inscribed  
"SE Corner of the Silver Dan #1 Claim"; the northeast corner is marked by a  
post 4 feet high, inscribed "NE Corner of the Silver Dan #1  
Claim." There is also a post at the center of each side line. The discovery  
work has been done, and the location completed since Feb 20, 1964

## LOCATORS

Dated Feb 26, 1964

Dan Sheek



# CERTIFICATE OF LOCATION

## LODE—QUARTZ

THIS IS TO CERTIFY that the  
claim was located by

Silver Dan #2

File No. 42417  
Filed for record at request of  
Dan Sheek  
March 10, 1964  
at 35 minutes past 2 o'clock  
P.M. and recorded in Book 68  
of Official Records Page 202  
Nye County Nevada  
Margarita Booth  
County Recorder

(print name of locator)

Dan Sheek

(print post office address)

P.O. Box 363 Tonopah Nevada

on the 16 day of December, 1963, situated in the  
Silver Bow Mining District, Nye County,  
State of Nevada, and about 3 miles  
Easterly from the Silver Bow Camp  
and between the Silver Bow Claim on the  
Southeast

We (or I) claim 1500 linear feet along the course of the mineral-bearing  
ledge, lode or vein, extending 10 feet from the location monument  
in a Northerly direction, and 1490 feet in a  
Southerly direction, together with 300 feet on  
each side of the center of the ledge for the entire length of the claim.

The discovery work consists of a Shaft  
located about 750 feet in a Southerly direction from the location  
monument, and its dimensions are 6 feet wide, 6 feet long  
and 70 feet deep, exposing ledge, lode or vein in place.

The northwest corner is marked by a Post 4 feet high, inscribed "NW  
Corner of the Silver Dan #2 Claim"; the southwest corner is marked by a  
Post 4 feet high, inscribed "SW Corner of the Silver Dan #2  
Claim"; the southeast corner is marked by a Post 4 feet high, inscribed  
"SE Corner of the Silver Dan #2 Claim"; the northeast corner is marked by a  
Post 4 feet high, inscribed "NE Corner of the Silver Dan #2  
Claim." There is also a Post at the center of each side line. The discovery  
work has been done, and the location completed since Feb 20, 1964

LOCATORS

Dated Feb 26, 1964

Dan Sheek



File No. 47418  
Filed for record at request of  
Dan Sheek  
March 10, 1964  
at 35 minutes past 2 o'clock  
P. and recorded in Book 68  
of Official Records, page 203  
Nye County lode mining records  
Margaret B. Smith  
County Recorder

# CERTIFICATE OF LOCATION

## LODE—QUARTZ

THIS IS TO CERTIFY that the Silver Dan #3  
claim was located by

(print name of locator)  
Dan Sheek

(print post office address)  
P.O. Box 363 Tonopah Nev.

on the 17 day of December, 1963, situated in the  
Silver Bow Mining District, Nye County,  
State of Nevada, and about 3 miles  
easterly from the Silver Bow Camp  
and 1/2 mile southerly from the Silver  
Bend claim

We (or I) claim 1500 linear feet along the course of the mineral-bearing  
ledge, lode or vein, extending 10 feet from the location monument  
in a northwesterly direction, and 1490 feet in a  
southerly direction, together with 300 feet on  
each side of the center of the ledge for the entire length of the claim.

The discovery work consists of a open cut  
located about 300 feet in a southerly direction from the location  
monument, and its dimensions are 20 feet wide, 50 feet long  
and 4 feet deep, exposing ledge, lode or vein in place.

The northwest corner is marked by a Post 4 feet high, inscribed "NW  
Corner of the Silver Dan #3 Claim"; the southwest corner is marked by a  
Post 4 feet high, inscribed "SW Corner of the Silver Dan #3  
Claim"; the southeast corner is marked by a Post 4 feet high, inscribed  
"SE Corner of the Silver Dan #3 Claim"; the northeast corner is marked by a  
Post 4 feet high, inscribed "NE Corner of the Silver Dan #3  
Claim." There is also a Post at the center of each side line. The discovery  
work has been done, and the location completed since Feb 20, 1964

LOCATORS

Dated Feb 26, 1964

Dan Sheek

(Section 517.050, Nevada Revised Statutes, provides that every location of a mining claim made after July 1, 1941, shall be absolutely void unless a certificate of location thereof is recorded with the county recorder of the county in which the claim is located within 90 days after the date of location.)

68-203



Dan Sheek

March 10, 1964

## CERTIFICATE OF LOCATION

## LODE—QUARTZ

THIS IS TO CERTIFY that the  
claim was located bySilver Dan #435 minutes past 2 o'clock  
and recorded in Book 68  
of Official Records Page 204  
Nye County, Nevada Records  
lode mining  
County Recorder

(print name of locator)

Dan Sheek

(print post office address)

P.O. Box 363 Tonopah Nevon the 17 day of December, 1963, situated in theSilver Bow Mining District, Nye County,State of Nevada, and about 3 mileseastward from the Silver Bow Camp and  
1/2 mile southward from the Silver Bend  
mineWe (or I) claim 1500 linear feet along the course of the mineral-bearing  
ledge, lode or vein, extending 10 feet from the location monument  
in a northward direction, and 1490 feet in a  
southward direction, together with 300 feet on  
each side of the center of the ledge for the entire length of the claim.The discovery work consists of a Open Cut  
located about 250 feet in a North East direction from the location  
monument, and its dimensions are 10 feet wide, 10 feet long  
and 6 feet deep, exposing ledge, lode or vein in place.The northwest corner is marked by a Post 4 feet high, inscribed "NW  
Corner of the Silver Dan #4 Claim"; the southwest corner is marked by a  
Post 4 feet high, inscribed "SW Corner of the Silver Dan #4  
Claim"; the southeast corner is marked by a Post 4 feet high, inscribed  
"SE Corner of the Silver Dan #4 Claim"; the northeast corner is marked by a  
Post 4 feet high, inscribed "NE Corner of the Silver Dan #4  
Claim." There is also a Post at the center of each side line. The discovery  
work has been done, and the location completed since Feb 20, 1964

## LOCATORS

Dated Feb 26, 1964Dan Sheek



File No. 42306  
Filed for record at request of  
L. W. Schlecht  
February 26, 1964  
15 minutes past 2 o'clock  
P. M. and recorded in Book 68  
of Official Records, page 61  
Bye County, Nevada  
Lode Mining  
County Recorder

# CERTIFICATE OF LOCATION

## LODE—QUARTZ

THIS IS TO CERTIFY that the  
claim was located by

Silver Bend #1 Margaret A. Borch

(print name of locator)  
Edward K. Hayes  
L.W. Schlecht

(print post office address)  
Box 3210 So Salt Lake City Utah  
PO Box 903 Grand Junction, Colorado

on the 28 day of November, 1963, situated in the  
Silver Bow Mining District, Wye County,  
State of NEVADA, and about 3 miles  
Easterly from the Silver Bow Camp

We (or I) claim 1500 linear feet along the course of the mineral-bearing  
ledge, lode or vein, extending 750 feet from the location monument  
in a Northerly direction, and 750 feet in a  
Southerly direction, together with 300 feet on  
each side of the center of the ledge for the entire length of the claim.

The discovery work consists of a open cut  
located about 200 feet in a Southerly direction from the location  
monument, and its dimensions are 20 feet wide, 50 feet long  
and 4' feet deep, exposing ledge, lode or vein in place.

The northwest corner is marked by a post 4 feet high, inscribed "NW  
Corner of the Silver Bend #1 Claim"; the southwest corner is marked by a  
post 4 feet high, inscribed "SW Corner of the Silver Bend #1  
Claim"; the southeast corner is marked by a post 4 feet high, inscribed  
"SE Corner of the Silver Bend #1 Claim"; the northeast corner is marked by a  
post 4 feet high, inscribed "NE Corner of the Silver Bend #1  
Claim." There is also a post at the center of each side line. The discovery  
work has been done, and the location completed since Apr 20, 1964

Edward K. Hayes  
L.W. Schlecht

### LOCATORS

Dated Feb 26, 1964

(Section 517.050, Nevada Revised Statutes, provides that every location of a mining claim made after  
July 1, 1941, shall be absolutely void unless a certificate of location thereof is recorded with the county  
recorder of the county in which the claim is located within 90 days after the date of location.)



3001

68 PM 62

## CERTIFICATE OF LOCATION

## LODE—QUARTZ

THIS IS TO CERTIFY that the  
claim was located by

Silver Bend #2

File No. 47302  
Filed for record at request of  
L. W. Schlecht  
February 26, 1964  
15 minutes past 2 o'clock  
P. M. and recorded in Book 168  
Page 62  
County, Nevada  
lode mining

Margaret A. Booth

(print name of locator)

Richard N. Hayes  
L. W. Schlecht

(print post office address)

1578-3210 So Salt Lake City Utah  
P.O. Box 963 Grand Junction Colo

on the 28 day of November, 1963, situated in the

Silver Bow Mining District, Nye County,  
State of Nevada, and about

3 miles easterly from the Silver  
Bow camp

We (or I) claim 1500 linear feet along the course of the mineral-bearing  
ledge, lode or vein, extending 750 feet from the location monument  
in a northerly direction, and 750 feet in a  
southerly direction, together with 300 feet on  
each side of the center of the ledge for the entire length of the claim.

The discovery work consists of a open cut  
located about 750 feet in a southerly direction from the location  
monument, and its dimensions are 20 feet wide, 50 feet long  
and 4 feet deep, exposing ledge, lode or vein in place.

The northwest corner is marked by a post 4 feet high, inscribed "NW  
Corner of the Silver Bend #2 Claim"; the southwest corner is marked by a  
post 4 feet high, inscribed "SW Corner of the Silver Bend #2  
Claim"; the southeast corner is marked by a post 4 feet high, inscribed  
"SE Corner of the Silver Bend #2 Claim"; the northeast corner is marked by a  
post 4 feet high, inscribed "NE Corner of the Silver Bend #2  
Claim." There is also a post at the center of each side line. The discovery  
work has been done, and the location completed since July 20, 1964

## LOCATORS

Dated Feb 26, 1964

Richard N. Hayes  
L. W. Schlecht

(Section 517.050, Nevada Revised Statutes, provides that every location of a mining claim made after  
July 1, 1941, shall be absolutely void unless a certificate of location thereof is recorded with the county  
recorder of the county in which the claim is located within 90 days after the date of location.)



File No. 47308  
Filed for record at request of  
L. W. Schlecht  
February 26, 1964  
15  
P  
and recorded in Book 68  
of the records of the  
County of Nevada  
lode mining  
Margaret Booth

# CERTIFICATE OF LOCATION

## LODE—QUARTZ

THIS IS TO CERTIFY that the TICKABO #1  
claim was located by

(print name of locator)  
Richard N. Hayes  
L.W. Schlecht

(print post office address)  
1507 E. 3210 S. SALT LAKE CITY 71111  
PO Box 963 Grand Junction Colo

on the 27 day of November, 1963, situated in the SILVER BOW  
Mining District, NYE County,  
State of NEVADA, and about 2 miles North  
from the Blue Horse mine and 1/4 mile Easterly  
from the Tonopah-Bonanza Range boundary

We (or I) claim 1500 linear feet along the course of the mineral-bearing  
ledge, lode or vein, extending 10 feet from the location monument  
in a Southerly direction, and 1490 feet in a  
Northerly direction, together with 300 feet on  
each side of the center of the ledge for the entire length of the claim.

The discovery work consists of a Shaft  
located about 10 feet in a Southerly direction from the location  
monument, and its dimensions are 4 feet wide, 6 feet long  
and 20 feet deep, exposing ledge, lode or vein in place.

The northwest corner is marked by a Post 4' feet high, inscribed "NW  
Corner of the TICKABO #1 Claim"; the southwest corner is marked by a  
Post 4' feet high, inscribed "SW Corner of the TICKABO #1  
Claim"; the southeast corner is marked by a Post 4' feet high, inscribed  
"SE Corner of the TICKABO #1 Claim"; the northeast corner is marked by a  
Post 4' feet high, inscribed "NE Corner of the TICKABO #1  
Claim" There is also a Post 4 at the center of each side line. The discovery  
work has been done, and the location completed since Feb 20, 1964

### LOCATORS

Dated Feb 26, 1964

(Section 517.050, Nevada Revised Statutes, provides that every location of a mining claim made after  
July 1, 1941, shall be absolutely void unless a certificate of location thereof is recorded with the county  
recorder of the county in which the claim is located within 90 days after the date of location.)



986K 68 PM 64

# CERTIFICATE OF LOCATION

LODE—QUARTZ

File No. 47309  
Filed for record at request of  
L. W. Schlecht  
February 26, 1964  
15 minutes past 2 o'clock  
P. and recorded in Book 68  
of Salt Lake County  
Lode mining  
Margaret A. Booth  
County Clerk

THIS IS TO CERTIFY that the Tickabo #2  
claim was located by

(print name of locator)  
Richard N. Hayes  
L. W. Schlecht

(print post office address)  
1807 E. 3210 S. Salt Lake Utah  
P.O. Box 963 Grand Junction Colo

on the 27 day of November, 1963, situated in the  
Silver Bow Mining District, NYE County,  
State of NEVADA, and about 2 miles northw  
from the Blue Horse mine and 1/4 mile  
Easterly from the Tonopah Bonanza range  
boundary.

We (or I) claim 1500 linear feet along the course of the mineral-bearing  
ledge, lode or vein, extending 10 feet from the location monument  
in a Northwesterly direction, and 1490 feet in a  
Southerly direction, together with 300 feet on  
each side of the center of the ledge for the entire length of the claim.

The discovery work consists of a open cut  
located about 100 feet in a northwesterly direction from the location  
monument, and its dimensions are 20 feet wide, 50 feet long  
and 4' feet deep, exposing ledge, lode or vein in place.

The northwest corner is marked by a Post 4' feet high, inscribed "NW  
Corner of the tickabo #2 Claim"; the southwest corner is marked by a  
Post 4' feet high, inscribed "SW Corner of the tickabo #2  
Claim"; the southeast corner is marked by a Post 4' feet high, inscribed  
"SE Corner of the tickabo #2 Claim"; the northeast corner is marked by a  
Post 4' feet high, inscribed "NE Corner of the tickabo #2  
Claim" There is also a Post at the center of each side line. The discovery  
work has been done, and the location completed since Feb 20, 1964

Richard N. Hayes  
L. W. Schlecht

## LOCATORS

Dated Feb 26, 1964

(Section 517.050, Nevada Revised Statutes, provides that every location of a mining claim made after  
July 1, 1941, shall be absolutely void unless a certificate of location thereof is recorded with the county  
recorder of the county in which the claim is located within 90 days after the date of location.)



File No. 47310  
Filed for record at request of  
L. W. Schlecht  
February 26, 1964  
15 minutes past 2 o'clock  
P. and recorded in Book 68  
Page 65  
Lode mining

**CERTIFICATE OF LOCATION**  
**LODE—QUARTZ**

THIS IS TO CERTIFY that the

Tickaho # 3

claim was located by

(print name of locator)

Richard N. Hayes  
L.W. Schlecht

(print post office address)

1878 3210 So. Salt Lake City Hwy  
P.O. Box 963 Grand Junction Colo

on the 27 day of November, 1963, situated in the

Silver Bow Mining District, Nejé County,  
State of Montana, and about 2 miles

northwesterly from the Blue Horse mine  
and 1/4 mile E. from the Toropah Bombing Range  
Boundary

We (or I) claim 1500 linear feet along the course of the mineral-bearing  
ledge, lode or vein, extending 10 feet from the location monument  
in a Southeasterly direction, and 1490 feet in a  
Northwesterly direction, together with 300 feet on  
each side of the center of the ledge for the entire length of the claim.

The discovery work consists of a open cut  
located about 50 feet in a westerly direction from the location  
monument, and its dimensions are 20 feet wide, 50 feet long  
and 4 feet deep, exposing ledge, lode or vein in place.

The northwest corner is marked by a post 4 feet high, inscribed "NW  
Corner of the Tickaho # 3 Claim"; the southwest corner is marked by a  
post 4 feet high, inscribed "SW Corner of the Tickaho # 3  
Claim"; the southeast corner is marked by a post 4 feet high, inscribed  
"SE Corner of the Tickaho # 3 Claim"; the northeast corner is marked by a  
post 4 feet high, inscribed "NE Corner of the Tickaho # 3  
Claim." There is also a post at the center of each side line. The discovery  
work has been done, and the location completed since Feb 20, 1964

**LOCATORS**

Dated Feb 26, 1964

(Section 517.050, Nevada Revised Statutes, provides that every location of a mining claim made after July 1, 1941, shall be absolutely void unless a certificate of location thereof is recorded with the county recorder of the county in which the claim is located within 90 days after the date of location.)



68 66

## CERTIFICATE OF LOCATION

## LODE—QUARTZ

THIS IS TO CERTIFY that the  
claim was located by

(print name of locator)

Richard N. Hayes

L. W. Schlecht

(print post office address)

1807 E. 3210 St Salt Lake City Utah

P.O. Box 963 Grand Junction, Colo

on the 27 day of November, 1963, situated in the

Silver Bow Mining District, Neve County,

State of Nevada, and about 2 miles northwesterly  
from the Blue House mine and 1/4 mile  
easterly from the Tinopal Bombing range boundary.

We (or I) claim 1500 linear feet along the course of the mineral-bearing  
ledge, lode or vein, extending 10 feet from the location monument  
in a northwesterly direction, and 1490 feet in a  
southeasterly direction, together with 300 feet on  
each side of the center of the ledge for the entire length of the claim.

The discovery work consists of a open cut  
located about 300 feet in a southeasterly direction from the location  
monument, and its dimensions are 20 feet wide, 50 feet long  
and 4' feet deep, exposing ledge, lode or vein in place.

The northwest corner is marked by a Post 4 feet high, inscribed "NW  
Corner of the Tickaho #4 Claim"; the southwest corner is marked by a  
Post 4 feet high, inscribed "SW Corner of the Tickaho #4  
Claim"; the southeast corner is marked by a Post 4 feet high, inscribed  
"SE Corner of the Tickaho #4 Claim"; the northeast corner is marked by a  
Post 4' feet high, inscribed "NE Corner of the Tickaho #4  
Claim." There is also a Post at the center of each side line. The discovery  
work has been done, and the location completed since Feb 20, 1964

## LOCATORS

Dated Feb 26, 1964

(Section 517.050, Nevada Revised Statutes, provides that every location of a mining claim made after  
July 1, 1941, shall be absolutely void unless a certificate of location thereof is recorded with the county  
recorder of the county in which the claim is located within 90 days after the date of location.)

File No. 47311

Filed for record at request of

L. W. Schlecht

February 26, 1964

15 minutes past 2 o'clock

P. and recorded in the 68

66

lode mining

Margaret T. Booth



File No. 47312

Filed for record at request of

## CERTIFICATE OF LOCATION

L. W. Schlecht

February 26, 1964

15 minutes past 2 o'clock

P. M. and recorded in Book 68.

lode mining 67

## LODE—QUARTZ

THIS IS TO CERTIFY that the

claim was located by

(print name of locator)

Richard N. Hayes  
L. W. Schlecht

(print post office address)

1407 E. 72nd St. Salt Lake City  
P.O. Box 763 Grand Junction Coloon the 9 day of December, 1963, situated in the  
Silver Bow Mining District, Nye County,  
State of Nevada, and about2 miles northwesterly from the  
Blue Horse mine and 1/4 mile easterly  
from the Tonopah Bombing range.We (or I) claim 1500 linear feet along the course of the mineral-bearing  
ledge, lode or vein, extending 10 feet from the location monument  
in a Southerly direction, and 1490 feet in a  
Northerly direction, together with 300 feet on  
each side of the center of the ledge for the entire length of the claim.The discovery work consists of a open cut  
located about 200 feet in a northerly direction from the location  
monument, and its dimensions are 20 feet wide, 50 feet long  
and 4' feet deep, exposing ledge, lode or vein in place.The northwest corner is marked by a post 4 feet high, inscribed "NW  
Corner of the Tickaho #5 Claim"; the southwest corner is marked by a  
post 4 feet high, inscribed "SW Corner of the Tickaho #5  
Claim"; the southeast corner is marked by a post 4 feet high, inscribed  
"SE Corner of the Tickaho #5 Claim"; the northeast corner is marked by a  
post 4 feet high, inscribed "NE Corner of the Tickaho #5  
Claim." There is also a post at the center of each side line. The discovery  
work has been done, and the location completed since Feb 20, 1964

## LOCATORS

Dated Feb 26, 1964

(Section 517.050, Nevada Revised Statutes, provides that every location of a mining claim made after  
July 1, 1941, shall be absolutely void unless a certificate of location thereof is recorded with the county  
recorder of the county in which the claim is located within 90 days after the date of location.)



## CERTIFICATE OF LOCATION

## LODE—QUARTZ

L. W. Schlecht

February 26, 1964

at 15 minutes and 20 seconds

P. and recorded in Book 68

lode mining

THIS IS TO CERTIFY that the

claim was located by

(print name of locator)

(print post office address)

Richard N. Hayes  
L. W. Schlecht107 E. 3210 St. Salt Lake City  
P.O. Box 963 Grand Junction, Colo.

on the 9 day of December, 1963, situated in the

Silver Bow Mining District, Tye County,  
State of Nevada, and about2 miles westerly from the Blue Horse  
mine and 1/4 mile easterly from the  
Tompah Bombing Range

We (or I) claim 1500 linear feet along the course of the mineral-bearing  
ledge, lode or vein, extending 10 feet from the location monument  
in a westerly direction, and 1490 feet in a  
southerly direction, together with 300 feet on  
each side of the center of the ledge for the entire length of the claim.

The discovery work consists of a open cut  
located about 1700 feet in a southerly direction from the location  
monument, and its dimensions are 20 feet wide, 50 feet long  
and 4 feet deep, exposing ledge, lode or vein in place.

The northwest corner is marked by a post 4 feet high, inscribed "NW  
Corner of the tukabo #6 Claim"; the southwest corner is marked by a  
post 4 feet high, inscribed "SW Corner of the tukabo #6  
Claim"; the southeast corner is marked by a post 4 feet high, inscribed  
"SE Corner of the tukabo #6 Claim"; the northeast corner is marked by a  
post 4 feet high, inscribed "NE Corner of the tukabo #6  
Claim." There is also a post at the center of each side line. The discovery  
work has been done, and the location completed since Feb 20, 1964

## LOCATORS

Dated Feb 26, 1964

(Section 517.050, Nevada Revised Statutes, provides that every location of a mining claim made after  
July 1, 1941, shall be absolutely void unless a certificate of location thereof is recorded with the county  
recorder of the county in which the claim is located within 90 days after the date of location.)



File No. 42314  
Filed for record at request of \_\_\_\_\_

L. W. Schlecht  
February 26, 1964

# CERTIFICATE OF LOCATION

# LODE—QUARTZ

THIS IS TO CERTIFY that the  
claim was located by

SILVER Dick

15 2  
P 68  
69  
code mining

Margaret H. Boon

(print name of locator)

(print name or locator)

Richard N. Hayes  
L.W. Schlecht

(print post office address)

1817 E. 3210 St Salt Lake Utah  
P.O. Box 963 Grand Junction Colo

on the 30 day of November, 1963, situated in the Silver Bow Mining District, Big County,  
State of Nevada, and about

3 miles East by from the Silver Bow  
Camp and about 1/2 mile ~~to~~ South by from  
the Silver Bend mine

We (or I) claim 1500 linear feet along the course of the mineral-bearing ledge, lode or vein, extending 750 feet from the location monument in a Westerly direction, and 750 feet in a Easterly direction, together with 300 feet on each side of the center of the ledge for the entire length of the claim.

The discovery work consists of a Open Pit  
located about 100 feet in a Easterly direction from the location  
monument, and its dimensions are 20 feet wide, 50 feet long  
and 4 feet deep, exposing ledge, lode or vein in place.

The northwest corner is marked by a post 4 feet high, inscribed "NW Corner of the Silver Dick Claim"; the southwest corner is marked by a post 4 feet high, inscribed "SW Corner of the Silver Dick Claim"; the southeast corner is marked by a post 4 feet high, inscribed "SE Corner of the Silver Dick Claim"; the northeast corner is marked by a post 4 feet high, inscribed "NE Corner of the Silver Dick Claim." There is also a post at the center of each side line. The discovery work has been done, and the location completed since Feb. 20, 1964

Richard P. Hayes  
Rev. Schless

## LOCATORS

Dated Feb 26, 1968

(Section 517.050, Nevada Revised Statutes, provides that every location of a mining claim made after July 1, 1941, shall be absolutely void unless a certificate of location thereof is recorded with the county recorder of the county in which the claim is located within 90 days after the date of location.)



UNITED STATES  
DEPARTMENT OF THE INTERIOR  
OFFICE OF MINERALS EXPLORATION

6000 0312 (4420)  
Budget Bureau No. 42-R1368  
Approval expires Dec. 31, 1968

APPLICATION FOR FINANCIAL ASSISTANCE IN MINERALS EXPLORATION

Pursuant to Public Law 85-701 (72 Stat. 700; 30 U.S.C. 641)

NAME OF APPLICANT (Full legal name and mailing address as they should appear on contract if one is executed.)		APPLICANT DO NOT USE THIS BLOCK	
<b>AIRLINE METALS</b> (formerly known as Silver Mountain Reserves, Inc.)  1801 South Catalina Avenue Suite 302 Redondo Beach, California 90277		DOCKET NUMBER	
		DATE RECEIVED	
		REGION	
		DIVISION CODE	
BUSINESS ORGANIZATION (Check one)	LIST CORPORATE OFFICERS OR PARTNERS HERE, IF APPLICABLE		
INDIVIDUAL <input type="checkbox"/> CORPORATION <input checked="" type="checkbox"/> PARTNERSHIP <input type="checkbox"/> OTHER (Specify) <input type="checkbox"/>	NAME ADDRESS TITLE  <p style="text-align: center;">See Enclosure No. 1</p>		
STATE IN WHICH FIRM IS ORGANIZED <b>California</b>			
MINERAL(S) FOR WHICH YOU WISH TO EXPLORE <b>Gold and Silver</b>	PROPERTY NAME <b>Silverbow Mining District</b>	LOCATION COUNTY <b>Nye</b>	STATE <b>Nevada</b>
ESTIMATED COST OF PROJECT \$ <b>192,950.</b>			

GENERAL INSTRUCTIONS

Before filling out this application, please read the *OME Regulations for Obtaining Federal Assistance in Financing Explorations for Mineral Reserves* (30 CFR Chap. III). To assure prompt action, your application must provide all applicable material and information specified on the back of this application form. Avoid unnecessary correspondence and delays by submitting complete and accurate information. Please submit two copies of this application and all accompanying papers except as otherwise noted. Place your name and address on each sheet. Each item of information, maps, and reports required as a part of this application is described on the back of this form. Identify each attached statement by the item number to which it applies. If an item does not apply to your application, show the item number on your statement and after it write "not applicable." Maps or sketches

should be used to supplement narrative descriptions of the property location and boundaries in item 2, existing mine workings and geology in item 3, and the proposed exploration work in item 5. When this information is not too complex, all of it may be shown on one map or sketch. All documents and other attachments submitted as a part of this application, except those in item 3(g) which you mark to be returned, become the property of the Government and will not be returned to the applicant. Send true copies, *not originals*, of leases, contracts, and other documents which are an essential part of your business records. File this application with the Office of Minerals Exploration, Department of the Interior, Washington 25, D. C., or with the nearest OME Field Office.

CERTIFICATION

The undersigned, whether as an individual, corporate officer, partner, or otherwise, both in his own behalf and acting for the applicant, certifies that the information set forth in this form and accompanying papers is correct and com-

plete, to the best of his knowledge and belief, and that he would not ordinarily undertake the proposed exploration under current conditions and circumstances at his sole expense.

**August 30, 1966**

DATED

*James F. Browne Jr.*  
BY (Signature)  
**Partner**

TITLE



## INFORMATION REQUIRED WITH THIS APPLICATION

### 1. Financial Eligibility:

(a) Submit evidence of efforts made within 90 days preceding the filing of this application to obtain credit from your bank of account and at least one other banking institution or other private source of credit. Such evidence shall include true copies of correspondence which show: (1) date of loan request, (2) amount and terms requested, (3) proposed use of loan funds, and (4) the replies from credit sources. If the loan was offered under terms which you consider unreasonable, state why you consider them so.

(b) List names and addresses of affiliated, parent, or controlling companies or organizations and state extent and nature of their interest.

(c) State how you propose to furnish your share of the cost of the exploration work.

### 2. Applicant's Rights in Land:

(a) State your interest in the land and mineral rights, whether owner, lessee, purchaser under contract, or other. If you are not the owner, submit one true copy of the lease, contract, or other document (with address of owner) under which you control the property. Describe all liens, mortgages, or other encumbrances on the land and state book and page number and official place where recorded.

(b) State the legal description (section, township, and range; metes and bounds; patent number of claims) of the land upon which you wish to explore and all adjacent land which you own or control. Describe any part of the land or workings which should not be subject to Government royalty and liens. If the land consists of unpatented claims, state book and page number for each recorded location notice, including amended locations, and official place where recorded. State all the names by which you know the property.

(c) For all land or mineral rights encumbered or not owned, submit five copies of Lien and Subordination Agreements on MME Form 52. If the agreements cannot be obtained, state reasons and provide copies of letters of refusal.

### 3. Physical Description:

(a) Describe in detail and illustrate with maps or sketches all mining or exploration operations which you know have been or are being conducted upon the land. Include existing mine workings and all production facilities.

(b) State your interest, if any, in operations described in (a).

(c) State, if you know, the past and current production, supporting your statement with copies of settlement sheets, mine records, or published data if available.

(d) Describe known ore reserves, giving quantities and grades and sampling methods used. Support your statement with copies of assay certificates and assay maps if available.

(e) Describe by narrative and maps or sketches the geologic features of the property, including ore minerals, geologic formations if known, and type of deposit (vein, bedded, etc.).

(f) State your reasons for expecting to find ore, and if you have sampled the area you propose to explore, show where the samples were taken, describe sampling methods used, and provide copies of assay certificates.

(g) Send with your application at least two copies of all geologic or engineering reports, assay maps, or technologic information which you have, indicating whether you require their return.

### 4. Accessibility of Property:

(a) To aid the OME representative who may examine the property, state name and address of person who will meet him; give directions for reaching the property; and describe accessibility of property and of any mine workings.

(b) Name the shipping and supply points and state the distances to the property.

### 5. Exploration Work:

(a) Describe fully the proposed exploration work giving individual footages and sizes of openings for each item of

work. Use narrative, maps, plans, and sections as necessary. Show location of the proposed work as related to geologic features such as veins, ore-bearing beds, contacts of rock formations, etc. Show also the relation of the proposed work to any existing mine workings and to land boundaries or to the closest identifiable corner.

(b) If an access road must be built, show the proposed location on the property map and state the length, type and construction methods proposed.

(c) If an OME contract is executed, state how soon thereafter work would be started and finished. State your anticipated average daily or monthly rate of progress for each type of work.

### 6. Experience:

State your operating experience and background to conduct this exploration work and also that of the person who will supervise the work.

### 7. Estimate of Costs:

Furnish detailed estimates of the necessary costs for each item of the work proposed in 5(a) under the headings listed below with a total for each heading and the estimated total cost of the work. Costs for any work to be performed by an independent contractor should be listed separately under category (a) below. Costs for any work that is not to be performed by an independent contractor should be listed under categories (b) through (g).

(a) Independent contracts. State the total cost of any proposed independent contract for all or any part of the work, and the number of units and the unit cost for each type of work, such as per foot of drilling, per foot of drifting, per hour of bulldozer operations, or per cubic yard of material moved. Cost estimates should be supported by bids from three contractors if possible. (Note—If none of the work is to be contracted, write "none" after this item.)

(b) Personal services. The cost of supervision, engineering and geological services, outside consultants, and labor should be itemized by numbers and classes of employees; rates of wages, salaries or fees; and periods of employment. State whether these services are available.

(c) Operating materials and supplies. List items of material and supplies giving quantity and cost of each. Include under this heading power, water, and fuel, and units of equipment and tools costing less than \$50 each.

(d) Operating equipment. List items of equipment and tools costing \$50 or more per unit. Give specifications and indicate how each item is to be acquired—i.e., rented, purchased or provided by the applicant. If rented or purchased, state the estimated rental or purchase price. If furnished by the applicant, state condition and present fair market value.

(e) Initial rehabilitation and repairs. Describe the type and the cost of initial rehabilitation or repair of existing buildings, fixtures, installations (exclusive of mine workings), and movable operating equipment now owned by the applicant which will be used in the exploration work.

(f) New buildings, fixtures, installations. Describe each building, fixed improvement, and installation to be purchased, constructed, or installed for the exploration work, stating specifications and cost including labor, materials, and supervision.

(g) Miscellaneous. Describe the type and estimate the cost of repairs and maintenance of the operating equipment listed in 7(d). Do not repeat initial repairs listed in 7(e). Show also the costs of analytical work, accounting, workmen's compensation and employees' liability insurance, payroll taxes, and other required costs that do not fall within the previous categories. [Note—The Government will not contribute to costs incurred before the date of the contract, or to costs of or incident to: (1) acquiring, using, or possessing land and any existing improvements, facilities, buildings, installations, and appurtenances, or the depreciation and depletion thereof; (2) general overhead, corporate management, interest and taxes (other than payroll and sales taxes); (3) insurance (other than employees' liability insurance); and (4) damages to persons or property (other than authorized repair to or replacement of equipment or other property used in the work).]





R E A EXPRESS

**COLLECT****UNIFORM EXPRESS RECEIPT**  
**NON-NEGOTIABLE**

6000 0312/4420

Origin

Code No.

(914-A) Salt Lake City, Utah (43-088)

Destination City and State

Code No.

Receipt No.

**C 019911**

Consignee's Name, Address and Credit Account No.

Date Shipped

Advances

Paid in Part

Storage

Shipper's Name and Address

Priced By

Other

Declared Value

Value Charges

No. Pcs. Commodity Description

Commodity Code

Weight

Rate  
Basis

Express Charges

Total

C.O.D.

C.O.D. Service Chg.

**SHIPPER'S COPY**

Tariff

Col.

Class

Collect Service Chg.  
From Consignee?☐ YES ☐ NO

Form 5081 (10-65)

NOTE—The Company will not pay over \$50, in case of loss, or 50 cents per pound, actual weight, for any shipment in excess of 100 pounds, unless a greater value is declared and charges for such greater value paid.

**1**

Date

Number Pieces

Hour

for Railway Express Agency, Inc.

Received shipment described hereon, subject to the Classifications and Tariffs in effect on the date hereof, which carrier agrees to carry upon the terms and conditions of the Uniform Express Receipt set forth in part on the reverse side hereof and in full in the effective Official Express Classification on file with the Interstate Commerce Commission and the regulatory bodies of the states to which the shipper agrees and as evidence thereof accepts this receipt. Value herein declared by Shipper to be that entered in space hereon, reading "Declared Value".



## SILVER BEND MINE

SILVER BOW DISTRICT, NYE COUNTY, NEVADA

BRUNTON and TAPE SURVEY.

FEB. 4, 1964 - E. V. Reinhardt

N  
↑

1 INCH = 30 FEET

O.M.E. PLATE No. 1

## ASSAYS

SAMPLE (IN FEET)			
NUMBER	WIDTH	OZ. GOLD	OZ. SILVER
2	4.4	0.08	9.8
3	4.4	0.25	10.2
4	3.5	0.045	8.7
5	4.4	0.06	8.3
6	3.7	0.07	23.9
7	4.0	0.052	9.1
8	3.0	0.055	12.5
9	3.5	0.040	9.9
10	6.3	0.070	11.1
11	6.1	0.18	21.5
12	2.4	3.35	24.1
13	1.9	0.18	32.7
14	2.2	0.09	25.6
15	2.1	0.045	9.95
16	2.3	0.005	3.90
17	5.5	0.025	5.5
18	3.3	0.010	3.8
19	2.3	0.06	13.40
20	5.4	0.005	2.60
21	3.4	0.008	3.00
22	1.0	0.25	21.0
23	2.0	0.28	32.1

ER TUNNEL

ING N.E.

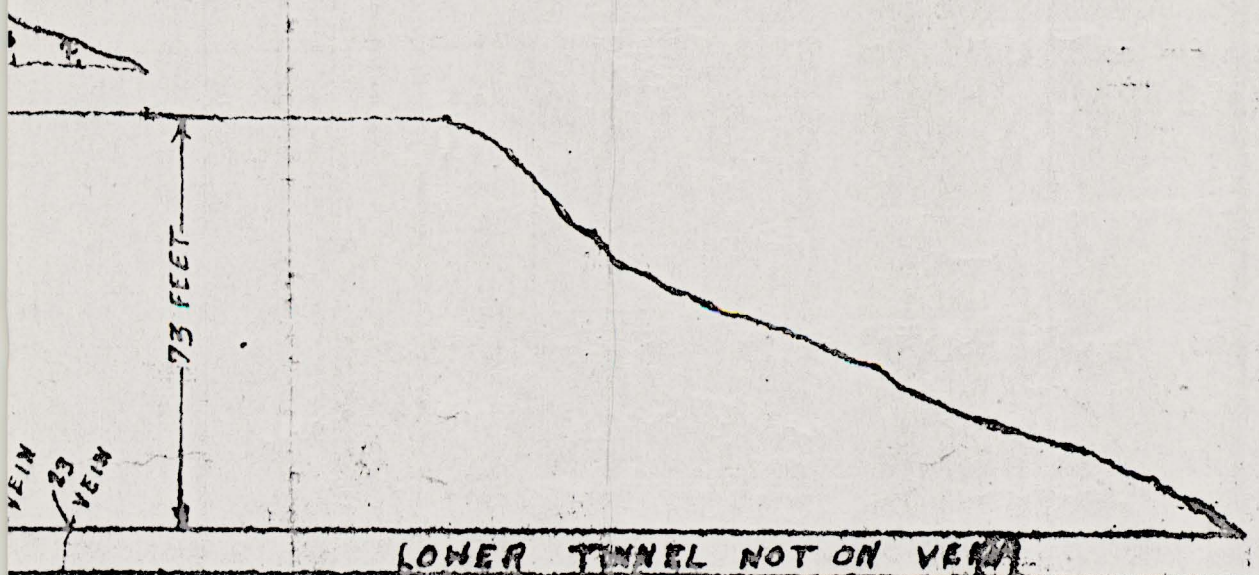

LOWER TUNNEL NOT ON VEIN

BASE



# PLAN

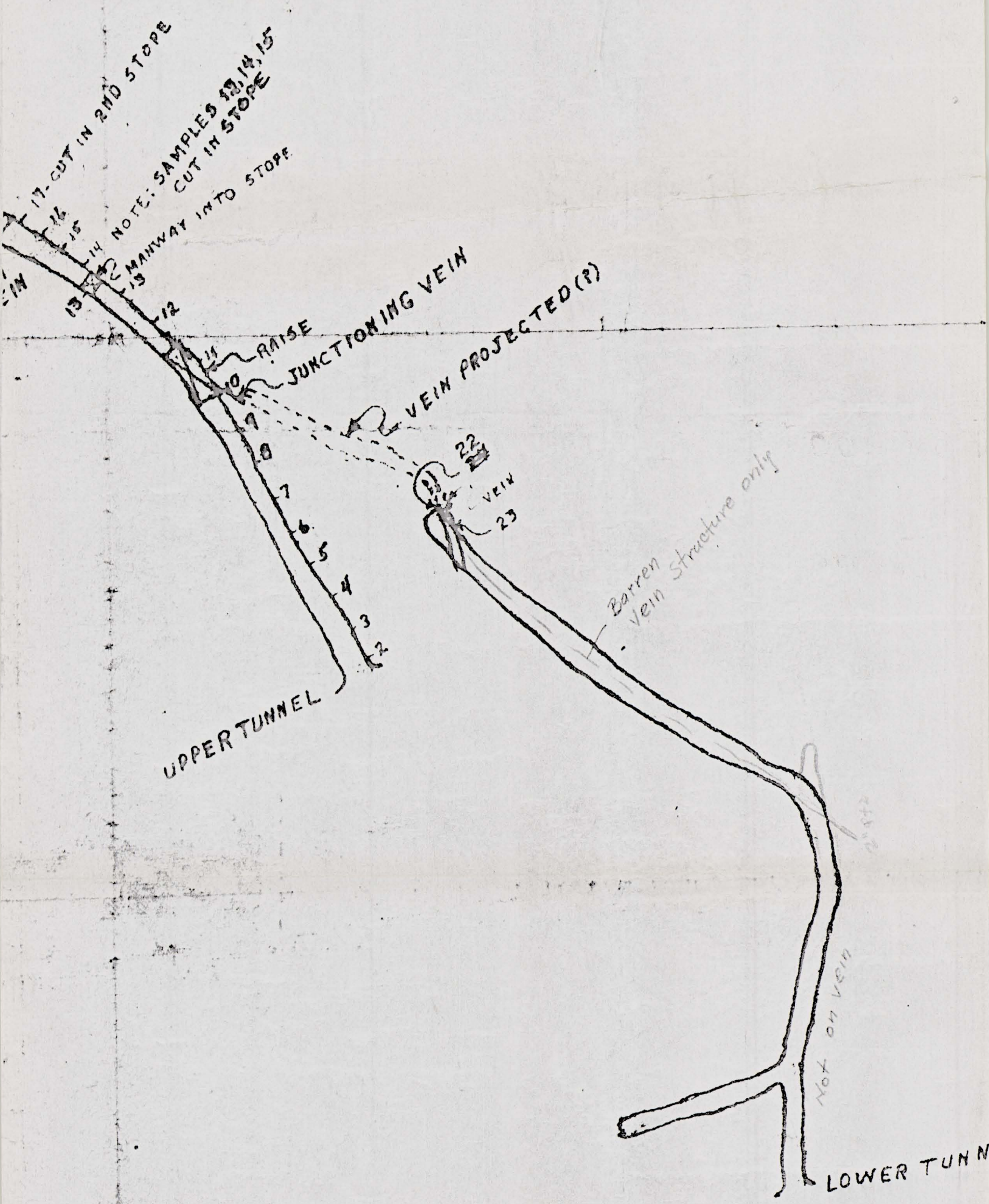

# LONGITUDINAL SECTION LOOKING N

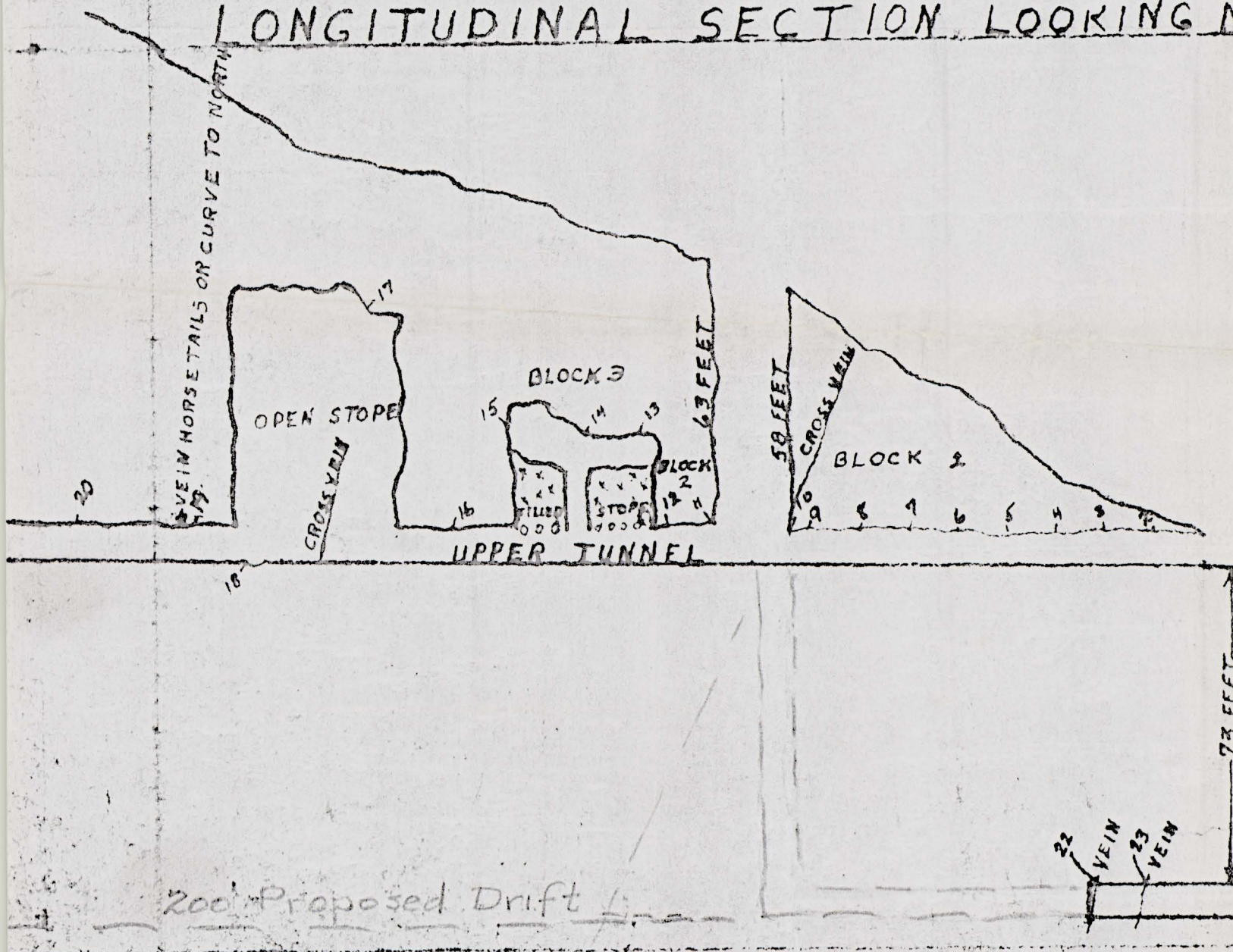



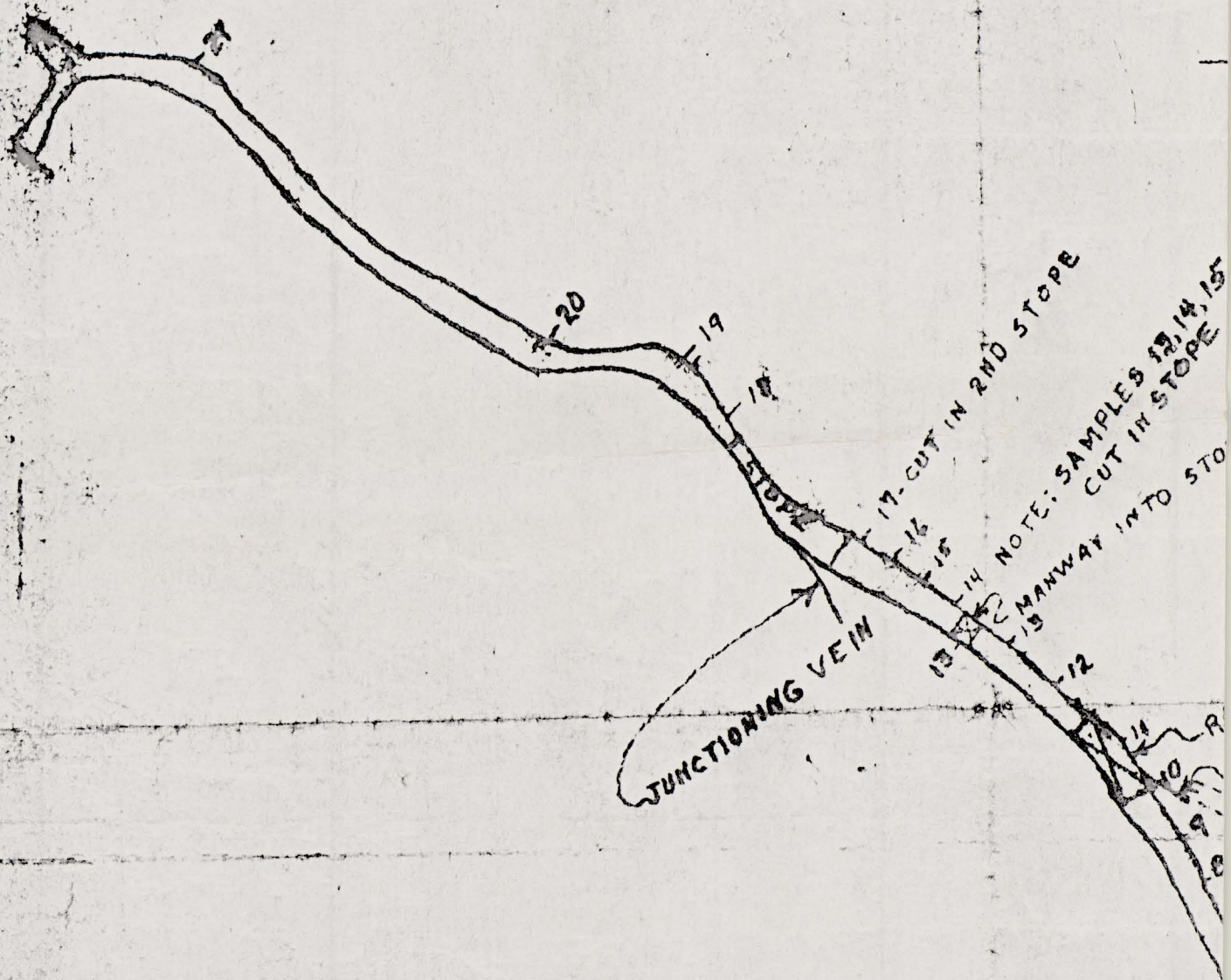

UPPERTU

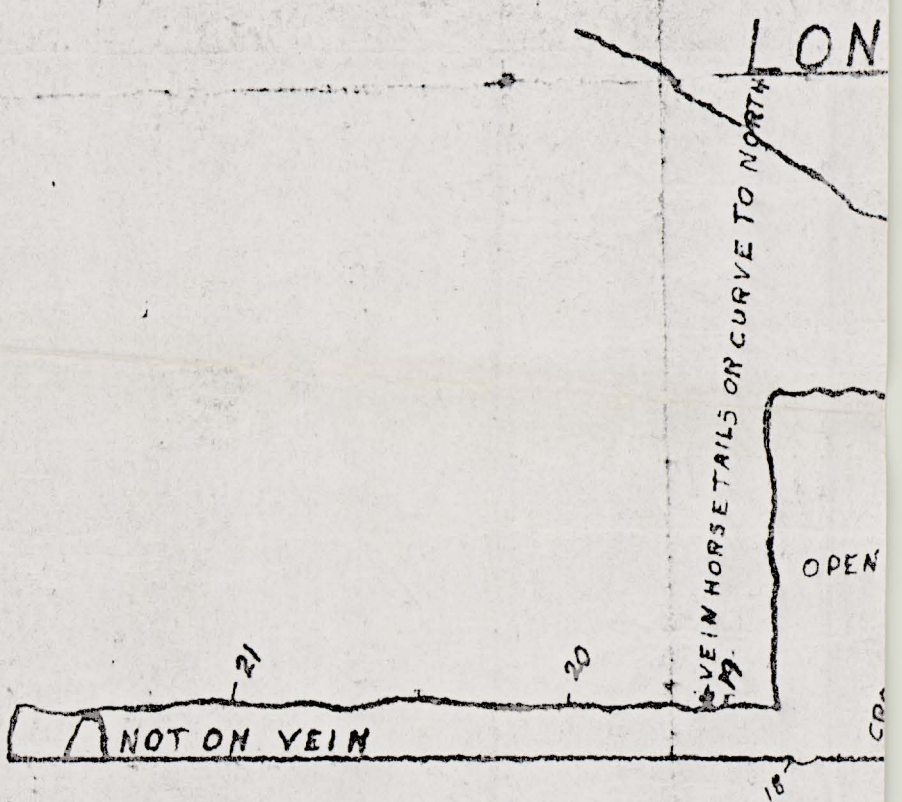



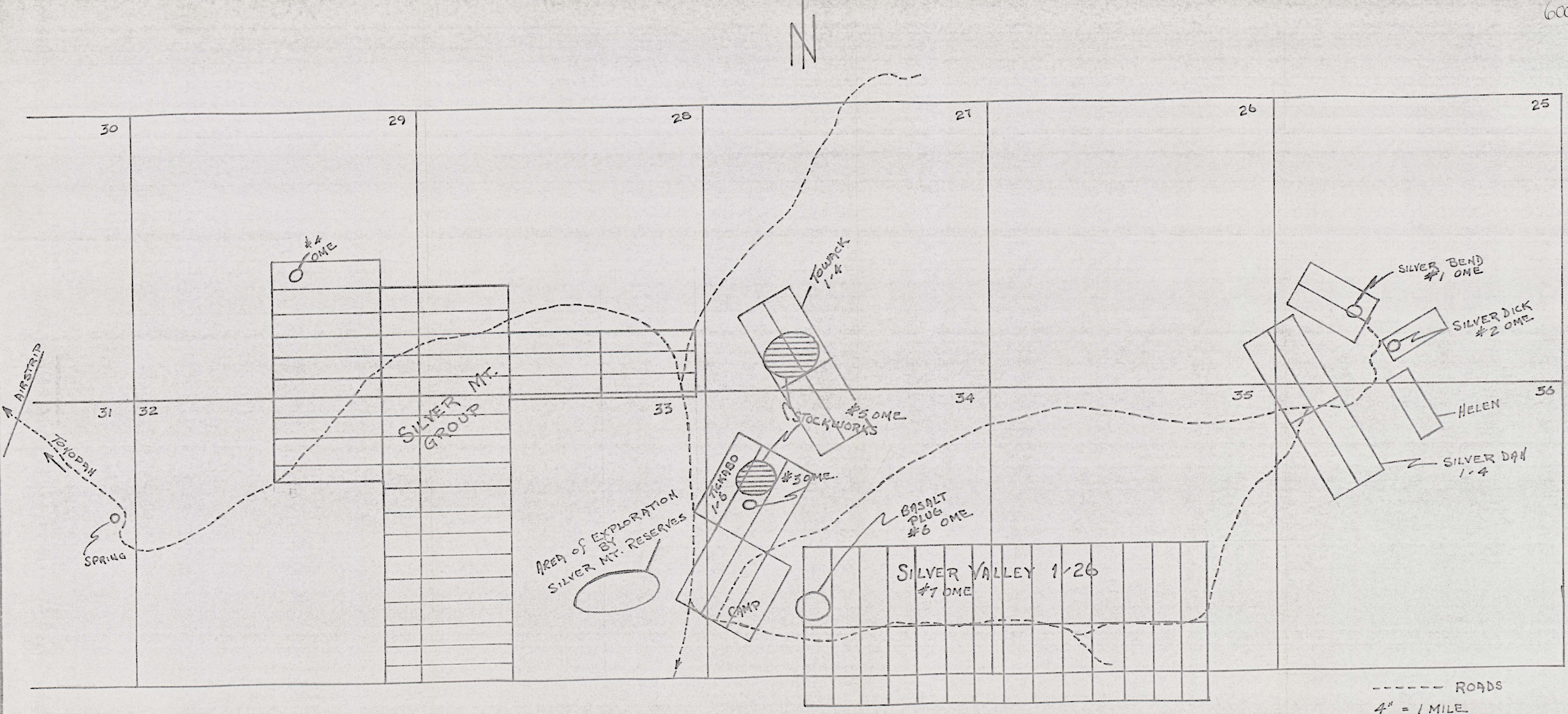

EXPLORATION LOCATIONS 1-7



