

250

item 3

4420 0003

S

R e p o r t

o n

T H E C A T L I N M I N E

With

Notes on the following prospects:

THE WHITE CAP

THE McCONOGALL

THE CLIFFORD

THE BELMONT

THE BLUE HORSE

THE MONOGRAM

S I L V E R B O W - N y e C o u n t y

N e v a d a

Examination: 4/8-13/1914.
Report: 4/16/1914.
By: W.H.SIRDEVAN.

R e p o r t

o n

T H E C A T L I N M I N E

The Silver Bow Mining District is located in the Kawich Range about 50 miles southeast from Tonápah. Golden Arrow is about 15 miles northwest and Bellehellen about 18 miles north from Silver Biw camp. Most of the development was done about 1906, but there are at present about a dozen people in the district, and some prospecting is being done.

The country rock is mainly light-colored rhyolite. Near the veins the rhyolite is either highly silicified or leached and altered to kaolin. Some of the veins show distinct brecciation, and the country rock near the Silver Bow Bell is a rhyolite flow-breccia.

The best millsite location is at Silver Bow Camp - where there is a stream flowing about two miner's inches.

This trip to Silver Bow was made primarily for the examination of The Catlin property, but other prospects in the district were visited and a few samples were taken.

THE CATLIN MINE

The Catlin property comprises six unpatented claims located about 1 1/2 miles northeast from Silver Bow, and covers about three thousand feet along the strike of the Catlin vein.

This prospect was brought to the company's attention by W. Stevenson of Silver Bow. Mr. Stevenson has a power of attorney to act for Nick Vico and J.A. Petrusich who are now working the property under lease. The terms of this lease are as follows: Given- Nov. 25, 1913; Expires- Jan. 1, 1916; Requirements: 50 shifts of 8 hours each per month; 200 linear feet of sinking during the life of the lease; all royalties to apply on the purchase price. Price: Total

\$25,000; Due Jan.1,1915 - \$2500; Due July 1,1915 - \$10,000; Due Jan.1,1916 - \$12,500. Power of attorney to W.Stevenson dated Jan.2,1914,before Hugh H. Brown,Notary Public,Tonopah.

The following shipments have been made from the Catlin property:
1 car (30 to 40 tons) - \$165 per ton; 2 cars - \$135; 2 cars - \$105;
1 car - \$94.60; 1 car - \$84.90; 21 tons \$69.80.

The Catlin vein varies from 1.5 to 5 feet in width, strikes N 70° to 80° W, and dips about 70° to the south. It has been developed to a depth of 123 feet by an incline shaft (see accompanying section), and is traceable on the surface for about 200 feet. The vein is a replacement in a light-colored rhyolite. The best ore is associated with a dark colored quartz carrying pyrite and black sulphide stains not very distinct but probably silver sulphides. The gold content of the ore is negligible.

Sampling Results.

Twenty - three samples were taken. See the accompanying longitudinal section for their location.

NO.	WIDTH	ASSAY		TOTAL
		Gold	Silver (50%)	
298	3.9'	tr	\$4.05	\$4.05
299	4.8'	tr	\$3.55	\$3.55
300	1.9'	tr	\$.60	\$.60
301	3.7'	\$.80	\$2.53	\$3.33
302	2.7'	tr	\$.42	\$.42
303	2.9'	\$1.20	\$17.12	\$18.32
304	5.0'	\$.80	\$7.43	\$8.23
305	1.9'	\$2.40	\$12.69	\$15.09
306	2.9'	tr	\$1.50	\$1.50
307	3.5'	tr	\$6.90	\$6.90
308	3.5'	tr	\$.44	\$.44
309	1.5'	tr	\$5.50	\$5.50
310	1.7'	tr	\$1.90	\$1.90
311	1.5'	tr	\$1.95	\$1.95
312	2.0'	tr	\$.12	\$.12
313	1.8'	tr	\$1.55	\$1.55
314	2.2'	\$.80	\$6.28	\$7.08
315	3.2'	tr	\$4.60	\$4.60
316	2.5'	tr	\$3.15	\$3.15
317	2.2'	tr	\$.26	\$.26
318	5.8'	tr	\$5.50	\$5.50
319	4.0'	tr	\$1.95	\$1.95
321	3.0'	tr	\$3.75	\$3.75
327	Grab shipping ore	\$3.20	\$35.37	\$38.57

Conclusions

The property is not recommended.

Notes on Other Prospects in the Silver Bow District.THE WHITE CAP.

This prospect is located in Breen Creek canyon about 1/2 mile from the Silver Bow Bell, and about two miles north from Silver bow. The owner - Nick Vico - claimed 20 feet of \$9 ore. Two 15' samples were taken in the soft altered rhyolite. One of them assayed a trace, and the other assayed \$.08 in silver per ton. See the accompanying section.

THE MCGONOGALL.

Located about one mile northeast from the Catlin. Four claims in the group. Development: a 400' tunnel with several crosscuts giving a maximum depth of about 200 feet. A few quartz stringers and bunches of quartz in a light-colored altered rhyolite. Poor showing. No samples were taken.

THE CLIFFORD.

Located about a mile and a half east from Silver Bow. A rhyolite breccia somewhat mineralized. On the tunnel level (see section) there are a few irregular bunches of good quartz ore carrying silver sulphides. One sample was taken near the surface across six feet of the best looking quartz. The assay result was \$.95 in silver per ton. The walls are not well defined.

THE BELMONT.

Adjoins the Clifford Group on the east. Now owned by M. Foran of Silver Bow. A quartz vein 2'-3' in width-traceable for several hundred feet along the surface. This property was optioned by Geo. Wingfield in 1906, and developed by a vertical shaft 100 feet in depth.

In the tunnel (see section) the vein is not so strong nor so well defined. It is here a brecciated zone with quartz, partly replaced silicified rhyolite, and some irregular masses and seams of kaolin.

Two samples were taken. NO.324 - a grab from quartz on the tunnel dump - assayed \$1.05 in silver. NO.325 - a cut sample at the surface for a width of 3.2' of quartz - assayed \$3.38 in silver.

THE BLUE HORSE and MONOGRAM (see section).

These prospects are located on the same vein, and about 1/4 of a mile southeast from the Clifford. A strong quartz vein - 2' to 5' in width, strikes N.30° to 55°W, and dips 50° to 76° north. This vein is traceable on the surface for about a thousand feet, and has been developed to depth of about 100 feet. At the Blue Horse shaft (a 100' incline on the vein) there is a stope about 100 feet in length said to have produced shipping ore.

One sample was taken on the Blue Horse property from a pile of quartz on the dump at shaft "A" (see claim map). NO.329 - vein 3' to 4' wide at this point - assayed \$1.70 in silver.

One sample was taken at the Monogram - NO.326 - cut sample on 100' level across 4.5' of quartz - assayed \$.55 per ton in silver.

The Blue Horse property is owned by Mrs. McNamara and Senator Bell of Tonopah. The Monogram group is owned by W. Stevenson of Silver Bow.

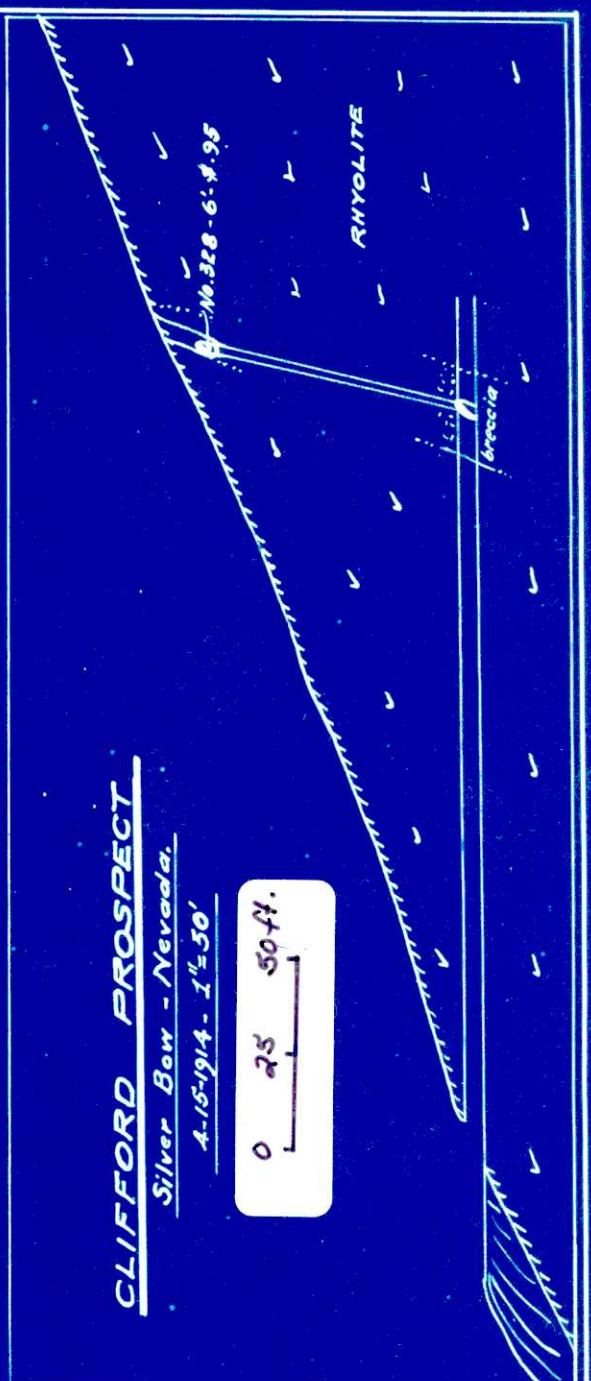
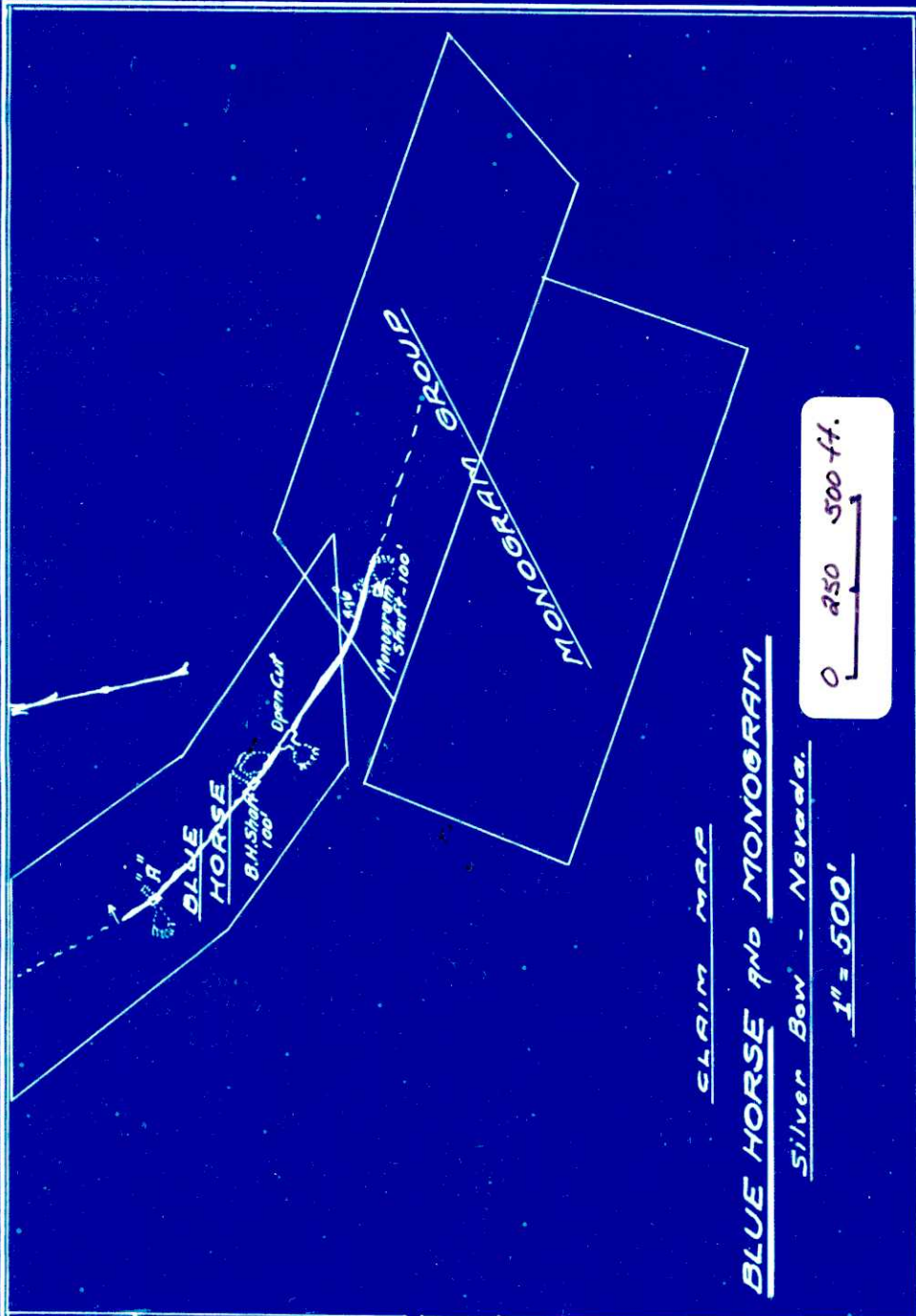
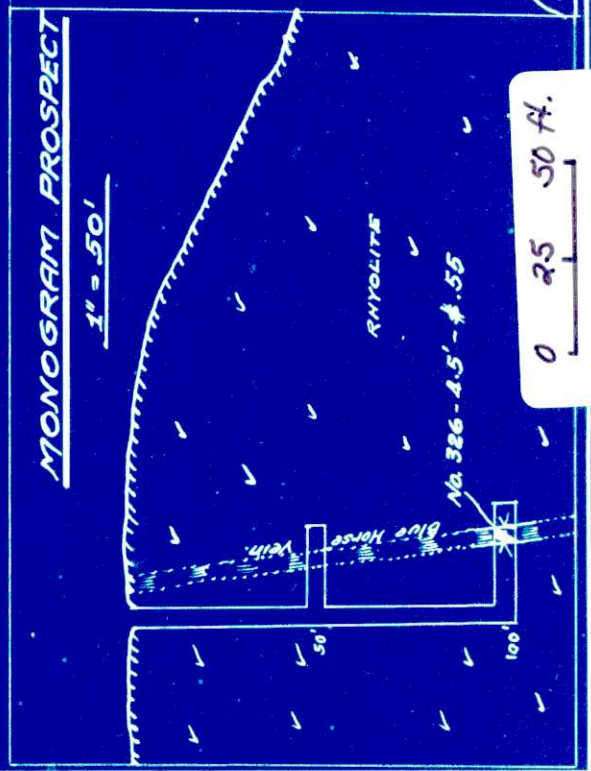
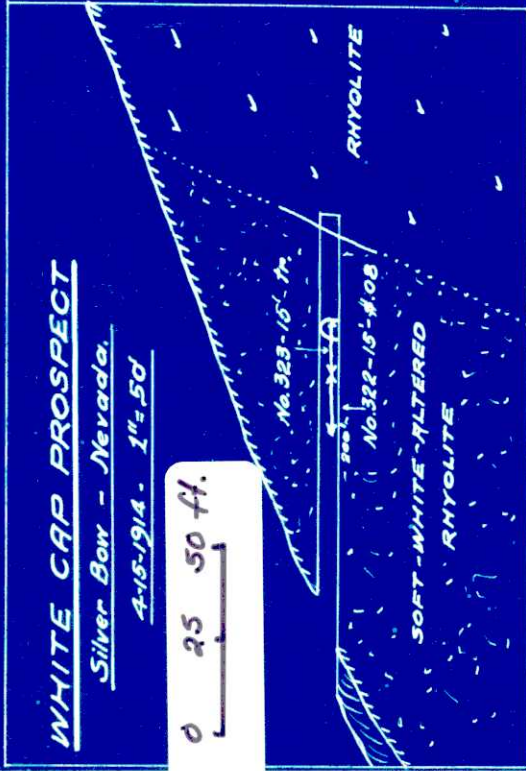
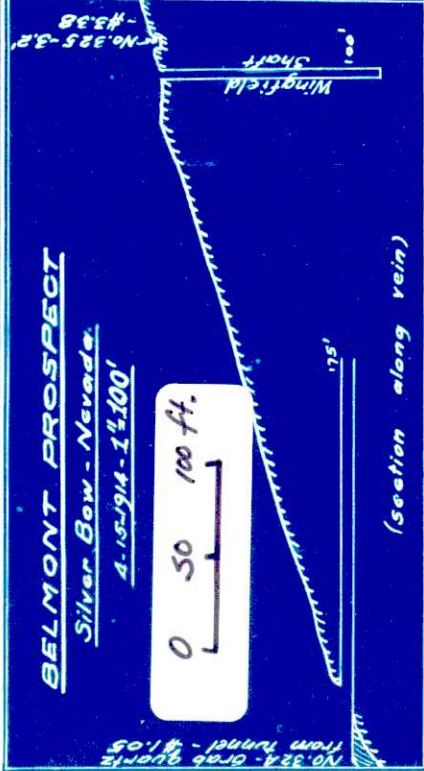

250 (item 3)

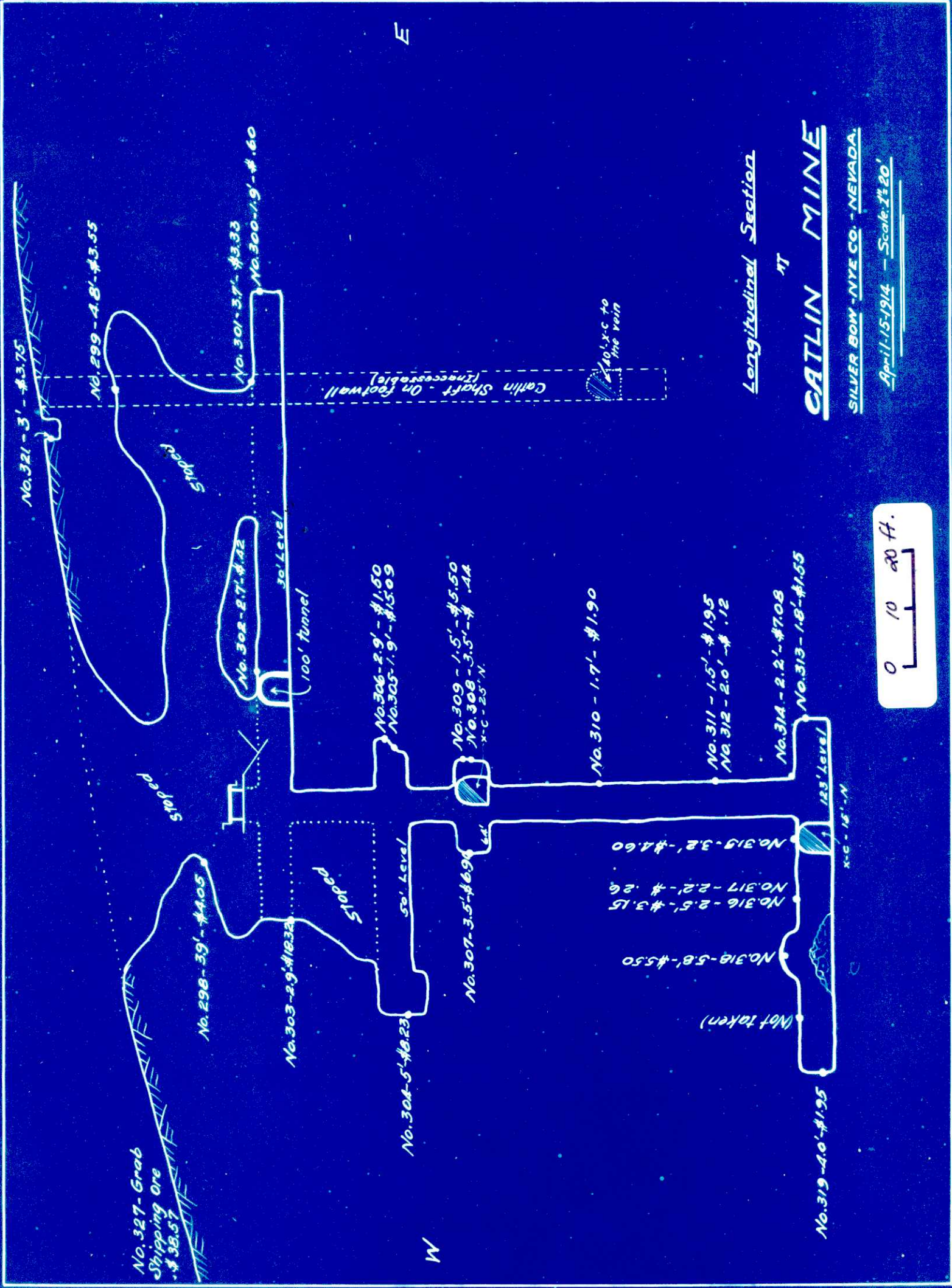

Longitudinal Section

47

CATLIN MINE

SILVER BOW - NYE CO. - NEVADA.

April-15-1914 - Scale: 1"=20'

