

Mining District File Summary Sheet

DISTRICT	Scodell
DIST_NO	4220 6000 0363
COUNTY If different from written on document	Pershing
TITLE If not obvious	Hughes Tool Co.; Claims offered for sale to Hughes Tool; "I" "J" - Antelope Springs Mine
AUTHOR	WD Johnson; L. Johnson; A. J. Anderson;
DATE OF DOC(S)	1970
MULTI_DIST Y (N?) Additional Dist_Nos:	
QUAD_NAME	Sugarloaf Knob 7½'
P_M_C_NAME (mine, claim & company names)	Hughes Tool Co.; Antelope Springs Mine
COMMODITY If not obvious	silver; gold; lead; copper, zinc
NOTES	property summary; assays; correspondence; location map

Keep docs at about 250 pages if no oversized maps attached
(for every 1 oversized page (>11x17) with text reduce
the amount of pages by ~25)

Revised: 1/22/08

SS: DD 2/7/08
Initials Date
DB: _____
Initials Date
SCANNED: T.M. 2/12/09
Initials Date

Group 32-5-74 - Drill Log

"I" & "J"

Al Decker

F

60

HUGHES TOOL CO.

CLAIMS OFFERED FOR SALE TO HUGHES TOOL

"I"

"J"

60

41700

4220

60000363

Immonen

Quampah, etc

C. Allen Jensen, agent

Johnson

Jones

PERSHING COUNTY

NEVADA

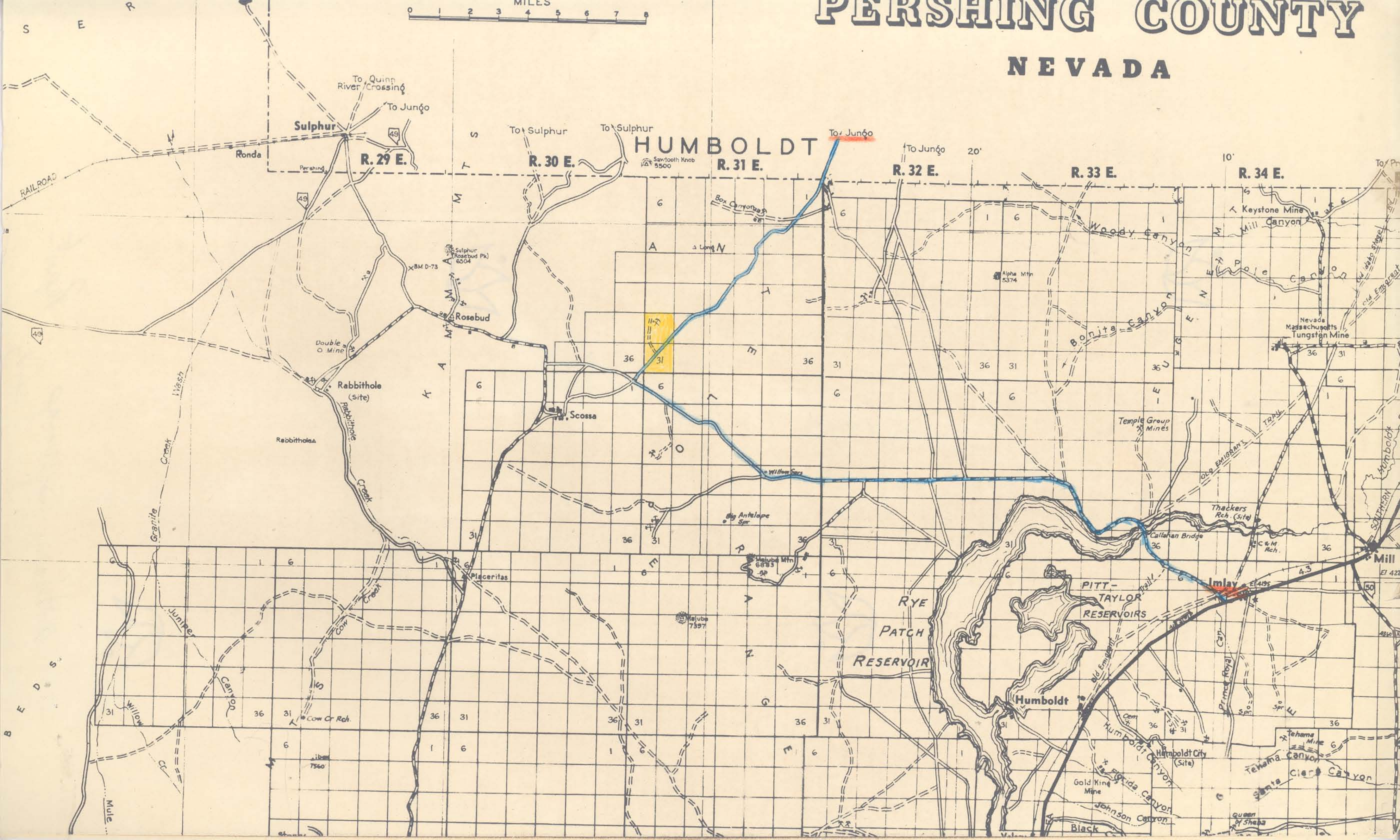

Telephone no(916)331-6684

5645 Madison Avenue
Sacramento, California-95841
September 18, 1970

Hughs Tool Company Mineing Operation
Tonopah, Nevada-89049

(Attention)

Mr. A.J. Anderson

Dear Mr. Anderson:

I am incloseing the report on the Antelope Springs mine allso
a map to show you where the Antelope Springs mine is located
in Pershing County Nevada,
Mr Anderson when you are ready to inspect the Antelope Springs
mine. call us and we will have Mr. Bill James to meet you in
Imlay , Mr Bill James is at Humboldt Nevada, just 7 miles from
Imlay Nevada, and he will show you the property.

Mr Anderson when you get through with the Report and Map Please
return them to us. Thank you.

Yours Truly



W.D. Johnson



Louise Johnson

RECEIVED
HUGHES TOOL COMPANY
Mining Division
Tonopah Office

SEP 22 1970

A. J. Anderson

MEMORANDUM

TO: Mr. A. J. Anderson
Mining Division

FROM: L. Bunker

DATE: September 29, 1970

SUBJECT: For Sale - Antelope Springs Mine - 640 acres patented
and 260 acres covered by claims.

Owners: Mr. W. O. Johnson
Louise Johnson
5645 Madison Avenue
Sacramento, California 95841

Phone: 916-331-6684

Location: The Antelope Springs Mine is located in Sections 30, 31; T35N; R31E in the Antelope Mining District in Pershing County, Nevada. This area is about 25 miles Northwest of Imlay, Nevada. The attached map shows the location of the area.

History: This is an old property and it has been extensively worked with a production record of \$500,000. The smelting returns varied, but it showed values in gold, .01 oz.; silver, 25.07 oz.; lead, 7.7%; copper, 2.55%, and zinc, 21.2%.

The mine has been worked to the 400 ft. level.

Report: Registered Engineer of Mines, Cecil M. Hanselman, submitted a report on the property in 1941 and concludes: The property of the Antelope Mine has a great deal of merit, based on the following deductions:

1. The property is located on two string, true fissures that can be traced for over a mile.
2. The intrusive porphyry dykes cutting across the vein and with a primary formation, is one most adaptable to ore deposition.
3. The entire property is of a primary origin.

First: The schist beds
Second: Intrusive porphyry dykes
Third: A true fissure vein

4. Mineralization of the fissure veins