

3890 0028

160

Item 39

**PRELIMINARY EXAMINATION  
OF THE  
METTACOM CLAIMS  
T 20 N, R 44 E, S 31 & 32, MDBM  
LANDER COUNTY, NEVADA**

**PAN-NEVADA INC.**

**L. B. GOLDSMITH**

**J. K. DUFF**

**AUGUST, 1968**

## TABLE OF CONTENTS

LOCATION MAP	1
INTRODUCTION	1
GENERAL GEOLOGY	1
ECONOMIC GEOLOGY	1
CONCLUSIONS AND RECOMMENDATIONS	2
APPENDIX	
SAMPLE LOCATION MAP	Pocket inside back cover

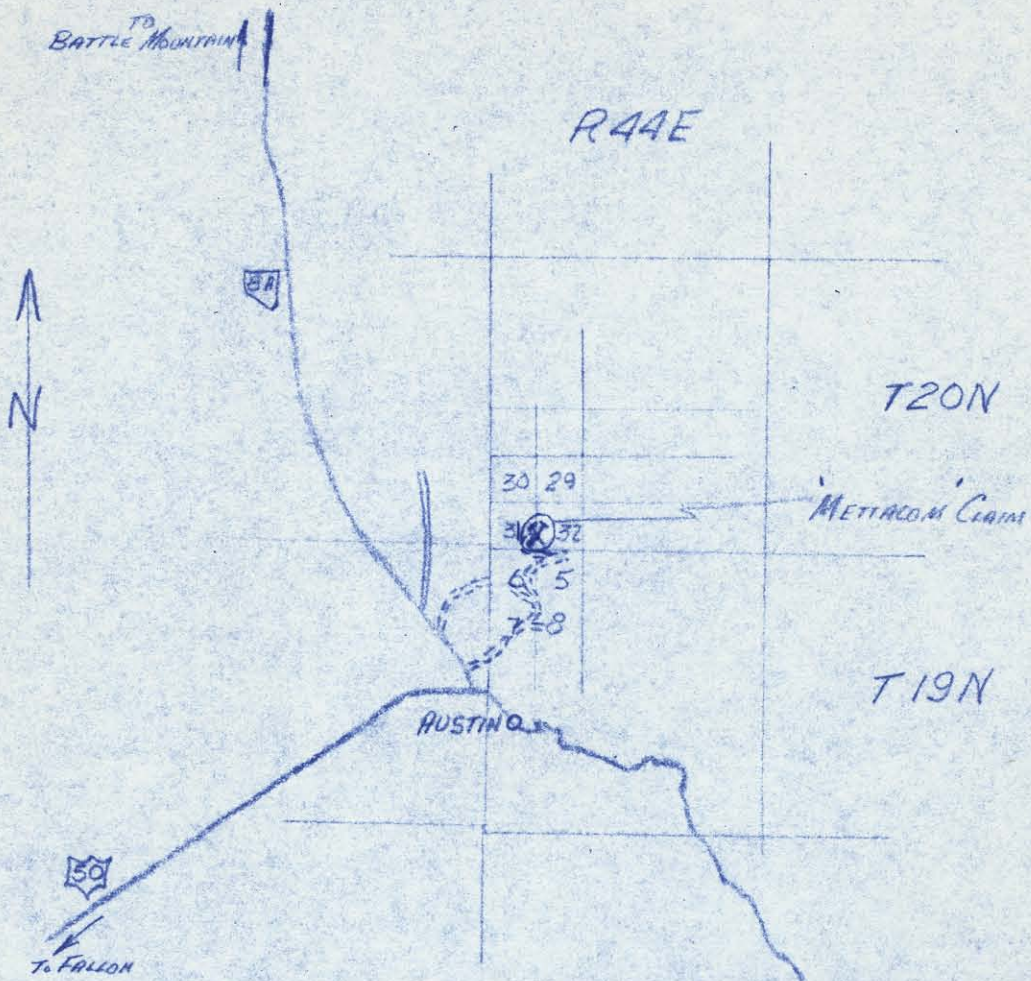

METTACOM CLAIM  
LOCATION MAP

T20N, R44E, S31°32'  
MDBM

LANDER COUNTY  
NEVADA

P22

SCALE  
0 1 2 3 4 5  
MILES



## **INTRODUCTION.**

One unpatented and one patented claim comprise the property, the unpatented claim supposedly staked over the old patent. The location description as furnished to us states that the claims are in T 19 N, R 44 E, Sec. 5 and 6; however it seems probable that they are in T 20 N, R 44 E, Sec. 31 and 32.

The property may be reached by truck from Austin. The claims are situated on the west slope of the Tolyaba Range.

No previous economic geology report has been found.

Preliminary examination of the property was performed on August 10, 1968 by J. K. Duff and L. B. Goldsmith.

## **GENERAL GEOLOGY.**

The claims are staked on a granitic plug which has intruded cherts and other sediments in the general vicinity. At least one porphyry dyke has dissected the granitic mass on the property.

Where sheared, the granitic altered zones carry some pyrite, sometimes associated with quartz veins and veinlets.

## **ECONOMIC GEOLOGY.**

Assays reveal that the most favourable appearing situations run nil or too low in gold and silver to be of commercial value.

**CONCLUSIONS AND RECOMMENDATIONS.**

**Assessment work is complete for 1967-68.**

**No further work is advised. The claims should be returned to the lessor in ample time to relieve us of assessment work for 1968-69.**

*L. B. Goldsmith*

**L. B. Goldsmith, Geologist**

**Pan-Nevada Inc.  
August, 1968**

## APPENDIX

# SAMPLE LOGS - METTACOM CLAIMS

NUMBER	DESCRIPTION	ASSAYS	
		Au Ozs/ton	Ag Ozs/ton
203	Channel, 10'. Alteration zone. Possible contact between granite and porphyry dyke. Some limonite and manganese stain present.	Tr	1.6
204	Chip, around walls of pit in granite. Light limonite gossan. Oxidized sulphides (pyrite).	Nll	Nll
205	Channel, 8'. Collar of inclined shaft. Sheared granite and quartz vein. Limonite gossan.	Nll	Nll

Assays were performed by the Union Assay Office, P. O. Box 1528, 269 Brooklyn Ave., Salt Lake City, Utah; the original assay report, dated August 15, 1968, is signed by Glen P. Williams.



160

Item 39

PURITE

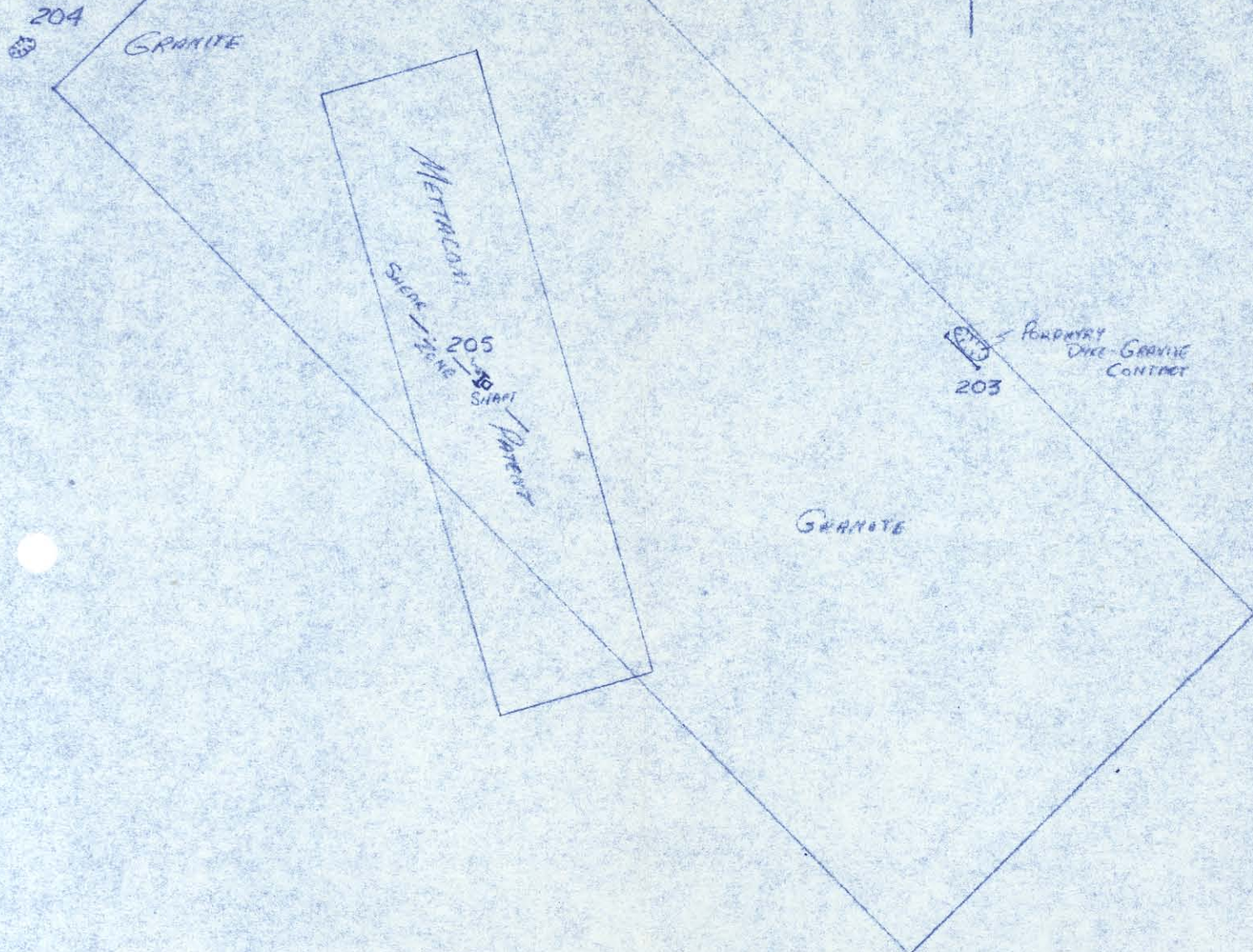

PAN-NEVADA, INC.

PRELIMINARY PLAN (AFTER F. LEWIS)

METTACOM CLAIMS

T 20 N, R 44 E, SEC 31 & 32, LANDER COUNTY

SCALE: 1" = 200'

AUGUST, 1968

LBG EJKD



FRANK W. LEWIS  
6904 WOODMAN AVENUE  
VAN NUYS, CALIFORNIA 91405

AREA 213 780-5689

May 21, 1968

L. B. Goldsmith, Geologist  
Pancoastal Mining  
Apt 512 Snyder Ave  
Yerington, Nevada

RE Lost Mines  
Mettacom

Dear Mr. Goldsmith:

Sorry to hear you are having so much trouble finding the Mettacom mine.

Enclosed are some maps and Notes which I am sure will lead you right to it.

My old posts were personally taped and measured by me on the Unpatented mine. So I am positive they are there. You must not yet be in the right area. Also each corner and side center is marked with an aluminum tag, properly describing the corner.

I am sure you will not have any trouble after spending one day with theses notes and maps and sketches I am sending along, enclosed herewith.

The key to finding it is to locate the old mill Foundation as noted on the map. From there you could even reconstruct my corners but even this would not be necessary for most of the old corners were Pine trees which I cut and trimmed up and it would have been very difficult to remove them. The Northwest corner was a regular 4 x 4 and the Location Monument also. All the rest were Trees, cut and trimmed. *as I recall*

I had put in the one claim just to hold the area. It is a good area and I reccomend you locate a couple of more claims while you are there. There are a number of outcrops which assay and the area is not explored at all. A Geo Chemical survey would be useful.

Site of the old Mettacom Mill is on the property. The N W Corner of the claim bears N 87° E to Prominent peak between Yankee Blade and New York Canyon, an estimated distance of 4,000 feet. It is approximatel in Section 5 and 6, near the center, T. 19 N, R 44 E.

Take along about 50 feet of ladders to put down the shaft as it is not deep. Then you can go right down it and assay it.

If you try once more and can't find it. Let it go and I will get with you and lead you to it the next time I come up.

Good Luck,

*F. W. Lewis*  
F. W. Lewis

Encl: Various maps & plats



AP1517 Snyoe Ave  
YERINGTON, NEVADA  
May 16, 1968

Mr. Frank Lewis  
6904 Woodman Ave  
Van Nuys California

Dear Frank

On May 14, 15, 116 Norm Byrne and  
myself hunted for the Mettacom group (P22)  
without success. We found a couple of  
mud sites without the corresponding shaft  
and lots of shafts. There has been considerable  
recent staking in the area; perhaps your  
posts have been removed. We would  
appreciate it if you would check the  
property for location and boundary posts,  
and forward a sketch map with the  
route to reach the property from Austin



Do you still wish notices of proof of labor with book and page number sent to each of the three addresses that are listed in the agreement?

We were to the Best Chance today, for a brief check on what we may require. Your man Harris expects to be there until about June 1; this should mesh well with our plans as we expect to commence work in the first week in June.

Yours truly,  
L. B. Goldsmith



# CERTIFICATE OF LOCATION

## LODE—QUARTZ

THIS IS TO CERTIFY that the METTACOM # 1 lode mining claim was located by

Frank W. Lewis  
(print name of locator)

(print post office address)

6904 Woodman Ave.

Van Nuys, Calif.

on the 31<sup>st</sup> day of August, 19 65, situated in the Amador (Reese River) Mining District, Lander County.

State of Nevada, and about in Sec 5 and 6 near the center - T 19 N, R 44 E. (Site of Old Mettacom Mill is on the property) N W Cor of the claim bears N 87° E to Prominent peak between Yankee Blade and N. Y. Canyon an estimated distance of 4000 ft. Thence the L. M. bears N. 45° E from N W Cor.

116/64 l claim 1500 linear feet along the course of the mineral-bearing ledge, lode or vein, extending 1499 feet from the location monument in a S. 45° E. direction, and 1 feet in a N. 45° W. direction, together with 300 feet on each side of the center of the ledge for the entire length of the claim.

The discovery work consists of a Trench located about 250 feet in a Northerly direction from the junction South side ctr. approx., and its dimensions are 4 feet wide, 11 20 feet long and 4 feet deep, exposing ledge, lode or vein in place.

The northwest corner is marked by a post 4 1/2 feet high, inscribed "NW Corner of the Mettacom # 1 Claim"; the southwest corner is marked by a Post 4 1/2 feet high, inscribed "SW Corner of the Mettacom # 1 Claim"; the southeast corner is marked by a Post 4 1/2 feet high, inscribed "SE Corner of the Mettacom # 1 Claim"; the northeast corner is marked by a post 4 1/2 feet high, inscribed "NE Corner of the Mettacom # 1 Claim" There is also a 4 1/2 post at the center of each side line. The discovery work has been done, and the location completed since September 1st 19 65

Frank W. Lewis

**LOCATORS**

*Frank W. Lewis*

Dated Afternoon Sept 1, 19 65

(Section 517.000, Nevada Revised Statutes, provides that every location of a mining claim made after July 1, 1941, shall be absolutely void unless a certificate of location thereof is recorded with the county recorder of the county in which the claim is located within 90 days after the date of location.)



## Proof of Labor

STATE OF

NEVADA

SS.

County of

LARDER

BEFORE ME. personally appeared the subscriber,

L.B. GOLDSMITH, PAN-NEVADA INC,APT 512, SNYDER AVE, YERINGTON, NEVADA

who being sworn, says: that at least

\$100

dollars

worth of labor or improvements

CONSISTING OF GEOLOGICAL MAPPING, SAMPLING,  
AND ASSAYING, DONE BY L.B. GOLDSMITH & J.K. DUFF  
GEOLOGISTS, ON AUGUST 10, 1968

were performed and made upon

THE 'METTACOM No 1', AN UNPATENTED COPE  
MINING CLAIM

situated in

REESE RIVER

Mining District, County

of

LARDER

State of

NEVADA

during the year

ending

SEPTEMBER 119 68

SUCH EXPENDITURE was made by or at the expense of

PAN-NEVADA INC, APT 512,SNYDER AVE, YERINGTON, NEVADA

owner.... of said claim, for the purpose of holding said claim.

Subscribed and sworn to before me, this

day of

19

L.B. Goldsmith

RECORDED AT REQUEST OF

Pan. Nevada

8-13 1968 AT 11:00 A.M.

BOOK 28 OFFICIAL RECORDS PAGE 422

OF LAS VEGAS COUNTY, NEVADA

FILE NO. 53097 Carol Schuch  
COUNTY RECORDER