

3860 0075

(b1)

ITEM

99

McGowan District Property
Silver Peak Dist.

on W side of Red Mt. about
4 ml. S of Silver Peak on
Fish Lake Valley side of the
range

Au Ag

PLATORO
K344 E. IN
HIGHER

Esmeralda

Argentine Feb

November 13, 1935.

Mr. H. A. Johnson, Supt.,
The Tonopah Mining Co. of Nevada,
Tonopah, Nevada.

Dear Johnny:

Many thanks for Sharp's report covering the Eureka District. We are sending one of the copies on to Mr. Lindsley, as you suggest.

There is a property located near Lordsburg, Arizona, which we have been considering and about which we will have more data within a few days. If we make the arrangements, and, if possible, I would like to have Sharp examine the property while he is in Arizona.

I think you are cleaning up the Argentine situation in good shape, and am only sorry that the crosscutting showed such poor results. We will hope for better luck on the other vein.

I am much interested in your idea of ore house rejects, and hope that you will be able to have a few rough samples taken to more or less check your idea. If these dumps will average 5 oz. they would certainly be of interest if silver goes to \$1.29.

Mr. Maehrlen tells me he is having you come on here in the near future, and we will all be glad to see you, and hope that Mrs. Johnson may come with you.

Sincerely yours,

Vice-President.

BNH-h.

November 4, 1935.

Mr. H. A. Johnson, Supt.,
The Tonopah Mining Co. of Nevada,
Tonopah, Nevada.

Dear Mr. Johnson:

Replying to your letter of October 30th, in further regard to the Argentite situation. I note that you have about finished the crosscut which we suggested, and that you are going to move the equipment over to the other canyon and start the tunnel on the other vein. You state in the letter that mineralization seemed to continue in the footwall for a considerable distance, but was of the same low value as you had been drifting upon. I note that you are going to make a short crosscut to the West at the same point. It seems to me that it might be worth while to sample these two crosscuts quite carefully, with the possible idea in mind that a considerable width of mineralization might carry possible workable values. However, you no doubt have this in mind.

I am glad that Mr. Sharp has been able to study the Eureka District, as suggested by Mr. Lindeley, and we will be glad to have his report.

Governor Scrugham started in a couple of weeks ago to consider with me the Windfall Mine at Eureka, but suddenly dropped out of the picture. I have a notion that Scrugham probably got some money from the U. S. on this venture, but this is only a surmise.

I am indeed interested in your statement that you think there is sufficient dump ore in Tonopah to warrant a custom mill, in case silver goes to \$1.25. I have been studying the statement in regard to a possible mill which you sent us, and will take the matter up with you in more detail later on. In the meantime, I would be interested in knowing what guess you would make as to the average value of the Tonopah dumps. I realize that this would be a crude guess, but think you may have some quite fair notion of the general dump value.

Very truly yours,

H. A. J.

H. A. J.

Very

Respectfully,
H. A. J.

THE TONOPAH MINING COMPANY OF NEVADA

EASTERN OFFICE
570 BULLITT BUILDING, PHILADELPHIA, PA.

PLEASE ADDRESS ALL COMMUNICATIONS
TO THE COMPANY, TONOPAH, NEVADA

TONOPAH, NEVADA,
October 30, 1935.

Mr. M.B. Huston, Vice President,
The Tonopah Mining Company of Nevada,
570 Bullitt Building,
Philadelphia, Pa.

Dear Mr. Huston:

Crosscutting to the east has been going on for the past ten days and has now reached a point about 15 feet east of the vein as shown on the surface. Some mineralization shows in the footwall but of the same low value as we have been drifting on. For the past 35 feet we have been in unaltered rhyolite. This crosscut is being discontinued tonight and two days will be spent in crosscutting west. If nothing of interest is found we will move the outfit so as to start where the other vein outcrops in the canyon. A short crosscut of about 30 feet will be driven to reach the vein before drifting on it. This gives a better setup and also about 15 feet more depth.

Sharp has been in Eureka for the past ten days looking over the district as proposed by Mr. Lindsley and will report on it shortly.

Further in regard to the construction of a mill in Tonopah I believe that there is sufficient dump (ore house reject) ore to warrant it in case silver should go to \$1.29. Of course, thorough sampling would be necessary. There are probably 100,000 tons of this material.

Yours very truly,

W. J. Carson
Superintendent.

October 30, 1935.

Mr. Thayer Lindsley,
25 King Street West,
Toronto, Ont., Canada.

Dear Chief:

Enclosed please find copy of letter from Johnson, in regard to the Argentite, in which he replies to the letter I sent him, and of which a copy was sent to you.

I believe Mr. Johnson's letter and my reply are self explanatory.

I am enclosing a tracing of the latest map which shows the sampling of the 50' shaft and croppings on the other vein where we contemplate driving at least 200'. The map indicates that the shaft is in quite good values, while the sampling of the two croppings between the shaft and the canyon where the tunnel would start are of much lower grade.

Sincerely yours,

Vice-President.

BNH-h.
Encl.

October 21, 1935.

Mr. H. A. Johnson, Supt.,
The Tonopah Mining Co. of Nevada,
Tonopah, Nevada.

Dear Mr. Johnson:

Mr. Lindsley was here on Friday, and we showed him the data which you have forwarded us on the Argentite, and discussed with him possible procedure. He, of course, felt that our present tunnel work is not very favorable and is beginning to suspect that the property may not prove of interest. At the same time, we are all of the opinion that it might be best to do at least a little more work before abandoning the proposition.

We noticed from your plan map that the lower tunnel is going off considerably to the West, and is striking more nearly to the North than the surface indications of the vein would seem to warrant. We presume that you have this well in mind, and no doubt have been studying the situation carefully to make sure that you are on the right vein, but at the same time there is always very much of a chance of losing the vein in that type of ground, that we thought it worth while to wire you to drive a crosscut from near your present face Eastward until you were at least vertically below the croppings. I think you will agree that this is a reasonable precaution.

Mr. Lindsley is of the impression that both he and yourself felt that the other vein upon which the 50' shaft is sunk was a stronger appearing vein on surface. You have sent us two pretty good assays from the drift at the bottom of this shaft, and I believe you have indicated that you are having the shaft completely sampled. If this sampling shows any interesting values, we were all of the opinion that it then might be worth while to drive a tunnel along this vein from near the bottom of the first gulch, South to the 50' shaft. However, this idea would also depend upon how much it would cost to move the equipment to this suggested location. Would this be relatively hard or simple? If you are reaching the end of the crosscut by the time you receive this letter, and if you think this other tunnel might be worth considering, I suggest that you send us a night letter giving us the cost of moving the equipment to the new location, as well as the cost of driving say 100 or 200'.

We noticed that this vein is very near to the Sanger Group, and that the suggested tunnel would probably start about the Sanger line, but, of course, we would hold any downward extension of the vein from this point northward under apex rights. However, if we are to do this work in the new location, it would be well to try again to get some reasonable option on the Sanger while the work is going on, provided this is possible. Will you kindly look into this and let us know.

-2-

Mr. Lindsley felt that he should have answered some of your letters before this, and suggested that we write this letter as the result of our combined conference, and also asked us to convey his best regards to you.

Very truly yours,

Vice-President.

MBH-h.

XC

No other telegraph office where this message originated

ONLY WESTERN UNION can carry your answer back by TELEGRAPH... Quickly, accurately

APPRECIATE SUGGESTIONS FROM ITS PATRONS CONCERNING ITS SERVICE

WESTERN UNION

1201-S

SIGNS	
DL =	Day Letter
NM =	Night Message
NL =	Night Letter
LC =	Deferred Cable
NLT =	Cable Night Letter
Ship Radiogram	

PRESIDENT

NEWCOMB CARLTON
CHAIRMAN OF THE BOARD

J. C. WILLEVER
FIRST VICE-PRESIDENT

The filing time as shown in the date line on full-rate telegrams and day letters, and the time of receipt at destination as shown on all messages, is STANDARD TIME.

Received at Western Union Building, 230 So. 11th St., Philadelphia, Pa.

OCT 18 AM 1 50

CD55 46 NL XC=TONOPAH NEV 17

W L HAEHNLEN, CHAIRMAN OF BOARD=

MINUTES IN TRANSIT	
FULL-RATE	DAY LETTER

THE TONOPAH MINING CO OF NEV 570 BULLITT BLDG PHA= ARGENTITE DRIFT IN TOTAL LENGTH FOUR HUNDRED TWELVE FEET VALUES CONTINUE TO BE LOW ALTHOUGH VEIN IS STRONG BUT NARROW STOP SHARP WILL MAKE ADVERSE REPORT GOLD PENN RAND STOP AIR MAIL LETTER SHOULD REACH YOU TODAY GIVING FULL DETAILS VERTEX STOP CONDITIONS MINE HERE NORMAL=

H A JOHNSON.

RECEIVED
OCT 18 1913
P. M.

OCT 18 1913
P. M.

THE QUICKEST, SUREST AND SAFEST WAY TO SEND MONEY IS BY TELEGRAPH OR CABLE

THE TONOPAH MINING COMPANY OF NEVADA

EASTERN OFFICE
570 BULLITT BUILDING, PHILADELPHIA, PA.

PLEASE ADDRESS ALL COMMUNICATIONS
TO THE COMPANY, TONOPAH, NEVADA

TONOPAH, NEVADA, Sept. 30, 1935.

Mr. L. H. Bregy,
Exploration Department,
The Tonopah Mining Company of Nevada,
Philadelphia, Pennsylvania.

Dear Mr. Bregy:

The tracing of the Argentite property was received Saturday. A few days before, we had sent a duplicate tracing to you, bringing the work closer to date. We still have a number of assays to run to bring the work up to the present time and these should be out in a day or so, at which time we shall place them on the tracing which you returned to us, and then send it on to you.

In regard to the three shafts (10, 20 and 50 feet deep) on which Mr. Huston has asked why they have not been sampled, there is included in the tracing which we have sent two assays taken at the bottom of the 50 foot shaft. I was at the property yesterday, and have made arrangements to have the 50 foot shaft sampled in 10 foot sections from the top to the bottom, and also to have several samples taken from the 10 and 20 ft. shafts. These shafts are on the Taylor & Sanger vein, which we think is a different vein from the one on which the tunnel is being driven. The strike is somewhat different, and there is a deep gulch between the tunnels and shafts. The vein in the tunnels appeared to be more promising than the Taylor & Sanger vein at the time we started work on the tunnel. The tunnel is now in 283 feet, of which 250 feet is our work. The vein is about 2 feet wide, consisting of about 8 inches of chert and about 16 inches of gouge and mud containing boulders of a very likely looking rock. I am having some of these boulders assayed today and shall send you the results. These boulders contain much calcite and barite, and I am in hopes will also carry sufficient values to make it interesting.

Mr. Spitzer, our foreman, is ill and has resigned. I have put Mr. C. L. Butler in charge and I hope things will go on as satisfactorily as they have been going.

With kind regards,

Yours very truly,

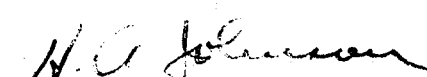

August 30, 1935.

Mr. H. A. Johnson, Supt.,
The Tonopah Mining Co. of Nevada,
Tonopah, Nevada.

Dear Mr. Johnson:

I am in receipt of your letter of August 23rd, in which you enclosed a sketch showing the approximate location of the Argentite. In going from Silver Peak to Bishop, I often used to notice the sign pointing off to the right, which was marked Cow Camp, so I know where this Argentite road is.

Your sketch is, of course, simply a rough one, but I am wondering if you meant to bring Argentite quite so close back to Silver Peak, as you have done. As you probably know, the road which goes up to the Silver Peak Mine extends in that direction, is a poor road for quite a long distance. I would say easy 10 miles beyond the old Silver Peak workings. I went up there one time to look at a prospect with a chap named McKenzie, who runs a bootleg joint at Silver Peak. From this prospect of McKenzie's we could look back down the hill to Blair Junction. At this point we were still in the old precambrian formation in which the deposits are typically lenticular. On the McKenzie property the lenses were very small, but, of course, on the Silver Peak some of them were very large. I wonder if you know this McKenzie property to which I refer, and how far West or Southwest this Argentite is actually located from it.

Very truly yours,

Vice-President.

MSH-jh.

THE TONOPAH MINING COMPANY OF NEVADA

EASTERN OFFICE
800 BULLITT BUILDING, PHILADELPHIA, PA.

PLEASE ADDRESS ALL COMMUNICATIONS
TO THE COMPANY, TONOPAH, NEVADA

TONOPAH, NEVADA, August 23, 1935.

Mr. M. B. Huston, Vice-Pres.,
The Tonopah Mining Co. of Nevada,
Philadelphia, Pennsylvania.

Dear Milt:

I have received your letter this morning, asking for a sketch of the Argentite district. This I am enclosing, and it is very rough as I have nothing to go on but the way the roads run in that country. Generally speaking, it lies on the west side of Red Mountain, about four miles south of Silver Peak, at an elevation of about 8000 feet and near the top of the range, on the Fish Lake Valley side of the range.

Yours very truly,

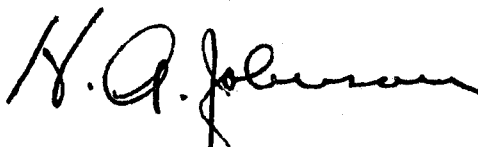
Superintendent.

HAI:m

encl.

Fish Lake Valley

MINE

Cave Springs

Cont Camp

Argentite

DATE

To Silver

Silver Park

To Casita

25 miles by road Silver Park
to Argentite

NORTH
SKETCH MAP NOT SURVEYED

FRANCIS No 1

FRANCIS No 2

FRANCIS No 3

AMERICAN

AMERICAN No 5

AMERICAN No 1

AMERICAN No 3

AMERICAN No 6

TONOPAH No 2

VEIN (?)

shaft
shaft
shaft

Lower Tunnel
Upper Tunnel

ALPINE (?)

AMERICAN No 7

TONOPAH No 1

TUNNEL VEIN

ALPINE No 1

AMERICAN No 4

TONOPAH

ALPINE FRAC.

ALPINE No 2

ARGENTUM No 3

J.T. KEENAN and

ARGENTUM No 1

H.L. HOWE

DOME

ARGENTUM No 2

ARGENTUM

DOME No 3

DOME No 1

DOME No 2

FAULT

THE TONOPAH MINING COMPANY OF NEVADA

EASTERN OFFICE
370 BULLITT BUILDING, PHILADELPHIA, PA.

PLEASE ADDRESS ALL COMMUNICATIONS
TO THE COMPANY, TONOPAH, NEVADA

TONOPAH, NEVADA, July 30, 1935.

Mr. W. L. Haehnlen, Chairman of Board,
The Tonopah Mining Company of Nevada,
Philadelphia, Pennsylvania.

Dear Mr. Haehnlen:

We are just in receipt of a report from Mr. MacDonald of an automobile accident which he had July 19th in Idaho. You will see from this report that he was in no way to blame for the accident, and we shall do everything possible to obtain the correct adjustment from the CCC organization. I presume that this will be a long drawn out affair as adjustments of this kind usually are.

Mr. Sharp was over to the Argentite district Sunday and took a number of samples on the Taylor property, the results of which I am enclosing. You will note that the gold values do not hold up as they did in the first two samples that were taken over there, and it now becomes a question as to whether or not the values as shown from the work already done are sufficiently interesting to go ahead with the prospect. Certainly I would not agree to do the 500 feet of drifting under the terms as suggested by Mr. Lindsley, and about which I have written you. I shall be glad to have your views in this matter.

Yours very truly,

H. A. Johnson
Superintendent.

HAI:m
encl.

THE TONOPAH MINING COMPANY OF NEVADA

THE TAYLOR PROPERTY,
ARGENTITE, NEVADA.

TONOPAH, NEV., July 29, 1935

ASSAYER

THE TONOPAH MINING COMPANY OF NEVADA

EASTERN OFFICE
570 BULLITT BUILDING, PHILADELPHIA, PA.

PLEASE ADDRESS ALL COMMUNICATIONS
TO THE COMPANY, TONOPAH, NEVADA

TONOPAH, NEVADA,
July 28, 1935.

Mr. W.L. Haehnlen, Chairman of Board,
The Tonopah Mining Company of Nevada,
570 Bullitt Building,
Philadelphia, Pa.

Dear Mr. Haehnlen:

Mr. Lindsley has spoken to you of our trip to
Argentite in the Silver Peak District. Several assays were taken
and in case you have not seen them I am giving them here.

No. 1	Face 100 N Drift	.04	Au	5.36	Ag	Value \$	5.52	
2	Taylor Shaft 4'	Tr		6.00			4.62	
3	" " 4'	.04		10.36			9.37	
4	Face Upper Tunnel	.18		4.90			10.17	4'
5	" Lower "	.32		15.68			23.21	3 1/2'

The first sample was taken from the old Sanger property. The others from Taylor's property which lies to the north of the Sanger property. Samples 2 and 3 are on a different vein than 4 and 5. It will be noted that the gold content is higher in the last two samples than in the others. The lower tunnel which is in 30 to 40 feet affords an excellent tunnel site and a depth of at least 500 feet can be obtained with approximately 500 feet of drifting.

Mr. Lindsley left the following memo with me and until yesterday I was unable to get hold of Mr. Taylor.

Re-Taylor Claims near Red Mountain.

1- Firm commitment to do 500 feet of drifting.

2- If results encouraging form buy 1,000,000 shares, 500,000

*10-40-10-110-143

81.518-921-40-22
82-08-1200-11432

How started work
Aug 23 1937

LOCALITY

24703

2004/13/1232

五

~~07-28-50~~

11-27-01

No. 3.

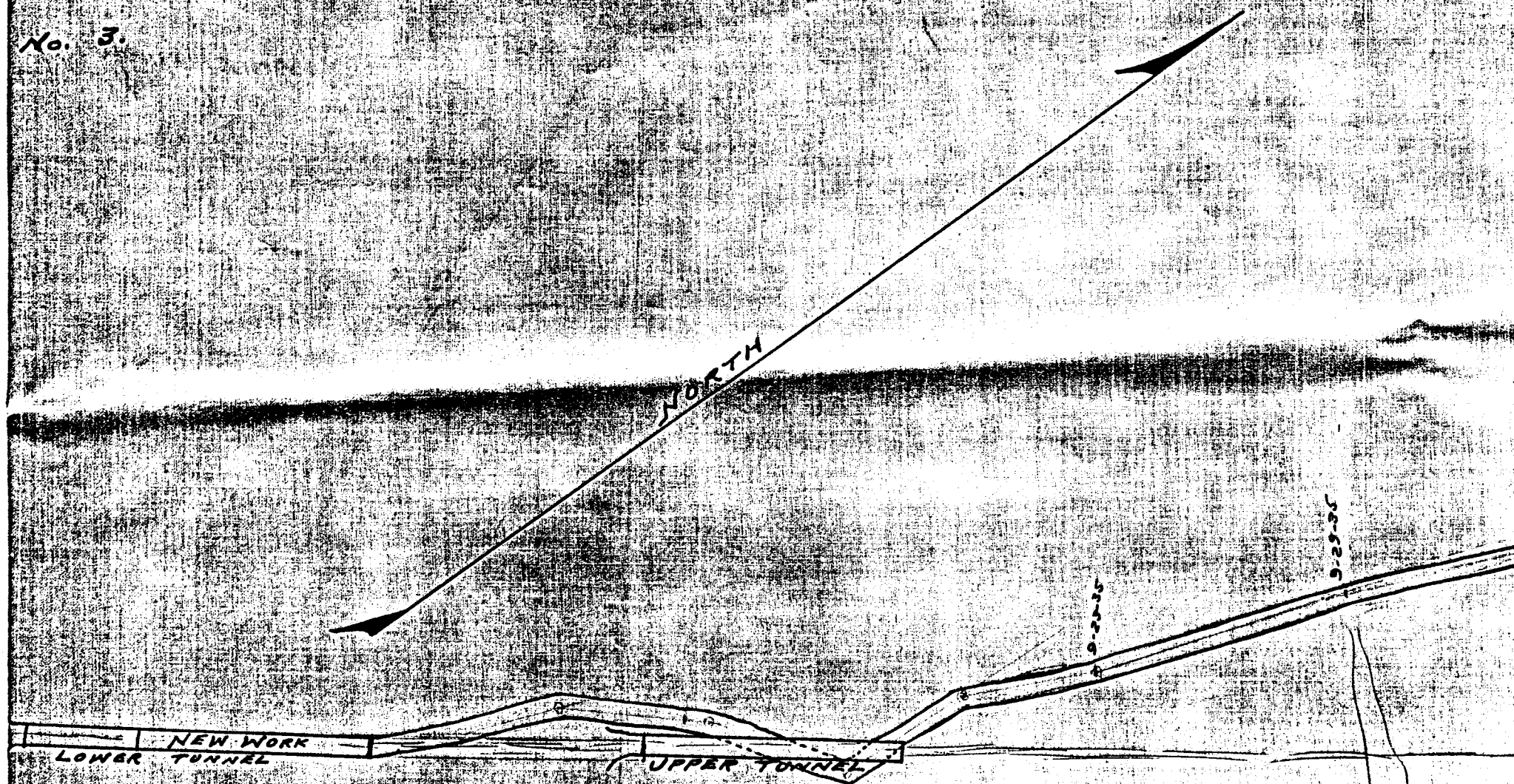

PLAN OF VEIN TONOPAH MINING CO., ARGENTITE, NEVADA.

5.6'-04"-13.96-#12.18
3.2'-08"-15.60-#14.79
3.7'-02"-8.46-#7.24
3.9'-02"-11.90-#9.86
2.9'-06"-24.82-#21.20
4.0'-02"-8.58-#7.32

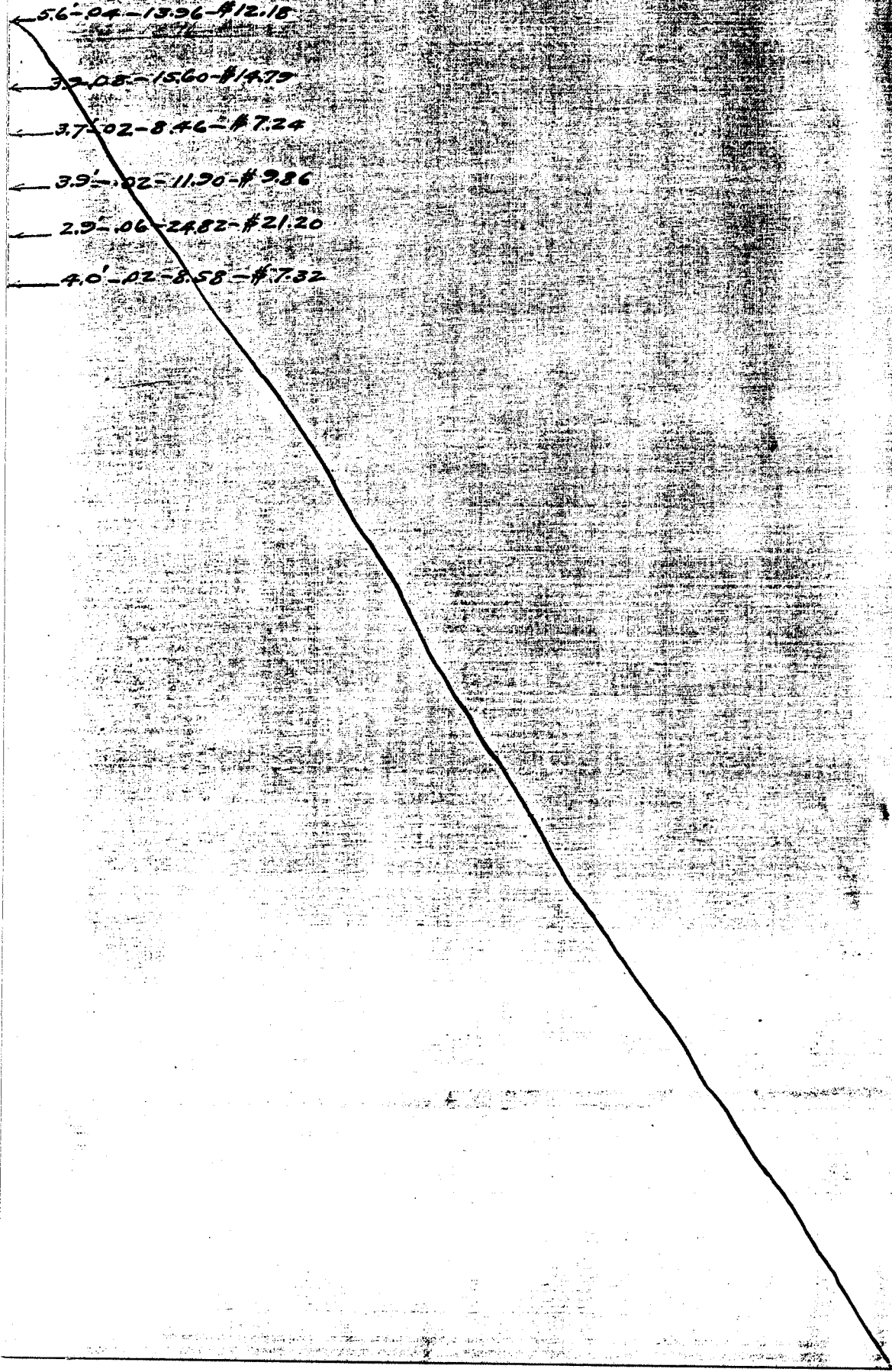

NAL SECTION

Sept. 12, 1935

- 3.5' TR-180-#1.38
- 3.5' TR-180-#1.38
- 3.5' TR-040-#0.30
- 3.5' TR-048-#0.36
- 3.5' TR-040-#0.30
- 3.5' TR-040-#0.30
- 3.5' TR-048-#0.37
- 3.5' TR-076-#0.58
- 3.5' TR-072-#0.55
- 3.5' TR-108-#0.83
- 3.5' TR-152-#1.17
- 3.5' TR-204-#2.97
- 3.5' TR-136-#2.45
- 3.5' TR-072-#0.55
- 3.5' TR-040-#0.30
- 3.5' TR-040-#0.30
- 3.5' TR-044-#0.34
- 3.5' TR-048-#0.37
- 3.5' TR-072-#0.55
- 3.5' TR-040-#0.30
- 3.5' TR-036-#0.28
- 3.5' TR-040-#0.30
- 3.5' TR-044-#0.34
- 3.5' TR-036-#0.28
- 3.5' TR-076-#0.58
- 3.5' TR-556-#5.68
- 3.5' TR-760-#8.02
- 3.5' TR-616-#6.14
- 3.5' TR-838-#7.15
- 3.5' TR-470-#4.32
- 3.5' TR-718-#6.32
- 3.5' TR-618-#5.45
- 3.5' TR-518-#4.68
- 3.5' TR-400-#3.08
- 3.5' TR-260-#2.00
- 3.5' TR-120-#0.92
- 3.5' TR-120-#0.92
- 3.5' TR-160-#1.23
- 3.5' TR-220-#1.69
- 3.5' TR-260-#1.78
- 3.5' TR-300-#2.31
- 3.5' TR-318-#7.77
- 3.5' TR-820-#6.31
- 3.5' TR-516-#5.37
- 3.5' TR-560-#4.31
- 3.5' TR-140-#1.08
- 3.5' TR-240-#1.84
- 3.5' TR-160-#1.23
- 3.5' TR-092-#2.12
- 3.5' TR-120-#0.92
- 3.5' TR-096-#0.74
- 3.5' TR-088-#0.68
- 3.5' TR-096-#0.74
- 3.5' TR-068-#0.52
- 3.5' TR-060-#0.46
- 3.5' TR-064-#0.49
- 3.5' TR-060-#0.46
- 3.5' TR-460-#3.22
- 3.5' TR-080-#0.61
- 3.5' TR-420-#3.23
- 3.5' TR-876-#8.14
- 3.5' TR-336-#3.22
- 3.5' TR-836-#7.84
- 3.5' TR-418-#3.32
- 3.5' TR-200-#1.54
- 3.5' TR-180-#1.39
- 3.5' TR-260-#2.00
- 3.5' TR-080-#0.61
- 3.5' TR-080-#0.61
- 3.5' TR-160-#1.23
- 3.5' TR-160-#1.23
- 3.5' TR-120-#0.92
- 3.5' TR-620-#4.77
- 3.5' TR-786-#6.05
- 3.5' TR-280-#2.16
- 3.5' TR-300-#2.31
- 3.5' TR-360-#2.77
- 3.5' TR-320-#2.46
- 3.5' TR-360-#2.77
- 3.5' TR-120-#0.92

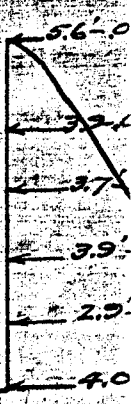

No. 3.

AMERICAN

GULCH

2

No. 3.

AMERICAN

GULCH

LOWER

PLAN OF

No. 2

T.M. Co. started work
Aug 29, 1935

3.3'.04-10.20-#9.25

3.6'.02-5.18-#4.70

3.7'.02-6.22-#5.47

3.7'.04-5.96-#5.95
#31.9

AMER

AME

ART

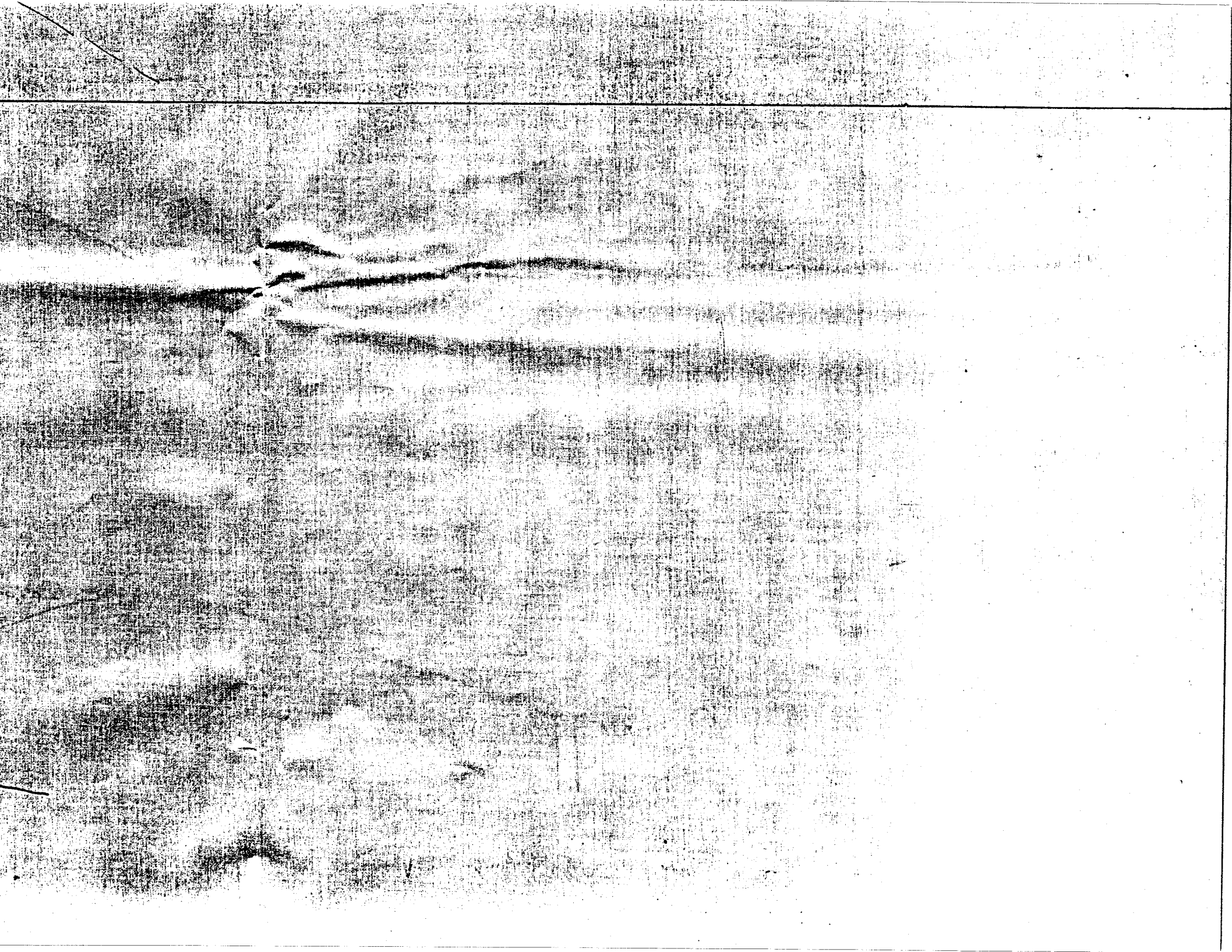

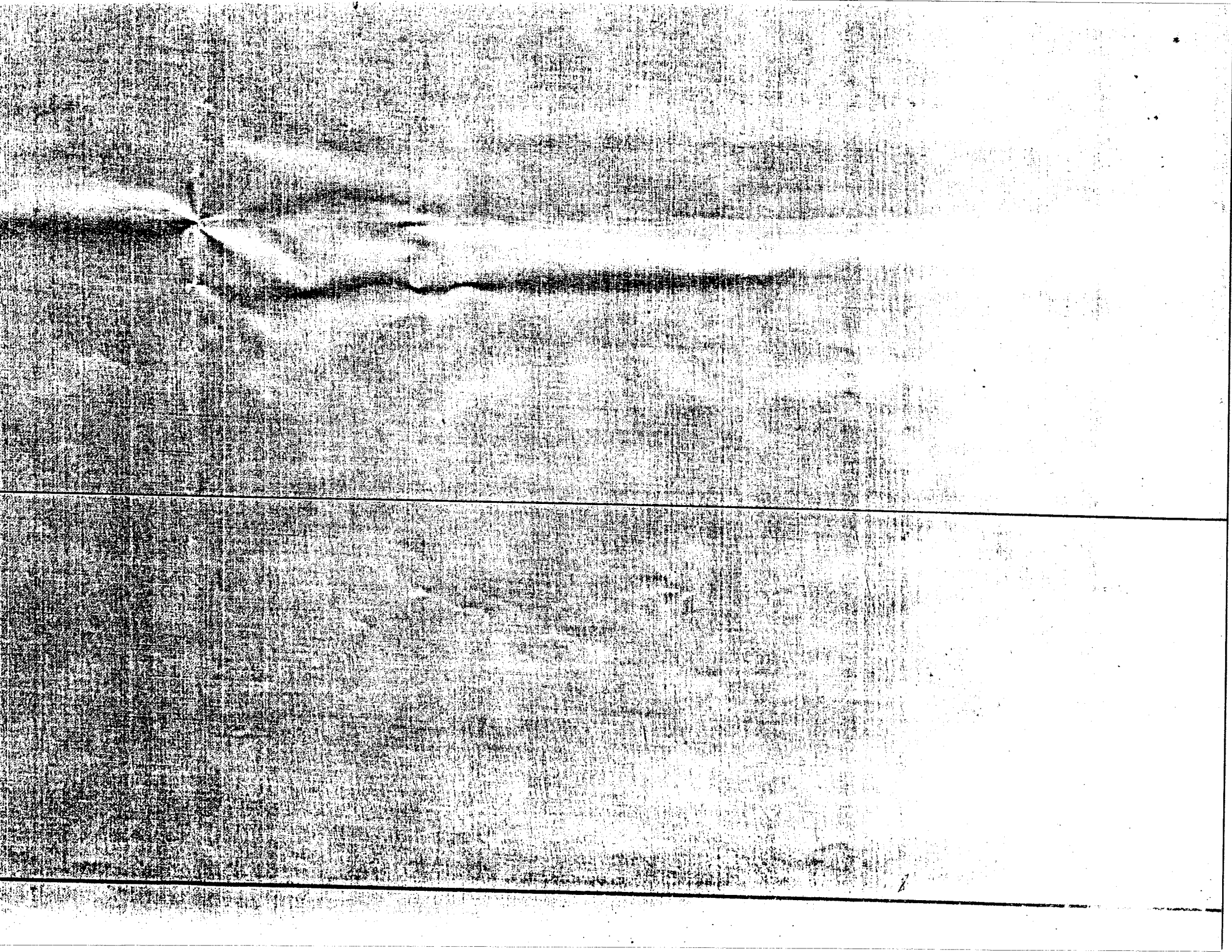

20 FT. SHAFT

20 FT. SHAFT



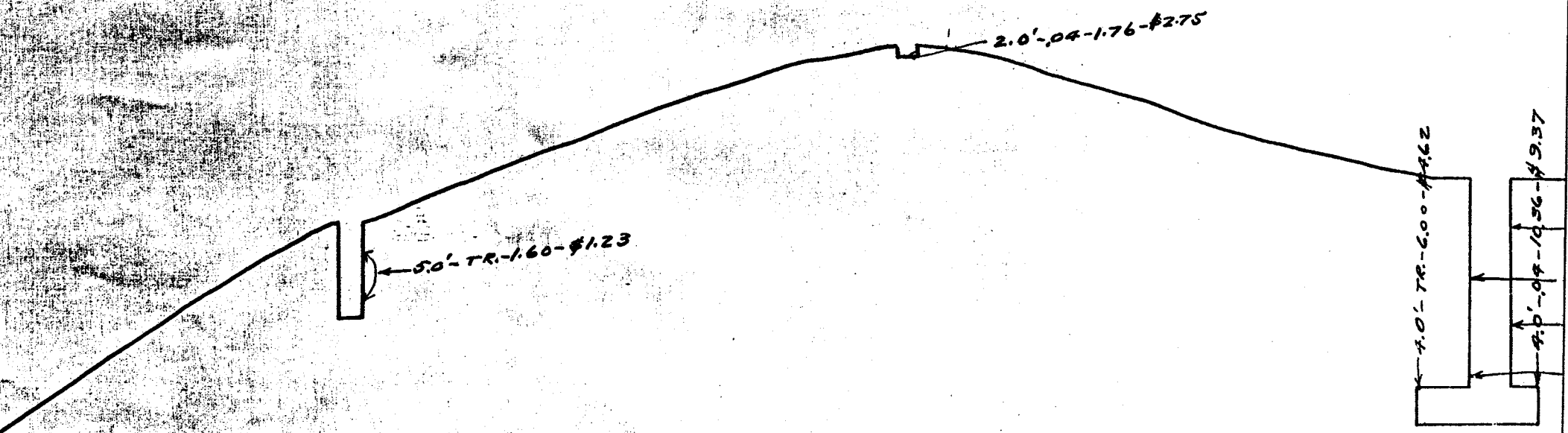

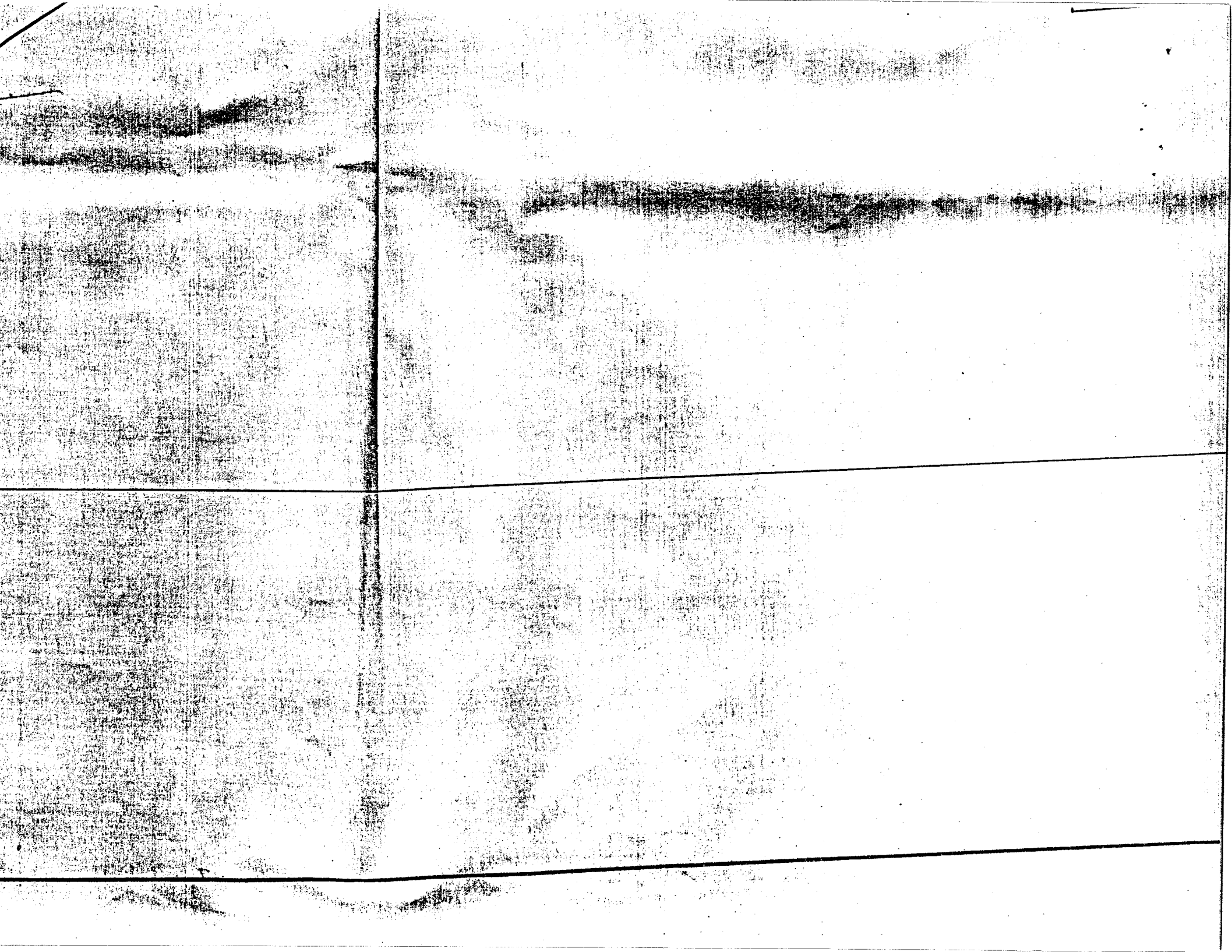

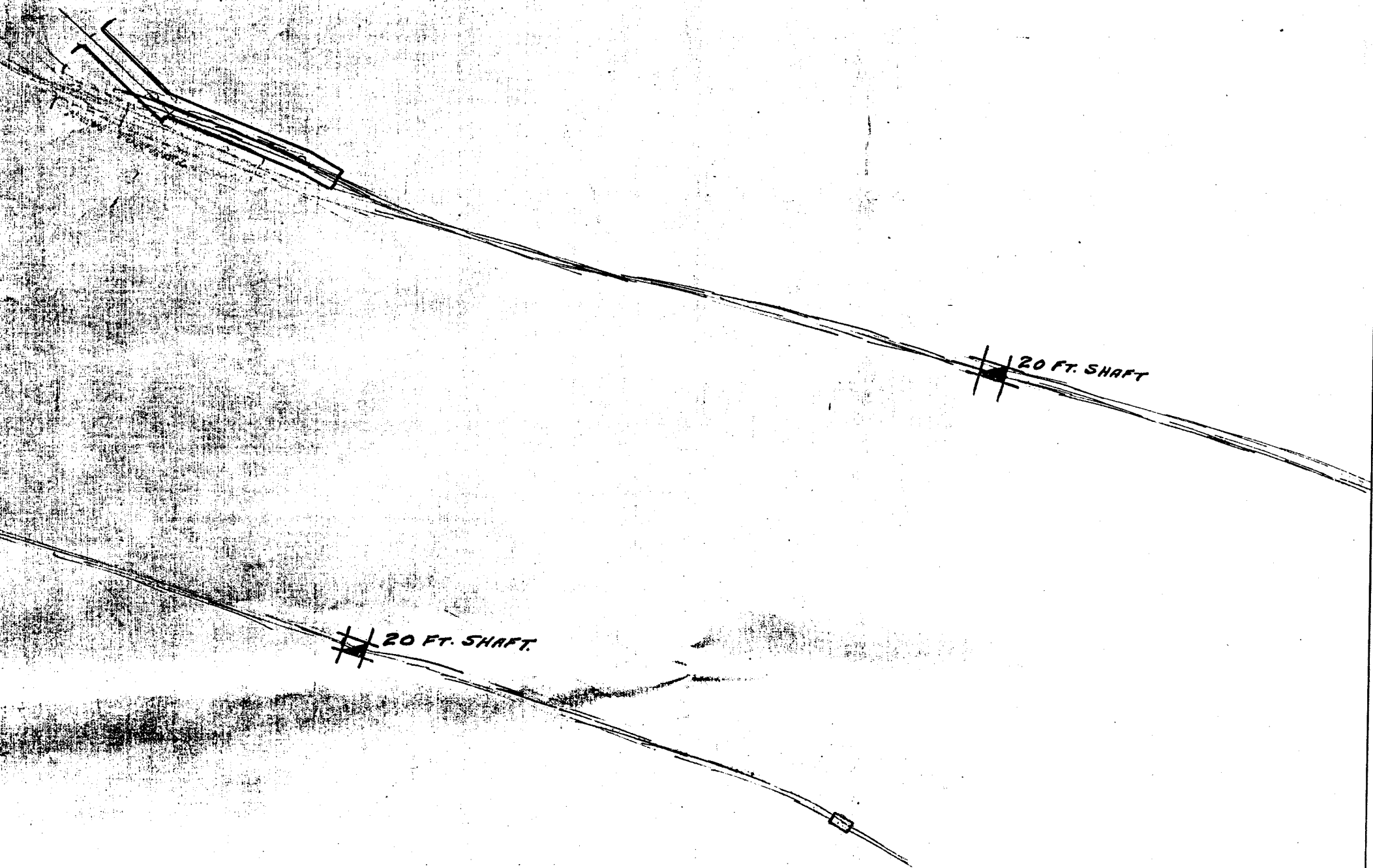

20 FT. SHAFT.



NEW TUNNEL

- ← 3.5'-10-380-#6.04
- ← 3.5'-04-5.08-#5.31
- ← 3.5'-TR-3.60-#2.31
- ← 3.5'-TR-4.80-#3.69
- ← 3.5'-TR-3.00-#2.77
- ← 3.5'-04-3.76-#4.18
- ← 3.5'-TR-5.60-#4.31
- ← 3.5'-TR-4.20-#3.23
- ← 3.5'-TR-4.80-#3.70
- ← 3.5'-TR-5.40-#4.15
- ← 3.5'-TR-5.88-#4.46
- ← 3.5'-06-5.94-#6.67

← #6-5.0'-TR-1.60-#1.23

← #5-2.0'-04-1.76-#2.75

← #2-4.0'-TR-6.00-#4.62

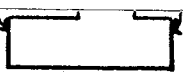



SCALE - 80 FT. = 1 INCH

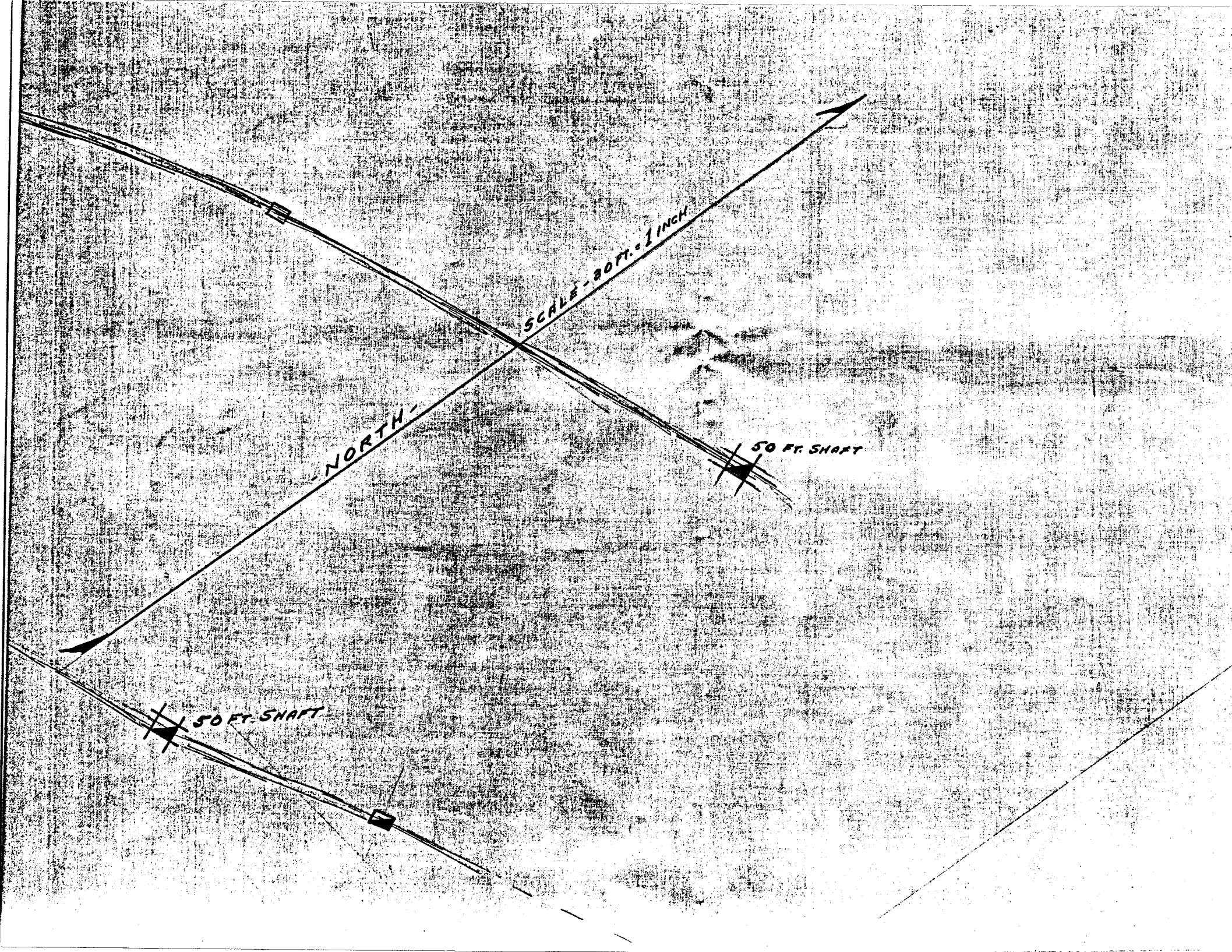

SCALE - 80 FT. = 1 INCH

NORTH

50 FT. SHAFT

50 FT. SHAFT

#2-4.0'-TR-6.00-#4.62

#3-4.0'-0.36-#5.38

#1-4.0'-0.04-21.96-#18.31

#2-4.0'-TR-8.80-#6.77

#3-4.0'-TR-8.60-#6.62

#4-4.0'-0.04-7.76-#7.37

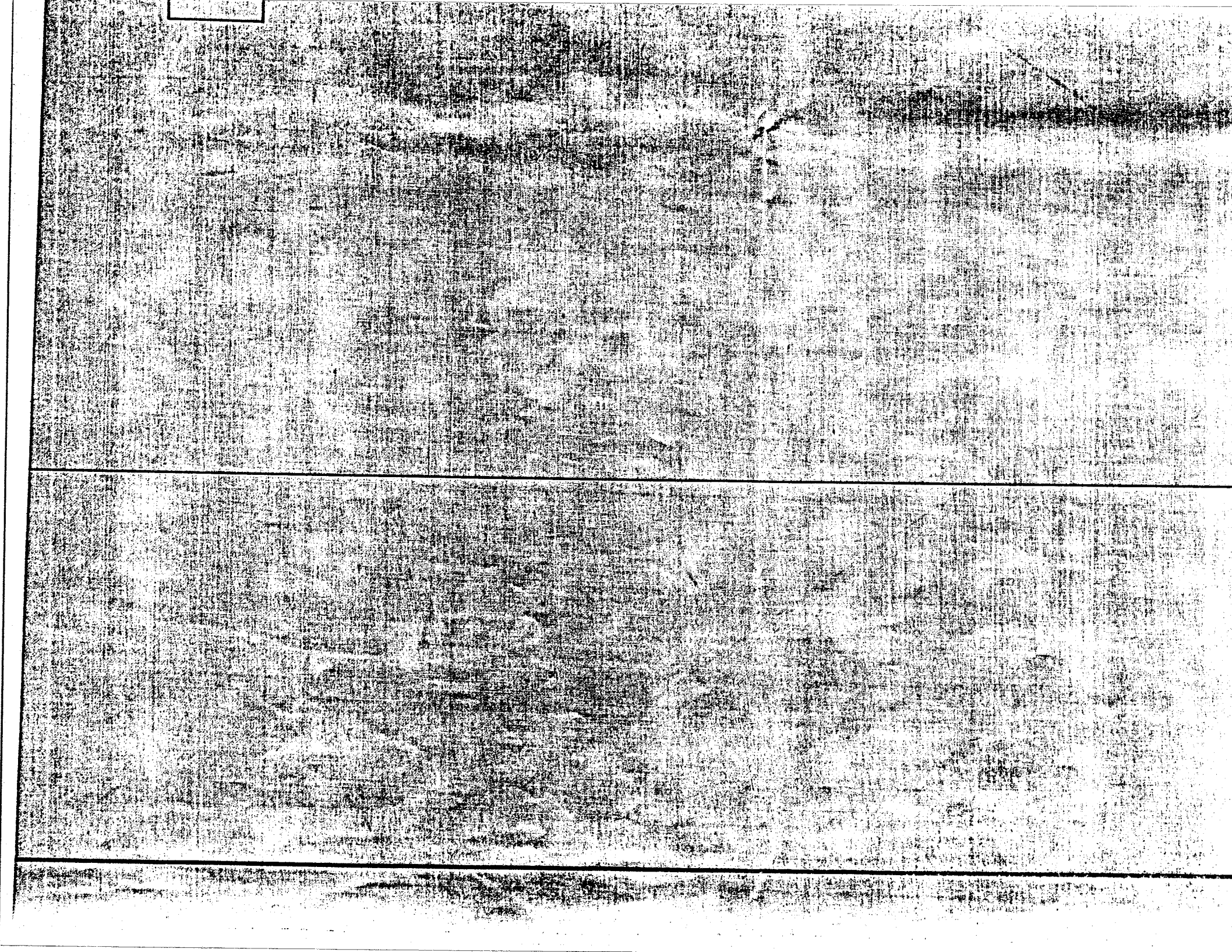

No. 2

AMERICAN No. 3.

GUECH

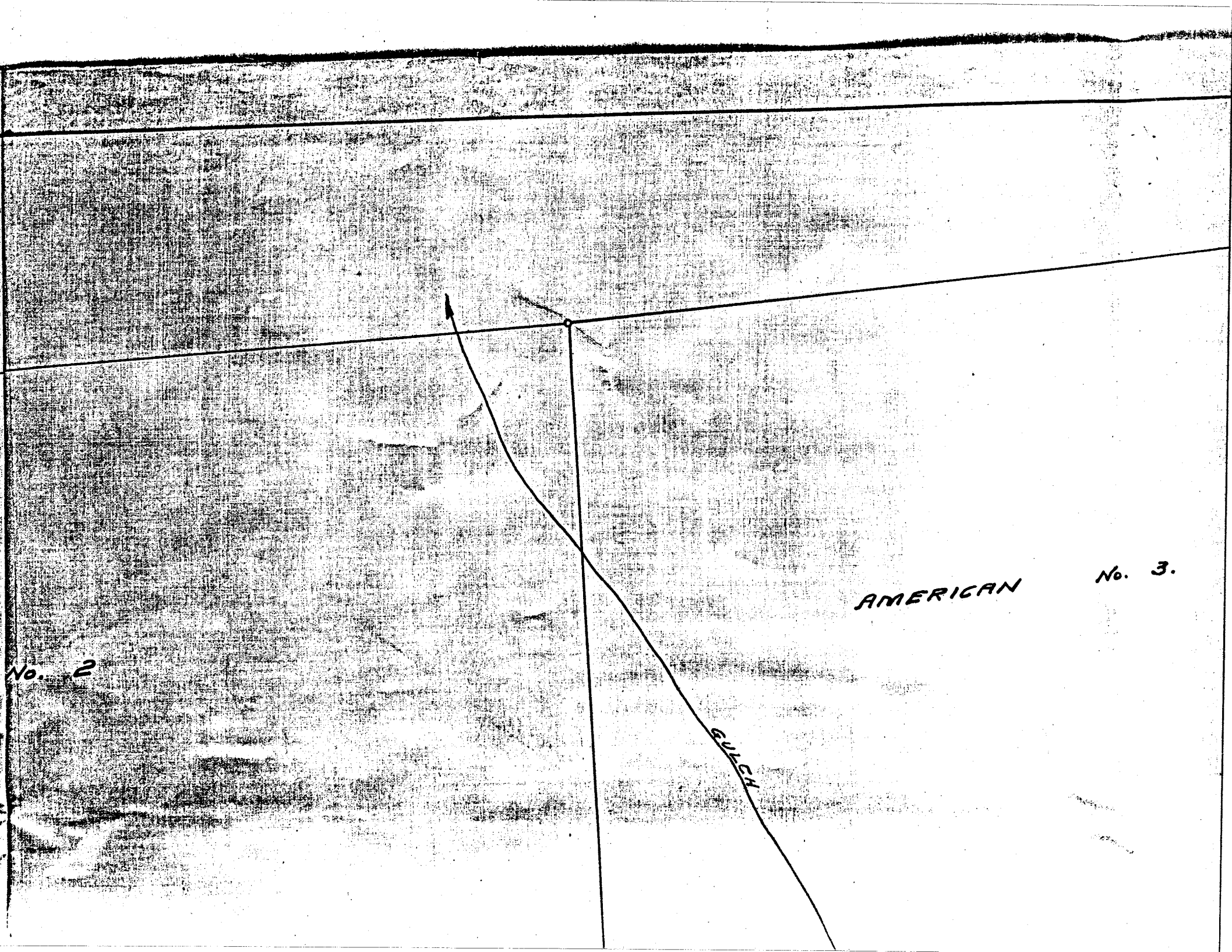

AMERICAN

No. 3.

GULCH

NEW
LOWER TUN

PLAN OF

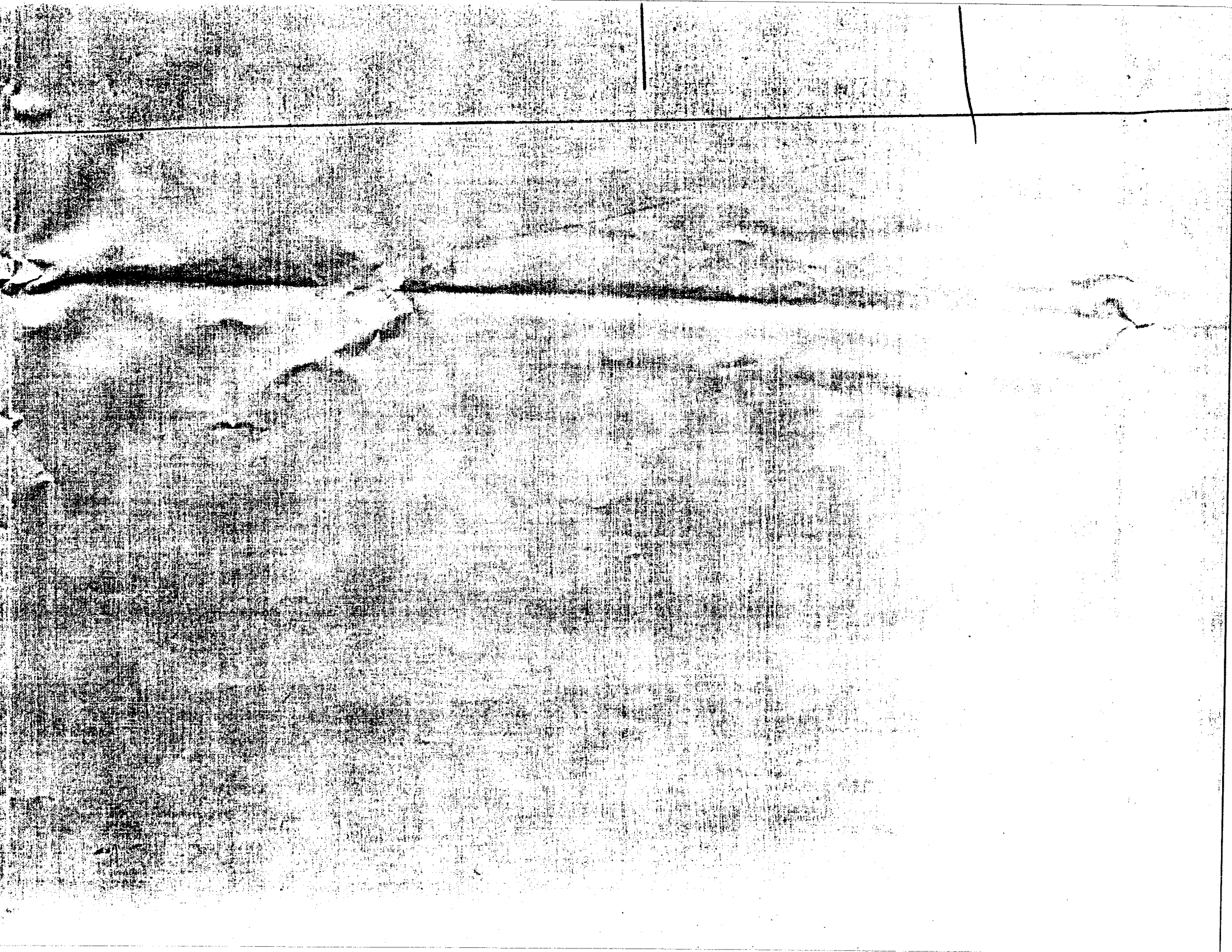

526#-0201-09-1020-#925

526#-0201-09-1020-#925

526#-0201-09-1020-#925

No. 3.

NORTH

No. 3.

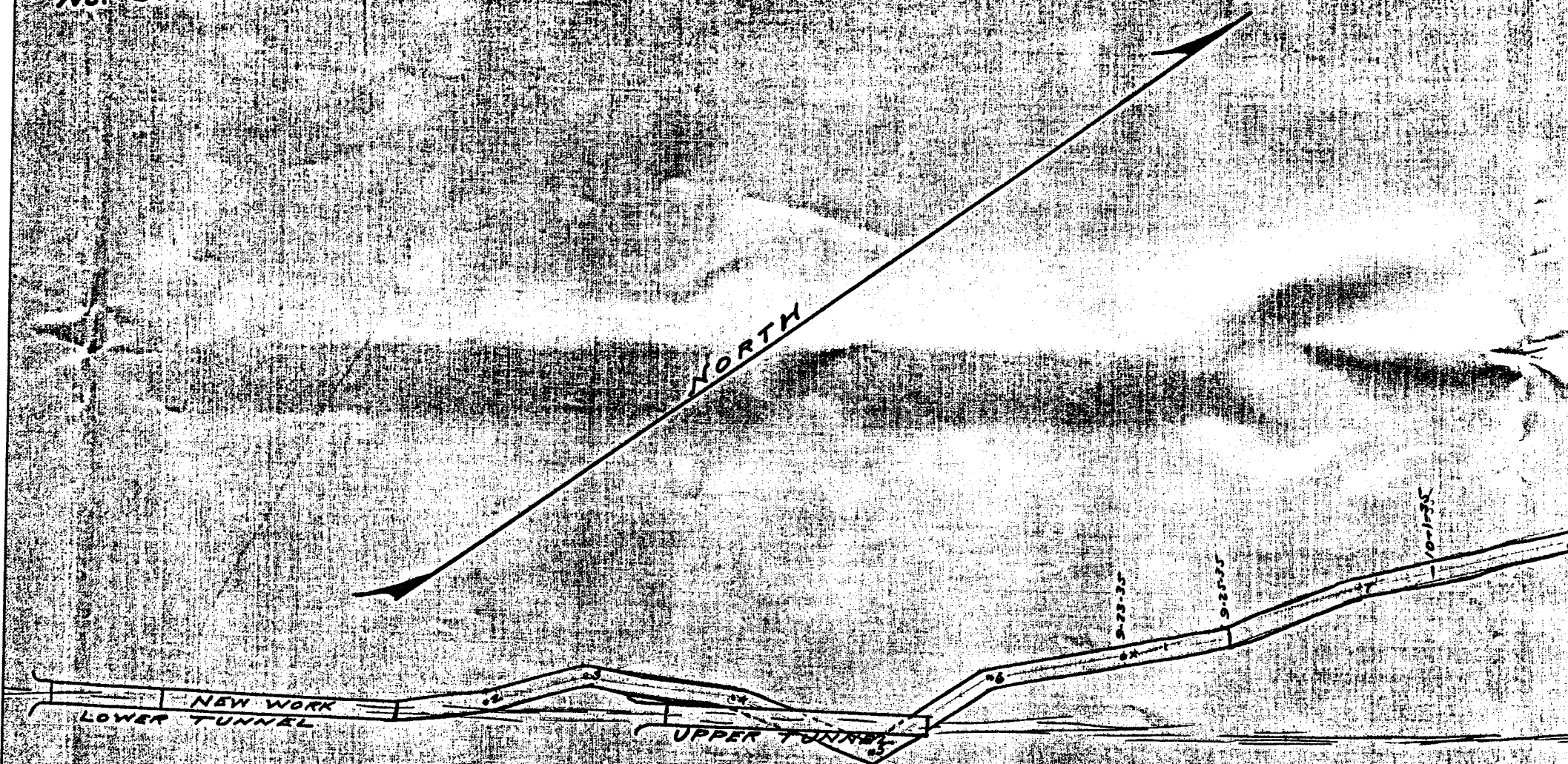

PLAN OF VEIN TONOPAH MINING CO., ARGENTITE, NEVADA.

SCALE - 30 FT. = 1 INCH

← #5-56'-04-1396-\$12.10

← #8-35'-08-1560-\$14.79

← #7-37'-02-846-\$7.24

← #6-39'-02-1120-\$9.86

← #5-29'-06-2482-\$21.20

← #4-46'-02-858-\$7.32

LONGITUDINAL SECTION

NEW

3.5'-02-10.20-#2255
 3.5'-02-5.18-#470
 3.5'-02-6.22-#547
 3.5'-02-5.96-#599
 3.5'-04-2.96-#3.68
 3.5'-02-1.58-#1.91
 3.5'-TR-1.60-#1.23
 3.5'-TR-1.40-#1.07
 3.5'-TR-1.72-#1.92
 3.5'-TR-1.16-#0.89
 3.5'-02-4.02-#3.80
 3.5'-04-5.04-#528
 3.5'-02-4.18-#3.92
 3.5'-02-4.98-#4.53
 3.5'-02-3.78-#3.60
 3.5'-TR-4.80-#3.69
 3.5'-02-6.12-#5.41
 3.5'-TR-1.80-#1.38
 3.5'-TR-1.80-#1.38
 3.5'-TR-0.40-#0.30
 3.5'-TR-0.48-#0.36
 3.5'-TR-0.40-#0.30
 3.5'-TR-0.40-#0.30
 3.5'-TR-0.48-#0.37
 3.5'-TR-0.76-#0.58
 3.5'-TR-0.72-#0.55
 3.5'-TR-1.08-#0.83
 3.5'-TR-1.52-#1.17
 3.5'-04-2.04-#2.97
 3.5'-04-1.36-#2.45
 3.5'-TR-0.72-#0.55
 3.5'-TR-0.40-#0.30
 3.5'-TR-0.40-#0.30
 3.5'-TR-0.44-#0.34
 3.5'-TR-0.48-#0.37
 3.5'-TR-0.72-#0.55
 3.5'-TR-0.40-#0.30
 3.5'-TR-0.36-#0.28
 3.5'-TR-0.40-#0.30
 3.5'-TR-0.44-#0.34
 3.5'-TR-0.36-#0.28
 3.5'-TR-0.76-#0.58
 3.5'-04-5.56-#5.68
 3.5'-04-7.60-#8.02
 3.5'-04-6.16-#6.14
 3.5'-02-8.38-#7.15
 3.5'-02-4.70-#4.32
 3.5'-02-7.18-#6.32
 3.5'-02-6.18-#5.75
 3.5'-02-5.18-#4.68
 3.5'-TR-4.00-#3.08
 3.5'-TR-2.60-#2.00
 3.5'-TR-1.20-#0.92
 3.5'-TR-1.20-#0.92
 3.5'-TR-1.60-#1.25
 3.5'-TR-2.20-#1.69
 3.5'-TR-2.60-#1.78
 3.5'-TR-3.00-#2.31
 3.5'-02-9.18-#7.77
 3.5'-TR-8.20-#6.31
 3.5'-04-5.16-#5.37
 3.5'-TR-5.60-#4.31
 3.5'-TR-1.40-#1.08
 3.5'-TR-2.40-#1.84
 3.5'-TR-1.60-#1.23
 3.5'-04-0.92-#2.12
 3.5'-TR-1.20-#0.92
 3.5'-TR-0.36-#0.24

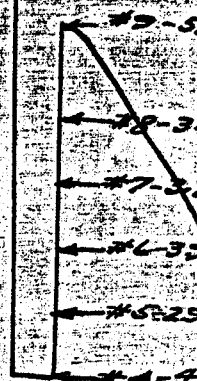

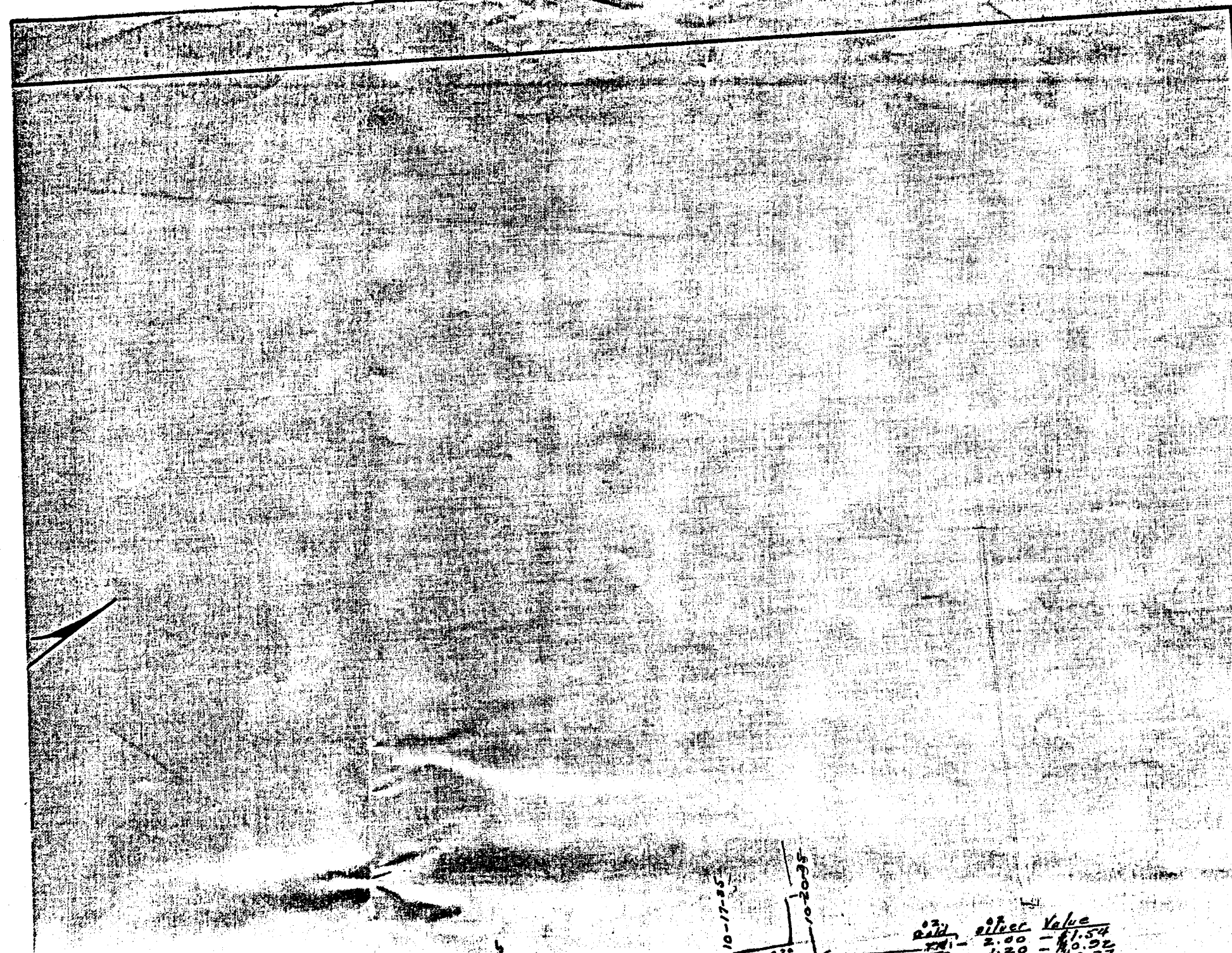

10-17-85
10-20-85
183° 183°

2nd	silver	Value
TR	3.00	1.54
TR	1.20	0.52
TR	1.00	0.77
TR	0.80	0.67
TR	0.36	0.46
TR	0.10	

#10-9.0-10-110-439

3.5' - .02 - 6.18 - \$0.77
3.5' - .02 - 5.18 - \$4.68
3.5' - TR - 1.00 - \$3.08
3.5' - TR - 2.60 - \$2.00
3.5' - TR - 1.20 - \$0.92
3.5' - TR - 1.20 - \$0.92
3.5' - TR - 1.60 - \$1.23
3.5' - TR - 2.20 - \$1.69
3.5' - TR - 2.60 - \$1.78
3.5' - TR - 3.00 - \$2.31
3.5' - .02 - 9.18 - \$7.77
3.5' - TR - 8.20 - \$6.51
3.5' - .04 - 5.16 - \$5.37
3.5' - TR - 5.60 - \$4.31
3.5' - TR - 1.40 - \$1.08
3.5' - TR - 2.40 - \$1.84
3.5' - TR - 1.60 - \$1.23
3.5' - .04 - 0.92 - \$2.12
3.5' - TR - 1.20 - \$0.92
3.5' - TR - 0.36 - \$0.44
3.5' - TR - 0.88 - \$0.68
3.5' - TR - 0.96 - \$0.74
3.5' - TR - 0.68 - \$0.62
3.5' - TR - 0.60 - \$0.46
3.5' - TR - 0.64 - \$0.49
3.5' - TR - 0.60 - \$0.46
3.5' - TR - 4.60 - \$3.22
3.5' - TR - 0.80 - \$0.61
3.5' - TR - 4.20 - \$3.23
3.5' - .04 - 8.76 - \$8.14
3.5' - .04 - 3.36 - \$3.99
3.5' - TR - 2.80 - \$2.15
3.5' - TR - 3.40 - \$2.62
3.5' - .04 - 8.36 - \$7.84
3.5' - .02 - 4.18 - \$3.72
3.5' - TR - 2.00 - \$1.54
3.5' - TR - 1.80 - \$1.39
3.5' - TR - 2.60 - \$2.00
3.5' - TR - 0.80 - \$0.61
3.5' - TR - 0.80 - \$0.61
3.5' - TR - 1.60 - \$1.23
3.5' - TR - 1.60 - \$1.23
3.5' - .10 - 1.90 - \$4.96
3.5' - TR - 6.20 - \$4.77
3.5' - .04 - 7.86 - \$6.05
3.5' - TR - 2.80 - \$2.16
3.5' - TR - 3.00 - \$2.31
3.5' - TR - 3.60 - \$2.77
3.5' - TR - 3.20 - \$2.46
3.5' - TR - 3.60 - \$2.77
3.5' - TR - 1.20 - \$0.92

FRANCES No. 4

FRANCES

FRANCES No. 10

DOME JR. No. 4

REUT SCUT

RECHANGER
200 FT. SW

FRAN

FRANCE

N 15° 25' E

DOME JR

DOM

REUT

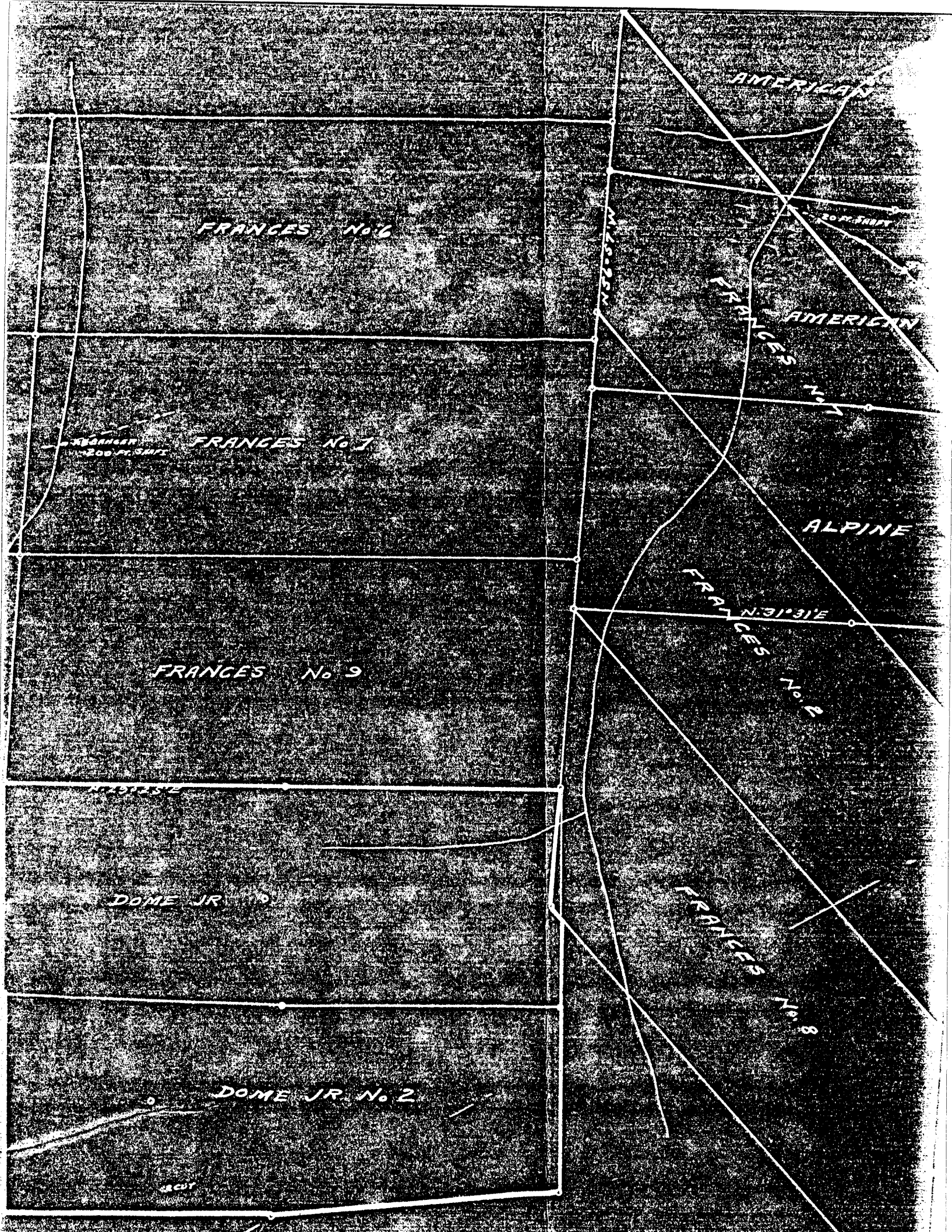

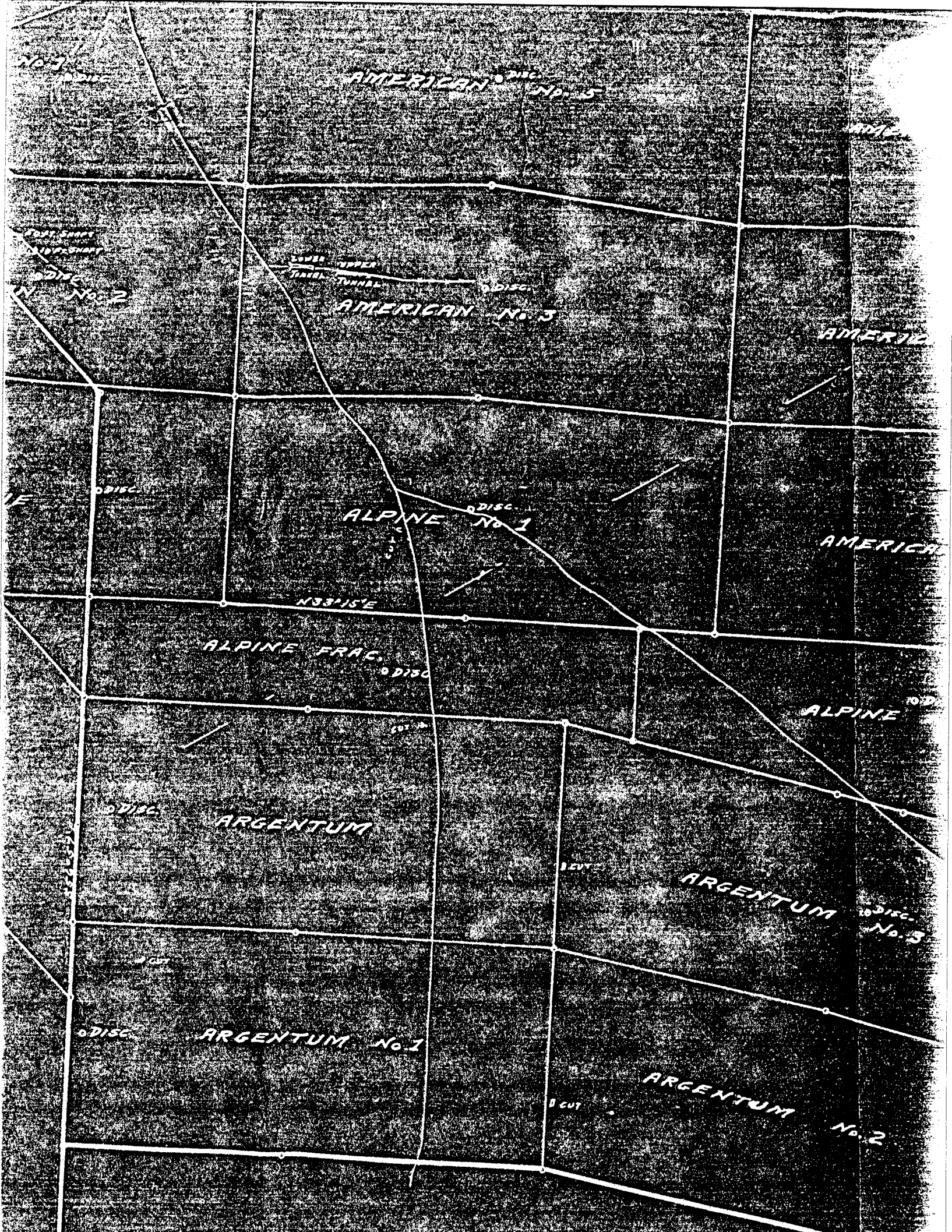

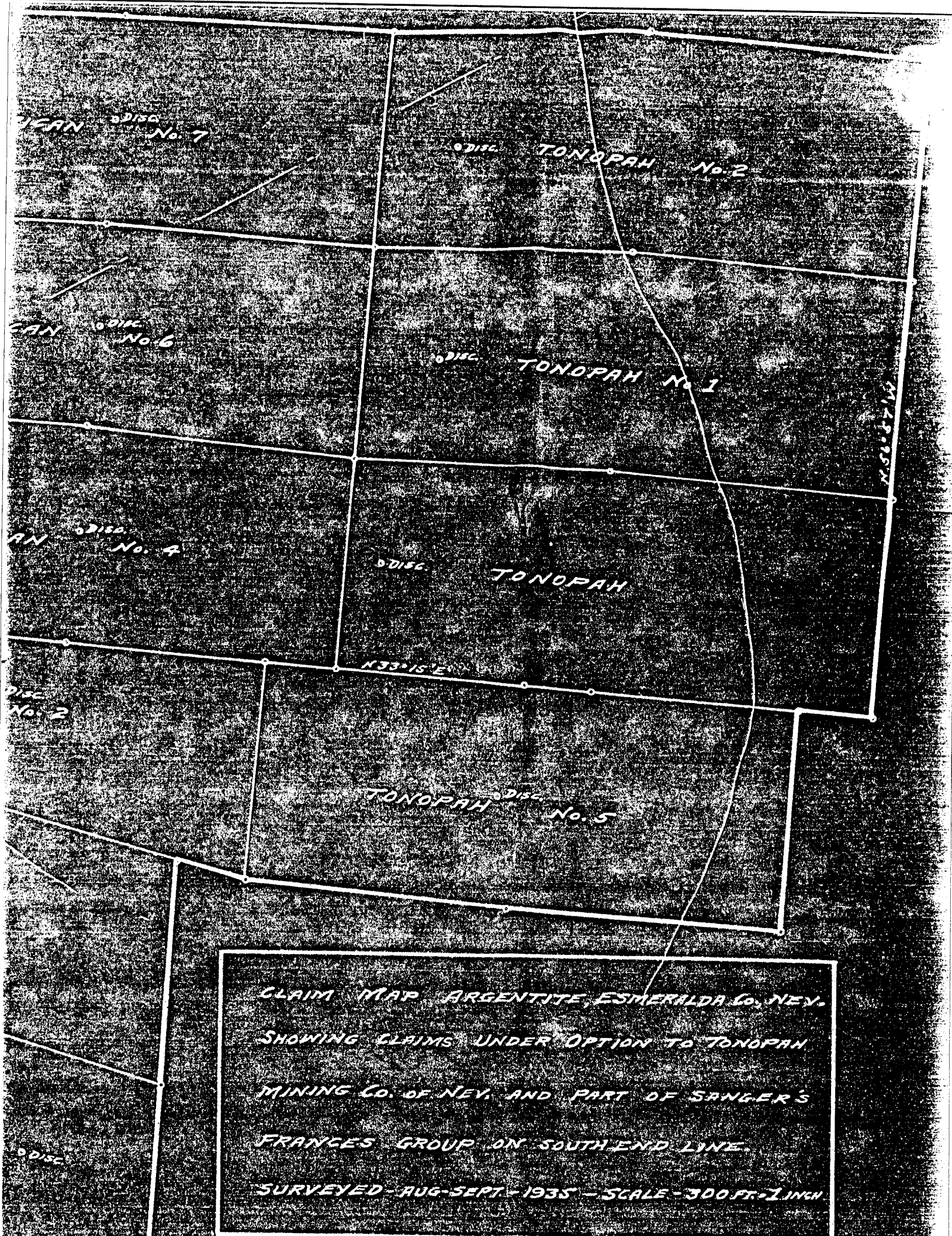

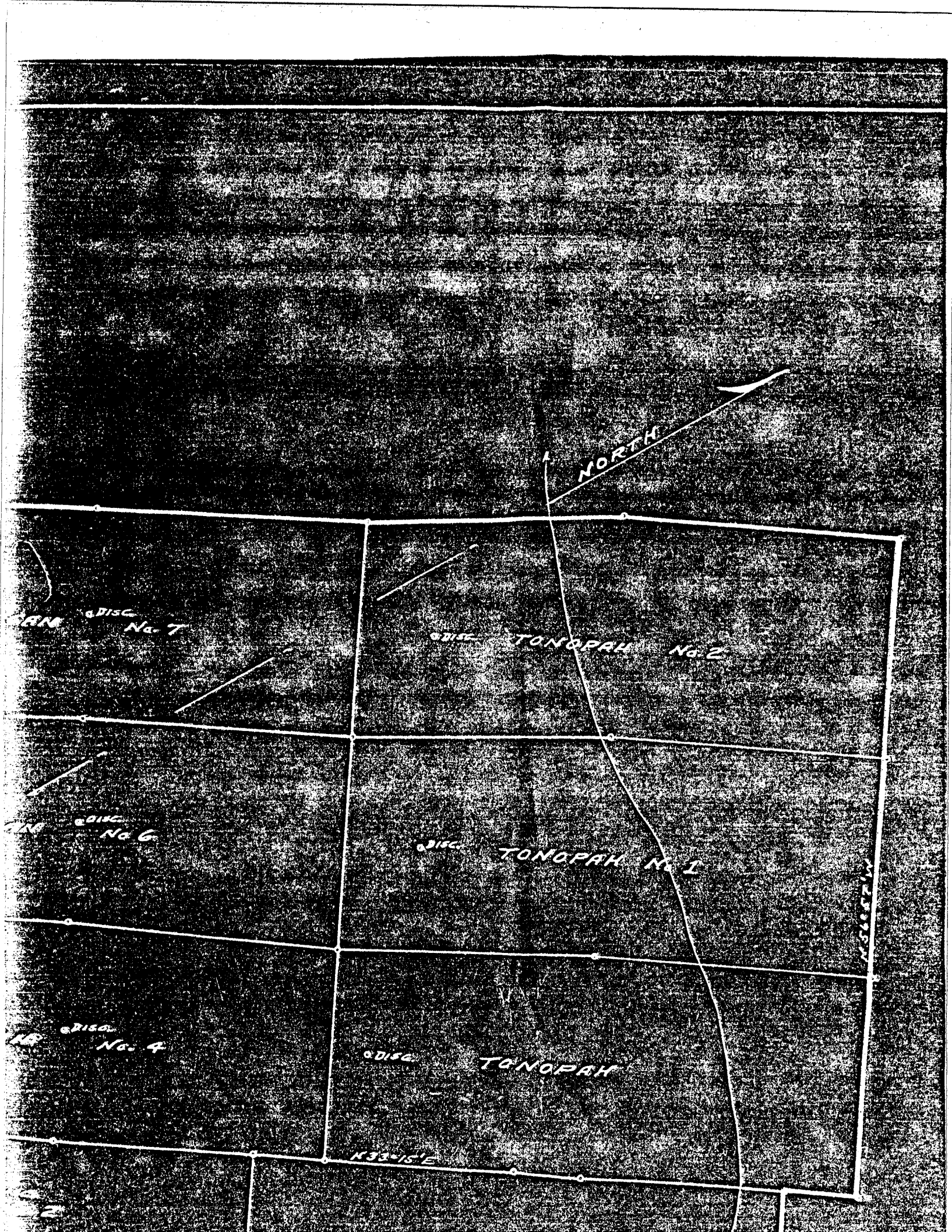

NORTH

DISC No. 7

DISC TONOPAH No. 2

DISC No. 6

DISC TONOPAH No. 1

DISC No. 4

DISC TONOPAH

N 36° 57' W

N 33° 15' E

shares to vendors, of which we get 25000 shares for doing the 500 feet of original work.

3. Option to take up remaining 800,000 shares @50¢ per share.
(Should be 775,000 Shares) H.A.J. ✓

4. Shares to be taken up at a rate of not less than 10,000 shares per month.

I passed this information on to Mr. Taylor yesterday and while he did not express himself he said that there would be no trouble in our getting together. There are several others interested in the property besides Taylor. He is paying \$100 per month to the partners which would have to be taken care of.

The road to the property is fair. There is one building which would suffice for a small crew of men. A temporary road from a quarter to a half mile would have to be built to get to the tunnel site. A sum of \$10,000 should be ample to do the work as above providing there are no unforeseen difficulties. Our portable compressor has been repaired and is now in first class shape and could be used on the work.

I have sent Sharp to the property today to do some more sampling and should the results confirm the previous sampling I consider the property to warrant the development as set forth above.

Yours very truly,

H.A. Johnson
Superintendent.

cc Thayer Lindsley

THE TONOPAH MINING COMPANY OF NEVADA
TONOPAH, NEVADA

July 28, 1935.

Mr. T.L. Lindsley, President,
The Tonopah Mining Company of Nevada,
850 King Street,
Toronto, Canada.

Dear Mr. Lindsley:

I have written Mr. Haehnlen the high lights of the Taylor property as per the enclosed copy. I was somewhat surprised at the unusual gold content of the samples taken from the tunnels as the Argentite District is supposedly a silver district. I have accordingly sent Sharp over again to check the sampling and will forward the results as soon as available.

I returned from Silverton a couple of days ago. I found that the report of the disaster was not in the least exaggerated and that the mill and lower tram terminal were a total loss.

Sharp is now working on the Tonopah maps that you asked for and as soon as ready these will be sent you.

We enjoyed your short visit with us and we look forward for your next one which we hope will not be too far distant.

Yours very truly,

H. A. Johnson
Superintendent.

cc Mr. Haehnlen.

FRANCES No. 4

FRANCES

FRANCES No. 10

DOME JR. No. 4

SCUT

WAGNER
200 FT. SHIP

FRAN

FRANCES

N 15° 15' E

DOME JR

DOY

SCUT

FRANCES No 6

FRANCES No 1

FRANCES No 9

DOVE JR No 1

DOVE JR No 2

AMERICAN

AMERICAN

ALPINE

FRANCES No 8

FRANCES No 8

20 FT. SHIFT

200 FT. SHIFT

N. 31° 31' E

N. 15° 15' E

SCUT

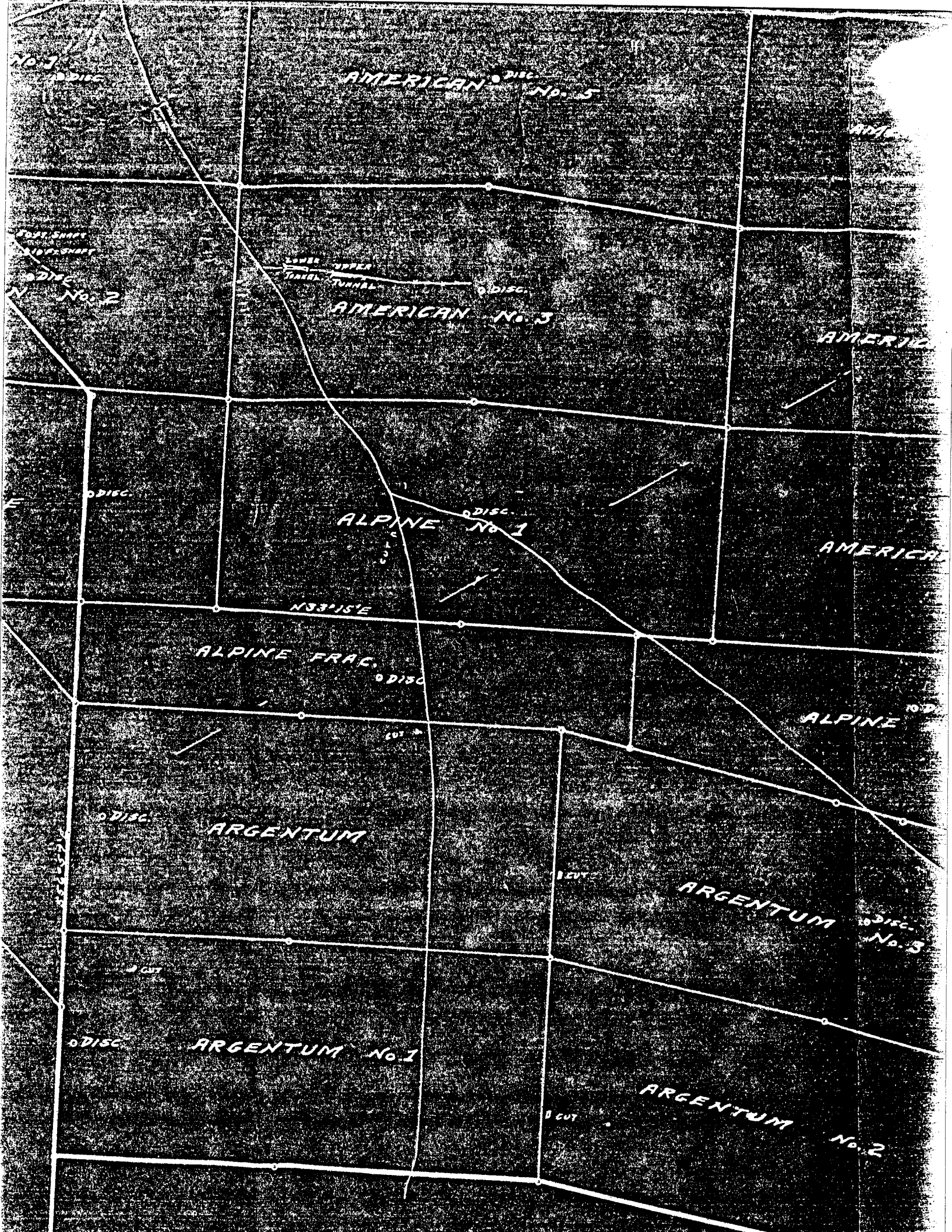

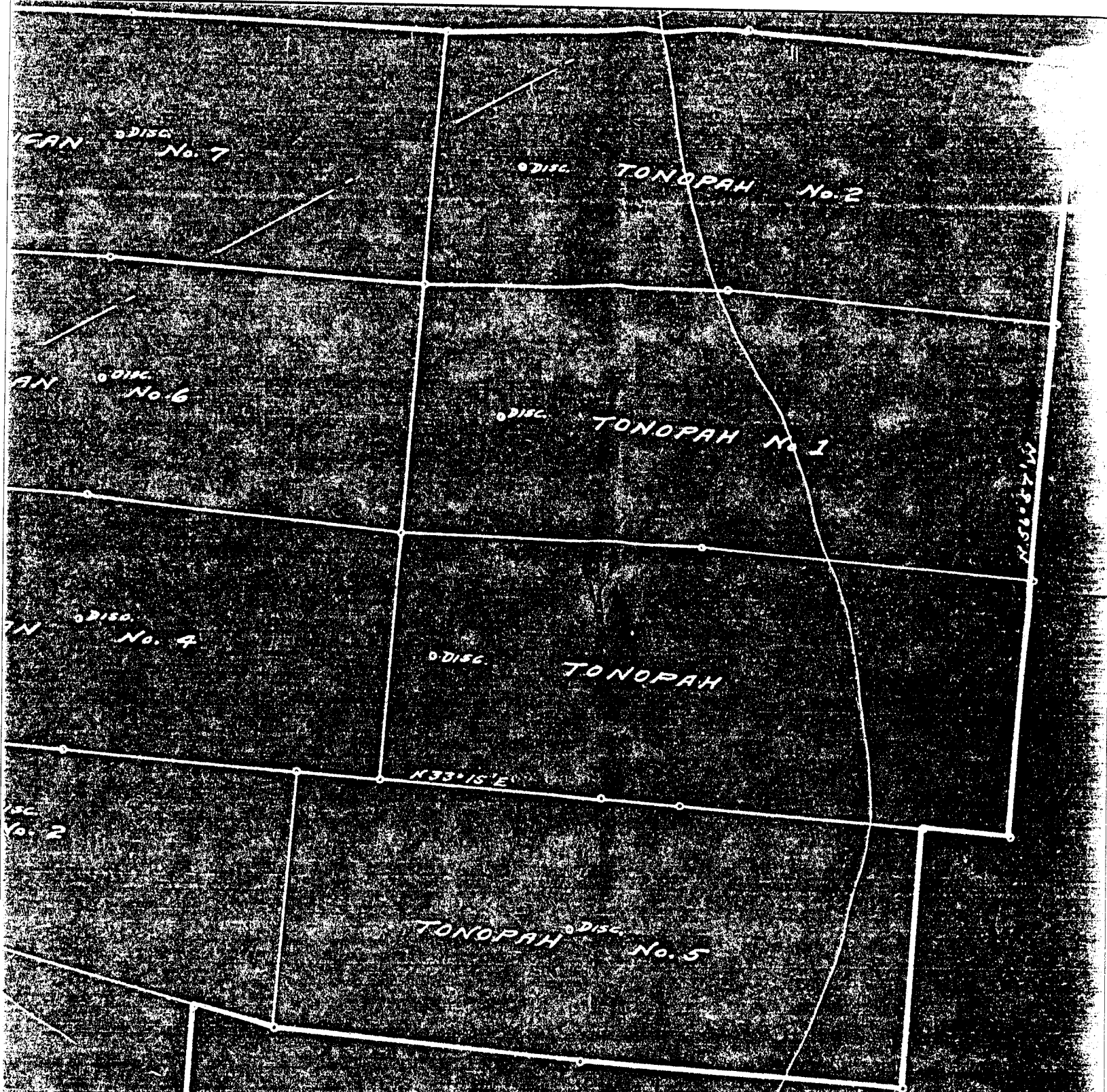

CLAIM MAP ARGENTITE, ESMEERALDA Co., NEV.
SHOWING CLAIMS UNDER OPTION TO TONOPAH
MINING Co. OF NEV. AND PART OF SANGER'S
FRANCES GROUP ON SOUTH END LINE.
SURVEYED - AUG-SEPT. - 1935 - SCALE - 300 FT. = 1 INCH.

NORTH

DISC No. 7

DISC TONOPAH No. 2

DISC No. 6

DISC TONOPAH No. 1

DISC No. 4

DISC TONOPAH

N33°15'E

N56°57'W

AMERICAN DISC. No. 10

AMERICAN DISC. No. 5

AMERICAN DISC. No. 7

UPPER
TUNNEL DISC. No. 3

AMERICAN DISC. No. 6

ALPINE DISC. No. 1

AMERICAN DISC. No. 4

ALPINE DISC. No. 2

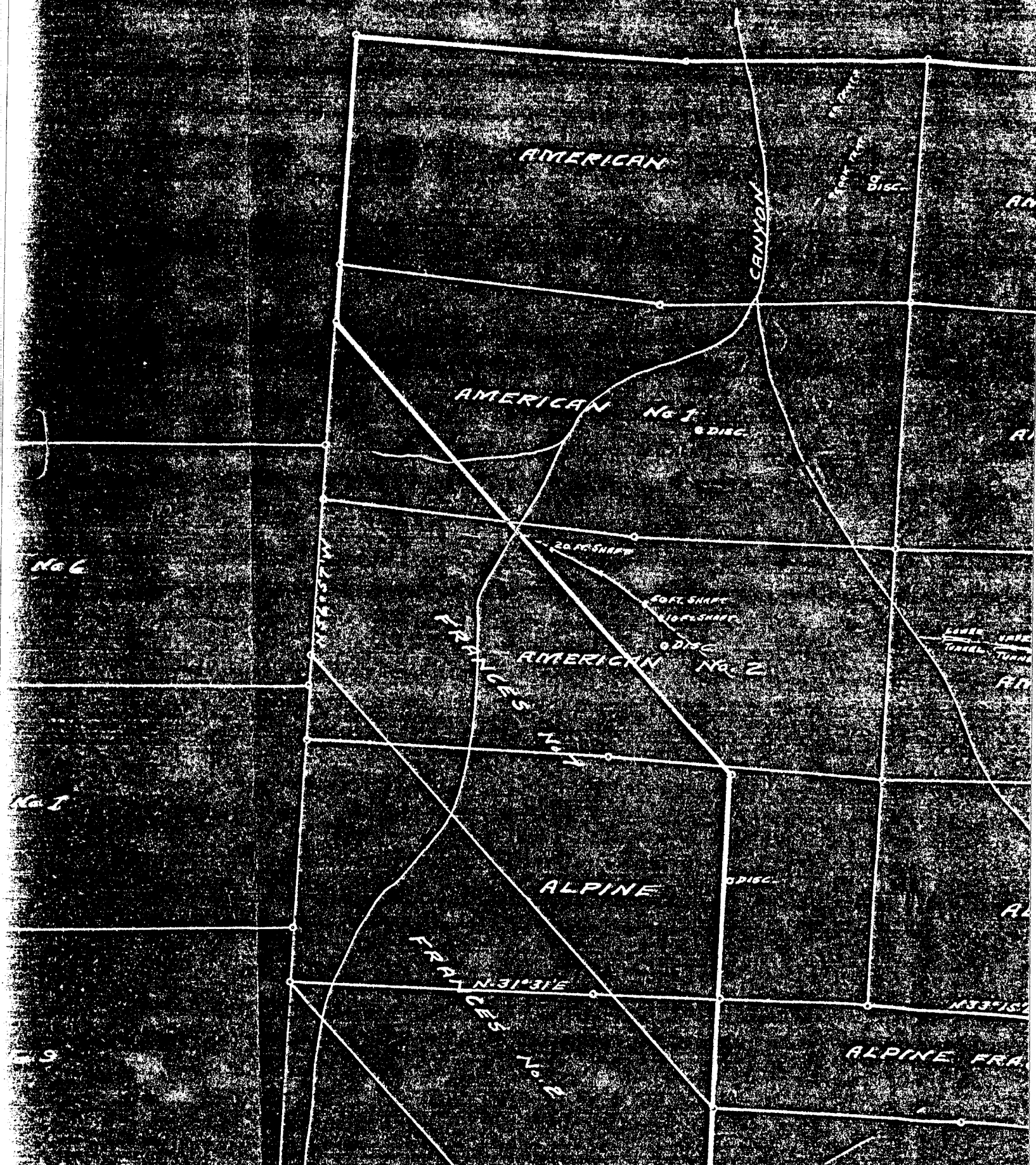

FRANCES No. 4

FRANCES

FRANCES

FRANCIS
200 ft. S.W.

FRANCES No.

FRANCES No. 10

FRANCES No.

MAN

40

13

1-18-1960-#0.46

PLAN OF VEIN MINING SCALE - 30 FT. = 1 INCH

UPPER
LOWER
NEW WORK

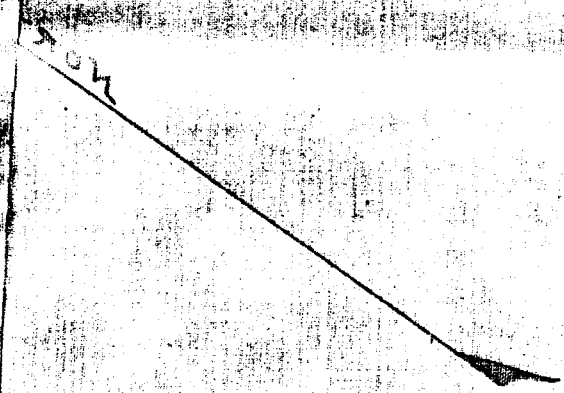

TR	-0.10	-0.41
TR	-0.20	-0.46
TR	-0.51	-1.83
TR	-0.40	-0.51
TR	-2.00	-1.54
TR	-1.20	-0.54
TR	-1.00	-0.77
TR	-0.80	-0.62
TR	-0.96	-0.74
TR	-0.60	-0.46
TR	-0.40	-0.31
TR	-0.41	-0.31
TR	-0.60	-0.46
TR	-1.00	-0.77
TR	-0.40	-0.31
TR	-0.40	-0.31
TR	-0.40	-0.31
TR	-0.60	-0.46
TR	-0.40	-0.31
TR	-0.40	-0.31
TR	-0.20	-0.15
TR	-0.20	-0.23
TR	-0.20	-0.15

10-11-11