

101

ITEM

100

3860 0031

Francis Group

JOHN & TAYLOR GROUP

in Silver Peak Range  
30 mi. W of Tonopah  
Argentine Dist.

Au Ag

Esmeralda County

(Nevada)

PLATON CORPORATION  
SILVER  
434 E. INDIAN STREET  
PHOENIX, ARIZONA



REC'D

JUN 22 1921

SEEN	J. H. W.	

SUPPLEMENTAL REPORT

ON

THE SANGER AND TAYLOR GROUP

ESMERALDA COUNTY, NEV.

Report by  
W. H. Blackburn

Tonopah, Nev., June 14, 1921.



## SANGER AND TAYLOR GROUP.

Since my visit to this property on May 17th, the shaft has been sunk an additional 15 feet and shows some improvement as to size. A nearly east-west fault pitching about 45 degrees to the south cut across the shaft and in the footwall of this fault a wider portion of the barite portion of the vein is exposed. A sample 4.8 feet wide gave gold trace, silver 14.2 ounces. A sample of the portion of the vein in the hanging wall of this fault over a width of 1.8 feet gave gold trace, silver 30.1 ounces, copper 0.2%. A grab sample of the fines thrown over the dump gave 10.6 ounces silver. Apparently there has been no increase in value.

It has been definitely determined that the best portion of the vein has a barium sulphate gangue (52% or over). Our cyanide test showed excessive cyanide consumption and we think this is due to copper silicate. Extraction was good and required short treatment time.

Sanger and Taylor have definitely stated their terms as follows: \$10,000. down, \$40,000. more in six months, then \$50,000. each six months until \$250,000. has been paid. All net on shipments to go to purchase price. All improvements to be left on ground if work abandoned.

Mr. Sanger was informed that these terms in view of the showing were excessive and would not be entertained, but that we would like a chance to consider any more favorable terms that they might offer.

It is our opinion that the property is about worth development



on the basis of no cash down and a year in which to ascertain whether it warrants a payment at the end of that time.

A corrected claim map is attached as a surveyor has surveyed the claims since our last visit.

---



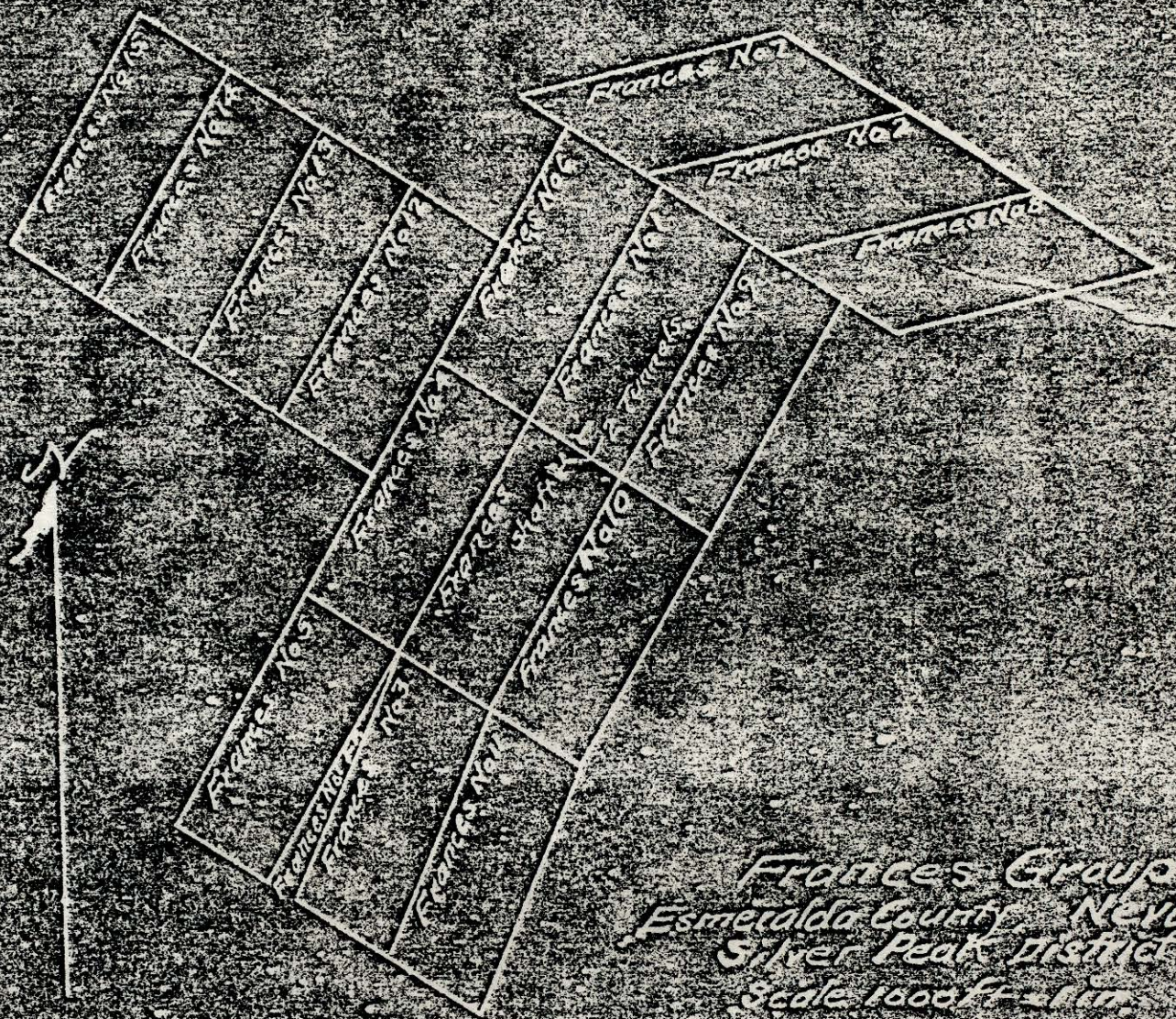

Frances Group  
Esmeralda County, Nevada  
Silver Peak District  
Scale 1000 ft = 1 in.



---

SANGER & TAYLOR GROUP

ESMERALDA COUNTY, NEVADA.

---

Report by:

W. H. Blackburn,

Tonopah, nevada.



## SANGER & TAYLOR GROUP.

### LOCATION:

Esmeralda County, Nevada. More precisely, the claims are located on the western border of Section 30, T. 2 S., R. 38 E. The mining district would probably be a southerly extension of the Silver Peak District. Silver Peak is the nearest postoffice.

### CLAIMS AND AREA:

This group of lode claims numbers 16 and are named Frances, Frances No. 1, etc., up to Frances No. 15. Each claim is supposed to contain 20.66 acres or 330.5 acres total. The mineral zone is protected for a distance of 6000 feet by a row of claims three wide (1800 feet). The mineral discovery is in the center of the tract. To the west of the center of the mineral claims four claims have been located for townsite purposes, and cover a very desirable flat. No millsites have been located as such. No water rights.

### TITLE:

By location and possession. Owners, W. A. Sanger and F. H. Taylor. Sanger grubstaking Taylor and furnishing money for development. Taylor is in charge of the development-work now under way. Sanger's present mail address is Silver Peak, though quite recently his residence was Big Pine, California.

### HISTORY:

All the claims have been located since the fall of 1920, by the present owners, who have been carrying on a small amount of development on the Frances and Frances No. 1 and have perfected their locations.



The property has not been bonded or offered for sale up to the present time.

ADJOINING PROPERTIES:

Locations that are now being made in all directions and surrounding the Sanger & Taylor Group. No developed properties.

FACILITIES:

Transportation:

Coaldale, or Blair Junction, on the Tonopah & Goldfield Railroad, are about equally distant in an air line. From Blair Junction the property can be reached in two ways, one via Silver Peak in 45 miles, another via Emigrant Pass in 30 miles, with about eight miles of road to build in either case. From Coaldale to the property is 32 miles, with four miles of road to build. The Coaldale road will cross the borax marshes, which are very heavy roads in the winter. Road building will cost, roughly, about \$1000.00 per mile. These roads will have medium grades. At the present time several miles of trail are necessary, and supplies are packed on horses.

The Silver Peak range has a flat top such as would be called a park in the Colorado country.

Power:

The Nevada-California Power Company's power line passes within nine miles of the property, while their transformer station is eleven miles distant at Silver Peak. About half the line construction would be through rough country.

Water:

Can be developed for milling and domestic purposes, but may



involve pumping, as the property is on the high slopes (8000 to 8500 ft.)

Timber:

The flat slopes are covered with a fair growth of pinon pine that will answer for domestic fuel.

Labor:

Will have to be brought in and will be of about the same class as employed at Tonopah.

Climate:

Good. There might be some snow on the roads in winter.

TOPOGRAPHY:

The hills traversed by the vein are rather rugged. At a lower elevation the country flattens out. The approach to the property is through rugged canons. The property can be partially developed by tunnels, but the real extraction of ore will be by shafts.

GEOLOGY:

Enclosing rock probably rhyolite. Portion of ground visited was covered with debris so that rock changes could not be observed.

ORE OCCURRENCE:

Strictly a silver ore at present. The low grade portion of the vein has a quartz gangue, the high grade a calcite or heavy spar gangue. The high grade portion of the vein is in the remains of a fault. Outcrop of the vein is traceable for one or more claim lengths. Outcrop is mostly low grade, but the vein shows improvement in depth. Strike of vein S. 25° W. Pitch 73° to East.

DEVELOPMENT:

Several shallow cuts on the outcrop. 60 feet of shaft work. 40 feet of tunnel work. All on vein material.



EQUIPMENT:

None. No camp except tents.

CONCLUSION:

No discussion of terms possible on account of Mr. Sanger's absence. This feature will be taken up in the near future.

From the assay list attached, one can see that the property has some value as a prospect, and I would advise spending money on it if the right terms can be secured.

W. H. Blackburn



SANGER & TAYLOR PROPERTYASSAY LIST

SAMPLE NO:	WIDTH :	GOLD OZ:	SILVER OZ:	DESCRIPTION
1	2.5 ft.	Trace	0.68	Hanging wall side of outcrop 600 ft. north of shaft.
2	2.0 ft.	"	0.72	(Middle portion of outcrop looks like fault material. (Joins No. 1.
3	5.4 ft.	"	1.08	Footwall side of outcrop. Quartz, spar, manganese & Iron. Joins No. 2.
4	1.0 ft.	"	2.30	Soft fault material in outcrop 400 ft. north of shaft.
5	4.5 ft.	"	5.72	quartz and spar in footwall of No. 4.
6	0.8 ft.	"	6.28	(Fault material on hangwall of outcrop 200 ft. north (of shaft.
7	3.0 ft.	"	1.76	quartz in footwall of No. 6.
8	4.0 ft.	"	4.30	Footwall side (west) face of south tunnel.
9	1.0 ft.	"	7.20	Fault material lies to east of No. 8.
10	0.8 ft.	"	8.40	Soft, talcy manganese stained material.
11	2.4 ft.	"	2.00	quartz in footwall at bottom 60 ft. shaft.
12	2.3 ft.	"	35.60	Spar portion of vein in hanging side of No. 11.
13	1.0 ft.	"	22.70	(Supposed to be high grade. Bottom of 60 ft. shaft near (Nos. 11 and 12.
14	1.0 ft.	"	20.90	Supposed to be high grade. Lies in hanging side #13.
15	1.5 ft.	"	17.00	40 ft. down shaft. Fault streak in hanging
16	3.2 ft.	"	7.60	Hard quartz in footwall of No. 15.
17	1.0 ft.	"	10.10	20 ft. down 60 ft. shaft. Fault material in hanging.
18	4.0 ft.	"	2.00	20 ft. " " " " Footwall of #16. Hard quartz.
19	-	"	16.20	Grab sample of footwall portion of vein at bottom of shaft.



100

Francis #8	Francis #9	Francis #10	Francis #11
Francis #2	Francis #1	Francis #10	Francis #9
Francis #7	Francis #6	Francis #4	Francis #5
		Francis #12	
		Francis #13	
		Francis #14	
		Francis #15	

Shaft  
Tunnels

Sanger & Taylor Group  
Silver Peak District  
Esmeralda County  
Nevada  
Scale 600 ft = 1 in.







# THE TONOPAH MINING COMPANY OF NEVADA

EASTERN OFFICE  
179 BULLITT BUILDING, PHILADELPHIA, PA.

PLEASE ADDRESS ALL COMMUNICATIONS  
TO THE COMPANY, TONOPAH, NEVADA

TONOPAH, NEVADA, October 22, 1935.

Mr. I. H. Bregy,  
Exploration Department,  
The Tonopah Mining Company of Nevada,  
Philadelphia, Pennsylvania.

Dear Mr. Bregy:

I have your letter of Oct. 11th, asking about the Sanger-Taylor-Francis group of claims in the Argentite district.

It has been reported, and I believe it to be a fact, that this group of claims is under option to Willard Hales and associates, but contrary to expectations no work of any kind has yet been done on the property and it is now idle. Rumor has it that \$5000.00 was to be expended on the property, and it is further reported that Hales has formed a company, and I think the difficulty now lies in the disposal of sufficient stock to finance an operation.

Considerable publicity has been given the fact that they are going ahead in the district in which The Tonopah Mining Company is working, and it even goes so far as to state in one mining journal that operations are now under way and that they are constructing a 100 ton plant. - This from the Arizona Mining Journal.

I received Mr. Huston's wire regarding cross-cutting, and this work was started Sunday and we should be under the surface projection of the vein in about a week. The vein dips approximately 80 degrees to the west, and with 260 feet of depth as we now have, the drift should be on the vein projected downward to this level.

We are enclosing preliminary report by Mr. Sharp on the Gold Pen Rand Mining Company, and maps of same are being forwarded to you under separate cover.

Yours very truly,

*H. A. Johnson*  
Superintendent.

HAB:2  
enc.



# THE TONOPAH MINING COMPANY OF NEVADA

EASTERN OFFICE  
179 BULLITT BUILDING, PHILADELPHIA, PA.

PLEASE ADDRESS ALL COMMUNICATIONS  
TO THE COMPANY, TONOPAH, NEVADA

TONOPAH, NEVADA,

Oct. 24, 1905.

Mr. W. B. Huston, Vice-President,  
The Tonopah Mining Company of Nevada,  
Philadelphia, Pennsylvania.

Dear Mr. Huston:

I have your letter of Oct. 21st, in regard to Argentite.

Upon receipt of your wire several days ago, we immediately discontinued drifting and started crosscutting to the east. This work should be completed before November 1st. When the values became so low on the vein as to be uninteresting I wrote to Mr. Lindley, suggesting that we proceed another 100 ft. and then crosscut, as has now been started. I feel that this should be done, and while I do not believe that we are off of the vein there is, as you state, always this possibility. The vein projected from the tunnel to the surface on an 80 degree dip outcrops approximately where we have it shown on the map.

In regard to drifting on the Sanger-Taylor vein, I feel that since we are in the district this should be done. While the values are not very high, I believe we should do this before abandoning the project. The point from where a tunnel will start in the canyon where the vein outcrops is about 40 feet below the bottom of the 40 ft. shaft. The distance from this point to where we will have to install a compressor should not be over 500 feet. We have sufficient pipe and material to make the change, and unless something unforeseen happens in the crosscut which we are now driving, I shall make arrangements to start drifting on the Sanger-Taylor vein.

As to the probable cost of this work, I believe that \$3000.00 will easily take care of the change and 200 ft. of drifting. The Sanger & Taylor property, as I wrote Mr. Bregy, is under option to Willard Hales.

I am today sending the tracing of the Argentite property up to date, and I am also including a copy of the claim map, showing the approximate position of the present work and of the contemplated work.

With kind regards,

Yours very truly,

*H. A. Johnson*

H.A.J:m

Superintendent.



COPY

THE TONOPAH MINING COMPANY OF NEVADA

PHILADELPHIA

June 17, 1921.

Mr. W. H. Blackburn, Supt.,  
Tonopah,  
Nevada.

Dear Mr. Blackburn:

Your favor of the 11th inst., has been received and I agree with you that Mr. Sanger's terms are most unreasonable, in fact I do not see the value would justify any terms whatever, as we must not think of silver at a \$1.00 an ounce in connection with taking over any properties. The much safer course is to treat silver according to the quotations for foreign production.

Yours very truly,

JHW.

President.



J. H. WHITEMAN, PRESIDENT

C. R. MILLER, VICE-PRESIDENT  
W. H. BLACKBURN, SUPERINTENDENT

F. S. BICKMORE, SECRETARY & TREASURER

## THE TONOPAH MINING COMPANY OF NEVADA

EASTERN OFFICE  
572 BULLITT BUILDING, PHILADELPHIA, PA.

PLEASE ADDRESS ALL COMMUNICATIONS  
TO THE COMPANY, TONOPAH, NEVADA

TONOPAH, NEVADA, June 11, 1921.

REC'D

JUN 17 1921

Mr. J. H. Whiteman, President  
The Tonopah Mining Co. of Nevada,  
Philadelphia, Pa.

SEEN

J. H. W.

Dear Mr. Whiteman:

I returned yesterday from the Siler Peak range, from further examination of the Sencer-Taylor property. Since the 16th of May they have sunk the shaft another fifteen feet. This work shows a change in the north end of their shaft from an ore width of about 2 feet to nearly 5 feet. A thorough sampling of this end of the shaft gave 14.2 ozs. silver. Another thorough sampling of the south end of the shaft for a width of 1.8 feet gave 30.1 ozs. silver. These samples check very well with my previous samples higher up the shaft and with Mr. Lawry's samples, Mr. Lawry having visited the property the same day I did in May. A grab sample from the fines that they are putting over the dump gave 10.6 ozs. silver. One of my samples gave .2 of 1 per cent copper, and a specimen gave 2.28 per cent copper. This probably accounts for our high cyanide consumption in the test that we made on my May 16th samples.



J. H. WHITEMAN, PRESIDENT

C. R. MILLER, VICE-PRESIDENT  
W. H. BLACKBURN, GENERAL SUPERINTENDENT

C. A. HIGGEL, SECRETARY & TREASURER

## THE TONOPAH MINING COMPANY OF NEVADA

PLEASE ADDRESS ALL COMMUNICATIONS  
TO THE COMPANY, TONOPAH, NEVADA

EASTERN OFFICE  
922 BULLITT BUILDING, PHILADELPHIA, PA.  
MAY 27 1921  
TONOPAH, NEVADA.

REC'D



Mr. J. H. Whiteman, President,  
The Tonopah Mining Co. of Nevada,  
Philadelphia, Pennsylvania.

Dear Mr. Whiteman:-

I am enclosing herewith report on the Sanger & Taylor Group, located in the Silver Peak range and situated about thirty miles west of Tonopah. This group is also located about two miles to the west of the Niwloc Mine.

While the assays taken at this property are not as high as expected, they still indicate a fair width of good ore, and if the proper terms can be arranged I would recommend spending a considerable sum of money in further development. Mr. Sanger, who has control of such matters in connection with the property, was not on the ground at the time of my visit. Mr. Sanger and Mr. Thayer will be in Tonopah soon to discuss terms with me.

I would also advise you that Mr. Sanger is a man of considerable means and perfectly able to do his own development work. The property really is desirable if obtained under the right conditions.

Yours very truly,

*W. H. Blackburn*

WFB/M  
encls

General Superintendent.