

(191) B.
Ham 8

3800 0007

R e p o r t

o n

T H E L O N E - S T A R M I N E

Nugent Wash Canyon,

Mineral County,

N e v a d a

Examination: 3/7/1914.
Report: 3/15/1914.
By: W.H.SIRDEVAN.

R e p o r t

o n

T H E L O N E - S T A R M I N E

The Lone Star Mine is located in Nugent Wash Canyon, Rand Mining District, Mineral County, Nevada, and about 17 miles south-east from Rawhide. It is about two thousand feet east from the Last Hope Mine - on the same diorite - andesite contact.

Sampling

Five samples were taken on the property with the following assay results. For the location of the samples see the accompanying sketch.

NO.	WIDTH	A s s a y		TOTAL
		G o l d	S i l v e r	
283	3/3'	\$6.00	\$20.15	\$26.15
284	3.3'	\$4.80	\$ 7.43	\$12.23
285	3.0'	\$3.60	\$ 7.06	\$10.66
286	3.0'	\$8.40	\$ 7.49	\$15.89
287	Grab	\$12.40	\$18.04	\$30.44

These samples give an average of 3' of \$16.37 ore. A grab from a pile of about twenty tons of shipping ore gave an assay of \$30.44 per ton.

Conclusions

This property will be worth further investigation in connedtion with the Last Hope Mine. No terms were discussed with the owners as it was stated that their price was very high.

The O'Brien Claim - located between the Last Hope and Lone Star properties (sketch) was recently sold for \$35,000 and the second cash payment is said to have been made. There is a poor showing on the surface and practically no work done on this claim.



SKETCH

9T

LAST HOPE AND LONE STAR MINES

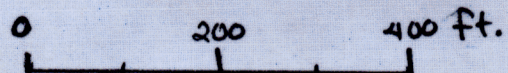

RAND MINING DISTRICT - MINERAL COUNTY - NEVADA.

Scale: 1"=200' - Mar. 7, 1914.

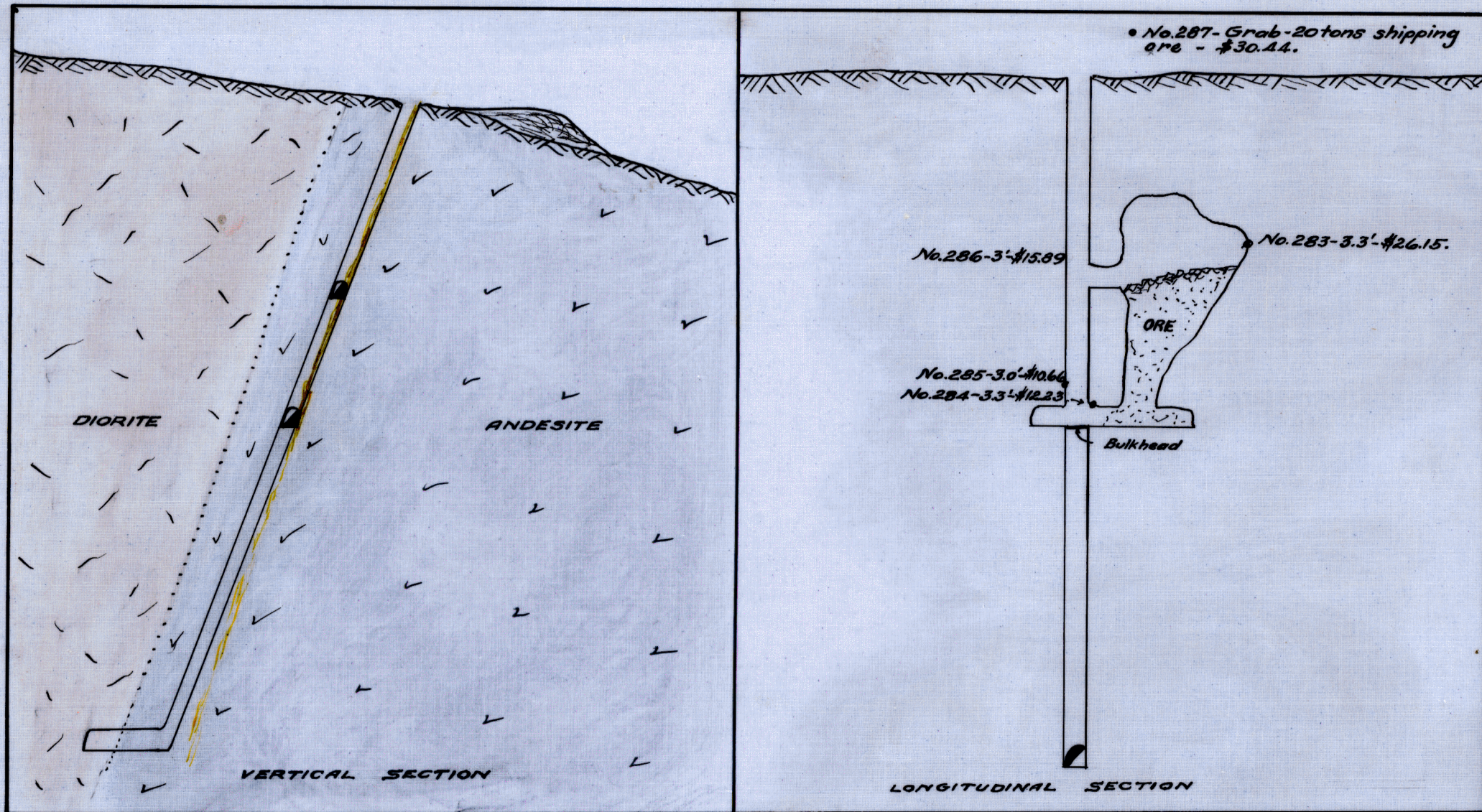

THE LONE STAR MINE

0 40 80 ft.

RAND MINING DISTRICT-MINERAL COUNTY-NEVADA.

Scale: 1"=40' - Mar. 7-1914.

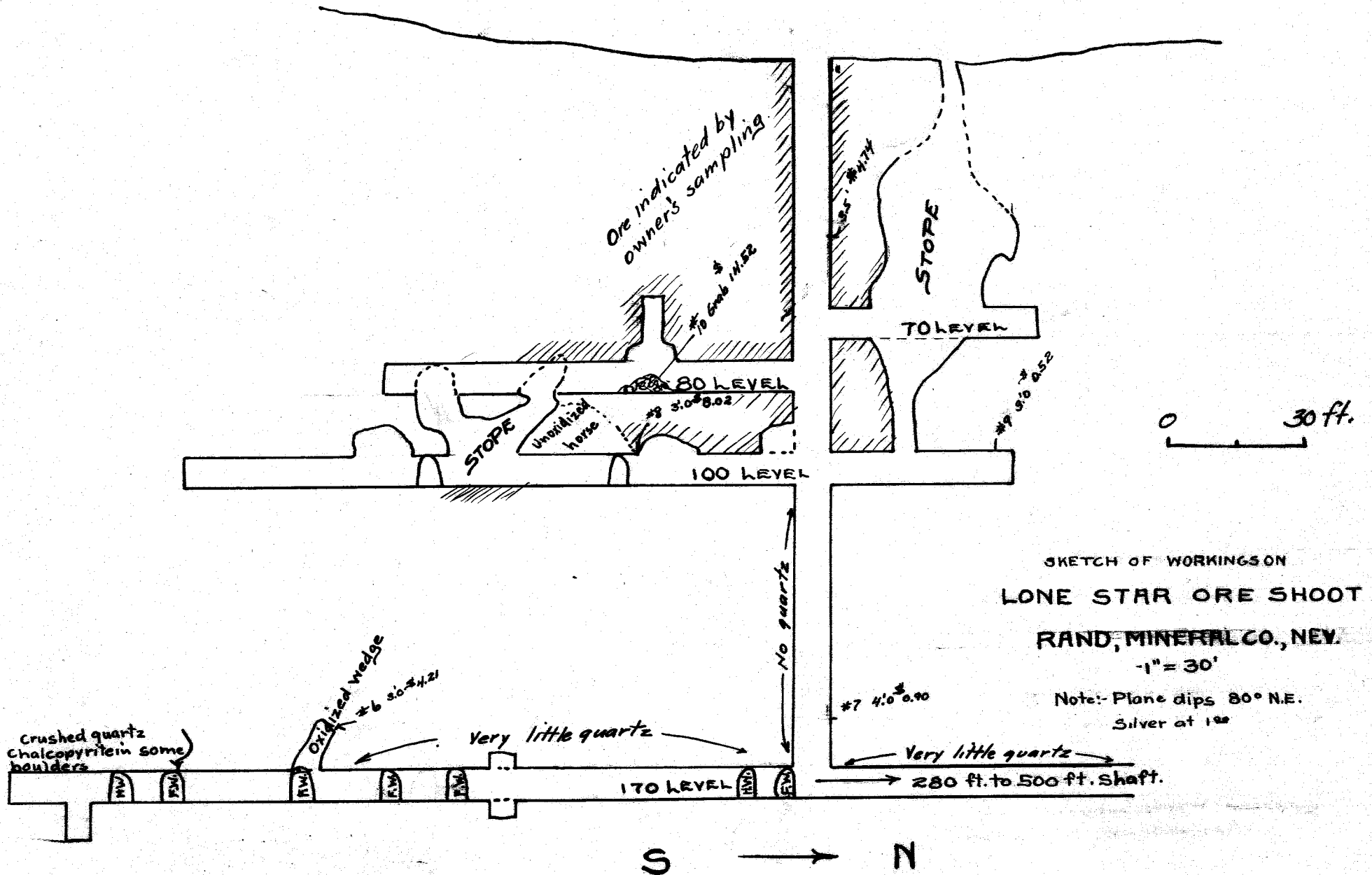

PRELIMINARY REPORT ON

Name and Owner. LONE STAR GROUP --- E. M. Mims, Rand, Nevada.

Location and Holdings. Seven lode claims, located 12/22/07 in the Rand Mining District, Mineral Co., Nev.

Accessibility and Transportation. Fair auto roads. 17 mi. from Nolan siding on T. & G., 99 mi. from Tonopah via Luning summit. Haul from Nolan \$ 6.00 per ton.

Geology. Entirely volcanic. Two andesites on surface, but, except for one x-cut on 500 level, all workings in the lighter colored one found on H.W. on surface. As indicated by dump, 500ft vertical shaft on F.W. side of vein was sunk chiefly in a ~~rhysli~~ rhyolite that does not outcrop on the property.

Veins or Ore Bodies. Where accessible for examination, "vein" consists of shear zone in the lighter colored andesite, with quartz lenses carrying gold and silver. Zone 10 to 100 ft. wide, often largely kaolinized. Quartz lenses small. All ores oxidized, high in manganese. About 500 tons shipped, \$ 38.00 to \$ 100.00, contained 1 oz. gold to 20oz. silver.

Samples and Assays. Few taken to check statements of owner and try out surface and ends of workings. No's 6 to 11 inclu. on attached print: #3 2.0 ft. Tr. Gold .12 oz. Silver Quartz, 40 ft. level, #1 shaft
#4 --- Tr. " .52 " " Cropping, 100' north of #2 shaft.
#5 Grab .09 " 2.81 " " "Ore" dump, #3 shaft.

Development. 2 90 ft. vert. shafts, a 500 ft. vertical shaft, 170 ft. 80° incline and about 2500 ft. of drifts and x-cuts. All ore has been found at the incline shaft.

Present Equipment. 15 H.P. Witte hoist, 30 ft. head frame, 700 ft. cable, blacksmith shop, camp for 8 men.

Metallurgy. In spite of the high manganese, a series of tests made by the Tonopah Extension indicates a very satisfactory extraction by cyanide.

Wood, Water and Power. Nev.-California power line 1 mi. away, but wire now being removed. Typical desert country, no timber. Water now being hauled from Dead Horse wells below Rawhide, 10 mi.

Price and Terms. \$ 75,000.00, would prefer most of it in stock. Wants work done on the property.

Possibilities. Limited. Ore does not go down to "170" level of Incline shaft, as shown by the drifts, x-cuts and the incline. Surface and underground work done indicates but the one ore-shoot on the property.

Miscellaneous. Adjoins the Nevada-Rand property on the south. Conditions in the two properties are identical. -- A little water was found in one x-cut on the 500 ft. level. 250 gal. per day.--

Conclusions. Too small for the Company. Owner can still make some profit by shipping the remainder of his ore.

Date. 6/22-23/20 Report for Tonopah Mining Co.
Report 6/27/20 of Nevada

By 

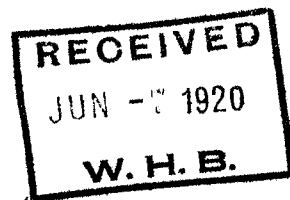

Rand Rev. June 8th 1920

Mr W. H. Blackburn

Dear Sir

Your letter just received & will say that, I would certainly be glad to have you visit & inspect my property; & also Mr J. E. Bray (Gen Manager) for the Gold Per mine extends you a pressing invitation to visit the Gold Per mine. Although my property has not been for sale I would be glad to make a deal with your Co. I will put my property up to you for sale for \$75,000. - seventy five thousand dollars. If you should wish to incorporate the Lone Star group of claims I would rather have mostly stock than money; at a reasonable figure. I would not accept enough payment at once to pay much war tax. My ground embraces 4000. ft on ledge between the Rand & Gold Per mines. I have six adjoining claims. This is a large dyke & the ore body occurs in differently widths varying so far from 10 to 3 feet wide & this shoot is opened up 180 ft

RECEIVED

JUN 14 1920

W. H. B.

Rand Nev. June 12th 1920.

Mrs W. H. Blackburn

Tonopah Nev.

Dear Sir :

Your letter of June 1st I have received. In regard to your inquiry of the route you speak of. will say when you leave Phenixite go to Lodi's Tanks, then go to Kellys wells on the Luning road. 8 miles distance.

From Kellys Well take the right hand road to Hob springs. They will direct you at Hob-springs to the Rawhide Road. In 12 miles distance you will reach the abandoned mills below Rawhide. take the left hand road. To two miles pass Head Horse Wells. you will have signs directing you to the Rand camp.

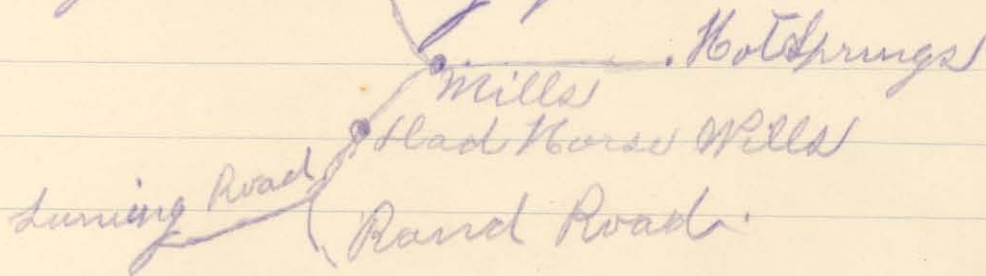

Hoping to see you soon. I remain
Yours Truly E. M. Minna.

long & 170 feet deep. This ore will break
from \$20. to \$60. per ton. The mill test made
by the Townshank Extension Mining Co shows
98% extractable by cyanide. The values
being - 30 oz of silver to 1 oz of gold. This
is the mine here which encountered the
calcopyrite ore which is only a drag of
large boulders 200 feet in depth. My
property is undeveloped on account of no
crosscutting. I am installing my hoisting
engine now but you can inspect the
ore body from the surface. I have one
shaft 500 feet deep but the dyke has not
been crosscutted to the ledge. You would
have 125 miles by auto via Luning or I
can pick you up at Nolan station
17 miles from the mine. I would be
glad for you to visit the mine before the
machinery is installed. Hoping to hear
from you or see you soon.

I have good accommodations
Yours Truly
E. M. Mines

~~DESERT POWER AND MILL COMPANY~~

TONOPAH MINING COMPANY OF NEVADA
TONOPAH, NEVADA

June 8, 1920.

Mr. E. M. Mims,
Rand,
Nevada.

Dear Sir:

I was very glad to get your letter of June 5th and wish to thank you and Mr. Bray for the invitation to visit Rand.

It is rather uncertain as to when I can make this trip but I may be able to come across from the old camp of Phonolite within the next two weeks. Will you kindly let me know whether there is a road between Phonolite or Burt Cabin Summit across Lodi Valley to your place. I hope I may see something interesting enough to get us started in your section.

Yours very truly,

General Superintendent.

WHB-HS

~~DESERT POWER AND MILL COMPANY~~

TONOPAH MINING COMPANY OF NEVADA
TONOPAH, NEVADA

June 30, 1920.

Mr. E. M. Mims,
Rand, Nevada.

Dear Mims:-

After discussion with Mr. Blackburn, it was decided that your property was not a suitable one for the Company.

I suppose by now you're at work on the headframe. I feel pretty fair, but still have occasional cramps to remind me of the experience.

Remember me to the Camp, especially the Walker boys. I neglected to thank them for their trouble while I was there.

Very truly yours,

