



AMERICAN  
SELCO INCORPORATED

SUBSIDIARY OF SELECTION TRUST LIMITED, LONDON, ENGLAND

698 SOUTH FIFTH STREET  
ELKO, NEVADA  
89801

TELEPHONE (702) 738-6723

WAG

ITEM 95

May 10, 1971

Mr. David L. Evans  
Consulting Geologist  
1700 Royal Drive  
Reno, Nevada 89503

Dear David:

I will be in Reno the evening of Sunday, May 23rd, and would like to arrange to get together with you in regards to Pyramid Lake the 24th or 25th.

Please let me know if this would fit into your schedule.

Very truly yours,

John F. Prochnau  
Regional Exploration Geologist

JFP:bj



May 15, 1971

Mr. John F. Prochnau,  
Regional Exploration Geologist,  
American Selec Incorporated,  
698 South Fifth Street,  
Elko, Nevada , 89801.

Dear John:

I have been out of town, returning home only yesterday, which will explain why you have not had this letter sooner.

Yours of the 10th is at hand and I am sorry that I have not been able to follow things through with Utah until now.

The situation has been discussed with Mr. Knaebel, and his reactions have been negative. It is his feeling, as well as Holly Peacock's, that it would not be to Utah's interest to have me go ahead with the matter we discussed. Believe me, it would have given me real pleasure to have seen more of that Moly property, as well as to spend the few days in the field with you. But under the circumstances, it is going to be impossible to proceed with the plans.

I do hope that at some future date there may be some other way in which to work with you; as noted above I regret the delay in providing this answer and only hope that it will not delay progress.

When you are in Reno, by all means call the house. Both Mrs. Evans and I would enjoy having you spend an evening with us.

Sincerely,

  
David LeCount Evans



Telephone 363-3302

Hand Sample Serial. **687**

ASSAY REPORT

**UNION ASSAY OFFICE, Inc.**

W. C. WANLASS, President  
 L. G. HALL, Vice President  
 G. P. WILLIAMS, Treasurer  
 LILY M. HOTTINGER, Secretary  
 P. O. Box 1528

Salt Lake City, Utah 84110

Mine **Utah Construction & Mining Co.**  
**70 Linden Street**  
**Reno, Nevada 89502**

RESULTS PER TON OF 2000 POUNDS **May 2, 1967**

NUMBER	GOLD Ozs. per Ton	SILVER Ozs. per Ton	LEAD Wet on Ore	COPPER Per Cent	INSOL. Per Cent	ZINC Per Cent	SULPHUR Per Cent	IRON Per Cent	LIME Per Cent	Per Cent	Per Cent
										<u>Mo</u>	
501	0.005	0.2					<i>Pyramidal Lake</i>			0.009	

Remarks .....

Charges \$ **8.00***G. P. Williams*



$\angle'' = 100'$

Dump.  
 Dec. 10. 97.  
 for the  
 some in garden  
 in clarkson  
 Bugg. of Moss.  
 But. U  
 412

1800 working  
 2800 x C. maximum  
 The 400 to E  
 3400 to W  
 100' Pelt  
 210  
 in 1 x 1

Heavy  
oxide  
- Tr. Fe<sub>2</sub>O<sub>3</sub>  
- 3.0% heavy  
Discol. in R.R. exp.

AT Typ of 14.11. SW of this area  
L.C. notice by  
Harriet Hale  
July 3 — (supposedly  
"Quartz" dam)



1" = 1320'

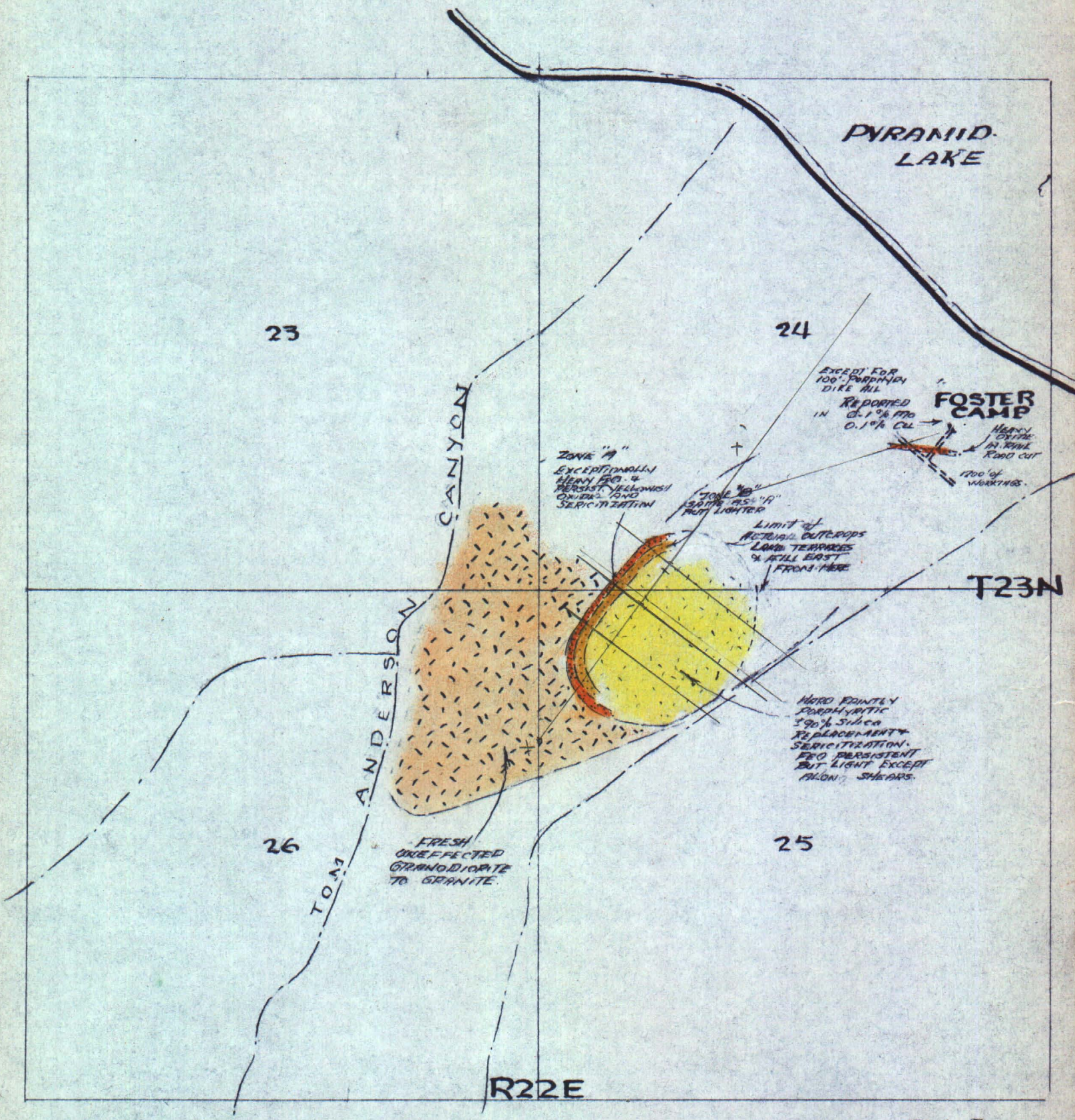

1560  
1320  
1140

D.L. EVANS  
MAY-24, 1967

1" = 1320'



1" = 1320'

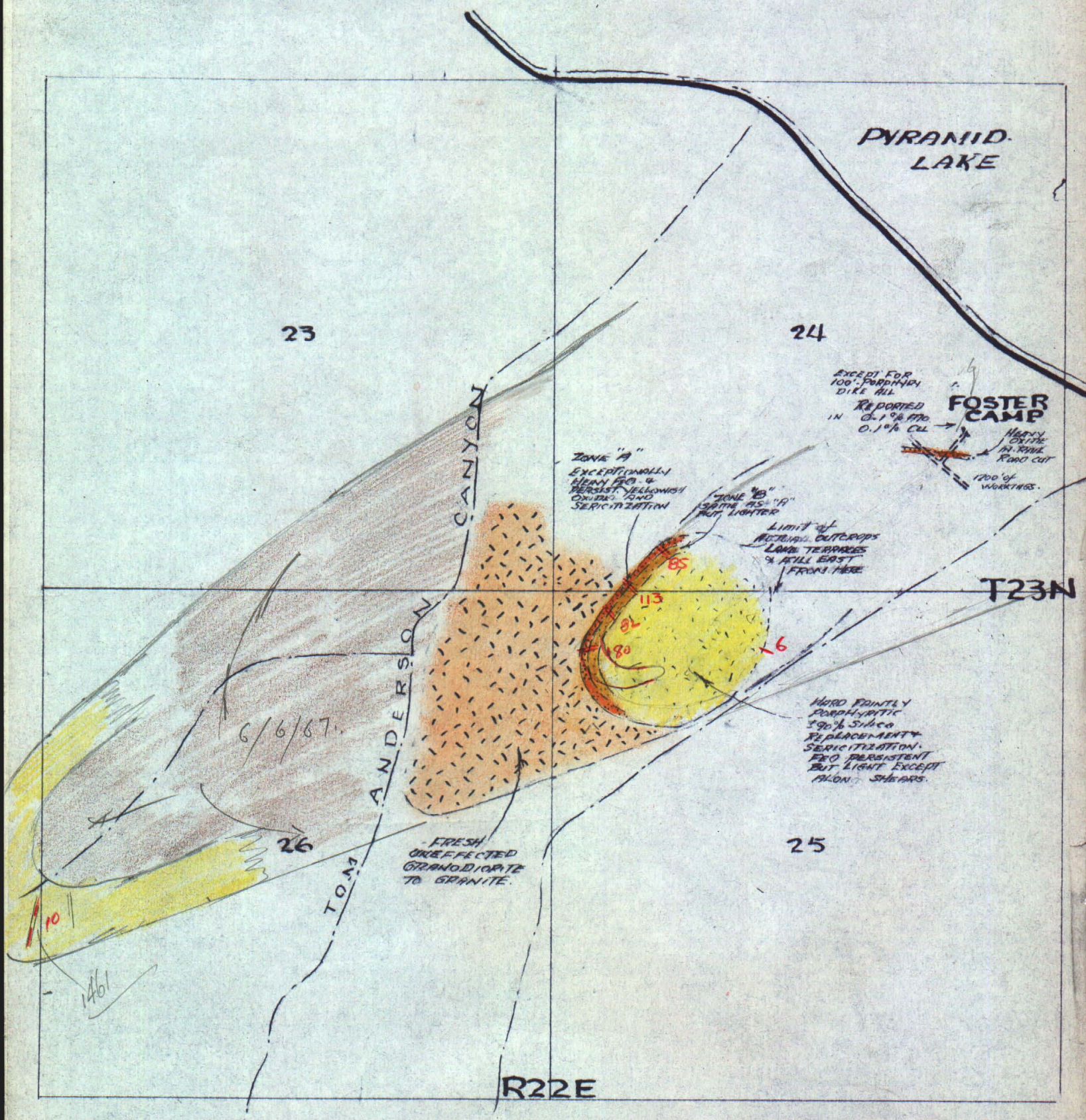

D.L. EVANS  
DAY-24 1967

1" = 1320'

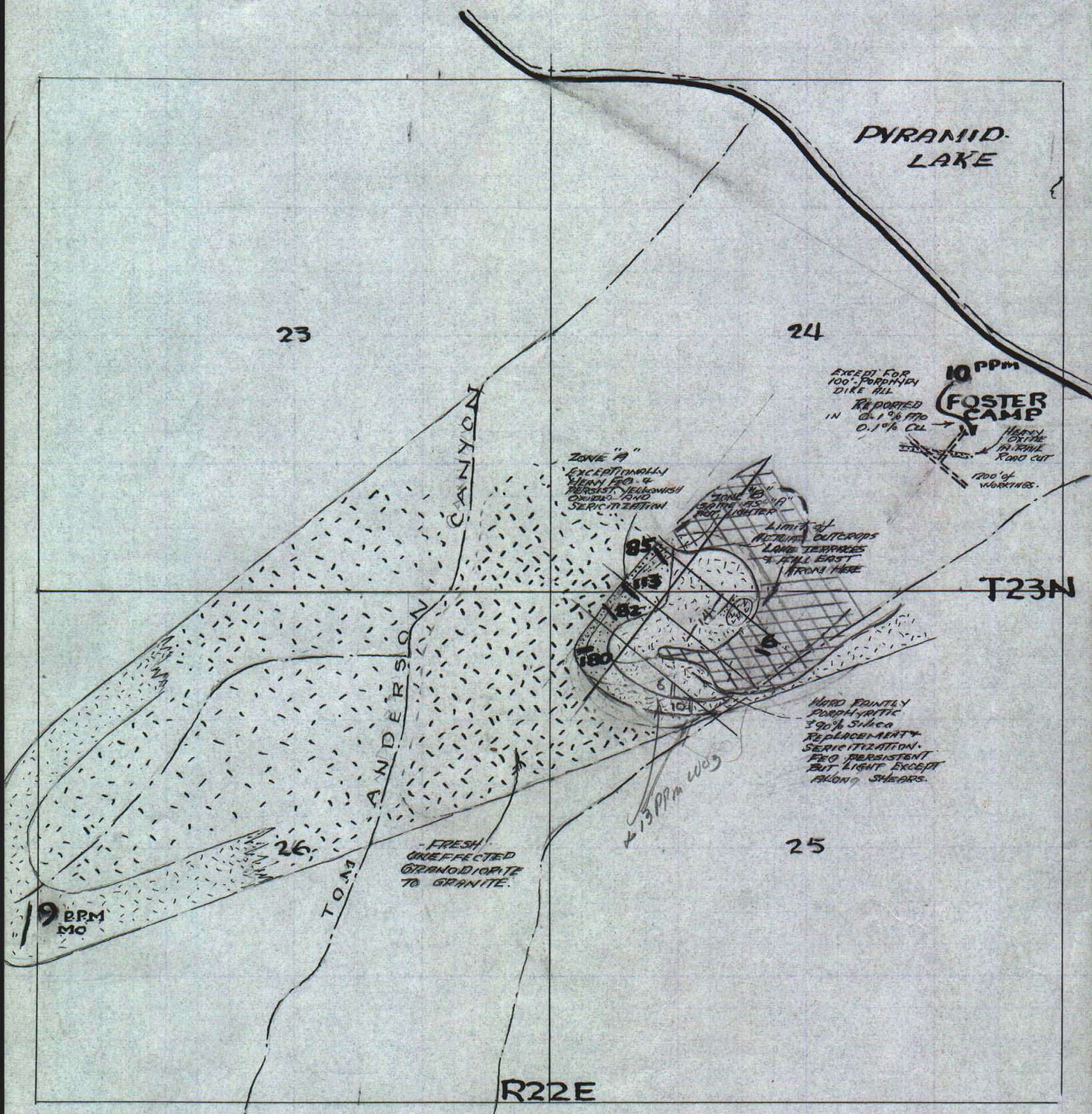

$$1'' = 1320$$

D. L. EVANS  
MAY-24-1967

1° 1320'



$200 \times 2000 \times 100 = 3,600,000 \text{ T/Vol } 100' -$   
 860' to Peter Ten Depth

For 900' - 32,000,000 Ton  
 Possibility  
 with no  
 measured  
 width

R22E

T23N 23 24  
 26 25

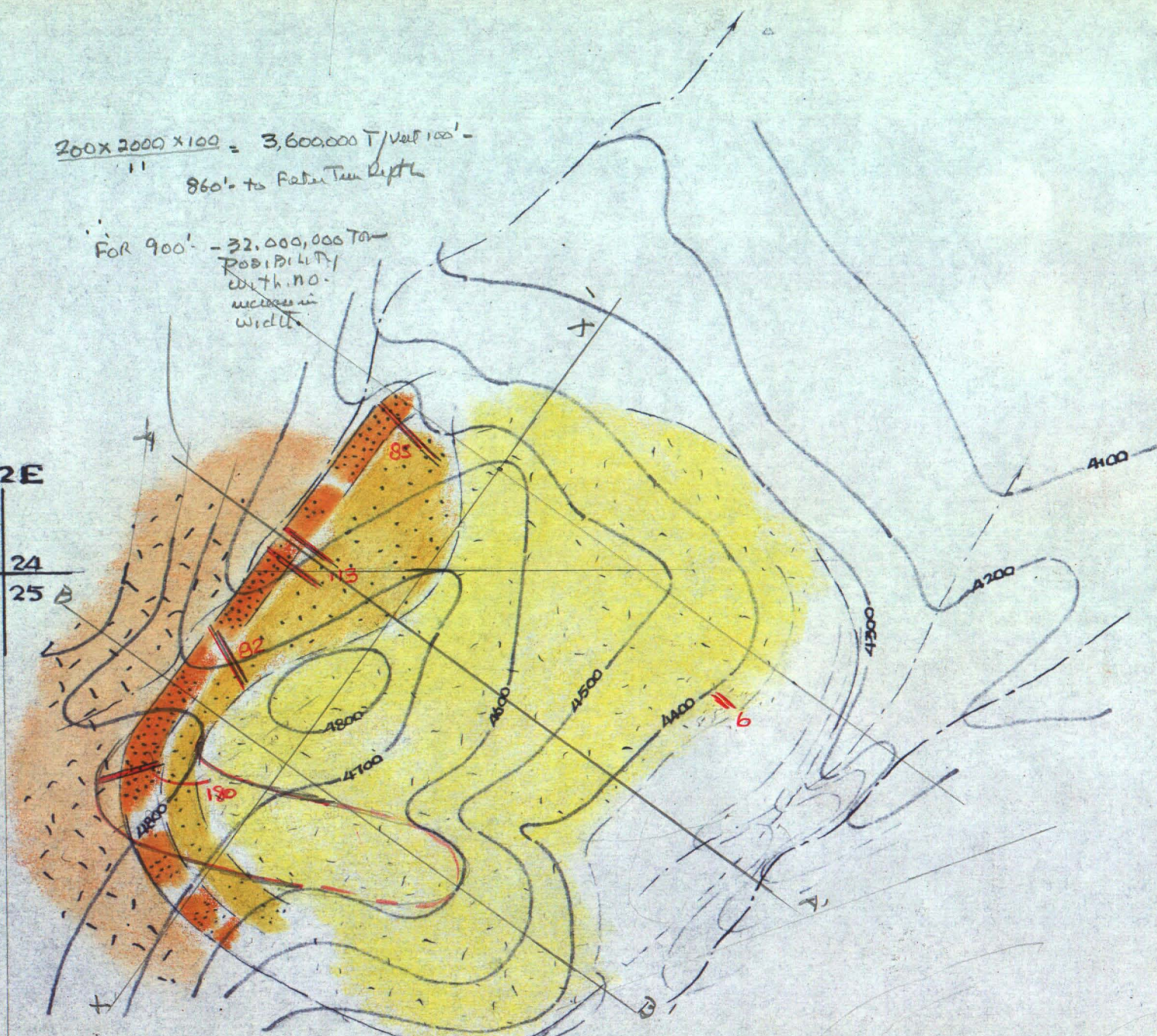

D. L. EVANS  
 MAY 20, 1967  
 1" = 400'



R22E  
T23N 23 24  
26 25

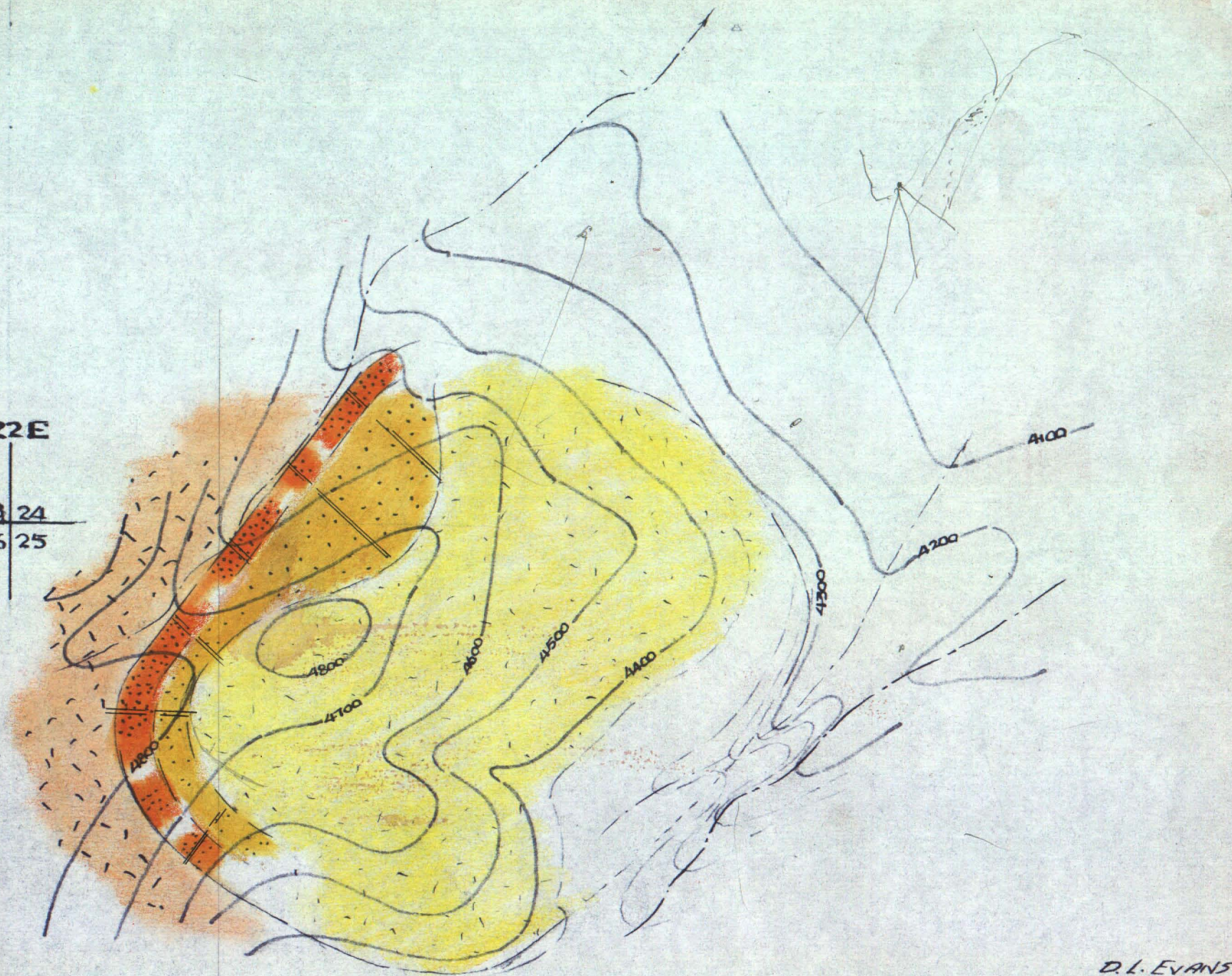

D. L. EVANS  
MAY 20, 1967  
1"=400'



$$150 \times 2200 + 500$$

$$330000 + 500$$

$$330500$$



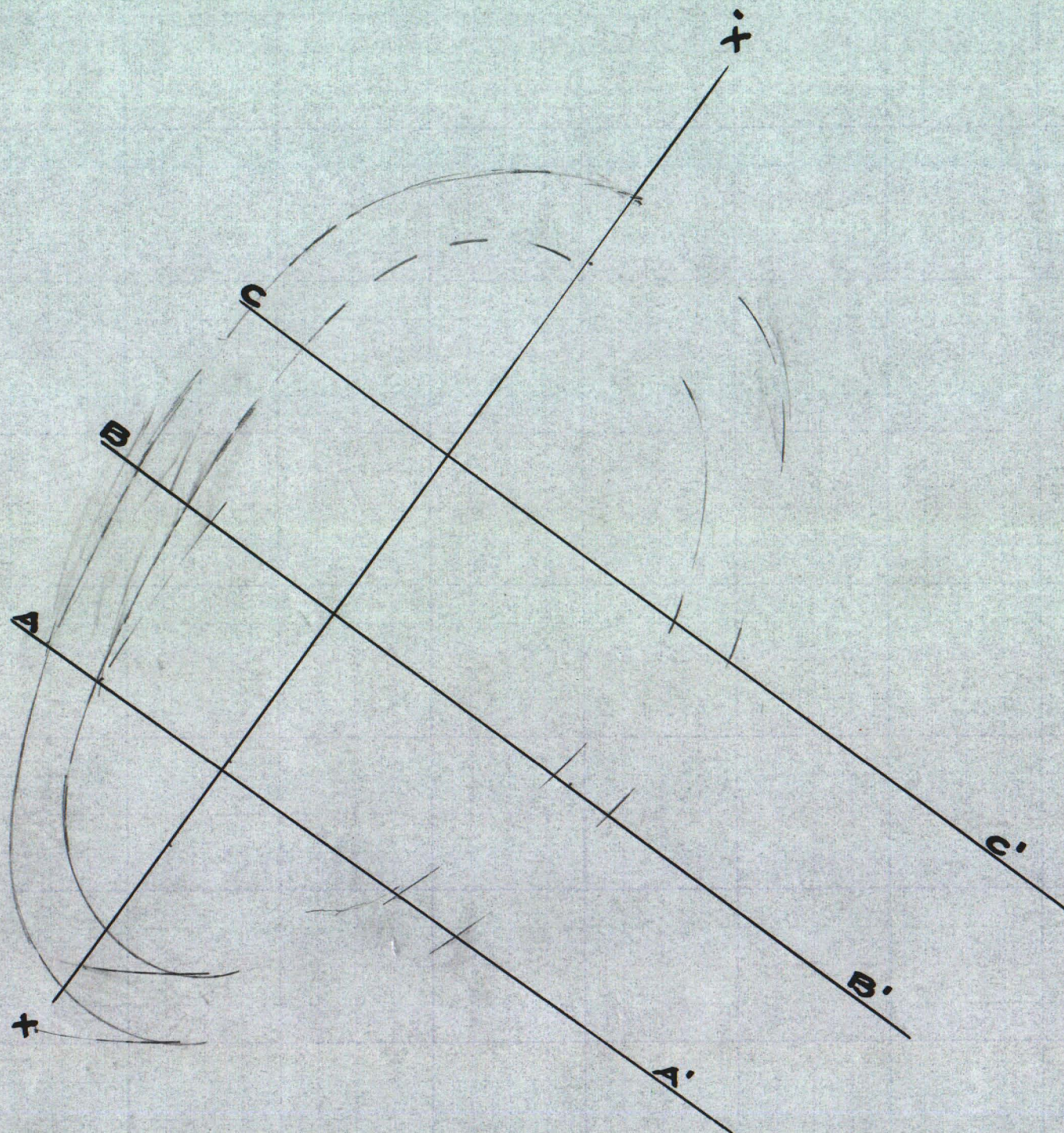

R22E  
T23N

23	24
26	25



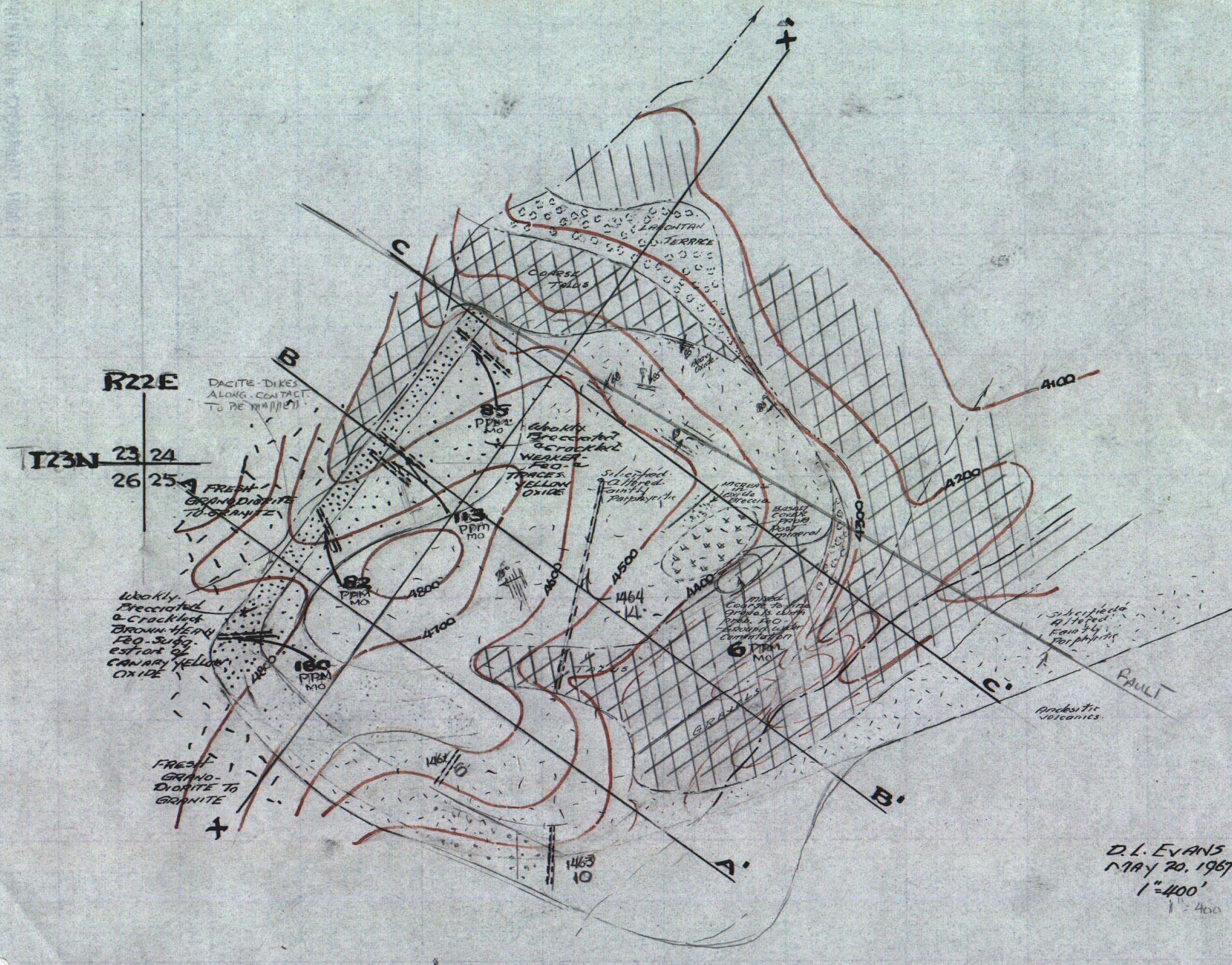



D. L. EVANS  
 MAY 20, 1967  
 1" = 400'



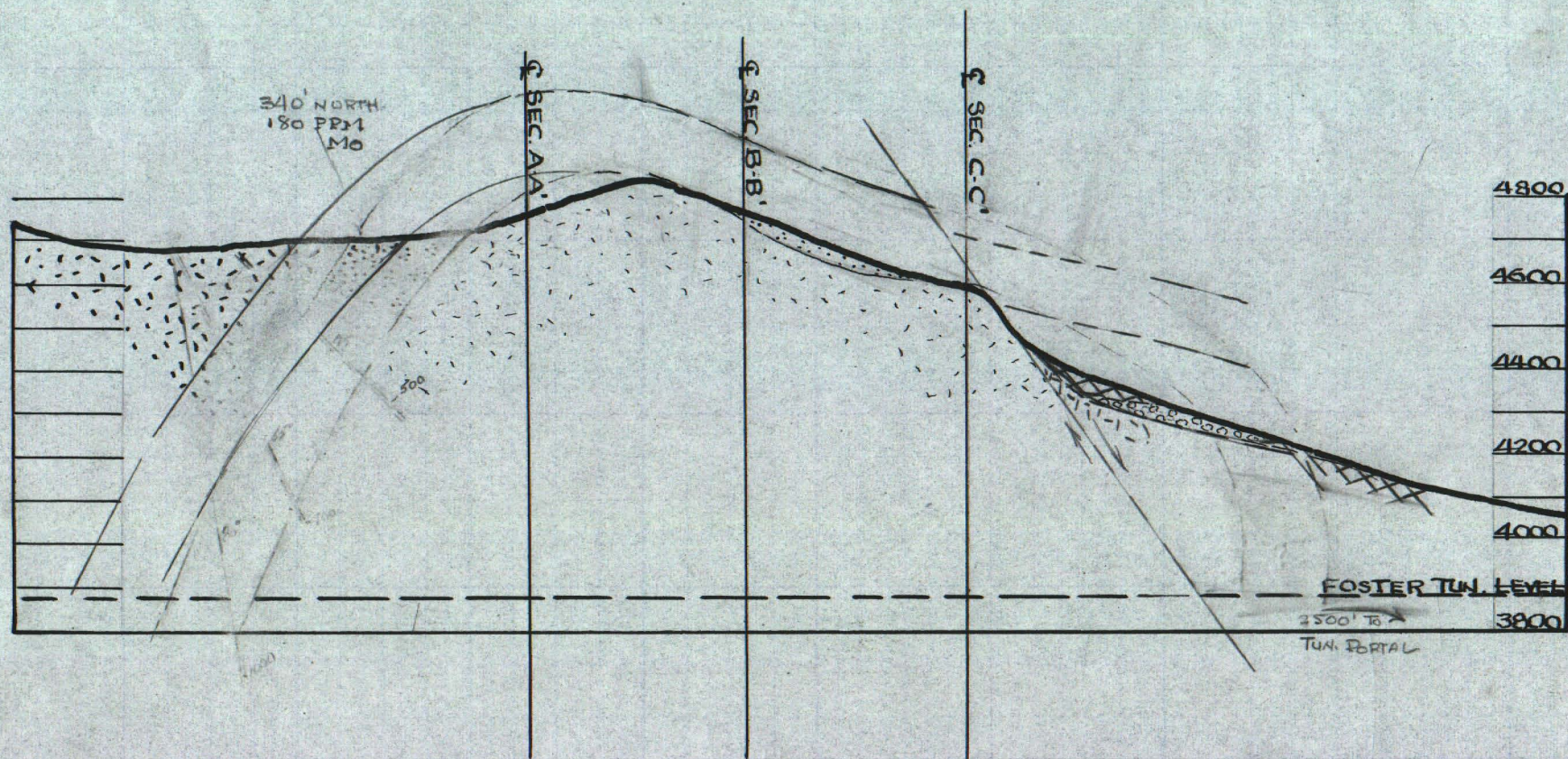

X-X'



