

Carroll E. Baradberry & Associates
ENGINEERS • CONSULTANTS
LOS ALTOS • CALIFORNIA

INCORPORATED

BY: CCM

W.O.:

885.1

MINERAL:

Barite

DATE: 7-28-64

MINERAL DEPOSIT ALONG WESTERN PACIFIC RAILROAD

PORTOLA TO WINNEMUCCA

PROPERTY NAME:

Osgood Mt. Claims

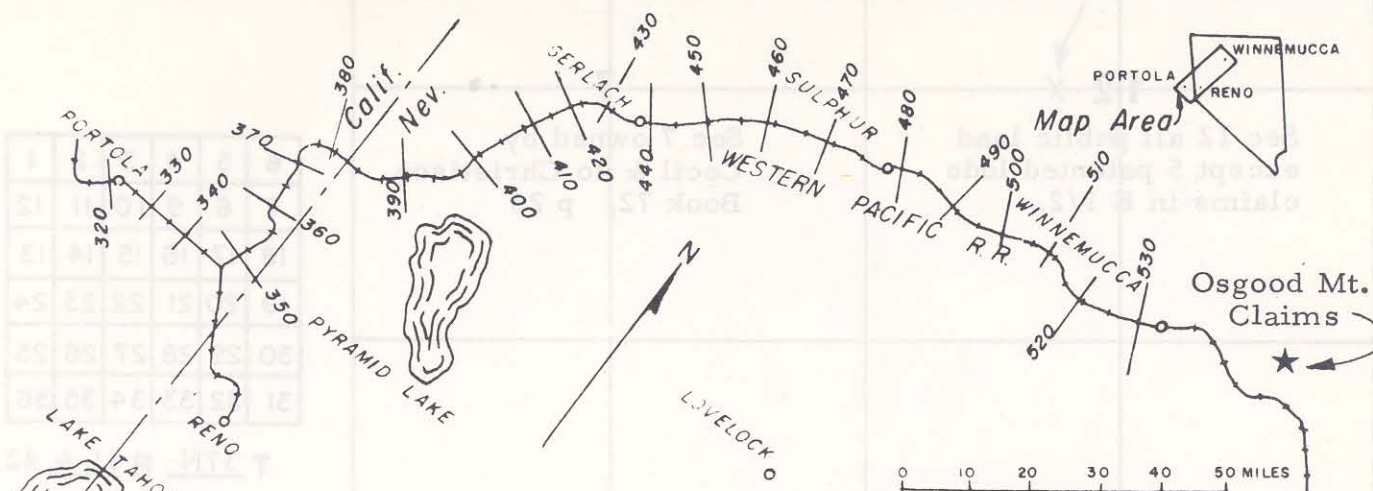
**LOCATION:** Humboldt County, Nevada

____ 1/4 OF ____ 1/4 OF SEC 12 TWP 37N RGE 41E

DISTRICT: Osgood Mt.

MILEPOST: _____

POTENTIAL:☐ LARGE☐ IMMEDIATE☐ MEDIUM☐ NEAR FUTURE☐ SMALL☐ DISTANT FUTURE☒ UNKNOWN

DESCRIPTION: Mineralized Comus (Ordovician) Limestone - a spotty occurrence of barite over 20-acre area in low foothills east side Osgood Mts. The barite is white to slightly bluish gray. Other country rocks in Comus Formation are dolomite, shale, and black shale. Structure is rather contorted. Barite replaces limestone and locally chert.

RESERVES: Appear minor in dozer cuts on small hill where visible - may be large under veneer of alluvium of surrounding pediment where gravels are estimated to be 10 to 25 feet thick.

ACCESS: Good road - 7 miles southeast to Western Pacific Railroad at Red House.

OWNERSHIP: 5 patented claims on hill by Baroid Division of National Lead Co., Box 1675, Houston, Texas. Pat. 1214867, Nov. 29, 1960. Listed value of claims \$2,500.00

SOURCES OF DATA: U. S. Geological Survey Professional Paper 431, p. 96-7 and 122.

ECONOMICS: Barite sells for only \$14-17/ton fob mine. Market rather monopolized by Baroid and Magcobar.

CONCLUSIONS: Gravity, shallow drill holes or shallow seismic survey recommended over surrounding pediment.

THE WESTERN PACIFIC RAILROAD COMPANY

<p>Barite Prospect</p> <p>12 X</p> <p>Sec 12 all public land except 5 patented lode claims in E 1/2.</p>		<p>7</p> <p>Sec 7 owned by Cecil & Jo Christison Book 72, p 23</p>	
<p>13</p> <p>Sec 13 owned by Wm Henry Scott Boox 72 p 254</p>		<p>18</p> <p>Sec 18, vacant land</p>	

6	5	4	3	2	1
7	8	9	10	11	12
18	17	16	15	14	13
19	20	21	22	23	24
30	29	28	27	26	25
31	32	33	34	35	36

T 37N R 41 & 42E

SECTION _____

SCALE: 1" = 1000'
