

3490 0009

Panlico - Hawthorne Dist.

(204)

Item 9

Scheelite is found in a number of small lenses of garnet tectite
and of quartz about 6.5 miles southeast of Hawthorne and 2 miles

625

north of Pamlico, in the Garfield Hills, approximately in sec. 1,
T. 7 N., R. 31 E., Hawthorne quadrangle. Two claims, the Silver Star
No. 1 and No. 2, were located in 1942 by Earl C. and Helen Kaylor,
but appear to be largely within the Hawthorne Naval reservation on
ground withdrawn from entry. The occurrences are at or near the con-
tact between quartz monzonite and marble. The 2 best showings ex-
posed in 1943 were one foot wide and 25 feet long, and contained about
0.5 percent of WO_3 and 2 percent of Cu.

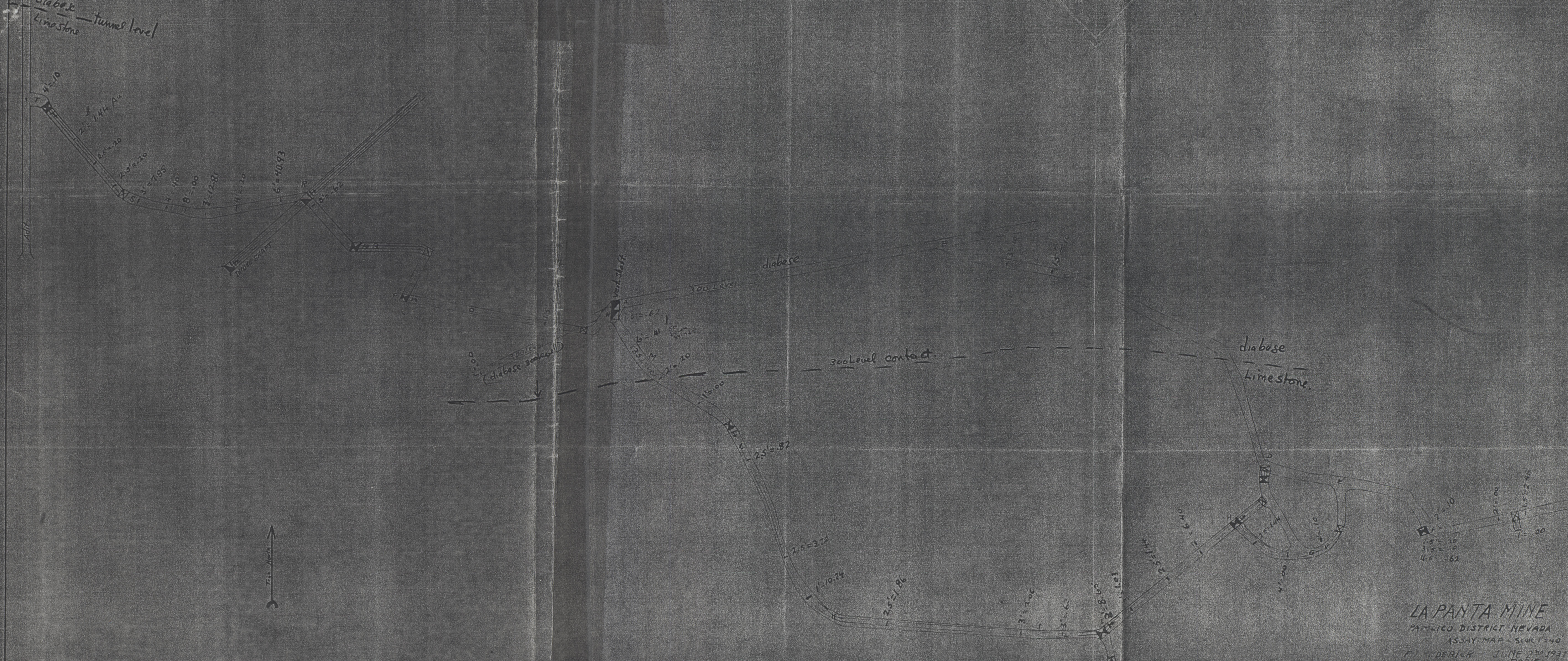

LA PANTA MINE
 PAMUNCO DISTRICT NEVADA
 ASSAY MAP - Scale 1"=40'
 F. J. FREDERICK JUNE 2nd 1937
 BOBIE

204 34910 0009
 Item