

3390 00153

ALPHA BETA

URANIUM PROSPECT

South Searchlight area

Clark County, Nevada

PRELIMINARY ANALYSIS

David LeCount Evans
Consulting Geologist

Reno, Nevada
December 20, 1978

DAVID LeCOUNT EVANS, CONSULTING GEOLOGIST

... ALPHA BETA
URANIUM PROSPECT

South Searchlight Area
Clark County, Nevada

PRELIMINARY ANALYSIS

INTRODUCTION:

The prospect area was partially covered on November 12, 1978. Accompanied by owners Lewis and Dollarhide, and Mrs. Wilma A. Brummett (authorized to sell the property), four hours were spent in and around the locus of mineralization, cutting samples in pit and hurriedly taking radiation readings in the immediate area. Owners, both employed at Kingman's Ford Testing Ground, had the day open but had to return to work by mid-afternoon.

Despite the obvious shortness of examination time and despite our low assay returns, the property, under the terms listed below, merits drilling.

Attached Plates A and B position the property, provide a regional geological picture and show owners' block, bordering a Federal recreation area.

PURPOSES AND PROCEDURES:

Purpose of this analysis, a product of hurried field work, augmented by Nevada Division of Mines and Geology Bulletins, is to support recommendations which are favorable.

Field procedures consisted of an examination of the 12 foot deep pit, the cutting of two samples, vertically through the twelve feet, testing the full section (with encouraging values in the bottom three feet) and to cover as much of the area as time limitations would per-

mit; and, in the office, to develop maps showing the outcrops of the pre Cambrian.

CONCLUSIONS:

1. The property is different with its occurrence of promising uranium values in pre Cambrian gneissic-granites and no indicated structural control.

2. Mineralization is not the secondary carnotite-type of the Plateau, to which one can become accustomed.

3. Cursory examination with scintilometer suggests possibilities for extension.

4. Other radiation in pre Cambrian granite has been described in workings, $3\frac{1}{2}$ miles to the southwest.

5. A very fair agreement being made with lessors, exceptionally easy access and indicated shallow drilling, all, assure a rapid and cheap exploratory program.

RECOMMENDATIONS:

1. The prospect is recommended, as is an exploratory program, to be completed within three months of the signing of a lease and option.

LOCATION:

The property lies in section 31, Township 31 South, Range 65 East, with claims lapping over slightly into adjoining sections 32, 30 and 36, the last in Township 64 East; in Clark County, Nevada.

Claims are 24 miles by road, south of Searchlight, Nevada, and 47 miles west of Kingman, Arizona. A dirt road to property enters Nevada Highway 77 at a point four miles east of U.S. Highway 95 and about 15 miles west of Davis Dam on the Colorado River. With reference to Plat A

the dirt entrance road is straight for about 2.2 miles from highway 77, then makes a right turn, continuing northeast a short distance to a northwest-southeast road and two ruined cabins. At that point, turning southeasterly for $\frac{1}{4}$ mile, obvious will be timbers in a pit on the west, which is the pit or small shaft, containing values at its base. Distance from Kingman is 47 miles.

HISTORY OF PROSPECT AND DISTRICT:

Without any other clues, it is believed that activity on the Alpha Beta block dates back to the Searchlight boom period from 1902 thru 1910. Neighboring properties and prospects in the general area suggesting some activity are:

Jackdaw Group, 8.2 miles north of the center of the Alpha Beta block, which produced \$15,000 from a quartz-silver vein, associated with malachite and azurite, cutting pre-Cambrian granite.

Goldenrod, 7 miles north, which had free gold in a vein 6 to 18 feet wide, in pre Cambrian granite; production of record amounted to \$ 3,500, and total is unknown.

Cottonwood, 3 miles north, and Juniper, 1 mile north were both silver-gold prospects, values in sulphides, in pre Cambrian granite. There was no production.

Wiley-Inspiration, 10 miles east, has a mineralized zone carrying gold and silver. The mine had 500 feet of mine workings and there is no known production.

Homestake Group, 10 miles east, mined gold and silver from three veins in pre Cambrian granite. The main vein had 12 feet of width. Production has been estimated at \$150,000.

Probably of the same period is the Superfluous #1 property, consisting of several pits in pre-Cambrian, 4 miles to the southwest. Bull. 81, (Nev, Mines and Geol) 1973, reports anomalous radioactivity for the prospect, with an high up to 1.8 MR/Hr. A select sample of the epidote-iron oxide contained 0.25% thorium.

PROPERTY:

With reference to Plat A, the property consists of 48 contiguous mining claims, making up a rectangle 6000 feet north and south and 7200 feet east and west.

Claims, by location, consist of Alphas 1 through 40 and Betas 1 through 8. The south line parallels and is 300 feet north of a north line of the Lake Mead National Recreation Area. The writer has neither checked Court House records nor claim corners.

Owners are James E. Lewis, 1913 Arlington, Kingman, Arizona and James C. Dollarhide, 3050 Clack Canyon, Kingman. Telephones are (602) 753-3857 and (602) 753-5449, respectively.

Mrs. Wilma A. Brummett of Kingman has been authorized to sell the property.

Owners have agreed to

- 1- A payment of \$1,000 at time of signing agreement;
 - 2- The next three months without payments to provide a free exploration period;
- followed, if possible, by
- 3- A reasonable "honest" payment and then minimum payments of \$4,800 per month on a total asking price of \$ 480,000.

Mrs. Brummett has been working on a lease arrangement with owners.

GENERAL AND LIMITING CONDITIONS:

Access: Access to property is exceptionally good. Within $2\frac{1}{2}$ miles of pavement, the final approach is over a solid, smooth dirt road.

Terrain: For the western two thirds of the property, slopes

are gentle and relief amounts to only 200 feet. A drill should be able ^{to move} onto locations with no road work and little, if any, "Cat" assistance.

Climate: Yearly precipitation does not exceed five inches. Except for summer flash-floods there are no hazards. Year round operation would be expected.

Deposit: Mineralization in pit area lies beneath 9 feet of valueless cover. The 3 foot zone at bottom of pit may be thicker. The occurrence if it can be extended offers open-pit possibilities.

Power: A high-tension line from Hoover Dam passes within 0.7 miles of the property. Nearest transformer outlet is probably at Searchlight, 21 miles to the north.

Drillers : Drillers and labor are available at Kingman.

Depths: Holes should be shallow, with depths assumed to approach a maximum of 50 feet.

GEOLOGY:

With reference to Flat B, note that the area is characterized by prominent pre-Cambrian metamorphics, emplaced by thrust faulting, and invaded by later Tertiary intrusives. Our map shows only the pre-Cambrian units, with which mineralization appears to be associated.

Gneiss is a metamorphosed end-product, probably of granite; it is coarse grained rock with bands of granular minerals, alternating with bands of schistose minerals. The Gneiss units, shown have been mapped on the bases of granite and gneiss and gneiss and schist, both pre-Cambrian.

Where observed in the bottom of the Alpha pit, material exhibited a porosity of openings between clusters of crystals, openings in fractures and

other interstecies. In openings a dark-brownish-black waxey filling represents the mineralization. An identification has not been made.

SAMPLES:

Two samples were taken by the writer, both in vertical cuts from top to bottom and both at right angles to the earlier samples reported for the pit. Prior to our examination, others had sampled the pit, both taking horizontal cuts across the mineralization in the bottom three feet.

The first, a Mr. Charles W. Begg, a consulting geologist representing E and B Explorations, Ltd., of Toronto, Ontario, Canada. Mr. Begg, sampling the east rib, recovered 0.16% U_3O_8 across ten feet.

The second, Mr. Arthur W. Goring, of Reserve Oil, Inc., reputedly a Shell Oil subsidiary, testing the West rib, reported 0.18% U_3O_8 across ten feet.

Owners report that both were interested, but had "never put up any money".

Personal samples consisted of vertical cuts, from top to bottom, on three foot centers with three cuts to the sample, each representing about 40 pounds before splitting.. Inasmuch as samples included nine feet of pure waste, values cannot be considered a fair test. They do indicate that stripping would be a requirement. The attached assay sheet provides values of only 0.02% and 0.01% for east and west ribs respectively.

Instrument readings throughout the bottom three feet, varying from as low as 0.1% to as high as 0.5% support the writer's belief that an average of 0.17% U_3O_8 is within reason.

EXTENSION POSSIBILITIES

Rapid reconnaissance with scintilometer suggested an anomalous condition for at least 1000 feet from the pit to the west.

1142 Howard Street — San Francisco, California 94103 — Area Code 415 863-8575

REPORT OF ANALYSIS

Submitted by Mr. David LeCount Evans
1700 Royal Drive
Reno, Nevada 89503

Date November 30, 1978

Sample of Mineral

P. O. No.

Lab. No. 0500

SAMPLE MARK

PERCENTAGES

Alpha #1 Shaft

Uranium Oxide

East Side

0.0002

West Side

0.0001

METALLURGICAL LABORATORIES, INC.

By

C. W. Begg spotted other occurrences away from the pit, providing above-ground readings of from 0.05% to 0.12% U_3O_8 . A. W. Goring reported three more "vein" possibilities 40 feet from the pit.

The writer repeats that which was reported. No written records were available.

RECAPITULATION:

This is a preliminary analysis. On the basis of the above, exploration is recommended, consisting of the following steps:

- 1- A drilling program, with drill sites starting at the pit and proceeding westerly, with new locations selected as results determine distribution.
- 2- Results per hole determined by sample studies and hand-probing, to be followed on all tests by gamma-ray Truck logging.
- 3- Core-drilling for every fifth hole, if initial results so warrant.
- 4- Scintrex surface surveys for the entire property, to seek other possibilities and reaching out to adjoining pre-Cambrian units, especially the Superfluous #1 area, $3\frac{1}{2}$ miles to the southwest.
5. The program to start immediately upon completion of agreements, thus taking full advantage of the three free months.

Reno, Nevada

December 20, 1978

Respectfully submitted,



David LeCount Evans
Consulting Geologist

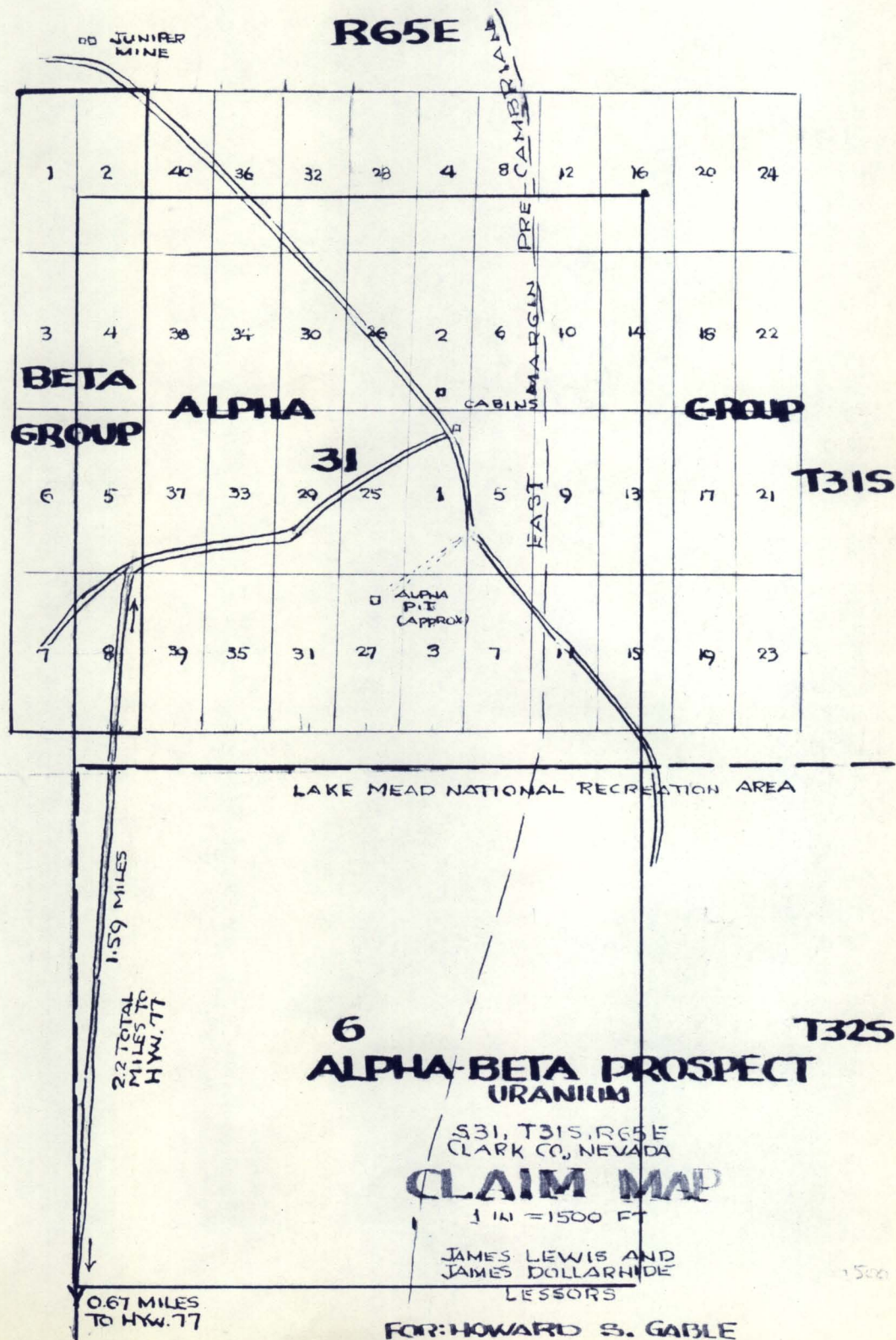

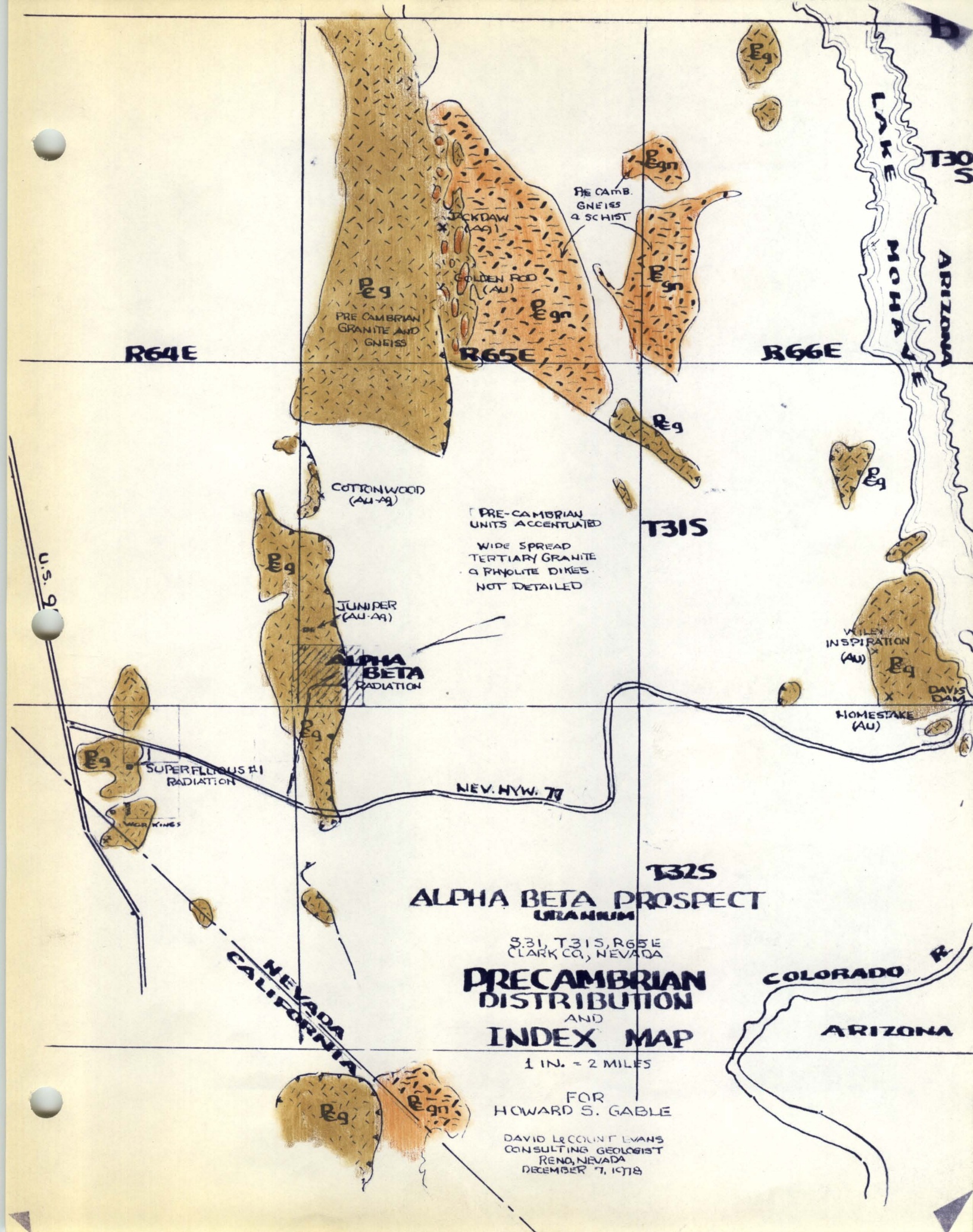

R64E

R65E

R66E

PRE CAMBRIAN
GRANITE AND
GNEISS

PRE CAMB.
GNEISS
& SCHIST

JACKDAW
(AU)

GOLDEN ROD
(AU)

COTTONWOOD
(AU-AG)

JUNIPER
(AU-AG)

ALPHA
BETA
RADIATION

PRE-CAMBRIAN
UNITS ACCENTUATED
WIDE SPREAD
TERTIARY GRANITE
& RHYOLITE DIKES
NOT DETAILED

T31S

WILEY
INSPIRATION
(AU)

HOMESTAKE
(AU)

SUPERFLUOUS #1
RADIATION

NEV. HWY. 79

T32S

ALPHA BETA PROSPECT
URAMU

S.31, T31S, R65E
CLARK CO., NEVADA

PRECAMBRIAN
DISTRIBUTION
AND
INDEX MAP

1 IN. = 2 MILES

FOR
HOWARD S. GABLE

DAVID L. COLIN F. EVANS
CONSULTING GEOLOGIST
RENO, NEVADA
DECEMBER 7, 1978

COLORADO

ARIZONA

NEVADA
CALIFORNIA

FEB. 13 :- 7:40 AM - LARSON
OUT OF TOWN; WILL CALL WHEN
HE GETS BACK - THURS? - 15th

Gene LARSON Geol.

URANCO — (Penn. Power & Light
Co.)

ORANGE - CLIFFS

ALPHA → BETA -

303 - 245 - 6276 - GRANT

Call Early Morning -
— — — — —

602 257 - 1525
Rm 818

Ben — — — — —