

972-4042

Located 9/6/81
by Richard J. Hawley, Sr.
Box 320 Yerington

12 Pearl Street
Yerington, Nevada
89447

Thomas R. Frank & Associates
2190 Carter Drive
Reno, Nevada
89509

Sir:

I, Richard Hanley, the undersigned, hereby guarantee that all the claims comprising the Mantha Lee Group (10 claims) are in proper legal standing.

Further, this letter guarantees that I am the sole legal owner of said claims.

I hereby grant Thomas R. Frank a 60-day exclusive right of first refusal on the Mantha Lee Group. This exclusive expires December 20, 1981.

This agreement cannot be transferred to another party.

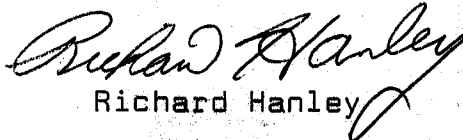
Richard Hanley

TO: **HUNTER MINING LABORATORY, INC.**

994 GLENDALE AVENUE • SPARKS, NEVADA 89431 • TELEPHONE: (702) 358-6227

LABORATORY ORDER

SAMPLES FROM:

<i>Alan A. Morris</i>		Laboratory Number: 01201012091
<i>to Thomas Frank Assoc.</i>		Date Received:
		Customer Order No.:
Attention:	Telephone:	Date Shipped: Via:

SAMPLE MARK	FORM	ANALYZE FOR	SAMPLE MARK	FORM	ANALYZE FOR	SAMPLE MARK	FORM	ANALYZE FOR
<i>Hanley</i>		<i>Assay TRACE FIRE</i>						
<i>1</i>		<i>Cu Pb Zn Ag Au</i>	<i>11</i>		<i>SA #1</i>			
<i>2</i>		<i>Same</i>	<i>12</i>		<i>Ag Au</i>			
<i>3</i>		<i>Same</i>	<i>13</i>		<i>SAME as #1</i>			
<i>4</i>		<i>Au Ag Only</i>						
<i>5</i>		<i>Same</i>						
<i>6</i>		<i>Same as #1</i>						
<i>7</i>		<i>Same as #1</i>						
<i>8</i>		<i>Same as #1</i>						
<i>9</i>								
<i>10</i>								

REMARKS:

Tom Frank will phone analysis requirements

NO. OF SAMPLES:

☒ TRACE

☐ ASSAY

☒ FIRE ASSAY

PULPS: ☐ Discard, ☐ Return.

REJECTS: ☐ Discard, ☐ Return.

PULPS held for 90 days. REJECTS held on request but not over 30 days. Arrangements may be made to store rejects @ \$1.00/cwt/month. Minimum charge for storage will be \$5.00/month.

SUBMITTED BY:

Alan A. Morris

Date:

10/20/81

$$\frac{4}{1}$$

463-3069

very fine grained
siliceous intrusive

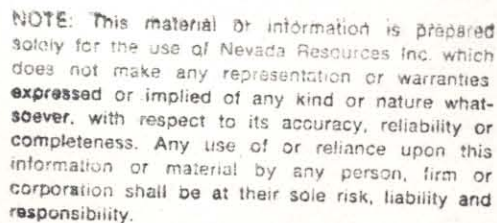

Hanley Property Samples

Hanley Property Samples

- #
- 1 - 3' channel; 400' NE of SW corner Mantha Lee #5 (?);
Cu sulfide in altered granite; little secondary quartz
 - 2 - 6' channel; Mantha Lee #5 (?), taken 40' W. of #1
toward footwall of zone; heavy FeOx, frags of granite
 - 3 - 15' channel @ NW Mantha Lee #3 (?); mid zone
FeOx stained frags of granite; moderate clay alt
 - 4 - "Purple Dump", deep shaft, bleached andesite loaded
with specular hem.; next to #5
 - 5 - ORE DUMP, deep shaft, easternmost of 2 shafts
90% qtz, some high clay alt. granite
 - 6 - 2' wide zone, main pit, west of shafts; all quartz
and sulfide same zone as "half ounce" Conoco material
 - 7 - 3' wide footwall zone next to #6; lace work of fine quartz
enclosing bleached fragments of granite; FeOx slight Cu stain
main pit
 - 8 - } 15' long channel; shattered FeOx granite
footwall of zone slight to moderate clay alt
 - 9 - } South Trench Total Width { 15' " " ; w. patches of heavy clay alt
mid-zone
 - 10 - } 15' " " ; Easternmost 5' intensely silicified
hanging wall of zone
 - 11 - 3' wide quartz/clay alt zone, northernmost ~~pit~~ trench
 - 12 - ~ 2' vein, portal of adit
 - 13 - andesite w. diss. spec. hem.; 200' S. of ramp site #3
Haukeley panned colors from this type

Sketch

Mineralized Zone

Hanley Property

Showing A.A. Morris
Sampling Sites

10/18/81

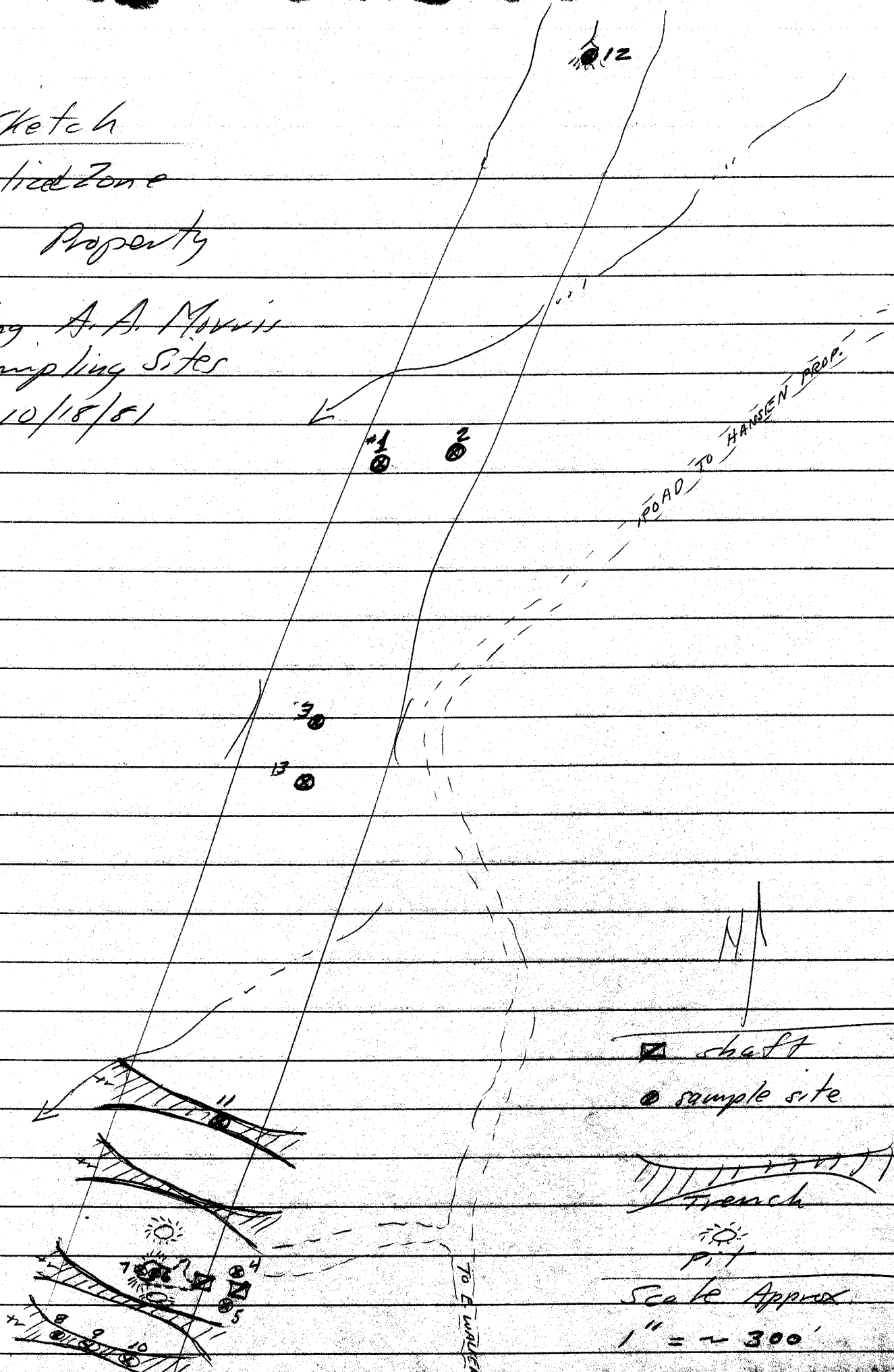

■ shaft
● sample site

||||| trench

☉ pit

Scale Approx
1" = ~ 300'

Location Certificate ---- Lode Claim

The undersigned citizen.... of the United States, hereby declare.... that on the 6TH
day of SEPT, 1981, he... discovered and located a lode bearing gold,
(DATE OF LOCATION)
silver or other valuable deposits and on the same day posted the notice of location at the place
of discovery and named the lode the MANHA LEE NO. 1
(NAME OF CLAIM)

The claim is situated in the MT GRANT
Mining District, Mineral County, Nevada being situated in Section 4
Township 8N Range 28E

The general course of the vein or lode is NORTH
and SOUTH and locator... claim 750 feet in a
NORTHERLY direction and 750 feet in a SOUTHERLY
direction from discovery monument, together with 300 feet on each side of the center of the vein.

The discovery work consists of maps as required in NRS 517.040.

Each of the four corners and the side centers is marked by 4X4 WOODEN
POST & METAL PLATES inscribed with the name of the claim and the name and number
of the corner.

Dated OCT. 19TH 1981

(NAME OF LOCATOR OR LOCATORS BELOW):

Richard J. Harley SR.

(MAILING ADDRESS OF LOCATOR OR LOCATORS BELOW):

P.O. Box 320 JERINGTON, NEV.

Recorder's Stamp

Location Certificate - - - - Lode Claim

The undersigned citizen... of the United States, hereby declare... that on the 6TH
day of SEPT, 1981, he... discovered and located a lode bearing gold,
(DATE OF LOCATION)
silver or other valuable deposits and on the same day posted the notice of location at the place
of discovery and named the lode the MANITA LEE NO. 2
(NAME OF CLAIM)

The claim is situated in the MT. GRANT
Mining District, Mineral County, Nevada being situated in Section 4
Township 8N Range 28E

The general course of the vein or lode is NORTH
and SOUTH and locator... claim 750 feet in a
NORTHERLY direction and 750 feet in a SOUTHERLY
direction from discovery monument, together with 300 feet on each side of the center of the vein.

The discovery work consists of maps as required in NRS 517.040.

Each of the four corners and the side centers is marked by 4X4 WOODEN POST
WITH METAL PLATES inscribed with the name of the claim and the name and number
of the corner.

Dated OCT. 19TH 1981

(NAME OF LOCATOR OR LOCATORS BELOW):

Richard J. Barclay SR.

(MAILING ADDRESS OF LOCATOR OR LOCATORS BELOW):

P.O. Box 320 YERINGTON, NEV.

Recorder's Stamp

Location Certificate ---- Lode Claim

The undersigned citizen.... of the United States, hereby declare.... that on the 6TH
day of SEPT., 1981, he.... discovered and located a lode bearing gold,
(DATE OF LOCATION)
silver or other valuable deposits and on the same day posted the notice of location at the place
of discovery and named the lode the MANHA LEE NO. 2
(NAME OF CLAIM)

The claim is situated in the MT. GRANT
Mining District, Mineral County, Nevada being situated in Section 4
Township 8N Range 28E

The general course of the vein or lode is NORTH
and SOUTH and locator... claim 750 feet in a
NORTHERLY direction and 750 feet in a SOUTHERLY
direction from discovery monument, together with 300 feet on each side of the center of the vein.

The discovery work consists of maps as required in NRS 517.040.

Each of the four corners and the side centers is marked by 4X4 WOODEN POST
WITH METAL PLATES inscribed with the name of the claim and the name and number
of the corner.

Dated OCT. 19TH 1981

(NAME OF LOCATOR OR LOCATORS BELOW):

Richard J. Stanley SR.

(MAILING ADDRESS OF LOCATOR OR LOCATORS BELOW):

P.O. Box 320 YERINGTON, NEV.

Recorder's Stamp

Location Certificate ---- Lode Claim

The undersigned citizen... of the United States, hereby declare... that on the 6TH
day of SEPT, 1981, he... discovered and located a lode bearing gold,
(DATE OF LOCATION)
silver or other valuable deposits and on the same day posted the notice of location at the place
of discovery and named the lode the MANITA LEE NO. 4
(NAME OF CLAIM)

The claim is situated in the MT. GRANT
Mining District, Mineral County, Nevada being situated in Section 4
Township 8N Range 28E

The general course of the vein or lode is NORTH
and SOUTH and locator... claim 750 feet in a
NORTHERLY direction and 750 feet in a SOUTHERLY
direction from discovery monument, together with 300 feet on each side of the center of the vein.

The discovery work consists of maps as required in NRS 517.040.

Each of the four corners and the side centers is marked by 4X4 WOODEN POST
WITH METAL PLATES inscribed with the name of the claim and the name and number
of the corner.

Dated OCT. 19TH 1981

(NAME OF LOCATOR OR LOCATORS BELOW):

Richard J. Hanley SR.

(MAILING ADDRESS OF LOCATOR OR LOCATORS BELOW):

P.O. Box 220 YERINGTON, NEV.

Recorder's Stamp

Location Certificate - - - - Lode Claim

The undersigned citizen... of the United States, hereby declare... that on the 6TH
day of SEPT., 1981, he... discovered and located a lode bearing gold,
(DATE OF LOCATION)
silver or other valuable deposits and on the same day posted the notice of location at the place
of discovery and named the lode the MANTHA LEE NO. 5
(NAME OF CLAIM)

The claim is situated in the MT. GRANT
Mining District, Mineral County, Nevada being situated in Section 4
Township 8 N Range 28 E

The general course of the vein or lode is NORTH
and SOUTH and locator claim 750 feet in a
NORTHERLY direction and 750 feet in a SOUTHERLY
direction from discovery monument, together with 300 feet on each side of the center of the vein.

The discovery work consists of maps as required in NRS 517.040.

Each of the four corners and the side centers is marked by 4x4 WOODEN POST
WITH METAL PLATES inscribed with the name of the claim and the name and number
of the corner.

Dated OCT. 19TH 1981

(NAME OF LOCATOR OR LOCATORS BELOW):

Richard J. Hanley SR.

(MAILING ADDRESS OF LOCATOR OR LOCATORS BELOW):

P.O. BOX 320 YERINGTON, NEV.

Recorder's Stamp

Location Certificate ---- Lode Claim

The undersigned citizen.... of the United States, hereby declare.... that on the 6TH
day of SEPT., 1981, he... discovered and located a lode bearing gold,
(DATE OF LOCATION)
silver or other valuable deposits and on the same day posted the notice of location at the place
of discovery and named the lode the MANITHA LEE NO. 6
(NAME OF CLAIM)

The claim is situated in the MT. PRANT
Mining District, Mineral County, Nevada being situated in Section 4
Township 8 N Range 28 E

The general course of the vein or lode is NORTH
and SOUTH and locator... claim 750 feet in a
NORTHERLY direction and 750 feet in a SOUTHERLY
direction from discovery monument, together with 300 feet on each side of the center of the vein.

The discovery work consists of maps as required in NRS 517.040.

Each of the four corners and the side centers is marked by 4x4 WOODEN POST
WITH METAL PLATES inscribed with the name of the claim and the name and number
of the corner.

Dated OCT. 19TH 1981

(NAME OF LOCATOR OR LOCATORS BELOW):

Richard J. Hanley SR.

(MAILING ADDRESS OF LOCATOR OR LOCATORS BELOW):

P.O. Box 320 YERINGTON, NEV.

Recorder's Stamp

Location Certificate - - - Lode Claim

The undersigned citizen... of the United States, hereby declare... that on the 6TH
day of SEPT, 1981, he... discovered and located a lode bearing gold,
(DATE OF LOCATION)
silver or other valuable deposits and on the same day posted the notice of location at the place
of discovery and named the lode the MANTHA LEE NO. 7
(NAME OF CLAIM)

The claim is situated in the MT. GRANT
Mining District, Mineral County, Nevada being situated in Section 4
Township 8N Range 28E

The general course of the vein or lode is NORTH
and SOUTH and locator... claim 750 feet in a
NORTHERLY direction and 750 feet in a SOUTHERLY
direction from discovery monument, together with 300 feet on each side of the center of the vein.

The discovery work consists of maps as required in NRS 517.040.

Each of the four corners and the side centers is marked by 4X4 WOODEN POST
WITH METAL PLATES inscribed with the name of the claim and the name and number
of the corner.

Dated OCT. 19TH 1981

(NAME OF LOCATOR OR LOCATORS BELOW):

Richard J. Hanley SR.

(MAILING ADDRESS OF LOCATOR OR LOCATORS BELOW):

P.O. BOX 320 VERINGTON, NEV.

Recorder's Stamp

Location Certificate - - - Lode Claim

The undersigned citizen.... of the United States, hereby declare... that on the 6TH
day of SEPT, 1981, he... discovered and located a lode bearing gold,
(DATE OF LOCATION)
silver or other valuable deposits and on the same day posted the notice of location at the place
of discovery and named the lode the MANHA LEE NO. 8
(NAME OF CLAIM)

The claim is situated in the MT. GRANT
Mining District, Mineral County, Nevada being situated in Section 4
Township 8 N Range 28 E

The general course of the vein or lode is NORTH
and SOUTH and locator... claim 750 feet in a
NORTHERLY direction and 750 feet in a SOUTHERLY
direction from discovery monument, together with 300 feet on each side of the center of the vein.

The discovery work consists of maps as required in NRS 517.040.

Each of the four corners and the side centers is marked by 4x4 WOODEN POST
WITH METAL PLATES inscribed with the name of the claim and the name and number
of the corner.

Dated OCT. 19TH 1981

(NAME OF LOCATOR OR LOCATORS BELOW):

Richard J. Stanley SR.

(MAILING ADDRESS OF LOCATOR OR LOCATORS BELOW):

P.O. Box 320 VERMILION, NEV

Recorder's Stamp

Location Certificate - - - - Lode Claim

The undersigned citizen.... of the United States, hereby declare.... that on the 6TH
day of SEPT, 1981, he.... discovered and located a lode bearing gold,
(DATE OF LOCATION)
silver or other valuable deposits and on the same day posted the notice of location at the place
of discovery and named the lode the MANITA LEE NO. 9
(NAME OF CLAIM)

The claim is situated in the MT. GRANT
Mining District, Mineral County, Nevada being situated in Section 4
Township 8N Range 28E

The general course of the vein or lode is NORTH
and SOUTH and locator... claim 750 feet in a
NORTHERLY direction and 750 feet in a SOUTHERLY
direction from discovery monument, together with 300 feet on each side of the center of the vein.

The discovery work consists of maps as required in NRS 517.040.

Each of the four corners and the side centers is marked by 4x4 WOODEN POST
WITH METAL PLATES inscribed with the name of the claim and the name and number
of the corner.

Dated OCT. 19TH 1981

(NAME OF LOCATOR OR LOCATORS BELOW):

Richard J. Stanley SR.

(MAILING ADDRESS OF LOCATOR OR LOCATORS BELOW):

P.O. Box 320 HERINGTON, NEV.

Recorder's Stamp

Location Certificate - - - - Lode Claim

The undersigned citizen.... of the United States, hereby declare.... that on the 6TH
day of SEPT, 1981, he... discovered and located a lode bearing gold,
(DATE OF LOCATION)
silver or other valuable deposits and on the same day posted the notice of location at the place
of discovery and named the lode the MANTHA LEE NO. 10
(NAME OF CLAIM)

The claim is situated in the MT. GRANT
Mining District, Mineral County, Nevada being situated in Section 4
Township 8N Range 28E

The general course of the vein or lode is NORTH
and SOUTH and locator... claim 750 feet in a
NORTHERLY direction and 750 feet in a SOUTHERLY
direction from discovery monument, together with 300 feet on each side of the center of the vein.

The discovery work consists of maps as required in NRS 517.040.

Each of the four corners and the side centers is marked by 4x4 WOODEN POST
WITH METAL PLATES inscribed with the name of the claim and the name and number
of the corner.

Dated OCT. 19TH 1981

(NAME OF LOCATOR OR LOCATORS BELOW):

Richard J. Hanley SR.

(MAILING ADDRESS OF LOCATOR OR LOCATORS BELOW):

P.O. BOX 320 YERINGTON, NEV

Recorder's Stamp