

2960 0004

240

Item 4

TONOPAH MINING CO. OF NEVADA	
MINING AND EXPLORATION DEPARTMENTS	
REC'D OCT 25 1913	
SEEN	
ANS'D	

R e p o r t

o n

THE BLAKER - SLOANE PROPERTY

Manhattan - Nye County,

N e v a d a

Examination: 10/17/13.
Report: 10/20/13.
By: W.H. Sirdevan.

R e p o r t

o n

THE BLAKER - SLOANE PROPERTY

The Blaker - Sloane property comprises four claims located about two miles south from Manhattan, Nye County, Nevada.

The ore is a lime - schist breccia cemented by calcite and quartz. The cementing material probably carries the metals. The chief value is in silver instead of gold as was represented. There are prominent outcrops of granite and quartzite on the property.

An assay plan of the workings is given on the accompanying plate. There is not sufficient work to define the limits of this brecciated zone - which appears to be an irregular zone of no great extent.

There is no water within a mile of the property. The ore is too low-grade to bear the cost of hauling so that a mill must be built at the property. The ore must be treated by cyanidation to recover the silver? The total cost of mining and milling under similar conditions at Manhattan is stated as \$3.50 per ton by Mr. Mushett - the man who brought this property to our attention, and who is now operating the Big Pine mine at Manhattan.

The terms for the property are as follows:

\$2000 cash and \$37,000 at the end of one year.

10% royalty on all ore shipped until total price is paid.

Conclusions

Sampling results indicate that the ore is too low-grade to work - even with the very low working cost given by Mr. Mushett.

This property was brought to the attention of the Tonopah Mining Company by L.L. Mushett of Manhattan, in a letter to Mr. Charles dated 10/12/13. It was claimed that the ore would mill \$6 per ton and give 90% extraction by amalgamation.

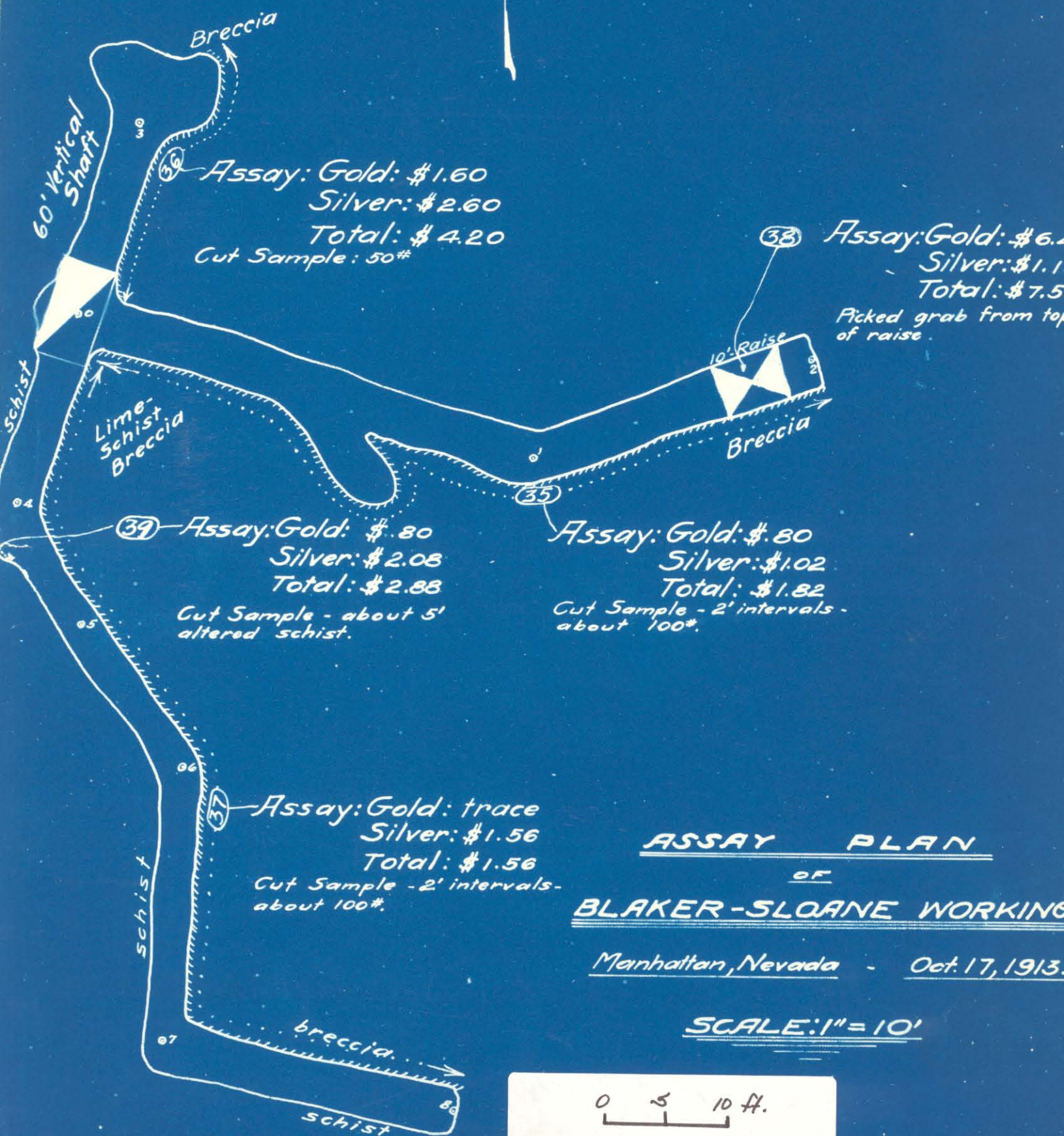

240

Item 4