

REMO OFFICE
RECONSTRUCTION FINANCE CORPORATION
FIELD REPORT

278

Item 11

Docket No. ND-5796

Date Application Received
Date of Examination
Date of Report

September 17, 1943
October 16-17, 1943
October 29, 1943

NAME AND ADDRESS OF APPLICANT

Fred Lentz
Valmy, Nevada

Correspondent

Same.

LOCATION OF MINE

The mine is situated on the lower eastern slopes of the Sonoma Range in Esmeralda County, Nevada. It is about 25 miles south of Valmy, a small station on the Southern Pacific Railroad. It is proposed to mine ore containing silver, lead and copper.

Valmy Mine

The mine is reached from Valmy via a dirt road, 15 miles of which is in very poor condition, and would have to be repaired and partly reconstructed before much heavy hauling could be done.

TITLE

Applicant's tenure is by virtue of a 10-year lease with option to buy. Royalty is fixed at 10 per cent net.

CHARACTER OF APPLICANT

The Applicant is 45 or 50 years old, an experienced miner of good character and standing. His mining experience, however, has been confined to gold mining in Arizona.

HISTORY OF MINE

Sporadic attempts have been made to mine lead-silver ore through shallow workings for many years past, and a small tonnage was produced. More recently a fairly well financed organization drove a long tunnel, 1800 ft., which cut 5 veins. Considerable work was done on one of these, and probably 500 tons of ore shipped. Drifting on the others for various distances did not produce any encouraging results. The ore was all oxidized lead-silver, with traces of copper and zinc.

The Applicant proposes to mine the remnants of these ore bodies, and sink a winze to deeper levels, with appropriate drifts, etc., in the expectation of finding more ore at depth.

LOAN REQUESTED

\$30,000.00.

LOAN RECOMMENDED

None.

DESCRIPTION OF MINE

The country rock in this area comprises a series of sedimentary rocks, consisting of limestone, slate, shale, quartzite and

conglomerate. These are east dipping at various angles between a number of west dipping faults and porphyry dikes. The veins are more or less associated with the dikes and all have a northerly strike. The long tunnel cross cuts all the formations. The main vein in the vicinity of the adit dips from 60 to 70° west.

The main vein was penetrated at about 900 feet from the portal. Nearly all the ore found was north of the adit. The vein splits in that area, and the various branches contained more or less ore, judging by the stopes noted. In this area the Applicant expects to glean an appreciable tonnage of "mill ore", but no claim is made for the presence of ore of shipping grade.

A drift was run south along the vein for about 200 feet, and produced one small stope. The vein is well defined but blank, except for a few short lenses, which were sampled and results shown on the attached assay certificates. At the end of this drift a north-west striking post-mineral fault was encountered, but not followed. This fault was cut also in the main adit, and a short cross-cut from it, as shown on the accompanying map.

Samples were taken at points where small lenses or bunches of ore were exposed in the south drift. This covers the area that the Applicant reports contains an ore body 150 ft. long, ranging from 6 inches to 6 feet in width, that will average 9% Zn, 9% Pb, and 10 oz. Ag.

North of the adit a winze was sunk on the vein 125 feet deep. Its timbers are rotted and it is full of gas below about 50 feet from the level. The Applicant believes the drift south from the bottom of this winze contains good ore. However, there is no positive information concerning it.

The Applicant is attempting, working alone, to "de-gas" the winze by blowing it out with compressed air. He has installed a small compressor in a drift from the main adit about 350 feet back toward the portal. It is gasoline powered, and the exhaust fumes are supposed to drift out to the portal when the wind is in the right direction. The writer strongly advised against this operation.

Results of samples taken are as follows:

- No. 207 - 6 feet across fault vein at end of south drift -
4 cuts - fragments, clayey, iron stained.
Au Trace; Ag 0.3 oz.; Pb 0.1%; Zn None.
- No. 208 - 4 cuts across lens 8 feet long averaging .8 feet wide,
30 feet back of face - south drift.
Au Trace; Ag 5.2 oz.; Pb 6.4%; Zn 3.6%.
- No. 209 - South drift - lens 10 feet long - 3 cuts, averaging
1 foot wide - 55 feet from adit.
Au Trace; Ag 12.8 oz.; Pb 5.6%; Zn 2.6%.
- No. 210 - In pocket below drift - 3 ft. cut, 25 ft. south of
adit.
Au Trace; Ag 3.8 oz.; Pb 1.4%; Zn 0.3%.
- No. 211 - Raise - north side adit. Bunches 6 inches to 8
inches wide, 2 feet long.
Au Trace; Ag 9.0 oz.; Pb 7.4%; Zn 1.0%.

Other assays show traces of copper up to as high as 0.2%.

RECOMMENDATION

No loan is recommended as there is obviously no ore in quantity or of sufficient value to justify the expenditure of any sum.

Carl Stoddard

CARL STODDARD
Supervising Engineer

No	Width ft	oz Au	oz Ag	% Pb	% Zn	Remarks
207	6.0	Tr	0.8	0.1	0	South Drift
208	0.8	Tr	5.2	6.4	3.6	"
209	1.0	Tr	12.8	5.6	2.6	"
210	3.0	Tr	3.8	1.4	0.3	"
211	0.6	Tr	9.0	7.4	1.0	Raise.

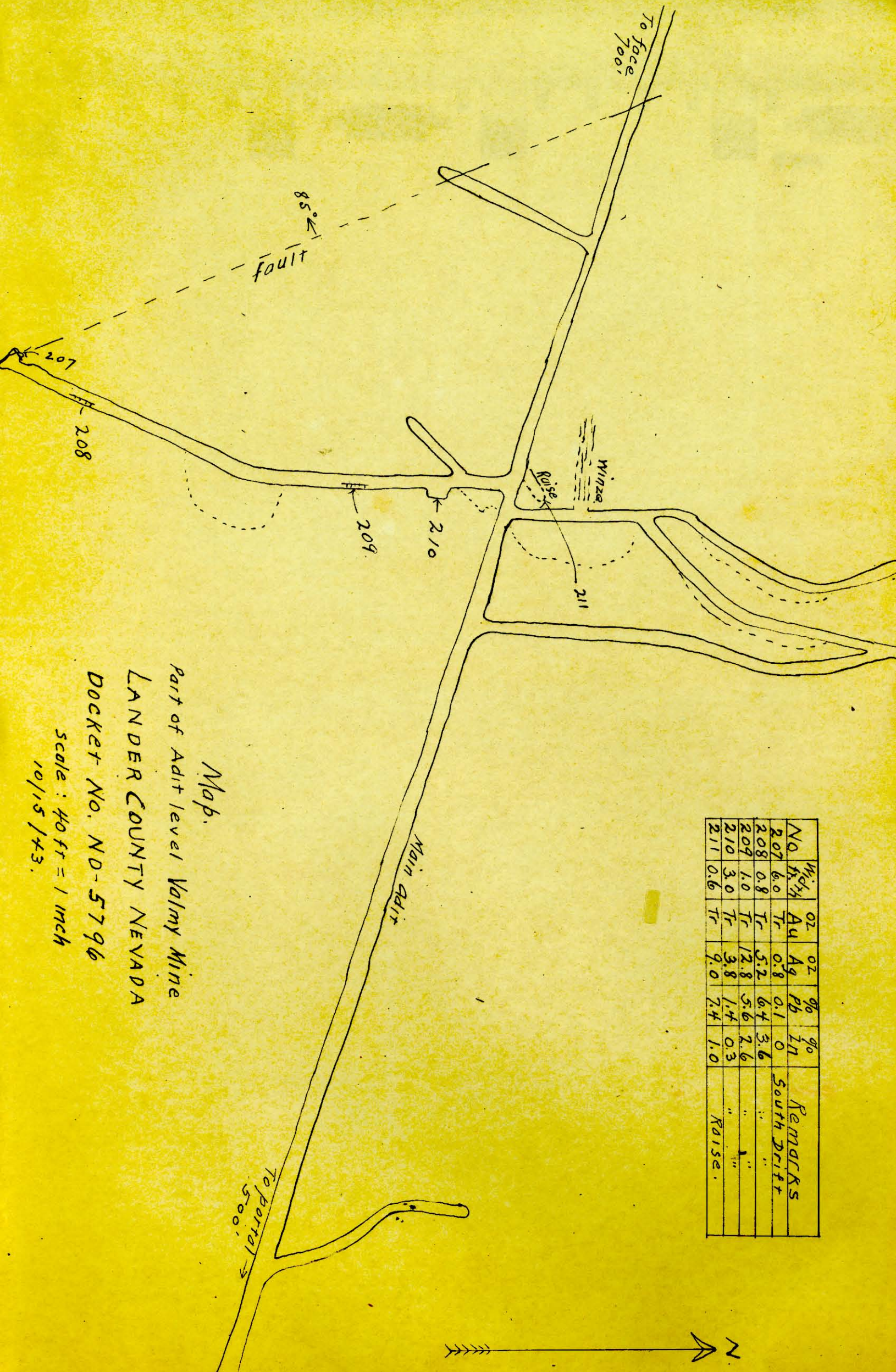

Map.

Part of Adit level Valmy Mine

LANDER COUNTY NEVADA

DOCKET NO. ND-5796

Scale: 40 ft = 1 inch

10/15/43.