

2190 0076

**TIFFIN GROUP AND
SINGER OR CARBONATE CLAIM.**

GOOD SPRINGS, NEVADA.

DATE **August 30th, 1911.**

INFORMATION SHEET FROM W. G. SWART, DENVER.

SHEET NO.

100.

Tiffin Group is owned by C. A. Beck, Good Springs, Nevada.

**Singer or Carbonate Claim is owned by Judge Erskine Ross,
Los Angeles, Calif. His attorney, who handles such matters is
Mr. I. H. Polk, Los Angeles.**

Visited this property July 2nd, 1911, with C. A. Beck.

About four miles from Sandy, Nevada.

Sketch Plan of Claims.

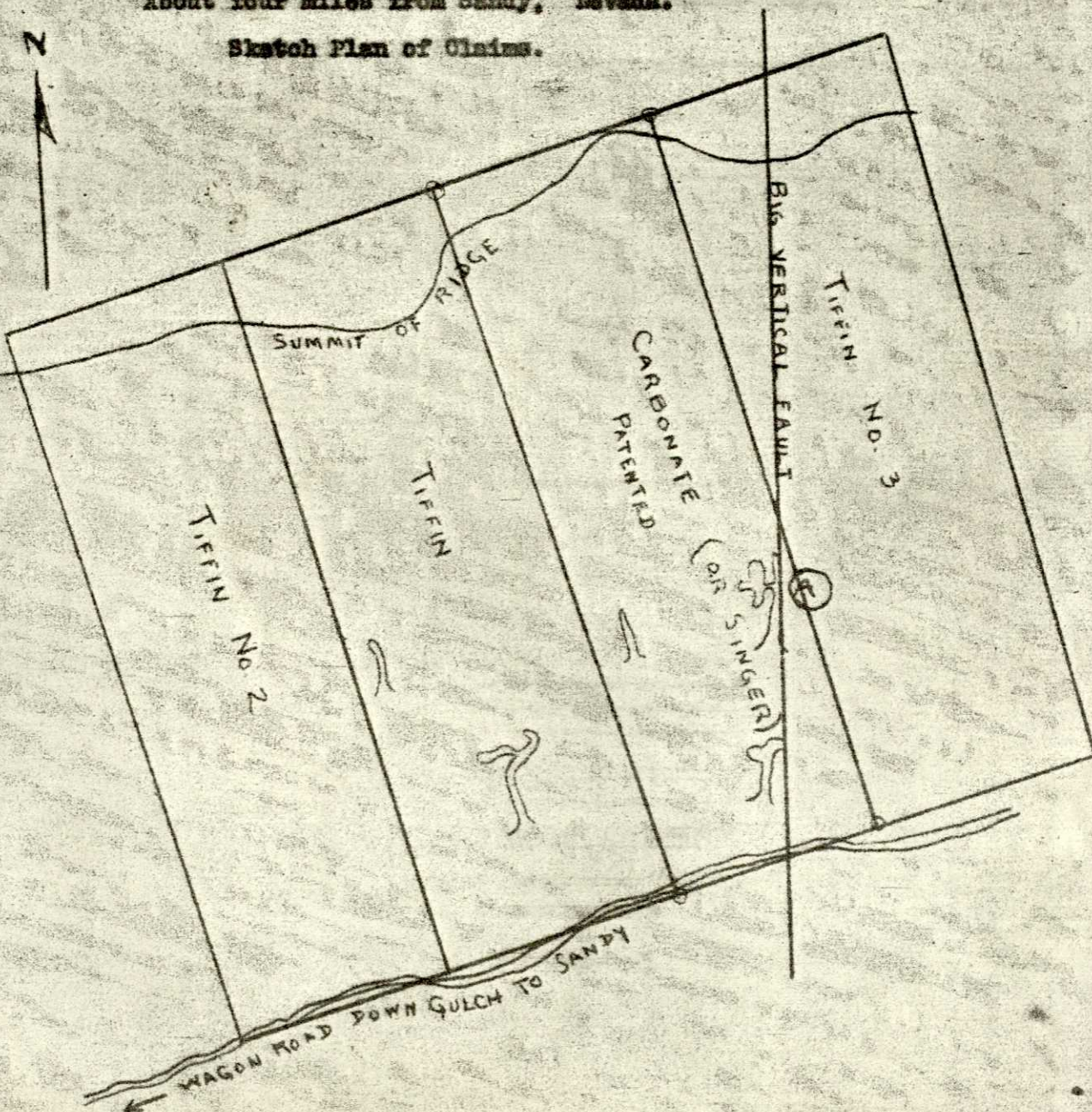

August 30th, 1911.

198.

DATE

INFORMATION SHEET FROM W. G. SWART, DENVER

SHEET NO

This is a limestone group, much like most others in the Good Springs district, with lead, zinc and copper carbonates occurring in the bedding planes and along the faults.

The claim marked "Carbonate" is patented and is also known locally as the "Singer". I do not know which is correct. Considerable shallow work has been done, especially along the big fault, which exposes as pretty and promising a body of lead ore as I saw anywhere in the district. Mr. Beck was with me—a rather shrewd German prospector—and I did not dare show the least interest in the property; but it is a property that ought to be opened up especially as it can be done cheaply.

The situation is this:

SKETCH OF WORKINGS
AT (A) LOOKING NORTH.
NOT TO SCALE

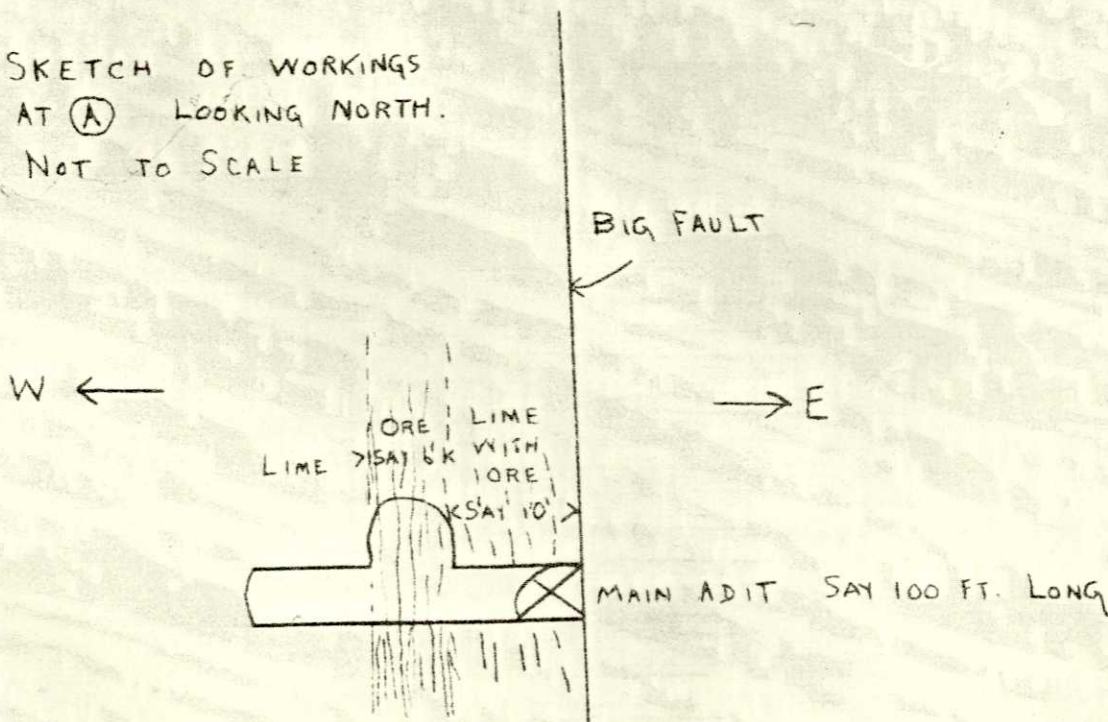

August 30th, 1911.

The fault is as straight and regular as a cement wall.

East of the fault the country seems to be a solid lime. West of the fault the lime is broken and shows considerable scattered ore. (Carbonates). About 10 feet West of the fault is what is apparently a parallel fracture, five to six feet wide, filled with lead carbonate and sulphide which has every appearance of being shipping ore as it stands. Not enough work has been done on this to prove its continuity and value, but development work would be all in ore, which improved transportation would make tributary to the Needles Smelter. The ground is soft and progress would be rapid.

The greater part of the surface of this claim and of the Tiffin claim which lies next West, is covered with ore showings and croppings, much more prominent than it usual in the Good Springs district.

It was my intention to go back to this property alone, look it over more carefully and take samples, but the opportunity did not come. If possible I will have Mr. Disbrow do this while he is in that section. A second look at it might not give so good an impression, and samples may show it to be unattractive.

These claims can undoubtedly be had on a very favorable basis.

W. G. Swart.