

J. H. WREN & CO.

CONSULTING MINING ENGINEERS

CABLE ADDRESS
WRENCO

PHONE GLADSTONE 6-0922
4297 D STREET
SACRAMENTO, CALIF.

James H. Wren
Mining Engineer

604 S. WELLS AVE., APT. 4
RENO, NEVADA PH. 322-4840

November 1, 1964

PINENUT KING MINE PRELIMINARY REPORT

TO:

Western Metal Producers Corp.,

FROM:

J. H. Wren & Company

SUBJECT:

PRELIMINARY REPORT PINENUT KING MINE

Gentlemen:

The following outline covers observations made on the Pinenut King Silver Mining property during the past two months. The writer is very familiar with the district having been on the Supervisory Staff of the Stone Cabin Consolidated Mines Company in 1935, where a 400 ton cyanide mill was treating silver bearing ore, about two miles from the Pinenut King property. In 1936 he was on the supervisory staff at the Como Mine, two miles Northerly from the Pinenut King Mine, where a 350 ton silver mill was treating ore from three ore body systems. In 1963 the writer did extensive economic survey work at the Como Mine, rehabilitated the portal area of their one mile long haulage adit and generally set engineering up to capitalize upon the property's developed silver reserves which were left intact when operations were suspended during a falling market in late 1936. The Como Mine principals were not able in 1963 to complete a \$250,000 underground rehabilitation program.

1. LOCATION:

The Pinenut King Mine is located 14 miles Southeasterly from Dayton, Nevada. It lies in Sections 24 and 25 of Township 15 North, Range 22 East, M. D. B. & M., in Lyon County, Nevada.

PINENUT KING MINE PRELIMINARY REPORT OF NOV. 1, 1964:

1. LOCATION , CONTINUATION:

Water for camp use and drilling is available at three spring areas on the property. It appears as though water for milling purposes can be developed.

Como Mines, Stone Cabin Mines and other mining projects, all with treatment plants in the district worked a full 12 months year without snow and freezing conditions in winter forcing operational suspension.

2. HISTORY:

The Como Mining District has produced silver bearings ores for over 100 years. The County Seat of Lyon County at one time was the old town of Como, two miles from the Pinenut King Mine.

Production history of the Como Mining District runs into multi-million dollars. The Pinenut King adjoins production properties where sufficient exploration-development produced project income for a long period of time. There were at least four large mills within a radius of four miles from this property.

Workings at the Pinenut King Mine, recently reopened, were estimated to have been driven in the 1870's and 1880's in view of the fact that they were run by hand drilling and use of black powder. These workings are in good standing condition. Portals of the x-cuts and drifts were caved only. After handling the caved areas, the workings were all open. See the photo section herewith.

Primitive metallurgy during the 1870's and 1880's and the problem of gaining depth below the leached zones probably was responsible for lack of mineral depletion on the holdings. In view of the workings extent, it is possible that some minor high grade ore which had resisted complete leaching had been shipped to the early Dayton, Nevada mills by wagon. No records of the pre-1900 work exist.

3. OWNERSHIP:

The Pinenut King Lode Claim group is owned by F. H. Webb, 140 Wilson Avenue, Reno, Nevada. It consists of ten full lode claims.

PINENUT KING MINE PRELIMINARY REPORT OF NOV. 1, 1964:

3. OWNERSHIP, CONTINUATION

W. N. Brown, of Hanford, California, James H. Wren, of Reno, Nevada, Bryan Cochran, of Hanford, California, and John E. Smith, of Hanford, California leased the property with option to purchase, on October 9, 1964. Terms of the lease with option to purchase, are:

- A). Life of lease-option is seven years.
- B). Royalty is 10% of the net-to-the-mine or mill ore or concentrate shipment returns.
- C). Royalty is applicable against a \$50,000 purchase price. F. H. Webb has indicated willingness to accept a block of Western Metal Producers Corp. Shares for delivery of property ownership title free and clear.
- D). The lease-option agreement ownership percentage is:

Brown-Wren	80%
Cochran	10%
Smith	10%
	<hr/>
	100%

Brown-Wren are turning the Pinenut King percentage of the lease-option into Western Metal Producers Corp., for that organization's shares. The other two lease percentage owners may accompany Brown-Wren in the negotiation.

4. GEOLOGY:

The rocks of the Como Mining District generally are tertiary volcanics several thousand feet thick, principally andesite.

Quartz veins traverse the area striking Northeasterly-Southwesterly with varying dips. Gold, silver and small amounts of copper occur in the quartz gangue. The quartz veins with their large outcroppings were discovered in the early 1860's and pioneering of the prospects

PINENUT KING MINE PRELIMINARY REPORT OF NOV. 1, 1964:

4. GEOLOGY:

was chiefly expedited in view of their resemblance to the Comstock Lode and created a "boom" in the district. It was soon found that the veins were highly leached and depth was needed to prove economic grade ore, as well as the fact that depth soon runs into sulphide ore which was difficult for the original operators to handle metallurgically.

Detailed geologic mapping of the Pinenut King Mine has not yet been accomplished. It will be covered in a subsequent supplement to this report. However, the writer's scrutiny and the Nevada Mining Analytical Laboratory, University of Nevada has made a preliminary study of the rock characters on the claim group. We found in general that the rocks on the claims are highly altered and particularly so contacting or near probable ore zones. Country rock associated with the veins were found to be: Brecciated silicified volcanics, andesite porphyry, altered and bleached, seritized volcanic rock originally an andesite, pyritized andesite showing alteration along joints some distance from vein zones, and dacite porphyry along with veins, veinlets and silicious quartz lenses, all highly impregnated with iron oxides as iron gossan remaining in the highly leached top of the veins and croppings.

PINENUT KING MINE PRELIMINARY REPORT OF NOV. 1, 1964 :

4. GEOLOGY, CONTINUATION :

Do NOT write on this page. For Laboratory use only.

Report No. 00368

Date: October 28, 1964

Sample Number	SAMPLE DESCRIPTION	XXXXXXXXXX XXXXXXXXXX XXXXXXXXXX
		LOCATION TAKEN
261.	Bleached (sericitized) andesite? Thoroughly soaked with yellowish and reddish brown iron oxides. Some leached quartz vein matter.	SW WALL CONTACTING VEIN ON #6 & #7 CLAIMS #261
265.	Pyritized andesite with bleached margins up to 1/2". These bands suggest alteration along joints at some distance from vein zones.	#1 CLAIM, STONE SPRING ROCK AT BOTTOM OF SPRING #26.
271.	Partly bleached andesite cut by thin quartz veinlets with yellow and brown iron oxide on joints and as staining.	LEACHED LEDGE MATTE IN PROSPECT HOLE 400' SW OF #9 DRIFT PORTAL ON #3 CLAIM #271.
	These are megascopic not petrographic identifications. Most samples are too altered to permit specific rock names.	#5 TUNNEL PORTAL ROCK. #251
251.	Bleached, sericitized volcanic rock (probably originally an andesite due to lack of free quartz). Shattered and stained irregularly with goethite and jarosite. Some veins of halloysite.	#5 CLAIM FLOAT AND IN PLACE ROCK #252
252.	Vesicular, somewhat altered rhyo-dacite.	#8 CLAIM C. ROCK. #253
253.	Brecciated silicified rock (vein zone ?) thoroughly impregnated with yellow-brown and red-brown iron oxides (goethite).	
254.	Silicified bleached, somewhat shattered andesite (?) irregularly stained with brown iron oxides.	#8 CLAIM ROCK FLOAT AND IN-PLACE #254
255.	Same as 254 but only slight silicification.	#1 CLAIM C. ROCK #255
256.	Brecciated silicified volcanic (?) rock veined with vuggy glassy quartz, and strongly stained with yellow brown and brown iron oxides.	#1 DUMP, #256
257.	Same as #254 but more iron oxides and vuggy glassy vein quartz.	#3 & #4 CLAIMS! LEACHED LEDGE MATTE #257
258.	Fresh andesite porphyry with some vesicules filled with glassy vuggy quartz. If the quartz appeared evenly distributed and less like a filling, this would be a dacite porphyry.	WALL N-WESTERN OF #3 & #4 CLAIMS #258

P. A. Weyler

P. A. Weyler

Nevada Mining Analytical Laboratory

PINENUT KING MINE PRELIMINARY REPORT OF NOV. 1, 1964 :

5. DEVELOPMENT :

A NEW ROAD HAS BEEN MADE 1-1/2 MILE FROM THE COUNTY ROAD TO THE NO. 1 CLAIM DUMP. IT WAS ALSO CONNECTED WITH THE CLAIMS NO. 3 AND NO. 4 DUMPS. TRACTOR AND JEEP TRAILS WERE MADE DURING OCTOBER 1964 TO THE DUMPS ON CLAIMS, NO. 6, 7, 8, 9, AND 10 .

TWO HIGH TENSION ELECTRICAL LINES ARE 1/2 MILE FROM THE CENTER OF CLAIM NO. 5. THESE LINES SERVICE YERINGTON, NEVADA AND ANACONDA COPPER COMPANY'S 10,000 TONS PER DAY OPERATION AT WEED HEIGHTS, NEAR YERINGTON.

THE NEVADA PLANNING BOARD IS CONSIDERING A NEW OILED ROAD WITHIN 3/4 MILE OF THE PROPERTY. THE OBJECT OF THIS ROAD IS TO CUT 25 MILES OFF OF THE CARSON CITY TO YERINGTON AND POINTS SOUTH PRESENT HIGHWAY LINE.

THERE ARE SEVERAL HUNDRED FEET OF DRIFTING ON THE PROPERTY, DRIVEN IN THE 1870S. ALL UNDERGROUND WORKINGS WERE CLOSED UNTIL SEPTEMBER AND OCTOBER OF 1964. THEY WERE OPENED WITH USE OF A FRONT END LOADER. AFTER THE RECOVERY OF DRIFT AND X-CUT PORTALS, WORKINGS WERE FOUND TO BE IN GOOD STANDING CONDITION.

CUTS AND PITS WERE OPENED IN OCTOBER 1964 ON : CLAIMS NOS. 1, 2, 3, 4, 5, 6, 7, 8, 9, AND 10. THERE ABOUT TEN PITS AND CUTS ON VARIOUS VEINS WHICH WERE NOT OPENED.

STONE SPRING , SHOWN ON THE COMO QUADRANGLE OF A U. S. G. S. TOPOGRAPHICAL SHEET, WAS OPENED IN OCTOBER 1964 AND RUNNING WATER DEVELOPED. TWO NEW SPRINGS WERE FOUND AND OPENED ON THE NORTHERLY END OF PINENUT CLAIM NO. 3, NEAR THE SOUTHERLY ENDLINE OF PINENUT KING CLAIM NO. 9. RUNNING WATER WAS DEVELOPED AT EACH SPRING. IN VIEW OF THE MONTH OF OCTOBER BEING A LOW WATER MONTH, ALL YEAR WATER SUPPLY IS ASSURED AT EACH OF THESE THREE SPRINGS FOR CAMP AND MINE SERVICE. YEAR AROUND WATER AVAILABILITY IN THIS AREA IS VALUABLE TO ANY OPERATION.

NEW BOUNDARY MARKERS WERE SET UP AFTER PLOTTING TO ESTABLISH ORIENTATION OF PROPERTY LINES BETWEEN THIS GROUP AND GROUND OWNED BY THE COMO CONSOLIDATED MINING COMPANY.

SAMPLING AND ROCK CLASSIFICATION WAS DONE IN AREAS OF THE NEWLY OPENED WORKINGS. THE LABORATORY OF THE UNIVERSITY OF NEVADA DID THE ROCK CHARACTER STUDY.

QUANTITATIVE GOLD-SILVER SAMPLES TAKEN OUT OF REOPENED WORKINGS WERE RUN AT , MINERALS SERVICES, INC., SALT LAKE CITY, UTAH.

PINENUT KING MINE PRELIMINARY REPORT OF NOV. 1, 1964 :

6. MINERAL OCCURRENCE :

SURFACE AND NEAR SURFACE ORES IN THE DISTRICT CONTAIN THE SILVER AS A CHLORIDE. ADJOINING PROPERTIES THAT HAVE BEEN MINED TO OVER SIX HUNDRED FEET IN DEPTH SHOW THAT AT FAIRLY SHALLOW DEPTH IN SOME ZONES, SILVER OCCURS IN TETRAHEDRITE.

THE PINENUT KING MINE'S VEIN SYSTEM IS SIMILAR TO THAT OF THE COMO MINE. THEY BOTH HAVE THE SAME COUNTRY ROCK, EXCEPTING THAT THE PINENUT KING MINE'S ANDESITE, ANDESITE PORPHYRY AND DACITE PORPHYRY NEAR THE VEINS IS CONSIDERABLY MORE ALTERED AND MINERALIZED.

THE COMO MINE IS IN AN AREA OF FASTER EROSION THAN THE VEIN SYSTEM ON THE PINENUT KING MINE. THEREFORE IN THE CASE OF COMO PART OF THE SECONDARY ORES WERE ERODED AWAY AND ECONOMIC MINERALS WERE EXPOSED IN THE CROPPINGS. THE OXIDE ORES IN THE COMO RAPIDAN, COMO AND BUCKEYE VEINS CARRIED FREE GOLD AND SILVER AMENDABLE TO CYANIDATION TO A DEPTH OF ABOUT 300 FEET WHERE SULPHIDE WAS COMBINED WITH THE OXIDE MINERALS. ON THE 500 FOOT LEVEL OF THE COMO MINE, IN ALL OF THE VEINS THE ORE WAS PRACTICALLY ALL SULPHIDE AND CHIEF VALUES WERE CONTAINED IN ARGENTITE (Ag_2S) WITH SOME SPACTACULAR OCCURRENCES OF PYRAGYRITE AND PROUSTITE IN HIGH GRADE PODS IN THE VEINS. THE WRITER HAS FIRST HAND KNOWLEDGE OF THE MINERAL GRADATION FROM FREE GOLD AND SILVER, CHLORIDES IN THE OXIDE ORES TO THE SULPHIDE MINERALS AT DEPTH IN THE COMO MINE AS HE WAS ON THE SUPERVISORY STAFF WITH GRADE CONTROL AS PART OF HIS RESPONSIBILITY IN 1936. HIS EXPERIENCE WITH THE AREA'S MINERAL GRADATION AND THE STRONG VEIN SYSTEM AT THE PINENUT KING MINE'S SIMILAR MINERALOGY INDICATED IT TO BE A PROPERTY WITH CONSIDERABLE SILVER PRODUCTION POTENTIAL. THE PINENUT KING MINE'S VEIN SYSTEM IS HIGHLY LEACHED ON THE SURFACE DOWNWARD. THEREFORE IT IS EXPECTED TO HOLD A DEEPER OXIDE ORE ZONE THAN WAS PROVEN AT THE COMO MINE, AS THIS LATTER PROPERTY'S OXIDE ORE ZONE WAS PARTLY LOST DUE TO EROSION OR PART OF THE ORE BODIES. IT IS ESTIMATED THAT OXIDE ORES WILL BE INTACT IN THE ORE SHOOTS OF THE PINENUT KING MINE AT A DEPTH OF 150' TO 250'.

SILVER CHLORIDE PODS WITH SOME SULPHIDES HAVE RESISTED OXIDATION IN THE VEIN SYTEM OF THE PINENUT KING. SAMPLES NOS. 272 AND 273. \$67.73 AND \$193.92 PER TON WERE TAKEN FROM ONE OF THESE PODS. IT IS LIKELY THAT AT SHALLOW DEPTH HERE, SHIPPING ORE WILL BE ENCOUNTERED. NO DOUBT, THE ORIGINAL 1870S PROSPECTORS WERE SELECTIVELY MINING THESE PODS WHICH HAD RESISTED OXIDATION. FURTHERMORE THEY WERE PROBABLY IMPRESSED WITH THE MINERAL OCCURRENCE AS BEING SIMILAR TO THAT OF THE COMSTOCK LODE SOME 20 MILES AWAY. IT PRODUCED SOME \$800,000,000 AND IN MANY INSTANCES , MAJOR ORE BODIES WERE SEVERAL HUNDRED FEET UNDERGROUND AS WAS THE CASE OF THE CON. VIRGINIA AND CALIFORNIA MINES. COMBINED THEY PRODUCED NEAR \$400,000,000 WITH LITTLE SURFACE SHOWINGS OTHER THAN THE MINERALIZED ZONES WHICH WERE HIGHLY LEACHED AS IS THE CASE OF THE PINENUT KING MINE VEINS.

PINENUT KING MINE PRELIMINARY REPORT OF NOV. 1, 1964 :

7. RECOMMENDATIONS :

THE PRELIMINARY TRACTOR WORK IN EXPOSING IMMEDIATE SHIPMENT ORE WAS SOMEWHAT DISAPPOINTING AT FIRST APPRAISAL. HOWEVER, THE VERY EXCELLENT SAMPLES FROM THE #1 AND #2 CLAIMS' SPECIMENS OPENED WITH THE TRACTOR INDICATE NEAR SURFACE UNLEACHED ORE. SECONDLY, ALL SAMPLES TAKEN SHOWED SOME GOLD AND SILVER - NONE CAME BACK "NIL". IN VIEW OF THE HIGHLY LEACHED CONDITION OF THE MINERALIZED AREAS DEPTH EXPLORATION IS REQUIRED. THE ELEMENT OF RISK WITH REGARD TO DRILLING IS APPARENTLY LOW IN VIEW OF THE STRENGTH OF THE ZONES AND MINERAL GRADATION HISTORY OF THE DISTRICT.

IT IS RECOMMENDED TO DO THE FOLLOWING EXPLORATION WORK :

- A). 12 HOURS OF HEAVY BULLDOZING-RIPPING AT SITE OF THE GOOD GRADE SAMPLES IN AN ATTEMPT TO OPEN SOME IMMEDIATE SHIPPING GRADE ORE.
- B). DRILL 150' TO 250' WITH BX CORE DRILL BELOW THE #1 AND #2 MINERAL OCCURRENCE.
- C). DRILL 150' TO 250' WITH BX CORE DRILL BELOW THE STONE SPRING WHICH SHOWED \$5.60 PER TON IN GOLD FIVE FEET UNDER THE SURFACE OVER 8' WIDE. GOLD WOULD BE EXPECTED TO CONCENTRATE IN THE UPPER LEACHED OUT VEIN. SILVER WOULD BE EXPECTED TO BE COMPLETELY LEACHED OUT IN THIS WATER COURSE, A PREMINERAL FAULT LINE. AS DEPTH IS OBTAINED ONE WOULD EXPECT GOLD VALUES TO DROP AND SILVER VALUES TO RISE ON A RATIO FINALLY OF 1 OZ. GOLD TO 50 OUNCES OF SILVER.
- D). DRILL UNDER THE HIGHLY LEACHED AND ALTERED ROCK ON CLAIM NO. 5. DEPTH HERE HOLDS INTEREST RELATIVE TO HIGH VOLUME POTENTIAL.
- E). 8 HOURS OF HEAVY BULLDOZING RIPPING AT SITE OF No. 2 SPRING. THIS HEAVY IRON OXIDE MAY MAKE SHIPPING ORE NEAR TO THE SURFACE.

AFTER DOING THE BULLDOZER-RIPPER WORK AS LISTED IN ITEMS " A)." AND "D)." ABOVE ON COMPANY ACCOUNT, A JOINT VENTURER OR SUB-LESSEE SHOULD BE CONTACTED FOR DRILLING CAPITAL IF THE COMPANY IS TOO INVOLVED IN OPERATION OF THE GIANT MINE'S PRODUCTION SETUP. THE GIANT MINE'S PRODUCTION WOULD FURNISH DRILLING FUNDS FOR THE PINENUT KING AS SOON AS COMMENCED. SILVER IS NOW IN FOCUS WHEREBY MANY MINING COMPANIES ARE LOOKING FOR PROPERTIES. CONSEQUENTLY, THERE SHOULD BE AVAILABLE INTERESTED OPERATORS SHOULD THE WESTERN METAL PRODUCERS CORP. DECIDE TO JOINT VENTURE OR SUB-LEASE PART OF THE 200 ACRES IT HOLDS ON AGREEMENT OF LEASE WITH OPTION TO PURCHASE.

PINENUT KING MINE PRELIMINARY REPORT OF NOV. 1, 1964 :

8. ECONOMICS :

BULLDOZER-RIPPER COST :

THE TOTAL OF 20 BULLDOZER-RIPPER HOURS RECOMMENDED WITH
OBJECT OF OPENING UP SHIPPING ORE IN THE ZONE WHERE
GOOD GRADE SAMPLES WERE TAKEN WOULD COST :

- A). BULLDOZER HAULAGE FROM CARSON CITY, NEVADA,
@ \$15 PER HOUR 1½ HRS. EACH WAY = 3 HRS..\$45.00
- B). 20 OPERATING HRS. @ \$20 PER HR. =400.00
- C). SAMPLING, SERVICE, ASSAY FEES =150.00

TOTAL \$ 595.00

EXPLORATION DRILLING :

FOR EXACT DRILLING FIGURES, BOYLES BROS. DRILLING COMPANY
OF SALT LAKE CITY, UTAH, WHO HAVE RIGS NEAR THE PINENUT
KING MINE, WERE CONTACTED FOR A DRILLING BID.

PRIOR TO RECEIVING THE BOYLES BROS. DRILLING BID,
THE FOLLOWING ESTIMATE FOLLOWS :

- A). 1,000 FEET OF BX DIAMETER CORE DRILL
HOLES @ \$10 PER FOOT - SURFACE RIG \$10,000.00
- B). WESTERN METAL PRODUCERS CORP. OR
JOINT VENTURER-SUB-LESSEE ACCOUNT
FOR SERVICE OF CORE TAKING,
SCRUTINY, SLUDGE SAMPLING, ASSAY
FEES, SAMPLE EXPRESS CHARGES, ETC. 1,750.00

TOTAL ESTIMATE \$11,750.00

THE ABOVE EXPLORATION IS JUSTIFIED IN VIEW OF THE EXISTING
MINERAL EVIDENCE, POSSIBLE IMMENSE SILVER POTENTIAL BACKED
BY THE DISTRICT'S SILVER PRODUCTION. THE SIMILAR GEOLOGIC
CONDITIONS OF THE PINENUT KING MINE AND THE NEARBY COMSTOCK
LODE LENDS CONSIDERABLE WEIGHT AND INTERESTING OUTLOOK WITH
REGARD TO TECHNICALLY ALIGNED EXPLORATION DRILLING.

PINENUT KING MINE PRELIMINARY REPORT OF NOV. 1, 1964 :

8. ECONOMICS, CONTINUATION :

ON THE BASIS OF SELECTIVELY MINED ORE SHIPPED CRUDE TO THE SELBY , CALIFORNIA SMELTER OF AMERICAN SMELTING & REFINING COMPANY, \$30 PER TON WOULD BE THE ECONOMIC CUT-OFF POINT INCLUDING : MINE PRODUCTION, FREIGHT, SMELTING FEES, SMELTING LOSSES, BULLION TAX AND ROYALTY.

AFTER SUFFICIENT POSITIVE RESERVES HAVE BEEN BLOCKED OUT TO JUSTIFY A TREATMENT PLANT ON THE PROPERTY, FREIGHT OF SOME \$13 PER TON , SMELTING FEES AND LOSSES WILL BE SAVED. WITH CYANIDE TREATMENT SILVER BULLION CAN BE POURED ON THE PROPERTY AND SOLD DIRECT TO MARKET. THE VERY ACUTE DEMAND FOR SILVER IN THE ELECTRONIC, SILVERWARE AND FILM INDUSTRIES ASSURES VERY FAVORABLE MARKETING. SOME \$20 PER TON WOULD BE SAVED BY MILLING ON THE PINENUT KING PROPERTY, AFTER FACILITIES HAVE BEEN INSTALLED. WHEN POSITIVE ORE TONNAGE HAS BEEN BLOCKED OUT, TREATMENT PLANT FINANCING WILL PRESENT NO PROBLEMS AS SOME SILVER USERS ADVANCE MONEY AGAINST SILVER BULLION SHIPMENTS ON THE BASIS OF PROVEN, POSITIVE ORE RESERVES.

9. SUMMARY :

WITHOUT ANY TECHNICAL RESERVATION THE PINENUT KING MINE JUSTIFIES DRILLING EXPLORATION AT A DEPTH BELOW THE VEIN SYSTEM'S LEACHED ZONE. MINERAL GRADATION IN THE DISTRICT IS KNOWN AND LITTLE EXPLORATION RISK IS INVOLVED IN THE DRILLING OF THIS PROPERTY.

SILVER ORE VOLUME POTENTIAL HERE HOLDS VERY FAVORABLE OUTLOOK. THERE IS ALSO A POSSIBILITY THAT SOME IMMEDIATE SHIPMENT ORE GRADE WILL BE FOUND WITH AS LITTLE AS 20 HOURS OF TRACTOR-BULLDOZER WORK.

THE COMPANY ENJOYS A VERY FAVORABLE LEASE WITH OPTION TO PURCHASE ON LIBERAL TERMS.

DOMESTIC DEMAND AND MARKETING OUTLOOK FOR SILVER IS BETTER NOW THAN AT ANY TIME IN UNITED STATES HISTORY. THE PRESENT PRICE AT \$1.293 IS HIGHER THAN ANY YEAR IN U. S. HISTORY SINCE FEB. 12, 1873 WHEN IT WAS \$1.2929 PER POUNCE.

VERY TRULY YOURS,
J. H. WREN & COMPANY,

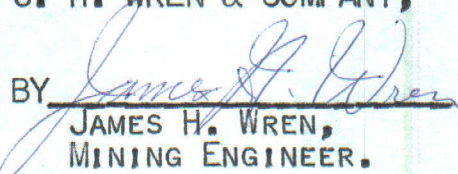
BY 
JAMES H. WREN,
MINING ENGINEER.

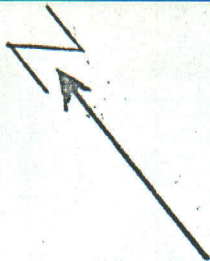

PINENUT KING NO. 9	PINENUT KING NO. 5	PINENUT KING NO. 8
PINENUT KING NO. 3	PINENUT KING NO. 1	PINENUT KING NO. 6
PINENUT KING NO. 4	PINENUT KING NO. 2	PINENUT KING NO. 7

PINENUT
KING
NO. 10

PINENUT KING LODE CLAIM
GROUP. COMO MINING DISTRICT,
LYON COUNTY, NEVADA. SECTIONS
24 & 25, T 15 N, R 22 E.

LOCATION MONUMENTS



SCALE : 1" = 500 FEET

OCTOBER 26, 1964

J. H. Wren & Company
Consulting Mining
Engineers
P. O. Box 2021
Reno, Nevada

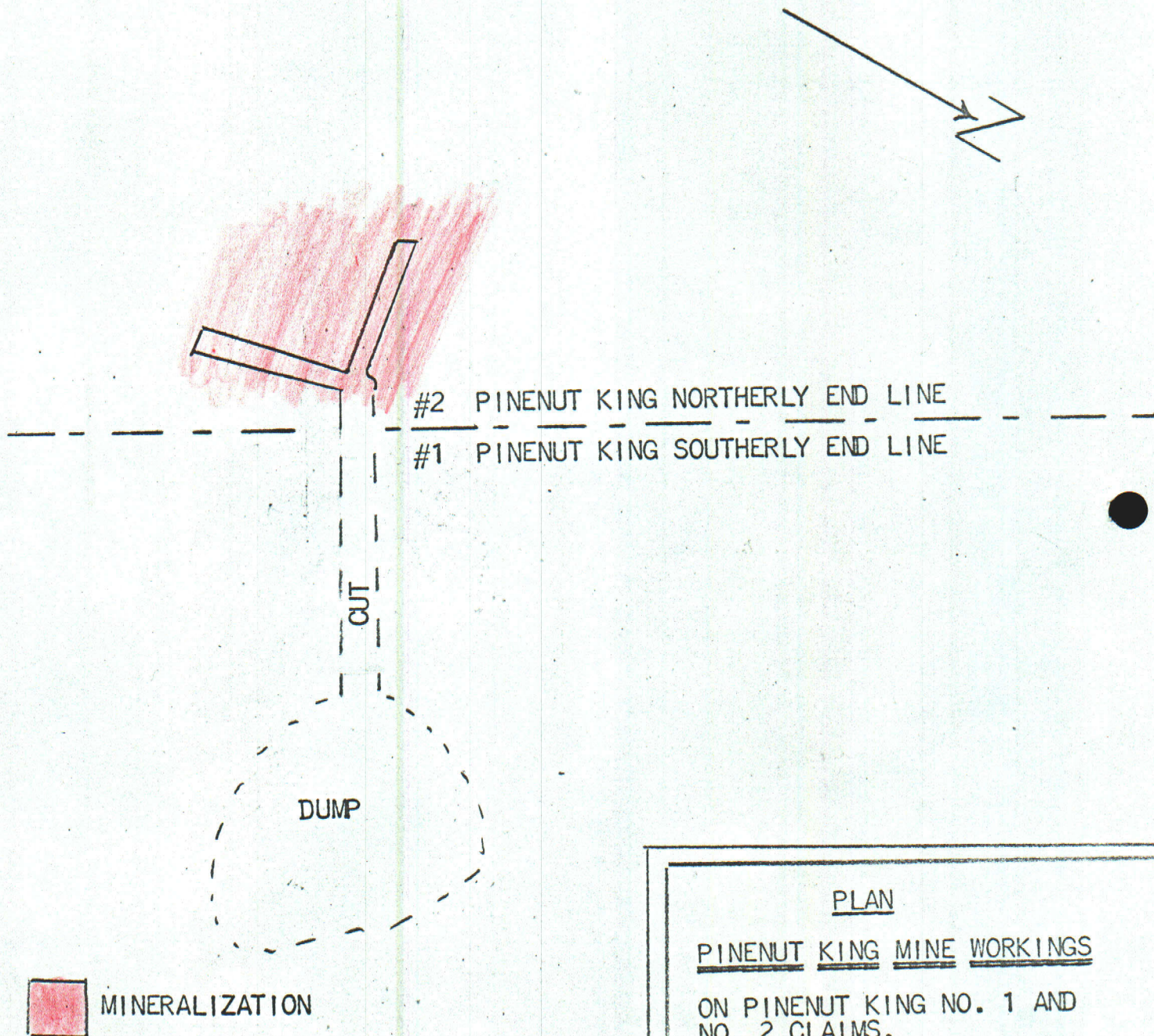

PLAN

PINENUT KING MINE WORKINGS

ON PINENUT KING NO. 1 AND
NO. 2 CLAIMS.

SCALE : 1' = 25' 10/24/64

HEAVY MINERALIZED FAULT ON THE
SOUTH FORK OF WORKINGS. FE
MINERALIZED WIDTH OVER 25'.

J. H. Wren & Company
Consulting Mining
Engineers
P.O. Box 2021
Reno, Nevada

NEW BULLDOZER CUT

PINENUT KING NO. 4

PINENUT KING NO. 3

OLD PROSPECT PIT 12' DEEP

NORTHERLY ENDLINE

SOUTHERLY END LINE



MINERALIZATION

PLAN

PINENUT KING MINE WORKINGS

ON PINENUT KING NO. 3 AND
PINENUT KING NO. 4 CLAIMS.

SCALE : 1" = 50'. 10/24/64

STRONG VEIN IN PREMINERAL
FAULT LINE - SOME POST MINERAL
FAULTING. VEIN MINERALIZATION
CARRIES QUARTZ, SILVER-GOLD
MINERALS, FeO .

J. H. Wren & Company
Consulting Mining
Engineers
P.O. Box 2021
Reno, Nevada

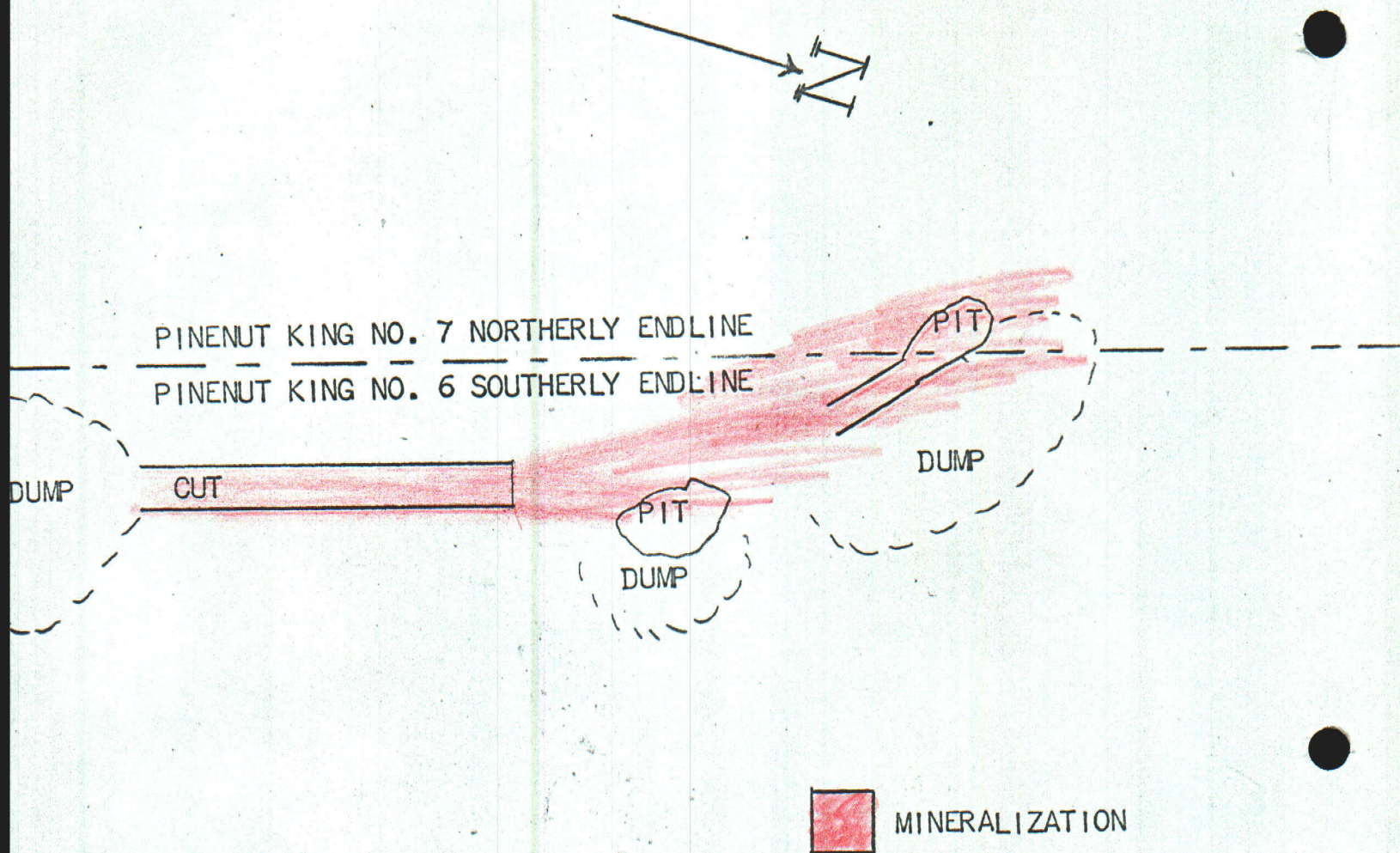

PLAN

PINENUT KING MINE WORKINGS

ON PINENUT KING NO. 6 AND
PINENUT KING NO. 7 CLAIMS

SCALE : 1" = 50'. 10/24/64

STRONG MINERALIZATION ALONG
PREMINERAL FAULT LINE. SOME
POST MINERAL FAULTING. HIGHLY
LEACHED INDICATING 10' OR MORE
ORE WIDTH AT DEPTH BELOW LEACH
ZONE.

J. H. Wren & Company
Consulting Mining
Engineers
P. O. Box 2021
Reno, Nevada



 MINERALIZATION

PLAN

PINENUT KING MINE

NO. 5 CLAIM X-CUT

SCALE : 1" = 30'
OCT. 24, 1964

X-CUT WAS DRIVEN BY HAND IN
THE 1870S THROUGH MINERALIZ-
ED, IRON OXIDE STAINED
GROUND. TUNNEL CROSS SECTION
IS PERFECTLY ARCHED AND IN
EXCELLENT CONDITION.

J. H. Wren & Company
Consulting Mining
Engineers
P.O. Box 2021
Reno, Nevada

DUMP

CUT

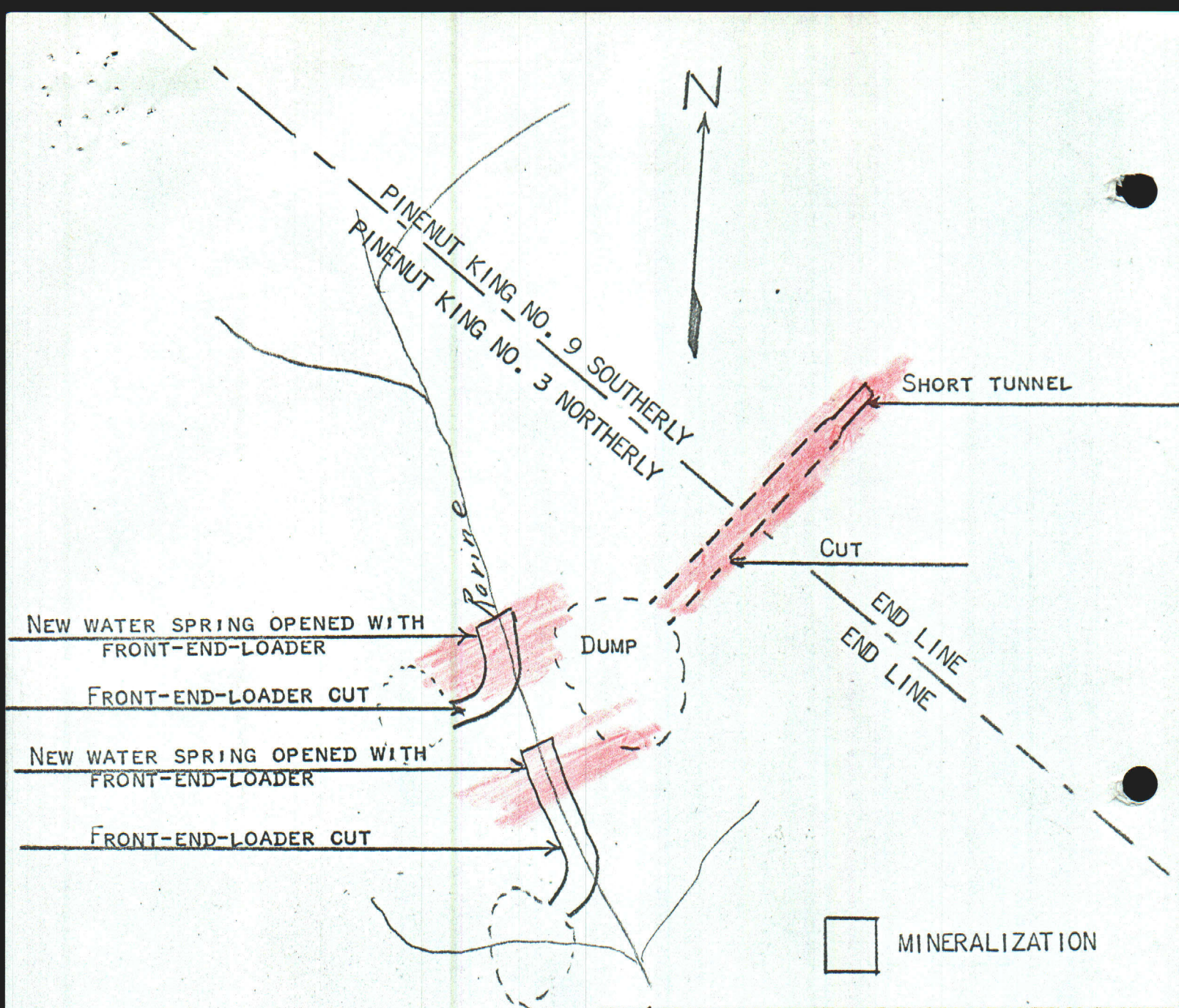

PLAN

PINENUT KING MINE WORKINGS

ON PINENUT KING NO. 3 AND PINENUT
KING NO. 9 LOSE MINING CLAIMS.

SCALE : 1" = 50'. 10 - 24 - 64

DISEMINATED MINERALIZATION, HEAVY
FE O ALONG PREMINERAL FAULT LINE
WITH POST MINERAL FAULTING. HEAVY
MINERALIZATION IN RAVINE BELOW DUMP.

TWO GOOD WATER SPRINGS FOUND WHILE
STRIPPING RAVINE MINERALS.

J. H. Wren & Company
Consulting Mining
Engineers
P. O. Box 2021
Reno, Nevada

James H. Wren
604 South Wells Avenue
Suite No. 4
Reno, Nevada

PHONE : RENO. 322-4840

Born : San Francisco, California - January 22, 1912 :

Marital Status : Married, two grown children - out of college.

Engineering Education : Post graduate studies, knowledge of the Spanish language, hold valid U. S. Passport, Member of the American Institute of Mining And Metallurgical Engineers, author of technical papers. "

P R O F E S S I O N A L R E C O R D

September 1, 1947 To-Date :

Individual fee basis mining engineering and short term management assignments, specializing in production problems. Examples : Basic Refractories Inc., a 4,000 tons per day magnesite project. Alder Copper-Gold Corp., 350 tons per day copper zinc operation with selective flotation plant. U. S. Tin Corp., an Alaskan lode and placer tin operation. Baltimore-Camas Corp., 125 tons per day tungsten enterprise. Placereros de Sonora, 5,000 cubic yard per day Mexican gold dredge. Northern Resources Corp., a 125 ton per day quicksilver project. Ecuadorian Dredge Corp., Ecuadorian Enterprises, Inc. Western Hemisphere Resources Corp. French Guiana Gold-Placers. Consulting Mining Engineer to Industrial Development Corp., Washington, D. C., and numerous other domestic and foreign firms for which examinations, evaluations, production mechanization, efficiency programs and production alignment, etc., were successfully handled.

Reference : Theodore Macklin Ph. D. 3127 Hampshire Dr., Sacramento, Calif.
H. P. Morrison, 1745 - K - Street, N. W., Washington, D. C.
J. M. Van Patten, 1714 Fletcher Ave., Sou. Pasadena, Calif.

Sept. 1945 to Sept. 1947 :

Gen'l. Supt. and Utah Manager for Metal Producers, Inc.. Chief operation : Horn Silver Mine, Milford, Utah, that State's largest gold, silver, lead and zinc Southerly Utah production mine during the writer's interim there. By engineering alignment, mechanization and marketing adjustment, production was raised from 50 tons per day to over 400 tons in form of three products : Complex selective flotation one, crude smelting one and a beneficiated product shipped direct to smelter. Metals produced : Gold, Silver, Lead, Zinc, Copper. A \$400,000 deficit was paid off by the writer's output and a profit shown. Activities were suspended Aug. 11, 1947 as a direct result of Metallic Premiums termination and the economic grade of existing reserves.

Reference : J. W. Mangram, 243 $\frac{1}{2}$ Sou. Elm Dr., Beverly Hills, California.

February 1944 To Sept. 1945 :

Superintendent, Tungstar Mine near Bishop, Calif. Project produced a monthly average of 3,000 W U3 units per month grossing \$90,000 leaving \$60,000 profit.

May 1941 To December 1943 :

Supervisory duties connected with military construction related to heavy earth moving, rock excavation and heavy construction in foreign fields.

For eight years prior to 1941, worked as a miner, millman, shiftboss, shaftboss, mine foreman, engineer and superintendent at various Western U. S. mines.

James H. Wren.