

0960 0001

264

Item 1

INTRODUCTION

On the afternoon of July 20th 1955, I made a reconnaissance inspection of a group of eight (8) mining claims which are located approximately one mile north of the Carson City Airport at Carson City, Nevada.

(See map accompanying this report.)

The purpose of the inspection was to determine whether this property warranted further exploration and development.

The property definitely warrants further exploration to determine the extent of the mineralization. There is a possibility that scheelite exists in commercial quantity.

GEOLOGY

The mineralization occurs along a contact between metamorphosed triassic sediments and granodiorite which has intruded the sediments. However, very little work has been done on the property and it is impossible to determine the extent of the mineralization. The owners of the property used a dozer to remove the sage brush in a number of places but they did not attempt to remove the overburden which varies in thickness from a few inches up to possibly three (3) feet. There is a good showing of scheelite in the overburden but this could be a concentration from the weathering of a series of small seams spread over a wide area. On the other hand there is a possibility of the existence of a concentrated vein structure. Only by the placing of a series of cuts in a systematic manner can this be determined. The present owners have put a number of small holes through the overburden but this was not done in a systematic manner. At the present time it is impossible to obtain the true dip and strike, the extent of the contact or the amount of mineralization along the contact.

RECOMMENDATIONS

A number of cuts should be placed in a systematic manner to expose the formation. It would be possible if this were done, to determine whether scheelite might exist in commercial quantity. Such a program would require the expenditure of approximately twenty-five hundred (\$2500.00).

CONCLUSIONS

This property is adjacent to Carson City and could be operated throughout the entire year if an ore body was developed.

WM BOURNE WOOD
Mining - Geologist
Reno, Nevada

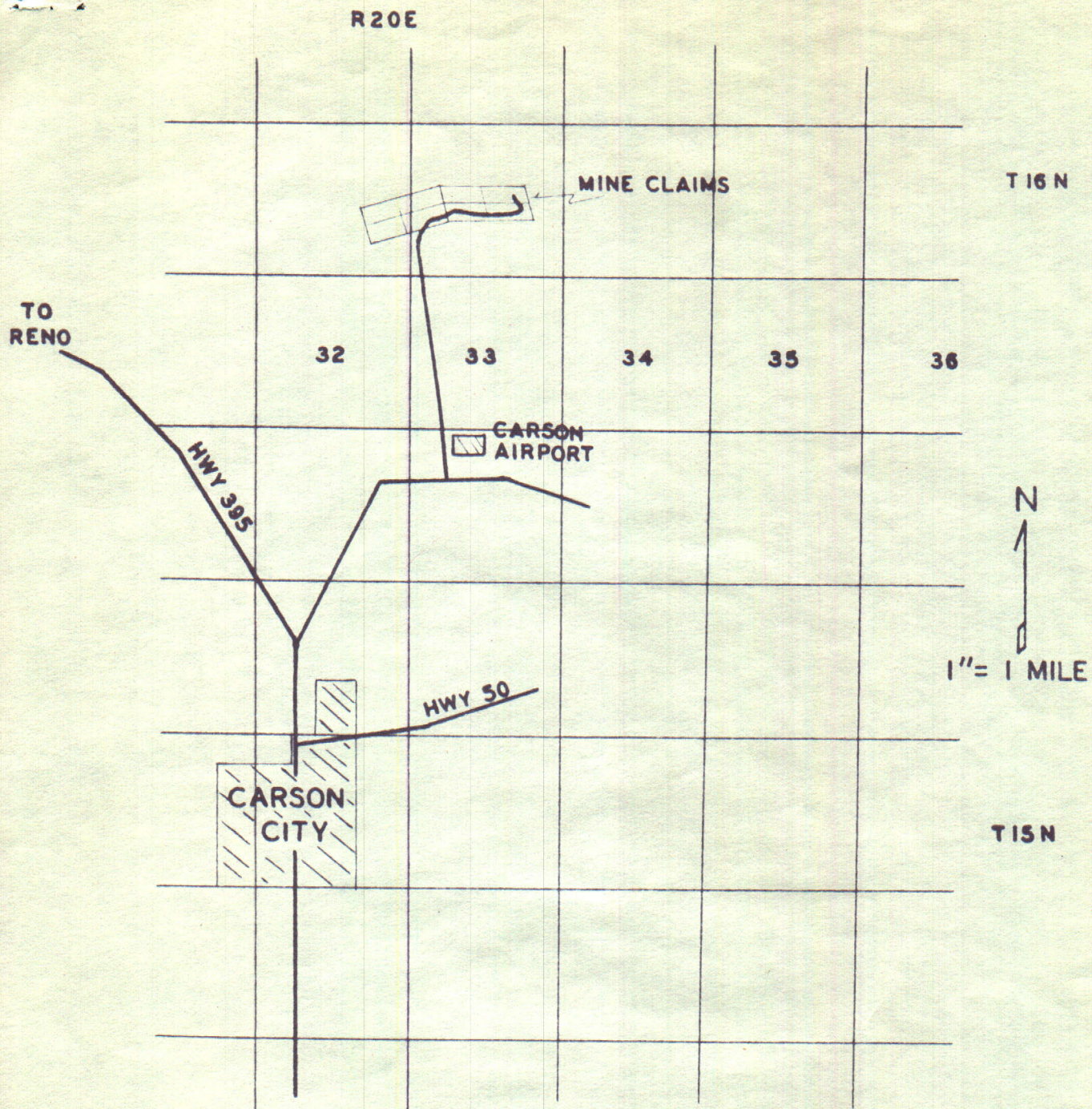

SKETCH MAP
SHOWING APPROXIMATE
LOCATION OF CLAIMS

WM BOURNE WOOD
MINING - GEOLOGIST