

Survey No. 50

# PLAT

of the claim of  
*P. Martin*

upon the  
*Good Faith*

*Columbus* Mining District,

*Esmeralda* County, Nevada.

Containing an Area of *6.09* Acres.

Scale of 200ft. to an inch.

Mariation *16° 45'*

Surveyed by *G. W. Carside*

*U. S. Deputy Min. Surveyor*

*July 22nd* 1882

The original field notes of the survey of the claim of the

*P. Martin*

upon the *Good Faith* L<sup>te</sup> from which this Plat has been made, have been examined and approved, and are on file in this office; and I hereby certify that they furnish such an accurate description of said Mining Claim as will, if incorporated into a patent, serve fully to identify the premises; and that such reference is made therein to natural objects and permanent monuments as will perpetuate and fix the locus thereof. I further certify that the value of the labor and improvements placed thereon by the applicant or ~~the~~ grantors, is not less than Five Hundred Dollars, and that said improvements consist of *a wind*

as appears by the report of the Deputy Surveyor and the testimony of two disinterested witnesses. And I further certify that this is a correct Plat of said Mining Claim, made in conformity with said original field notes of the survey thereof.

U. S. Surveyor-General's Office,  
*Reno* Nev.  
*July 26th* 1882

*G. W. Carside*

U. S. Surveyor-General for Nevada

Donated by:  
**HUGH SHAMBERGER**

(195)

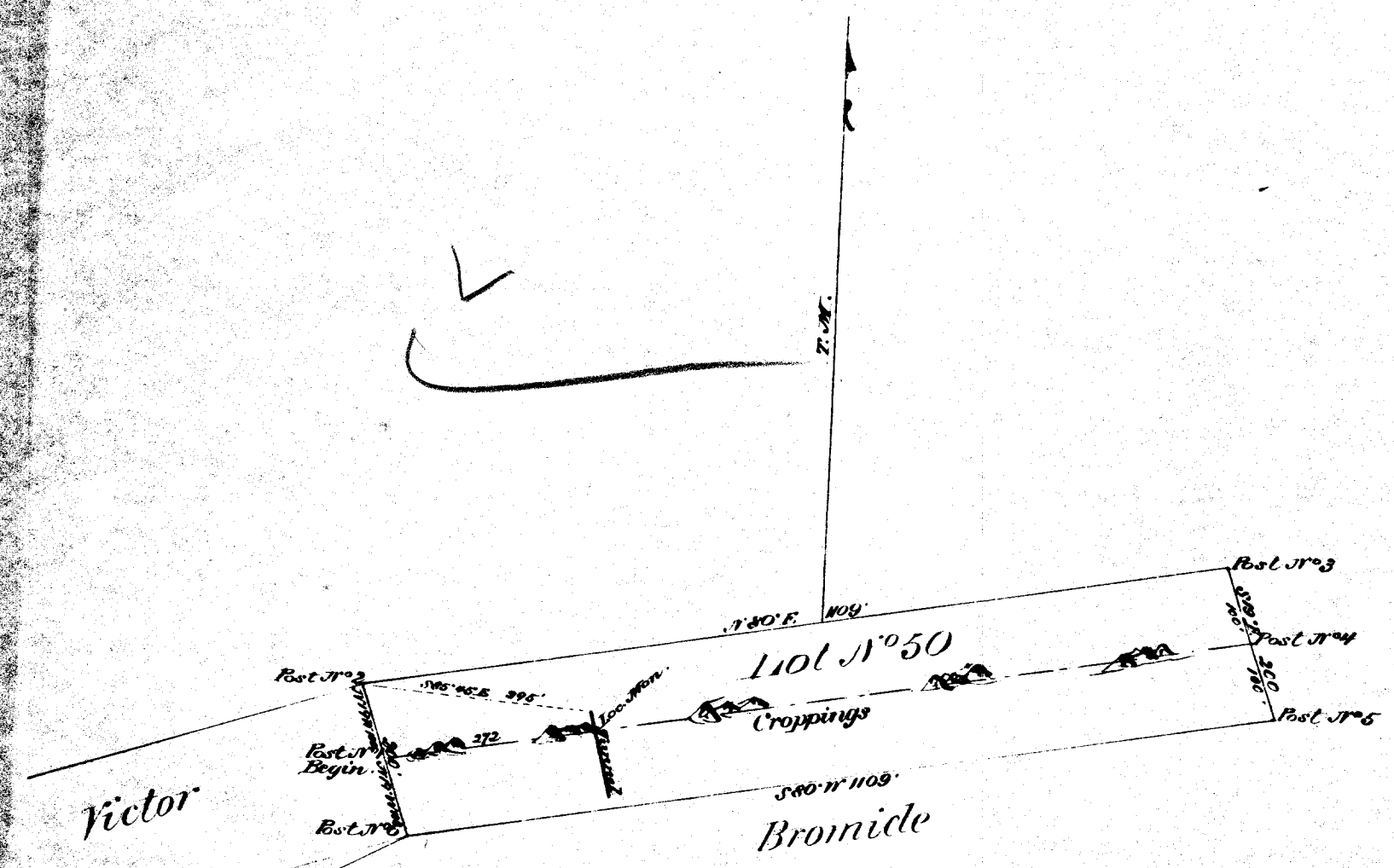

*1/4 Sec 32  
54215W  
2082'*

0930 0090