

0770 0029

(35)

ITEM 29

From: J. McLaren Forbes
To: Hatfield Goudey
Subject: Buckskin Mine, Yerrington, Nevada

October 9, 1963

Conclusion: The Buckskin Mine as a vein deposit, for copper and gold, is of no further interest at the present time.

The small area of strong alteration and weak copper showings, at the west end of the mine, could indicate a larger altered mineralized area at depth.

The Buckskin Mine, presented by Milo M. Harcourt, P.O. Box 701, Yerrington, Nevada, is located in the Buckskin Mining district approximately 23 miles west of Yerrington, Nevada. It is on the west side of the north end of Smith Valley in the E $\frac{1}{2}$ of T. 13 N; Ra. 23 E. The property consists of 6 and a fraction patented claims. The property was reportedly worked for gold in the early days and there are two small shafts, an adit level and a 90, 130, and 230 level. The water level stands just above the 130 level. There are several small stoped areas. Only the surface and adit level were seen. The property was visited on October 4th and 5th, 1963.

Six diamond drill holes were drilled, from the surface, under the direction of Mr. Harcourt. He has furnished sections of these holes showing the assays. Due to various reasons the cores have been dumped and as piled up are of no value except to possibly show rock type and mineralization.

Mr. Harcourt has furnished a map of the adit level, showing the drill hole locations, 5 sections along the drill holes, and a composite long section showing the widths and assays he has used to calculate ore reserves. The maps and sections appear to be reasonable. The assays are from a mine sample assay plan by I.E. Klein, the long section by Synider-Burton, and from results of the recent diamond drilling.

An ore reserve calculation by Mr. Harcourt, using the above data, gives the following, as shown on the long section.

Block	Possible Ore		
	Tons	Oz. Au.	% Cu
A	42,141	0.16	1.52
B	2,462	0.18	1.56
C	1,281	0.30	1.97
D	62,554	0.17	1.60
E	1,263	0.15	1.06
Total	109,701	0.17	1.57; or \$15.37

The grade of 0.17 oz. Au and 1.57% Cu compares favorably with the composite assays for the diamond drill intercepts which are 0.19 oz. Au, 0.15 oz. Ag, 1.43% Cu and .028% Wo; or \$15.23.

The geology of the Buckskin district, from Mineral Resources of Douglas County by T.D. Overton, Nevada Bureau of Mines, is described as, "Triassic sediments----- intruded by granitic rocks resulting in intense metamorphism near the intrusives." The rocks in and near the mine, as shown on Mr. Harcourt's plan and sections are classed as diorite or meta diorite, monzonite or monzonite porphyry, and quartzite. These appear to be reasonable field names.

The Buckskin veins or shear zones are, on the whole, steeply south dipping and strike from east-west to north 40° west. The foot and hanging wall veins are up to 60 feet apart with occasional north 40° west cross veins. These veins or mineralized shear zones are two to 10 feet or more wide, and in places strongly quartz bearing. The sulfide minerals seen were pyrite and chalcopyrite. Assayed widths varied from 1 to 14 feet with an average width of 7.4 feet.

The rock between the veins or shears is weakly or unmineralized on the adit level and according to Mr. Harcourt the same held true for the diamond drill holes.

To the west of the mine, at the end of the hanging wall drift, and also on the surface there is an area of highly altered bleached sericitized and silicified rock with nearby strong epidotization. The highly altered rock was originally the monzonite porphyry or possibly the diorite. On the adit level there is strong sulphating and some copper staining along the drift in this altered rock. This same material, on the surface, may have been slightly pyritized and have had a little copper mineralization.

There is a possibility that this small area of highly mineralized bleached and altered rock could be the surface exposure of an underlying larger altered and mineralized mass.

The Buckskin shear or vein zone appears to be cut off by the alteration but may pick up again farther to the west as indicated by several pits 500 or more feet west of the end of the workings. There are also several north east steep dipping structures, some containing strong quartz vein material, cutting both the Buckskin shear zone and the altered zone to the west.

Nothing is known regarding the extension of the Buckskin vein or shear to the east under the valley fill. There are indications of a range front fault but its presence is not certain.

SECTION A-A

BUCKSKIN MINE
Douglas Co., Nev.

N: 13 shaft
collar 5500 (estimated)

Adit Level

120' level

Scale 1" = 40'

Mela-Diorite

Monz. Porphyry

Quartzite

Copper Min'n.

SECTION B-B

BUCKSKIN MINE

Douglas Co., Nev.

no. 2 shaft
(new)

Adit level

N12°E

90' level

130' level

0-100

10-0.05-1.43%

30-0.06-2.43%

2-0.05-0.75%

14-0.15-1.21%

Scale 1"=40'

Meta-Diorite

Monz. Porphyry

Copper Min. l.

SECTION C-C
BUCKSKIN MINE
Douglas Co., Nev.

Adit Level

90' Level Δ

130' Level Δ

5528'

Scale 1" = 40'

Meta-Diorite

Monz. Porphyry

Copper Minn.

1" = 0.22 - 0.28%

10" = 0.39 - 1.14%

(stopped in ore)

SECTION D-D
BUCKSKIN MINE
Douglas Co., Nev.

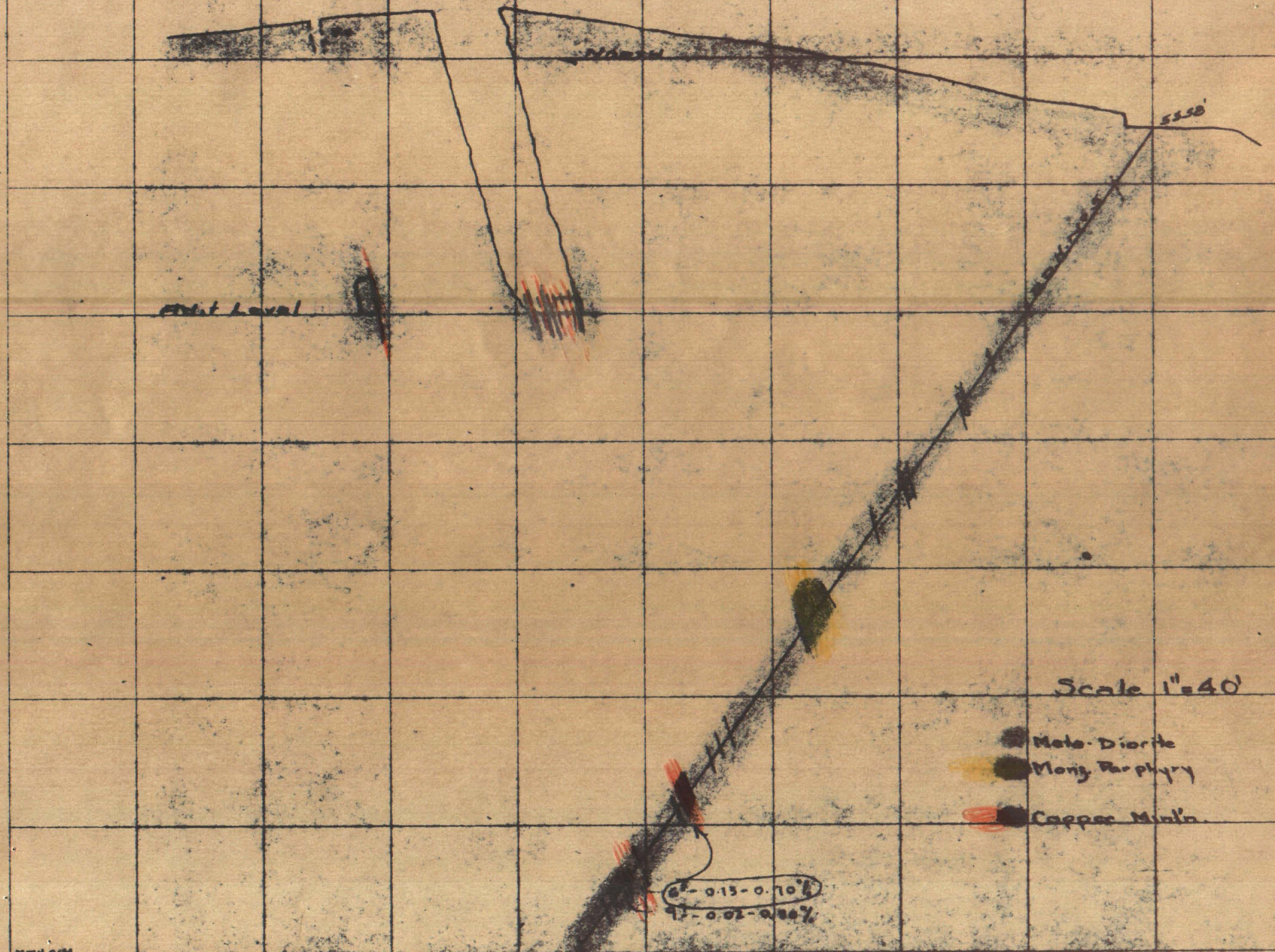

SECTION E-E
BUCKSKIN MINE
Douglas Co., Nev.

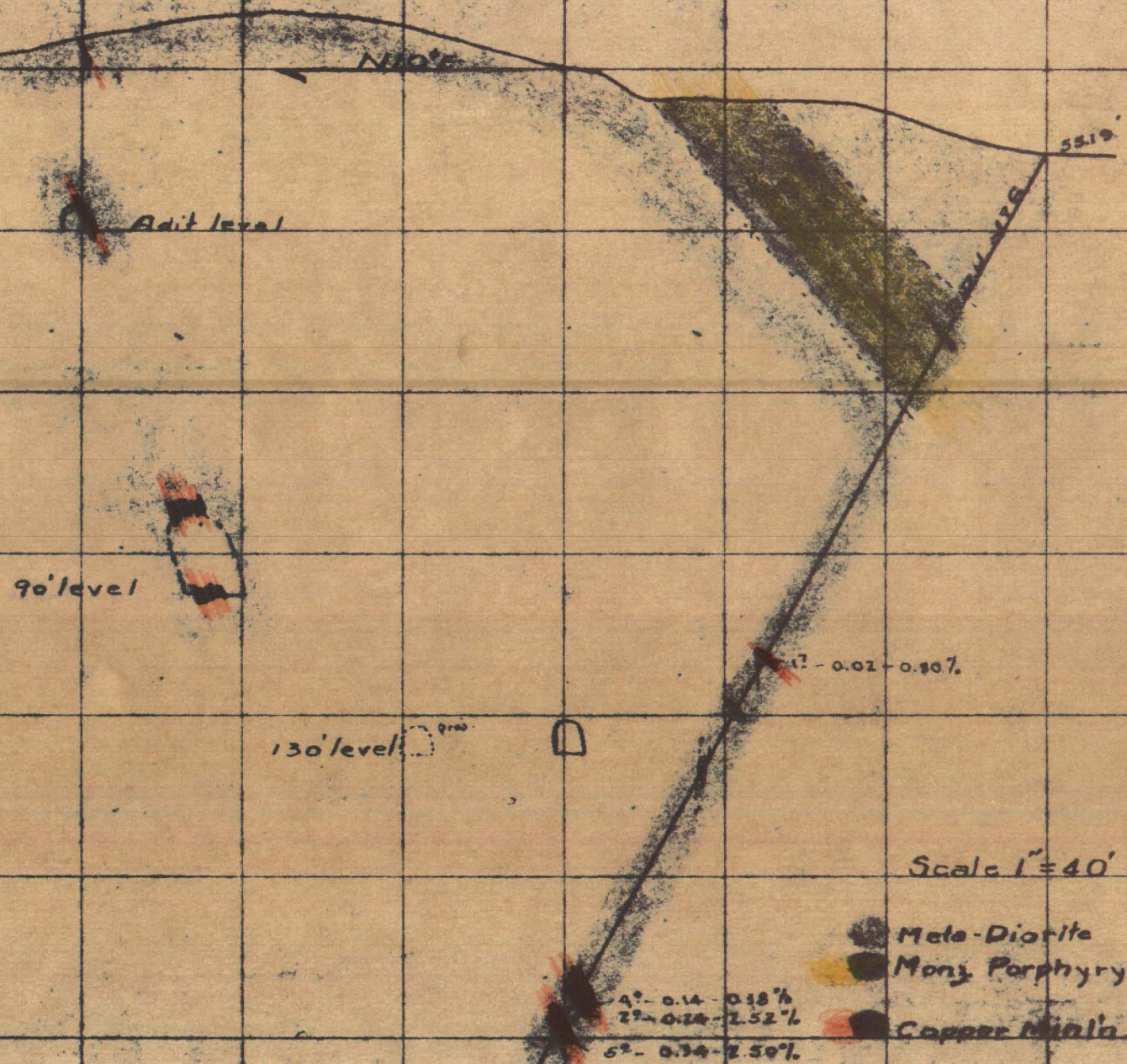

Scale 1" = 40'

Mela-Diorite
Mong. Porphyry
Copper Mtn's

D

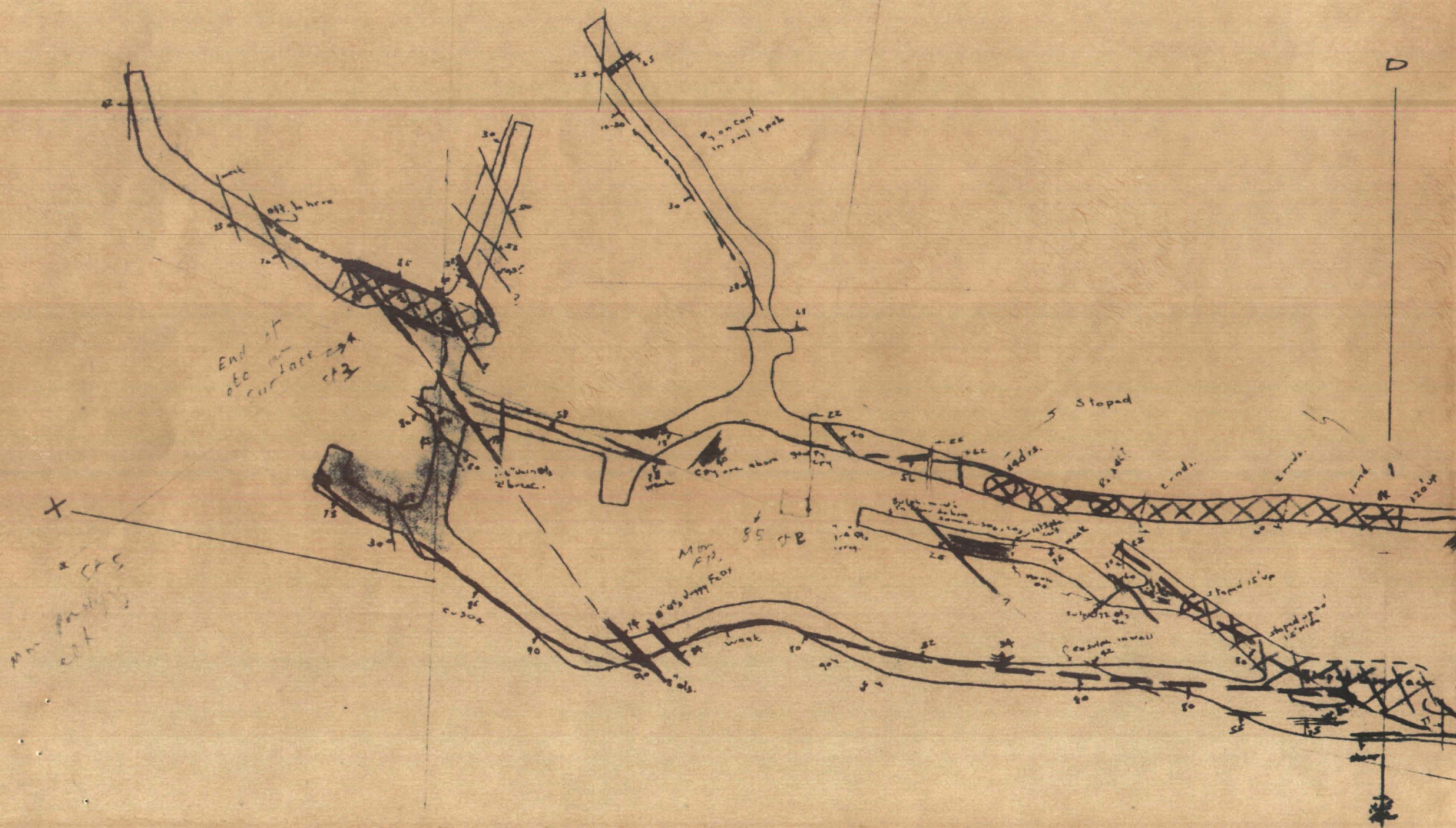

□ St 4

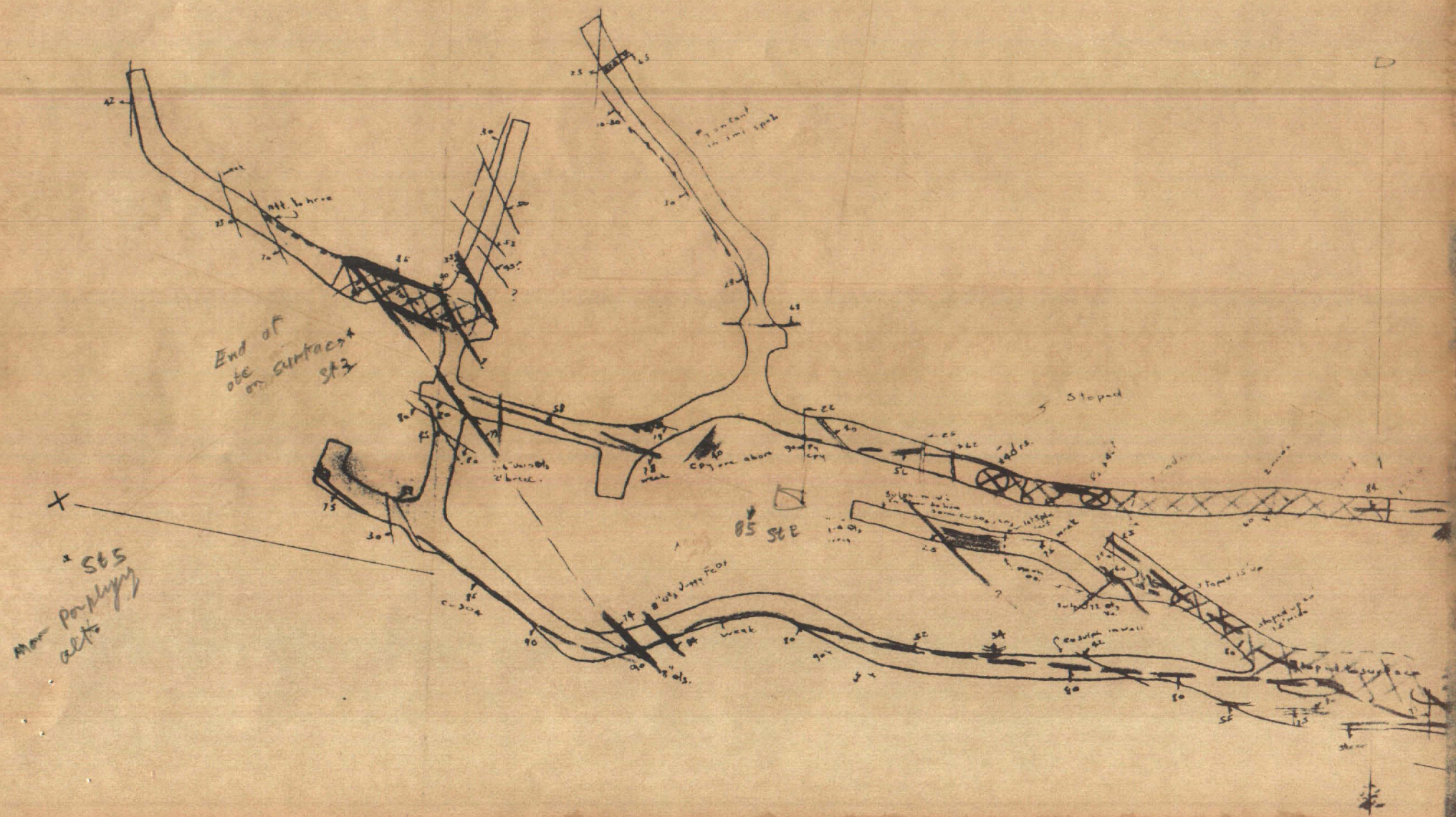

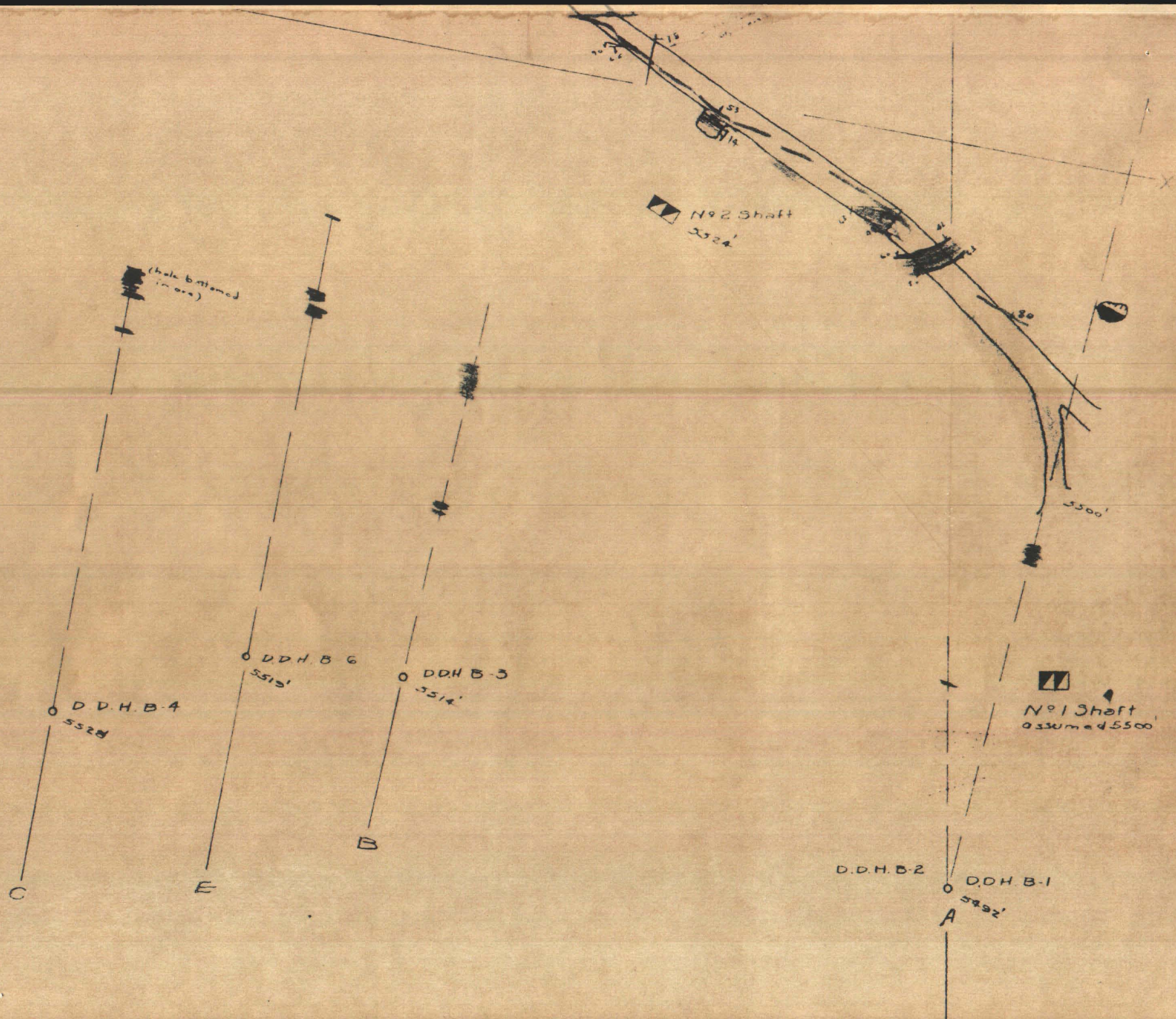



BUCKSKIN MINE

DOUGLAS COUNTY, NEV.

— PLAN-ADIT LEVEL —

1 INCH = 40 FEET

- Diorite
- Monzonite
- Quartzite
- Min'l'n. (Feox, Pt_2 , Cu-carb. or Sulph.)

M.M.H. 4-63

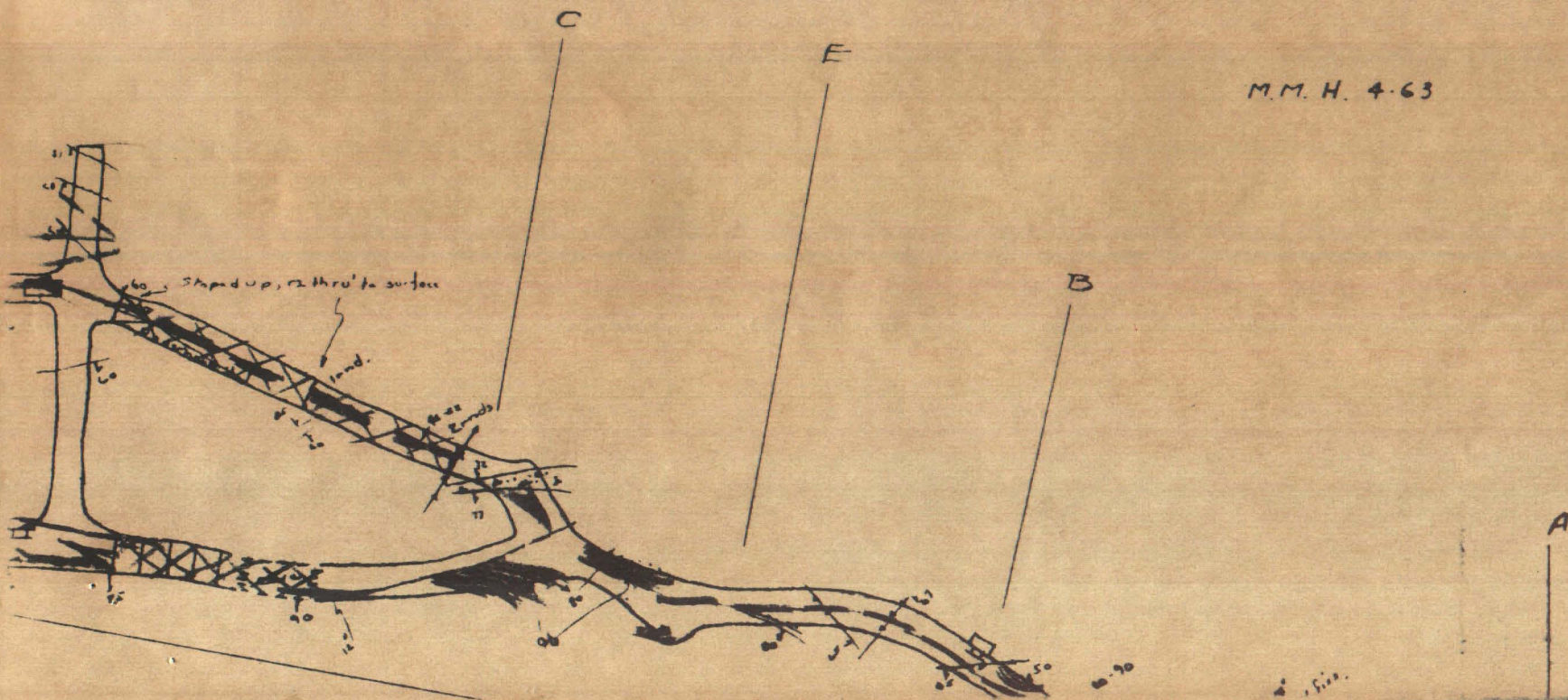

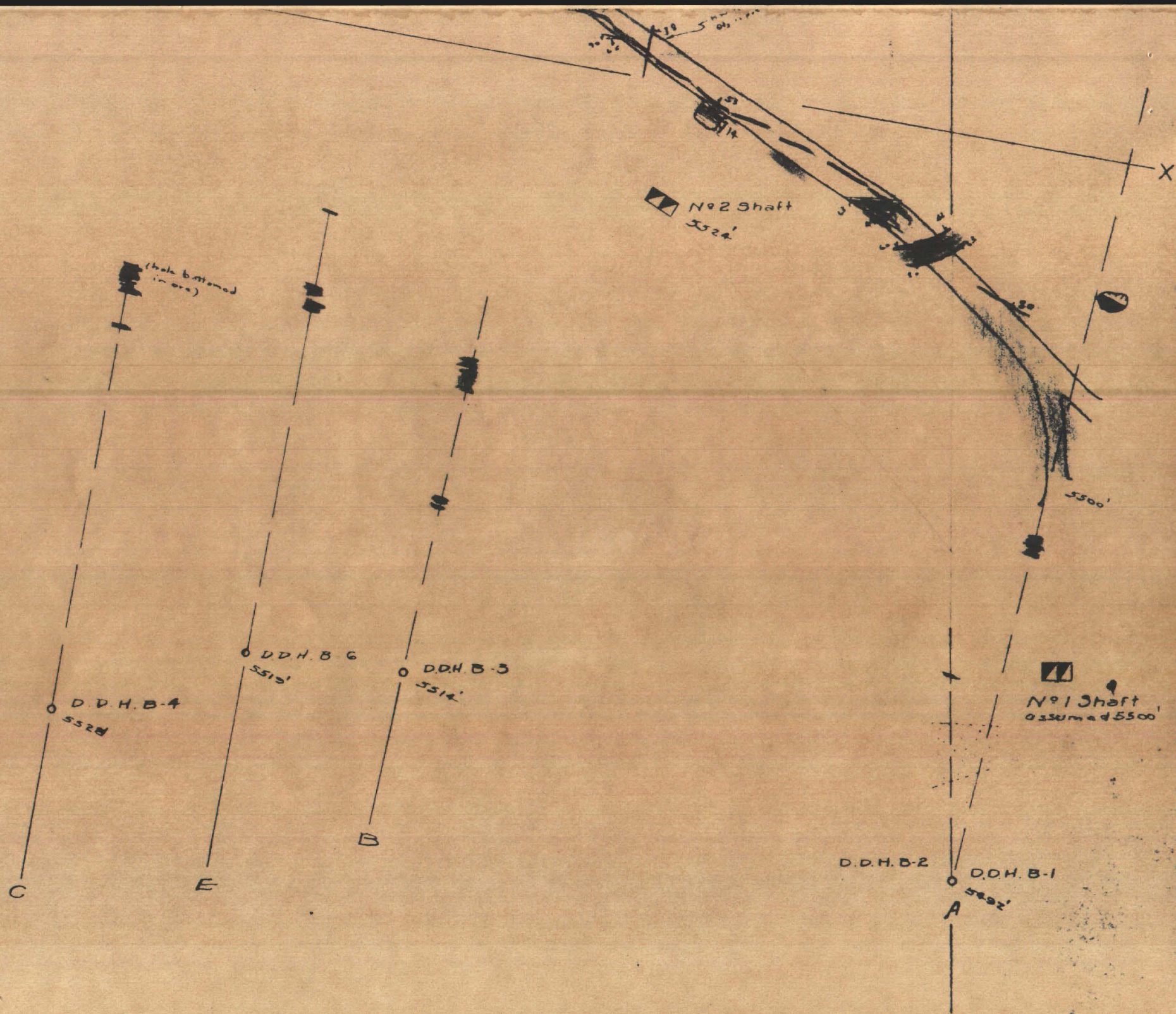



BUCKSKIN MINE
DOUGLAS COUNTY, NEV.

~ PLAN-ADIT LEVEL ~

1 INCH = 40 FEET

■ Diorite
■ Monzonite
■ Quartzite

■ Min'l'n. (Fe ox., Qtz., Cu-carb. & Sulph.)

M.M.H. 4-63

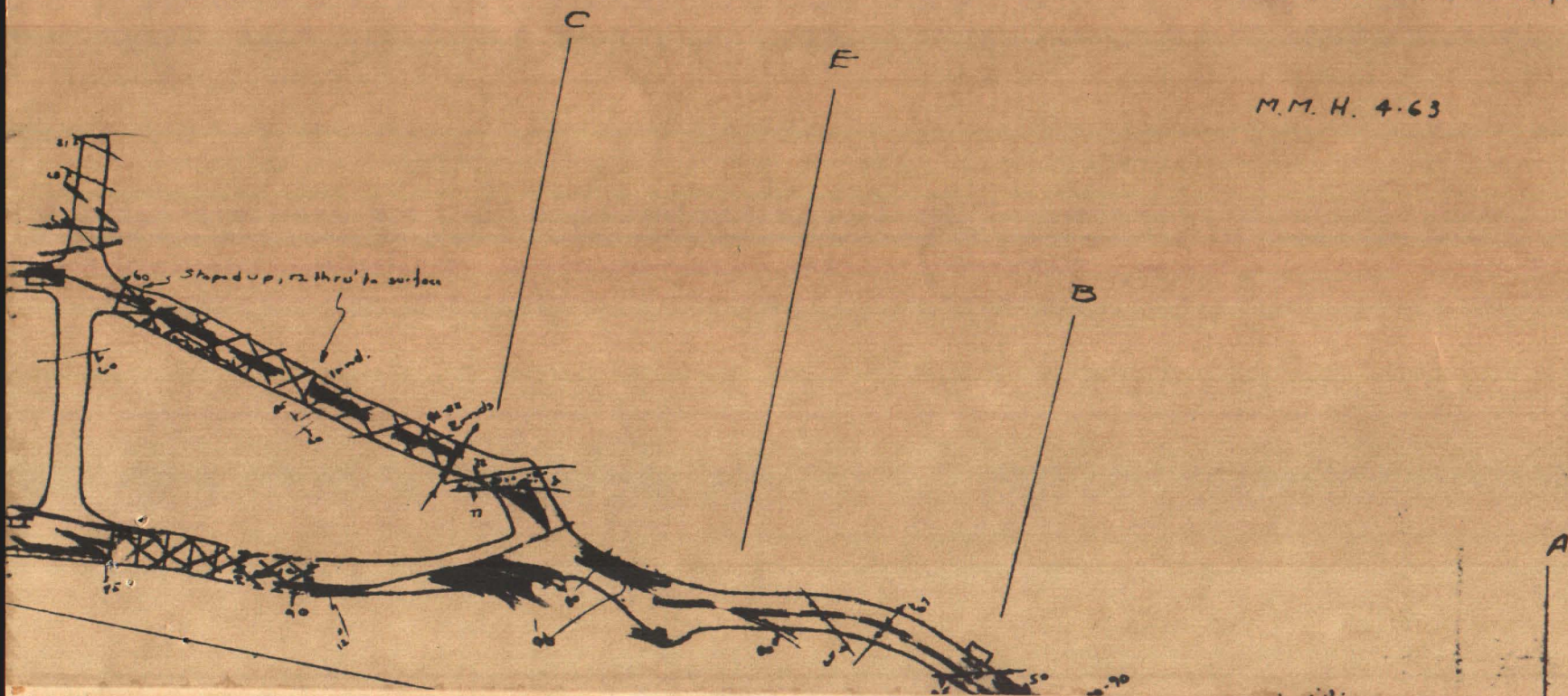

May 26, 1970

Mr. Don McMillan
5919 E. Pima Street,
Tucson, Arizona 85716

Dear Don:

I took a look at the Nev-Lorain claims adjoining the Buckskin mine west of Yerington, Nevada, as you suggested in your letter of May 12th. Mr. William C. Smith, of Yerington, showed me the property.

There is now considerable activity in the Yerington district. Mr. Smith seemed to have a good idea of what was going on. I am enclosing the geology map of Bulletin 75 Geology and Mineral Deposits of Lyn, Douglas and Ormsby Counties, Nevada. I think you have this Bulletin, so please return me the map. If you do not have it, I'll send the rest of the bulletin and get another one.

There is an overlay, on the geology map, showing some of the recent and present drill sites; pointed out by Mr. Smith.

The Nev-Lorraine group, on the surface, has been oxidized and is well limonite stained. According to the drill holes, the depth of oxidation is not great and no extensive chalcocite blanket has developed.

The Phelps Dodge, preliminary Outcrop Map, which you sent, is preliminary, as the name implies. There certainly is more faulting and shearing than they show, notably near the drill sites.

On the one day visit I made to the property, I did not see any obvious areas for future drilling. A day or two more, thoroughly going over the surface, might show some more favorable areas; possibly to the west. There are old workings and surface showings with copper, away from the P. D. drilling. However, I am really not too optimistic regarding the possibility of finding better areas for drilling, than the one's picked by Phelps Dodge.

Some samples are enclosed in the mailing tube.

Sincerely,

J. McLaren Forbes

JMF:ap

Straus Exploration, Inc.

5919 EAST PIMA STREET
TUCSON, ARIZONA 85716
(602) 296-0072

May 12, 1970

Mr. J. M. Forbes
2275 Mueller Drive
Reno, Nevada 89502

Dear Mac:

463-3887 I am sending you material pertaining to a group of 22 NEVADA claims adjoining the Buckskin mine west of Yerington. These claims are held by Milo Harcourt and William C. Smith, East Pearl Street, Yerington and the enclosed data, as you can see, was acquired by Phelps Dodge who explored the ground under an option agreement with them.

The two holes that PD drilled found nothing better than 0.15% copper and from studying the map, geochemistry, etc, I can't see where one would expect to find better. However, it is probably worth a first-hand look at the ground to evaluate alteration, leaching if any, and any other features that might recommend some further drilling.

Would you call Mr. Smith at your convenience and make a date to see these claims - he has a phone at the Yerington address but I don't know the number. And when you are finished with the maps, etc, please return them to me.

Very truly yours,

Don McMillan
Donald T. McMillan

cc:LHHart

Encl: Outcrop map - Buckskin Project

- ✓ Drill log BUE-1
- ✓ Drill log BUE-2
- ✓ IP Line location map
- ✓ Claim map and IP sections
- ✓ Surface samples - assays
- ✓ Geochemical samples - assays
- ✓ Drill holes BUE-1 and BUE-2 assays
- ✓ Report on the Buckskin Mine by Milo M. Harcourt

Buckskin -

7.4' Au. width @

.17 Au 1.57 Cu
using all assays

- 1.2 Ag. #15.37

Composh

0.19 Au 0.15 Ag

1.43 Cu 0.28 W/o

0.00 Mo #15.23

Mineral Resources of
Douglas County by
T. D. Overton
Nevada B.M. Publication

Buckskin District

Triassic Sediments -
intruded by granitic
rocks resulting in
intense met. near the
intrusives
country rock altered
and discolored

NE corner Douglas Cr
E $\frac{1}{2}$ Td 3N; R 23E

23 miles west of
Yerington

Through main pass
across north end
of Smith valley

6 patented claims
+ 1 fraction

Buckskin Mts.

(x¹) 3rd shaft

W 200'

(x²) Shaft or HCU

N70 W 135' ± end OBC

along line of OBC
85° S dip at shaft

Main rd to S of
shaft + line of
OBC.

st 2

NSE 245

to st 4 short to East
shows slight alt r
on dump

st 3

SSW 110' to Man Pa
ote to st 5

2nd SIO. otc

Trend N 30E 70W