

0740 0003

217
item 4

additional maps
in map files

Reno, Monday morning 6-20 Aug 26th 1929
Golden Eagle Mining & Milling Co.
200 Dwight Bldg.
Kansas City, Mo.

Gentlemen:

It was just afternoon of Wednesday that Profn Jones reached the property with me and that afternoon he took his first look and in the evening we talked over the situation.

It was Sunday afternoon when he left the property and it was night when I drove him to his house here in Reno.

From his arrival at the property until depositing him at his home last night we have been trying to establish facts that will allow at least a good possibility of ore production that will more than pay its production cost for he recognizes the mill and the water and that the same have real values if they can be used profitably.

I am very glad to say that Prof. Jones has brought me information on the property that I consider very valuable, either for operation for milling in the future if ample ore is mined of satisfactory value, or for some high grade leasing.

I consider that his idea of the location of possible ore and how it has been deposited and its likelihood of continuing, is very far superior to any information that we have had in the past. He could if he so desired taken samples at many places in our property close to those that Ordway took, that showed very small values, that would have told a very different result. He seems much more interested in what operating samples have shown, taken at various times in the development work. He also seems to think that we have some quite fair sized blocks of ore indicated, but until more is done he will not express himself as to positive mill ore for any long run.

While he did not have time to go into the Leader workings, and in fact did not desire to make a trip in a filled mine with gas, he is convinced that the ore deposit there is not far different from that on our property and he has looked at the samples of ore that came from the Leader. He did look at the Glory Hole, above the Derelect also looked at the Derelect and while there is ore showing that will give good assays, he will be the one to tell you his idea as to how the larger assays were secured and the probability of large ore production, which would have all to do in establishing a buying price. I also expect that he can advise you along the same lines regarding the Leader if he so desires. If this advice is given you, most likely the price that he names for the present development will not exceed the price that I named to you in a former letter.

I was in hopes that the final maps of Ordway would be here at Reno today also any other maps that may be at Kansas City so that a comprehensive idea could be established from all the information, past and present.

I am expecting to see Prof Jones in a very few minutes, using time that he said would be available to further discuss our problems.

On account of some possible boils on my left arm, if everything is not ironed out today, I may remain in Reno for tomorrow.

We are still having leaks in the water line and I hope that you will sanction the securing of valves to hold the water in the line when repairs are being made; also indicate that you are interested in the claims that will allow a pumping plant, at small cost, and thus make the line available for large water movement, at all times that the flow will furnish the water.

Yours very truly
k

217

WALTER P. NEFF, PRES.
MISS ETHEL B. RIDENOUR, 1ST VICE PRES.

L. L. LINDSAY, 2ND VICE PRES.

PARIS J. KEYES, 3RD VICE PRES
FRED L. FERGUSON, TREAS.

Hamy

Golden Eagle Mining and Milling Company

OPERATING MINES AND MILL AT PHONOLITE, NYE CO., NEVADA
(INCORPORATED UNDER THE LAWS OF NEVADA)

OTHER DIRECTORS

N. H. SOOY
ROBERT W. WADDELL
M. H. GREENE
FRANK PORAWSKI

KANSAS CITY OFFICE
200 DWIGHT BUILDING

KAY H. BEACH
SECRETARY AND
MANAGER OF PROPERTIES
POST OFFICE
FALLON, NEVADA

KANSAS CITY, MISSOURI.

19 867 16473
32 2512 80384
19 1120 21280
42 13225 555450
34 1933 65722
32 7296 233472
38 2753 104614
216 216) 1077395 (\$988
17 7864
30.9 2133
1944
1894
1728
1710

867 2512
19 32
7803 5024
867 7536
16473 80384

1933 1120
34 19
7732 10080
5799 1120
65722 21280

7296 13225
32 42
14592 26450
21888 52900
233472 555450

2753 38
22024
82894
104614

21050
10500

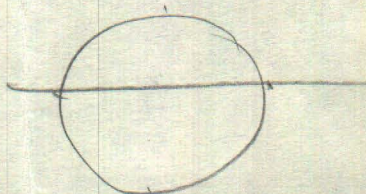

60/165 11040
275 1120

314.16
1258.64
25
628320
251328
15/3141.500 2094
30 141
133
65

GOLDEN EAGLE M&M CO.
DULUTH WORKINGS
PHONOLITE NEV.

UPPER TUNNEL

LOWER TUNNEL

WHITE SHAFT PRODUCED HIGH GRADE

Magnetic Meridian - no variation set off

SCALE 1 IN = 20 FT

J. F. Tamm

ft. 20 10 0

7217. 1800

Item 4

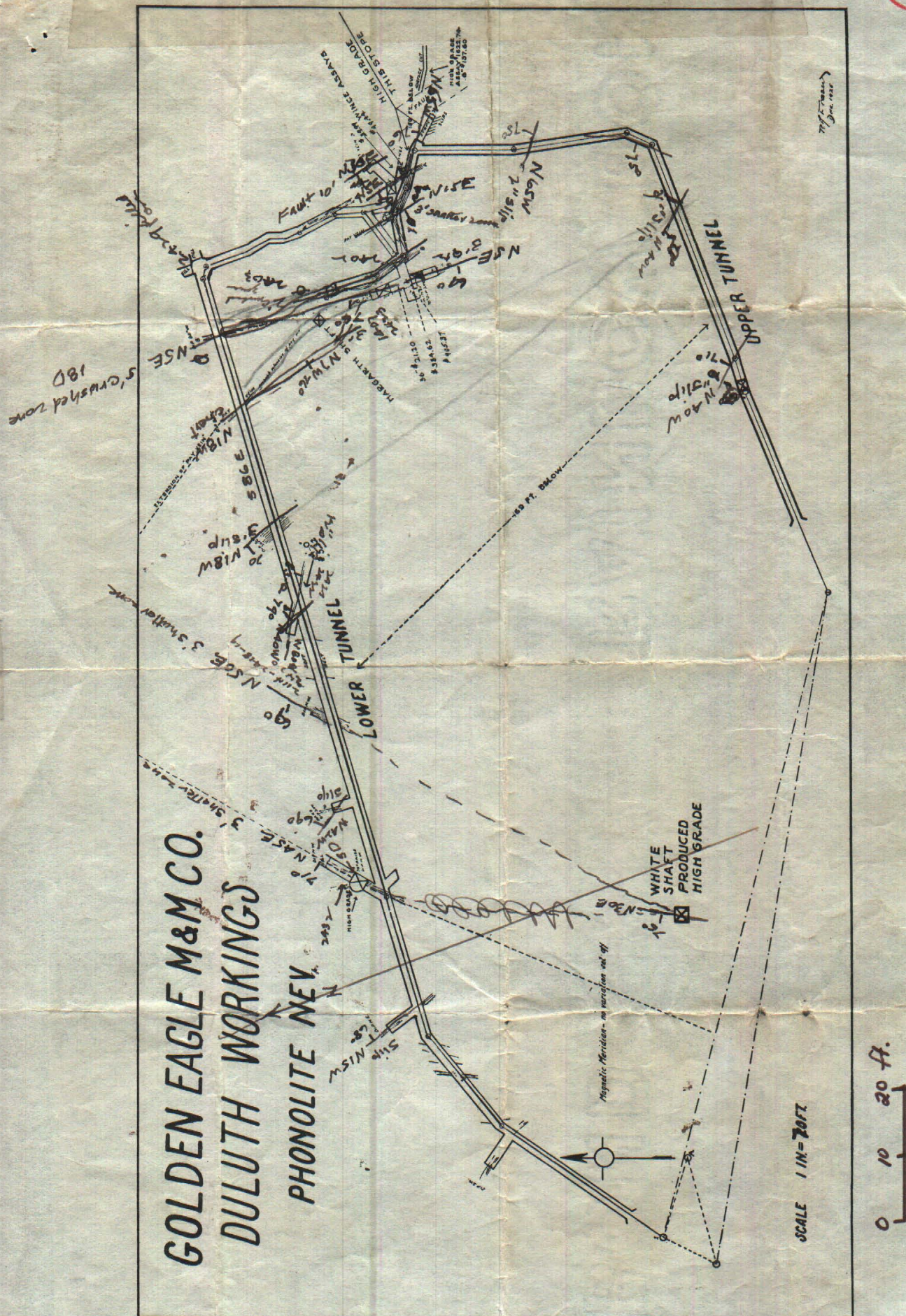

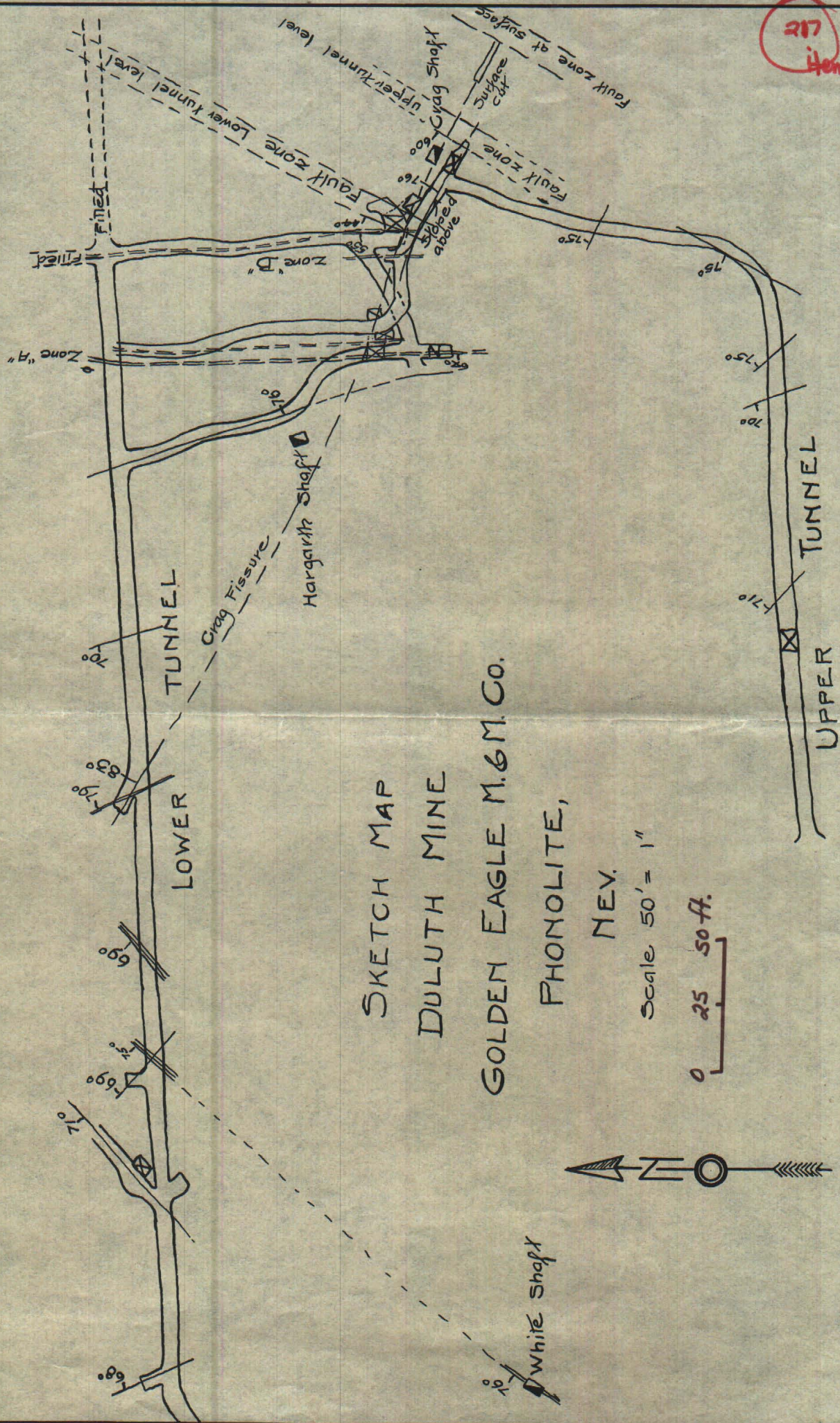

SKETCH MAP
DULUTH MINE
GOLDEN EAGLE M. & M. CO.

NEV.

Scale 50' = 1"

0 25 50 ft.



White shaft

217
item 4

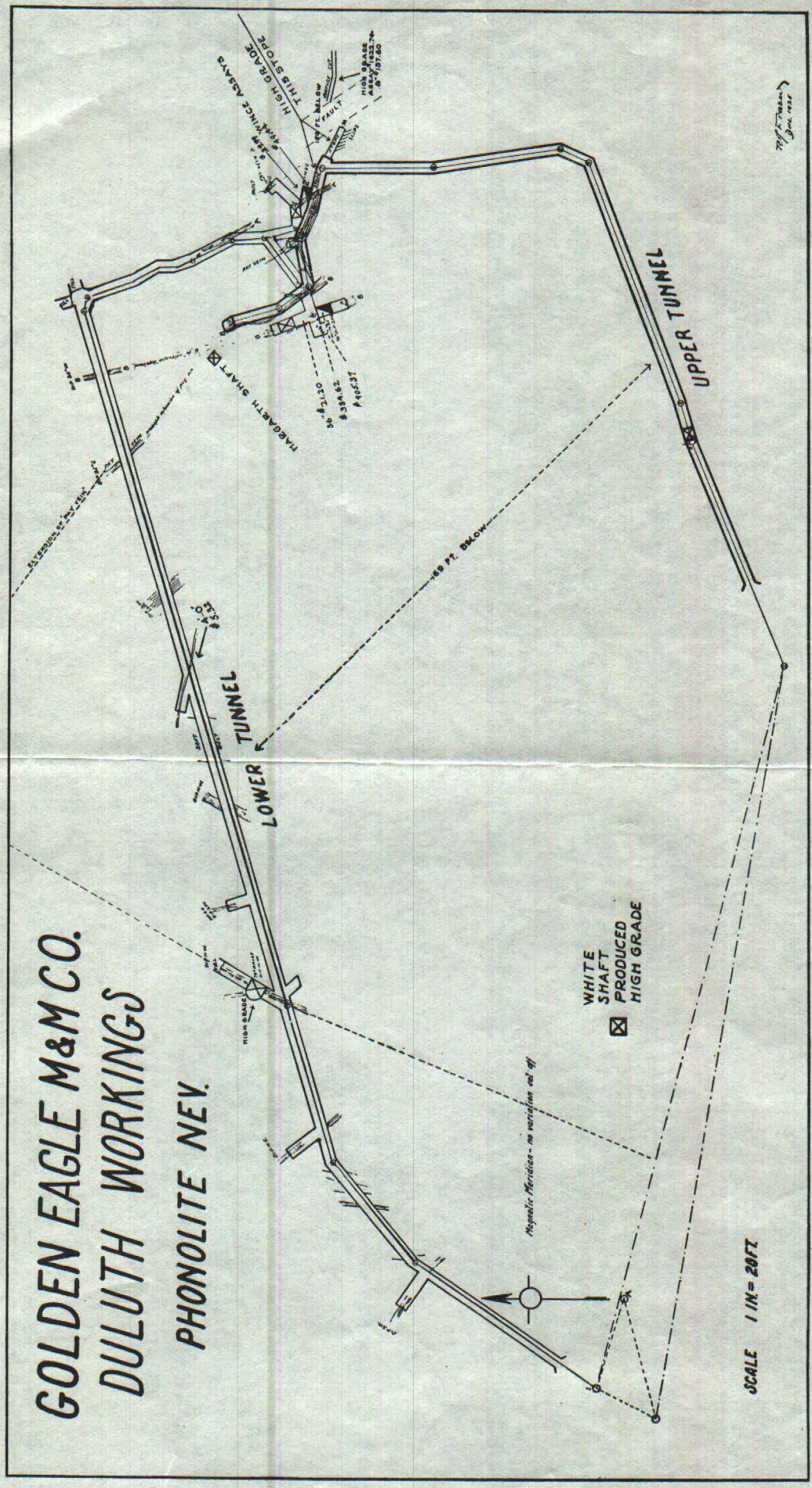

GOLDEN EAGLE M&M CO.
DULUTH WORKINGS
PHONOLITE NEV.

SCALE 1 IN = 20 FT.

0 10 20 ft.