

MIZPAH, SILVER LEAF, GOLD DUST
CLAIMS
LANDER COUNTY, NV.

0480 0231

SUMMARY REPORT

MIZPAH, SILVERLEAF AND GOLD DUST CLAIMS

COPPER BASIN AREA LANDER COUNTY, NEVADA

August, 1967

Dudley L. Davis

Location Access

This property is situated in Sections 29 and 30, T. 32 N., R. 43 E., MDM in the Copper Basin area of the Battle Mountain Mining District, Lander County, Nevada. It adjoins Duval property on the south and east and claims leased to Union Pacific Railroad on the north and west.

It is accessible via Nevada Hiway 8A south from Battle Mountain to the Copper Basin road thence about three miles via improved gravel road past Duval's leaching plant to the claimed area.

Ownership

Ownership rests in the Hospital Board of Lander County by virtue of a quit claim deed from the prior owner. It is rumored that Duval has an option on these claims but terms of the option are not known to the writer.

General Geology

Much of the claimed area is covered by alluvium but the eastern and northern portion shows Cambrian sediments of the Harmony formation and intrusive monzonite. Disseminated copper and minor molybdenum characterize the adjoining Copper Queen property which Duval holds and the MM & S claims to the north show a rather strong northwest fracture system with copper and silver values.

The Silverleaf zone is a well-mineralized fault-fissure which traverses the eastern portion of the property and the Irish Rose fissure is prominent in the west. Both trend N. 10° to 20° W. and contain copper-silver mineralization.

The central and southern part of the property shows no good mineralization but is potentially valuable for disseminated copper or molybdenum. It is reasonable to assume the intrusive rocks exposed in the Copper Queen area are genetically related to those seen in the Union Pacific Railroad leased area to the northwest. If this is true, the Hospital Board area should be underlain by similar material as it lies between these mineralized zones.

Recommendations

An induced polarization survey (I.P.) should be run to determine if sulphide mineralization is present at depth, particularly where the Irish Rose and Silverleaf mineralized fissures would cut the contact between the sediments of the Harmony formation and the intrusive. If favorable results are obtained by the I.P. survey, drilling should be done to evaluate the anomalous areas so found.

Respectfully submitted,

DUDLEY L. DAVIS
Registered Professional Engineer
No. 3038

T 32N, R. 43E, MDM
~~R 44E, MDM~~

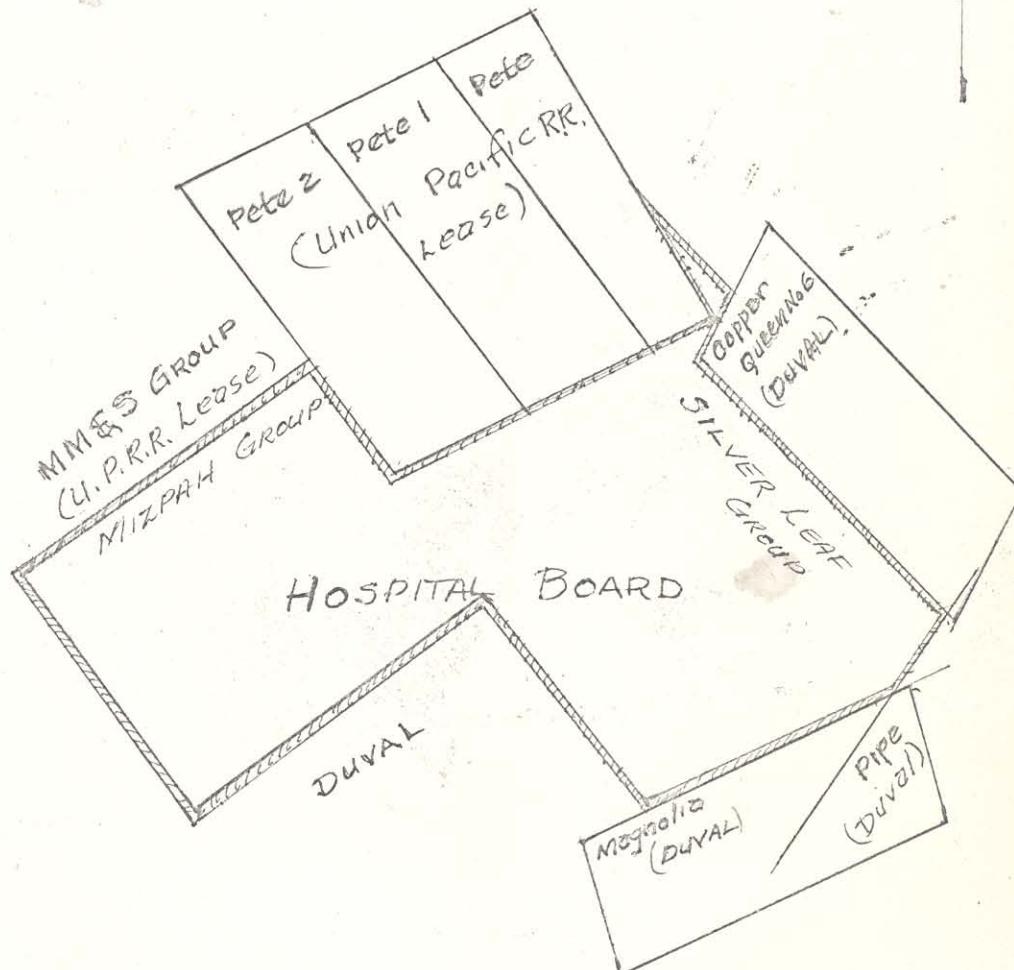

HOSPITAL BOARD AREA
Battle Mountain District
Lander County, Nevada
scale: 1" = 800'
August, 1967 D.L. DAVIS

T 32N, R. 43E, MDM
~~R 44E, MDM~~

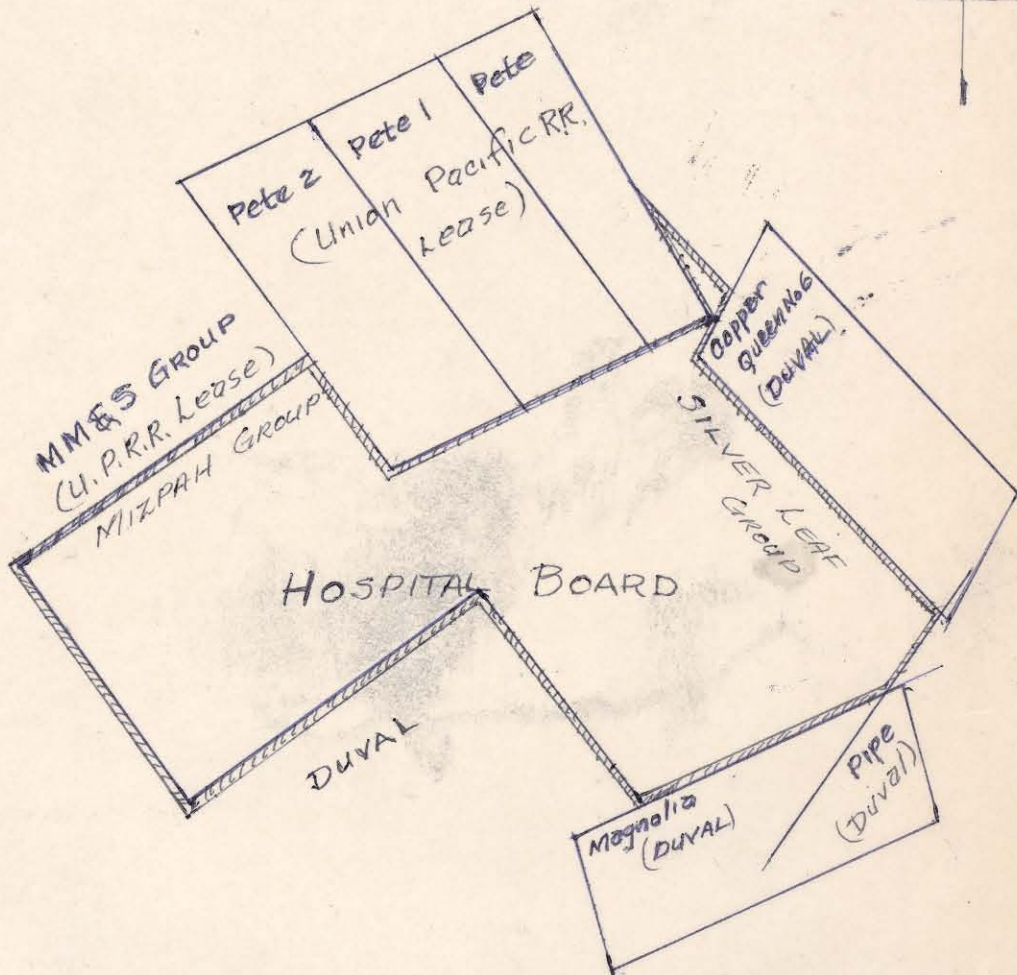
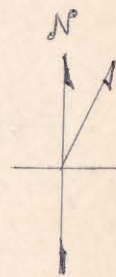

HOSPITAL BOARD AREA
Battle Mountain District
Lander County, Nevada
scale: 1" = 800'
August, 1967
D.L. DAVIS



EXPLANATION:
 SM QUARTZ MONESSITE
 SA HARMONY FA.
 O ROCK OUTCROP
 - VEIN-Fault

DDH DIAMOND DRILL HOLE
 MW MINE WORKING

PRINT 1/2 SIZE

DUVAL CORPORATION		
Geological Map of the Silver Leaf Claim Area, Little Grant, Arizona		
Scale of 1" = 100'		
Project	Map of 100'	Map of 100'
Scale	Map of 100'	Map of 100'
Map of	Map of 100'	Map of 100'

Bel Court
Battle Mountain, Nevada 89820
August 9, 1967

Hospital Board, Lander County
Battle Mountain, Nevada 89820

Attention: Mr. E. B. Swackhamer

Gentlemen:

Enclosed is my geologic report on claims you hold in the Battle Mountain mining district, together with the necessary affidavit on the Mispah, Silverleaf and Gold Dust claims.

As I explained to the District Attorney, this affidavit is in lieu of performance of annual assessment work as provided in Public Law 85-876, 85th Congress, S-2039, recorded in the Congressional Record, September 2, 1958. It is my understanding that the Lions' Club has been asked to contribute labor to open portals of some of the adits, as well. You may wish to file proof of labor by a separate instrument for the work which they have completed. This is not necessary, however, as my affidavit will be adequate.

If I can be of further service to you, please let me know.

Very truly yours,

DUDLEY L. DAVIS.

Enclosures

DLD:bc

*Ltr re payment
1/13/69
"acct. Rec file"*

PROOF OF PERFORMANCE AND COMPLETION OF
ANNUAL ASSESSMENT WORK

STATE OF NEVADA)
 : ss
COUNTY OF LANDER)

I hereby certify that a geological examination was made and map prepared at my direction in lieu of Annual Performance of labor as provided in Public Law 85-876, 85th Congress, S2039, September 2, 1958 on the following claims:

Claim Name	Certificates of Location Book	Page
Mispah, #1	12	463
Silverleaf, #1, #2	12	464-465
Silverleaf, #3, #4, #5	13	169-170
Mispah, #2, #3	14	286
Mispah #4	--	--
Gold Dust Nos. 1, 2, 3	13	294-295
Gold Dust No. 4	--	--
Gold Nugget	14	399

Note: The Gold Dust group of claims located by Percy Burridge are sometimes known as the Gold Top Mine group of Claims.

The Silverleaf group of claims were formerly known as the Little Giant claims. The Mispah group of claims were formerly known as the Irish Rose group or the Meadow Lark group of claims.

situated in the Battle Mountain Mining District of the County of Lander, State of Nevada, during the year ending 12:00 Noon, September 1, 1967.

The work described above was performed on August
2nd - 14th by _____

Such expenditure was made by or at the expense of The Board of Lander County Hospital Trustees of Battle Mountain, Nevada, owners of said claims for the purpose of holding said claims.

E. B. Swackhamer

Subscribed and sworn to before me this
_____ day of _____, 1967

PROOF OF PERFORMANCE AND COMPLETION OF
ANNUAL ASSESSMENT WORK

STATE OF NEVADA)
COUNTY OF LANDER) ss

I hereby certify that a geological examination was made and map prepared at my direction in lieu of Annual Performance of Labor as provided in Public Law 85-876, 85th Congress, S2039, September 2, 1957 on the following claims:

Claim Name	Certificates of Location Book	Page
Mizpah, #1	12	453
Silverleaf, #1, #2	12	464-465
Silverleaf, #3, #4, #5	13	169-170
Mizpah, #3, ^{#2} <u>#4</u>	14	286
Gold Dust, Nos 1, 2, 3	13	294-295
Gold Dust No.4, and	14	
Gold Nugget		399

Note: The Gold Dust group of claims located by Percy Burridge are sometimes known as the Gold Top Mine group of Claims.

The Silverleaf group of claims were formerly known as the Little Giant claims. The Mizpah group of claims were formerly known as the Irish Rose group or the Meadow Lark group of claims.

situated in the Battle Mountain Mining District of the County of Lander, State of Nevada, during the year ending 12:00 Noon, September 1, 1967.

The work described above was performed on August
2nd-14th by Dudley L. Davis

Such expenditure was made by or at the expense of The Board of Lander County Hospital Trustees of Battle Mountain, Nevada, owners of said claims for the purpose of holding said claims.

Subscribed and sworn to before me this
day of _____, 1967