

0480 0082

147
Item 90

SUMMARY
PRELIMINARY REPORT
DRISCOL-BUENA VISTA PROJECT
December 1985

F. W. LEWIS CO.
120 Greenridge Dr.
Reno, Nevada, 89509
Phone: 702 826 2404

INTRODUCTION

The F. W. Lewis Co has owned portions of the DRISCOL MINE since 1962. The property has had several lessees, the most recent being Hart Resources Inc. of Salt Lake City. Hart has notified its termination of the lease.

Exploration to date has developed an ore reserve in excess of two million tons, containing nearly 100,000 ounces of gold and more than 7,000,000 ounces of silver. This reserve is on only a portion of the project area, which has the potential of developing an ore body of the magnitude of the adjacent Fortitude deposit owned by Battle Mountain Gold Company (Duval/ Pennzoil). Fortitude has been reported to have an ore reserve of sixteen million tons containing more than 2,000,000 ounces of gold and nearly 10,000,000 ounces of silver.

LOCATION

The property is located in the Battle Mountain Mining District approximately 12 Miles South of Battle Mountain.

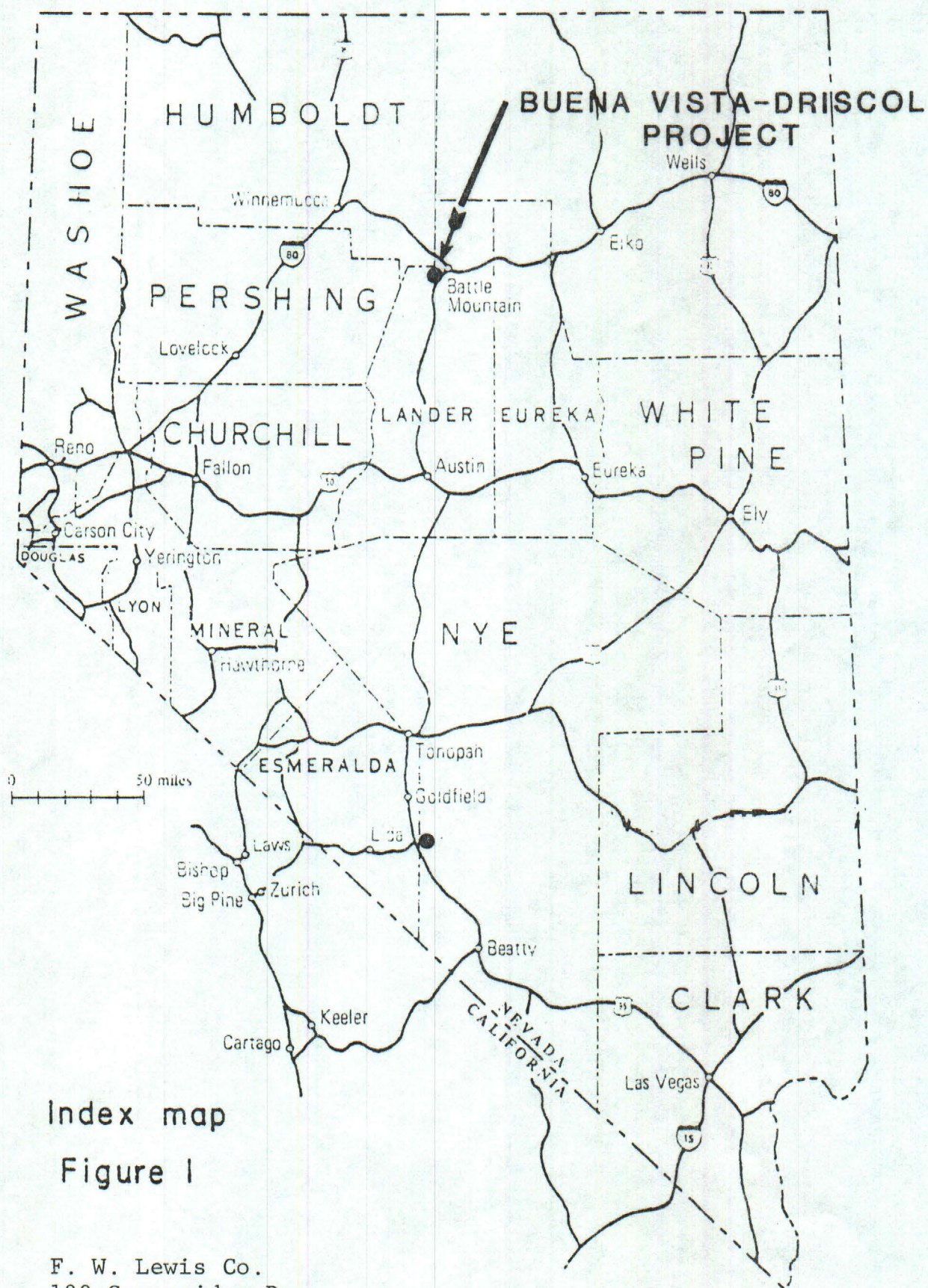

Index map

Figure 1

F. W. Lewis Co.
120 Greenridge Dr.
Reno, Nv. 89509
Ph: 702 826 24 04

PROPERTY

There are 356 located claims in the DRISCOL-BUENA VISTA PROJECT, two patented (deeded) mines, as well as a substantial concrete block mill building, concrete block assay lab., water rights, fenced trailer park, etc.

A Judgement in favor of Frank W. Lewis, suit No. 4222 in Lander County District Court, Battle Mountain, Nevada, quieted title in the patented mines, and the portion of the unpatented claims then held, in Favor of Frank W. Lewis.

A boundary agreement has been entered into to between the F. W. Lewis Co. and The Battle Mountain (Duval) Corporation and vertical minerals rights have been agreed to along the Edge of the Battle Mountain Gold - F. W. Lewis Co. Boundary in Copper Canyon.

LEGEND

- BUENA VISTA-DRISCOL PROPERTY
- DUVAL CORP. PROPERTY
- SOUTHERN PACIFIC RAILROAD CO. PROPERTY
- AMAX EXPLORATION CO. PROPERTY
- ELDON ROBERTS PROPERTY
- OPEN PIT GOLD MINE (DUVAL)

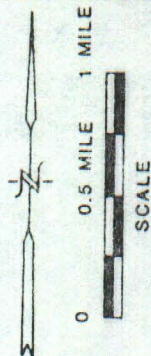

F. W. Lewis Co.

SCALE
APPROVED BY R.R. ROBINSON
DATE JAN. 1984 MINING ENGINEER
REVISED

OWNERSHIP MAP

BUENA VISTA-DRISCOL PROJECT
DRAWING NUMBER HR-1

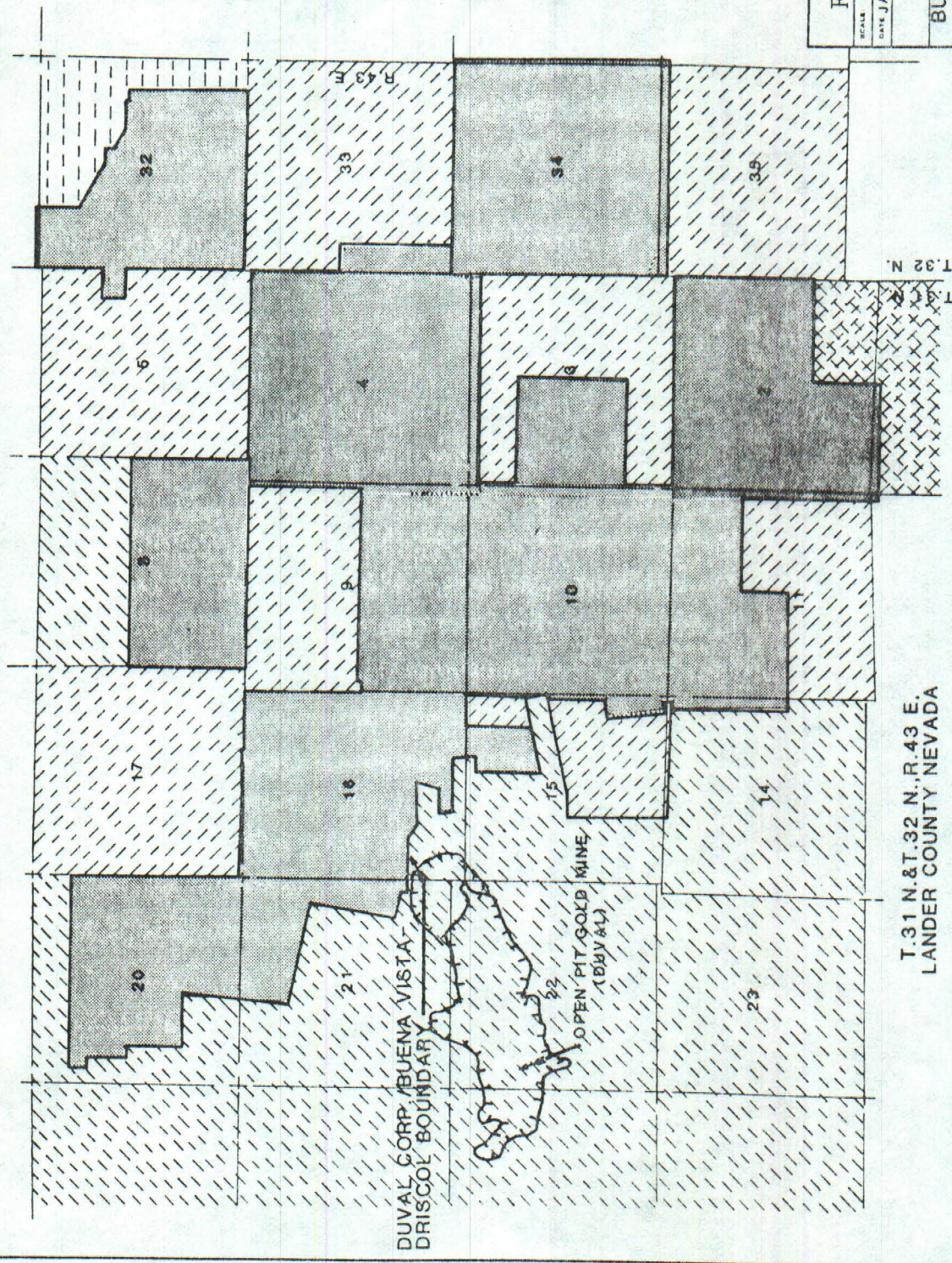



T.31 N. & T.32 N. R.43 E.
LANDER COUNTY, NEVADA

MINERAL ACTIVITY IN THE AREA

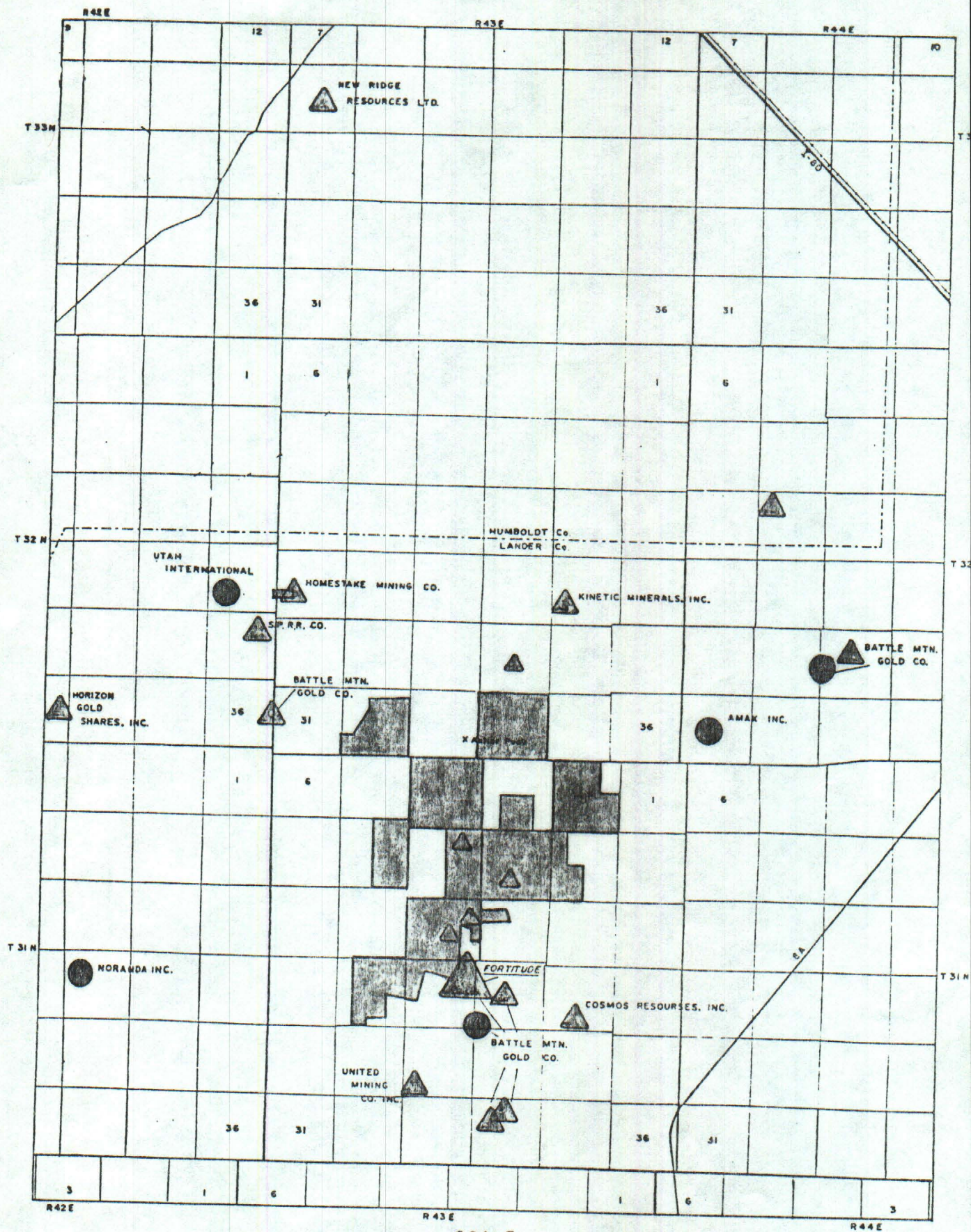
The Battle Mountain area is one of the most intensely active areas for mining and exploration in Nevada. Major sized deposits of gold, silver, copper and molybdenum, have been discovered within the immediate area of the DRISCOL-BUENA VISTA PROJECT.



-  F. W. Lewis Co.
-  Precious Metal Deposits
-  Base Metal Deposits

MINERAL ACTIVITY IN THE
GENERAL VICINITY OF THE
BUENA VISTA/DRISCOLL PROJECT

ANTLER PEAK, NEV.

RECENT EXPLORATION

Since 1980 an active program of exploration has been pursued on the DRISCOL-BUENA VISTA PROJECT. This program consisted of activities including surface geologic mapping, surface sampling, underground geologic mapping, underground sampling, old mine dump sampling and drilling. More than 8,000 samples have been assayed, with most of the samples derived from nearly 30,000 feet of drilling in 170 holes.

Most of the exploration thus far has been concentrated on a small portion of the project area. The bulk of the drilling has been in areas with the highest potential of developing ore reserves with the least work, and with very shallow drilling.

Four ore deposits have been developed and the potential of developing additional reserves in the DRISCOL-BUENA VISTA PROJECT are very good.

The area surrounding the 4 proven ore deposits have very good potential for additional ore reserve development surrounding the deposits as well as down dip on the deposits. These reserves can be developed primarily through drilling along the geologic trends of the deposits, and drilling for deeper continuations of the deposits. Much of this development could be undertaken as the existing ore reserves are mined.

Possibly the largest ore reserve potential of these four areas exists in the S.O.S. deposit area. This deposit is situated along the Trinity Fault System and the ore reserves are estimated along a strike length of about 2,000 feet. The fault system extends for a distance more than 6,000 feet and minimal

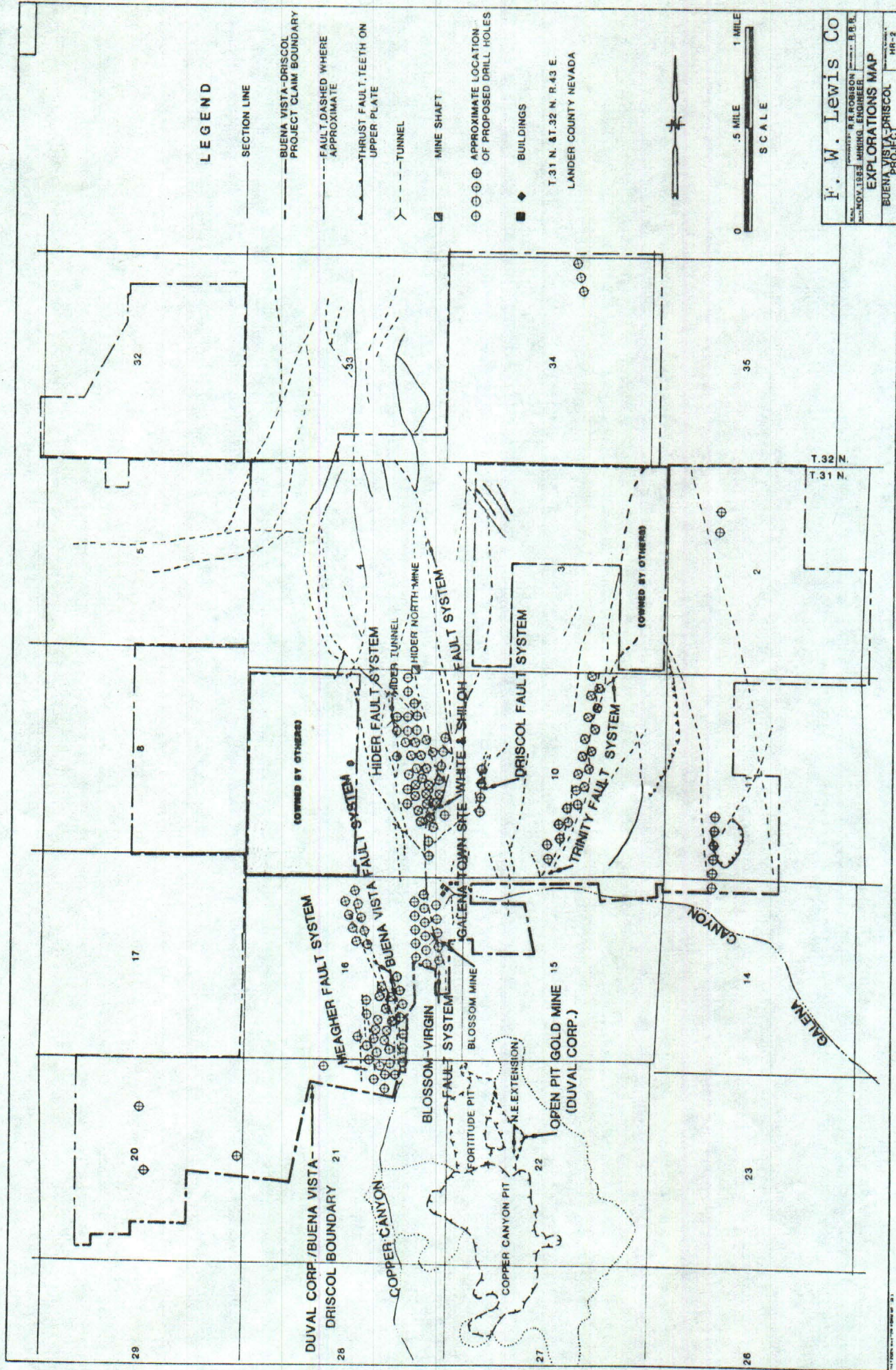

sampling along this additional length has shown samples that have assayed 0.24 ounces per ton in gold. This fault system is an extension of the same fault system on which the North East Extension Deposit of Battle Mountain Gold Company's deposit is located.

Exploration of other parts of the area is likely to develop new ore deposits, some of which will be similiar to those already found and the potential exists that a Fortitude Type Deposit may be found. In the area to the northwest of the Fortitude Deposit, the potential of finding an extension or another similiar deposit is good. Surface sampling of outcrop materials at a location one half mile from the Deposit assayed 0.08 ounces per ton in gold and at two other locations about a mile to the north, samples assayed 0.08, and 0.09 ounces per ton in gold.

RESERVES

The ore reserves of the DRISCOL-BUENA VISTA PROJECT total 2,048,500 tons containing 92,182 ounces of gold and 7,436,055 ounces of silver (Table 1.) These reserves are classified as proven, probable, and potential.

THE HIDER DEPOSIT contains an ore reserve of 796,000 tons which contain 0.022 ounces per ton of gold, and 6.57 ounces per ton of silver. These reserves are estimated over a linear distance of about 4,000 feet with an average depth of about 100 feet. The proven and probable reserves are based on 32 drill hole intercepts and surface sampling of ore grade mineralization over a distance of 2,400 feet.

THE S. O. S. deposit contains an ore reserve of 960,000 tons

which contain 0.061 ounces per ton of gold and 0.98 ounces of silver per ton. These reserves are estimated over a linear distance of about 2,000 feet with an average depth of about 100 feet. The proven and probable reserves are based on 11 drill hole intercepts and surface sampling of ore grade mineralization over a distance of 500 feet.

THE BLOSSOM DEPOSIT contains an ore reserve of 92,500 tons which contain 0.039 ounces per ton of gold and 9.12 ounces per ton of silver. These reserves are estimated over a linear distance of about 200 feet and to a depth of 250 feet. The probable reserves are based on 2 drill hole intercepts and underground channel sampling over a distance of about 100 feet.

THE BUENA VISTA DEPOSIT contains an ore reserve of 200,000 tons which contains 0.059 ounces per ton of gold and 1.83 ounces per ton silver. These reserves are estimated over a linear distance of 1,000 feet and to a depth of about 100 feet. All of the reserves are potential and are based on 3 drill hole intercepts and surface sampling over a distance of about 1,000 feet.

All reserves figures are taken from information supplied by Hart Resources.

METALLURGY

A few preliminary tests were run on drill cuttings from one area on the property indicating good extraction by Cyanidation. However, as the tests were not comprehensive nor were the tests made on all four of the indicated deposits the F. W. Lewis Company does not consider that there is sufficient information to come to a good conclusion about extraction at this point in the development of the property.

OBJECTIVE

The objective of the F. W. Lewis Co. is to enter into an agreement with a Company financially capable of placing the mine in production, and capable of continuing exploration to fully develop the property potential.

TABLE 1

BUENA VISTA-DRISCOL PROJECT

ORE RESERVES

JUNE 1, 1985

CLASS	AREA	TONS	GRADE oz/ton	
			GOLD	SILVER

PROVEN				
	HIDER	296,000	0.022	6.57
	SOS	240,000	0.061	0.98
		-----	-----	----
		536,000	0.039	4.07
PROBABLE				
	HIDER	185,000	0.022	6.57
	SOS	240,000	0.061	0.98
	BLOSSOM	42,500	0.039	9.12
		-----	-----	----
		467,000	0.044	3.93
POTENTIAL				
	HIDER	315,000	0.022	6.57
	SOS	480,000	0.061	0.98
	BLOSSOM	50,000	0.039	9.12
	BUENA VISTA	200,000	0.059	1.83
		-----	-----	----
		1,045,000	0.048	3.18

TOTAL ALL AREAS		2,048,500	0.045	3.63