

United States Forest  
Department of Service  
Agriculture

Toiyabe National Forest  
Bridgeport Ranger District

P.O. Box 595  
Bridgeport, Ca. 93517  
(619) 932-7070

189

189

ITEM 60

Reply to: 2810/1950

Date: November 21, 1996

04100059

Nevada State Clearinghouse  
Dept. of Administration  
Capitol Complex  
Carson City, NV 89710  
Att- John Walker

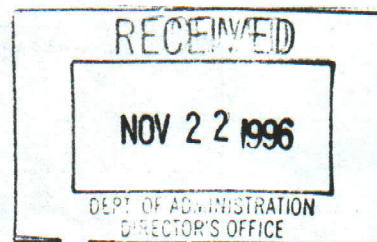

Dear Mr. Walker:

In March, 1996, I requested your comments regarding a proposal by Nevada Goldfields Inc. to expand their Juniata Open Pit Mine located approximately one mile east of Aurora, Nevada, in T.5 N., R.28 E., sections 17 and 20 MDM. This proposal was an extension of a previous pit expansion project approved by the Forest Service during October, 1992.

Since my original scoping letter, Nevada Goldfields has amended their proposal to include additional details regarding their new waste rock dump and expanded tailings pond. The proposal involves 24 acres of disturbance on private lands and 79 acres of disturbance on National Forest System lands.

The Bridgeport Ranger District is currently conducting an environmental analysis of this proposal (please see attached map). If you have any issues, concerns or questions regarding this proposal, please contact Cliff Shaw at the Bridgeport Ranger District, P.O. Box 595, Bridgeport, CA 93517. I would appreciate receiving any comments you might have by December 31, 1996.

Sincerely,

Kathleen Lucich  
DISTRICT RANGER

Enclosures



**TOIYABE NATIONAL FOREST**  
(BRIDGEPORT RANGER DISTRICT)  
**NEVADA AND CALIFORNIA**  
**MT. DIABLO MERIDIAN**  
1984

Scale  $\frac{1}{4}$ " = 1 Mile

1	4	0	1	2	3	4	5 Miles
---	---	---	---	---	---	---	---------

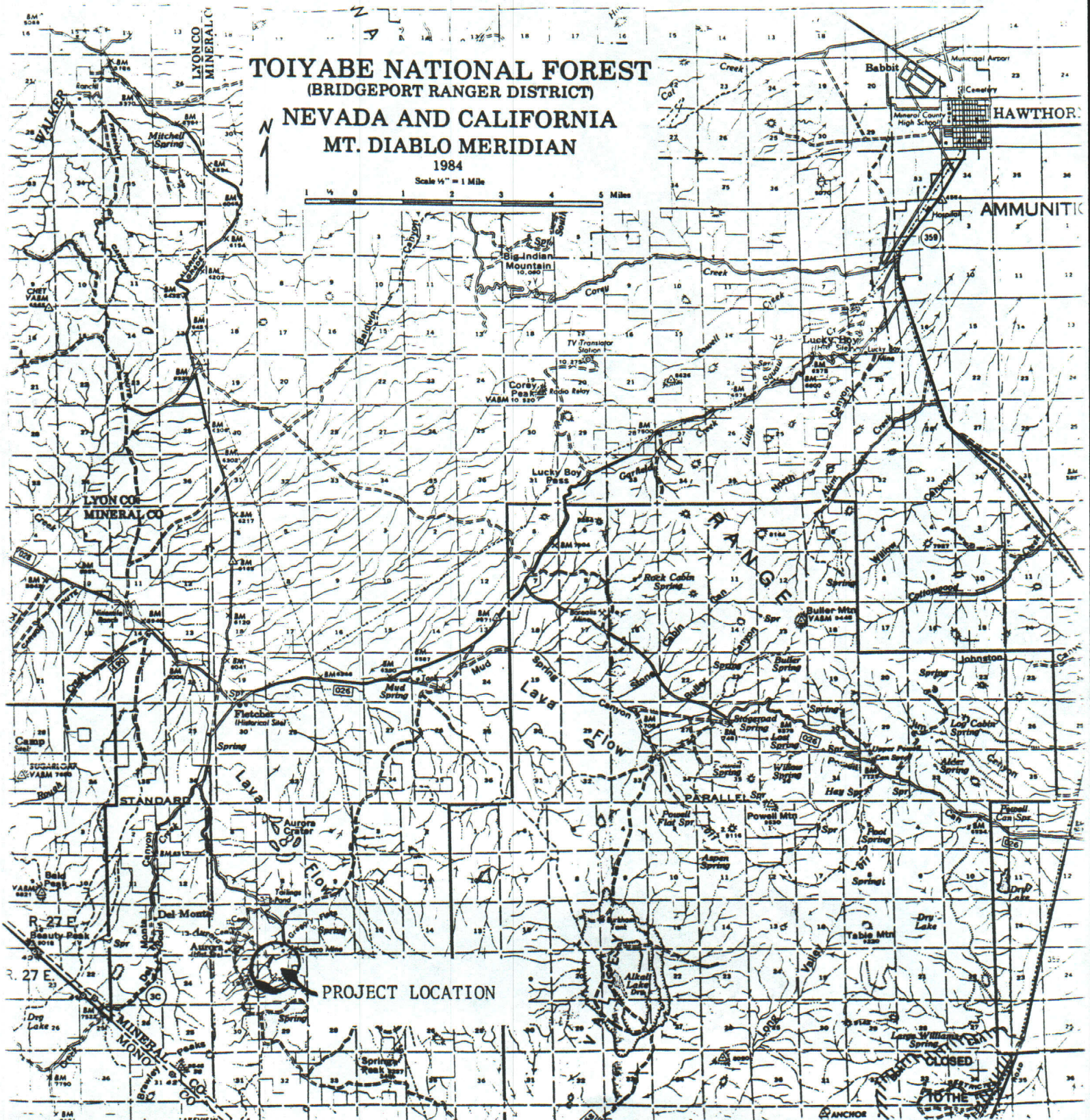



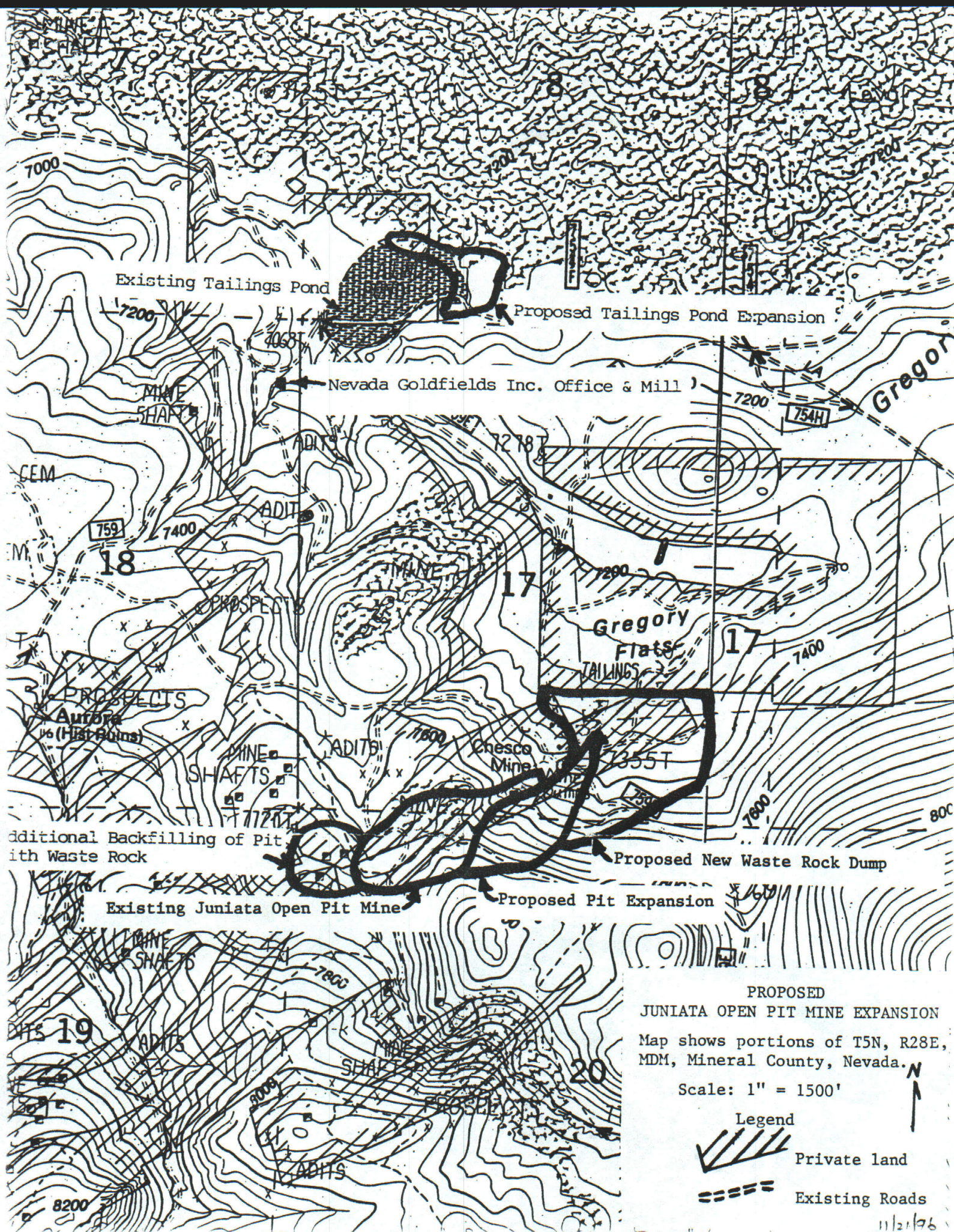

# PROPOSED JUNIATA OPEN PIT MINE EXPANSION

Map shows portions of T5N, R28E, MDM, Mineral County, Nevada.

Scale: 1" = 1500'

## Legend

- Private land
- Existing Roads

11/21/76