

0260 0027

267

ITEM 27

October 11, 1961

Mr. J. L. Fisher,
Box 523,
Des Moines,
Washington.

Dear Mr. Fisher :

It is a far cry from your kind reply of July 29 to this date, and I am sorry that I have been so slow in assuring you that your interest in my Majuba interest has been appreciated.

I left the Crescent City area, a week ahead of schedule, mainly, I am sure that I could not get that hill out of my mind. Saw Mrs. Myler, at that time, in Reno, found the property available, and immediately went back out there to look over the situation. Convinced that the door had not been closed on the tin vein possibilities, arrangements were made with Mrs. Myler, and later with Al Bilmet, and we are now getting ready to do something about it.

I am in touch with two reputable contractors, weighing and balancing the costs of each, laying out the crosscutting and the drilling we intend to do, and shortly will be moving back out that way. The chances are, that by early November, I will be a Nevadan again.

Your comments on the Greenan period were very helpful and greatly appreciated. The reference you made to the five feet of unusually good mineralization, fits in to my interpretation of the copper area, and I hope to find out more about it in the next few months. But my main interest, as it was in 1941 when Freeport knocked the props out from under us, remains the tin area. As far as I am concerned, and as I concluded in 1941, this is a matter of the proper interpretation of faulting, certainly there has been some systematic offsetting, and I continue to believe that we will find continuity of structure, once we get beyond the influence of the Majuba fault system.

I am very anxious to meet you, and I feel that with the open door I extend to a property that you once found to be intriguing, as well as the fact that Florence in Reno, will bring you and Mrs. Fisher through the area in the near future. I can assure you that it will not be run like an 'Oak Ridge'.

Your references to the interpretation on the old Freeport map that was at your disposal warmed my heart. I am glad that someone found it of merit. I was also entertained to find maps and sections bearing the D.L.E. in Mrs. Myler's file. It is a property I have always had a great deal of respect for, and I hope this time to prove that I have not been just a dreamer.

Best regards,

David LeCount Evans.

CURRENTLY - AT
Box 602 - CRESCENT CITY,
CALIFORNIA.

July - 25 - 1961

MR. JOE FISHER -
P.O. Box 523,
Des Moines,
WASHINGTON.

DEAR - MR. FISHER:

MRS. J.W. OSMUN - a mutual and good friend - y
Reno - Nevada - has suggested that I write you.

In 1940 - I examined - recommended and supervised the
Majuba Hill property for Freeport Sulphur. Possibly Florence
has told you that some years were asked when Freeport -
dropped the option. That was true indeed.

Since Freeport's effort 20 years ago - Greenan
did, I understand, considerable work - and in the middle
fifties. The present owner did more. I am in this area
until mid August - and plan to return - to Kansas. Via
Reno - Lovelock etc.

I have my own maps - But am most anxious to add
later development & information to them before evaluating
the Majuba - 1961 - possibilities. Florence has told me
of your interest - as you supervised Jim Greenan's work.
and thought that perhaps - you might be able to sketch
for me - the exploration and stoppage of that period.

If such is possible - anything you can let me see - via
the Crescent City address will be greatly appreciated. My
interest in Majuba - is genuine. Yours very truly
D.L. Ross

Box 523 - Des Moines, Washington
July 29, 1961

Dear Mr. Evans:

Your letter of the 25th. arrived just yesterday and was much surprised to hear again of anything pertaining to Majuba Hill, which I had last seen during the summer of '53 when my wife and I stopped over a few days in Imlay to visit Florence Wallace and made a run out to the old camp to find a mill being built and almost finished to the shake-down run and was amused to encounter so much " Hush, hush " from the few people who were working there for I did not introduce myself but from the amount of security about a working that I knew inside out was only laughable to me. I had only to close my eyes to imagine I could be at White Sands or Oak Ridge and inside the stockade. I don't remember who the people were but as I recall they were not well known mining figures of the west or I am sure I'd have known something of them, at least by reputation.

Jim Greenan and George Kerr became interested in the property in the summer of '42 and to begin with at least, their chief interest was chiefly because of the showing of tin in the form of cassiterite. The then owner, a cantankerous Irishman named Ed. Myler had paid attention too, to this mineral and had stacked about a carload of high grade and two carloads of low grade on the dump just outside the main upper tunnel. This ore was later milled by Jim at one of the two tungsten mills west of Lovelock and conc. sent to Texas. They had paid something to Myler, \$ 5,000 I believe to hold the ground and sent to Salt Lake for me to come over and sample the ground and stake some additional claims which I did. To be with me in this work they sent up Frank Maloney from Reno and after we had sampled the tin as thororly as was necessary we free-lanc- thru the mine looking over the copper showing in an open stope (The main one) and found that in addition to what we found in the backs which was quite good and in some places quite fancy as there was considerable cuprite with the usual showing of native, however I must admit that the best of it had been left in a pillar and as you might know would have to be left till the very last thing to take. What intrigued both Maloney and me was the fact that there was a considerable showing of chalcocite in what had been left as a hanging wall and as you will remember there was a gov't bonus of 15¢ clear of any penalty or charge in addition to the, then, market-price of 12¢ and as you will know too, that meant one could mine at a profit ore that would only go a little better than 2 % and while I do not know how well Greenan and Kerr ^{did} on the operation I am quite certain they must have split better than \$100,000 per year while they were there. Both of these men were skeptical of the value of the copper showing but were later to feel quite pleased at the outcome.

After I left there in '44 their operation was pretty well worked out but after they turned the property back to Myler, the latter did some work but I don't believe he ever shipped any of the ore but he may have. His work was above the level and in the first X-cut which we had driven earlier but found the ore so lean we never followed it above the level but he did and on a visit there once while I was on a Placer south of Mill City on Willow Creek, the ore he was working on looked quite good. Just beyond the big stope and in a x-cut which takes off to the right (east) there was an old winze with no timber left in it and continuing into the x-cut a short ways to it's face we had put in a diamond drill hole that cut about five feet of what must have been quite good ore. Unfortunately, instead of cutting off off the sample (sludge) the driller went right on to his five foot mark and then did the same with the next cut which made two, much diluted samples but I remember the core which was almost 100% recovered was very nice mineral. The hole was continued to the showing I have just described that Myler later raised on but no one, as far as I know ever drove over to actually look at the stuff we found in that drill hole.

I should say that the ore in that drill hole was the best prospect in the mine if it is still there. By the way, the tin showing was straight on past to the north, perhaps 150 feet or so and while there was scattered showing of cassiterite all around thru the copper, that was the only one that approached anything minable.

I will try to make a sketch of the approximate opening as they were when I left the property but I have understood that much of the country that had been stoped had caved badly but of that I would not know.

Hope this may be of some help and only wish I might have been around that part of Nevada when you get back there next month for we still have quite a few good friends thereabouts. With best good wishes for your success there,

I Am, Yours very truly,

A handwritten signature in dark ink, reading "J. L. Fisher". The signature is written in a cursive style with a horizontal line extending to the right.

J. L. Fisher
Des Moines, Wash.
Box 523

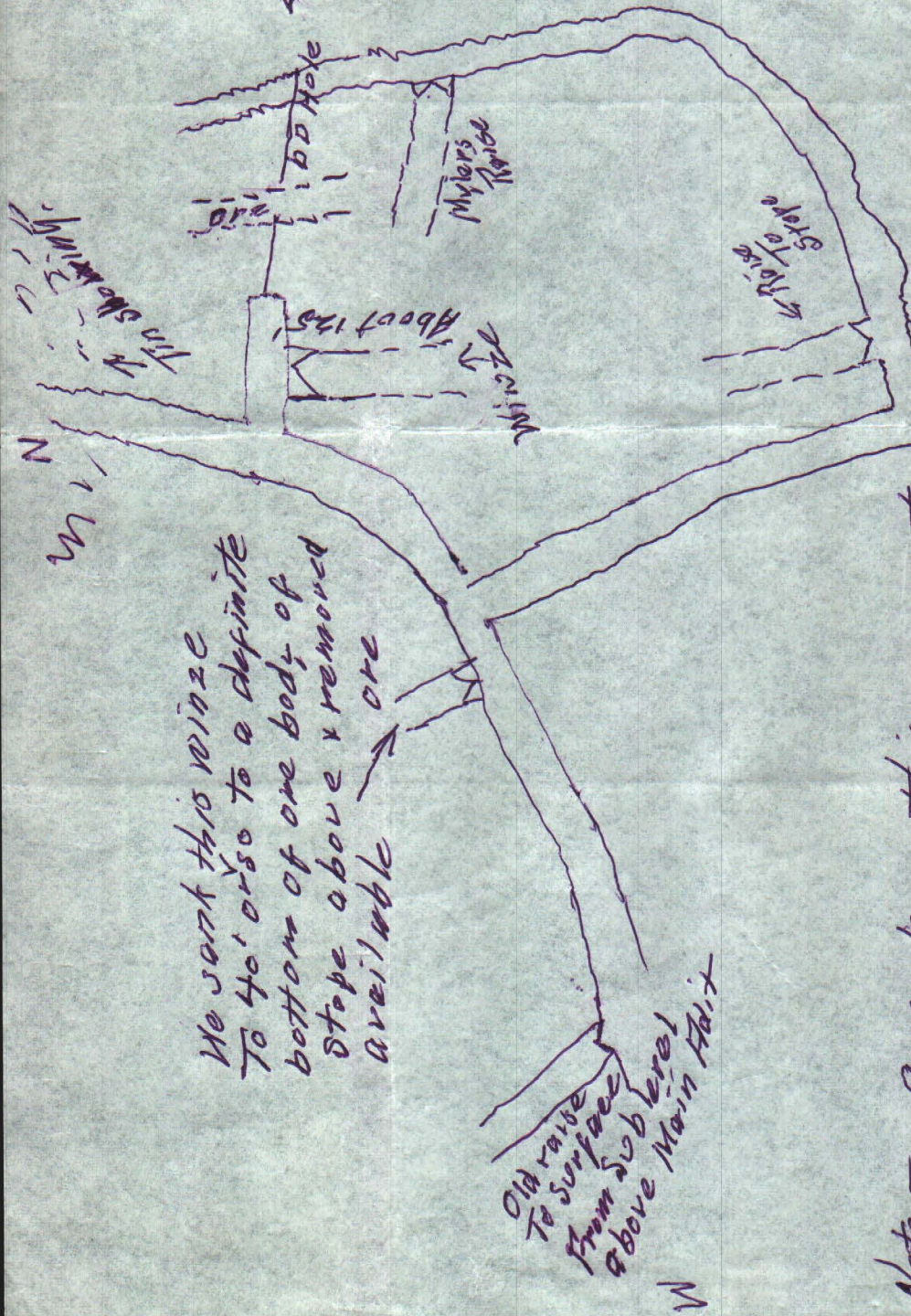

DD Hole as I remember was around 150' or less + ore about 5' in width.

We sank this winze to 40' or so to a definite bottom of ore body of stope above + removed available ore

Old raise to surface from sub level above Main Adit.

Note - As you know, this was not

a fissure vein at all, but a volcanic plug with the ore segregated area which had no definite HW + which was by far, best above adit level.

— During war time there, and very detailed Freeport Sulphur map was at our disposal which showed the property to be exactly what I think it is — a quite large + very low grade deposit, a very well drilled

It occurs to me that among Jim Greenans effects to that drill be some reference to that drill hole but I doubt it for he was engrossed with a lot of outside interests about that time

Majuba Hill Mine

Portal

MRS. J. W. OSMUM -
805 - REAVES LANE
RENO.

May 23, 1962

Dear Florence:

Certainly appologies are due you, for the long length of time it has taken me to pick up the pieces from last July to now; you may have wondered what happened to father and son after they left the Sparks post office, heading for California, in search of adventure; we have been inexcuseably silent, but until I had something definite to report I didn't want to write; too often, one talks big and then fails to produce; I have seen many of the type in the last 35 years and never want to eneter that category.

As you prbbably surmised, I have never lost my interest and faith in Majuba, and had that very much on my mind, when I saw you in July. I followed up your suggestion, among other moves, wrote, Mr. Fisher up in Washington, had a very nice letter from him, in which he too expressed similar confidence, and told me something of the Greenan operations. In the meantime, we were able to arranges leases and options with Mrs. Myler and Al Gilmet, have struggled through a Bureau of Mines waiting period, for which we got nothing in the way of satisfaction, and now that that is over with, are ready to get started on some work.

Until I could say this, definitely, I did not want to start shouting. The way things look at this writing, before the first of the month, a contract for underground mining will have been arranged, and men and equipment will be moving in. At least such is my hope. I have been on the verge of making such a statement for the last two months, and each time there have been further delays, but now it seems that matters are under control.

I am also writing Mr. Fisher, and again suggesting that he make Majuba a port of call; I know how very interested he has always been, and think that the possible approach I have worked out will interest him.

In the meantime this is written to tell you how very good it was to see you again after all these years, and how I am looking forward to seeing you and meeting your husband soon.

I do hope that the silence of many months will not be held against me, as much as I deserve it.

Sincerely,

David LeCount Evans.

May 23, 1962

Mr. J. L. Fisher,
Box 523,
Des Moines,
Washington.

Dear Mr. Fisher:

This is just a line to assure you that I still hope to see you in Nevada. Matters have been going slowly, mainly due to the fact that the group was interested in the possibility of getting O.M.E. help.

An approach was made to O.M.E. in mid November, reports submitted in full after I had returned from some work in Haiti, and we sat around waiting for an engineer to examine the property until February; after all of this, and as was to be expected, the Bureau of Mines would not go along; had they done so they would have been reversing decisions of 1940, 1945, et cetera. My feelings regarding the U.S.B.M. had better be left unsaid; in the case of Majuba they have always been hard to figure out; I don't understand their philosophies.

But in a sense their lack of interest is a blessing; I could picture myself making a trip to San Francisco every time any change in an agreed upon program appeared wise. On our own we can operate with complete fluidity.

I have not written until now, since things have been dragging along since February. But now everything appears to be in order and I feel that we will be moving into the property by June 1.

Our first efforts will be devoted to crosscutting on the Tunnel 2 level, cutting the extensions if possible and drifting on the results. From crosscuts and drifts, the results can be further filled out by drilling with stoper and jointed steel. My first purpose is to prove that the tin area has continuity, in short to destroy the 'pocket' image given Majuba by Ward Smith and the U.S.G.S. in 1940, from which the hill has never recovered.

I do hope that you will still be interested in dropping by, and look forward to seeing you. I will stay either in Lovelock or Inlay, and mail addressed to General Delivery at either post office should reach me.

Sincerely,

David L. Evans.

Post Office Department
REGIONAL OFFICE

805- Reeves Ave
Reno, Nevada
June 17, 1962.

Dear David:

I was very pleased to receive your letter of May 23, 1962, telling me that you are taking Majuba over. I so wish you every succe ss - because I too believe in that Mine and think that the only thing that can bring Pershing County back is the opening of the Mines.

I was happy to see you and your Son at the Sparks Post Office and hope that when you get into operation at Majuba and are down this way that you will again look in on me.

All the best and may Majuba come into its' own.

Sincerely,

A handwritten signature in blue ink, appearing to read 'Florence', with a long, sweeping horizontal line extending to the left.

Florence Sears Osmun