

267

ITEM 24

0260 0024

February 16, 1942

Mr. Ira B. Joralemon
315 Montgomery
San Francisco, California

Dear Mr. Joralemon:

I tried to reach you by telephone today and make an appointment to see you Wednesday or Thursday in San Francisco. The purpose of my call was for you to meet a very good friend of mine, Mr. David L. Evans, who is a geologist and a classmate of mine at Stanford. I can't recommend him too highly and I know he is the type of man you would like to meet and who will consider it a great privilege to make your acquaintance.

Mr. Evans has done considerable work on a property in Nevada which he feels was not developed to the fullest extent by his associates, and which he feels during this crisis has sufficient merit to warrant further careful investigation and consideration.

I am asking him to call you Wednesday to see if it is possible for you to see him for a few minutes as I believe it would be well worth while and he will be in San Francisco only one day.

Trusting you had a pleasant trip and hoping to see you in the near future,

Sincerely,

Benj. C. Charles

BCC n

CC to David L. Evans- Box 95, Palo Alto

February 19, 1942

Personal

Mr. Percy G. Dobson
Summit King Mines, Limited
Box 632
Fallon, Nevada

Dear Percy:

In regard to the tin deposit we were discussing; Mr. Evans was in the office Monday and I tried to arrange an appointment in San Francisco with Mr. Joralemon, but find that he won't be back for another week. A copy of my letter to Mr. Joralemon is enclosed for your information. I thought possibly Mr. Evans could see him on his way North.

Time is more or less the essence of this proposal and so I am asking if you will please call Mr. David L. Evans; his address is 860 Monroe Street, Reno, telephone 22321. In view of his being associated with Free Port Sulphur he feels it would be better if you would call him and make an arrangement with him to meet at his home some evening and go over the matter carefully. I would appreciate it if you would do this as soon as possible as I believe it is something that might be very helpful to the Country and profitable to your company. I have informed Mr. Evans that you will call him as he desires it this way even though they have dropped and forgotten the property. He will tell you all about it when you see him.

I will be only too glad to intercede and act on your behalf to secure a reasonable option, as it might be possible the owners would place too great a value on the property knowing the interests you represent.

I am enclosing also a copy of my letter to Mr. Evans and please let me know your ideas on the matter.

Sincerely,

Benj. C. Charles

BCC n

February 19, 1942

Mr. David L. Evans
860 Monroe Street
Reno, Nevada

Dear Taffy:

I am very sorry you weren't able to meet Mr. Joralemon and I trust you received a copy of my letter in Palo Alto.

I have written Mr. Dobson of Summit King and asked him to call you in accordance with your wishes and suggested that he make an appointment with you at your home in Reno some evening. I know both of you gentlemen will get along beautifully and let me know if I can do anything to assist either of you.

It was impossible for me to see the owners of the property in Reno as I was delayed and unable to accomplish all I had planned. However, if either Dad or I can assist in consummating an option in behalf of the principals we will be only too glad to act.

Hope you had a pleasant trip and with kind regards,

Sincerely,

Benj. C. Charles

BCC n

PS Unable to reach your house in Reno; no answer on the telephone so called on the Keiths and advised them.

CLASS OF SERVICE

This is a full-rate Telegram or Cablegram unless its deferred character is indicated by a suitable symbol above or preceding the address.

WESTERN UNION

1201

SYMBOLS

DL=Day Letter

NT=Overnight Telegram

LC=Deferred Cable

NLT=Cable Night Letter

Ship Radiogram

R. B. WHITE
PRESIDENTNEWCOMB CARLTON
CHAIRMAN OF THE BOARDJ. C. WILLEVER
FIRST VICE-PRESIDENT

The filing time shown in the date line on telegrams and day-letters is STANDARD TIME at point of origin. Time of receipt is STANDARD TIME at point of destination

3FO RO 16

FALLON NEV 1010A FEB 25 1942

DAVID L EVANS

Freeport Sulphur Co

860 MONROE ST RENO NEV

Hagette Bldg

VERY SORRY UNABLE TO COME TO RENO THIS WEEK BUT
WILL LOOK YOU UP SOME FUTURE TIME

PERCY G DOBSON

1017A

22321

FREEPORT SULPHUR COMPANY

1804 AMERICAN BANK BUILDING
NEW ORLEANS, LOUISIANA

February 25, 1942,

Mr. Benj. C. Charles,
510 West Sixth Street,
Los Angeles, California.

Dear Ben,

Mr. Dobson's letter, concerning the possibilities of a future meeting in Reno, arrived several days ago, and at that time the chances of my being in Reno for at least ten days were excellent.

However, yesterday it was brought to my attention that I would be leaving next Tuesday for Oregon to be gone about a month.

I called Mr. Dobson by phone last night and suggested that he and Mrs. Dobson come up to Reno for dinner this next Friday Night. The enclosed wire, just received indicates that such an arrangement is not feasible. And so it appears that I must leave without being of much help to you.

You of course have Fred DeLongchamps Reno address in the event you get hot and bothered. If not call Kitty and she will be of any help to you she can.

With best regards to yourself and John,
and to the respective Senoras,

David LeCount Evans

March 21, 1942

Mr. Julius Rodman
American Smelting & Refining Co.
120 Broadway
New York, N. Y.

RE - TIN MINE
MAJUBA HILL DISTRICT - NEVADA

Dear Rodman:

A very good friend of mine, Mr. D. L. Evans who is a Geologist and field man for the Freeport Sulphur Co. and who was a classmate of my son, Ben, at Stanford, has discovered what he feels confident of as being a good tin mine if it is properly developed a little further.

Here is the story; Evans was put on the job of developing some work on this property when under option to his Company and they spent around \$25,000. there. The last \$5,000. was not spent under his direction as he was called on another job. I also understand the U.S. Government has taken no serious interest and here is a property with TIN ore showing averaging from 5% to 6% in Tin (Cassiterite) and around 200,000 tons of Copper ore averaging around 3% Cu.

Evans knows tin ore as he spent two or three years at the tin mines in Bolivia. He has asked me since his Company is no longer interested and he has all this data, if I knew of a good Company who might be interested in such a proposition. I told him I knew you and Mr. Guess in New York and it might be possible this would appeal to Mr. Guess if properly presented. Evans has all his maps and details and feels he is free to show them to you if interested. However, he asks that this all be considered in confidence as he still wants to hold his job and not be considered a promoter. However, he did say he is so sure that this property will develop into a real producer, and profitably so, if certain work is done to fully carry out the plan for development that he would gamble his job and take over this work if it was desired. So he has faith and plenty of it.

There are two or three tunnels on this property. One around 3000 feet and another 700 feet etc. etc. The ore occurs in step faults as I understand it and there is enough Copper ore developed to make this a Copper producer as well as Tin producer if the tin ore continues to develop as he feels very confident it will.

The terms for the purchase of these properties is very easy. I believe a \$100. per month is required and a few small payments later on and the whole deal on 10% royalty for the balance. Evans feels so sanguine about this whole deal he does not want anyone to disturb the owners by making inquiries of them as they will surely raise their sights if they felt he was still interested. He does not want anyone to disturb it for that reason. He has a good job with the Freeport Company and wants to hold that too. So please ask Mr. Guess to carry on this preliminary correspondence through me if interested. After we know if you care to consider further, then I will ask Evans to send you all his data, maps, and assays, etc., etc. and carry on direct.

April 1, 1942

Mr. David L. Evans
Route 3, Box 902
Grants Pass, Oregon

Dear Taffy:

Thanks for your kind letter and I'm sorry for not answering more promptly. However, the Charles family were all down with the flu at the time and when I returned to the office I got busy in the matter and you will find enclosed Dad's letter, together with the reply from the A. S. & R.

Now, when you were in Reno, did you check on the matter and is it still available? I have since discussed it with Major Boyd who is a close friend of John's and mine and geologist for Pacific Coast Borax and other interests. He can get someone also to go in there and pick up where you left off.

I believe first the property should be tied up and I will do it and to assist me could you outline about what the owners will want and roughly what you estimate it will cost. What property we should have tied up and approximately what terms you feel we can get and what terms your company had it on. Further, what interest do you want and to protect you is it satisfactory to have it in my name and later assign it to you.

Let me know at your earliest convenience. I will carry the matter through to conclusion and see if we can't get something going quick.

It was great to hear you didn't have to go back to New Orleans and what a grand country you picked for your summer vacation. Your new residence sounds too good to be true. Thanks for the invitation and maybe at the A. S. & R's or someone else's expense we can visit you - lets hope.

Extended your greetings to all here and advise me your instructions.

Sincerely,

FREEPORT SULPHUR COMPANY

1804 AMERICAN BANK BUILDING

NEW ORLEANS, LOUISIANA

Box 190
Grants Pass, Oregon
April 3, 1942

Mr. Benj. C. Charles
Charles, Keith & Rivers, Inc.
510 West Sixth Street
Los Angeles, California

Dear Ben:

Your very good letter of April 1 reached me yesterday and only the necessity of establishing an office prevented an immediate reply. However, we are now thoroughly entrenched at 607 East "G" Street with Post Office Box 190. I trust that this will reach you Saturday by special delivery service to your home.

As far as I know, Majuba is still open. However, this is a qualified statement inasmuch as the bulk of my time since seeing you last has been spent in the field.

If possible, and if you are still as interested as I am, I strongly urge that you get the place tied up. That to me is the first step, thus protecting yourself and giving yourself time to interest the proper parties. Concerning myself, forget me entirely. I am not interested in benefiting financially from Majuba; I am too close to the property and am in no position to promote it for my own interest. It is an Evans' interpretation of mining ethics. To see someone else complete the work which I consider unfinished is in my own mind reward enough. My interest is based on the fact that I originally recommended the property that I still believe in and that I would like to see my original judgment vindicated. I also know the country's need for tin and believe that in pushing Majuba I can be of some help.

The property is divided into three groups, as follows:

- (1) Three Majuba Hill patented claims belonging to Harvey D. Reber, 225 North Rebecca Street, Pomona, California, and last under option to Fred J. DeLongchamps, Gazette Building, Reno. Mr. Reber also has a full section on the northeast corner of the area of questionable importance.
- (2) A group of claims surrounding the Reber claims known as Majuba A to M, inclusive, and owned by Alfred Gilmet, 518 West Second Street, Reno. These claims are staked and recorded in the name of Marguriete F. Smith, Gilmet's sister-in-law.
- (3) A group of claims mixed in with those belonging to Gilmet and belonging to George H. Copley, 214 South Carson Road, Beverley Hills, California.

done to
done to

An appraisal of these groups on the basis of knowledge to date indicates that the Reber claims are of the utmost importance and that groups 2 and 3 have only a nuisance importance. It is not inconceivable, however, that established trends may someday enhance the importance of the Gilmet group. DeLongchamps had the Reber ground for a total of \$15,000 with certain royalty stipulations and a minimum payment of \$100 per month. We were to pay over a certain length of time (ending in 1949) \$40,000 for this group. In the same way, Copley was to get \$40,000, and Gilmet, through himself and his sister-in-law was to get \$105,000. Gilmet also ended up with a 3% perpetual interest in net profits from any operation. Copley had a 2% interest. Whereas it appears stiff, we had only the payments of \$100 per month to Reber to meet for the first 18 months, which, in a sense, is free prospecting time.

The above should give you a picture to start with. Perhaps you can improve upon it -- it is conceivable that our failure may have made them all the more approachable.

From a procedure standpoint, I would --

- Pom. 1-3502*
- (1) Approach Harvey Reber, find out from him if his ground has been returned from DeLongchamps, and if it is open option it yourself. If not, go directly to DeLongchamps, whom you will find a very decent person to do business with.
 - (2) Only after you have a hold on the patented ground, approach Copley.
 - (3) After (1) and (2) go after Gilmet. In the case of Gilmet, do not use my name -- or Freeport's name -- (he does not like me or us) and crush his enthusiasm if possible.

In conclusion, since my interest in Majuba, placer tin has been found at Rabbit Hole, 25 miles northwest of Majuba and at Placeritas, and tin was reported at Maude's Well in the same district near Scossa several years ago. It is an area of significance and such a distribution in my mind is not all coincidence.

The enclosed copy of a letter to your father explains the situation on maps and reports. My hands are more or less tied, but I feel quite at liberty to talk the thing over with anyone interested. I do hope that such an arrangement can be made. You naturally will treat the lease and option data in confidence.

My best regards to Alta and yourself.

Yours very truly,



David LeCount Evans

DLE*all
Special Delivery Air Mail
to 820 Westchester Place
Los Angeles, California

Enclosure-1

Box 190
Grants Pass, Oregon
April 3, 1942

Mr. W. W. Charles
510 West Sixth Street
Los Angeles, California

Dear Mr. Charles:

I have had Ben's letter and the enclosed letter to you from A. S. & R. expressing interest in the Majuba Hill property. I only wish that I could feel free to send on to you my own personal maps on the subject. I have given it considerable thought and have come to the conclusion that since the owners did not receive such detail such a distribution of data might not be advisable.

However, I can see absolutely no reason why I should not talk freely on the subject and would be very glad to do so as I did with you and Ben with any representative of any company which you might desire to interest.

It is not inconceivable that much of this data could be prepared for publication. In that event, it would become public property and there would be no objection to giving you any and all details. I do, however, intend to sound out my superiors on the request from A. S. & R. and will tell you at a later date of their reaction.

Regarding their query as to compensation, believe me when I say I am not interested in any. Majuba was my recommendation and to see the problem solved as I believe it can be is reward enough.

With best regards and hoping to see you and Ben or any of your friends in Grants Pass, I am

Yours very truly,

DLE-s
cc-Mr. Benj. C. Charles

David LeCount Evans

FREEPORT SULPHUR COMPANY
1804 American Bank Bldg.
New Orleans, Louisiana

Box 190
Grants Pass, Oregon
April 4, 1942

Mr. Julius Rodman
American Smelting & Refining Company
120 Broadway
New York City

Dear Mr. Rodman:

In yesterday's mail I received a copy of Mr. W. W. Charles' letter to you regarding the Majuba Hill tin-copper occurrence, and its possibilities. Unfortunately, I have been moving my family from Reno to Grants Pass, which explains why the letter did not find me more promptly.

Mr. Charles and I are very good friends, but he is such a good friend that he has given me more credit than I deserve. I am not an expert, having spent only two years at Potosi Bolivia — that was my only tin experience.

To further clarify the Majuba Hill picture as presented on March 21, may I summarize the details as follows:

Present Status: Freeport did some exploratory work from March to December, 1941. This consisted of drilling and crosscutting. The property was finally turned back to the owners in December and is now open. I am sure that there would be no objection to a personal discussion of the property.

Mine or Prospect: I look at the property as an excellent prospect, despite our negative work of last year. This qualified to a certain extent any idea I may have given Mr. Charles that I consider the area a proven mine.

The main purpose of this letter is to place in writing my position. I am not promoting this property and do not intend to. In short, I want absolutely nothing from Majuba Hill. It was on my recommendation that the work was done, which naturally explains my continued interest in the property.

Mr. Charles and his son, Benj. C. Charles, are very good friends and have shown a definite interest in the Hill's possibilities. Anything I can do to help them on this problem I will do, providing it conforms to the policy of the company I represent.

In conclusion, Mr. Charles is perfectly correct when he tells you of my disappointment when we were not allowed to continue the work. However, life is far too interesting and Freeport a very good company to work for. Therefore, I am not contemplating suicide because of this denial.

Trusting that this will clearly place before you the position of the undersigned, I am. Yours very truly (signed) DAVID LEGGENT EVANS)

April 6, 1942

Mr. David LeCount Evans
Box 190
Grants Pass, Oregon

Dear Taffy:

Thanks for your letter regarding Majuba Hill; received it at home when I returned from the ranch last night and tomorrow I have an appointment with Mr. Reber in Pomona and will let you know the outcome.

Under separate cover I am sending you a copy of the last California Mining Journal which gives some data on a tungsten property adjoining our ranch. Believe I will do some sampling on an adjoining 5000 acres and if I get any satisfactory indications would your company be interested? Let me know.

Will be writing you promptly and will include any additional news and information in my next letter.

Sincerely,

benj. C. Charles

BCC n

April 8, 1942

Mr. David Le Count Evans
Box 190
Grants Pass, Oregon

Dear Taffy:

Yesterday morning I went to Pomona and saw Mr. Harvey Reber. Briefly he wants to do business with me and advises that Mr. DeLongchamps has paid him the \$100 a month every month up to January 1, 1942. He is now three months delinquent; however I also determined that some time last year Mr. Reber needed funds and DeLongchamps paid \$700 on account of the purchase price in addition to the \$100 a month. It occurs to me that Mr. DeLongchamps will now claim the \$700 advanced last year may be used to apply on the monthly payments now in arrears. Also, I determined that the option price to DeLongchamps on the patented claims and 640 acres of ground, was for only \$10,000.00.

Mr. Reber has promised me that he will get all the papers and lease out of the safety deposit box and call me later this week. Dad and I will go out and review the matter with him carefully. I will keep you advised of my progress with Reber and report any news to you promptly.

I am sending under separate cover the California Mining Journal for October, 1941, which on Page 7 refers to Majuba Hill. I secured this from Major Boyd, and if you will recall he was one person I wanted you to meet when you were here. He is consulting engineer for Pacific Borax, and also is teaching a course in strategic minerals at U. S. C., and is very much interested in the work you did at Majuba Hill. After reading the article by Edward Morris, he had several questions he wanted me to ask you. In sampling the vein matter did you find the cassiterite disseminated clear across the 14 ft. ore body, or would it be confined in a very concentrated form to a two or three inch space within the ore body and be giving the whole cross section a 3 to 4% content? I informed Major Boyd I would ask you these questions. Naturally his object is to find out if these are very high grade streaks in a larger ore body, or if it is distributed in a commercial form. The Major has examined the tin deposits in England and also turned down the Riverside deposits, which he says are very rich on the surface, but amount to nothing at the present time; all of which you are quite familiar with.

I would appreciate it if you would return this article when you are through with it, as I would like to include it in my file on the subject.

Again, kind regards and many thanks for your continued cooperation.

Sincerely,

FREEPORT SULPHUR COMPANY

1804 AMERICAN BANK BUILDING
NEW ORLEANS, LOUISIANA

Box 190
Grants Pass, Oregon
April 9, 1942

Mr. Ben Charles
510 West Sixth Street
Los Angeles, California

Dear Ben:

Just a note in answer to yours of recent date which will tell you that I am glad you have made contacts with Reber and that I hope everything will materialize to your satisfaction. Since writing you, I have noted in the Reno Gazette a news item that states Brockbank has brought suit against Reber for supposedly due commissions which were not paid on the turning of Majuba Hill to various parties. It might be well to check this with Reber before you get yourself involved. Since the sum sought from Reber is small it would appear that Brockbank might be making an effort to secure control of the patented land.

After last writing you I received the duplicate copy which had gone to Reno and which included a copy of your father's letter to American Smelting and Refining. I appreciate the interest your father has taken in me in giving me a boost, but after reading the letter I thought it would be wise for me to clarify my position in the eyes of that company so I took the liberty of dropping them a line emphasizing the fact that I wished nothing for myself from Majuba and that I was not attempting to promote the property. I stated that my interest was based entirely on the fact that I considered the property a good prospect and that I had once recommended it. I also brought out the fact that I considered the Charles family, father and son, extremely good friends and that I had in mind doing anything I could to assist them in their Majuba interest as long as it was consistent with company policy.

I am sure that the letter was not pessimistic and will have no ill effect on the interest expressed to you by A. S. & R.

I hope that on the basis of some excuse you will be able to visit Grants Pass at some future date. If you do be sure and bring Alta because we have lots of room and would like to have you stay with us. Best regards to you, your family and John and Frankie.

Yours very truly,



David LeCount Evans

DLE:all

6.6' Cur
wants. A
4.5' 90° SW
1' 90° SW
Cura: 3.7' 90° SW

4.5' 90° SW
1' 90° SW

70'
Plan 2
Plan 1

6.6' Cur
wants. A
4.5' 90° SW
1' 90° SW

11' 90°
15' - 18'
141° - 121° SW
8' 0.5' SW

8' 0.5' SW
8' - 8' 4'

8' 0.5'

4.5' 90° SW
4.5' Cur

Plan 2
Plan 1

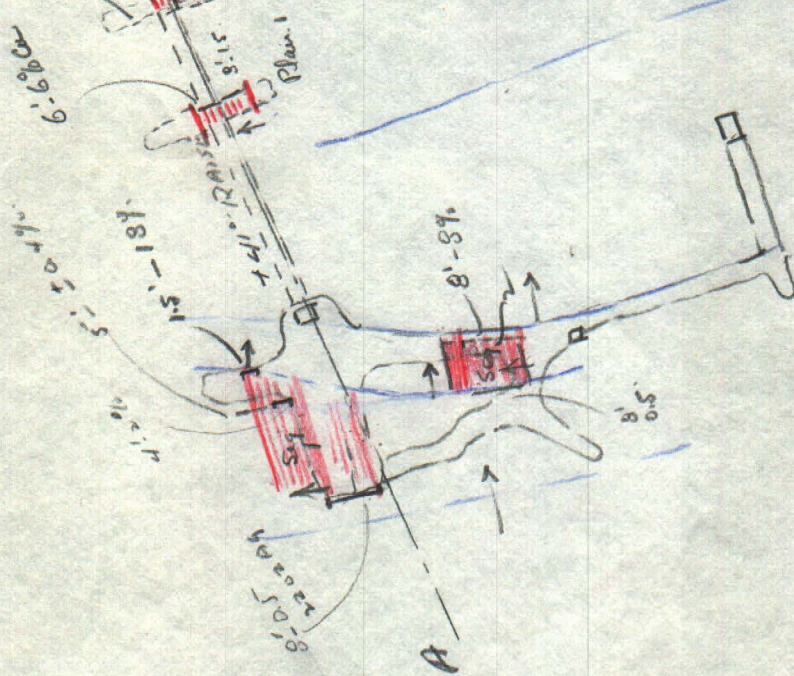
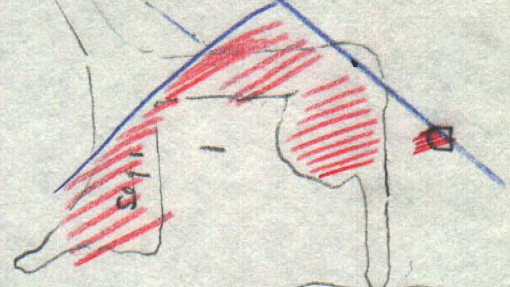

seg-2-73
above level
cut-off by
the structures

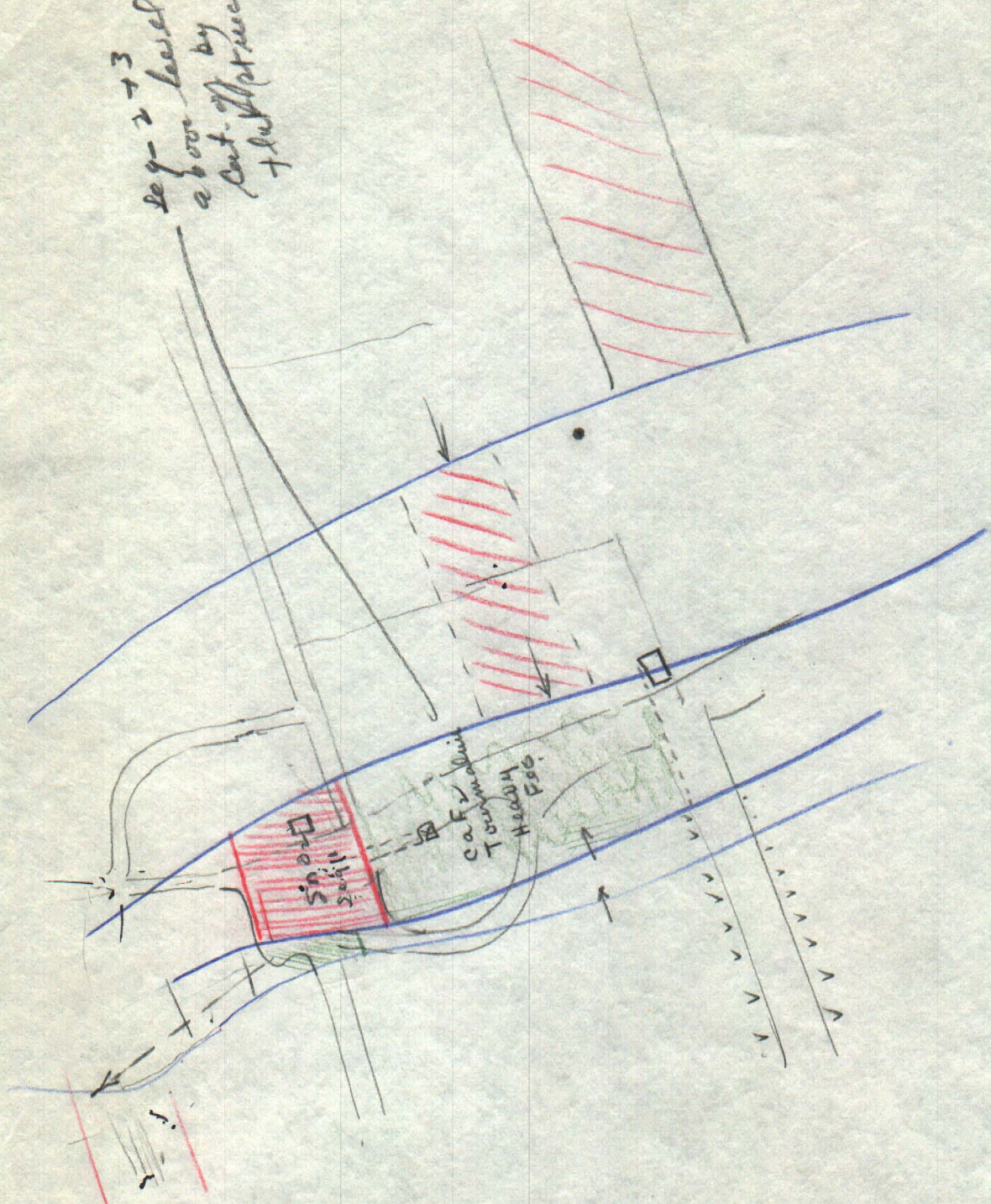

April 10. 1942.

Mr. Benj. C. Charles,
510 W. 6th St.
Los Angeles, California.

Dear Ben—

It is busy - and so I'll 'longhand' this note to you. First of all, thank you for the April copy of the Auburn paper - which I am returning under separate cover. I read the paper usually for its gossip content -; I find it particularly handy - also - on cold mornings; it keeps one's blood temperature up without the aid of furnace heat. From the start, the man has been absolutely wrong on the Burns - Oregon - tin set-up - but apparently there is no way of settling or muzzling him. The fact that some traces of tin were found by the spectrograph is not significant - inasmuch as volcanic rocks of the Burns type - commonly carry traces of tin - which are uncommon from a mining standpoint. As an example - that - take the Lynwood Ranch occurrence near Battle Mountain - which the Auburn Journal refers to as "exceptionally good" - and reputed favorably upon by Knopf and Sandberg. The tin in place - at Lynwood - occurs in isolated small quartz veins - in rhyolite flows - and from a local standpoint could never make an operation. Knopf's report has been public

property in its publication about 1915. Bill Vanderburg
showed me his report on Gunko. d.; that plus
conversations - gave a pretty clear picture of his
ideas - which were not complimentary. However in
this area - no one can condemn small place
localities until the ground is sampled.
Another example of this with occurrences - also
non-economic - are the Mexican (Mines -
in Chyolite - extending for about 450 miles -
South from northern Durango.

As for Boake Carter - Colorado has
nothing - New Mexico (Taylor and Square Creek)
occurrences - are dead mines for the Spotty -
Mexican type - and of no intrinsic value; The
Texas occurrence - in the Franklin Mountains
near El Paso - has been given the benefit
of much development - only to be proved very
small - and of no value; In Washington -
this is found in Pegmatite at Spokane -
but this in Pegmatite is like Molybdenite -
i.e. Spotty - high grade - no tonnage - and
of little value. As for Oregon - I have
already - spoken my piece.

Carter forgets North and South Carolina
(Cofrey area) - the Black Hills - finds
I meet in Temascal. The first two are
Pegmatites - and we agree on
Temascal.

Regarding the new Nevada - possibilities - they must be considered - interesting until proven otherwise. Being in the general Mojave area - where the ore has occurred in place - in association with copper and silver - associated with an acid nitrous flux - I naturally think there is a chance. It has been damnable luck - for me - to be shipped to Oregon - just when an area - I have been working in - starts to get really interesting.

I note with interest your critical contact with Reber. From what you found out - it would appear that Fred - de L. - has things fairly well in hand. I would have no qualms about approaching him directly therefore - but I would also look into this Brockbank matter - referred to in a recent letter.

I sincerely regret not having had the opportunity of meeting Major Boyd. Eva and I - Peck Guin - went to look for Proc. Coast Borax - I have secured him - but that is as far as I ever got. But - I would have valued the chance to discuss matters with Major Boyd. If there is any chance at all of his being up this way - such a discussion - ~~is~~ can be arranged - if a few days notice can be given to get me - out of the field. (Most of my time will be spent in the field -).

In answer to his question - a few inches of
high grade material did not foster
a 4% average across 14 feet. The
14 feet - show tin across that width.
as in all structure - there is some tendency
towards spottedness - with some samples
much higher grade than others - but the
best way to show it is on the attached
sheet; Give them "con sidera" -
and treat the stuff with the confidence
I know you will. The included - is merely
a taste - and duplicates what I
know you have in your mind fear
our first consideration in this property.
As you know - there is considerable data
on the ^{the} pipe - structure - etc.

Hard on the length of the article -
but know that length of discourse -
is prompted - by a sincere interest
in tin.

Best regards

W. J. H.

P.S.

None of the above - please - to and especially
to those now intimately - associated with
the property. T.

April 10, 1942

Mr. Benj. C. Charles
510 West Sixth Street
Los Angeles, California

Dear Ben:

Al is busy and so I'll longhand this note to you. First of all - thank you for the April copy of the Auburn paper which I am returning under separate cover. I read the paper usually for its gossip content; I find it particularly handy, also on cold mornings; it keeps one's blood temperature up without the aid of furnace heat. From the start the man has been absolutely wrong on the Burns-Oregon Tin set-up- but apparently there is no way of settling or muzzling him. The fact that some traces of tin were found by the Spectrograph is not significant inasmuch as volcanic rocks of the Burns type commonly carry traces of tin, which are uneconomic from a mining standpoint. As an example of that - take the Izenhood Ranch occurrence near Battle Mountain which the Auburn Journal refers to as "exceptionally good" and reported favorably upon by Knopf and Vanderburg. The tin in place-at Izenhood-occurs in isolated small gash veins, in rhyolite flows- and from a lode standpoint could never make an operation. Knopf's report has been public property since its publication about 1915. Bill Vanderburg showed me his report on Izenhood; that plus conversation gave a pretty clear picture of his ideas, which were not complimentary. However, in this area no one can condemn small placer possibilities until the ground is sampled. Another example of tin with volcanics - also non-economic - are the Mexiean Mines in rhyolite, extending for about 450 miles South from Northern Durango.

As for Boake Carter - Colorado has nothing. New Mexico (Taylor and Squaw Creek) occurrences are dead ringers for the spotty Mexiean type and of no intrinsic value; The Texas occurrence in the Franklin Mountains near El Paso has been given the benefit of much development only to be proven very small and of no value; In Washington tin is found in Pegmatite at Spokane, but tin in Pegmatite is like Moly in pegmatite, ie; Spotty - high grade - no tonnage - and of little value. As for Oregon, I have already spoken my piece.

Carter forgets North and South Carolina (Gafrey area) the Black Hills - fails to ~~visit to~~ ^{MENTION} Temescal. The first two are pegmatites and we agree on Temescal.

Regarding the New ~~Mexico~~ ^{VERADA} possibilities they must be considered interesting until proven otherwise. Being in the general Majuba area where the one known occurrence in place is Cassiteute with copper and silver associated with an acid ^{INTRUSIVE PLUG} I naturally think there is a chance. It has been damnable luck for me, to be shipped to Oregon just when an area I have been working in starts to get really interesting.

I note with interest your initial contact with Reber. From what you find out it would appear that Fred de L has things fairly well in hand. I would have no qualms about approaching him directly therefore, but I would also look into this Brockbank matter referred to in a recent letter.

I sincerely regret not having had the opportunity of meeting Major Boyd. Ever since Pete Guin went to work for Pacific Coast Borax I have envied him, but that is as far as I ever got. But I would have valued the chance to discuss Majuba with Major Boyd. If there is any chance at all of his being up this way such a discussion can be arranged if a few days notice can be given to get me out of the field (most of my time will be spent in the field) .

In answer to his question - a few inches of high grade material did not foster 4% average across 14 feet. The 14 feet shows tin across that width. As in all structure there is some tendency towards spottiness with some samples much higher grade than others, but the best way to show it is on the attached sheets; guard them "con su vide" - and treat the stuff with the confidence I know you will. The included is merely a taste and duplicates what I know you have in your mind after our first conversation on this property. As you know there is considerable data on the pipe- structure- etc.

Pardon the length of this epistle but know that length of discourse is prompted by a sincere interest in tin.

Best regards,

Tafft (signed)

PS None of the above - please - and especially to those now intimately associated with the property!

- A -

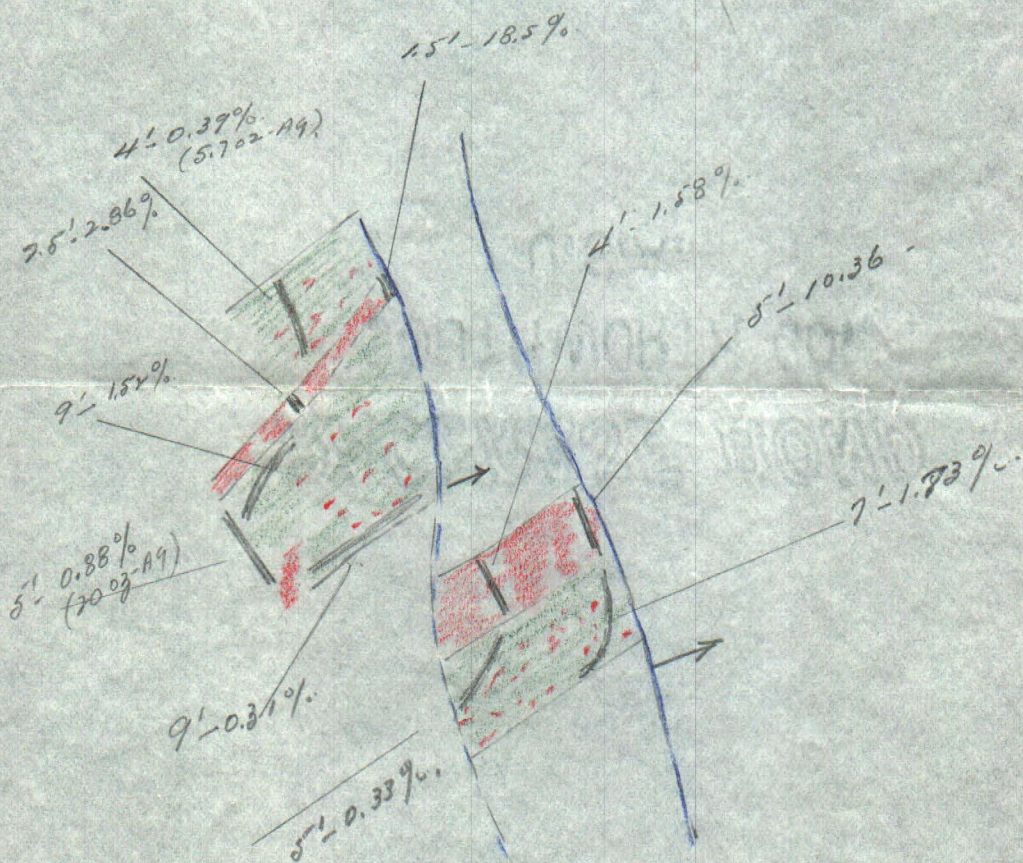
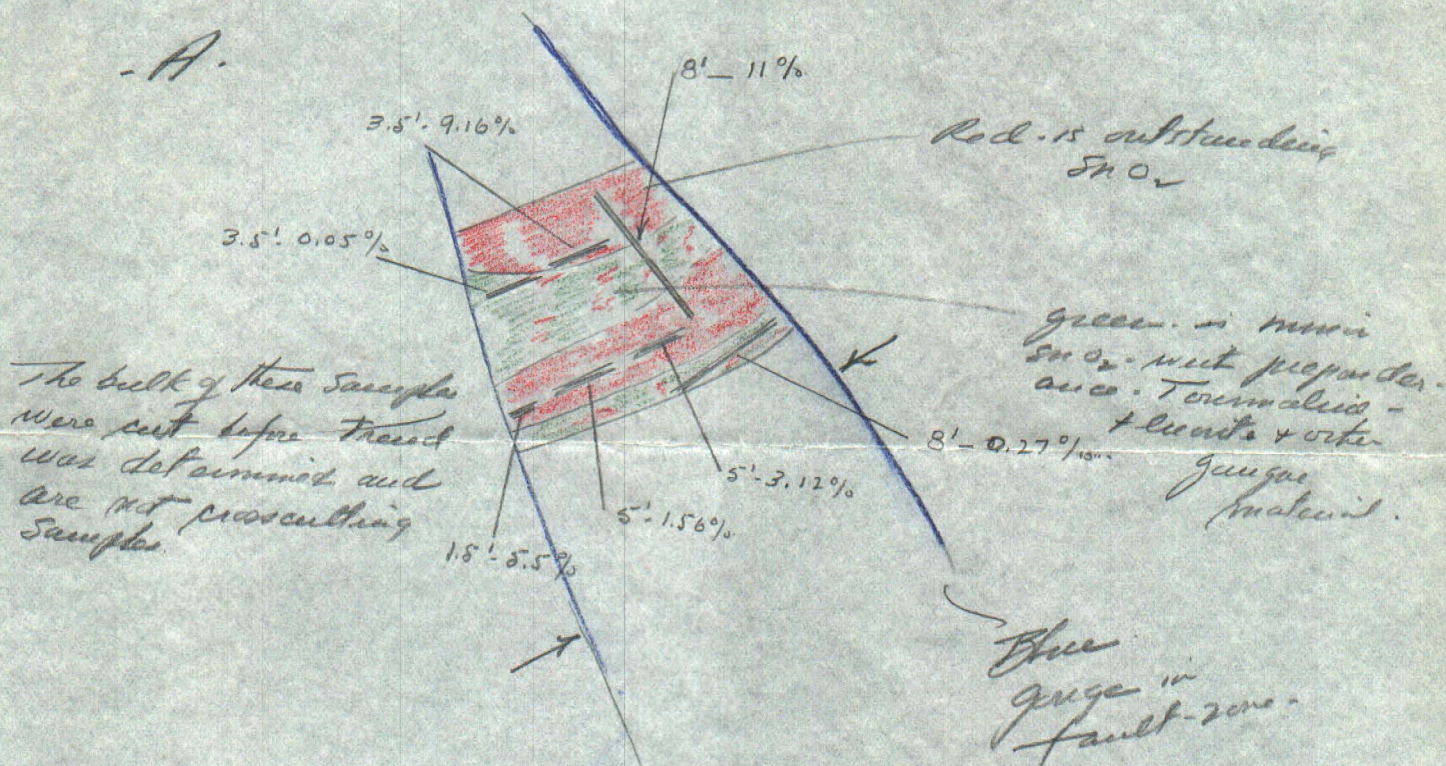

- B - in same general area as - A - but 25 feet vertically above.

April 11, 1942

Mr. F. L. DeLongchamps
Gazette Building
Reno, Nevada

Dear Mr. DeLongchamps:

This letter will serve as my notice to you that you are in default of payments to me on that certain agreement dated August 13, 1940. Said agreement pertains to your purchase of claims owned by me located on Mojuba Hill in the Antelope Mining District, Pershing County, State of Nevada.

The delinquency to date amounts to \$400.00, being \$100.00 due respectively the first of January, February, March, and April, 1942. Unless this delinquency is corrected within fifteen days after receiving this notice our agreement shall be considered cancelled in accordance with the stipulations contained therein.

With kind regards.

Yours very truly,

April 16, 1942

Mr. David L. Evans
~~Route 3, Box 902~~ Box 190
Grants Pass, Oregon

Dear Taffy:

To bring you up to date - I saw Mr. Reber April 11th, and agreed to send him the enclosed letter. I determined from reading the lease that the \$700 was a payment on the principal and had nothing to do with monthly payments and that Mr. DeLongchamps already is four months delinquent and has fifteen days to clear up any delinquency or misunderstanding. I have just received a call from Mr. Reber and he advises he has sent the letter.

He mentioned nothing of any suit by Brockbank and I have not brought the subject up. If you happen to have that clipping or knowledge from the past, please send it to me. He advised me on the telephone that he will keep me posted and at the termination of fifteen days if no payment has been made, the lease is ours. However, the old rascal would like to get the cash payment for the whole property and forget any lease. I believe the three claims and the 640 acres could probably be bought for \$5,000 and may end up by offering him that for the property.

I read your letter to Major Boyd, knowing that you would not object, as he will keep the information very confidential and he has assisted me considerably. He believes the data you sent is sufficient and it will not be necessary to make further samples. Either Harvey Mudd, American Smelting or Desert Silver will be the developers of the property if we are successful in securing the lease.

More later, and kind regards.

Sincerely,

Benj. C. Charles

BCC n

INSURANCE OFFICES
CHARLES, KEITH & RIVERS, INC.

BENJ. C. CHARLES
JOHN B. KEITH
HENRY E. RIVERS

TRINITY 2365
FIVE TEN WEST SIXTH STREET
LOS ANGELES

April 13, 1942

Mr. Harvey Reber
255 North Rebecca Street
Pomona, California

Dear Mr. Reber:

I am enclosing for your approval and signature, the original and copy of the letter you desire to forward for cancellation of the Majuba Hill lease and option. Before we can proceed, it would be best to have the property in the clear.

Please call on me if I can be of any further assistance and I appreciate your giving me the first opportunity to proceed with the work at Majuba Hill after the present option is cancelled or defaults.

Kind personal regards.

Yours sincerely,

Benj. C. Charles

BCC n

AMERICAN SMELTING AND REFINING COMPANY
Mining Department
120 Broadway, New York

H. A. Guess
Vice President

April 24, 1942

MAJUBA HILL COPPER-TIN PROPERTY
NEVADA

Mr. W. W. Charles,
510 West Sixth Street
Los Angeles, California

Dear Mr. Charles:

Mr. Rodman has given me a letter he received of April 4th from Mr. Evans, written after he had received copy of your letter to Mr. Rodman of March 21st, reference above. I have made copies of this and attach a copy herewith and as you will see from this Mr. Evans doesn't really want to be injected into the picture at all with respect to Majuba Hill.

Therefore suppose you ascertain and let me know upon just what basis in the way of a lease and option the owners of the above property would be willing to turn it over to us or if you think it better to keep us out of it for the present, then have it as a lease and option to yourself with privilege of assignment, and let me know just what these terms are and if you get an actual agreement, send me copy of the agreement and for your services in the matter I would think a compensation equivalent to say 5% of the amount we pay the owners would be fair enough, but you could also let me know as to that.

Yours very truly,

H. A. Guess (signed)

C
O
P
Y

April 29, 1942.

Dear Ben,

Thanks for your letter, dated yesterday, and many thanks for being so good about keeping me in touch with the Majuba picture. I appreciate it no end, and sincerely hope that something develops with AS and R or Brailorne. Your approach has been quite systematic and thorough; and I am sorry that I have been of so little help to you.

I know that you understand my position in the matter; it is hard for me to isolate myself, taking on only an inactive interest in Majuba; but even though my interest must be labeled 'inactive', if I can be of help, I rely on you to let me know.

As pictured in Newsweek, March 30th, our new interest is in Nickel silicates. That particular article is partially based on the new venture in Cuba, and if you have not seen it, it may clarify for you to some extent why we left Reno. These silicates have a particular affinity for certain rocks found in the northwest, as well as through out California, known as peridotites, and for the time being all of our energies are going into that investigation. I am not talking out of school. I am giving you the same sales talk we give the local prospectors, so if you know of any nice large deposits of a mineral, pistache green in color, known as garnierite or genthite, let me know and maybe I can get sent to southern California.

That is about all I have to say. Naturally I have no suggestions to make; I think you have approached Majuba in the best possible way.

Give my best regards to your father, to Alta, and of course to John and Frankie. Am still hoping that I'll see you in Grants Pass.

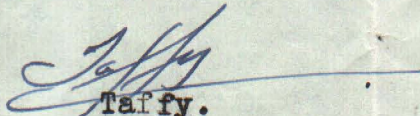
Taffy.

Fred

H/S

The original
of this letter & copy
just came in as your
letter is being mailed
I had written answer delaying
you until your instructions
are received

Best
Fred

Freight Office:
BLAIR JUNCTION, NEVADA

Express Office:
TONOPAH, NEVADA

Telegraph Address:
SILVER PEAK, NEVADA

Mail Office:
NIVLOC, NEVADA

DESERT SILVER, INC.

NIVLOC, NEVADA

May 13, 1942

Mr. Ben C. Charles
Charles, Keith & Rivers, Inc.
510 West Sixth Street
Los Angeles, California

Dear Ben:

I have received your letter of May 6th enclosing two letters from Evans regarding the Majuba Tin property.

I have gone over this new information which I found very interesting, and advise that I have gone over the whole matter with Mr. Joralemon who paid us a flying visit yesterday. He thinks that the property is worth looking into and suggests that I send Mr. Michell, our geologist, up there to study the mine and take a few samples, etc.

If you will remember, in the last letter I received from you you thought we had better wait to take a look at the property until you got the thing tied up or got some more information on whom to contact in visiting the mine. As soon as you are ready, therefore, for us to visit the property, I will make arrangements to send Mr. Michell up there to give it a thorough going over.

With very best regards, I remain,

Sincerely yours,



Fred E. Gray

FEG:RL

INSURANCE OFFICES
CHARLES, KEITH & RIVERS, INC.

BENJ. C. CHARLES
JOHN B. KEITH
HENRY E. RIVERS

TRINITY 2365
FIVE TEN WEST SIXTH STREET
LOS ANGELES

May 1, 1942

Mr. Fred E. Gray
% Desert Silver, Inc.
Nivloc, Nevada

Dear Fred:

Thank you for your letter of April 29th, just received, regarding Majuba Tin. Major Boyd called yesterday and said he had just received the enclosed bulletin and so I sent for two of the Majuba Hill No. 931 C immediately. I am enclosing it for you to read and please return it so I may give it back to Major Boyd. I will send you one of the Government bulletins as soon as received.

As to going to the property, I cannot tell you anything about it. As you realize the lease is cancelled and Monday I will see what the owner will do. I don't believe anyone is there however. Possibly it would be best to wait until I see Reber, the owner. I only wish Percy could have seen Evans when he was in Reno - since W. C. Smith, I believe is the Government man who made the report and Evans said had not properly looked at the mine. I'm sure comments on the bulletin will be made for you by Evans so that your work will be simplified.

Doug and I know Evans and his integrity is unquestioned, and for that reason alone I have ignored the many reports. It is almost a cinch for an engineer to say "no" and be right with no tin in this country in commercial quantities. However, this may be the one out of a thousand they are wrong on and a geologist such as Evans, acquainted with the ore and its occurrence should be given some consideration. Major Boyd is teaching stratigic metal classes at the University here and says the property is the only one he feels has the chance of being a real tin mine.

Please call on me for any assistance I may render and give my kind regards to Mr. Joralemon; I hope he won't think me too much of a promoter of questionable mines.

Kind personal regards.

Sincerely,

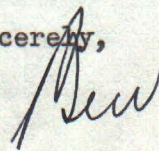

Benj. C. Charles

BCC n

Box 190
Grants Pass, Oregon
May 27, 1942

Mr. Benjamin C. Charles
Charles, Keith & Rivers, Inc.
510 West Sixth Street
Los Angeles, California

Dear Ben:

Just a note to tell you that I have had a letter from De Longchamps stating that ~~our~~ lease has been given to an operator for the purpose of mining Majuba Hill copper, which in turn he hopes will pay for future tin development. Mr. De Longchamps also informs me that he has been retained as consulting engineer for the work.

You may have this information but, nevertheless, I am passing it on to you.

Very best regards.

Yours very truly,



David LeCount Evans

DLE:ptl

RECEIVED
SOUTHWESTERN
MAY 28 1942

INSURANCE OFFICES
CHARLES, KEITH & RIVERS, INC.

BENJ. C. CHARLES
JOHN B. KEITH
HENRY E. RIVERS

TRINITY 2365
FIVE TEN WEST SIXTH STREET
LOS ANGELES

June 8, 1942

Mr. David LeCount Evans
Box 190
Grants Pass, Oregon

Dear Taffy:

I certainly was surprised as you probably were when Reber gave another lease to De Longchamps. He said he gave him a five year lease to buy at \$10,000.00, and minimum royalty of \$100 per month. I don't know what the outcome will be but I did hope that by this time some work would have been accomplished on the tin. That's what the Government needs and its too bad it cannot be pushed at this time or taken over by the Government.

Hope every thing is going well with you and you are making some real progress on the nickle.

Best regards,

Sincerely,

Benj. C. Charles

BCC n

FREEPORT SULPHUR COMPANY

122 EAST 42ND STREET

NEW YORK

Box 190
Grants Pass, Oregon
June 20, 1942

Mr. Benjamin C. Charles
Charles, Keith & Rivers, Inc.
510 West Sixth Street
Los Angeles, California

Dear Ben:

I have been so busy for the past two weeks that your recent letter has gone unanswered. This is just a note to tell you that I am sorry that you were unable to acquire a Majuba option.

As I told you in a past note, Mr. De Longchamps has sublet to other parties. From his brief description, they are attempting to mine copper which is partially blocked out with the hope of a profit which could be put into further development in the tin area.

Life continues to be of considerable interest in the southwestern part of Oregon, although in this confinement to basic rocks I can sympathize with Alice in Wonderland.

I hope that eventually some circumstances will get me to Los Angeles but, in the meantime, I rely on you to keep me informed on anything I might do to assist with your Majuba ambitions. I would also like to rely on you to find me a good nickel mine.

Give my best to your father, to John, and to the respective ~~senoras~~. With very best wishes, I am

Yours very truly,



David LeCount Evans

DLE:ptl