

LINCOLN ~~THE~~ COUNTY GENERAL
ITEM ~~40~~

Papoose?

0100 0015

Las Vegas, Nevada,
May 5, 1930.

U. S. S. R. & M. Exploration Co.,
816 Newhouse Building,
P. O. Box 1785,
Salt Lake City, Utah.

Gentlemen:

ATTENTION: R. W. GIBSON:

Your letter of May 3rd received regarding the Kelly Mine, fourteen miles west of Groom Mine, Lincoln County, Nevada. Would be glad to have your engineer look at the property any time, which is convenient to you. The mine is 90 miles from Las Vegas, Nevada. You turn off at Indian Springs, take the Groom road until you come to a sign Kelly Mine 6 miles. I am at the property most of the time. It might be advisable for who ever comes to examine the mine to look up Mr. Patrick Shehan in Las Vegas, as I only come to town about once a week. He will know if I am in town. If you will advise me about one week ahead of time I can arrange to meet your engineer, take him out to the mine and bring him back.

Yours truly,

W A Smith

W. A. Smith.

WASLSW.

SUNDANCE OIL ROYALTY COMPANY

W. A. SMITH, GENERAL MANAGER

San Negeer Denver April 28-1930
Dear Mr. Cardley,

I have a lead Silver Property
14 miles West of Graham mine known as
the Kelly mine. Shaft 200 feet deep 140 feet
drift on lower level. 2 ore shoots 3 feet
incl. ore shoots continues from surface
carbonate ore. mostly cerussite some galena
runs about 20. lead 5 silver.
formations Shale. quartzite. lime,
also east west fissure. Tunnel on some
150 feet. sand carbonate ore and cerussite
width 4 to 10 feet incl this fissure
intersects with North south. Vein
~~500 feet~~ ft at Shaft

Looker like the making of a mine
have a air drill compressor and air hoist
and machines
thought your co might be in the market
for a Property.
any

I am on the ground developing
the mine and if interested drop
around and give it the once over
yourself,

W A Smith

Po Box 778

Gar Meyer near

Salt Lake City, Utah,

Date August 1st, 1933.

Name of Property: Kelly Prospect

Location of Property: 7-1/2 miles northwest of Motoqua, Utah, in Mormon Range. 40 Miles southeast of Delamar, Nevada, Lincoln County.

Presented by: Charles Kelly. (No present address) Mail might be addressed to him at Motoqua, Utah, or Royal Hotel, Park City, Utah.

Papers Submitted: None.

Owned by: Charles Kelly.

Area: 14 claims, full-sized.

Adjoining Properties: None. Virgin territory.

Facilities: (Give railroad, power, water, fuel, timber, etc.).

15 miles to railroad (at Bartley, below Caliente.)

Plenty of water.

Remarks:

Equipment:

None.

Formation:

Andesite Porphyry-Limestone contact.

Development:

30-foot shaft, 10 x 7, on the vein.

1933 14 1933 14 1933

SL-4308-7

May 1st, 1940.

Mr. W. A. Smith,
P. O. Box 711,
Las Vegas, Nevada.

RE: KELLY MINE, LINCOLN CO., NEV.

Dear Mr. Smith:

Your note of April 25th was received on my return to the office from an extended field trip. I have not had an opportunity to write you sooner concerning my visit to the Kelly mine because of the fact that I have been in the field and have been unable to properly weigh the information obtained during my visit to the property. At this time I regret to inform you that we would not be interested in the purchase or development of your property.

Yours very truly,

Miles P. Romney,
Field Engineer.

MPR/G

Kelly Mine 4.25.1949

Mr Miles P Romney

Dear sir I have been looking fore the letter you said
would be written later.
I was disappointed that I wase not hoam when you arriaved
to make the so called examination. I arriaved hoam at 10
A.M the day you departed so wase did not mis one other
much

Yours truly

W A Smith

Feb-29- 940

Mr. W. A. Smith.

Sorry not to find you at home when I called to visit you -
Presently. However I spent Part of Feb 28th and 29th - going through
the swamps and over the surface.

I had my sleeping bag and some grub - so made my self
comfortable in the Hunt house. I helped myself to 3 eggs - $\frac{1}{4}$ lb of
butter and some honey.

Will write you later.

Sincerely
Yours P. Rimmer
Field Engineer
W. S. A. R. & W. Co.

P.S. It was an awful long day to swipe you - don't
glass - that long stand is an unusually fine piece.
W. S. R.

SC 4308-7

MEMORANDUM - MR. RICHARD M. HUNT

March 7th, 1940.

Re: Kelly Mine, Lincoln Co.,
Nevada.

The Kelly mine, presented by Mr. W. A. Smith, is located 88 miles west of Caliente, Nevada, and about 14 miles south of the Groom mine. It has been operated intermittently for the past 30 years and has produced a few cars of lead carbonate ore.

The mine is developed by an adit level 152 feet in length, a 60-foot inclined winze from the adit level, and an 81 foot drift from the bottom of the winze. The adit tunnel level gains a back of about 45 feet. The workings occur in a quartzite formation which strikes northwest and dips 50-60° to the northeast. This formation has been broken by two sets of weak irregular fractures. One set coincides with the bedding while the other strikes generally east and west and dips northerly. Mineralization occurred on both types of fracture planes, but apparently only small uneconomic concentrations. In the main adit level the quartzite rock is highly broken and some lead carbonate is visible in the joints and cracks. However on the level at the bottom of the 60-foot winze the quartzite country rock is solid and the ore minerals are confined to a zone some 2 feet thick.

Most of the ore mined has been taken from a stope above the adit level. The stope is on an intersection of fracture planes, has a sill length of 20 feet, and has been mined for an average width of +3 feet. The winze follows the rake of the intersection

and evidently contained ore. The drift from the bottom of the winze follows an easterly striking fissure, and two small stopes were started where the mineralization showed about 2 feet of width.

The property as proven by the present workings is too small to be of interest.

Miles P. Romney,
Field Engineer.

MPR/G

cc - Mr. F. S. Mulock,
- Mr. E. A. Hamilton.

Property visited:
February 29th, 1940.

Dated at Phoenix, Arizona,
March 7th, 1940.

The following is an average assay of the ore from the tunnel level:
Gold .015 - silver 2.5 - copper 22.5 - iron 50.5 - lead 1.6 - zinc 1.5
manganese - antimony none - Fluorine 0.4 - Boron 0.1 - lime 1.1

As it is not a good idea to drive down into the mine to the Kelly, I shall suggest that you make the trip down to the Kelly, and look over the property, and make a report on the present state of the mine.

The property has had a long history, and after all the treatment and the delay, or something similar to this which could be satisfactory to all parties concerned, with a small monthly payment during the time of the lease.

Will be glad to hear from you.

Yours very truly,

M. P. Romney

[Signature]

SL 4508-7
P.O.Box 711
Las Vegas, Nevada.
Feb. 10th 1940.

United States Smelting Refining And Mining Co.
P.O.Box 1980
Salt Lake City, Utah.
Attention Mr Miles P. Romney.

RECEIVED
2/14/40
USSR&M Expt. Co.

Gentlemen:-

Your letter of Jan. 30th received and contents noted.
As to the ore body or bodies exposed at the Kelly mine, the method of ascertaining the average grade of ore is by taking the samples properly, and then having them assayed.

There has not been sufficient work done on or in any ore body in the breccia ore zones to determine the size or extent of same, in other words, there are, apparently, ore bodies of large demension. The values given you in my previous letter, Lead 12% silver 5oz., are based on the tunnel assays, that is, the tunnel level and also above the tunnel level. In the bottom of the 60ft. winze, and all along the crosscuts and drifts leading off from the bottom of this 60ft winze, the silver values will average from 1 - on 1½ oz. to the percent of lead. In other words, every foot you sink on this ore body the silver values increase with every foot of depth.

As to my quotations of values on car shipments, they were low, to my knowledge, there was only one car which ran below that quoted you, and that particular car was comprised of 37 tons of straight mine ore, nothing taken out, which I consider average grade of the whole mine, and was shipped for the sole purpose of finding out just what the ore would run as it came out of the mine, and that ran 19%. All the rest of the car shipments were hand-sorted so naturally they ran higher.

I shipped one car of ore to your company which ran 46% and Kelly shipped three cars (in 1916) which ran as follows:- 41% lead - 39% lead - and 53% lead. In 1926 the leasers shipped two cars to A. S. & R. Co. this went 42%.

The following is an average assay of the ore zone above the tunnel level,
Gold .015 - silver 5.4 oz. lead - 22.6 - copper .4 - Sio 60% - Zn .6 - Sul .5
Arsenic none - antimony none - Iron 5.4 - Mn trace - lime .5

As it is only a one day's trip (driving) from Salt Lake City to the Kelly, I would suggest that you make the trip down here at your earliest convenience, and look over the property for yourself. I am living at the mine at the present time.

The property can be had on a long lease, say 10% royalty, after RR and treatment charges are deducted, or something similar to this which would be satisfactory to all parties concerned, with a small monthly payment during the life of the lease.

Will be pleased to hear from you.

Yours very truly,

W.A. Smith.

W A Smith

SC 4308-7

January 30, 1940.

Mr. W. A. Smith,
P. O. Box 711,
Las Vegas, Nevada.

Dear Sir:

Mr. M. W. Woolley handed us your letter of Jan. 24th, in which you inquire concerning this company's interest in the Kelly mine.

The information contained in your letter is interesting but is not sufficient for us to determine our interest. I note that you have shipped several cars of lead-silver ore and that you report the average metal content of the exposed orebody to be 12% lead, 5 Oz. silver, and 0.06 Oz. gold. We would appreciate your telling us the dimensions of the orebody you have exposed and of your method of ascertaining its average grade. The smelter returns, or copies of them, showing the tonnage and assay information for each lot, would be of interest.

If you would care to send us that information together with any data which you have that you feel would be of assistance to us, we will be pleased to review it. We will receive it of course with the understanding that we are under no obligation other than to review it and return the same if you wish us to do so.

If you send us information for further consideration of the Kelly mine, would you please give us an outline of the price and terms under which you wish to offer the property for sale.

Yours very truly,

M. P. R.

Miles P. Romney,
Field Engineer.

MPR/G

P.O.Box 711
Las Vegas, Nevada.

Jan 24 - 40

United States Smelting Refining & Mining Co.
Newhouse Bldg.
Salt Lake City. Utah.
Attention Mr W. W. Woolley.

Gentlemen:-

I was wondering if your company would be interested in a large Lead-silver deposit, namely the East Blue Bell Group, commonly known as the Kelly Mine, consisting of ten (10) unpatented lode mining claims, situated in Lincoln County, Nevada, some 88 miles westerly from Caliente, Nevada. This town has been the main shipping point.

The formation or country rock here, is massive precambrian quartzsite. The ore occurs in breccia zones of large demensions for a length of 5100ft. strike northerly and southerly, dip 45 deg. east. At about the end line or common corner of East Blue Bell 1-2-3 and 4, which is near center of deposit, is an adit drift about 150ft. long, driven in an easterly and westerly direction which exposes a mineralized breccia ore zone. About the center of this 150ft. drift is a 60ft. winze, sunk on the downward extention of the said breccia ore, from which several car loads of hand-sorted ore have been shipped to Salt Lake smelters averaging 25% lead - 7ozs. silver - 60% Sio. 4% Fe. trace of lime, arsenic and antamony. The average metal content of the exposed body of ore is 12% lead - 5ozs. silver - .06 gold, trace of copper, antamony, arsenic and zinc. The apparent width of the breccia quartzsite ore zone is 200ft. and crops for 5100ft. in length. Judging from surface indications it is all mineralized. This mother-lode is absolutely in place and all indications are, a large lead-silver mine. Numerous other shafts, tunnels, holes have been sunk on the foot-wall side of the ore zone by the old timers with minor results. It is not a question of ore here, what is necessary is a mill on the property. The property may be had on very reasonable terms, and if you are interested will be glad to hear from you.

Yours very truly

W.A.Smith.

W.A. Smith

5-75 41
5-65 40

small hole up 15' or
2' zone looking gray
20% or less
some lichen
stepped up on rocks
6-50' \pm to NW.
stepped and hand
and galled to 5' or
into

Leaf-36.

dam adult. N 62 E
 level N 62 W. 20' 1
 21-57' N 62 W - 80'

b - 5.25 ft. from Duff

1-2	N	74	W	43'
2-3	N	87E		13'
3-4	N	73	W	18'
4-5	N	32	W	22'
5-FACE	N	42E		15'

YMP MAC: P19 - 170 -

PORTAL-1-3-84M 91.

Kelly LINE
Lincoln EQUITY, NA
Feb-29-1940 - M.P.R.

KELLY MINE
 LINCOLN COUNTY, NEV
 FEB-29-1942 - MAP 12

N
 1 = 50'

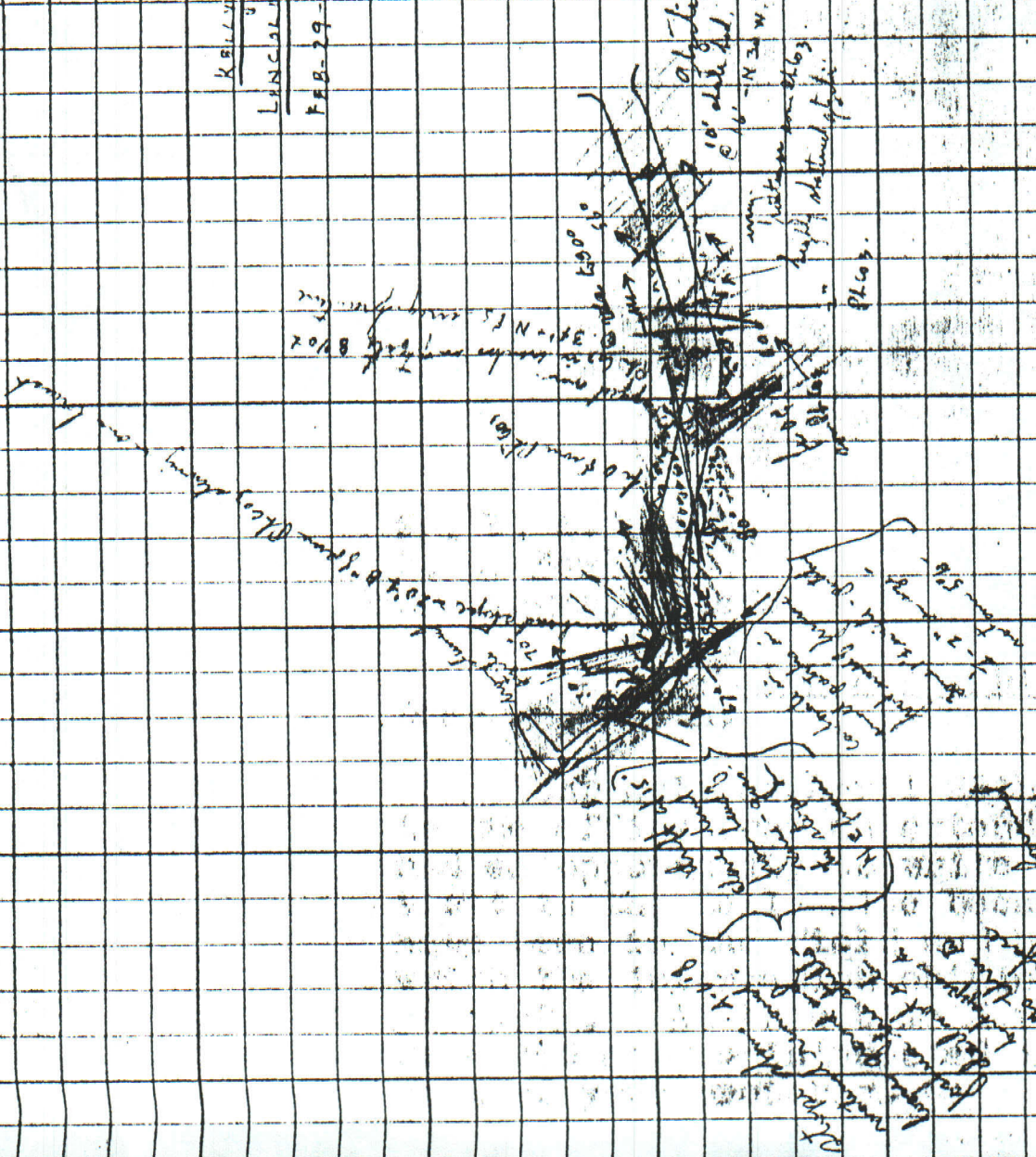

USED MAG-DEC = 170°

PORTABLE 1 - S 84 W - 41°

1-2 N 74 W 43°

2-3 N 67 E 17°

3-4 N 73 W 18°

4-5 R 32 W 22°

S-EDGE N 42 E 15°

6 - S 25 E 12° from Drift

down drift - N 60 E - 21° - 22°

land N 62 W - 70°

71-57° N 62 W - 80°

land 21°

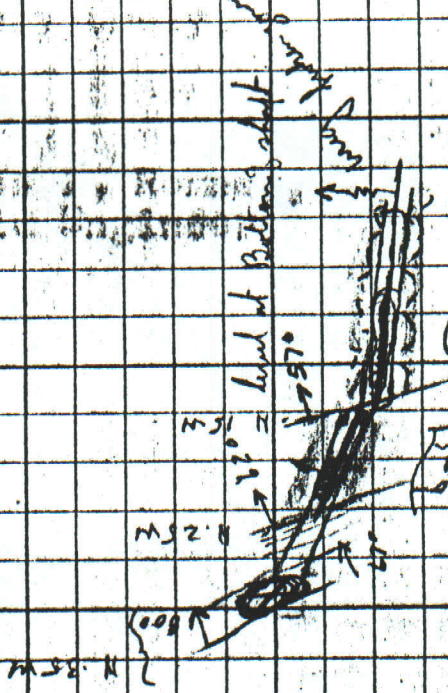

8.5' 9' 10' 11' 12' 13' 14' 15' 16' 17' 18' 19' 20' 21' 22' 23' 24' 25' 26' 27' 28' 29' 30' 31' 32' 33' 34' 35' 36' 37' 38' 39' 40' 41' 42' 43' 44' 45' 46' 47' 48' 49' 50' 51' 52' 53' 54' 55' 56' 57' 58' 59' 60' 61' 62' 63' 64' 65' 66' 67' 68' 69' 70' 71' 72' 73' 74' 75' 76' 77' 78' 79' 80' 81' 82' 83' 84' 85' 86' 87' 88' 89' 90' 91' 92' 93' 94' 95' 96' 97' 98' 99' 100'

S-75 E 41°

S-85 E 46°